

INIU
BI-B64 140W
POWER BANK
CHARGER



INIU BI-B64 140W Power Bank Charger User Manual

[Home](#) » [INIU](#) » INIU BI-B64 140W Power Bank Charger User Manual 

Contents

- [1 INIU BI-B64 140W Power Bank Charger](#)
- [2 Introduction](#)
- [3 Product Overview](#)
- [4 Specifications](#)
- [5 Charge Your Devices](#)
- [6 Warnings](#)
- [7 Troubleshooting](#)
- [8 Warranty](#)
- [9 FAQs](#)
- [10 Video-INIU BI-B64 140W Power Bank Charger](#)
- [11 References](#)
- [12 Related Posts](#)

INIU

INIU BI-B64 140W Power Bank Charger



Introduction

The INIU BI-B64 140W Power Bank Charger. This advanced power bank is made to meet the needs of modern tech users with its high-capacity charging, multiple output ports, and sleek design. With a robust 25,000mAh capacity, it ensures that your gadgets stay powered throughout the day. The power bank features fast charging capabilities, allowing you to quickly recharge computers, smartphones, and other high-power devices. Its multiple ports, including USB-A, USB-C, and Micro USB, provide versatile charging choices. Additionally, the compact and portable form makes it easy to carry around. The digital LED display shows the leftover battery percentage, and built-in safety features protect against overcharging, overheating, and short circuits. Trusted by over 38 million users, INIU ensures safe and efficient charging. Let's study its detailed specifications, usage, care, upkeep, and troubleshooting tips.

Product Overview

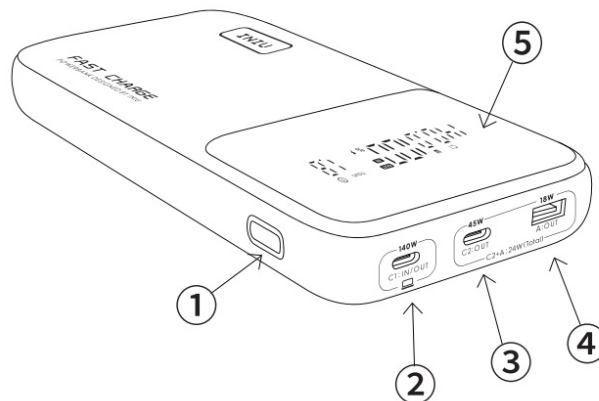

- power button
- Type-C1 Input/Output
- Type-C2 Output
- Type-A Output
- LED Power Display

Specifications

Specification	Details
Capacity	27,000mAh / 99.9Wh
Size	7.23.51.0in / 183.8926.5mm
Weight	22oz / 624g
Input	
	Type-C1: 5V=3A, 9V=3.0A, 15V=3.0A, 20V=5.0A, 28V=3.5A (100W Max)
	Type-C1 (PD3.1): 5V=3.0A, 9V=3.0A, 12V=3.0A, 15V=3.0A, 20V=5.0A, 28V=5.0A (140W Max)
	Type-C2 (PD3.0): 5V=3.0A, 9V=3.0A, 12V=3.0A, 15V=3.0A (45W Max)
	USB-A: 5V=3.0A, 9V=2.0A, 12V=1.5A (18W Max)
Output	
	Type-C1 + Type-C2: 100W Max + 45W Max (145W Total)
	Type-C1 + USB-A: 100W Max + 18W Max (118W Total)
	Type-C2 + USB-A: 24W Total
	Type-C1 + Type-C2 + USB-A: 100W Max + 24W (124W Total)

Understanding the Power-Button Actions for LED Power Display Modes

Button Behavior	Display Mode Switching
Press for 5 Seconds	Switch between Pro & EZ Modes
Double-Click (when in the Pro Mode)	Toggle USB Output Power Display

NOTE:

All the LED power display modes controlled by the power-button actions mentioned above only apply when the power bank is connected to a device.

Features

- **High Capacity:** 25,000mAh capacity for multiple charges on your devices.
- **Fast Charging:** 140W output allows quick charging of laptops and other high-power devices.
- **Multiple Ports:** Equipped with USB-A, USB-C, and Micro USB ports for versatile charging options.
- **Compact Design:** Sleek and portable design for easy carrying.
- **LED Display:** Digital LED display shows remaining battery percentage.
- **Safety Features:** Built-in protection against overcharging, overheating, and short circuits.
- **Wide Compatibility:** Supports a range of devices including smartphones, tablets, and laptops.
- **INIU SAFE Fast Charge Pro:** Trusted by over 38 million global users, using only the highest-grade materials.
- **Magnetic Charge:** Built-in 1500Gs strong magnets for firm attachment to iPhone 12/13/14/15 series, enabling easy snap and charge.
- **Extra Power:** 10,000mAh capacity adds 2X extra power to your iPhone, offering extended usage time.

- **PD 20W Wired Charging:** Delivers 20W of power via the USB-C port for fast charging, 3.5X faster than original chargers.

Charge Your Devices

1. Connect your device to the power bank with a suitable cable, the LED digits will stay on during charging.
2. If your device is fast-charging-capable, connect it to the power bank with a fast-charging cable, and the indicator will stay on during fast charging.
3. When the power level is low, the LED digits will keep blinking.
4. **Note:** The Inis power bank comes with a Pu 3. 140w cable equipped with a t-mark chip. For optimal fast charging, we recommend using a cable that supports 100W or higher with an E-mark chip.

Recharge Your Power Bank

- Connect the power bank to an adapter with a USB-C cable, and it will start to charge automatically. While charging, the last digit will keep blinking until a solid 100% is displayed.
- To recharge it under the fast charging mode, both the adapter and the cable are required to be fast charging supported. The indicator” will stay on during fast charging.
- The charging time varies depending on the Power of the adapter used

Adapter Type	Charging Time
100W Fast-Charge Adapter	1.8h
65W Fast-Charge Adapter	2.3h
45W Fast-Charge Adapter	3.2h
36W Fast-Charge Adapter	4.8h

Warnings

Read all the important information below before using this BI-B64 140W Power Bank.

1. Do not drop, open, disassemble, or crush the product.
2. Do not use the product near a heat source or liquid.
3. Do not use chemical detergents.g, alcohol) to clean the product. Use a soft and dry cloth.
4. To preserve the battery lifespan, please use and recharge the power bank at least once every two months.

Troubleshooting

Issue	Possible Cause	Solution
Power bank not charging	Faulty cable or adapter	Try using a different cable or adapter
Device not charging	Incompatible device or faulty cable	Ensure device compatibility or replace the cable
Overheating	High ambient temperature or prolonged use	Allow the power bank to cool down before using again
LED display not working	Battery depleted or internal issue	Charge the power bank fully or contact customer support
Slow charging	High power consumption or multiple devices connected	Disconnect some devices or use a higher-rated cable

Warranty

At INIU, we use only the highest-quality materials, giving us the confidence to provide an industry-leading **3-year warranty** for each item.

- 30-day money-back guarantee
- Hassle-free 3-Year Warranty
- Lifetime technical support Whatever you need, we're here to help.

Just get in touch with us at: support@iniu.shop You will get timely assistance, replacement, or refund. We promise to make things right with our wholehearted service.

FAQS

What is the capacity of the INIU BI-B64 140W Power Bank Charger?

The INIU BI-B64 140W Power Bank Charger has a capacity of 25,600mAh.

How many devices can the INIU BI-B64 140W Power Bank Charger charge simultaneously?

The INIU BI-B64 140W Power Bank Charger can charge up to three devices simultaneously.

What is the maximum output power of the INIU BI-B64 140W Power Bank Charger?

The maximum output power of the INIU BI-B64 140W Power Bank Charger is 140W.

What types of ports are available on the INIU BI-B64 140W Power Bank Charger?

The INIU BI-B64 140W Power Bank Charger features two USB-A ports and one USB-C port.

How long does it take to fully charge the INIU BI-B64 140W Power Bank Charger?

It takes approximately 2.5 hours to fully charge the INIU BI-B64 140W Power Bank Charger.

What safety features does the INIU BI-B64 140W Power Bank Charger include?

The INIU BI-B64 140W Power Bank Charger includes safety features such as overcharge protection, over-discharge protection, and short-circuit protection.

How much does the INIU BI-B64 140W Power Bank Charger weigh?

The INIU BI-B64 140W Power Bank Charger weighs approximately 1.2 pounds (550 grams).

What materials is the INIU BI-B64 140W Power Bank Charger made of?

The INIU BI-B64 140W Power Bank Charger is made of high-quality ABS and PC materials for durability.

What is the input power required to charge the INIU BI-B64 140W Power Bank Charger?

The input power required to charge the INIU BI-B64 140W Power Bank Charger is 60W via the USB-C port.

How durable is the INIU BI-B64 140W Power Bank Charger?

The INIU BI-B64 140W Power Bank Charger is designed to be highly durable, with a robust build that can withstand daily wear and tear.

Video-INIU BI-B64 140W Power Bank Charger



[Download this file: INIU BI-B64 140W Power Bank Charger.mp4](#)

References

- [User Manual](#)

[Manuals+](#), [Privacy Policy](#)

This website is an independent publication and is neither affiliated with nor endorsed by any of the trademark owners. The "Bluetooth®" word mark and logos are registered trademarks owned by Bluetooth SIG, Inc. The "Wi-Fi®" word mark and logos are registered trademarks owned by the Wi-Fi Alliance. Any use of these marks on this website does not imply any affiliation with or endorsement.