



inim PREVIDIA-C-REP Repeater Panel With 4.3 Graphic Touch... Instruction Manual

[Home](#) » [INIM](#) » inim PREVIDIA-C-REP Repeater Panel With 4.3 Graphic Touch... Instruction Manual 

inim PREVIDIA-C-REP Repeater Panel With 4.3 Graphic Touch... Instruction Manual



Contents

- [1 Technical specifications](#)
- [2 Documents / Resources](#)
 - [2.1 References](#)
- [3 Related Posts](#)

Technical specifications

Power supply voltage	PREVIDIA-C-REP 19 / 30 V
Stand-by current draw	110 mA
Current draw during mains failure	80 mA
Maximum current draw	130 mA
Operating temperature	-5°C / 40°C
Dimensions	210 x 132 x 32mm
Weight	330g



EN IEC 62368-1

Isolation class		I
Terminal type	+24/A+/A-/-, +24/B+/B-/-	ES1, PS2
	Ethernet	ES1, PS1
	USB	ES1, PS1

Mounting

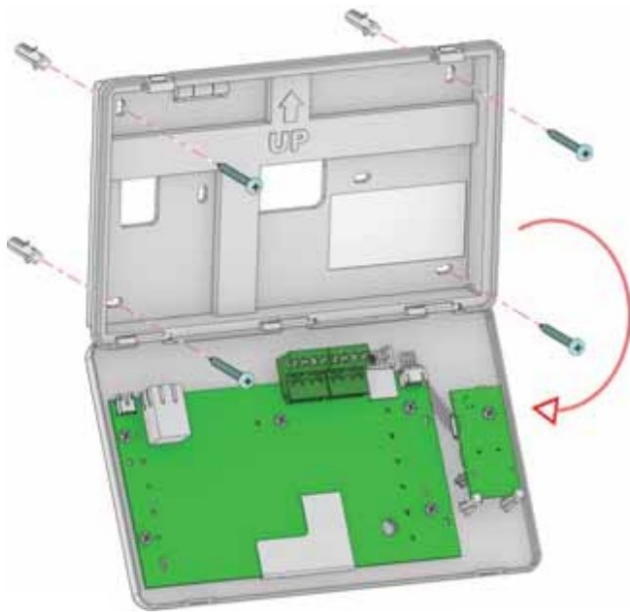

Hornet+ network connection

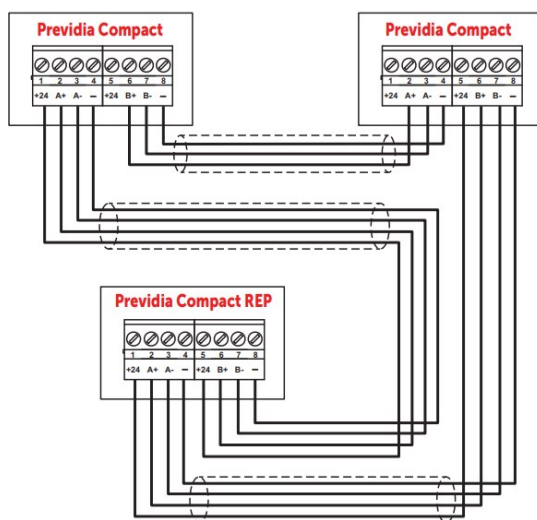
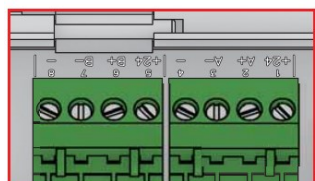
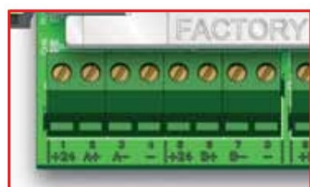

Wiring the repeater using an external power supply

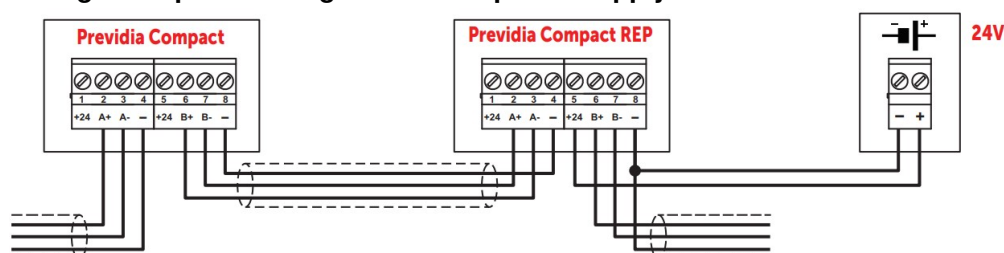

EN54:

The power supply device must comply with EN54-4 normatives

Download



Directive 2014/53/EU Hereby, INIM Electronics S.r.l. declares that these Previdia Compact control panels are in Directive 2014/53/EU Hereby, INIM Electronics S.r.l. declares that these Previdia Compact control panels are in

Documents for the users Declarations of Performance, Declarations of Conformity and Certificates concerning to INIM Electronics S.r.l. products may be downloaded free of charge from the web address www.inim.biz, getting access to Extended Access and then selecting “Certifications” or requested to the e-mail address info@inim.biz or requested by ordinary mail to the address shown in this manual.

Manuals may be downloaded free of charge from the web address www.inim.biz, getting access to Extended Access and then selecting “Manuals”

WEEE Informative notice regarding the disposal of electrical and electronic equipment (applicable in countries with differentiated waste collection systems)



The crossed-out bin symbol on the equipment or on its packaging indicates that the product must be disposed of correctly at the end of its working life and should never be disposed of together with general household waste. The user, therefore, must take the equipment that has reached the end of its working life to the appropriate civic

amenities site designated to the differentiated collection of electrical and electronic waste. As an alternative to the autonomous-management of electrical and electronic waste, you can hand over the equipment you wish to dispose of to a dealer when purchasing new equipment of the same type. You are also entitled to convey for disposal small electronic-waste products with dimensions of less than 25cm to the premises of electronic retail outlets with sales areas of at least 400m2, free of charge and without any obligation to buy

Appropriate differentiated waste collection for the subsequent recycling of the discarded equipment, its treatment and its environmentally compatible disposal helps to avoid possible negative effects on the environment and on health and favours the reuse and/or recycling of the materials it is made of.

Copyright The information contained in this document is the sole property of INIM Electronics s.r.l. No part may be copied without written authorization from INIM Electronics s.r.l. All rights reserved.

Inim Electronics S.1

Centobuchi, via Dei Laboratori 10
63076 Monteprandone (AP) Italy
Tel. +39 0735 705007M
Fax +39 0735 70491
info@inim.biz _ www.inim.biz

PREVIDIA

Documents / Resources

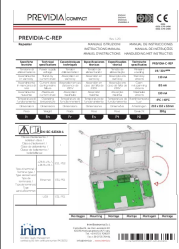
	<p>inim PREVIDIA-C-REP Repeater Panel With 4.3 Graphic Touch... [pdf] Instruction Manual PREVIDIA-C-REP Repeater Panel With 4.3 Graphic Touch, PREVIDIA-C-REP, Repeater Panel With 4.3 Graphic Touch, Panel With 4.3 Graphic Touch, With 4.3 Graphic Touch, Graphic Touch</p>
---	---

References

- [inim Inim - Sistemi di sicurezza, domotica e antincendio](#)
- [User Manual](#)

[Manuals+](#), [Privacy Policy](#)

This website is an independent publication and is neither affiliated with nor endorsed by any of the trademark owners. The "Bluetooth®" word mark and logos are registered trademarks owned by Bluetooth SIG, Inc. The "Wi-Fi®" word mark and logos are registered trademarks owned by the Wi-Fi Alliance. Any use of these marks on this website does not imply any affiliation with or endorsement.