



# Ingecafea INGE-2253 Espresso Scale with Timer User Manual

[Home](#) » [Ingecafea](#) » Ingecafea INGE-2253 Espresso Scale with Timer User Manual 

## Contents

- [1 Ingecafea INGE-2253 Espresso Scale with Timer](#)
- [2 PRODUCT INFORMATION](#)
- [3 SCALE OVERVIEW](#)
- [4 TECHNICAL SPECIFICATIONS](#)
- [5 HOW TO USE](#)
- [6 TIMER FUNCTION](#)
- [7 Battery Charging](#)
- [8 WARRANTY AND SERVICE](#)
- [9 Documents / Resources](#)



**Ingecafea INGE-2253 Espresso Scale with Timer**



## PRODUCT INFORMATION

Thank you for being our valued customer.

We are so grateful for the pleasure of serving you and hope we met your expectations. We strongly believe that premium-grade high-quality utensils make the difference between a mediocre cup of coffee/tea and one that will put a smile on your face. We are committed to helping you start your day with a delicious cup of coffee that ignites your senses.

Ingecafea creates my cup of joy!

If you have any questions, inquiries, or suggestions, please feel free to contact us at [support@ingecafea.com](mailto:support@ingecafea.com).

## SCALE OVERVIEW

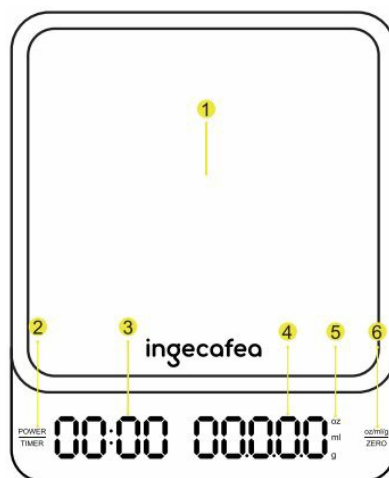

1. Weighing Platform
2. Power/Timer Button
3. Time
4. Weight

- 5. Unit Indication
- 6. Unit/Tare Button

CHAPTER 1: KNOW YOUR SEAL

PACKAGE INCLUDED

Thank you for choosing our scales. The Ingecafeia coffee scale is designed to enhance your coffee brewing experience. Our coffee scales contain all the parts listed below:

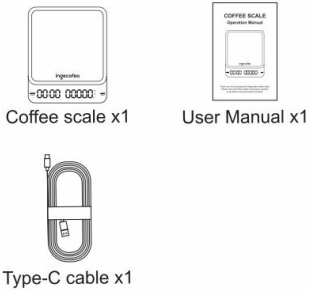

TECHNICAL SPECIFICATIONS

<div><div>● Accurate Operation</div><div>● Multiple Units</div><div>● Low Battery Indicator</div><div>● Tare &amp; Timer Function</div></div>	
Model NO	INGE-2253
Measuring Capacity	1g - 3000g
Measuring Weight	g / oz / ml
Precise Measure	0.1g/ 0.005oz/0.1ml
Indication Limit	3600g
Accuracy	±0.3%
Auto-off	5 minutes
Unit Dimensions	4.53"x 5.51" x 1.18" (L x W x H)
Unit Weight	0.6 lb
Battery	Built in 3.7V 1000mAh Lithium rechargeable battery
Applicable Adaptor (not included)	220VAC/110VAC output: 5V/1A

BUTTONS

Button	Function	Example
POWER TIMER	Turn On	Press 2 seconds
	Turn Off	Long press to turn off
	Start/Stop Timer	While the scale is turned on, press to start/stop the timer
	Reset Timer	While in the Timer mode, double tap to reset timer
oz/ml/g ZERO	Tare	While in weighing mode, short press to make tare operation
	Reset Tare	While in tare mode, double tap to reset mode
	Unit Mode	Long press to change between gram, ounce, and ml in weighing mode

## CHAPTER 2:

### HOW TO USE

#### BEFORE USING

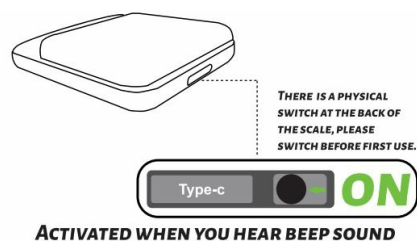

THERE PHYSICAL SWITCH AT THE BACK OF THE SCALE, PLEASE SWITCH BEFORE FIRST USE.

ACTIVATED WHEN YOU HEAR BEEP SOUND

#### NORMAL MEASUREMENT

1. Press the <sup>POWER</sup><sub>TIMER</sub> button for 2 seconds to turn on successfully in weighing mode as show below:
2. Place an item on the center of the weighing platform and choose the unit of weight by long pressing <sup>oz/ml/g</sup><sub>ZERO</sub> the Button.



3. Remove the item and then press and hold the POWER  
TIMER button (approx. 2 seconds) to turn the power off.

### Assured Accuracy Range

The scale is manufactured and tested with technical standards in our laboratory. Accuracy is assured within the range specified below

(The test was applied at a room temperature of 25 C)

Weight	Accuracy
1g to 10g	±0.1g
20g to 200g	± 0.2g
200g to 1000g	± 0.3g

(Gravity value differs slightly in different regions. This may cause inaccuracies for some high-precision scales).

### TIMER FUNCTION

1. While the scale is turned on, short-press the POWER  
TIMER button to start the timer.
2. The maximum timer will be 99 minutes 59 seconds and then will auto-off.
3. During the timer mode, press the button POWER  
TIMER again to stop the timer. Press it again to continue.
4. During the timer mode, double-tap the POWER  
TIMER button to reset the timer.



### UNIT CONVERSION

1. Place an item on the center of the weighing platform and choose the unit of weight by long pressing the oz/ml/g  
ZERO to change the Unit to “g”, “ml”, “oz”, as shown below:

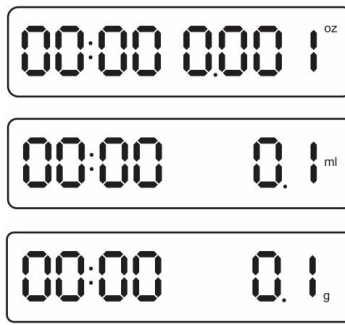

## Battery Charging

When the USB Cable is connected and the scale starts to charge, the display looks like this:

- The scale cannot be used while plugged into the power supply



- When the battery is fully charged, the LED shows



It takes about 2 hours to fully charge the battery from empty. A fully charged battery can last continuously for about 25 hours.

If it is not applicable for a long time, the battery has no power, and it needs to be flushed at the DC point (charger) for more than 15 minutes to wake this scale up.

## TARE FUNCTION

1. Press the  $\frac{\text{POWER}}{\text{TIMER}}$  switch to turn the power on.
2. Place a container on the center weighing platform.
3. Make sure that the "0.0g" is displayed before placing the container on the platform.
4. Press the  $\frac{\text{oz/ml/g}}{\text{ZERO}}$  button and "0.0g" will display.
5. Place the item into the container and the weight of the item will display.
6. When the container or item is removed, Minus(-) will be displayed.
7. To reset the weight, just need to remove the item and short-press again  $\frac{\text{oz/ml/g}}{\text{ZERO}}$  to reset.

## CHAPTER 3:

### POUR OVER COFFEE INSTRUCTIONS

1. Short Press  $\frac{\text{POWER}}{\text{TIMER}}$  to power on.



2. Place the  $\frac{\text{oz/ml/g}}{\text{ZERO}}$  server, dripper, and panel on the scale



3. Press the <sup>oz/ml/g</sup>  
ZERO zero to the weight to zero.



4. Place the ground coffee into the dripper and the weight is displayed.



5. Press the to tare the ZERO weight again POWER

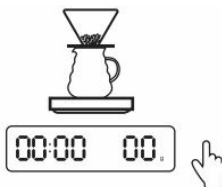

6. Short press the <sup>POWER</sup>  
TIMER Timer and start pouring hot water slowly over the coffee. Let the coffee drip for 30 seconds.



7. Continue to pour more hot water and brew for about 2 ½ mins, or until desired flavor. Press the <sup>POWER</sup>  
TIMER POWER to stop the timer. TIMER Brew ratio suggested: 20g ground coffee: 300g hot water.

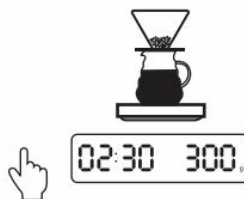

8. Press and hold <sup>POWER</sup>  
TIMER to power off.

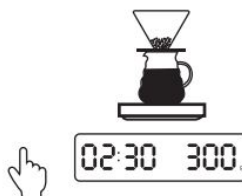

## WARRANTY AND SERVICE

### Length of Warranty:

One Year Full Warranty from the date of purchase.

### Hassle-Free Replacement Warranty:

Hassle-Free Replacement of your coffee scale. For details on how to arrange for service, please contact our service contact support at [@ingecafea.com](mailto:support@ingecafea.com).

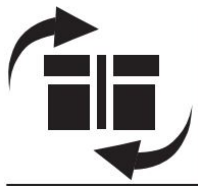

Shipping and handling charges, if any, are not included in the warranty.

Please note that the following cases are not included in the replacement warranty:

- Any defect or damage that is a result of repair, alteration, or modification carried out without the written permission of the Company.
- Using parts not manufactured, sold, or approved by the Company for replacement or repair.
- When damage is caused directly or indirectly by utility supply problems, lack of user care, electrical storm damage, or incorrect power supply.
- When the cause of a defect or damage is due to operator error.

### HAPPY WITH THE PRODUCT?

We sincerely appreciate if you can share your happiness with our product by writing a review on Amazon. Your opinion will be helpful for other shoppers on Amazon.

### NEED HELP?

Ingecafea Support Team is always here to make sure you are completely satisfied with our product! If you have any questions, inquiries, or suggestions, please feel free to contact us via Amazon or our service team at [support@ingecafea.com](mailto:support@ingecafea.com).

### CONTACT US

[support@ingecafea.com](mailto:support@ingecafea.com)

Support Hours Mon- Fri (9:00 am – 6:00 pm PST)

### Documents / Resources

<p><b>Thank you</b> for being our valued customer.</p> <p>We are so grateful for the pleasure of serving you and hope we met your expectations. We strongly believe that premium-grade high quality cereals make the difference between a mediocre cup of coffee and one that will put a smile on your face.</p> <p>We are committed to helping you start your day with a delicious cup of coffee that ignites your senses.</p> <p>Ingecafea creates my own cup of joy! If you have any questions, inquiries, or suggestions, please feel free to contact us at <a href="mailto:support@ingecafea.com">support@ingecafea.com</a>.</p>	<p><a href="#">Ingecafea INGE-2253 Espresso Scale with Timer</a> [pdf] User Manual INGE-2253 Espresso Scale with Timer, INGE-2253, Espresso Scale with Timer, Scale with Timer, Timer</p>
---	---