



InfinityLAB B08V75L359 INSTANTGO 10000 mAh External Battery with Integrated Lightning Connector User Guide

[Home](#) » [InfinityLAB](#) » InfinityLAB B08V75L359 INSTANTGO 10000 mAh External Battery with Integrated Lightning Connector User Guide 

Contents

- [1 InfinityLAB B08V75L359 INSTANTGO 10000 mAh External Battery with Integrated Lightning Connector](#)
- [2 WHAT'S IN THE BOX](#)
- [3 WIRELESS CHARGING](#)
- [4 CHARGE YOUR DEVICES](#)
- [5 RECHARGE YOUR POWERBANK](#)
- [6 CHARGE & RECHARGE SIMULTANEOUSLY](#)
- [7 BATTERY INDICATION](#)
- [8 Specifications](#)
- [9 Documents / Resources](#)
- [10 Related Posts](#)

InfinityLAB

InfinityLAB B08V75L359 INSTANTGO 10000 mAh External Battery with Integrated Lightning Connector



WHAT'S IN THE BOX



USB-C®
IN/OUT PD



USB-A
OUT

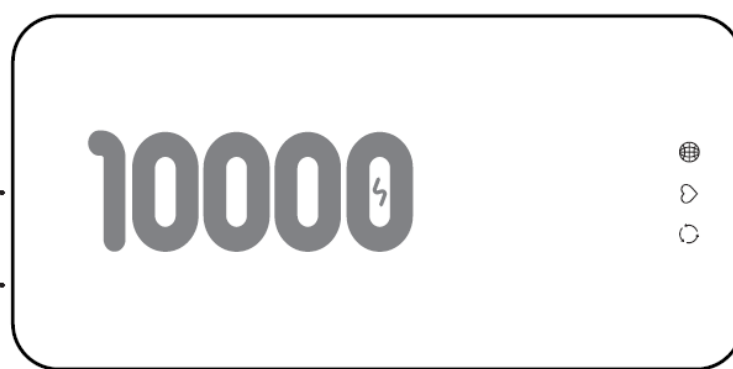

WIRELESS CHARGING

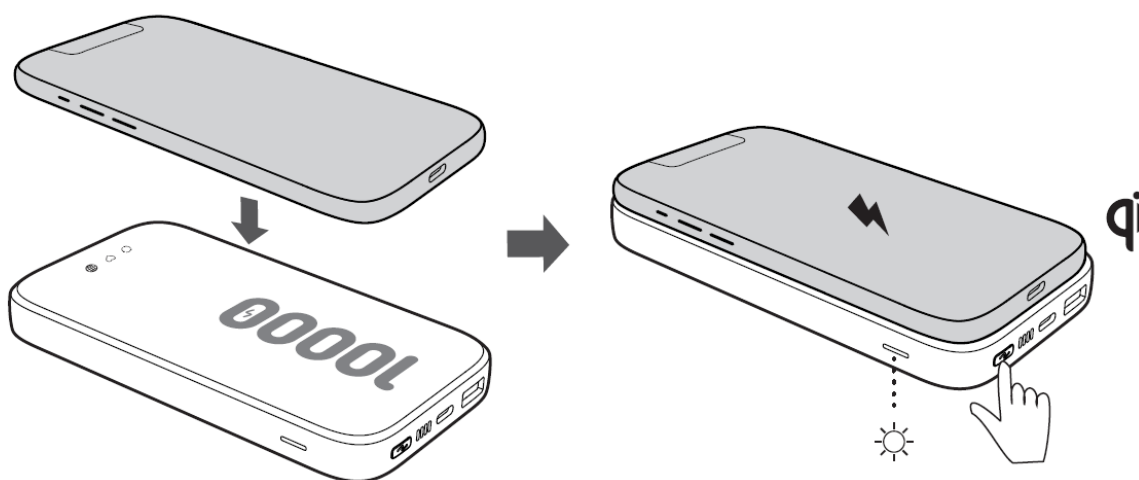

CHARGE YOUR DEVICES

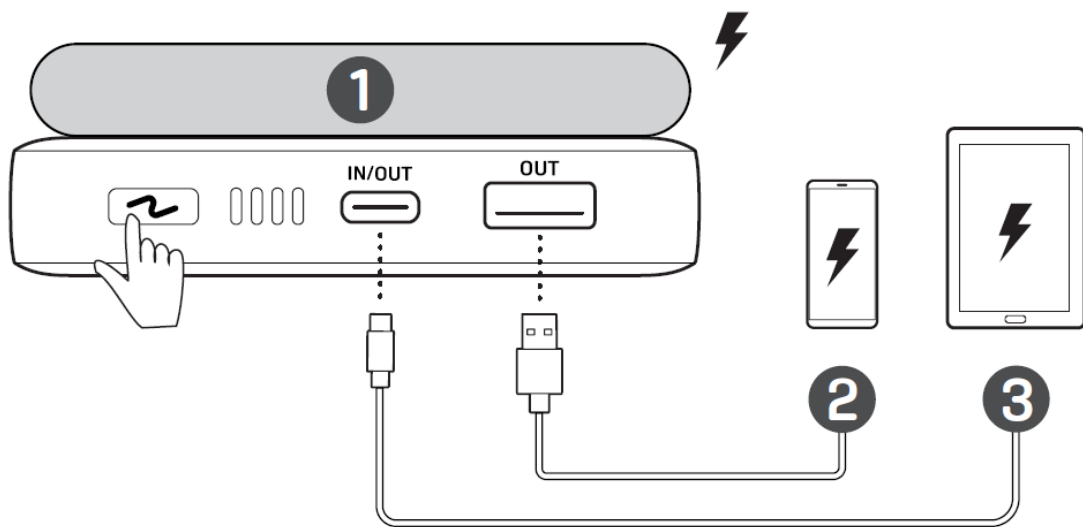

RECHARGE YOUR POWERBANK

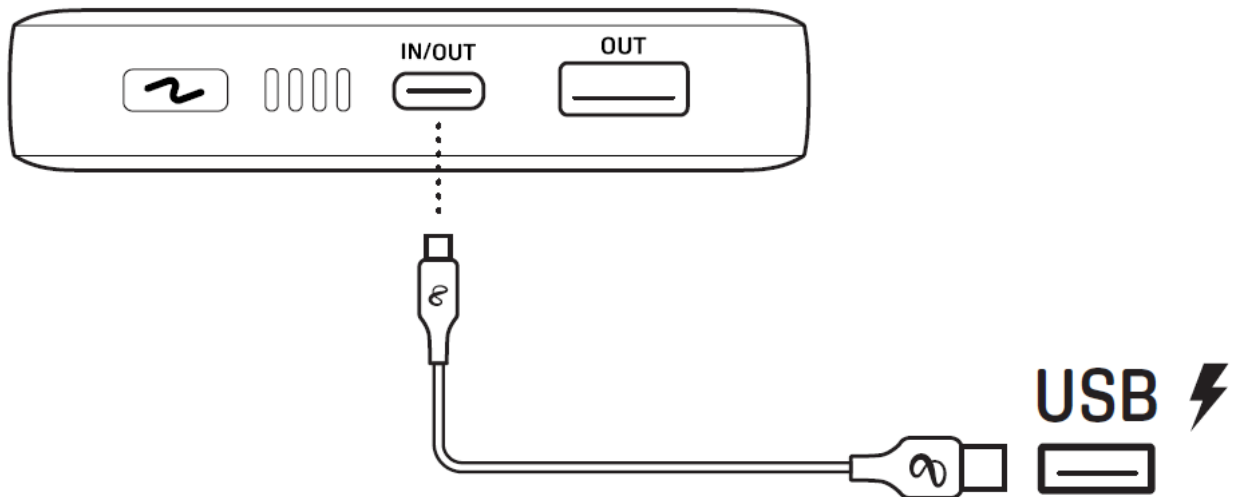

CHARGE & RECHARGE SIMULTANEOUSLY

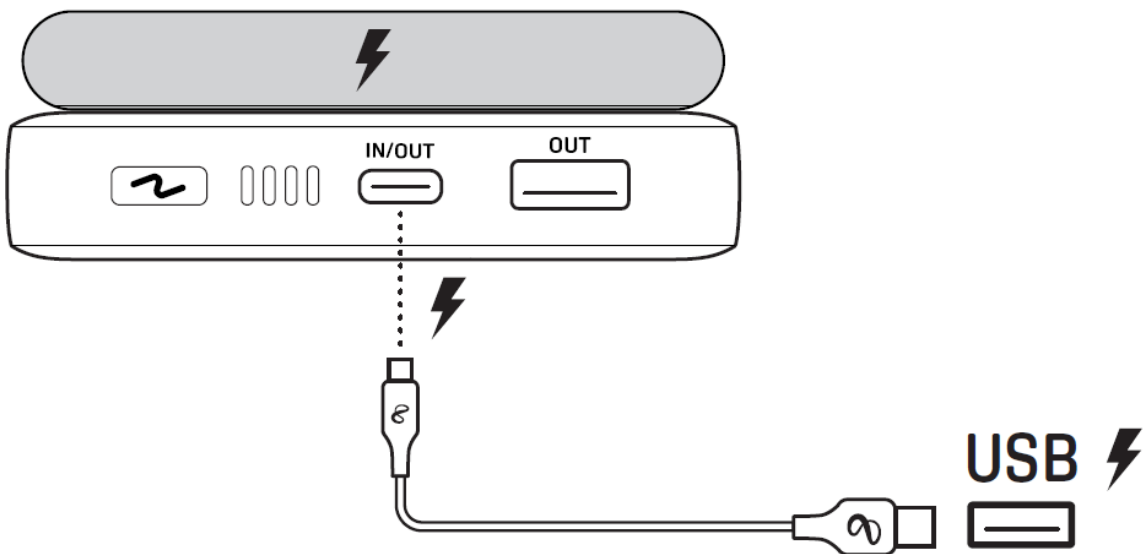

BATTERY INDICATION

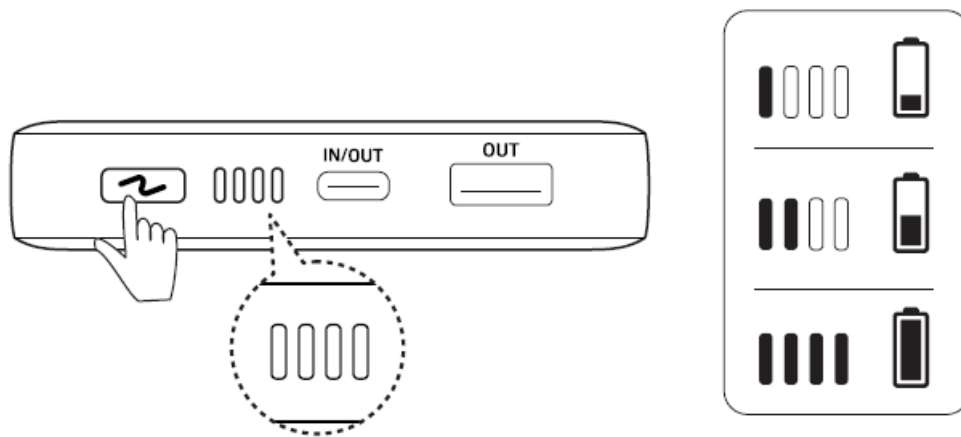

To protect battery lifespan, fully charge at least once every 3 months. Battery life will vary due to usage patterns and environmental conditions.

Specifications

- **Model Number** ILING10000W
- **Battery type** Lithium-ion Polymer 38.5 Wh
- **Operating temperature** 0~45 °C
- **USB-C in/out** 5 V 3 A; 9 V 3 A; 12 V 2.5 A; 15 V 2 A; 20 V 1.5 A
- **USB-A out** 5 V 3 A
- **Wireless out (Qi)** 5W 7.5W 10W
- **Total Output** 30 W Max.
- **RF Frequency Range** 124.359 kHz – 155.929 kHz
- **RF Field Strength** -18.97 dBuA/m @10m
- **Battery charge time** 4 hours (5 V 3 A)
- **Dimension** 145.6*75*19 mm
- **Weight** 252.1 g

Documents / Resources

