



Infinity Primus PR503CF Component Speaker Instruction Manual

[Home](#) » [Infinity](#) » Infinity Primus PR503CF Component Speaker Instruction Manual 

Contents

- [1 Infinity Primus PR503CF Component Speaker](#)
- [2 WHAT'S IN THE BOX](#)
- [3 DIMENSION](#)
- [4 INSTALLATION](#)
- [5 System set up](#)
- [6 TECHNICAL SPECIFICATIONS](#)
- [7 Documents / Resources](#)
- [8 Related Posts](#)



Infinity Primus PR503CF Component Speaker



WHAT'S IN THE BOX

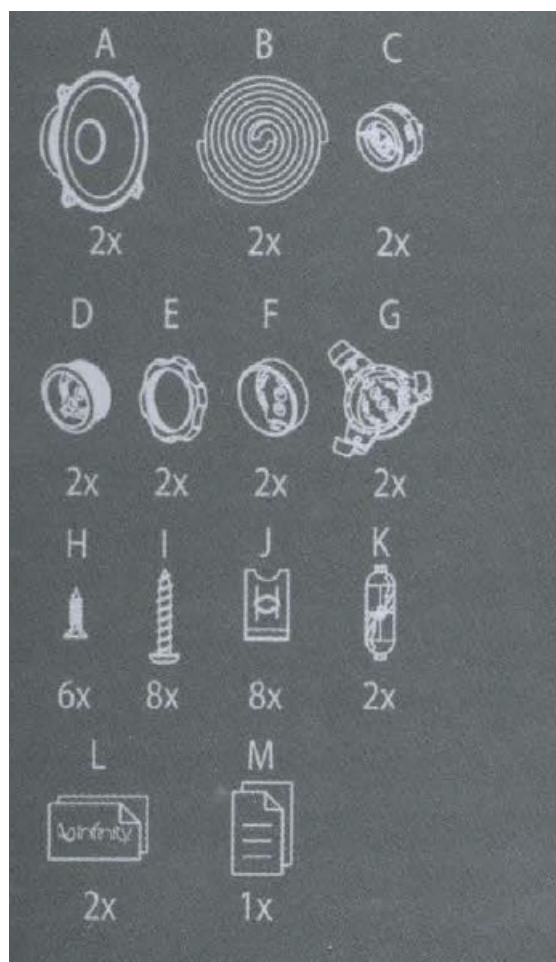

DIMENSION

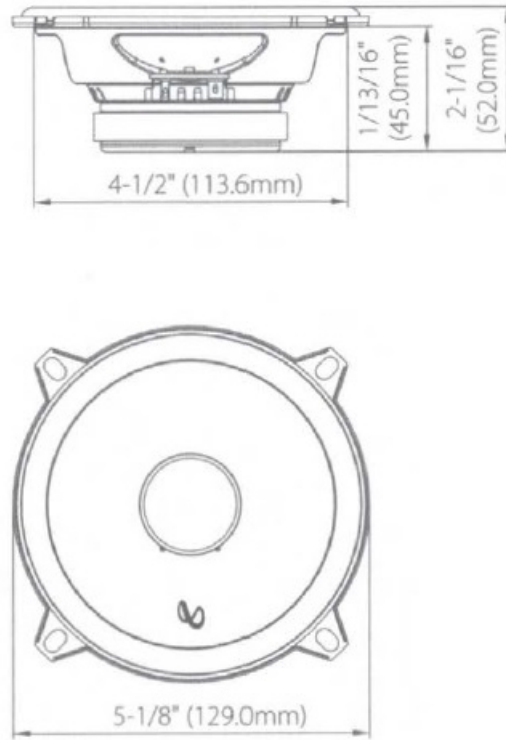

PRIMUS 503CF

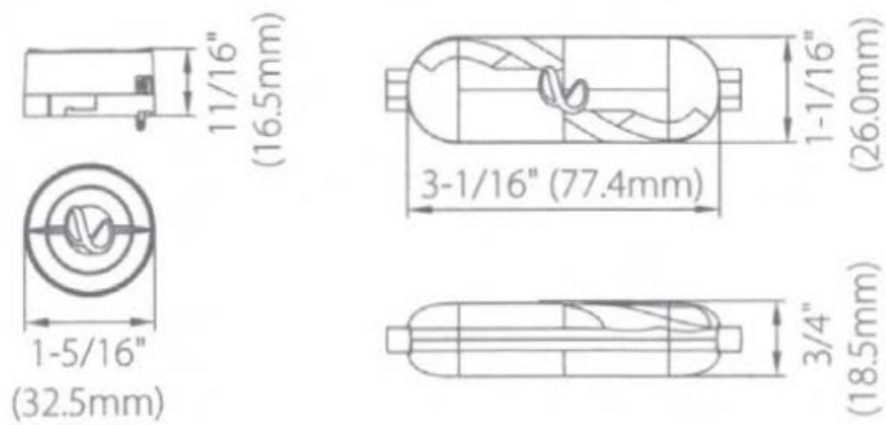

INSTALLATION

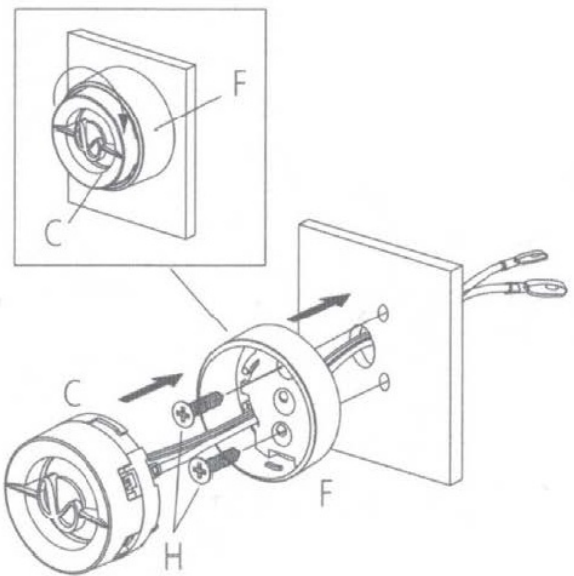
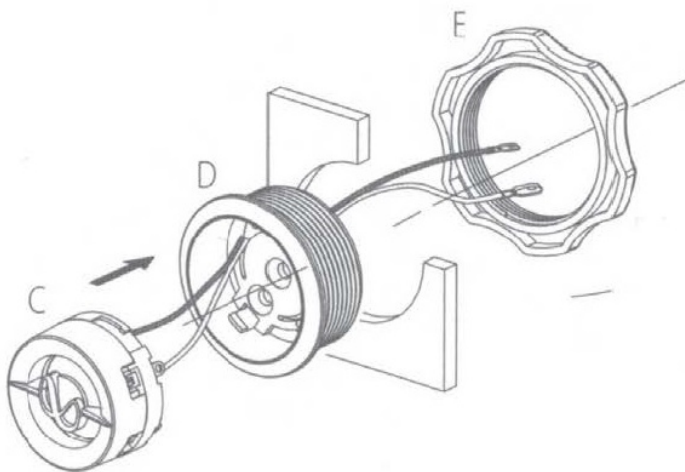
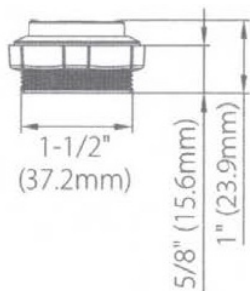
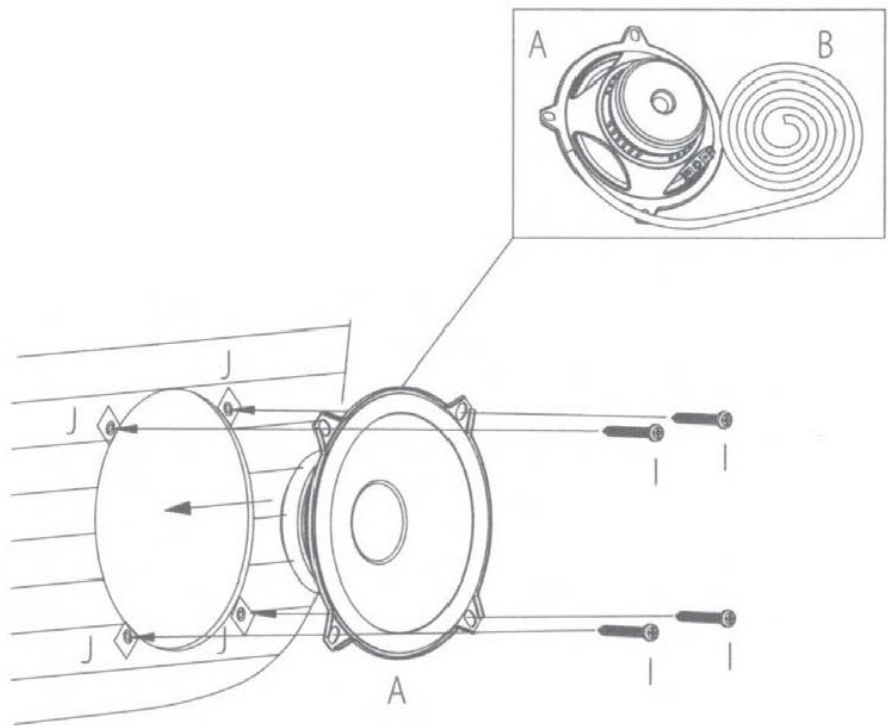
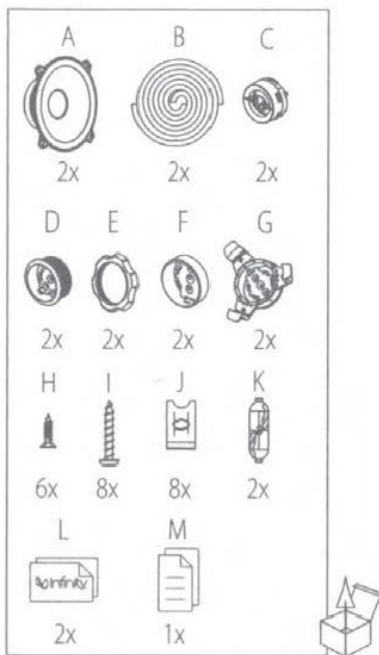

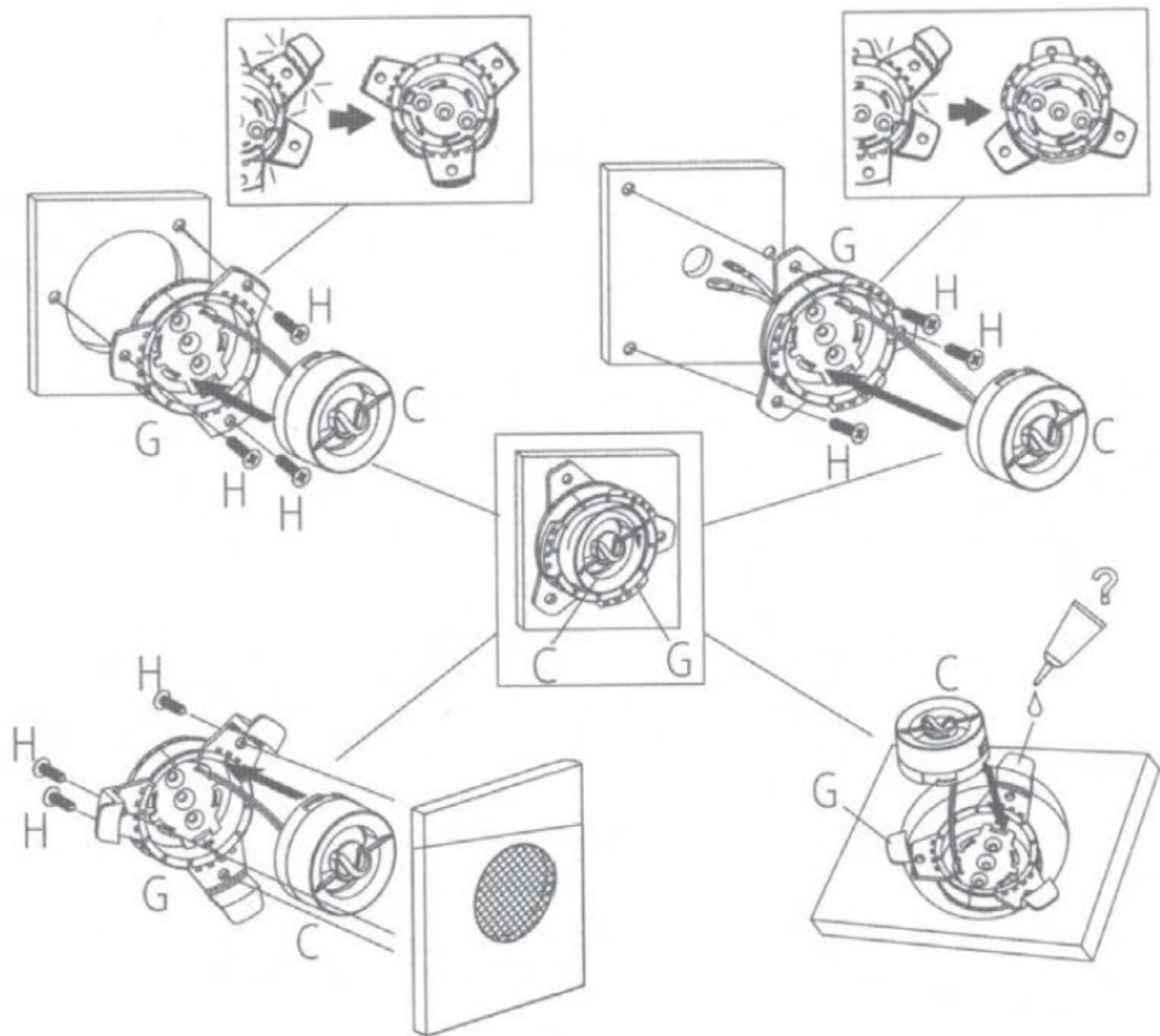

System set up

option 1

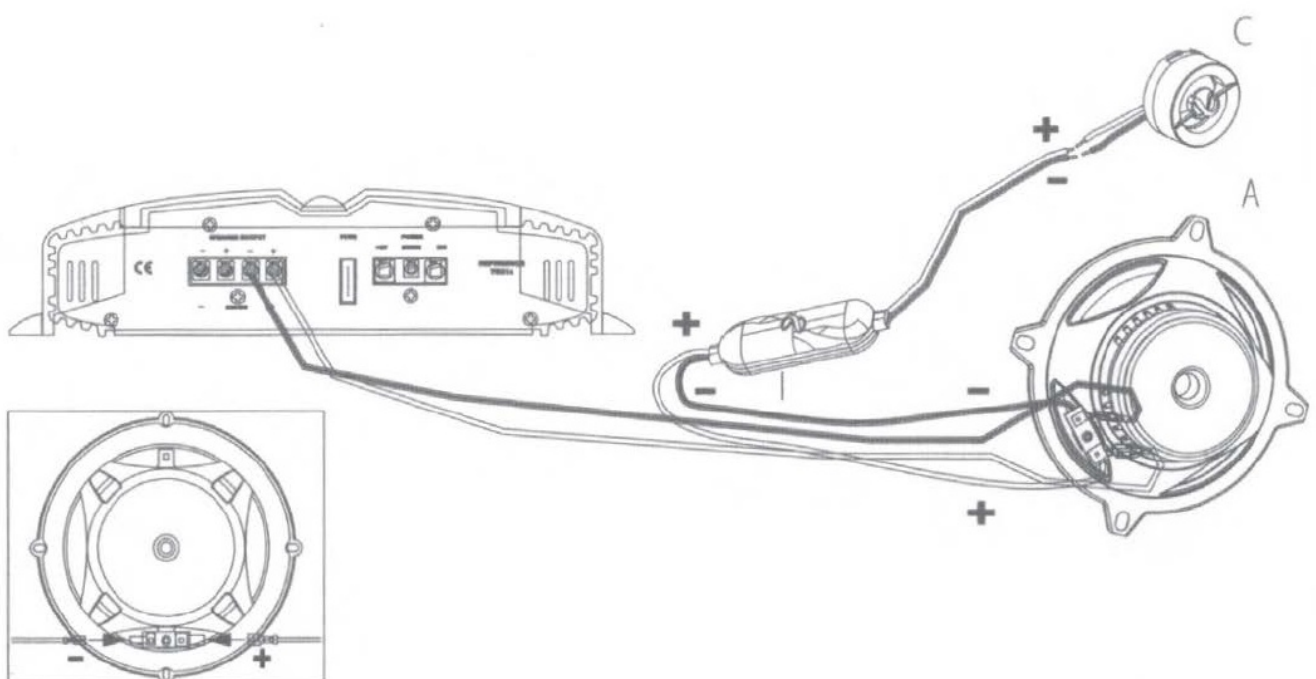

option 2

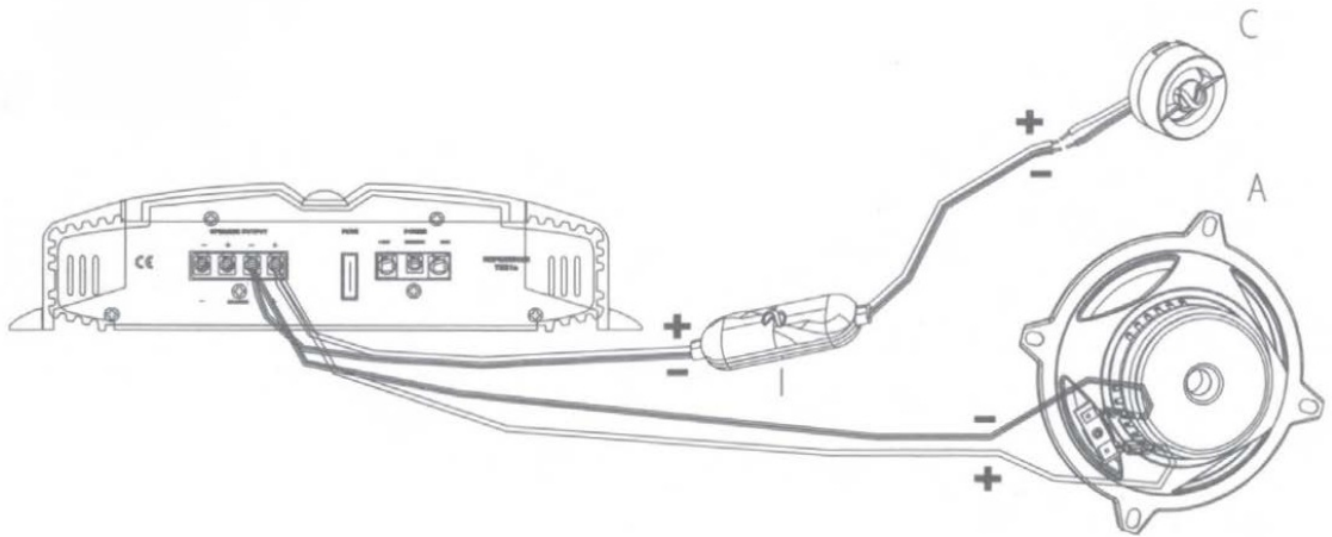

HARMAN International Industries, Incorporated, 8500 Balboa Boulevard, Northridge, CA 91329 USA
© 2022 HARMAN International Industries, Incorporated. All rights reserved. Infinity is a trademark of HARMAN International Industries, Incorporated, registered in the United States and/or other countries. Features, specifications and appearance are subject to change without notice

50W RMS, 150W PEAK

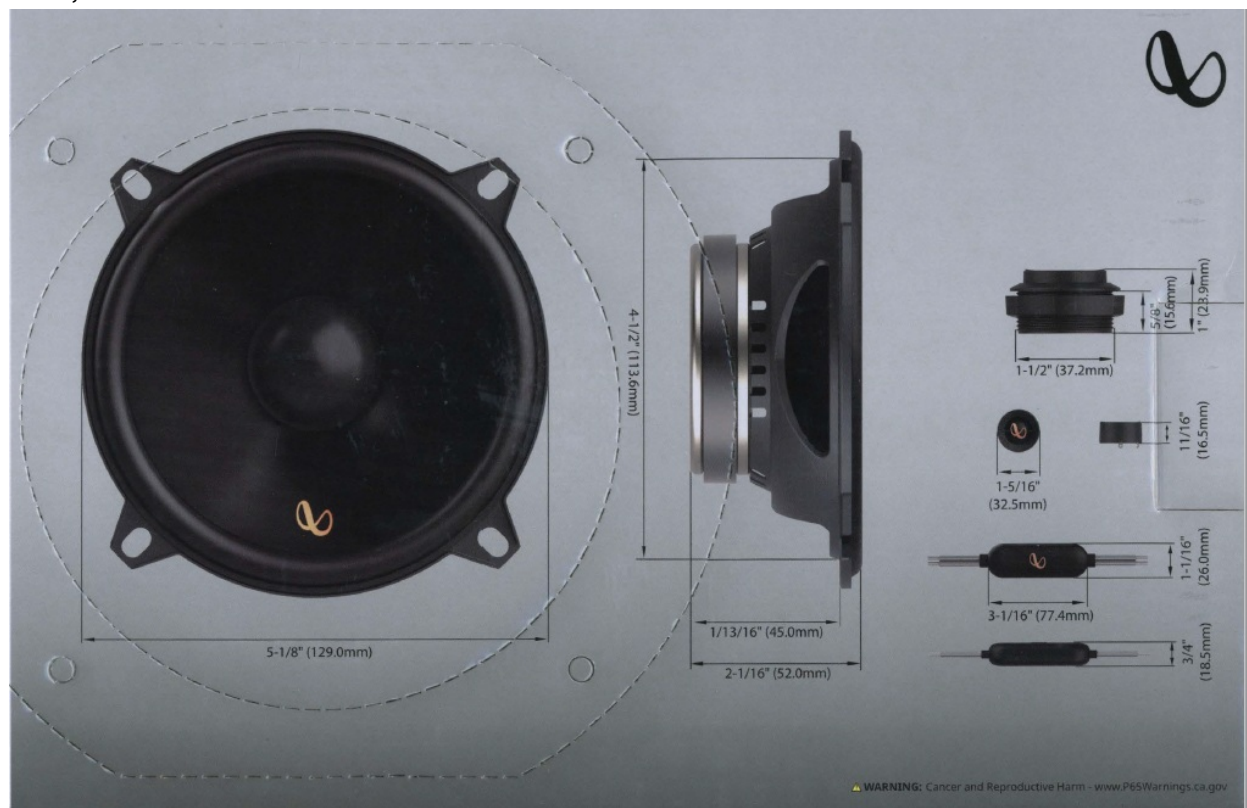

- PLUS ONE WOOFER CONE
- VENTED BASKET FRAME DESIGN
- EDGE-DRIVEN SILK-DOME TWEETER

TECHNICAL SPECIFICATIONS

- **Woofer:** 5-1/4" Polypropylene Driver
- **Tweeter:** 3/4" Silk Dome
- **Power Handling:** 50W RMS, 150W PEAK
- **Sensitivity** (2.83V@1m): 91dB
- **Frequency Response** (-5dB}: 75Hz 20kHz
- **Nominal Impedance:** 3.0 ohms
- **Crossover Point:** 5kHz@12d8/octave

Infintiy is a trademark of HARMAN International Industries, Incorporated, registered in the United States and/or other countries. Features, specifications and appearance are subject to change without notice
HARMAN International Industries, Incorporated. 8500 Balboa Boulevard,
2022 HARMAN International Industries, Incorporated. All ights reserved.

Documents / Resources

	Infintiy Primus PR503CF Component Speaker [pdf] Instruction Manual Primus PR503CF Component Speaker, Primus PR503CF, Component Speaker, Speaker
---	--

Manuals+.