



INFINITY ARCADE1up Game Table User Guide

[Home](#) » [Infinity](#) » INFINITY ARCADE1up Game Table User Guide 

INFINITY ARCADE1up Game Table User Guide



Thank you for your purchasing the **INFINITY® game table**.

We hope that you have endless hours of fun playing with your family and friends! Let the games begin ...

Contents

- 1 CONTENTS INCLUDED
- 2 PRODUCT FEATURES
- 3 PRODUCT ASSEMBLY
- 4 GETTING STARTED
- 5 FCC/ISED STATEMENT
- 6 IMPORTANT SAFETY INSTRUCTIONS
- 7 INSTALLATION
- 8 SPECIFICATIONS
- 9 ASSISTANCE OR SERVICE
- 10 TROUBLESHOOTING
- 11 Documents / Resources
 - 11.1 References
- 12 Related Posts

CONTENTS INCLUDED

- Game Table

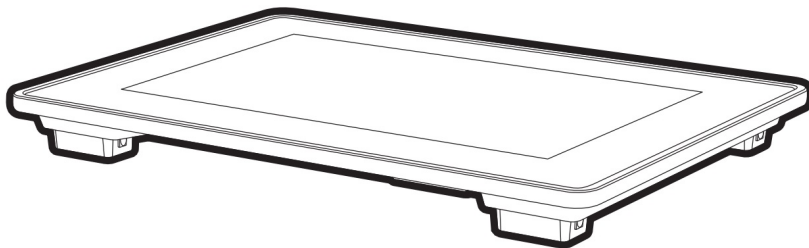

- Quick Start Guide

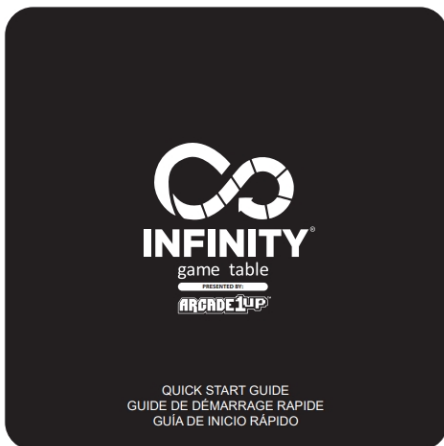

- Detachable Leg

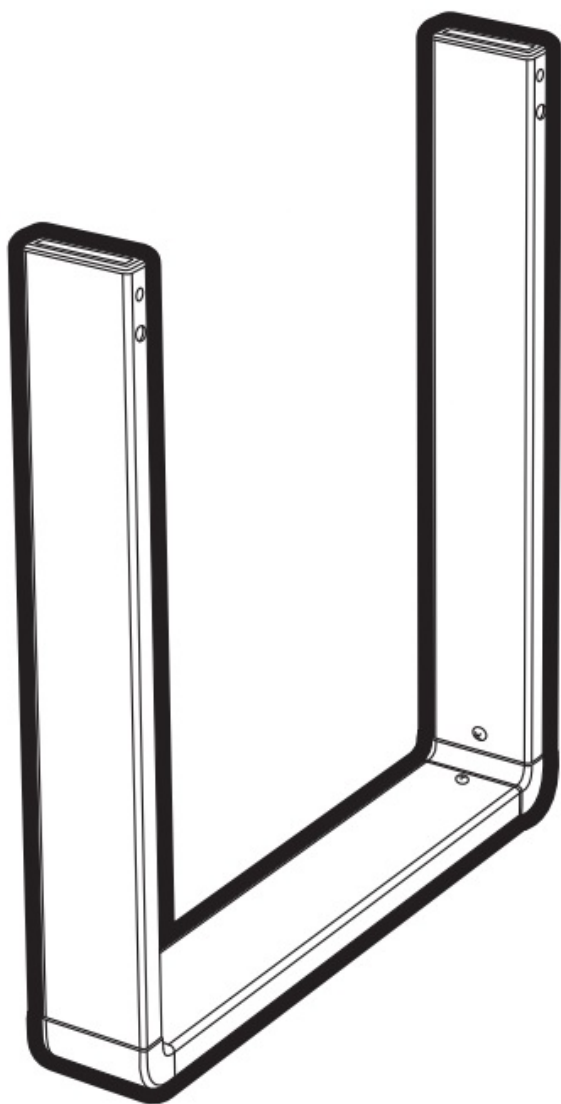

- Detachable Leg

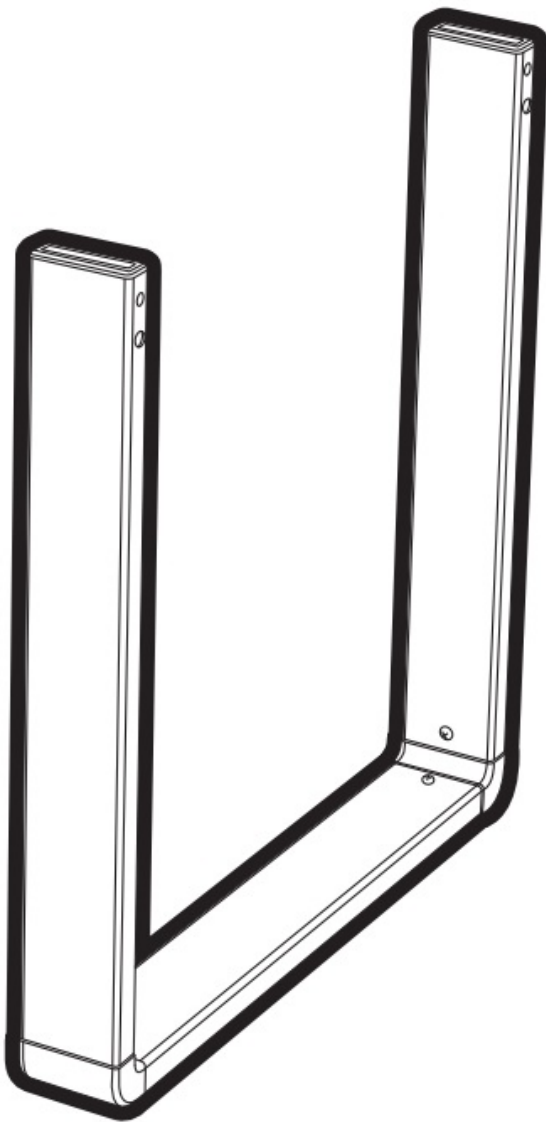

- Extension Cable

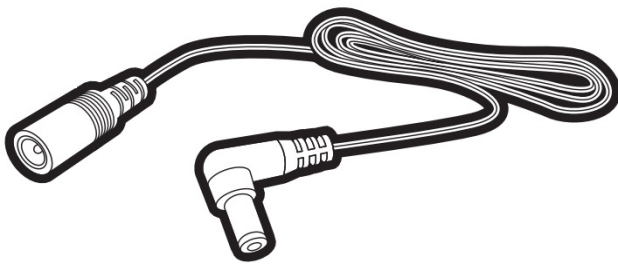

- Wipe Cloth

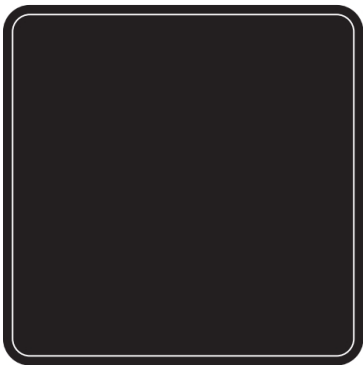

- Power Supply

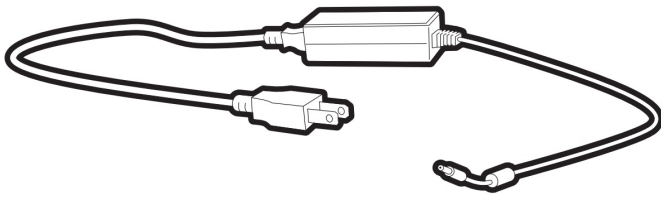

- Cardboard Coasters



- Game Blocker

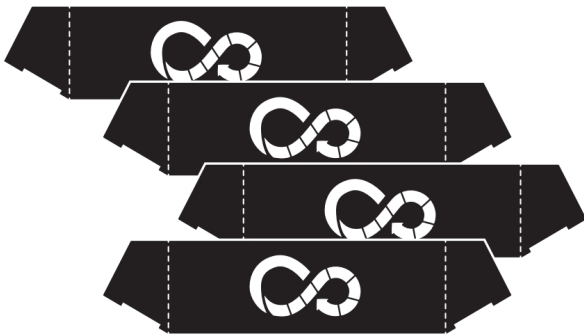

- Game Blocker Stand

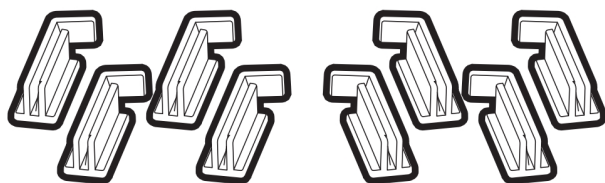

ALL PICTURES SHOWN ARE FOR ILLUSTRATION PURPOSE ONLY. ACTUAL PRODUCT MAY VARY DUE TO PRODUCT ENHANCEMENT.

PRODUCT FEATURES

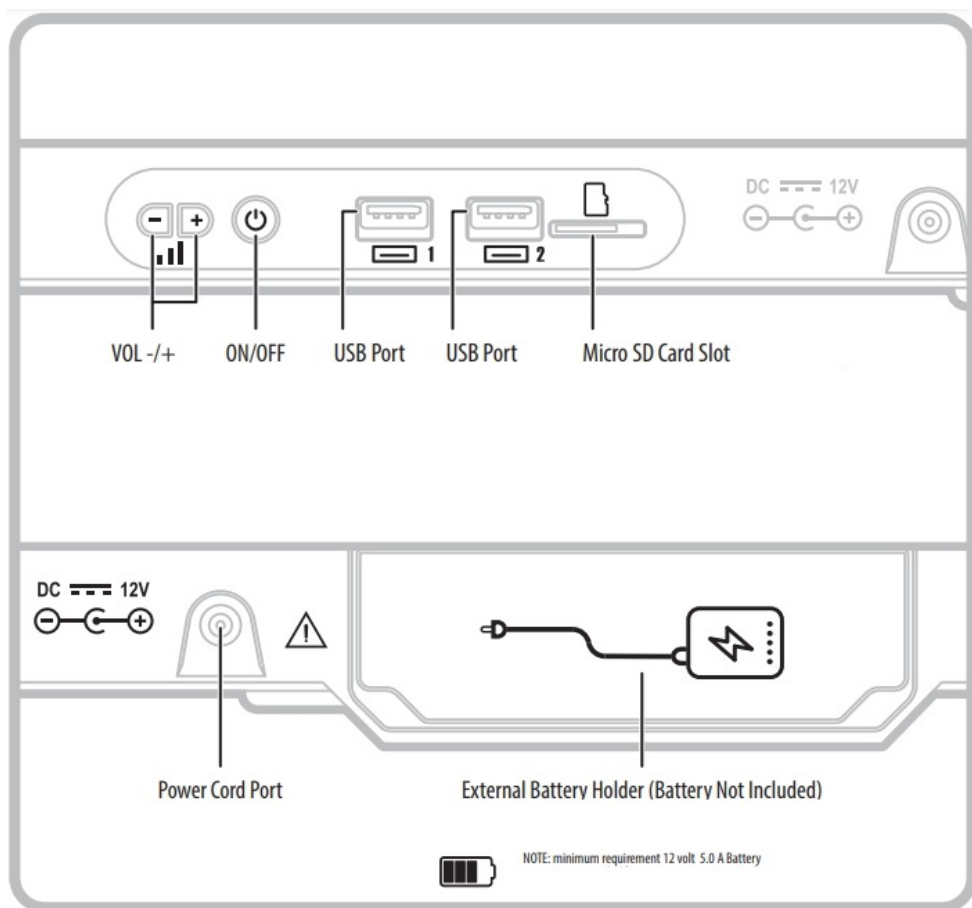

PRODUCT ASSEMBLY

- Insert the legs until you hear a click sound on all 4 legs.
- Plug in the extension power wire and clip to the inside of the leg.
- Plug in the power supply to the table.

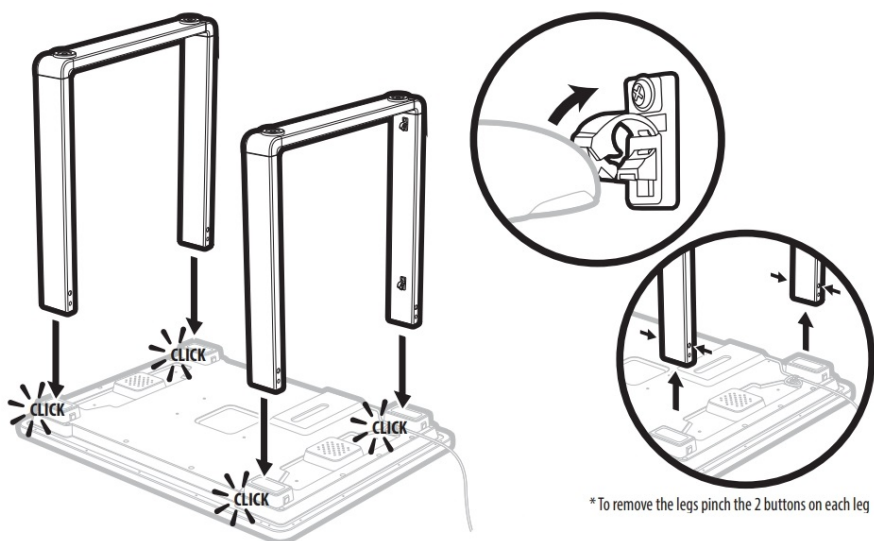

WARNING

- Set upGame Table on a level oor.
- Never allow children to climb or hang on product.
- DON'T sit or stand on the Game Table.

- DON'T use as a step.
- If liquid spilled on the Game Table, wipe it off immediately.

Make sure to locate your Game Table on a flat surface.

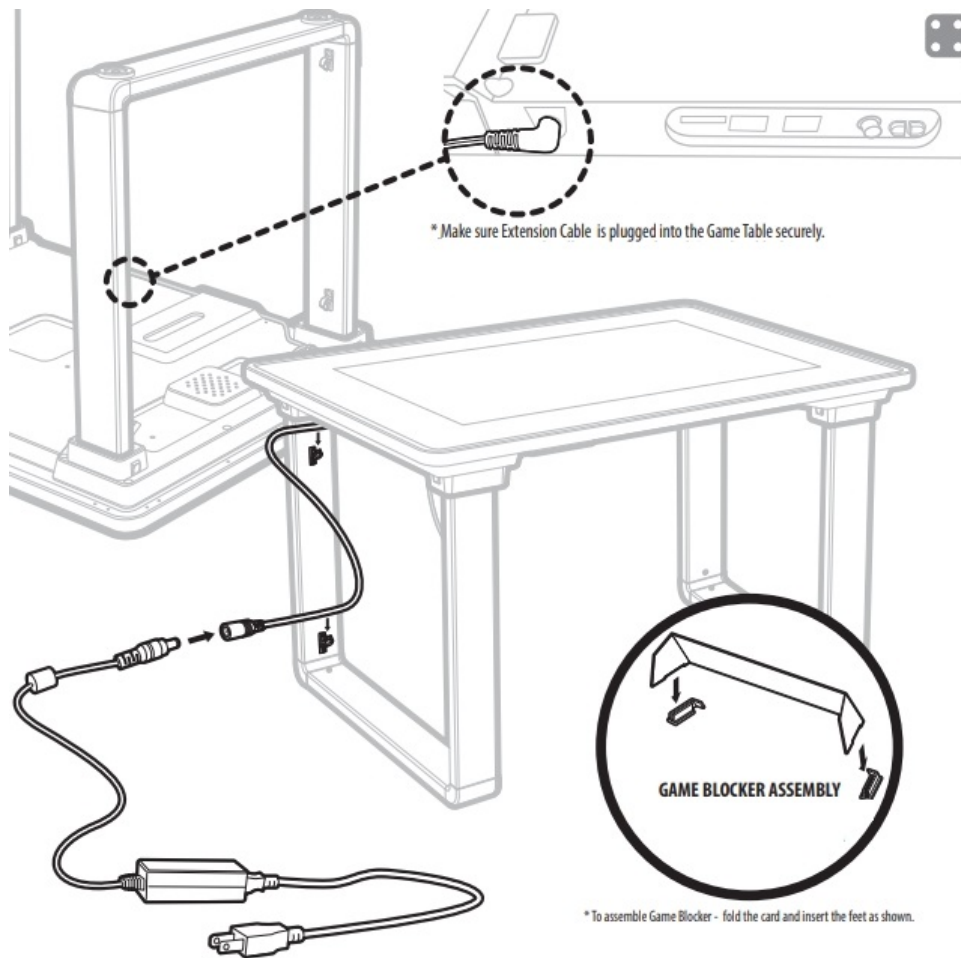

GETTING STARTED

Turn ON your Infinity® Game Table and follow the on-screen instructions.

Please have your Wi-Fi and Password ready!

⚠ WARNING
READ BEFORE USING THE GAME TABLE

SAFETY PRECAUTIONS

The following symbols are used in labels on the game to draw attention to potentially hazardous situations:

⚠ WARNING: Failure to avoid the risk may result in death or serious injury.

⚡ Electrical Shock Hazard. Disconnect power before removing cover. Should only be done by a qualified technician.

⚠ WARNING: To reduce the risk of fire or electric shock, do not expose this apparatus to rain or moisture.

1. Please read and comprehend all warnings stated in this manual.
2. Do not get Game Table wet when cleaning.
3. Parents and guardians: Please read entire manual before allowing gamer to play.
4. The AC/DC adapter and apparatus shall not be exposed to dripping or splashing and that no object filled with liquids, such as vases, shall be placed on apparatus. The AC/DC adapter is used as disconnect device. The AC/DC adapter of apparatus should not be obstructed OR should be easily accessed during intended use. To be completely disconnect the power input, the AC/DC adapter of apparatus shall be disconnected from the mains.
5. If appliance is provided with protective earth terminal, it should be connected to main outlet with a protective earth connection.
6. Minimum distances 10 cm / 3.94 inches around the apparatus for sufficient ventilation.
7. The ventilation should not be impeded by covering the ventilation openings with items such as newspaper, table-cloths, curtains etc.
8. No naked flame sources such as lighted candles should be placed on the apparatus.
9. The apparatus should only be used in moderate climates.



EPILEPSY WARNING

A very small percentage of individuals may experience epileptic seizures or blackouts when exposed to certain light patterns or flashing lights. Exposure to certain patterns or backgrounds on a television screen or when playing video games may trigger epileptic seizures or blackouts in these individuals. To reduce the risk of such a seizure incident, it is recommended to take a 10-15 minute break at each hour of playing.

FCC/ISED STATEMENT

This device complies with part 15 of the FCC rules / Innovation, Science and Economic Development Canada's licence-exempt RSS(s). Operation is subject to the following two conditions: (1) This device may not cause harmful interference, and (2) this device must accept any interference received, including interference that may cause undesired operation.

Warning: Changes or modifications to this unit not expressly approved by the party responsible for compliance could void the user's authority to operate the equipment

NOTE: This equipment has been tested and found to comply with the limits for a Class B digital device, pursuant to Part 15 of the FCC/ISED rules. These limits are designed to provide reasonable protection against harmful interference in a residential installation. This equipment generates, uses, and can radiate radio frequency energy and, if not installed and used in accordance with the instructions, may cause harmful interference to radio communications. However, there is no guarantee that interference will not occur in a particular installation. If this equipment does cause harmful interference to radio or television reception, which can be determined by turning the equipment off and on, the user is encouraged to try to correct the interference by one or more of the following measures:

- Reorient or relocate the receiving antenna.
- Increase the separation between the equipment and receiver.
- Connect the equipment into an outlet on a circuit different from that to which the receiver is connected.
- Consult the dealer or an experienced radio/TV technician for help.

FCC RF RADIATION EXPOSURE STATEMENT:

This equipment complies with FCC radiation exposure limits set forth for an uncontrolled environment. This equipment should be installed and operated with a minimum distance of 20cm between the radiator and any part of your body.

ISED RF RADIATION EXPOSURE STATEMENT:

This equipment complies with IC RSS-102 radiation exposure limits set forth for an uncontrolled environment. This equipment should be installed and operated with a minimum distance of 20cm between the radiator and any part of your body.

IMPORTANT SAFETY INSTRUCTIONS

1. Read these Instructions
2. Keep these Instructions
3. Heed all Warnings
4. Follow all instructions
5. DO NOT sit or stand on the table in any way
6. DO NOT use as a step.
7. DO NOT allow children to climb or hang on product.
8. DO NOT drop any heavy objects on the glass table top.
9. DO NOT hit or bang the glass table top.
10. DO NOT use this apparatus near water.
11. DO NOT put extremely hot or cold cups on glass as glass can break. (use Infinity Game Table coaster supplied.)
12. If liquid is spilled on the table. wipe it out immediately. Unplug the power supply before cleaning. Note: you game will automatically save.
13. Clean only with a dry cloth. This is a glass top use with care.
14. Do not block any ventilation openings. Install in accordance with the manufacturer's instructions.
15. Do not install near any heat sources such as radiators, heat registers, stoves, or other apparatus (including amplifiers) that produce heat.
16. Do not defeat the safety purpose of the polarized or grounding – type plug. A polarized plug has two blades with one wider than the other. A grounding type plug has two blades and a third grounding prong. The wide blade or the third prong are provided for your safety. When the provided plug does not fit into your outlet, consult an electrician for replacement of the obsolete outlet.
17. Protect the power cord from being walked on or pinched particularly at plugs, convenience receptacles, and the point where they exit from the apparatus.
18. Unplug this apparatus during lightning storms or when unused for long periods of time.
19. Refer all servicing to qualified service personnel. Servicing is required when the apparatus has been damaged in any way, such as power-supply cord or plug is damaged, liquid has been spilled or objects have fallen into the apparatus, the apparatus has been exposed to rain or moisture, does not operate normally, or has been dropped.
20. The equipment shall be used at working ambient temperature 32° – 95°F (0° – 35°C).

INSTALLATION

This Game Table is designed for indoor and personal use only. It must not be installed outdoors. The

following conditions must be avoided.

1. Direct exposure to sunlight, high humidity, direct water contact, dust, high heat, or extreme cold.
2. Vibration. The Game Table must be installed on a level surface.
3. Do not install in an area such that the Game Table would present an obstacle in case of an emergency (i.e., near fire equipment or emergency exits)

SPECIFICATIONS



This product is intended for use only with the adapter provided.

- **POWER SUPPLY:** AC/DC Adapter
 - **INPUT POWER:** AC 100-240V~50/60Hz 1.4A Max
 - **OUTPUT POWER:** DC12V $\underline{\hspace{0.5cm}}$ 5A
 - **MONITOR:** 31.5" (80cm) LCD
 - **ASSEMBLED DIMENSIONS:** 21.5 IN x 33.5 IN x 22.2 IN (54.6 CM x 85 CM x 56.3 CM)
1. The AC/DC adapter is used as disconnect device
 2. To be completely disconnect the power input, the AC/DC adapter of apparatus shall be disconnected from the mains
 3. **Adapter energy efficiency information also available in the FAQ at WWW.ARCADE1UP.COM

ASSISTANCE OR SERVICE

Before contacting us for assistance or service, please check the "Troubleshooting" section in the Quick Start Guide.

If you still have questions regarding your Infinity Game Table or require technical support, contact Customer Service at:

WWW.INFINITYGAMETABLE.COM/SUPPORT

TROUBLESHOOTING

PROBLEM	POSSIBLE CAUSE	SOLUTION

<p>The Game Table will not turn on</p>	<ul style="list-style-type: none"> • Power cord is not plugged into wall outlet. • Wires/Plugs are hooked up incorrectly. 	<ul style="list-style-type: none"> • Make sure power cord is plugged into the wall outlet and there is power to that outlet. (Plug other electrical equipment into the power outlet to make sure the outlet normally works.) • Press and hold ON/OFF button (3 seconds) to ON
<p>The Game Table will turn ON, but there is no sound.</p>	<p>Volume is turned down.</p>	<p>Press + Volume Switch. NOTE: + Volume Switch to increase, – Volume Switch to lower.</p>
<p>The game screen is frozen.</p>	<p>The game encountered a problem when processing the data.</p>	<ul style="list-style-type: none"> • Press & hold the ON/OFF button 7 seconds to power OFF the Game Table. Then release, press and hold ON/OFF button (3 seconds) to ON • Unplug the game from the wall outlet and wait 60 seconds to RESET the game. Plug the game table back in and press the ON/OFF button back to ON.

<p>The game screen looks pixelated or there are lines running through the image.</p>	<ul style="list-style-type: none"> • The game encountered a problem when processing the data. 	<ul style="list-style-type: none"> • Press & hold the ON/OFF button 7 seconds to power OFF the Game Table. Then release, press and hold ON/OFF button (3 seconds) to ON. • Unplug the game from the wall outlet and wait 60 seconds to RESET the game. Plug the game table back in and press the ON/OFF button back to ON.
<p>The Game Table will not connect to the internet.</p>	<ul style="list-style-type: none"> • The Game Table may be located too far away from your wireless router. • You may need to re-establish a new connection to your Game Table after factory reset. • You may be entering the wrong password to your WIFI network 	<ul style="list-style-type: none"> • Try moving your Game Table closer to your WIFI internet router. • Factory Reset in the setting menu, then re-establish a new connection by selecting your network name and entering in your WIFI password again. • Make sure you are using the correct password to your WIFI network. (Always check to make sure your WIFI password works on your other devices.)

ANY OTHER ISSUES

Contact Customer Service at:

WWW.INFINITYGAMETABLE.COM/SUPPORT





Documents / Resources



[INFINITY ARCADE1up Game Table](#) [pdf] User Guide
GAME, 2APXHGAME, ARCADE1up Game Table, ARCADE1up, Game Table, Table

References

-  [Arcade1Up | Officially Licensed Arcade Cabinets](#)
-  [Arcade1Up | Officially Licensed Arcade Cabinets](#)
-  [Support Portal – Infinity Game Table](#)

Manuals+.