



IndiaMART DG-10 Synchronization Control Panel Instructions

[Home](#) » [indiamart](#) » IndiaMART DG-10 Synchronization Control Panel Instructions 

Contents

- [1 IndiaMART DG-10 Synchronization Control Panel](#)
- [2 STANDARD COMMANDS](#)
- [3 ADVANCED COMMANDS](#)
- [4 BLUETOOTH COMMANDS](#)
- [5 Documents / Resources](#)
 - [5.1 References](#)
- [6 Related Posts](#)



IndiaMART DG-10 Synchronization Control Panel



CONTROL PANEL DG-10

STANDARD COMMANDS

Driver Volume
Press the first time: the display blinks and shows the pre-set volume, the other press changes the volume.

Telephone call control
Press the green for 2 seconds to start a phone call, press the red for 2 seconds to close it.
To adjust the telephone volume.
Green short press: the right display blinks and shows the pre-set volume. Press Co-driver + and - to adjust the phone volume also during a call. This operation doesn't effect the intercom volumes.

Left display
When any button is pressed the display shows:
'S' for Stage mode,
'R' for Road mode

Right display
When any button is pressed the display shows the setting of cancellation mode (0..3)

Co-Driver Volume
Press the first time: the display blinks and shows the pre-set volume, the other press changes the volume.

Digital active noise cancellation mode
Press the first time: the left display shows 'd', and the right display shows the pre-set noise cancellation mode.
0 = digital cancellation off.
1 = digital cancellation minimum
2 = digital cancellation medium
3 = digital cancellation maximum
The second press changes the noise cancellation mode (0..3).

Stage/Road
A short press changes between Stage and Road mode.

	Stage	Road (2)
Intercom	Active	Active
Videocamera OUT	Active	Active
Radio	NO	Active
Phone	NO	Active

RCA OUT (Red)
Camera connection

RCA IN (White)
Radio connection

ADVANCED COMMANDS

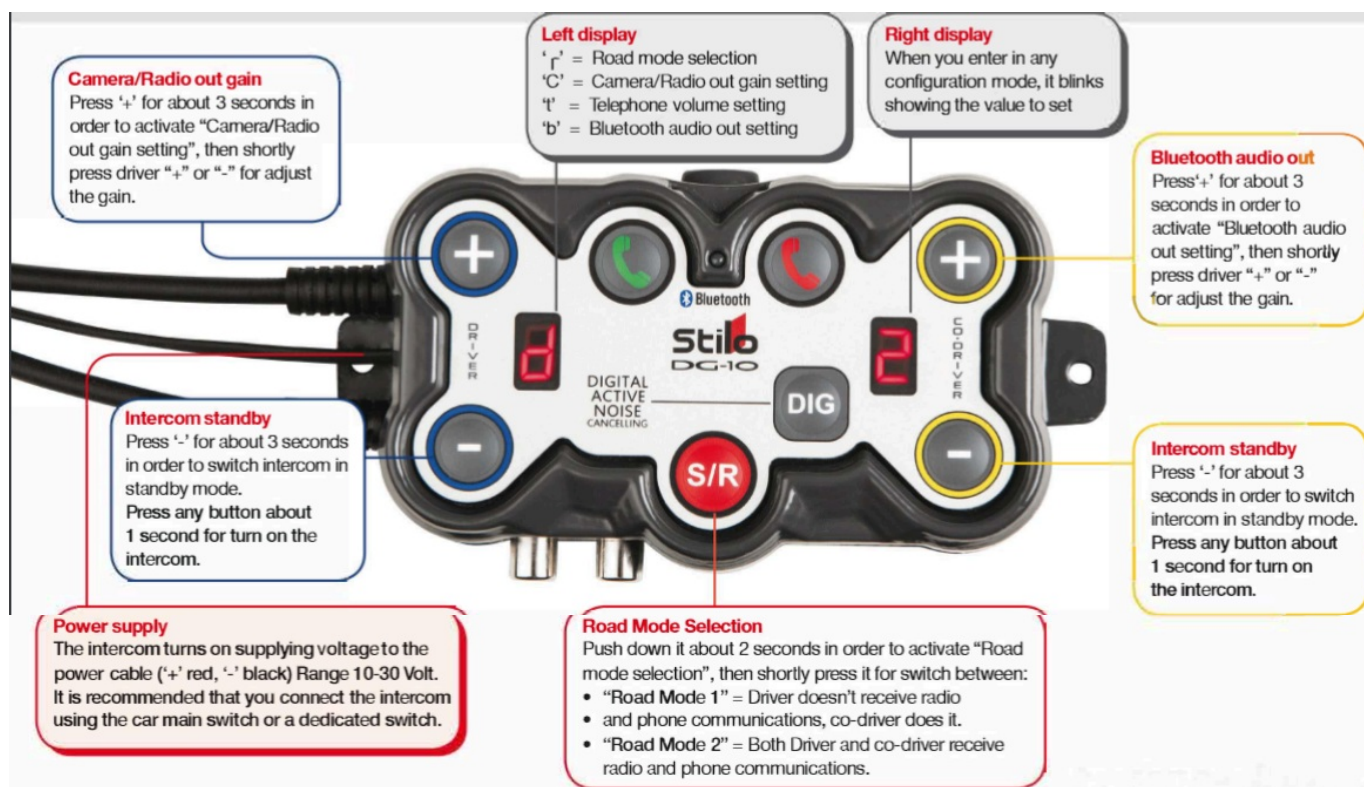

BLUETOOTH COMMANDS

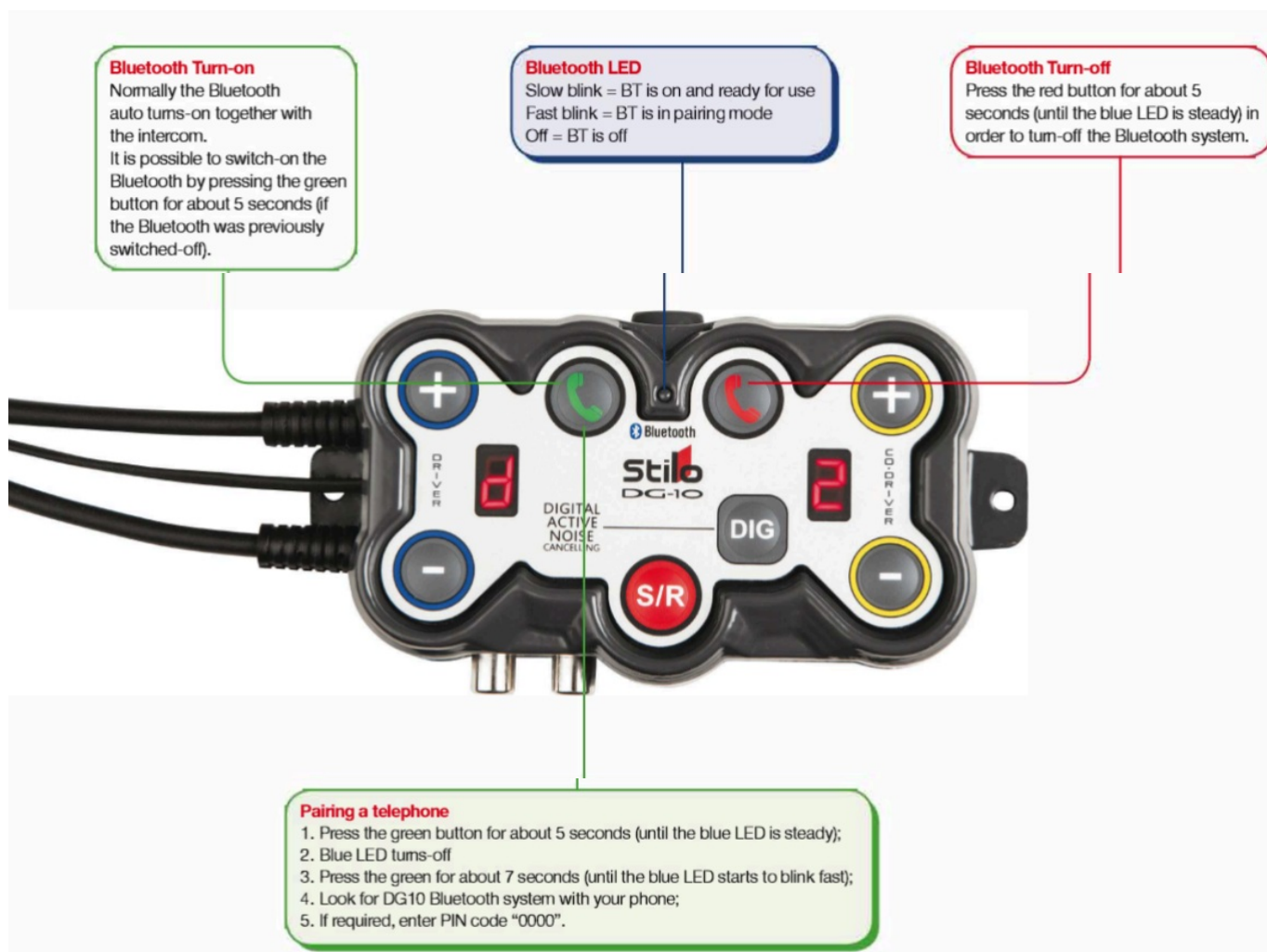

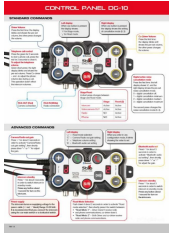

[IndiaMART DG-10 Synchronization Control Panel](#) [pdf] Instructions
DG-10 Synchronization Control Panel, DG-10, Synchronization Control Panel, Control Panel, Panel

References

- [User Manual](#)

[Manuals+](#), [Privacy Policy](#)

This website is an independent publication and is neither affiliated with nor endorsed by any of the trademark owners. The "Bluetooth®" word mark and logos are registered trademarks owned by Bluetooth SIG, Inc. The "Wi-Fi®" word mark and logos are registered trademarks owned by the Wi-Fi Alliance. Any use of these marks on this website does not imply any affiliation with or endorsement.