

IN-SITE Installer Friendly Series Single Phase Simplex



# IN-SITE Installer Friendly Series Single Phase Simplex Owner's Manual

[Home](#) » [IN-SITE](#) » IN-SITE Installer Friendly Series Single Phase Simplex Owner's Manual 

## Contents

- [1 IN-SITE Installer Friendly Series Single Phase Simplex](#)
- [2 Specifications](#)
- [3 FAQ](#)
- [4 INTRODUCTION](#)
- [5 TOUCHPAD FEATURES](#)
- [6 COMPONENTS](#)
- [7 CONTACT](#)
- [8 Documents / Resources](#)
  - [8.1 References](#)
- [9 Related Posts](#)

**IN-SITE®**

## IN-SITE Installer Friendly Series Single Phase Simplex



## Specifications

- **Enclosure base dimensions:** 14 x 12 x 6 inches (35.56 x 30.48 x 15.24 cm)
- **Enclosure rating:** NEMA 4X
- **Control panel types:** Simplex Timed Dose, Simplex Demand Dose
- **Starting device options:** 120/208/240V, 120V only
- **Pump full load amps options:** 0 – 7 FLA, 7 – 15 FLA, 15 – 20 FLA
- **Level control applications:** Timed Dose, Demand Dose, C-Level™ Sensor

## FAQ

- **Q:** What is the purpose of the C-Level™ Sensor?
- **A:** The C-Level™ Sensor is used for high water alarm and redundant off floats in pump-down applications.
- **Q:** How can I set the pump ON/OFF times for timed dose control?
- **A:** Use the UP and SET push buttons on the touchpad to set the pump ON/OFF times for timed dose control.
- **Q:** What should I do if a float operates out of sequence?
- **A:** An alarm will activate if a float operates out of sequence. Check the float and reset it if necessary.

## INTRODUCTION

### Get In-Site® to your On-Site™ Systems!

- The IFS In-Site® simplex control panel utilizes an innovative circuit board design to control one 120/208/240V single-phase pump in water and sewage applications.
- IFS panels feature an easy-to-use touchpad on the inner door for programming and system monitoring. Quick retrieval of all system events can be done by downloading panel information onto a USB flash drive.
- The panel configuration can be easily converted in the field to either a timed dose or a demand dose. Available with the EZconnex® float system.
- Monitor system events including pump run times, pump cycles, alarm conditions, power outages, service calls, and more! Quick, convenient reports make diagnosing system conditions easy! Plug the flash drive into the USB port located on the inner door of the IFS In-Site® panel to download system events that occurred. No computer is needed at the site!
- Use the flash drive (included with the panel) with any computer to download system information and reports.
- The pre-loaded software on the flash drive formulates system data for you, creating reports quickly in an easy-to-read format so system conditions can be easily identified and corrected. In addition to monitoring system events, the IFS In-Site® panel logs any service calls and changes made to system settings, which helps protect service providers.
- The panel can utilize the C-Level™ sensor for continuous level monitoring. It senses the level in the tank and sends a signal to the panel. Pump activation levels can be
- adjusted by using the panel touchpad. C-Level™ CL40 sensor operating range is 3-39.9 inches (7.6-101.3 cm). C-Level™ CL100 operating range is 3-99.5 inches (7.6-252.7 cm).
- Five-year limited warranty on panel

- Two-year limited warranty on C-Level™ Sensor

## TOUCHPAD FEATURES

- A. Level Status indicators illuminate when floats or set points are activated; an alarm will activate if a float operates out of sequence
- B. HOA (Hand-Off-Automatic) buttons with indication control pump mode; Hand mode defaults to Automatic when stop level or redundant off level is reached
- C. Pump Run indicator illuminates when the pump is called to run
- D. LED display for system information including level in inches or centimeters (C-Level™ sensor only), mode, pump elapsed time (hh: mm), events (cycles), alarm counter, float error count, timed dose override counter (timed dose only), pump ON/OFF times
- (timed dose only), and sequence ON/OFF times (timed dose only)
- E. NEXT push button toggles display
- F. UP and SET push buttons used to set pump ON/OFF times (timed dose only), date and hour, activation levels (C-Level™ only)

## COMPONENTS

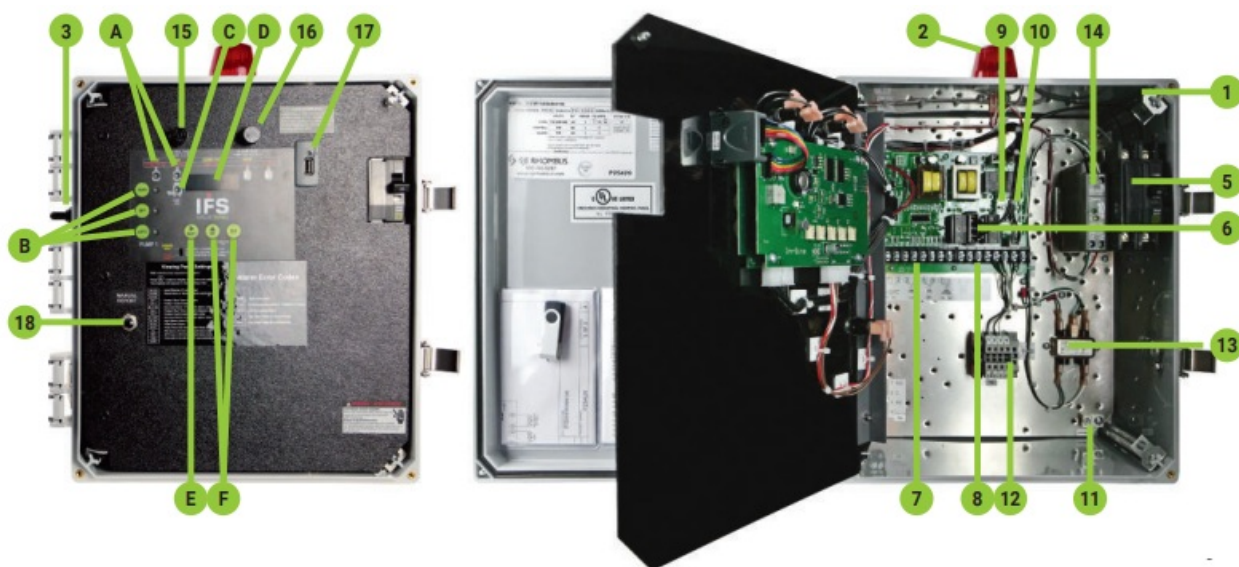

Panel layout may vary with options. Reg. Cdn Pat. & TM Off C-Level™ Sensor US Patent No. 8,336,385; 8,567,242; 8,650,949

1. Enclosure base measures 14 x 12 x 6 inches (35.56 x 30.48 x 15.24 cm); NEMA 4X (ultraviolet stabilized thermoplastic with removable mounting feet for outdoor or indoor use)
2. The Red LED beacon provides a 360° visual check of the alarm condition
3. The exterior Alarm Test/Normal/Silence switch allows the horn and light to be tested and the horn to be silenced in an alarm condition; the alarm automatically resets once the alarm condition is cleared
4. The alarm horn provides audio warning of alarm conditions (83 to 85 decibel rating) (Not shown)
5. Circuit breaker (optional) provides pump disconnect and branch circuit protection

6. Power relay controls pump by switching electrical lines; definite purpose contactor used when pumping full load amps are above 15
7. Float connection terminal block
8. Incoming control/alarm terminal block
9. Control Power indicator/fuse indicator light illuminates if control power is present in the panel; an alarm will activate if the control fuse is blown
10. The alarm Power indicator/fuse indicator light illuminates if alarm power is present in the panel
11. Ground lug
12. Incoming pump power connections
13. RF filter
14. Power supply
15. Control fuse
16. Alarm fuse
17. USB port for flash drive to download time-stamped system events
18. Manual report switch date and time stamps service calls

**Note:** Options, voltage, and amp range selected may change enclosure size and component layout.

**Note:** Schematic/Wiring Diagram and Pump Specification Label are located inside the panel.

**INSTALLER FRIENDLY SERIES® IN-SITE® SINGLE PHASE SIMPLEX** – Demand or timed dose float-controlled system for pump control, system monitoring, event logging and reporting.

IFI		1	W					8AC
CONTROL PANEL	MODEL TYPE	ALARM PACKAGE	ENCLOSURE RATING	STARTING DEVICE	PUMP FULL LOAD AMPS	PUMP DISCONNECTS	LEVEL CONTROL APPLICATION	OPTIONS (LISTED BELOW)

<b>CONTROL PANEL</b>	✓	IF		
<b>MODEL TYPE</b>		1	Simplex Timed Dose (includes Option 8AC as standard)	\$2,742.00
		2	Simplex Demand Dose (includes Option 8AC as standard)	\$2,774.00
<b>ALARM PACKAGE</b>	✓	1	Alarm Package (includes test/normal/silence switch, fuse, red light, & horn)	Base
<b>ENCLOSURE RATING</b>	✓	W	Weatherproof, NEMA 4X (engineered thermoplastic)	Base
<b>STARTING DEVICE</b>		1	120/208/240V	Base
		9	120V only	Base
<b>PUMP FULL LOAD AMPS</b>		0	0 – 7 FLA	Base
		1	7 – 15 FLA	Base
		2	15 – 20 FLA	\$106.00
<b>PUMP DISCONNECTS</b>		0	No Pump Disconnect	Base
		4	Circuit Breaker 120V (select STARTING DEVICE Option 9 above)	\$43.00
			Circuit Breaker 120/208/240V (select STARTING DEVICE Option 1 above)	\$86.00
<b>LEVEL CONTROL APPLICATION</b>		H	Floats – Pump Down (select Option 17 below)  Timed dose = timer enable and alarm / Demand dose = stop, start, and alarm	Base
		E	EZconnex® Float Switch System (select Option 33, 35 or 36 below)	Timed Dose
				– \$68.00
		X	No Floats	Demand Dose
				– \$102.00
		C	C-Level™ Sensor (select Option 24 or 29)* Select Option 3E and/ or 4A & 4D for high water alarm and/or redundant off floats	Timed Dose
				– \$68.00
				Demand Dose
				– \$102.00

<b>PRICING WORKSHEET</b>	<b>BASE PRICE</b>	
	Simplex Timed Dose - \$2,742.00	
	Simplex Demand Dose - \$2,774.00	
	IFI Simplex Base Price	_____
	Alarm Package	_____
	Enclosure Rating	_____
	Starting Device	_____
	Pump Full Load Amps	_____
	Pump Disconnects	_____
	Level Control Application	_____
Total Options	_____	
<b>TOTAL LIST PRICE</b> _____		

**NOTE:** Pump down applications only. Industry practices suggest that a secondary device, such as a float switch, be used for redundant activation of the high-level alarm and pump shut off when using the C-Level™ sensor.

	OPTIONS	DESCRIPTION	LIST PRICE
	1J	Duo Alarm Inputs	\$34.00
	3A	Alarm Flasher	\$66.00
	3B	Manual Alarm Reset	\$119.00
	3E	High Water Alarm Float (must also select Option 17) <b>Only Available with Level Control Application = C</b>	\$34.00
	4A	Redundant Off (must also select Option 4D if floats are required)	Timed Dose \$0.00
			Demand Dose \$72.00
	4D	Redundant Off Float (must also select Option 4A and Option 17)	\$34.00
	6A	Auxiliary Alarm Contact, Form C	\$51.00

✓	8AC	<b>Display Board – Includes: ETM Counter, Events (Cycles) Counter, Al arm Counter, and Override Counter (Timed Dose Only) (included as standard)</b>	<b>\$0.00</b>
	10E	Lockable Latch – NEMA 4X	\$51.00
	10F	Lightning Arrestor (select pump circuit breaker, control, and alarm power combined)	\$285.00
	10K	Anti-condensation Heater ( <b>must select if the operating temperature is colder than 0 degrees F or -18 degrees C</b> )	\$124.00
	11C	Additional NEMA 1 Remote Alarm Panel (must also select Option 6A)	\$114.00
	11D	Additional NEMA 4X Remote Alarm Panel (must also select Option 6A)	\$368.00
	15A	Control/Alarm Circuit Breaker	\$112.00
	16A	10' Cord in Lieu of 20' Cord (per Float)	– \$3.00
	16B	15' Cord in Lieu of 20' Cord (per Float)	– \$2.00
	16C	30' Cord in Lieu of 20' Cord (per Float)	\$6.00
	16D	40' Cord in Lieu of 20' Cord (per Float)	\$18.00

	OPTIONS	DESCRIPTION	LIST PRICE
	17C	Sensor Float® / Internally Weighted (per Float) – Mercury	\$13.00
	17D	Sensor Float® / Externally Weighted (per Float) – Mercury	\$15.00

17G	SJE MilliAmpMaster™ / Pipe Clamp (per Float) – Mechanical	\$0.00
17H	SJE MilliAmpMaster™ / Externally Weighted (per Float) – Mechanical	\$8.00
17J	Sensor Float® / Pipe Clamp (per Float) – Mercury	\$6.00
18A	Timer Override Float (Timed Dose Float Panel Only)	\$34.00
24E	C-Level™ CL40 Sensor with 25' Vented Cable	\$380.00
24F	C-Level™ CL40 Sensor with 50' Vented Cable	\$425.00
24P	C-Level™ CL40 Sensor with 100' Vented Cable	\$515.00
24X	No C-Level™ CL40 Sensor	\$0.00
29A	C-Level™ CL100 Sensor with 25' Vented Cable	\$380.00
29B	C-Level™ CL100 Sensor with 50' Vented Cable	\$425.00
29C	C-Level™ CL100 Sensor with 100' Vented Cable	\$515.00
29X	No C-Level™ CL100 Sensor	\$0.00
33D ■	EZconnex® 3-Port, 25', with 10' Floats (3) / Pipe Clamp	\$313.00
33E ■	EZconnex® 3-Port, 50', with 10' Floats (3) / Pipe Clamp	\$355.00
33G ■	EZconnex® 3-Port, 25', with 20' Floats (3) / Pipe Clamp	\$337.00
33H ■	EZconnex® 3-Port, 50', with 20' Floats (3) / Pipe Clamp	\$379.00
35D ■	EZconnex® 4-Port, 25', with 10' Floats (4) / Pipe Clamp	\$442.00
35E ■	EZconnex® 4-Port, 50', with 10' Floats (4) / Pipe Clamp	\$496.00
35G ■	EZconnex® 4-Port, 25', with 20' Floats (4) / Pipe Clamp	\$473.00
35H ■	EZconnex® 4-Port, 50', with 20' Floats (4) / Pipe Clamp	\$526.00



	36D ■	EZconnex® 3-Port, 25', with 10' Floats (2) / Pipe Clamp, Sealing Plug	\$271.00
	36E ■	EZconnex® 3-Port, 50', with 10' Floats (2) / Pipe Clamp, Sealing Plug	\$313.00
	36G ■	EZconnex® 3-Port, 25', with 20' Floats (2) / Pipe Clamp, Sealing Plug	\$286.00
	36H ■	EZconnex® 3-Port, 50', with 20' Floats (2) / Pipe Clamp, Sealing Plug	\$328.00

\*C-Level™ Sensor lengths up to 300 ft. available. Call for details.

EZconnex® mechanically-activated, narrow-angle float switches with quick-release connections

**California Prop 65 requires the following**

**WARNING**-Cancer and Reproductive Harm – [www.P65Warnings.ca.gov](http://www.P65Warnings.ca.gov)

## CONTACT

- [www.sjrhombus.com](http://www.sjrhombus.com)
- email: [customer.service@sjeinc.com](mailto:customer.service@sjeinc.com)
- Toll Free [888-342-5753](tel:888-342-5753)

## Documents / Resources

	<p><b><a href="#">IN-SITE Installer Friendly Series Single Phase Simplex</a></b> [pdf] Owner's Manual  3A, 15C, D16, Installer Friendly Series Single Phase Simplex, Installer Friendly Series, Installer Friendly Series Simplex, Single Phase Simplex, Simplex</p>
---	--

## References

- [🔌 Home - SJE Rhombus Control Products](#)
- [User Manual](#)

[Manuals+](#), [Privacy Policy](#)

This website is an independent publication and is neither affiliated with nor endorsed by any of the trademark owners. The "Bluetooth®" word mark and logos are registered trademarks owned by Bluetooth SIG, Inc. The "Wi-Fi®" word mark and logos are registered trademarks owned by the Wi-Fi Alliance. Any use of these marks on this website does not imply any affiliation with or endorsement.