

IN-SITE Installer Friendly Series Single Phase Simplex



IN-SITE Installer Friendly Series Single Phase Simplex Instruction Manual

[Home](#) » [IN-SITE](#) » IN-SITE Installer Friendly Series Single Phase Simplex Instruction Manual 

Contents

- [1 IN-SITE Installer Friendly Series Single Phase Simplex](#)
- [2 Specifications](#)
- [3 FAQ](#)
- [4 INTRODUCTION](#)
- [5 TOUCH PAD FEATURES](#)
- [6 COMPONENTS](#)
- [7 CONTACT](#)
- [8 Documents / Resources](#)
 - [8.1 References](#)
- [9 Related Posts](#)

IN-SITE®

IN-SITE Installer Friendly Series Single Phase Simplex



Specifications

- **Panel Control:** Demand Dose or Timed Dose
- **Sensor Control:** Float or C-Level™ Sensor
- **Pump Control:** System monitoring, event logging, and reporting
- **C-Level™ CL40 Sensor Operating Range:** 3-39.9 inches (7.6-101.3 cm)
- **C-Level™ CL100 Sensor Operating Range:** 3-99.5 inches (7.6-252.7 cm)
- **Enclosure Base Size:** 14 x 12 x 6 inches (35.56 x 30.48 x 15.24 cm)
- **Enclosure Rating:** NEMA 4X

FAQ

- **Q:** What is the operating range of the C-Level™ sensors?
- **A:** The C-Level™ CL40 sensor operates in the range of 3-39.9 inches (7.6-101.3 cm), while the CL100 sensor operates in the range of 3-99.5 inches (7.6-252.7 cm).
- **Q:** How can I adjust the pump activation levels?
- **A:** Pump activation levels can be adjusted using the panel touchpad by following the instructions provided in the user manual.
- **Q:** What components are included in the system?
- **A:** The system includes an enclosure base, a touchpad with various features, an LED display for system information, and C-Level™ sensors for level monitoring.

INTRODUCTION

Get In-Site® to your On-Site™ Systems!

The IFS In-Site® simplex control panel utilizes an innovative circuit board design to control one 120/208/240V single-phase pump in water and sewage applications. IFS panels feature an easy-to-use touchpad on the inner door for programming and system monitoring. Quick retrieval of all system events can be done by downloading panel information onto a USB flash drive. The panel configuration can be easily converted in the field to either a timed dose or a demand dose. Available with the EZconnex® float system. Monitor system events including pump run times, pump cycles, alarm conditions, power outages, service calls, and more! Quick, convenient reports make diagnosing system conditions easy! Plug the flash drive into the USB port located on the inner door of the IFS In-Site® panel to download system events that occurred. No computer is needed at the site! Use the flash drive (included with the panel) with any computer to download system information and reports. The pre-loaded software on the flash drive formulates system data for you, creating reports quickly in an easy-to-read format so system conditions can be easily identified and corrected. In addition to monitoring system events, the IFS In-Site® panel logs any service calls and changes made to system settings, which helps protect service providers. The panel can utilize the C-Level™ sensor for continuous level monitoring. It senses the level in the tank and sends a signal to the panel. Pump activation levels can be adjusted by using the panel touchpad. C-Level™ CL40 sensor operating range is 3-39.9 inches (7.6-101.3 cm). C-Level™ CL100 operating range is 3-99.5 inches (7.6-252.7 cm).

- Five-year limited warranty on panel
- Two-year limited warranty on C-Level™ Sensor

TOUCH PAD FEATURES

- **A.** Level Status indicators illuminate when floats or set points are activated; the alarm will activate if a float operates out of sequence
- **B.** HOA (Hand-Off-Automatic) buttons with indication control pump mode; Hand mode defaults to Automatic

when stop level or redundant off level is reached

- **C.** Pump Run indicator illuminates when the pump is called to run
- **D.** LED display for system information including level in inches or centimeters (C-Level™ sensor only), mode, pump elapsed time (hh: mm), events (cycles), alarm counter, float error count, timed dose override counter (timed dose only), pump ON/OFF times (timed dose only), and sequence ON/OFF times (timed dose only)
- **E.** NEXT push button toggles display
- **F.** UP and SET push buttons used to set pump ON/OFF times (timed dose only), date and hour, activation levels (C-Level™ only)

COMPONENTS

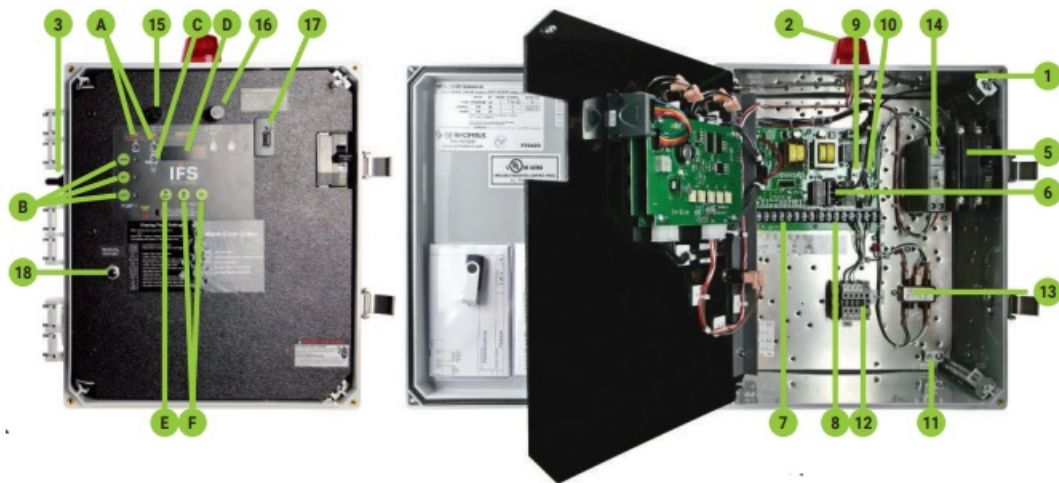

Panel layout may vary with options. Reg. Cdn Pat. & TM Off C-Level™ Sensor US Patent No. 8,336,385; 8,567,242; 8,650,949

1. Enclosure base measures 14 x 12 x 6 inches (35.56 x 30.48 x 15.24 cm); NEMA 4X (ultraviolet stabilized thermoplastic with removable mounting feet for outdoor or indoor use)
2. Red LED beacon provides 360° visual check of the alarm condition
3. The exterior Alarm Test/Normal/Silence switch allows the horn and light to be tested and the horn to be silenced in an alarm condition; the alarm automatically resets once the alarm condition is cleared
4. The alarm horn provides audio warning of alarm conditions (83 to 85 decibel rating) (Not shown)
5. Circuit breaker (optional) provides pump disconnect and branch circuit protection
6. Power relay controls pump by switching electrical lines; definite purpose contactor used when pumping full load amps are above 15
7. Float connection terminal block
8. Incoming control/alarm terminal block
9. Control Power indicator/fuse indicator light illuminates if control power is present in the panel; the alarm will activate if control fuse is blown
10. The alarm Power indicator/fuse indicator light illuminates if alarm power is present in a panel
11. Ground lug
12. Incoming pump power connections
13. RF filter
14. Power supply

- 15. Control fuse
- 16. Alarm fuse
- 17. USB port for flash drive to download time-stamped system events
- 18. Manual report switch date and time stamps service calls

Note: Options, voltage, and amp range selected may change enclosure size and component layout.
Note: Schematic/Wiring Diagram and Pump Specification Label are located inside the panel.

INSTALLER FRIENDLY SERIES® IN-SITE® SINGLE PHASE SIMPLEX – Demand or timed dose float controlled system for pump control, system monitoring, event logging and reporting.

PRICING WORKSHEET

IFI Simplex Base Price

Alarm Package

Enclosure Rating

Starting Device

Pump Full Load Amps

Pump Disconnects

Level Control Application

Total Options

TOTAL LIST PRICE

IFI		1	W					8AC
CONTROL PANEL	MODEL TYPE	ALARM PACKAGE	ENCLOSURE RATING	STARTING DEVICE	PUMP FULL LOAD AMPS	PUMP DISCONNECTS	LEVEL CONTROL APPLICATION	OPTIONS (LISTED BELOW)

CONTROL PANEL	✓	IFI		
MODEL TYPE		1	Simplex Timed Dose (includes Option 8AC as standard)	
		2	Simplex Demand Dose (includes Option 8AC as standard)	
ALARM PACKAGE	✓	1	Alarm Package (includes test/normal/silence switch, fuse, red light, & horn)	
ENCLOSURE RATING	✓	W	Weatherproof, NEMA 4X (engineered thermoplastic)	
STARTING DEVICE		1	120/208/240V	
		9	120V only	
PUMP FULL LOAD AMPS		0	0 – 7 FLA	
		1	7 – 15 FLA	
		2	15 – 20 FLA	
PUMP DISCONNECTS		0	No Pump Disconnect	
		4	Circuit Breaker 120V (select STARTING DEVICE Option 9 above)	
			Circuit Breaker 120/208/240V (select STARTING DEVICE Option 1 above)	
LEVEL CONTROL APPLICATION		H	Floats – Pump Down (select Option 17 below) Timed dose = timer enable and alarm / Demand dose = stop, start, and alarm	
		E	EZconnex® Float Switch System (select Options 33, 35 or 36 below)	Timed Dose
				Demand Dose
		X	No Floats	Timed Dose
				Demand Dose
		C	C-Level™ Sensor (select Option 24 or 29)* Select Option 3E and/or 4A & 4D for high water alarm and/or redundant off floats	Timed Dose
				Demand Dose

PRICING WORKSHEET	IFI Simplex Base Price	_____
	Alarm Package	_____
	Enclosure Rating	_____
	Starting Device	_____
	Pump Full Load Amps	_____
	Pump Disconnects	_____
	Level Control Application	_____
	Total Options	_____
TOTAL LIST PRICE		_____

NOTE: Pump down applications only. Industry practices suggest that a secondary device, such as a float switch, be used for redundant activation of the high level alarm and pump shut off when using the C-Level™ sensor.

	OPTIONS	DESCRIPTION	
	1J	Duo Alarm Inputs	
	3A	Alarm Flasher	
	3B	Manual Alarm Reset	
	3E	High Water Alarm Float (must also select Option 17) Only Available with Level Control Application = C	
	4A	Redundant Off (must also select Option 4D if floats are required)	Timed Dose
			Demand Dose
	4D	Redundant Off Float (must also select Option 4A and Option 17)	

	6A	Auxiliary Alarm Contact, Form C
✓	8AC	Display Board – Includes: ETM Counter, Events (Cycles) Counter, Alarm Counter, and Override Counter (Timed Dose Only) (included as standard)
	10E	Lockable Latch – NEMA 4X
	10F	Lightning Arrestor (select pump circuit breaker, control and alarm power combined)
	10K	Anti-condensation Heater (must select if operating temperature is colder than 0 degrees F or -18 degrees C)
	11C	Additional NEMA 1 Remote Alarm Panel (must also select Option 6A)
	11D	Additional NEMA 4X Remote Alarm Panel (must also select Option 6A)
	15A	Control/Alarm Circuit Breaker
	16A	10' Cord in Lieu of 20' Cord (per Float)
	16B	15' Cord in Lieu of 20' Cord (per Float)
	16C	30' Cord in Lieu of 20' Cord (per Float)
	16D	40' Cord in Lieu of 20' Cord (per Float)

	OPTIONS	DESCRIPTION
	17C	Sensor Float® / Internally Weighted (per Float) – Mercury
	17D	Sensor Float® / Externally Weighted (per Float) – Mercury

	17G	SJE MilliAmpMaster™ / Pipe Clamp (per Float) – Mechanical
	17H	SJE MilliAmpMaster™ / Externally Weighted (per Float) – Mechanical
	17J	Sensor Float® / Pipe Clamp (per Float) – Mercury
	18A	Timer Override Float (Timed Dose Float Panel Only)
	24E	C-Level™ CL40 Sensor with 25' Vented Cable
	24F	C-Level™ CL40 Sensor with 50' Vented Cable
	24P	C-Level™ CL40 Sensor with 100' Vented Cable
	24X	No C-Level™ CL40 Sensor
	29A	C-Level™ CL100 Sensor with 25' Vented Cable
	29B	C-Level™ CL100 Sensor with 50' Vented Cable
	29C	C-Level™ CL100 Sensor with 100' Vented Cable
	29X	No C-Level™ CL100 Sensor
	33D ■	EZconnex® 3-Port, 25', with 10' Floats (3) / Pipe Clamp
	33E ■	EZconnex® 3-Port, 50', with 10' Floats (3) / Pipe Clamp
	33G ■	EZconnex® 3-Port, 25', with 20' Floats (3) / Pipe Clamp

	33H ■	EZconnex® 3-Port, 50', with 20' Floats (3) / Pipe Clamp
	35D ■	EZconnex® 4-Port, 25', with 10' Floats (4) / Pipe Clamp
	35E ■	EZconnex® 4-Port, 50', with 10' Floats (4) / Pipe Clamp
	35G ■	EZconnex® 4-Port, 25', with 20' Floats (4) / Pipe Clamp
	35H ■	EZconnex® 4-Port, 50', with 20' Floats (4) / Pipe Clamp
	36D ■	EZconnex® 3-Port, 25', with 10' Floats (2) / Pipe Clamp, Sealing Plug
	36E ■	EZconnex® 3-Port, 50', with 10' Floats (2) / Pipe Clamp, Sealing Plug
	36G ■	EZconnex® 3-Port, 25', with 20' Floats (2) / Pipe Clamp, Sealing Plug
	36H ■	EZconnex® 3-Port, 50', with 20' Floats (2) / Pipe Clamp, Sealing Plug

*C-Level™ Sensor lengths up to 300 ft. available. Call for details.

EZconnex® mechanically-activated, narrow-angle float switches with quick-release connections

California Prop 65 requires the following

WARNING-Cancer and Reproductive Harm – www.P65Warnings.ca.gov

CONTACT

- www.sjerhombus.com
- email: customer.service@sjeinc.com
- Toll Free [888-342-5753](tel:888-342-5753)

Documents / Resources



[IN-SITE Installer Friendly Series Single Phase Simplex](#) [pdf] Instruction Manual
CL40, CL100, Installer Friendly Series Single Phase Simplex, Installer Friendly Series, Installer
Friendly Series Simplex, Single Phase Simplex, Simplex

References

- [🔗 Home - SJE Rhombus Control Products](#)
- [User Manual](#)

[Manuals+](#), [Privacy Policy](#)

This website is an independent publication and is neither affiliated with nor endorsed by any of the trademark owners. The "Bluetooth®" word mark and logos are registered trademarks owned by Bluetooth SIG, Inc. The "Wi-Fi®" word mark and logos are registered trademarks owned by the Wi-Fi Alliance. Any use of these marks on this website does not imply any affiliation with or endorsement.