

In Common With Luca Rectangular Wall Sconce Instruction Manual

[Home](#) » [In Common With](#) » In Common With Luca Rectangular Wall Sconce Instruction Manual 

Contents

- [1 In Common With Luca Rectangular Wall Sconce](#)
- [2 Product Information](#)
- [3 Product Usage Instructions](#)
- [4 How to Install Your New Light](#)
- [5 Contents](#)
- [6 INSTALLATION](#)
- [7 Documents / Resources](#)
 - [7.1 References](#)

In Common With

In Common With Luca Rectangular Wall Sconce

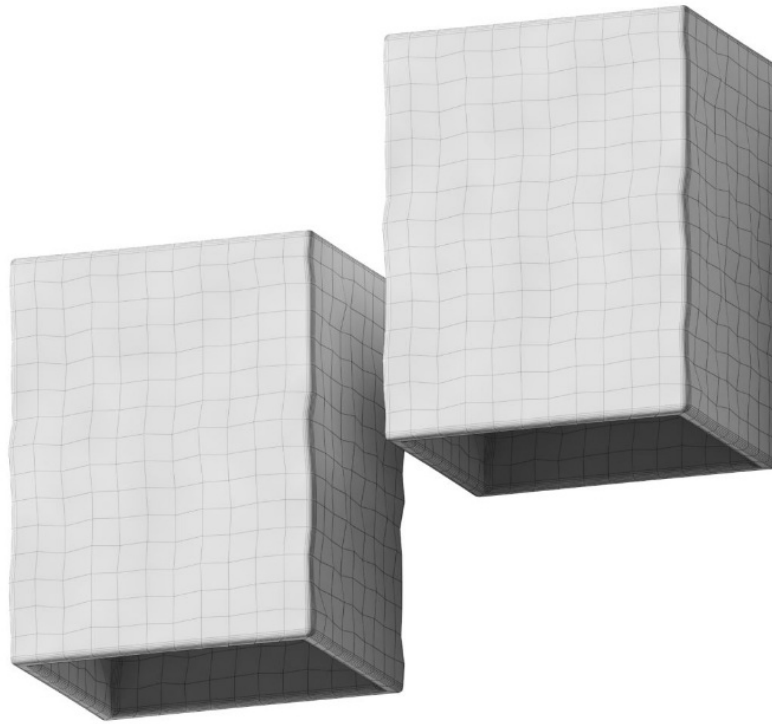

Product Information

- The Luca Wall Mount is a light fixture designed for wall or ceiling installation. It comes with all the necessary components for installation, including a backplate, wago clips, hex key, bulbs, mounting screws, and canopy set screws.
- Please note that the following tools are not included and will be required for installation: standard wire stripper and Phillips head screwdriver.
- Before starting the installation process, it is essential to turn off the electrical power source to avoid any electrical shock risk. We recommend consulting a qualified electrician for assistance.

Product Usage Instructions

1. Step 1: Turn off electrical power at the main fuse box or circuit panel before beginning installation.
2. Step 2: Mount the backplate (A) to the junction box using a Phillips head screwdriver to tighten the mounting screws (E).
3. Step 3: Use the wago clips (B) to connect the fixture's wires to the corresponding wires from the junction box in the wall or ceiling. The white wire is neutral, the black wire is live, and the green/yellow wire is ground. One ground wire should be attached to the backplate (A), and the other should come from the junction box. If needed, use a wire stripper to remove 3/8 of the insulation from each wire before inserting them into the corresponding wago clip.
4. Step 4: Align the holes of the backplate with the holes of the canopy cover attached to the fixture (G) and secure the set screws (F) by tightening them using the included L-shaped hex key (C).
5. Step 5: Gently screw in the included lightbulb (D) into the sockets of the fixture (G).

How to Install Your New Light

Please check that you received all of the components pictured in this guide. Reach out to us if anything is missing. It's very rare, but it happens. Don't forget to turn off the electrical power source.

Tools you will need that aren't included: standard wire stripper, Phillips head screwdriver.

CAUTION

Electrical shock risk. Turn off electrical power at the main fuse box or circuit panel before beginning installation, servicing the light, or installing accessories. We recommend working with a qualified electrician familiar with the type of work you'd like done.

Contents

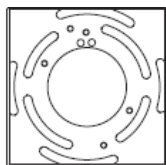

Part A
Backplate



Part B
Wago Clips (x3)



Part C
Hex Key



Part D
Bulb (x2)



Part E
Mounting Screws (x2)



Part F
Canopy Set Screws (x2)

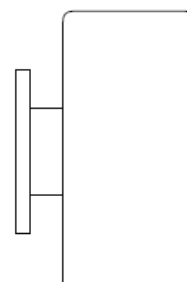

Part G
Luca Fixture

INSTALLATION

1. **Step 1:** Turn off electrical power at the main fuse box or circuit panel before beginning installation.

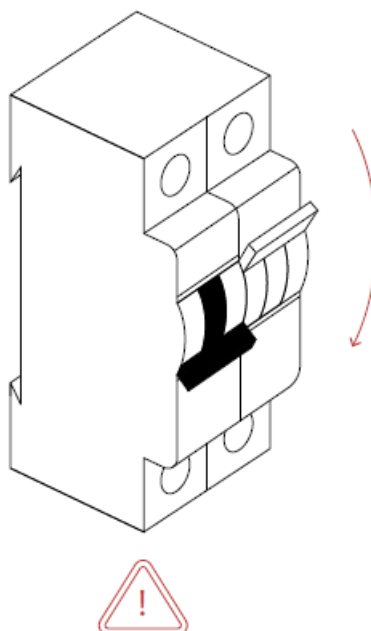

2. **Step 2:** Mount the backplate (A) to the junction box using a Phillips head screwdriver to tighten the mounting screws (E).

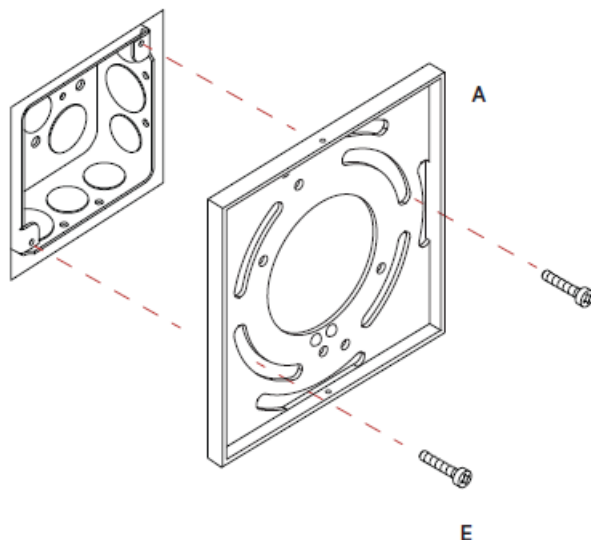

3. **Step 3:** Use the wago clips (B) to connect the fixture's wires to the corresponding wires from the junction box in the wall or ceiling. White is neutral; Black is live; Green/ Yellow is ground. One ground wire will be attached to the backplate (A), the other ground wire should come from the junction box. If needed use a wire stripper to remove 3/8" of the insulation from each wire before inserting them into the corresponding wago clip.

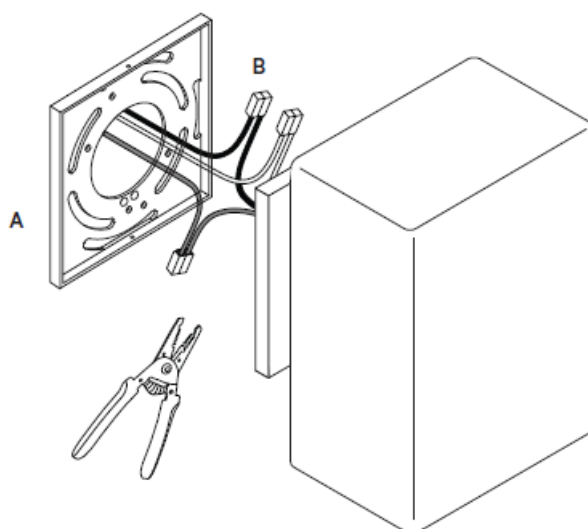

4. **Step 4:** Align the holes of the backplate with the holes of the canopy cover attached to the fixture (G) and secure the set screws (F) by tightening using the included L-shaped hex key (C).

-  [In Common With](#)

Manuals+.