



Imou IPC-F42FX Consumer Camera User Manual

[Home](#) » [imou](#) » Imou IPC-F42FX Consumer Camera User Manual 



IPC-F42FX Consumer Camera User Manual



Contents

- [1 Packing List](#)
- [2 Camera Introduction](#)
- [3 Operating with Imou Life App](#)
- [4 Installing Camera](#)
- [5 FAQ](#)
- [6 Documents / Resources](#)
- [7 Related Posts](#)

Packing List



Camera ×1



Positioning Map ×1



Power Adapter ×1

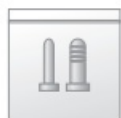

Screw Package ×1



QSG ×1



Waterproof Connector ×1

Camera Introduction

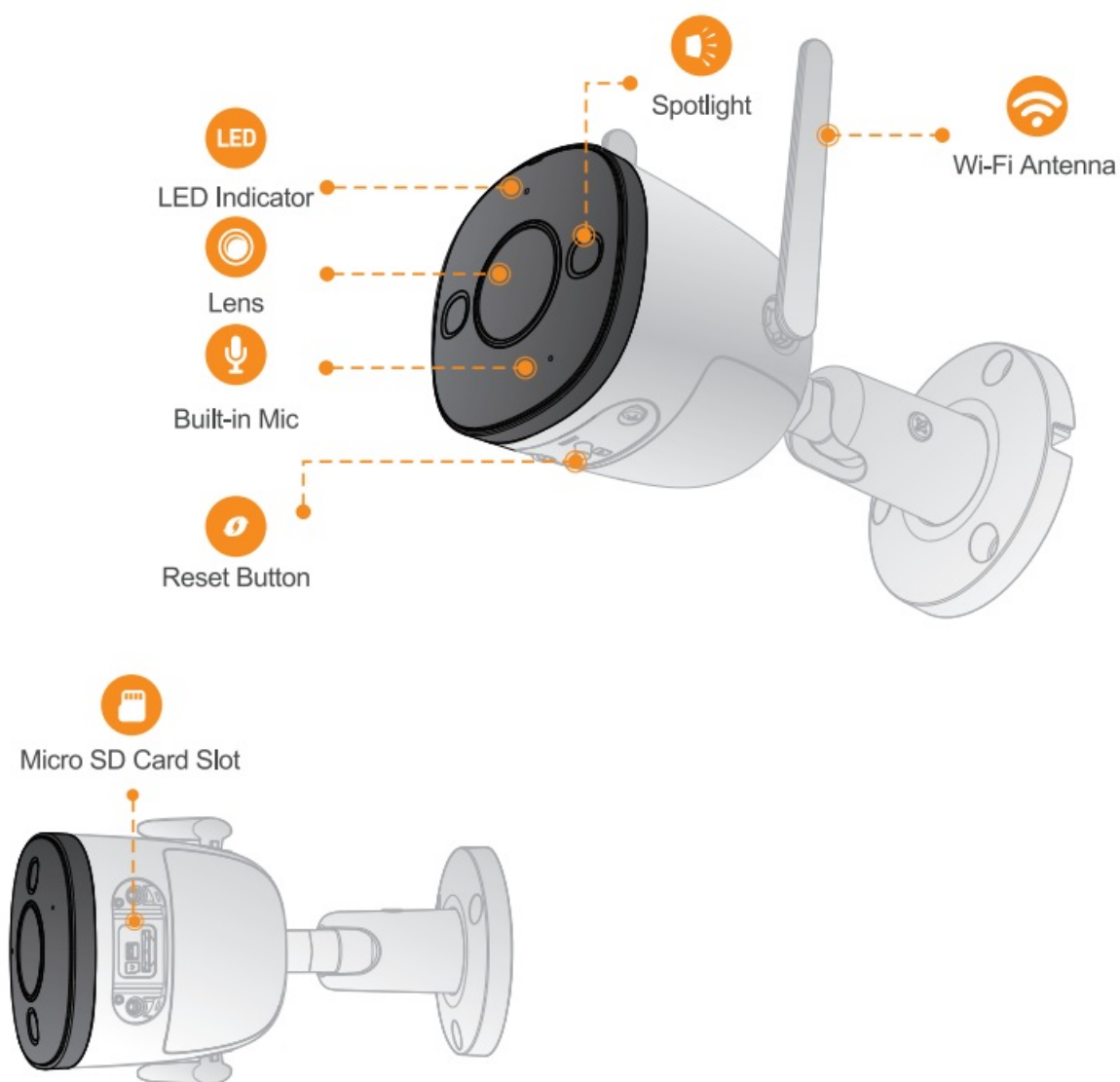

The pattern of the LED indicator is included in the following table.

LED Indicator Status	Device Status
Off	<ul style="list-style-type: none"> • Powered off/LED turned off • Rebooting after reset
Red light on	<ul style="list-style-type: none"> • Booting • Device malfunction
Green light flashing	Waiting for network
Green light on	Operating properly
Red light flashing	Network connection failed
Green and red lights flashing alternately	Firmware updating

Operating with Imou Life App

Step 1

Scan the following QR code or search “Imou Life” in Google Play or App Store to download and install the app.

Note: If you have installed the app, update it to the latest version.



<http://mobile.easy4ipcloud.com/imou/detect.html>

Step 2

Run Imou Life App, and then register an account for the first use.

Step 3

Connect the camera to the power source with the power adapter.

Step 4

Wait for booting to be finished, and then the camera indicator flashes with green light.

Step 5

Do the following operations to finish adding the camera.



Note:

- If you have more than one camera, do step 5 to add them one by one.
- If the Wi-Fi network has changed or the indicator status goes wrong, reset the camera, and then do step 5 to add it again.

Installing Camera

Note: Make sure that the mounting surface is strong enough to hold at least three times the device's weight.

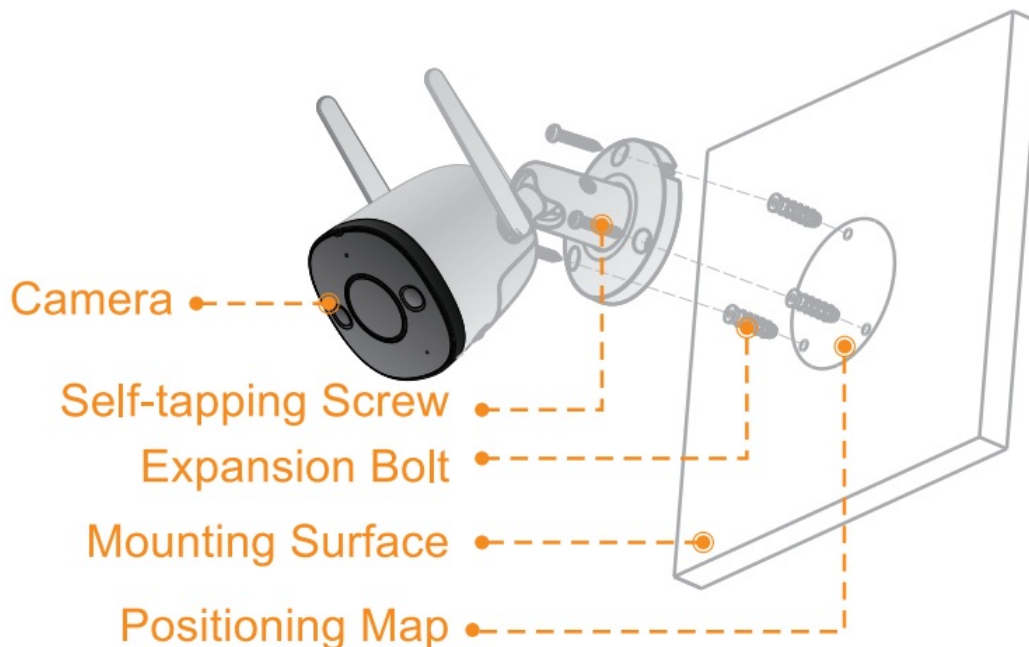

Step1 Drill screw holes on the mounting surface as the positioning map shows, and then put in the expansion bolts.

Step2 Attach the pedestal to the mounting surface with the self-tapping screws.

Step3 Power up the camera, and then adjust the lens to the ideal angle.

FAQ

► Q: The device cannot work normally or start?

Check the LED indicator status. If the light is not in green, press and hold the reset button for 10 s to reset the camera.

► Q: How to connect the camera to a new Wi-Fi?

- If the camera is online, select Device > Network Config to change the Wi-Fi connection.
- If the camera is offline, reset the camera and then configure the camera again.

► Q: Connection is over time?

- Check the Wi-Fi configuration: Select the communication channel to auto and the mode to 11 bgn Mixed.
- Please put the camera and router, camera, and smartphone within 5 m (16.4 ft) during the connecting period.

► Q: The device is offline?

Check the indicator status:

- If the green light is on, check whether the router can connect to the Internet. If the Internet is working, restart the camera.
- If the red light flashes, reset the camera and then configure the camera again.
- If the red light is on, it means the camera is faulty.

► Q: When the Micro SD card is full, how is the recorded video saved?

When the Micro SD card is full, the system will overwrite the previously recorded videos. Save the important information in time.

For more questions, please visit www.imoulife.com/web/support/help, or scan the QR code below.



www.imoulife.com/web/support/help

About the Guide

This quick start guide is for reference only. The minor differences might be found in the user interface.
All the design and software here are subject to change without prior written notice.
All trademarks and registered trademarks mentioned are the properties of their respective owners.
Please visit our website or contact your local service engineer for more information.
If there is any uncertainty or controversy, please refer to our final explanation.

Documents / Resources

	<p>Imou IPC-F42FX Consumer Camera [pdf] User Manual IPC-F4XF-D, IPCF4XFD, 2AVYF-IPC-F4XF-D, 2AVYFIPCF4XFD, IPC-F42FX, IPCF42FX, 2AVYF-IPC-F42FX, 2AVYFIPCF42FX, IPC-F42FX Consumer Camera, Consumer Camera, Camera</p>
---	---