



IMOU CR2032 Smart Temperature and Humidity Sensor User Guide

[Home](#) » [imou](#) » IMOU CR2032 Smart Temperature and Humidity Sensor User Guide 

Contents

- [1 IMOU CR2032 Smart Temperature and Humidity Sensor User Guide](#)
 - [1.1 Package Contents](#)
 - [1.2 Specifications](#)
 - [1.3 Overview](#)
 - [1.4 Device Setup](#)
 - [1.5 Pairing Setup](#)
 - [1.6 Installation](#)
 - [1.7 Regulatory Information](#)
- [2 Documents / Resources](#)
 - [2.1 References](#)
- [3 Related Posts](#)

IMOU CR2032 Smart Temperature and Humidity Sensor User Guide



Temperature & Humidity Sensor Quick Start Guide

V1.0.0

Package Contents

- Sensor x 1
- 3 M Sticker x 1

- Mounting Bracket x 1
- Battery x 2
- Quick Start Guide x 1
- Warranty Card x 1

Specifications

- Wireless technology: Zigbee
- Working voltage: 3 VDC (with CR2032 battery)
- Temperature sensing range: +14°F to +131°F
- Temperature sensing range: -10°C to +55°C
- Humidity sensing range: 0% RH to 99% RH
- Low voltage notification: Support

Overview

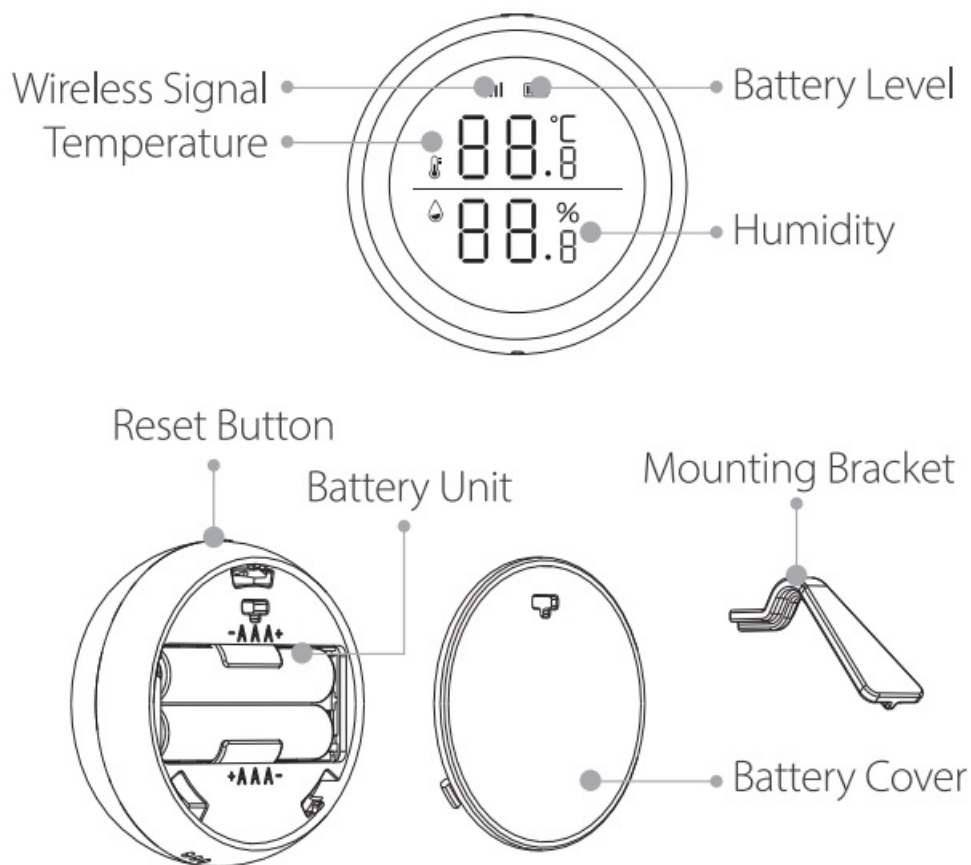

Device Setup

1. Scan the QR code below or search for "Imou Life" in the app store to download and install the app.

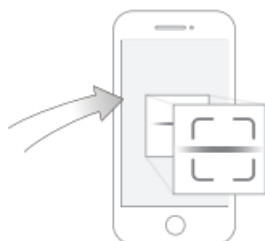

i If you already use the app, make sure that you are using the latest version.

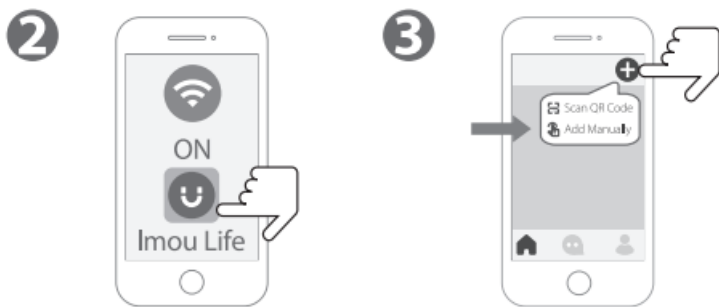

Pairing Setup

1. Place the device close to the gateway. Make sure the gateway is powered on. Press the button on the front of the gateway and wait until the indicator slowly flashes blue.
2. Twist the battery cover anticlockwise to remove it and fix two AAA batteries into the unit to power on the device.

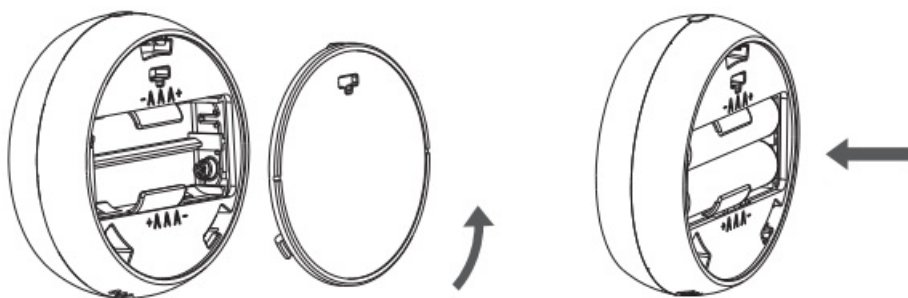

3. Hold down the button for 5 s until the wireless signal flashes.

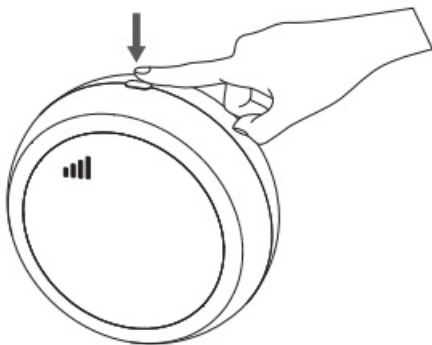

Use the Imou Life app to scan the QR code on the manual and follow the instructions on the app.

Installation

Method 1 Mount the device on the spot

Remove the protective film from the 3M adhesive sticker, and attach the device to where you want to install.

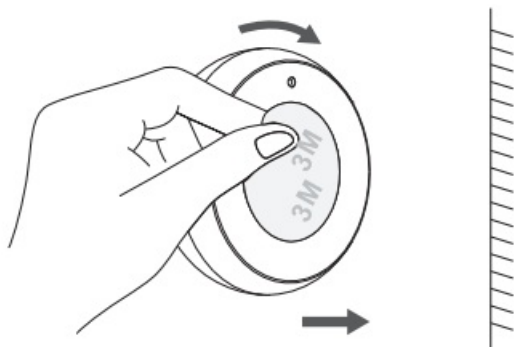

Method 2 Place it with a mounting bracket.

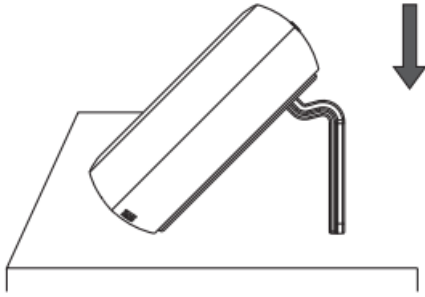

Regulatory Information

European Directives Compliance



This product complies with the applicable CE marking directives and standards:

- Low Voltage (LVD) Directive 2014/35/EU.
- Electromagnetic Compatibility (EMC) Directive 2014/30/EU.
- Restrictions of Hazardous Substances (RoHS) Directive 2011/65/EU and its amending Directive (EU) 2015/863.

A copy of the original declaration of conformity may be obtained from Imou.

The most up to date copy of the signed EU Declaration of Conformity (DoC) can be downloaded from:

<https://en.imou-life.com/support/downloadCenter/eudoc>.

CE-Electromagnetic Compatibility (EMC)

This digital equipment is compliant with Class B according to EN 55032.

CE-Safety

This product complies with IEC/EN/UL 62368-1, Audio/video information and communication technology equipment – Part 1: Safety requirements and IEC/UL 60950-1: Safety of Information Technology Equipment.

RF Exposure Warning

(Only for the product has F communication function)

This equipment must be installed and operated in accordance with provided instructions and the antenna(s) used for this transmitter must be installed to provide a separation distance of at least 20 cm from all persons and must not be co-located or operating in conjunction with any other antenna or transmitter. End-users and installers must be provided with antenna installation instructions and transmitter operating conditions for satisfying RF exposure compliance.

This equipment should be installed and operated with a minimum distance 20cm between the radiator and your body.

Imou



service.global@imoulife.com



<https://www.imoulife.com/support/faq>



<https://www.imoulife.com>



@imouglobal

Documents / Resources

	<p>IMOU CR2032 Smart Temperature and Humidity Sensor [pdf] User Guide CR2032 Smart Temperature and Humidity Sensor, CR2032, Smart Temperature and Humidity Sensor, Temperature and Humidity Sensor, Humidity Sensor, Sensor</p>
---	---

References

- [User Manual](#)

[Manuals+](#), [Privacy Policy](#)