



Imou Bullet 3 Security Camera User Guide

[Home](#) » [imou](#) » Imou Bullet 3 Security Camera User Guide 

Contents

- [1 Imou Bullet 3 Security Camera](#)
- [2 IN THE BOX](#)
- [3 Power On the Camera](#)
- [4 Get the Imou Life App](#)
- [5 Set Up the Camera](#)
- [6 Install the Camera](#)
- [7 Documents / Resources](#)
 - [7.1 References](#)

imou

Imou Bullet 3 Security Camera



IN THE BOX

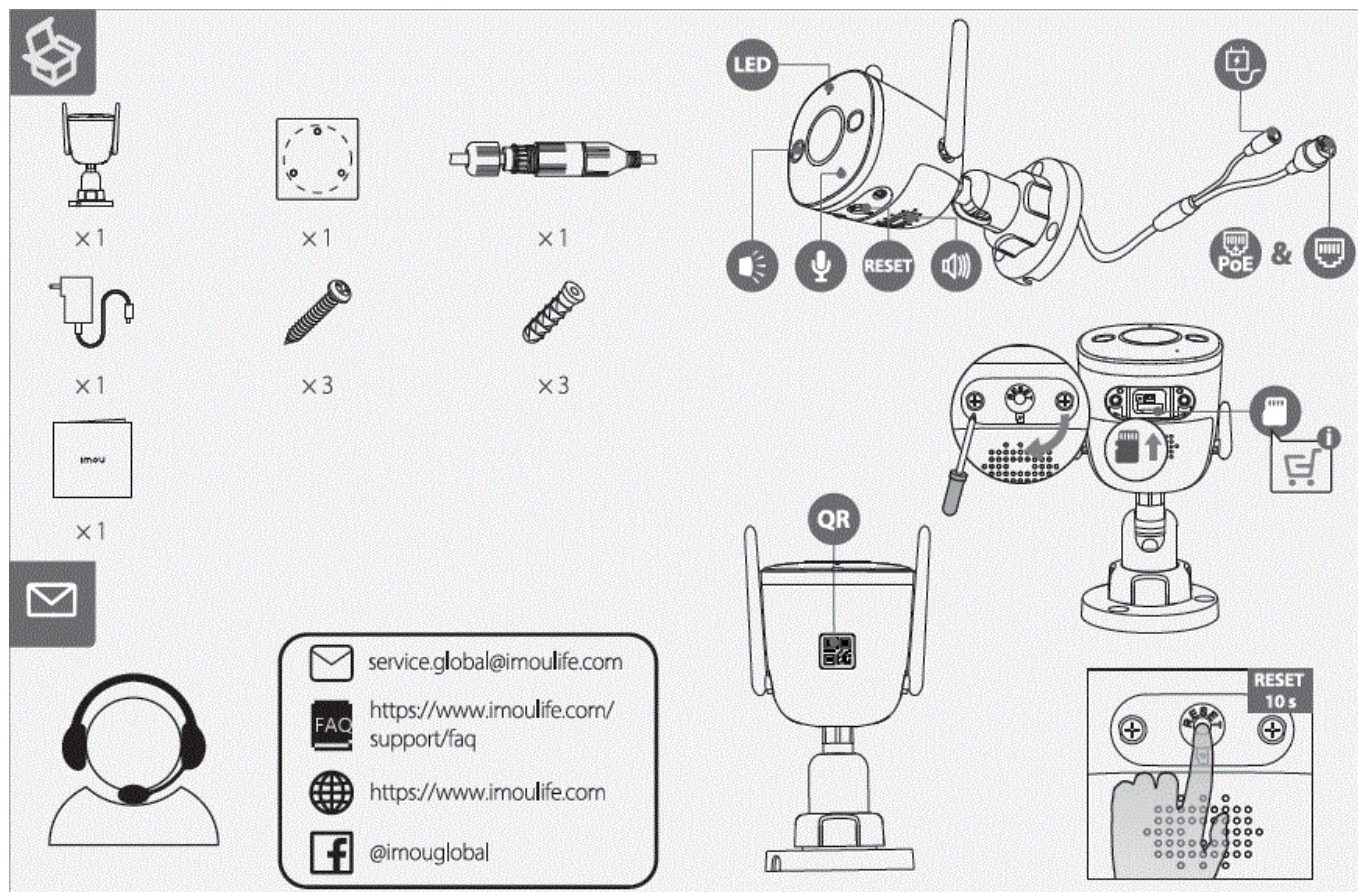

service.global@imoulife.com
<https://www.imoulife.com/support/faq>
<https://www.imoulife.com>
 @imouglobal

Power On the Camera

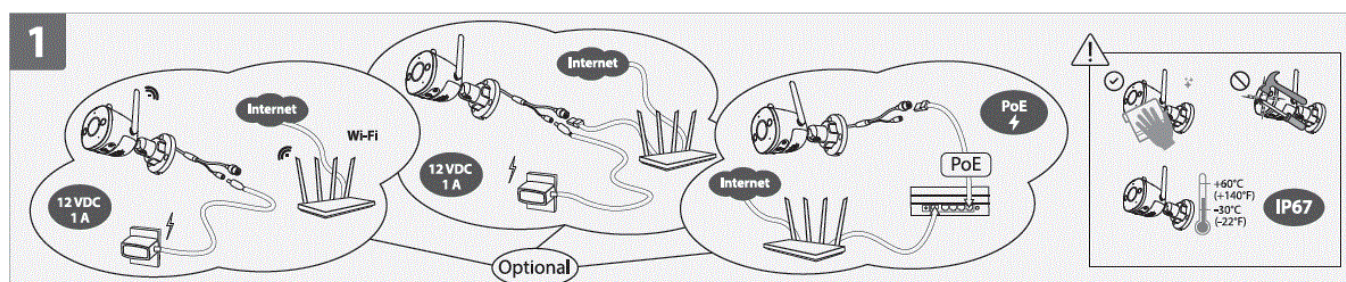

- Connect the camera to power. You can choose a wireless or wired network connection. Since the camera is PoE-featured, you can also connect it to a POE device such as a POE switch with an Ethernet cable to transmit both power and data (see part 1).

Get the Imou Life App

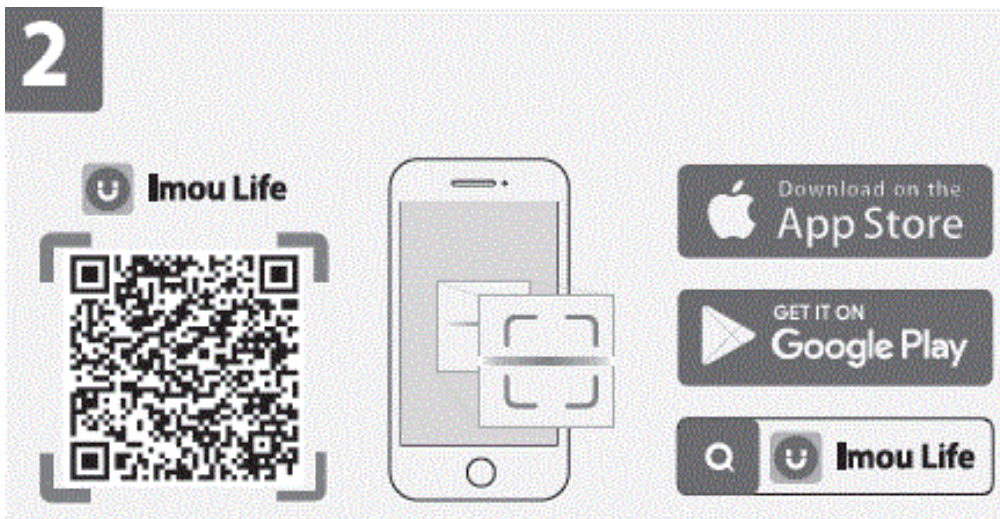

- Scan the QR code on part 2 or search for “Imou Life” to download and install the app. Create an account and log in.

Set Up the Camera

•

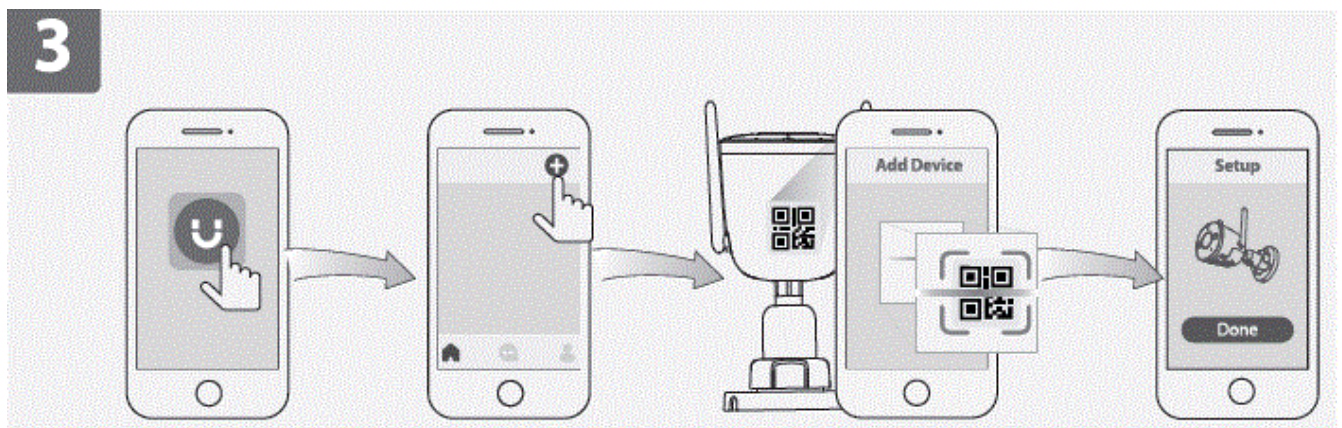

Scan the QR code on the body of the device or on the cover of this guide with the app, and then follow on-screen instructions to complete the setup (see part 3).

Install the Camera

4

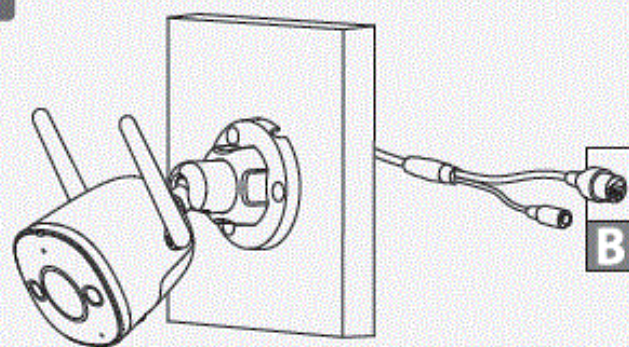

A-1

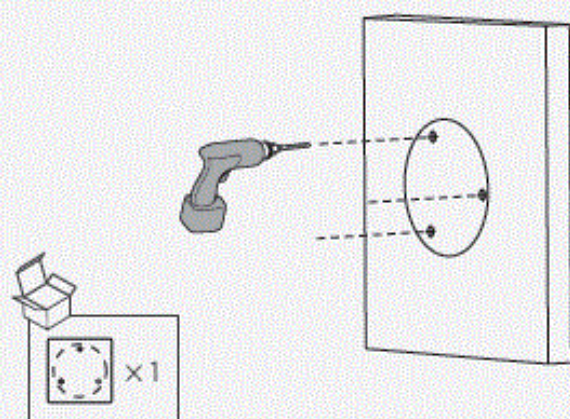

A-2

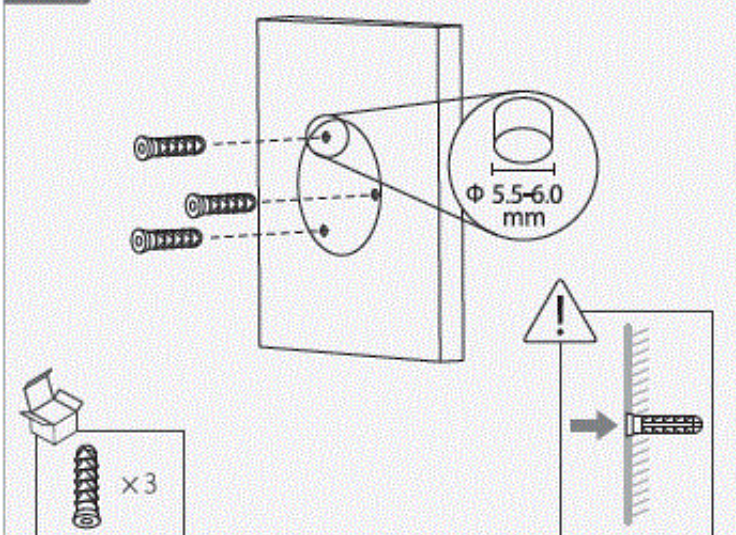

A-3

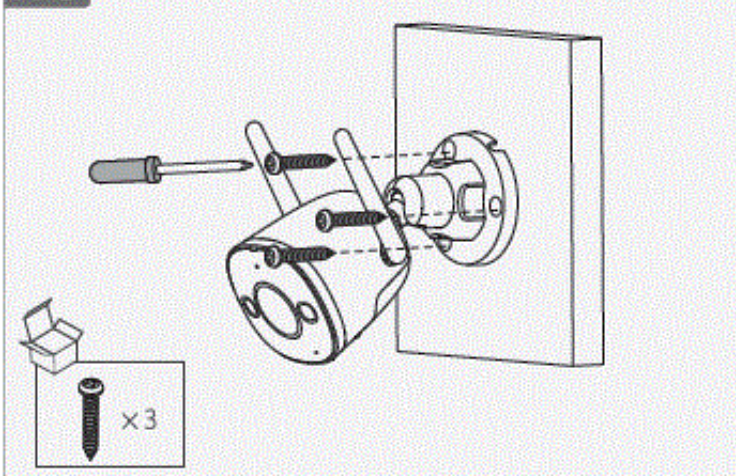

i

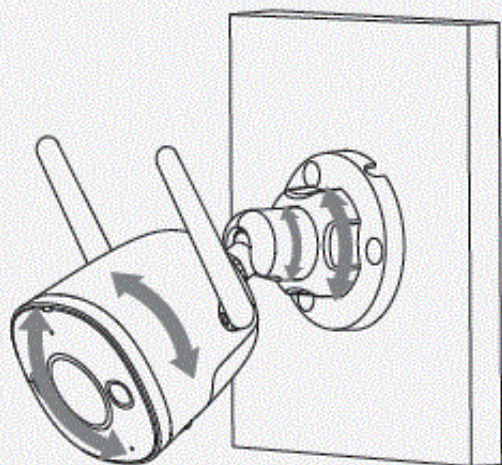

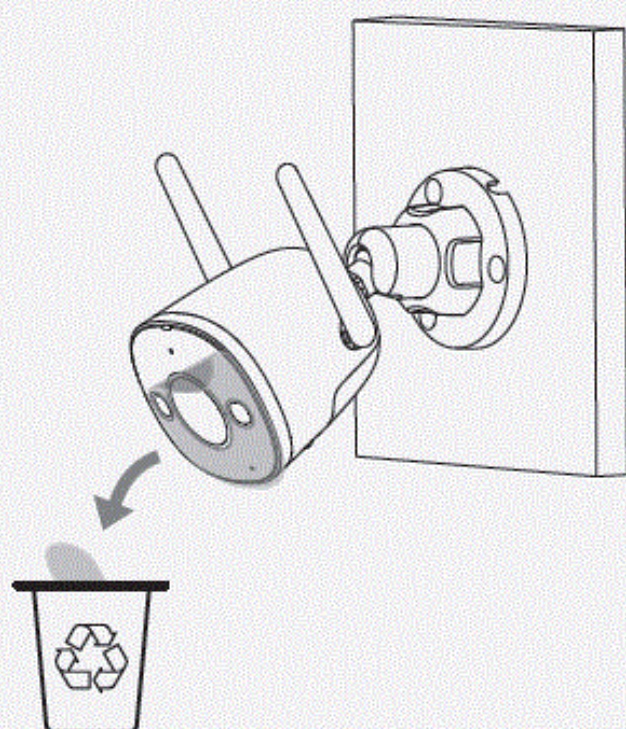

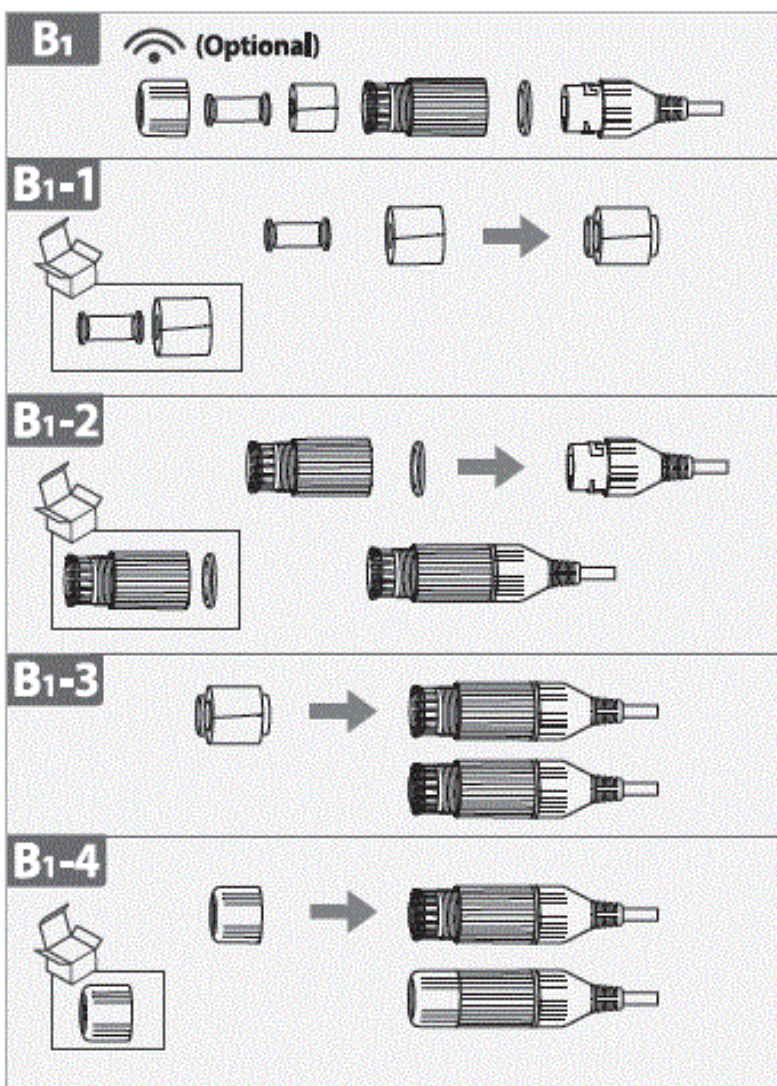

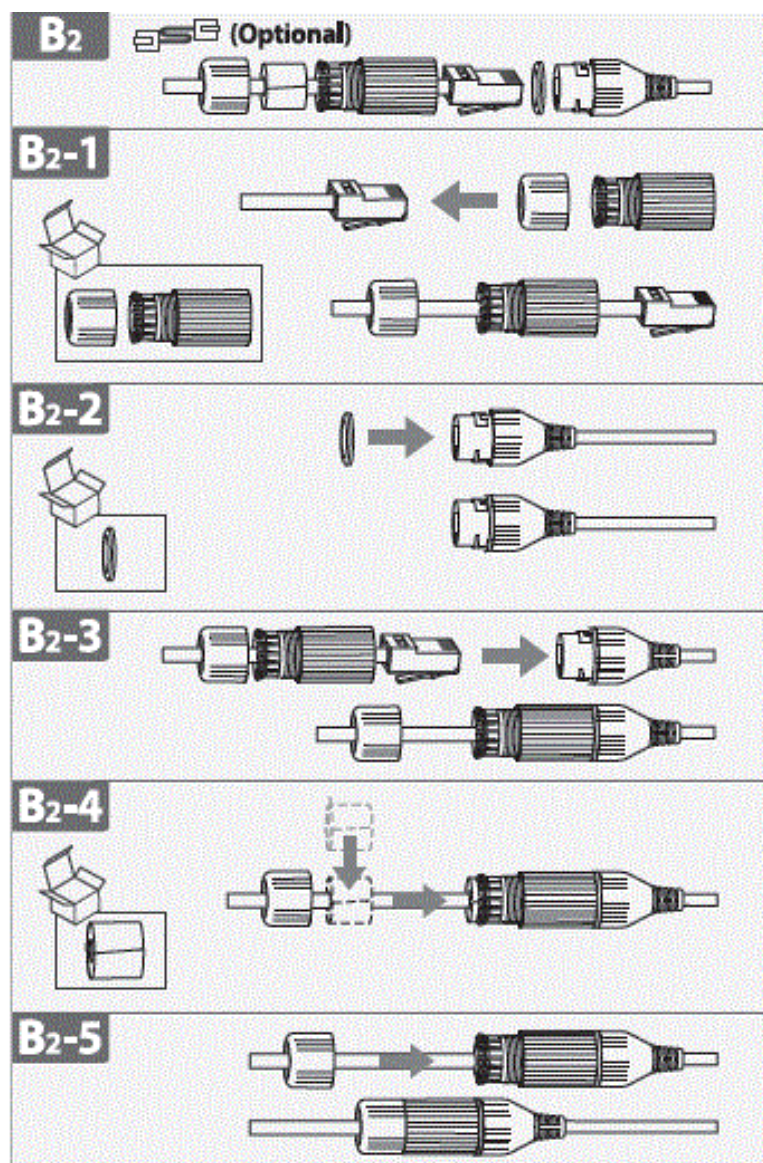

- Make sure the mounting surface is strong enough to hold three times the weight of the camera. For a detailed installation process, please see part 4.

LED Status		Device Status
Green	Flashing	Ready to set up the device
	Solid	Working properly
Red	Flashing	Network disconnected
		Failed to set up the device
	Solid	Booting
		Device malfunction
Green & Red	Alternating	Updating firmware
Off	/	Power off
		LED turned off

If you need to reset the camera, press and hold the reset button for 10 s. The LED turns solid red when the camera is booting.

Documents / Resources

	Imou Bullet 3 Security Camera [pdf] User Guide Bullet 3 Security Camera, 3 Security Camera, Camera
---	---

References

- [User Manual](#)