



## Imou BULLET 2S Bullet Network Camera User Guide

[Home](#) » [imou](#) » Imou BULLET 2S Bullet Network Camera User Guide 

### Contents

- [1 Imou BULLET 2S Bullet Network Camera](#)
- [2 Packing List](#)
- [3 Camera Introduction](#)
- [4 Operating with Imou Life App](#)
- [5 Installing Camera](#)
- [6 FAQ](#)
- [7 Documents / Resources](#)
- [8 Related Posts](#)

**imou**

**Imou BULLET 2S Bullet Network Camera**



**Packing List**



Camera ×1



Positioning Map ×1



Power Adapter ×1



Screw Package ×1



QSG ×1



Waterproof Connector ×1

## Camera Introduction

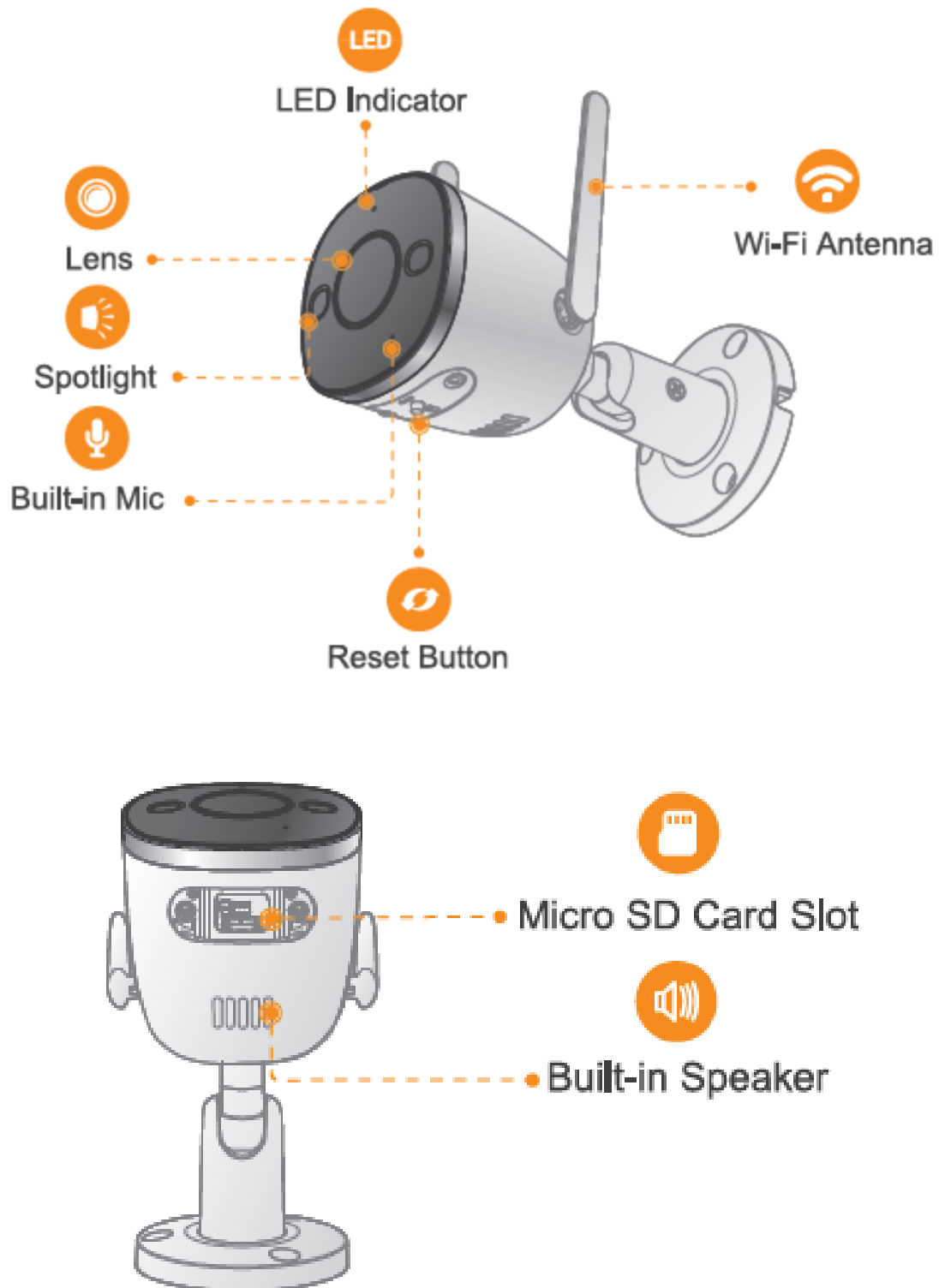

The pattern of the LED indicator is included in the following table

LED Indicator Status	Device Status
Off	<ul style="list-style-type: none"> <li>• Powered off/LED turned off</li> <li>• Rebooting after reset</li> </ul>
Red light on	<ul style="list-style-type: none"> <li>• Booting</li> <li>• Device malfunction</li> </ul>
Red light flashing	Network connection failed
Green light flashing	Waiting for network
Green light on	Operating properly
Green and red lights flashing alternately	Firmware updating

## Operating with Imou Life App

### Step 1

Scan the following QR code or search “Imou Life” in Google Play or App Store to download and install the app.

If you have installed the app, update it to the latest version.



### Step 2

Run the Imou Life App, and then create an account for the first use.

### Step 3

Connect the camera to the power source with the power adapter.

### Step 4

Wait for booting to be finished, and then the camera indicator light flashes green.

### Step 5

Do the following operations to finish adding the camera.



- If you have more than one camera, do step 5 to add them one by one.
- If the Wi-Fi network has changed or the indicator status goes wrong, press and hold the RESET button for 10 s to reset the camera, and then do step 5 to add the camera again.

## Installing Camera

Make sure that the mounting surface is strong enough to hold at least three times the device's weight.

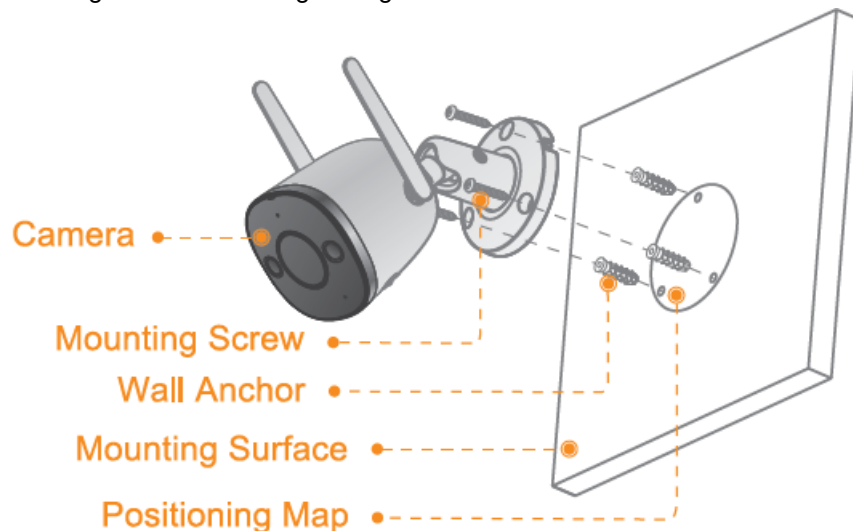

### Step 1

Drill screw holes on the mounting surface as the positioning map shows, and then put in the wall anchors.

### Step 2

Attach the pedestal to the mounting surface with the mounting Screws.

### Step 3

Power up the camera, and then adjust the lens to the ideal angle.

## FAQ

### Q: The device cannot work normally or start?

Check the LED indicator status. If the light is not in green, press and hold the reset button for 10 s to reset the camera.

### Q: How to connect the camera to a new Wi-Fi?

- If the camera is online, select Device Details > Network Config to change the Wi-Fi connection on the app.
- If the camera is offline, reset the camera, and then configure the camera again.

**Q: Connection is over time?**

- Check the Wi-Fi configuration of the router: Select the channel to auto and the mode to 11bgn mixed.
- Check if the distance between the camera and the router, the camera, and the smartphone is within 5 m (16.4 ft) during the connection.

**Q: When the Micro SD card is full, how is the recorded video saved?**

When the Micro SD card is full, the system will overwrite the previously recorded videos. Save the important information in time.

**Q: The device is offline?**

Check the indicator status:

- If the green light is on, check whether the router can connect to the Internet. If the Internet is working, restart the camera.
- If the red light flashes, reset the camera and then configure the camera again.
- If the red light is on, it means the camera is faulty.

For more questions, please scan the QR code below or visit: [www.imoulife.com/web/support/help](http://www.imoulife.com/web/support/help).



**Documents / Resources**

	<p><a href="#">Imou BULLET 2S Bullet Network Camera</a> [pdf] User Guide  IPC-FX2F-C, IPCFX2FC, 2AVYF-IPC-FX2F-C, 2AVYFIPCFX2FC, IPC-FX6F-C, IPCFX6FC, 2AVYF-IPC-FX6F-C, 2AVYFIPCFX6FC, IPC-FX6F-A-LC, IPCFX6FALC, 2AVYF-IPC-FX6F-A-LC, 2AVYFIPCFX6FALC, IPC-FX6F-B-LC, IPCFX6FBLC, 2AVYF-IPC-FX6F-B-LC, 2AVYFIPCFX6FBLC, IPC-FX6F-B, IPCFX6FB, 2AVYF-IPC-FX6F-B, 2AVYFIPCFX6FB, IPC-, FX6F-A, IPCFX6FA, 2AVYF-IPC-FX6F-A, 2AVYFIPCFX6FA, BULLET 2S, Bullet Network Camera, Network Camera, BULLET 2S, Camera</p>
---	---