



IMOU A26HS Network Camera User Guide

[Home](#) » [imou](#) » IMOU A26HS Network Camera User Guide 



Quick Start Guide
Version 1.0.0

Contents

- [1 Packing List](#)
- [2 Camera Introduction](#)
- [3 About the Guide](#)
- [4 Operating with Imou Life App](#)
- [5 Installing Camera](#)
- [6 Documents / Resources](#)
- [7 Related Posts](#)

Packing List



Camera ×1



Positioning Map ×1



Power Adapter ×1



Screw Package ×1



QSG ×1



Waterproof Connector ×1

Camera Introduction

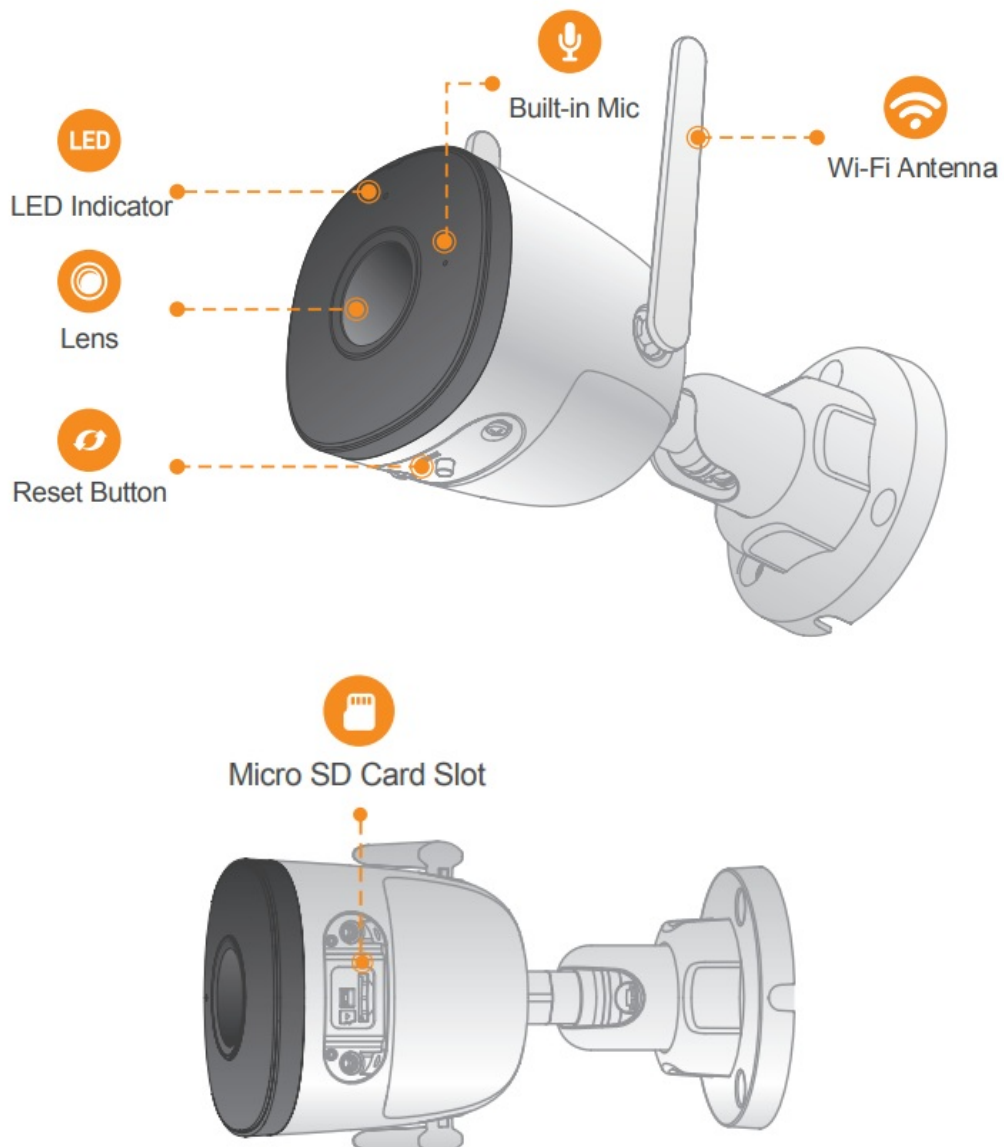

Note: Press and hold the reset button for 10 s to reset the camera.
The pattern of the LED indicator is included in the following table.

LED Indicator Status	Device Status
Off	•Powered off/LED turned off •Rebooting after reset
Red light on	•Booting •Device malfunction
Greenlight flashing	Waiting for network
Greenlight on	Operating properly
Red light flashing	Network connection failed
Green and red lights flashing alternately	Firmware updating

About the Guide

- This quick start guide is for reference only. The minor differences might be found in the user interface.
- All the design and software here are subject to change without prior written notice.
- All trademarks and registered trademarks mentioned are the properties of their respective owners.
- Please visit our website or contact your local service engineer for more information.
- If there is any uncertainty or controversy, please refer to our final explanation.

Operating with Imou Life App

Step 1

Scan the following QR code or search “Imou Life” in Google Play or App Store to download and install the app.

Note: If you have installed the app, update it to the latest version.



<http://mobile.easy4ipcloud.com/imou/detect.html>

Step 2

Run You Life App, and then register an account for the first use.

Step 3

Connect the camera to the power source with the power adapter.

Step 4

Wait for booting to be finished, and then the camera indicator flashes with green light.

Step 5

Do the following operations to finish adding the camera.



Note:

If you have more than one camera, do step 5 to add them one by one.

If the Wi-Fi network has changed or the indicator status goes wrong, reset the camera, and then do step 5 to add it again.

Installing Camera

Note:

Make sure that the mounting surface is strong enough to hold at least three times the device weight.

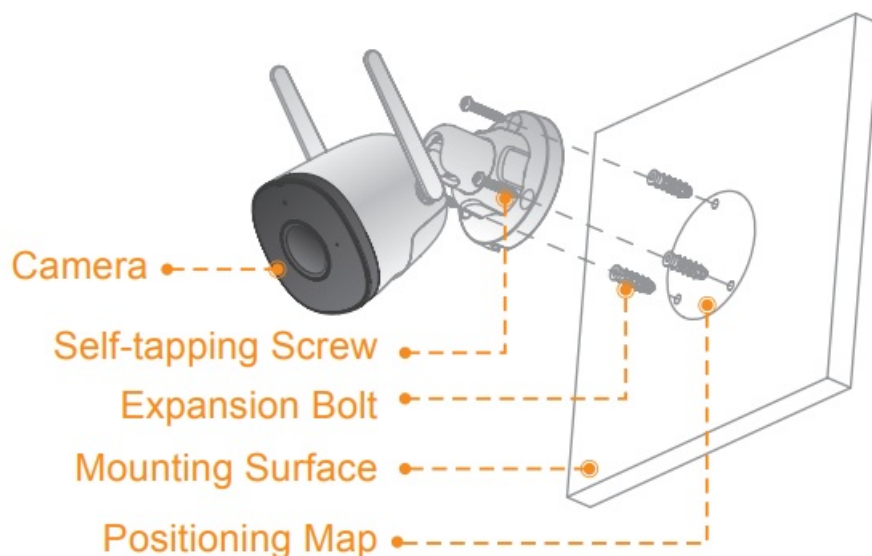

Step1 Drill screw holes on the mounting surface as the positioning map shows, and then put in the expansion bolts.

Step2 Attach the pedestal to the mounting surface with the self-tapping screws.

Step3 Power up the camera, and then adjust the lens to the ideal angle.

Documents / Resources



[IMOU A26HS Network Camera](#) [pdf] User Guide
A26HS, Network Camera