



imotion MC432 Mobile Computer User Guide

[Home](#) » [imotion](#) » imotion MC432 Mobile Computer User Guide 



Mobile Computer MC432/MC432L Quick Start Guide

Contents

- [1 General Safety Rules](#)
- [2 Package Contents](#)
- [3 Charging Instructions](#)
- [4 Micro SD / SIM\(For MC432L\) Card Installation](#)
- [5 Scanning a Barcode Label](#)
- [6 Important Notices When Using](#)
- [7 Bluetooth](#)
- [8 Body-worn Operation](#)
- [9 FCC Warning Statement](#)
- [10 Documents / Resources](#)
- [11 Related Posts](#)

General Safety Rules

- Please read this Guide carefully before you start using this device.
- Use only the MC432/MC432L components and accessories supplied by the manufacturer.
- Do not attempt to disassemble the MC432/MC432L, as it does not contain parts that can be repaired by the user. Any tampering will void the warranty.
- Discard replaced battery packs properly according to local laws.
- At the end of this device's product life, dispose of properly according to local laws.

- Do not submerge the MC432 in any type of liquid.
- Charging Temperature 0°C to 45°C

Package Contents

- MC432/MC432L Mobile Computer
- Battery Pack (with Rechargeable Battery)
- Quick Start Guide
- USB Charge/Communication Cable
- Quick Charge Compliant Power Adapter



After unpacking, please inspect package contents. If any item is damaged or missing, please contact your customer support representative immediately.

Features Front View

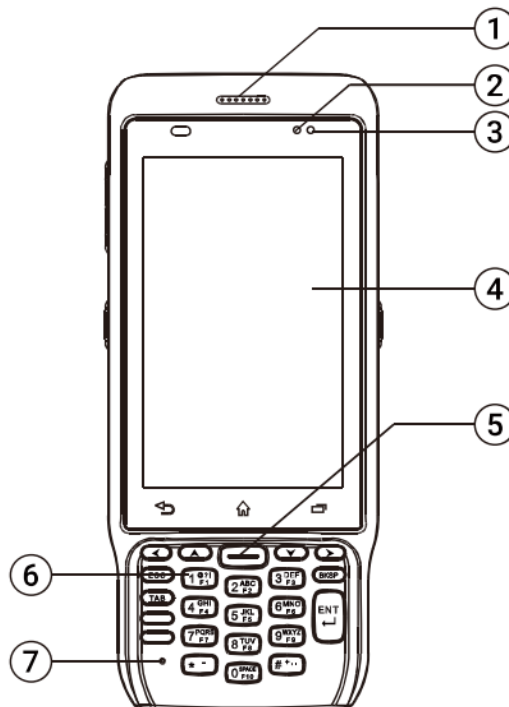

1. Speaker
2. Scan LED
3. Charging LED
4. Touch Screen
5. Scan Button
6. Keypad
7. Mic

Back View

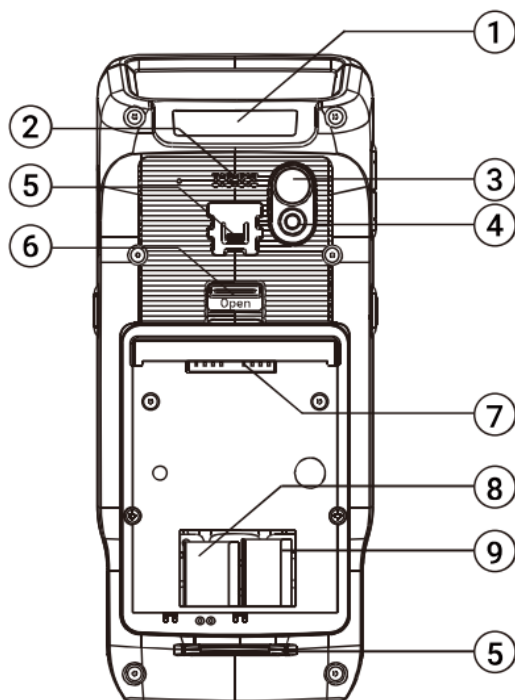

- 1. Laser Warning Label
- 2. Speaker
- 3. Camera
- 4. Flash LED
- 5. Hand Strap
- 6. Attachments
- 7. Battery Cover Lock Switch
- 8. Battery Pins
- 9. Micro SD Card Slot
- 10. SIM Card Slot(For MC432L)

Side View

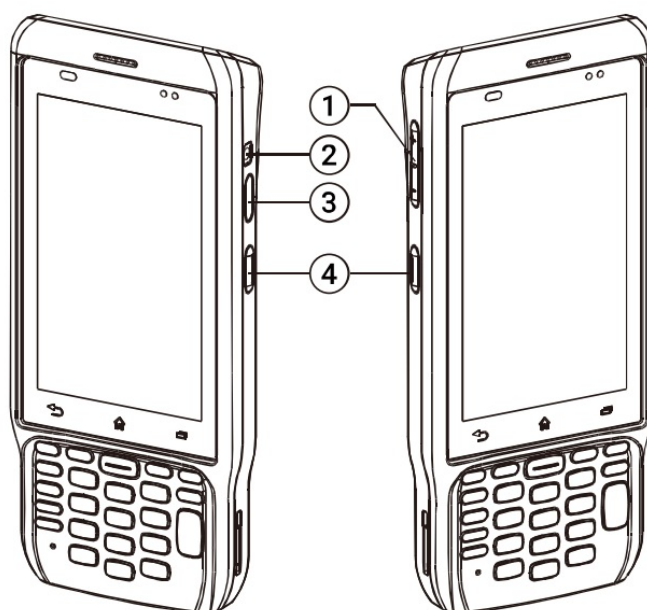

1. Volume Up/Down
2. Power Button
3. Headphone Jack
4. Scan Buttons

Top View

1. Scan Window

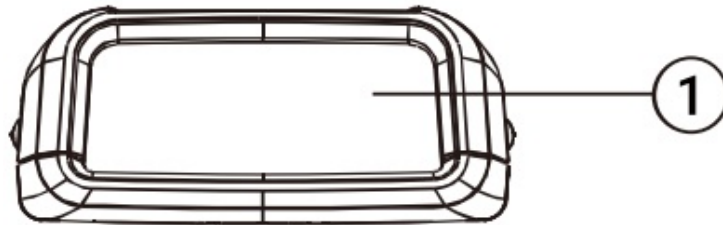

Bottom View

1. Charging Pin / USB C Connector

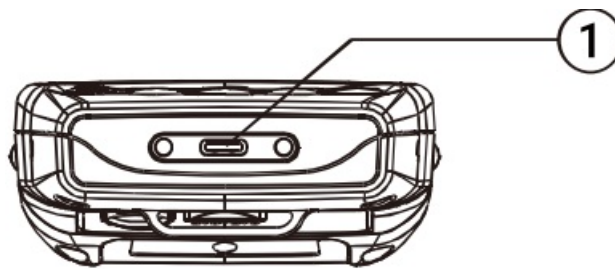

Charging Instructions

The MC432/MC432L battery pack is not initially fully charged. After installing the battery pack, please charge it via the USB cable or the charging cradle. By default, the battery pack is disconnected at the factory to avoid damage caused by excessive draining. Replace the battery pack annually to ensure maximum performance. Avoid storing batteries for long periods of time in fully charged or very low battery level status. To maintain a moderate charge and maximize battery life, charge spare battery packs every two to three months.

Installing the Battery Pack

1. Press and push the Battery Lock Switch to Open and remove the Battery Cover.
2. Align the Battery Pack and the device connectors and slide it into the Battery Slot.
3. Slide the Battery Cover into place.
4. Press and push the Battery Lock Switch to Lock to secure the battery.

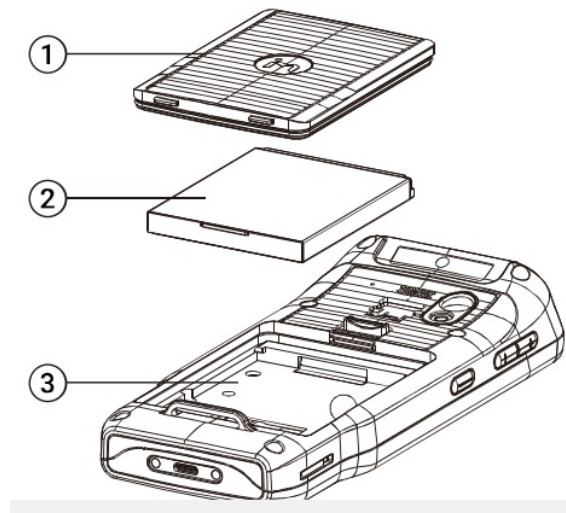

1. Battery Cover
2. Battery Pack
3. Battery Slot

CAUTION

RISK OF EXPLOSION IF BATTERY IS REPLACED BY AN INCORRECT TYPE. DISPOSE OF USED BATTERIES PROPERLY ACCORDING TO LOCAL LAWS.

Charging via USB Cable

Use the provided USB charge/communication cable together with the Quick Charge compliant power adapter to charge the MC432/MC432L from a power outlet.

Charging via Charging Cradle

Place the MC432/MC432L in the charging cradle. Attach the power adapter to the cradle, and then plug the power adapter into a power outlet.

Charging Time

The charging time required will vary depending on the actual application of the MC432/MC432L and the condition of the battery pack. This device is shipped with a lithium-ion battery that is not fully charged. Please charge this device fully before first-time use. Use under environment temperatures of 0°C~45°C.

Rated Voltage

Input AC 100-240V, 50/60Hz, 0.5A

Output

(1) DC 5V,3A/9V,2A

(2) DC 5V,2.5A/9V,2A(For USA)

Micro SD / SIM(For MC432L) Card Installation

1. Turn off the MC432/MC432L.
2. Open the Battery Cover and remove the Battery Pack.
3. Locate the SIM or Micro SD Card Slot inside the Battery Slot.
4. Insert the SIM Card or Micro SD Card into the appropriate slot.
5. Gently press and slide the card up until it clicks into place.
6. Reinstall the Battery Pack and Battery Cover.

Scanning a Barcode Label

1. Point the scan window at the barcode you wish to scan.
2. Tap Scan on the Scan app screen or press a scan button on the MC432/MC432L.

3. The imager projects a laser aiming pattern to position the barcode in the imager's field of view. Center the laser dot and cross-hair aiming pattern barcode.
4. Release the scan button to capture and decode the image.

Laser Safety

Do not stare into the beam of the laser light from this device. The MC432/MC432L uses an imager Aiming System with a laser light that is visible to the human eye and is emitted from the scan window at the top of the device.



Laser Light – Do not stare into this Beam Class 2 Laser Product. The maximum output radiation is 1 mW compliant with EN 60825-1 (2007)

Important Notices and Precautions

The manufacturer has made safety the first priority during the design stage. To avoid potential mishaps, please observe the following notices and precautions:



- Do not stock this device under high-temperature conditions that may cause the battery to overheat.
- Do not charge longer than required. When the charging light is red, stop charging immediately.
- Charge this device in a place without any water spray or moisture.
- Use a dry cloth to wipe any dust off of the AC adapter plug to avoid a potential fire.
- Do not drop this device on hard surfaces.
- Do not place heavy objects on this device to avoid cracking the enclosure.
- Do not unplug the AC adapter with wet hands to avoid electric shock.
- Do not use the AC adapter of the MC432/MC432L with any other devices.
-  Do not place the device in liquids to prevent short-circuits or fire.
- Do not place this device near an open fire.
- If the power or USB cable is seriously twisted or broken, stop using immediately to prevent electric shock, short-circuit, or fire.
- Stop using immediately if there is any unusual smell or overheating during charging or operation.
- Stop using immediately when there is liquid or dew on the device.



- Do not use the AC adapter outdoors.
- Please do not wrap the AC adapter with a cloth or other objects that could block heat dissipation and cause electric shock or fire.
- When not charging, remove the AC adapter plug from the wall AC outlet socket to avoid a fire hazard.

Important Notices When Using

- Before replacing the battery pack due to failure, shortened life, or unusual behavior, please confirm that the device has been used correctly, with no user operation issues involved.
- The manufacturer is not responsible for possible missing data or interference encountered during wireless transmissions.
- Do not use alcohol, benzene, organic solvents, cleaning liquid, or steel wool on the surface of this device.
- Do not scratch or mar the surface of the Scan Window in any way to avoid barcode scanning problems.

Bluetooth

- This device is designed based on Bluetooth standard specifications. However, compatibility problems may still occur with other Bluetooth devices.
- Before using this device, please make sure there is no other wireless device operating within a short distance of the same application area that may cause wireless signal interference.

Signal Interference from TV or Radio

- Sometimes transmitting or receiving data may fail due to signal interference from nearby TV or radio devices.

Audio Safety



To prevent possible hearing damage, do not listen to high volume levels for long periods of time.

European Union Regulatory Notes

1. Requirements for AT/BE/BG/CZ/DK/EE/FR/DE/IS/IE/IT/EL/ES/CY/LV /LI/LT/LU/HU /MT/NL/NO/PL/PT/RO/SI/SK/TR/FI/SE/CH/UK/HR.5150MHz~5350MHz is for indoor use only.
2. iMotion declares that the radio equipment type for the MC432/MC432L is in compliance with Directive 2014/53/EU.

The full text of the EU declaration of conformity is available at the following internet address: www.iwaypro.com



Hot Part Warning

The temperature of the battery surface may increase during operation.

SAR Compliance SAR Information (European Union):

Head: 0.297 W/kg@ 10g (CE)

Body: 1.29 W/kg@ 10g (CE) 

This device is restricted to indoor use when operating in the 5150 to 5350 MHz frequency range.

Body-worn Operation

This device was tested for typical body-worn operations. To comply with RF exposure requirements in Europe, a minimum separation distance of 0.5cm must be maintained between the user's body and the handset, including the antenna. Third-party belt clips, holsters, and similar accessories used by this device should not contain any metallic components. Body-worn accessories that do not meet these requirements may not comply with RF exposure requirements and should be avoided.

Power and Frequency Ranges

Radio Type	Description	Frequency	Maximum Output
Bluetooth	Bluetooth BR+EDR	2400-2483.5 MHz	10dBm
	Bluetooth 4.0-LE	2400-2483.5 MHz	0dBm
WLAN	2.4GHz	2400-2483.5 MHz	18dBm
	5GHz	5150-5350 MHz	16dBm
		5475-5850 MHz	16dBm
GSM(For MC432L)	GSM 850	824-849 MHz	33dBm
	GSM 900	880-915 MHz	33dBm
	GSM 1800	1710-1785 MHz	30dBm
	GSM 1900	1850-1910 MHz	30dBm
WCDMA(For MC432L)	WCDMA Band I	1920-1980 MHz	24dBm
	WCDMA Band II	1850-1910 MHz	24dBm
	WCDMA Band IV	1710-1755 MHz	24dBm
	WCDMA Band V	824-849 MHz	24dBm
	WCDMA Band VIII	880-915 MHz	24dBm
LTE(For MC432L)	LTE Band 1	1920-1980 MHz	23dBm
	LTE Band 2	1850-1910 MHz	23dBm
	LTE Band 3	1710-1785 MHz	23dBm
	LTE Band 4	1710-1755 MHz	23dBm
	LTE Band 5	824-849 MHz	23dBm
	LTE Band 7	2500-2570 MHz	23dBm
	LTE Band 8	880-915 MHz	23dBm

LTE(For MC432L)	LTE Band 20	832-862 MHz	23dBm
	LTE Band 28	703-748 MHz	23dBm
	LTE Band 38	2570-2620 MHz	23dBm
	LTE Band 39	1880-1920 MHz	23dBm
	LTE Band 40	2300-2400 MHz	23dBm
	LTE Band 41	2496-2690 MHz	23dBm
Other	NFC	13.56 MHz	
	GPS	1575.42 MHz	

FCC Warning Statement

This device complies with Part 15 of the FCC Rules. Operation is subject to the following two conditions: (1) This device may not cause harmful interference, and (2) this device must accept any interference received, including interference that may cause undesired operation.

This equipment has been tested and found to comply with the limits for a Class B digital device, pursuant to Part 15 of the FCC Rules. These limits are designed to provide reasonable protection against harmful interference in a residential installation. This equipment generates, uses, and can radiate radio frequency energy and, if not installed and used in accordance with the instructions, may cause harmful interference to radio communications. However, there is no guarantee that interference will not occur in a particular installation. If this equipment does cause harmful interference to radio or television reception, which can be determined by turning the equipment off and on, the user is encouraged to try to correct the interference by one of the following measures:

- Reorient or relocate the receiving antenna.
- Increase the separation between the equipment and receiver.
- Connect the equipment into an outlet on a circuit different from that to which the receiver is connected.
- Consult the dealer or an experienced radio/TV technician for help.

FCC Caution:

- Any changes or modifications not expressly approved by the party responsible for compliance could void the user’s authority to operate this equipment.
- This transmitter must not be co-located or operating in conjunction with any other antenna or transmitter.
- This device meets all the other requirements specified in Part 15E, Section 15.407 of the FCC Rules.
- Max SAR 0.991(Body)
- The product complies with the FCC portable RF exposure limit set forth for an uncontrolled environment and is safe for intended operation as described in this manual. Further RF exposure reduction can be achieved if the product is kept as far as possible from the user’s body or if the device is set to a lower output power if such a function is available.

Waylin Inc.
6F., No.288, Sec. 6, Civic Blvd., Xinyi Dist., Taipei City, Taiwan
<https://www.iwaypro.com>

Documents / Resources

	imotion MC432 Mobile Computer [pdf] User Guide MC432, SPYMC432, MC432, MC432L, MC432 Mobile Computer, Mobile Computer, Computer
---	--