

Contents [[hide](#)]

- [1 IMMAX Neo LITE Smart Home Device](#)
- [2 Product Specifications](#)
- [3 FAQs](#)
- [4 Documents / Resources](#)
 - [4.1 References](#)



IMMAX Neo LITE Smart Home Device



Product Specifications

- **Protocol:** Radiofrequency RF
- **Frequency:** 433MHz

- **Maximum Power:** 20dBm
- **Battery:** 23A 12V – 1.5Wmax

Manufacturer and importer

IMMAX, Teslova 1179/2, 702 00 Ostrava, EU | www.immax.cz Designed in the Czech Republic, manufactured in China

APPLICATION DOWNLOAD AND REGISTRATION



Download the Immax NEO PRO application by scanning the QR code, or search for and install the Immax NEO PRO application in the App Store or Google Play. Launch the Immax NEO PRO application and click on “Register” and create your own account via e-mail. When you have finished registration, log in to your existing account.

ADDING A PRODUCT TO THE IMMAX NEO PRO APPLICATION

- Install and connect the fan to the electrical wiring according to the enclosed instructions.
- Press the “8H” button on the remote control for at least 5 seconds. When you hear a click, it means the device is in pairing mode.
- Open the Immax NEO PRO application.
- Click on the “Room” icon.
- Click on the “+” icon to add a new device.
- Select the Immax NEO category in the left column.
- From the offered products, choose Fan – WiFi.
- Confirm that the device is in pairing mode – beep.
- Click on the “Next step” icon.
- Wait until the device is properly paired with Immax NEO PRO
- Enter the device name.

- Select the room in which you want to have the device located.
- Click 'Done.'

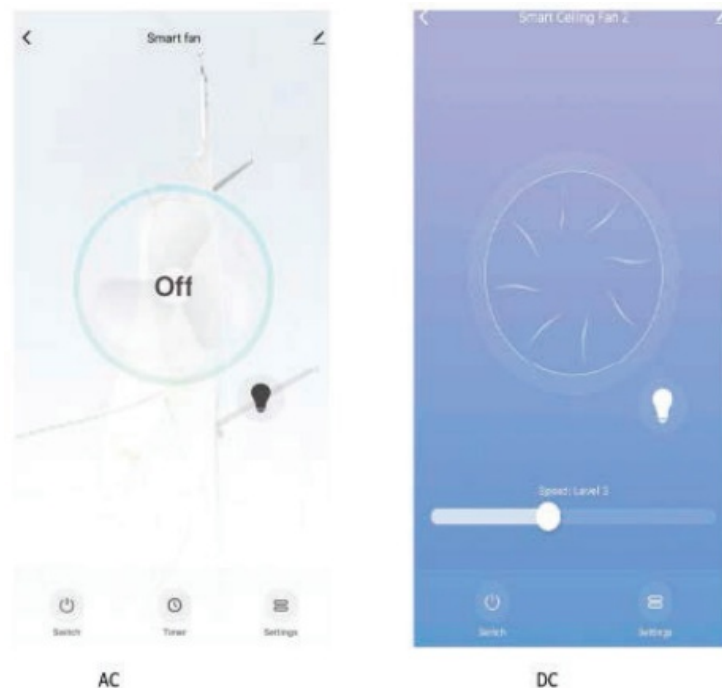

REMOVE THE PRODUCT FROM THE IMMAX NEO PRO APPLICATION

- Open the Immax NEO PRO application
- Click on the “Room” icon
- Select the device you want to pair
- Click on the icon in the upper right corner, “Settings.”
- Click on “Remove device”
- Select one of the options
 - Disconnect – removes the device from the Immax NEO PRO application, but the device information remains stored in the Immax NEO cloud
 - Disconnect and delete data – removes the device from the Immax NEO PRO application and from the Immax NEO cloud
- Confirm the removal of the device

DEVICE RESET

- Press the “8H” button on the remote control for at least 5 seconds.

BUTTONS FUNCTION

- FAN On/OFF – on/off ventilator
- Light ON/OFF – on/off light
- 1-5 fan speed
- 1H 4H 8H – timer 1h 4h 8h
- F/R: Change the direction of rotation of the fan
- Safety instructions for products containing batteries.
- Use only the recommended type of batteries listed in the product specifications (for example, AA).
- Do not attempt to recharge batteries unless they are specifically marked as rechargeable.
- Do not throw batteries into fire, disassemble, or expose them to excessive heat. Keep out of reach of children. Risk of ingestion.
- In case of electrolyte leakage, replace the batteries immediately and clean the contacts thoroughly.
- Instructions for installing and replacing batteries
- Open the battery compartment located on the back of the product.
- Insert the batteries according to the marked polarity (+ and -).
- Close the battery compartment.
- If the product stops working, check the batteries and replace them if necessary.

Maintenance and storage

- Remove the batteries when not using the product for a long period of time to prevent electrolyte leakage.
- Store batteries in a dry place and out of direct sunlight.
- Check the batteries periodically for leakage or wear.
- Crossed-out bin symbol
- This symbol on batteries or packaging indicates that the batteries are subject to special recycling. By following these instructions, you are helping to protect the environment.

DISPOSAL

The product (battery) must not be disposed of with municipal waste. To dispose of the product properly, take it to the designated collection points. ASEKOL: AK-016010, WEEE-Reg.-No. DE 88927148 For more information on Immax or Immax NEO Smart products, please visit: www.immax.cz

- **Protocol:** radio frequency RF
- **Frequency:** 433MHz
- **Max Output:** 20dBm
- **Battery:** 23A 12V – 1.5Wmax

FAQs

Q: How do I reset the device?

A: Press the 8H button on the remote control for at least 5 seconds to reset the device.

Q: How do I pair the device with the Immax NEO PRO application?

A: Follow the steps outlined in the “Adding a Product to the Immax NEO PRO Application” section above to pair the device with the application.

Documents / Resources

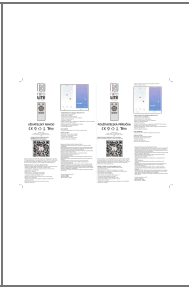
	immax neo LITE VARIABLE Smart LED Ceiling Lamp [pdf] User Manual 07280-RC, neo LITE VARIABLE Smart LED Ceiling Lamp, VARIABLE S mart LED Ceiling Lamp, Smart LED Ceiling Lamp, LED Ceiling Lamp, Cei ling Lamp, Lamp
--	--

References

- [User Manual](#)

device, immax, Lite, NEO, NEO LITE, Smart Home, user

immax manual

Leave a comment

Your email address will not be published. Required fields are marked *

Comment *

Name

Email

Website

☐ Save my name, email, and website in this browser for the next time I comment.

Post Comment

Search:

e.g. whirlpool wrf535swhz

Search

[Manuals+](#) | [Upload](#) | [Deep Search](#) | [Privacy Policy](#) | [@manuals.plus](#) | [YouTube](#)

This website is an independent publication and is neither affiliated with nor endorsed by any of the trademark owners. The "Bluetooth®" word mark and logos are registered trademarks owned by Bluetooth SIG, Inc. The "Wi-Fi®" word mark and logos are registered trademarks owned by the Wi-Fi Alliance. Any use of these marks on this website does not imply any affiliation with or endorsement.