

Immax 07570L NEO Smart Temperature and Humidity Sensor



# Immax 07570L NEO Smart Temperature and Humidity Sensor User Manual

[Home](#) » [immax](#) » Immax 07570L NEO Smart Temperature and Humidity Sensor User Manual 

## Contents

- [1 Immax 07570L NEO Smart Temperature and Humidity Sensor](#)
- [2 Product Information](#)
- [3 Product Usage Instructions](#)
- [4 Technical specifications](#)
- [5 Product Description](#)
- [6 Commissioning the device](#)
- [7 Installation Of The Tab](#)
- [8 Battery replacement](#)
- [9 Safety Information](#)
- [10 Maintenance](#)
- [11 Declaration Of Conformity](#)
- [12 Documents / Resources](#)
  - [12.1 References](#)



**Immax 07570L NEO Smart Temperature and Humidity Sensor**



## Product Information

### Specifications:

- **Product Name:** Immax NEO Smart Temperature and Humidity Sensor
- **Model Number:** 07570L
- **Connectivity:** Zigbee 3.0
- **Battery:** CR2032
- **Manufacturer:** Made in PRC

## Product Usage Instructions

### Commissioning the Device:

1. Remove the protective strip from the battery.
2. Put the device into pairing mode. The LED will flash.
3. Open the Immax NEO PRO application and search for Temperature and humidity sensor (Zigbee) or Other Zigbee devices.
4. Select a smart gateway and proceed according to the instructions in the application.

### Battery Replacement:

If you receive a low battery warning in the app, replace the CR2032 battery as soon as possible. When inserting a new battery, pay attention to the polarity.

### Installation:

1. Insert the loop as shown in picture 2.

2. Check that the holes for the sensors are aligned when closing the sensor.

## FAQ:

- **Q: How do I download and register the Immax NEO PRO app?**

A: You can scan the QR code provided in the manual or search for and install the Immax NEO PRO app from the App Store or Google Play.

- **Q: What type of battery does the sensor use?**

A: The sensor is equipped with a CR2032 battery for power.

- **Q: How do I pair the sensor with a smart gateway?**

A: Put the sensor into pairing mode, open the Immax NEO PRO app, and follow the on-screen instructions to connect it to a smart gateway.

## Technical specifications

- **Protocol:** ZigBee 3.0
- **Frequency:** 2400MHz~2483.5MHz
- **Maximum RF output power:** ZigBee: 10dBm – max 19dBm
- **Wireless range:** 30 m line of sight, 10 m in built-up space
- **Power source:** 1x 3V CR2032 battery
- **Operating voltage:** 2.4V-3.3V
- **Average operating current:** 5 mA (Zigbee)
- **Standby current:** < 3uA
- **Battery life:** 6 – 8 months
- **Data detection:** temperature and humidity detection takes place every 5 seconds
- **Data update:** when the temperature change is greater than 0.6 degrees or the humidity change is greater than 6%; by default, data is sent to the application every 30 minutes
- **Operating temperature:** -10°C to + 50°C
- **Operating humidity:** maximum 95% (non-condensing)
- **Degree of protection:** IP20
- **Certificates:** CE
- **Dimensions:** 35x35x8mm
- **Weight:** 8g
- **Package contents:** sensor, user manual

## Product Description

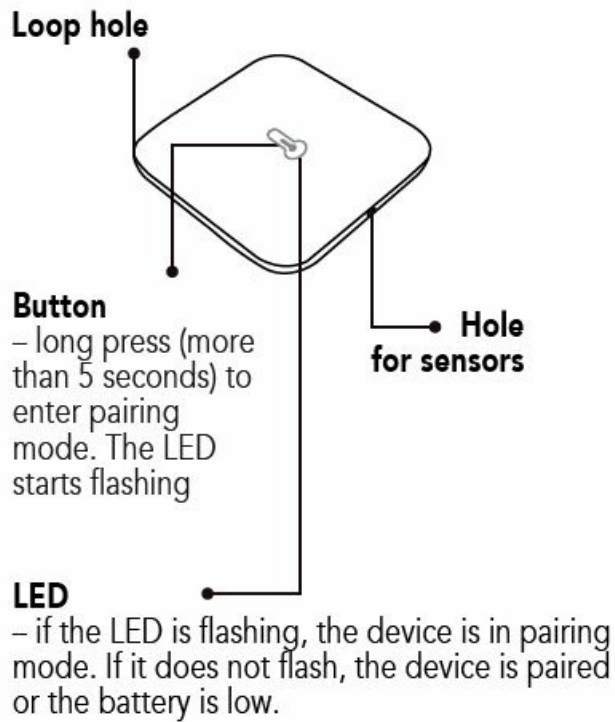

## Commissioning the device

- IMMAX NEO PRO APP DOWNLOAD AND REGISTRATION
- Scan the QR code to download the Immax NEO PRO app.
- Or search for and install the Immax NEO PRO app in the App Store or Google Play.



1. Remove the protective strip from the battery
2. Put the device into pairing mode. The LED will flash
3. Open the Immax NEO PRO application and search for Temperature and humidity sensor (Zigbee) or Other Zigbee devices. Select a smart gateway and proceed according to the instructions in the application.

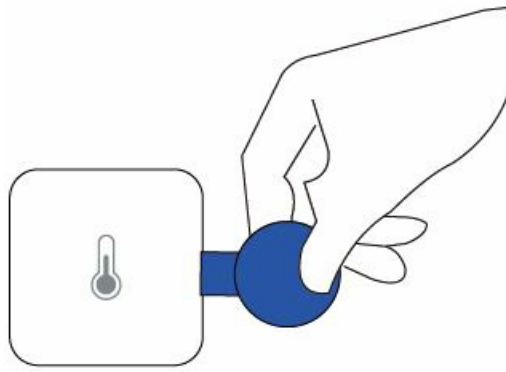

## Installation Of The Tab

1. Open the sensor – see picture
2. Insert the loop – see picture
3. When closing the sensor, check that the holes for the sensors are in the same places – see picture

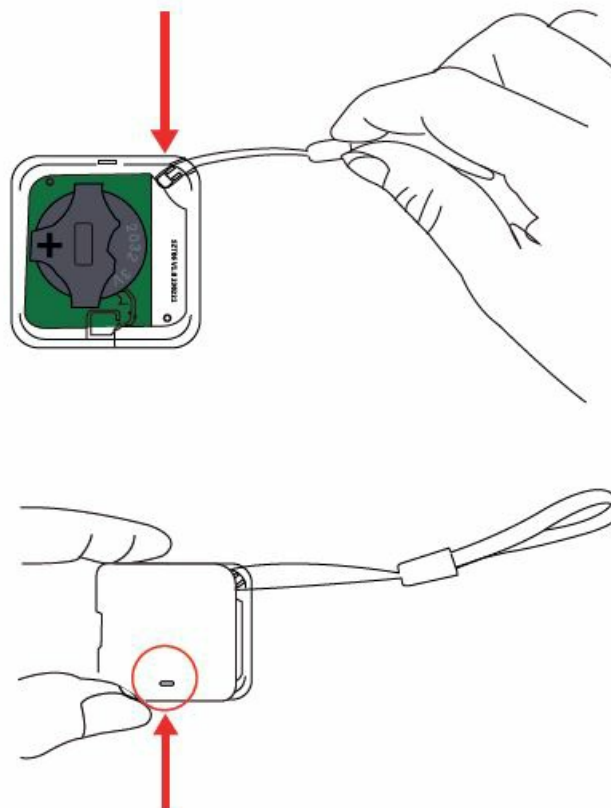
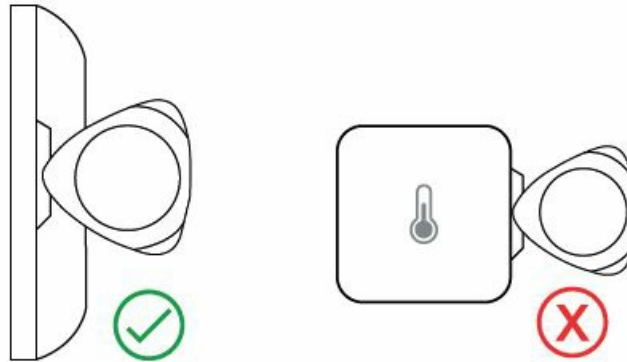

## Battery replacement

The sensor is fitted with a CR2032 battery. If you get a low battery warning in the app, replace it as soon as possible. When inserting a new battery, pay attention to the polarity.

## Safety Information

- **CAUTION:** Keep out of reach of children. This product contains small parts, which may cause suffocation or injury if swallowed.
- **WARNING:** Every battery has the potential to leak harmful chemicals that can damage skin, clothing or the area where the battery is stored. To avoid the risk of injury, do not allow any substance from the battery to come into contact with the eyes or skin. Every battery may burst or even explode if exposed to fire or other forms of excessive heat. Take care when handling the batteries. To reduce the risk of injury from mishandling the batteries, take the following precautions:
  - Do not use different brands and types of batteries in the same device
  - When replacing the batteries, always replace all the batteries in the device
  - Do not use rechargeable or reusable batteries.
  - Do not allow children to insert batteries without supervision.
  - Follow the battery manufacturer's instructions for proper battery handling and disposal.
- **CAUTION:** The product and batteries should be disposed of at a recycling centre. Do not dispose of them with normal household waste.
- **CAUTION:** To ensure safe use of the product, wires must be brought to the installation site according to valid regulations. The installation must only be carried out by an individual with the appropriate certification in the field of electronics. During installation or when a fault is detected, the power cable must always be disconnected from the socket (in the case of direct connection, the relevant circuit breaker must be switched off). Improper installation can damage the product and cause injury.
- **CAUTION:** Do not disassemble the product, an electric shock may occur.
- **CAUTION:** Use only the original power adapter provided with the product. Do not operate the device if the power cord shows signs of damage. **CAUTION:** Follow the instructions in the enclosed manual.

## Maintenance

- Protect the device from contamination and soiling. Wipe the device with a soft cloth, do not use rough or coarse materials.
- DO NOT USE solvents or other aggressive cleaners or chemicals.

## Declaration Of Conformity

- A Declaration of Conformity has been issued for this product. More information can be found at [www.immax.eu](http://www.immax.eu).
- If you have any questions or need advice, please contact us at [support@immax.eu](mailto:support@immax.eu).

	<p><b><a href="#">Immax 07570L NEO Smart Temperature and Humidity Sensor</a></b> [pdf] User Manual  07570L NEO Smart Temperature and Humidity Sensor, 07570L, NEO Smart Temperature and Humidity Sensor, Temperature and Humidity Sensor, Humidity Sensor, Sensor</p>
--	---

## References

-  [Velkoobchod s LED technikou IMMAX | Immax.cz](#)
-  [Velkoobchod s LED technikou IMMAX | Immax.cz](#)
-  [Velkoobchod s LED technikou IMMAX | Immax.cz](#)
-  [Velkoobchod s LED technikou IMMAX | Immax.cz](#)
-  [Velkoobchod s LED technikou IMMAX | Immax.cz](#)
-  [Velkoobchod s LED technikou IMMAX | Immax.cz](#)
-  [Velkoobchod s LED technikou IMMAX | Immax.cz](#)
-  [Velkoobchod s LED technikou IMMAX | Immax.cz](#)
- [User Manual](#)

### Manuals+, Privacy Policy

This website is an independent publication and is neither affiliated with nor endorsed by any of the trademark owners. The "Bluetooth®" word mark and logos are registered trademarks owned by Bluetooth SIG, Inc. The "Wi-Fi®" word mark and logos are registered trademarks owned by the Wi-Fi Alliance. Any use of these marks on this website does not imply any affiliation with or endorsement.