



imilab C20 Home Security Camera Instructions

[Home](#) » [IMILAB](#) » imilab C20 Home Security Camera Instructions 

Contents

- [1 imilab C20 Home Security Camera](#)
- [2 INSTALLATION INSTRUCTIONS](#)
- [3 Documents / Resources](#)
 - [3.1 References](#)
- [4 Related Posts](#)



imilab C20 Home Security Camera



INSTALLATION INSTRUCTIONS

WHY I CANNOT TURN ON THE CAMERA

Check if:

- the power supply is connected.
- the original power cable and adapter is used.



Why the indicator didn't light up after turning on the camera?

Enable the status indicator light in the settings.

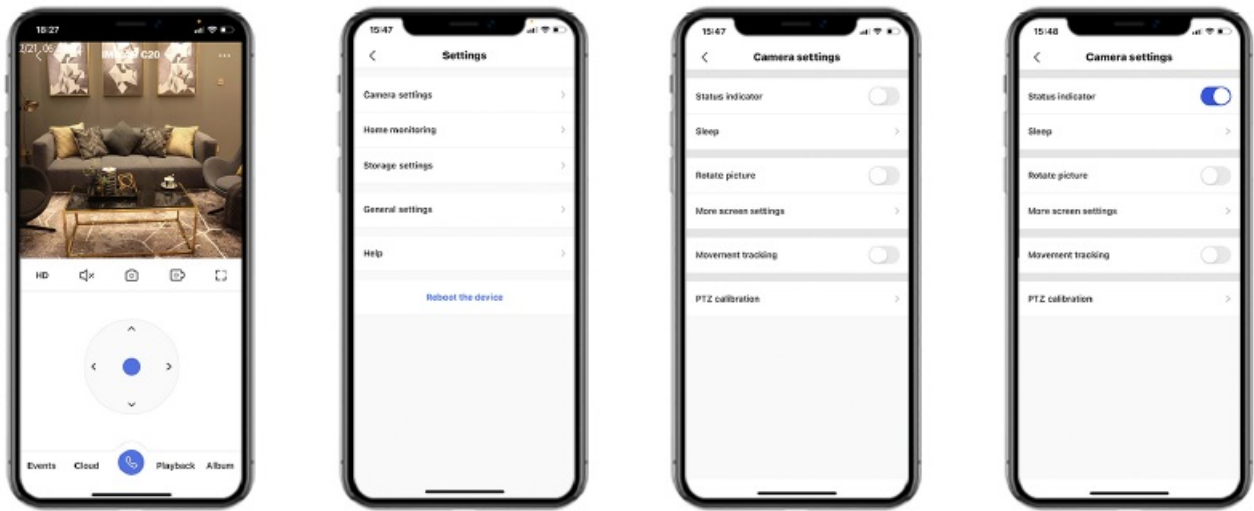

Why I cannot use my camera after changing:

- the name or password of Wi-Fi
- router
- the camera position

Reset the camera, pair it with the app and place the camera closer to router.



Restart your router and move your camera close to it



Check if your Wi-Fi is working. You can test the camera by connecting it with your phone's hotspot.

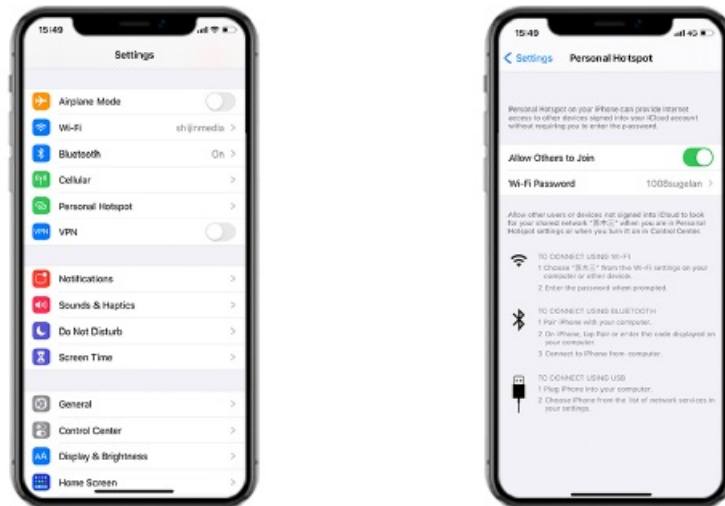

Why camera's indicator is a solid orange light but the app shows my device as offline?

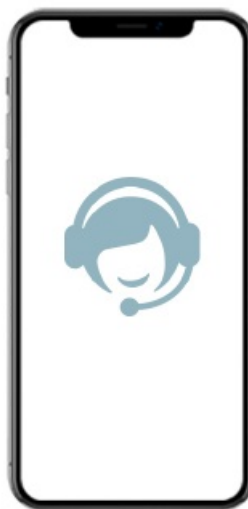

Please contact Imilab After-Sales Customer Service at help@imilab.com.

Why camera's indicator is a flashing blue/orange light and the app shows my device as offline?



- Check if your camera is turned on normally and the original adapter is used.
- Check if the Wi-Fi is working. Reset the camera and pair it again if you have changed your Wi-Fi name or password.



- Restart your router and move your camera closer to it.



Why I Cannot view previous camera recordings in the app?

Check if you have mounted a memory card having enough memory in your camera.



whyl Cannot record footage / delete videos / format my Card?



You can either format the memory card in the app or format it on a computer before mounting it. If the issue still persists, try replacing the memory card.

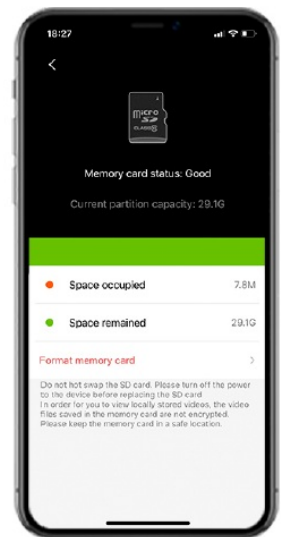
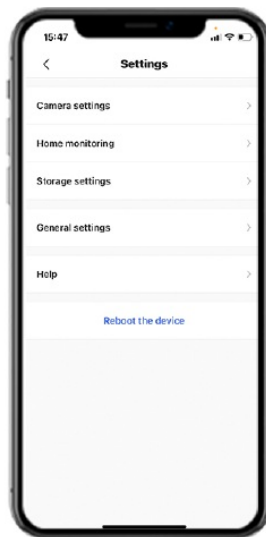
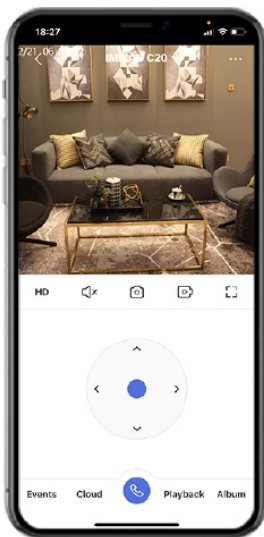

Why I cannot hear any audio when viewing a video in the app?

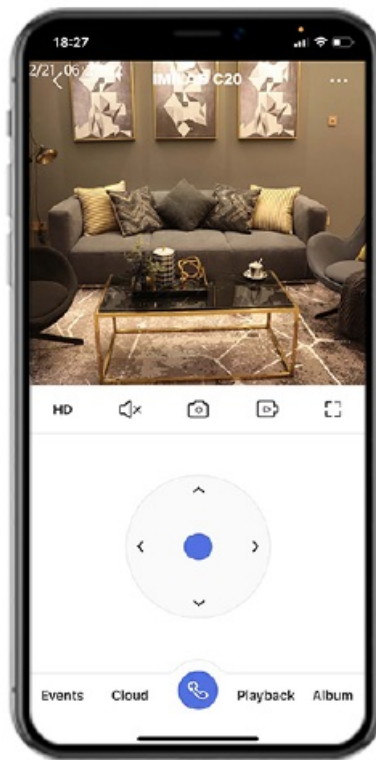

By default, the audio for live videos is turned off in the app. You can turn on the audio with the Sound Volume button on the live video screen.

Why audio at camera cannot be received during voice calls?

Enable audio recording permissions for the app in phone's settings.



Why my phone cannot receive alarm notifications / other messages from Home Assistant?

Enable notification permissions for app in phone's settings.

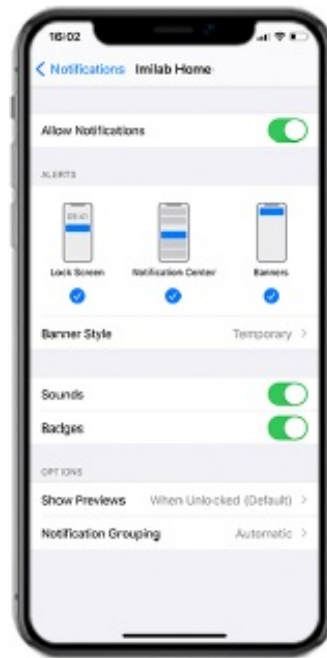

Documents / Resources

[imilab C20 Home Security Camera](#) [pdf] Instructions
C20, Home Security Camera

IMILAB C20 FAQs



the camera closer to router.

After exiting the app, reset your camera and print it again.

Restart your router and move your camera closer to it.

Check if your Wi-Fi is working. You can test the camera by connecting it with your phone's hotspot.

Blower contact built into After-Care

A diagram showing a transformer with two secondary windings. One winding is connected to a meter, and the other winding is connected to a load. The meter is connected to the transformer via two wires.



Restart your router and have your camera connect to it.

Why I cannot view previous camera

AB C20 Home Se



Enable audio recording permissions for the app
phone's settings.

ification permissions for app in phone

Manuals+,

[imilab C20 Home Security Camera](#) [pdf] User Manual
C20, C20 Home Security Camera, Home Security Camera, Security Camera, Camera