



imarku Rolling Knife Sharpener Tool User Guide

[Home](#) » [imarku](#) » imarku Rolling Knife Sharpener Tool User Guide 

imarku



User Guide

Contents

- [1 4 ANGLES MAGNETIC SUPPORT](#)
- [2 USING METHOD](#)
- [3 Documents / Resources](#)
 - [3.1 References](#)

4 ANGLES MAGNETIC SUPPORT

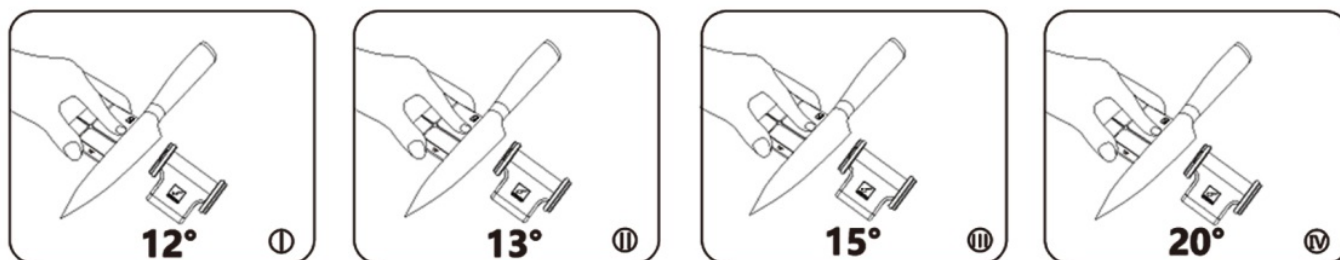

USING METHOD

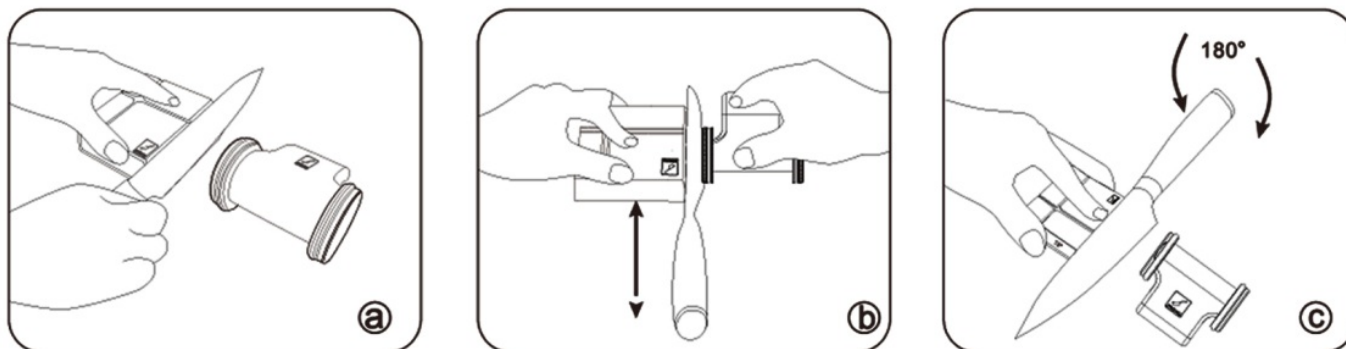

1. Fix the knife at the desired height
2. Put the sharpener against the knife
3. Gently roll the knife through the sharpener from the base to the tip, until it is successfully sharpened.

*When using, please keep the blade facing down and beyond the edge of the base to achieve the best sharpening effect

Documents / Resources

	imarku Rolling Knife Sharpener Tool [pdf] User Guide Rolling Knife Sharpener Tool, Rolling, Knife Sharpener Tool, Sharpener Tool
---	---

References

- [User Manual](#)

[Manuals+](#), [Privacy Policy](#)

This website is an independent publication and is neither affiliated with nor endorsed by any of the trademark owners. The "Bluetooth®" word mark and logos are registered trademarks owned by Bluetooth SIG, Inc. The "Wi-Fi®" word mark and logos are registered trademarks owned by the Wi-Fi Alliance. Any use of these marks on this website does not imply any affiliation with or endorsement.