



ILP CFS-36WLED CF Series Light User Guide

[Home](#) » [ILP](#) » ILP CFS-36WLED CF Series Light User Guide 

Contents

- [1 ILP CFS-36WLED CF Series Light](#)
- [2 Overview](#)
- [3 FEATURES](#)
- [4 SUITABLE APPLICATIONS](#)
- [5 ORDERING GUIDE](#)
- [6 QUICK SHIP ITEMS](#)
- [7 LED SYSTEMS INFO](#)
- [8 SPECIFICATIONS](#)
- [9 WARRANTY](#)
- [10 MOUNTING OPTIONS](#)
- [11 LINE DRAWINGS](#)
- [12 Contact](#)
- [13 Documents / Resources](#)



ILP CFS-36WLED CF Series Light



Overview



FEATURES



- Architectural die-cast aluminum housing
- Bronze (BRZ), Black (BLK), & White (WHT) polyester powder coat finishes (std.)
- Field Swappable NEMA optical Distributions:
 - **CFS:** NEMA 7×6 (std.), 5×5 & 4×4
 - **CFM:** NEMA 7×6 (std.), 5×5, 4×4, & 3×3
- Mounting:
 - ½" Knuckle (std.)

- Trunnion Mount Bracket
- 2 3/8" Tenon Cap option
- Embedded Photocell
- Pushbutton convertible top provides toolless access:
 - Easily swap optics
 - Field Adjustable Output (FAO) allows individual luminaire lumen output control (std.)
 - Photocell override switch
- 120-277V Universal Voltage
- 4000K & 5000K CCT (std.)
- >80 Color Rendering Index (CRI)
- Calculated L70 >100,000 Hours @ 25°C per TM-21-11
- IP66 Rated Luminaire
- 5 Year Warranty
- ETL Listed for Wet Locations, Suitable for Ground Mounting
- DesignLights Consortium® Qualified Luminaire

SUITABLE APPLICATIONS

- Landscape
- Flag Pole
- Wall Wash
- Signage
- Spot and Flood Light
- Elevation Illumination

ORDERING GUIDE

SERIES /WATT /DRIVER /COLOR /OPTICS /FINISH

CFS	CF Series Small	36W	U 120-277 V	50	N76/S	7×6 Optic (CFS)	BRZ	Bro nze
				40	N76/M	7×6 Optic (CF M)	WHT	Whi te
CF M	CF Series Medium	52W 85W					BLK	Bla ck

OPTIONS

- **SP1¹**: 10kA Max Univolt Surge Protector

MOUNTING – FIELD INSTALLED

- **CF-TR/xxx**: 2 3/8" Tenon Adapter (xxx=fixture color)

- **CF-TM/xxx:** Trunnion Mounting Bracket (xxx=fixture color)

Ship With Accessories

- **N33/xxx:** NEMA 3Hx3V Optics (xxx=M52 or M85)
- **N44/xxx:** NEMA 4Hx4V Optics (xxx=M52 or M85)
- **N55/xxx:** NEMA 5Hx5V Optics (xxx=M36, M52, or M85)
- **OPTxxx:** All Optical Distributions included (xxx=S36, M52, or M85)
- **HD/x-yyy2:** Hood (x = S & M, yyy =fixture color)

1. CFM Only
2. Does not qualify for DLC

QUICK SHIP ITEMS

SERIES /WATT /DRIVER /COLOR /OPTICS /FINISH

CFS CF Series Small	36W	U 120-277 V	50	N76/S	7×6 Optic (CFS)	BRZ	Bro nze
			40	N76/M	7×6 Optic (CF M)	WHT	Whi te
CFM CF Series Medium	52W 85W					BLK	Bla ck

LED SYSTEMS INFO

LED SYSTEMS INFORMATION ¹				4000K		5000K	
Part Numbers	Optics	Lumens	Efficacy	Lumens	Efficacy		
cacy	Watts ²	DLC Listing					
CFS-36WLED	7X6	4,017 lm	117 lm/W	3,945 lm	115 lm/W	34 W	PREMIUM
	5X5	4,146 lm	118 lm/W	4,107 lm	117 lm/W		
4X4	3,304 lm	96 lm/W	3,274 lm	95 lm/W			
CFM-52WLED	7X6	6,285 lm	110 lm/W	6,655 lm	117 lm/W	57W	STANDARD
	5X5	6,245 lm	110 lm/W	6,612 lm	116 lm/W		
	4X4	6,276 lm	109 lm/W	6,645 lm	117 lm/W		
	3X3	6,183 lm	119 lm/W	6,547 lm	115 lm/W		
CFM-85WLED	7X6	10,630 lm	125 lm/W	11,160 lm	130 lm/W	85 W	PREMIUM
	5X5	10,370 lm	122 lm/W	10,886 lm	127 lm/W		
	4X4	8,895 lm	103 lm/W	9,236 lm	108 lm/W		
	3×3	7,959 lm	94 lm/W	8,391 lm	98 lm/W		
1Values are nominal, see IES file for more detail							
2Electrical data at 25C (77F). Actual wattage may differ by +/-10%.							

SPECIFICATIONS

CONSTRUCTION

The CF Series features an architectural low-profile die-cast aluminum housing with a durable polyester powder coat finish tailored to withstand extreme weather changes without cracking or peeling (Available in ILP White (WHT), Black (BLK), or Bronze (BRZ) finishes; Consult factory for alternate finishes). The tempered clear glass lens seals to the housing with a one-piece silicone gasket creating an IP66 rating for maximum ingress protection. The tool-less Salt Spray tested for 500 hrs. 3' cord included.

ELECTRICAL

High-performance driver features over-voltage, under-voltage, short circuit and over temperature protection. 0-10V dimming (10% – 100%) standard. Standard Universal Voltage (120-277 Vac) Input 50/60 Hz. L70 >100,000 hrs. in accordance of IESNA TM-21-11 Projected values at 25°C Ambient temperature. Power Factor > 0.90. Input power stays constant over life. Minimum 2.5kV surge rating. Standard Integral Field Adjustable Output (FAO) device allows for easy tuning of luminaire light levels for individual site conditions (10-100%).

MOUNTING

The CF Series's tool-less head latch allows for easy servicing and the standard provided locking screw provides optional vandal resistance. Provided standard with a fully adjustable ¾" Female knuckle with 3' outdoor rated (3)

conductor power cord for easy quick installation. Optional heavy-duty trunnion bracket or 2-3/8" die-cast aluminum tenon adaptor accessories available.

OPTICS

The CF Series features field swappable snap-in NEMA optical distributions. Available in 7Hx6V (std.) 5Hx5V, 4Hx4V, or 3Hx3V (Medium only). OPTxxx option provides all NEMA optical distributions standard. Available in 4000K or 5000K color temperature (CCT) per ANSI C78.377 standard. Consult factory for availability of alternate CCTs.

THERMAL

CF Series's features (2) High-efficacy COB LED's mounted directly to the cast aluminum housing with heat dissipating fins to provide excellent thermal performance extending the life of electronic components. Operating Ambient Temperature: -40°C — +40°C (-40°F—104°F)

CONTROLS

Integral embedded IP66 rated electronic photocell provides dusk/ dawn control standard with an optional override switch to by-pass the photocell when required.

CERTIFICATIONS

ETL Listed for wet locations, suitable for ground mounting. DesignLights Consortium® (DLC) Premium qualified product and DLC qualified product. Not all versions of this product may be DLC Premium qualified or DLC qualified. Please check the DLC Qualified Products List at www.designlights.org/QPL to confirm which versions are qualified. Tested in accordance with IESNA LM-79 and LM-80 standards.

WARRANTY

- 5 Year Warranty (Terms and Conditions apply).
- See Website for more details. <https://www.ilp-inc.com/documents/>

MOUNTING OPTIONS

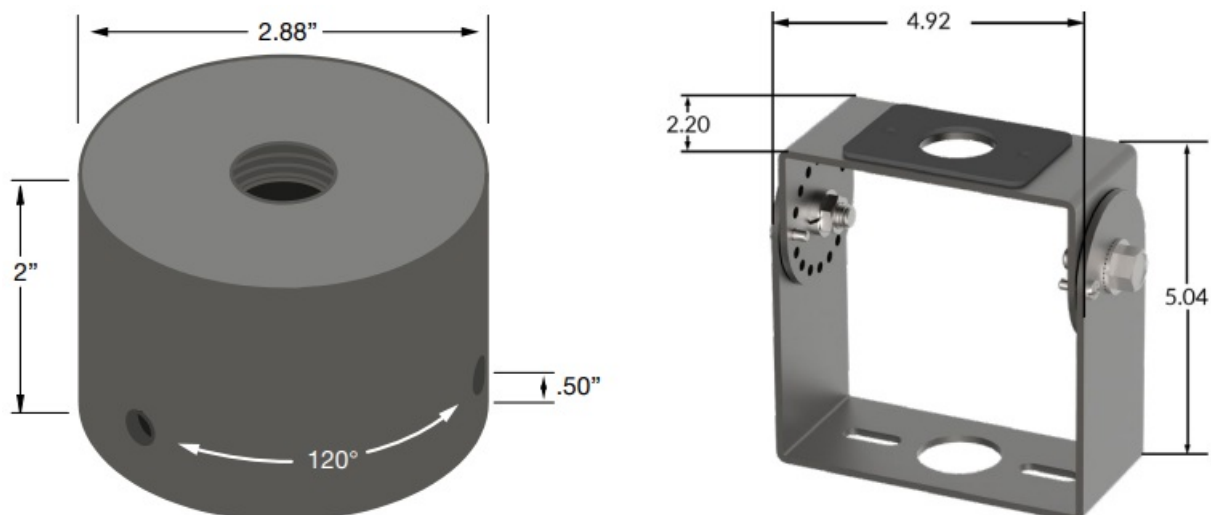

- CF-TR – 2-3/8" Tenon Adapter

- TMB – Trunnion Mount Bracket

LINE DRAWINGS

CFS – 36W

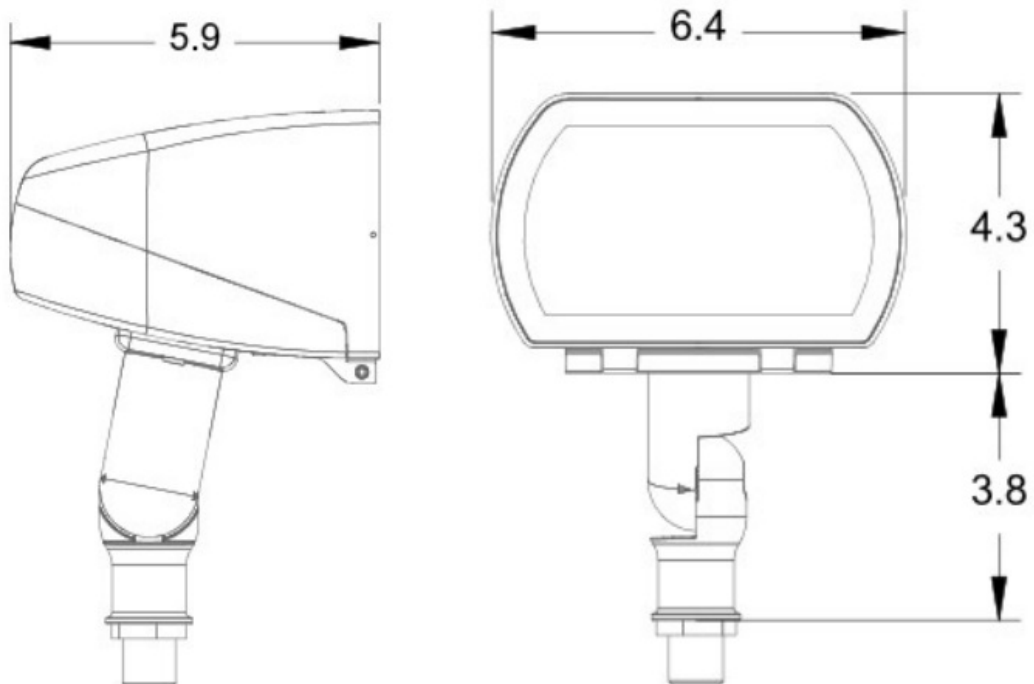

CFM – 52W & 85W

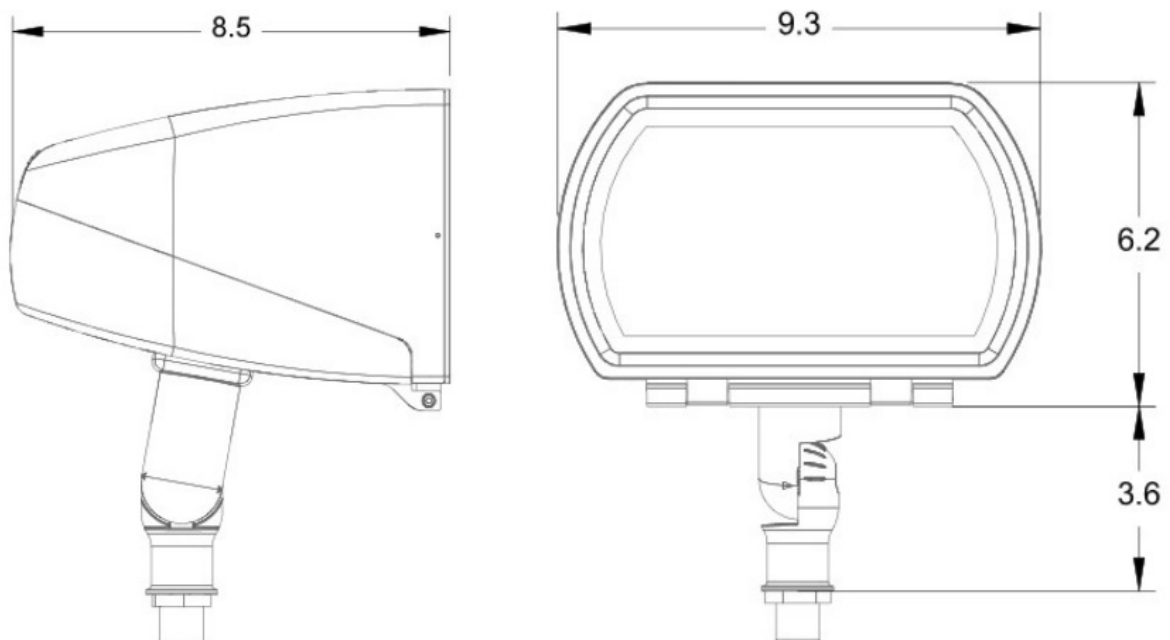

OPTICS

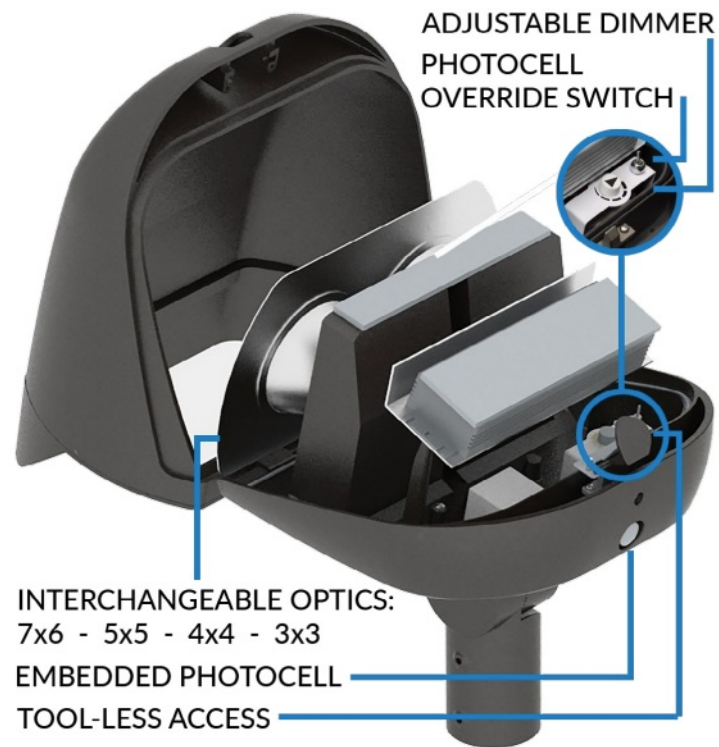

Contact

- 407-478-3759
- www.ilp-inc.com

Documents / Resources

	<p>ILP CFS-36WLED CF Series Light [pdf] User Guide</p> <p>CFS-36WLED CF Series Light, CFS-36WLED, CF Series Light, Series Light</p>
---	---