



iLIVE ITTB401DW Turntable with Bluetooth Transmitter User Guide

[Home](#) » [iLive](#) » iLIVE ITTB401DW Turntable with Bluetooth Transmitter User Guide 



Turntable with Stereo Speakers
User's Guide for Model ITTB751 DW







For the most up-to-date version of this User's Guide, go to www.iliveelectronics.com

Contents

- 1 Safety Instructions & Warnings**
- 2 Important Safety Instructions**
- 3 FCC Warnings**
- 4 Additional Warnings and Precautions**
- 5 Setup**
- 6 Orientation**
- 7 Assembly**
- 8 Connecting to Devices**
- 9 Customer Support**
- 10 Documents / Resources**
- 11 Related Posts**

Safety Instructions & Warnings

<p>CAUTION RISK OF ELECTRIC SHOCK DO NOT OP EN</p>	<p>Warning: To reduce the risk of electric shock, do not remove cover (or back). No user-serviceable parts inside. Refer servicing to qualified service personnel.</p>
	<p>The exclamation point within an equilateral triangle is intended to alert the user to the presence of important operating and maintenance (servicing) instructions in the literature accompanying the appliance.</p>
	<p>The lightning flash with the arrowhead symbol, within an equilateral triangle, is intended to alert the user to the presence of “dangerous voltage” within the product’s enclosure that may be of sufficient magnitude to constitute a risk of electric shock to persons.</p>
	<p>This symbol indicates that this product incorporates double insulation between hazardous mains voltage and user-accessible parts.</p>
	<p>This product utilizes a Class 1 laser to read Compact Discs. This laser Compact Disc Player is equipped with safety switches to avoid exposure when the CD door is open and the safety interlocks are defeated. Invisible laser radiation is present when the CD Player’s lid is open and the system’s interlock has failed or been defeated. It is very important that you avoid direct exposure to the laser beam at all times. Please do not attempt to defeat or bypass the safety switches.</p>
	<p>Warning: This product can expose you to chemicals including lead, which is known to the State of California to cause cancer and birth defects, or other reproductive harm. For more information go to www.P65Warnings.ca.gov. This product meets and complies with required Federal product guidelines</p>

Important Safety Instructions

- Read these Instructions.
- Keep these Instructions.
- Heed all Warnings.
- Follow all instructions.
- Do not use this apparatus near water.
- Clean only with a dry cloth.
- Do not block any ventilation openings. Install in accordance with the manufacturer’s instructions.
- Do not install near any heat sources such as radiators, heat registers, stoves, or other apparatus (including amplifiers) that produce heat.

- Do not defeat the safety purpose of the polarized or grounding-type plug. A polarized plug has two blades with one wider than the other. A grounding-type plug has two blades and a third grounding prong. The wide blade or the third prong are provided for your safety. When the provided plug does not fit into your outlet, consult an electrician for the replacement of the obsolete outlet.
- Protect the power cord from being walked on or pinched particularly at plugs, convenience receptacles, and the point where they exit from the apparatus.
- Only use attachments/accessories specified by the manufacturer.
- Unplug this apparatus during lightning storms or when unused for long periods of time.
- Refer all servicing to qualified service personnel. Servicing is required when the apparatus has been damaged in any way, such as power-supply cord or plug is damaged, liquid has been spilled or objects have fallen into the apparatus, the apparatus has been exposed to rain or moisture, does not operate normally, or has been dropped.



- Use only with a cart, stand, tripod, bracket, or table specified by the manufacturer, or sold with the apparatus. When a cart is used, use caution when moving the cart/ apparatus combination to avoid injury from tip-over.

FCC Warnings

Warning: Changes or modifications to this unit not expressly approved by the party responsible for compliance could void the user's authority to operate the equipment.

NOTE: This equipment has been tested and found to comply with the limits for a Class B digital device, pursuant to Part 15 of the FCC Rules. These limits are designed to provide reasonable protection against harmful interference in a residential installation. This equipment generates, uses, and can radiate radio frequency energy and, if not installed and used in accordance with the instructions, may cause harmful interference to radio communications. However, there is no guarantee that interference will not occur in a particular installation. If this equipment does cause harmful interference to radio or television reception, which can be determined by turning the equipment off and on, the user is encouraged to try to correct the interference by one or more of the following measures:

- Reorient or relocate the receiving antenna.
- Increase the separation between the equipment and receiver.
- Connect the equipment into an outlet on a circuit different from that to which the receiver is connected.
- Consult the dealer or an experienced radio/TV technician for help.

To comply with FCC RF exposure compliance requirements, this grant is applicable to only mobile configurations. The antennas used for this transmitter must be installed to provide a separation distance of at least 20cm from all persons and must not be co-located or operating in conjunction with any other antenna or transmitter.

Additional Warnings and Precautions

- CAUTION: TO PREVENT ELECTRIC SHOCK, MATCH WIDE BLADE OF PLUG TO WIDE SLOT, FULLY INSERT.
- The mains plug is used as a disconnect device and it should remain readily operable during intended use. In order to disconnect the apparatus from the mains completely, the mains plug should be disconnected from the

mains socket outlet completely.

- **CAUTION:** Use of controls or adjustments or performance of procedures other than those specified may result in hazardous radiation exposure.
- **WARNING:** Changes or modifications to this unit not expressly approved by the party responsible for compliance could void the user's authority to operate the equipment.
- **WARNING:** The use of this unit near fluorescent lighting may cause interference regarding the use of the remote. If the unit is displaying erratic behavior move away from any fluorescent lighting, as it may be the cause.
- **WARNING:** Shock hazard – Do Not Open. Caution and marking information is located at the rear or bottom of the apparatus.
- **WARNING:** To reduce the risk of fire or electric shock, do not expose this apparatus to rain, moisture, dripping, or splashing.
- Objects filled with liquids, such as vases, shall not be placed on the apparatus.

Setup

Includes

- RCA stereo audio cable
- User's Guide
- 45 rpm adapter

Power

Plug the built-in AC power cord into a standard wall outlet.

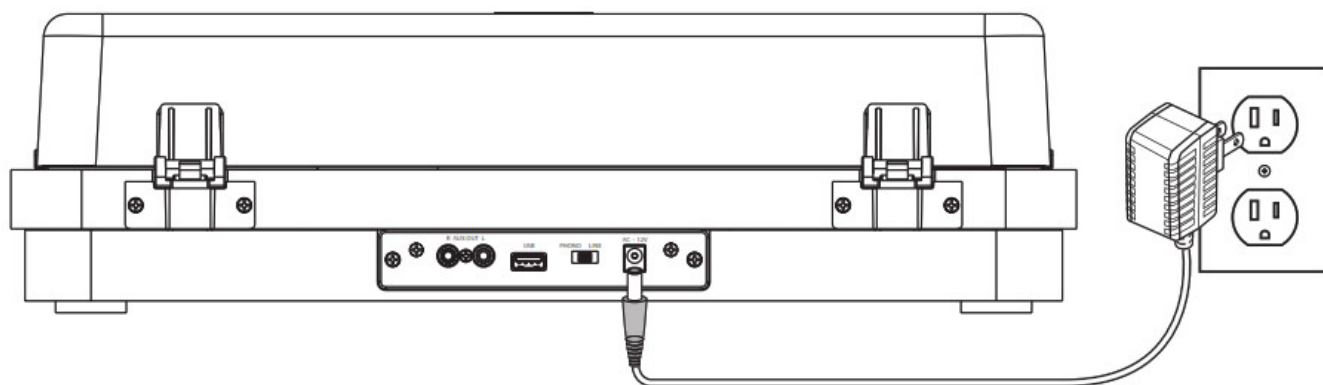

Orientation

Features & Controls

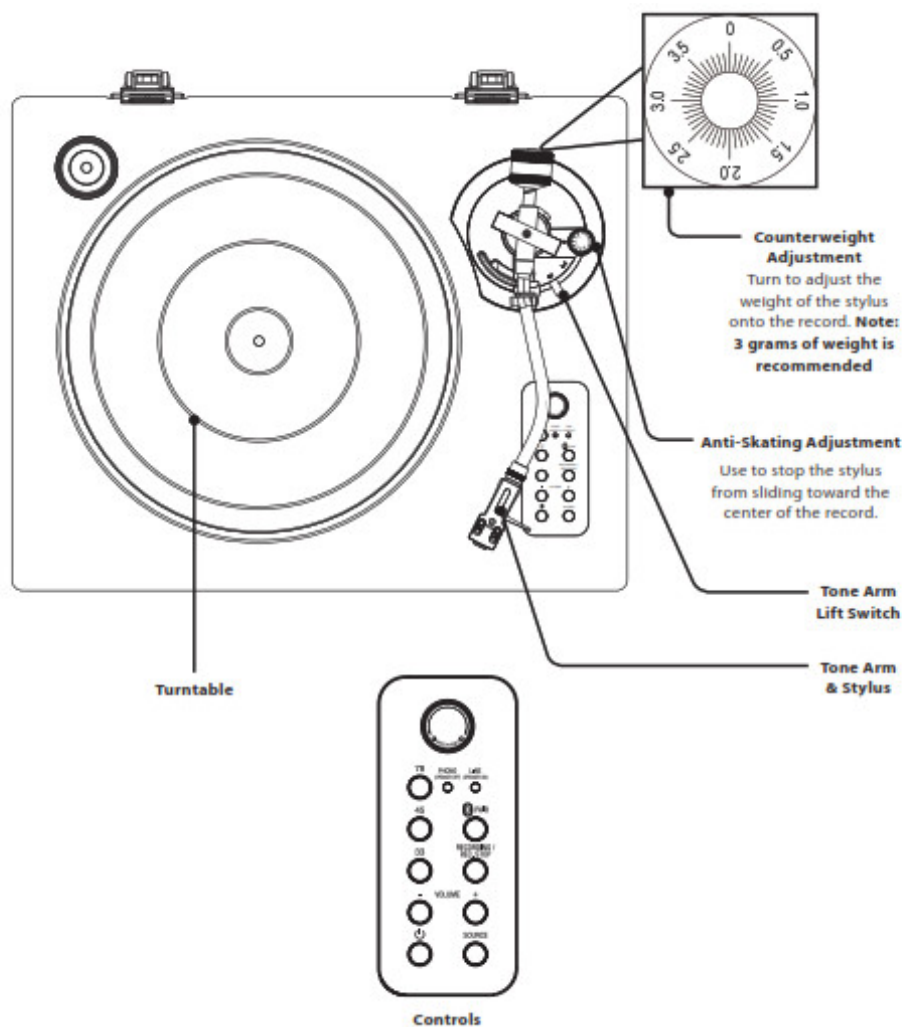

Pitch Adj.

Use to fine-tune the speed of the turntable.

78/45/30

Press to select the playback speed of a record.

Power

Press to power ON/OFF.

Rec. Stop

Press to stop recording music to a USB.

Recording

Press to start recording music to a USB drive.

Pair

Press and hold to begin pairing to a Bluetooth device.

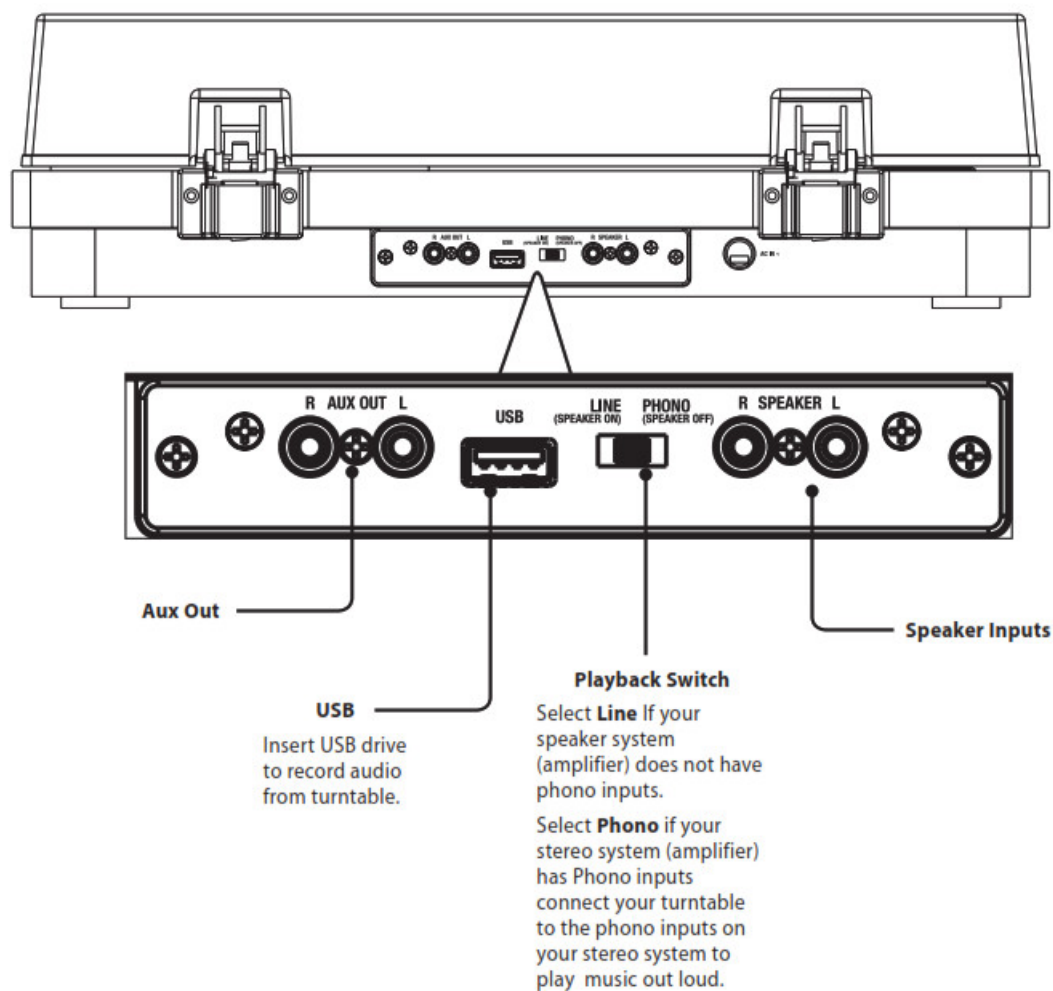

Assembly

Step 1

Place the Belt plate onto the main unit as seen below.

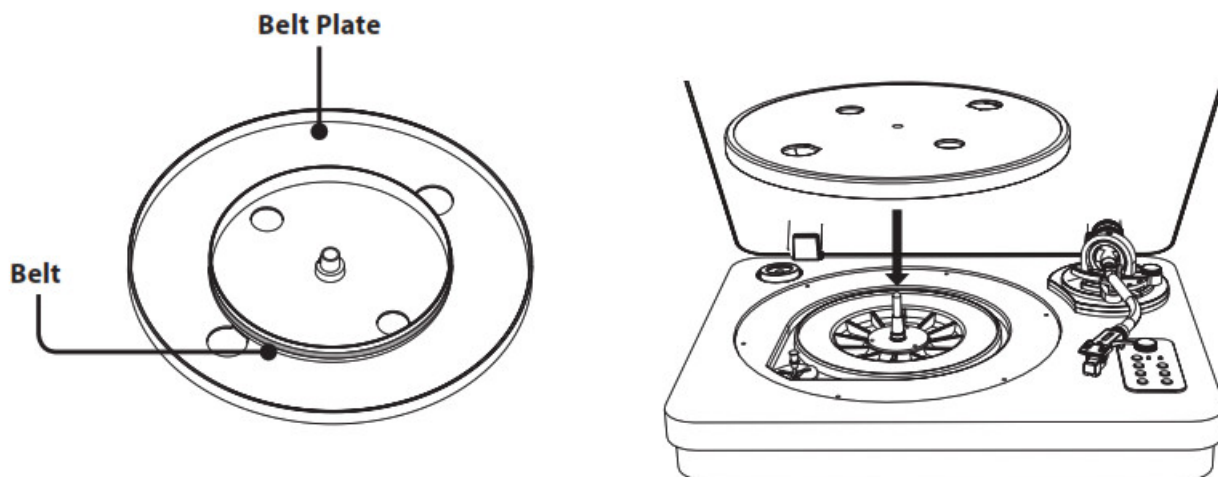

Step 2

Pull the Belt of the Belt Plate around the Roller as shown below.

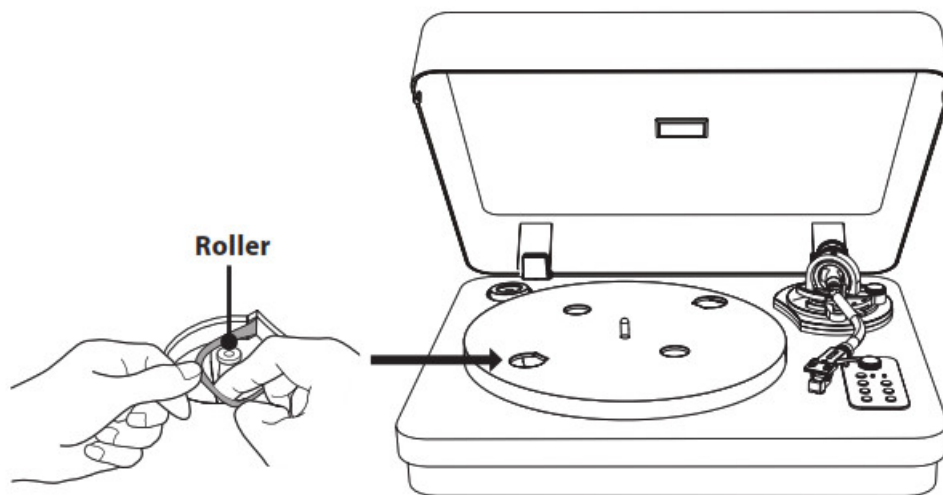

Step 3

Place the Plate Cover over the Belt Plate as shown below. You may now load a record onto the turntable.

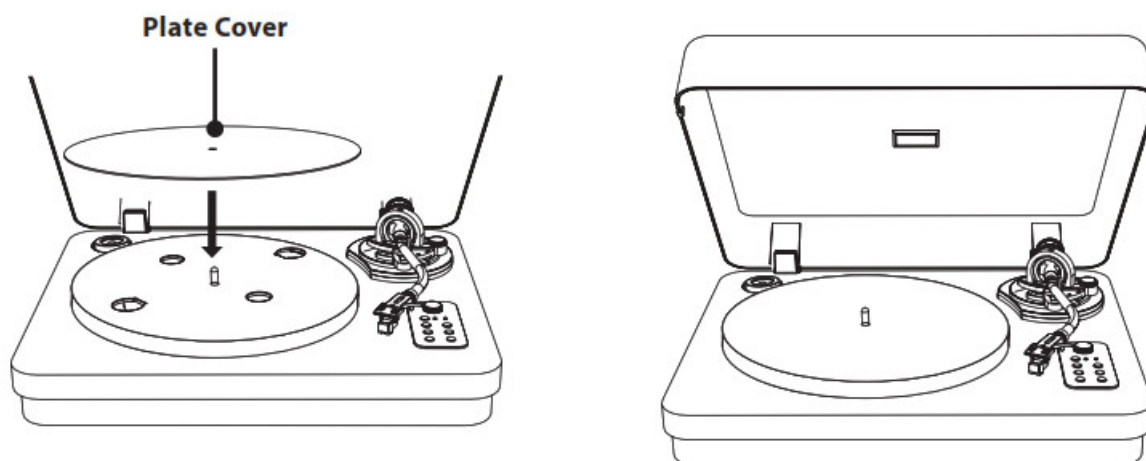

Connecting to Devices

Connecting to a Bluetooth Speaker

Note: This turntable has a Bluetooth transmitter and can stream the audio from a record to a speaker for room-filling sound. This unit does not have a Bluetooth Receiver, therefore it cannot receive Bluetooth signals from a phone or tablet to play music.

1. Start by enabling Pairing Mode on the Bluetooth Speaker you want to use. Before beginning the pairing process, be sure no other devices are connected to the speaker.
2. Press the Pair button on the turntable to begin pairing to your speaker. The backlight on the turntable will quickly flash blue while it attempts to connect to the speaker.
3. When successfully paired, the indicator light on the turntable will turn solid. Note: If the turntable fails to connect, the indicator light will continue flashing blue. Press the Pair button to try again.
4. Audio from the record will now be heard through the connected speaker's system.

Using the Aux Out

Requires RCA audio cable (included).

1. Plug the included RCA audio cable into the Aux Out on the turntable and your amplifier.

2. Set the Playback Switch to Phono mode, the backlighting will turn white.
3. Audio from the record will now be heard through the connected amplifier/speakers.

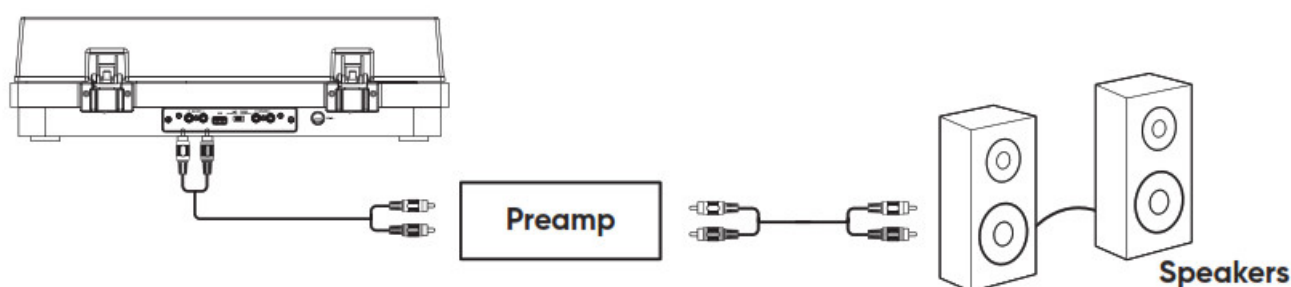

Note: Select Phono on the Playback Switch if your stereo system (amplifier) has Phono inputs connect your turntable to the phono inputs on your stereo system to play music out loud. If your stereo system (amplifier) does not have Phono inputs set the Playback Switch to Line.

Playing a Record

It is recommended that you use extreme care when manipulating the tonearm, stylus, and other components of this turntable. These parts are very sensitive and can easily break or become damaged if they are carelessly handled.

1. Remove the shroud that protects the stylus and release the lock that holds the Tone Arm in place.
2. Use the Tone Arm Lift Switch to raise the Tone Arm from its catch.
3. Using your hand, gently swing the Tone Arm into the desired location over the record. The turntable will start spinning as the Tone Arm is moved into position.

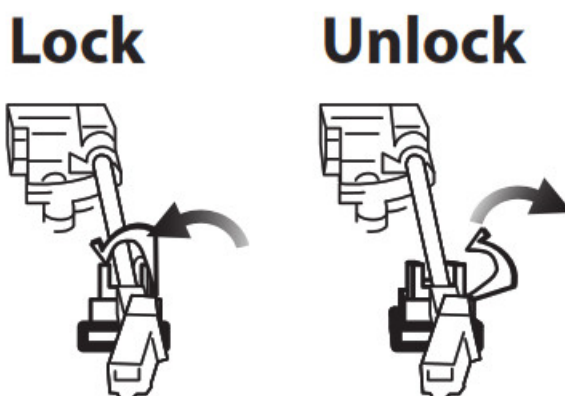

4. Use the Tone Arm Lift Switch to safely lower the stylus onto the record.
Using the Lift Switch instead of your hand will reduce the chance of accidentally damaging the record or the stylus.
5. When not in use, secure and lock the Tone Arm in its resting position and replace the protective shroud over the stylus. This will minimize the risk of accidental damage to these sensitive parts.

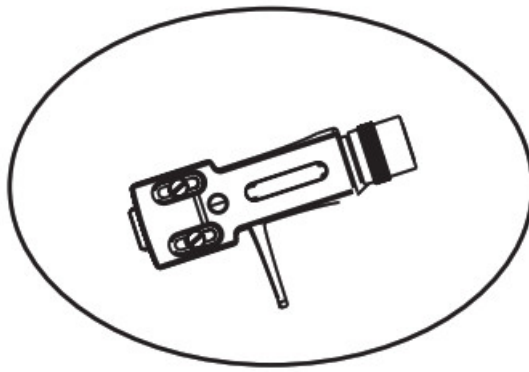

Stylus

Recording (USB)

Note: This unit can record playback from a record onto a USB drive to be saved via MP3 format. Please check to make sure Bluetooth is OFF.

1. Insert a USB drive into the rear of the unit.
2. Press the Recording button to begin recording the audio of the record being played. When recording the backlighting will turn red.
3. To pause recording, press the Rec. Stop button. The red backlighting will begin flashing slowly.
4. When the recording is finished or you want to stop it, press and hold the Recording button for 5 seconds, the red backlighting will turn off and the unit will exit recording mode.

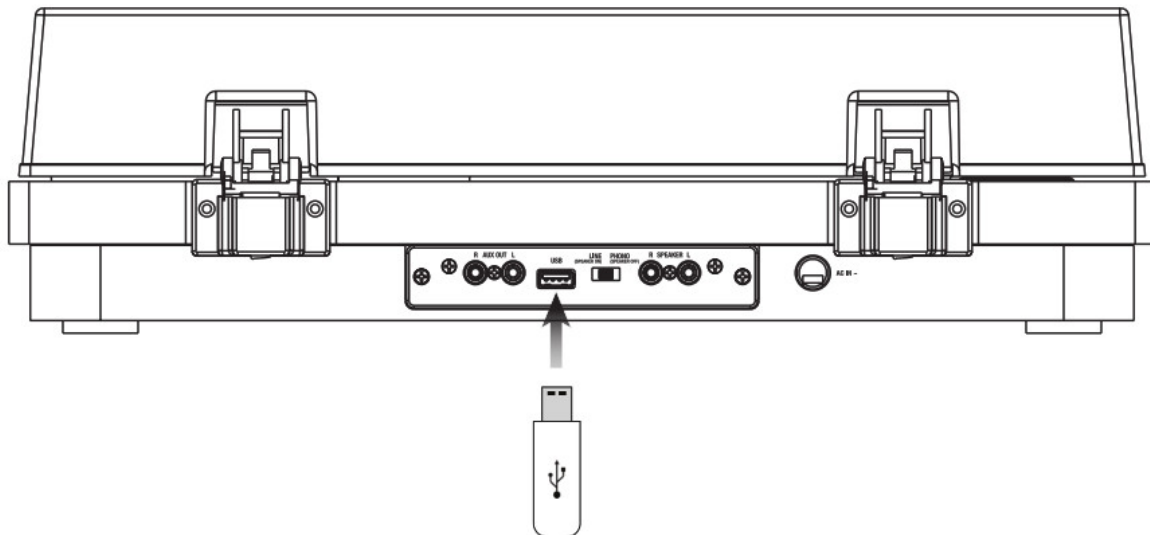

Customer Support

Contact Information

Website: www.iliveelectronics.com

Email Support: prodinfo@dpiinc.com

Email Parts: partsinfo@dpiinc.com

Phone Support: 1-888-999-4215

Warranty

For Warranty Information and the most up-to-date version of this User's Guide, go to: www.iliveelectronics.com

International Support

To download this User's Guide in English, Spanish, and French, or to get answers to frequently asked questions,

visit the support section at: www.iliveelectronics.com



Copyright © 2021 Digital Products International (DPI, Inc.). All other trademarks appearing herein are the property of their respective owners. Specifications are subject to change without notice.

Documents / Resources

 <small>Turntable with Bluetooth Transmitter</small>	iLIVE ITTB401DW Turntable with Bluetooth Transmitter [pdf] User Guide ITTB401DW, 2ATT8ITTB401DW, ITTB401DW, Turntable with Bluetooth Transmitter, Bluetooth Transmitter
---	--