



iLIVE IHB26B Wireless Speaker System with Subwoofer User Guide

[Home](#) » [iLive](#) » iLIVE IHB26B Wireless Speaker System with Subwoofer User Guide 



Wireless Speaker System with Subwoofer
User's Guide for Model IHB26B v1616-01

Contents

- [1 FCC WARNINGS](#)
- [2 ADDITIONAL WARNINGS](#)
- [3 Overview](#)
- [4 Power & Charging](#)
- [5 Connect Speakers](#)
- [6 Charge Devices](#)
- [7 Bluetooth Wireless Audio](#)
- [8 Aux In](#)
- [9 INTERNATIONAL SUPPORT](#)
- [10 Documents / Resources](#)
- [11 Related Posts](#)

FCC WARNINGS

Warning: Changes or modifications to this unit not expressly approved by the party responsible for compliance could void the user's authority to operate the equipment.

NOTE: This equipment has been tested and found to comply with the limits for a Class B digital device, pursuant to Part 15 of the FCC Rules. These limits are designed to provide reasonable protection against harmful interference in a residential installation. This equipment generates, uses, and can radiate radio frequency energy and, if not installed and used in accordance with the instructions, may cause harmful interference to radio communications. However, there is no guarantee that interference will not occur in a particular installation. If this equipment does cause harmful interference to radio or television reception, which can be determined by turning

the equipment off and on, the user is encouraged to try to correct the interference by one or more of the following measures:

- Reorient or relocate the receiving antenna.
- Increase the separation between the equipment and receiver.
- Connect the equipment into an outlet on a circuit different from that to which the receiver is connected.
- Consult the dealer or an experienced radio/TV technician for help.

ADDITIONAL WARNINGS

- **WARNING:** Changes or modifications to this unit not expressly approved by the party responsible for compliance could void the user's authority to operate the equipment.
- **WARNING:** Shock hazard – Do Not Open.
- Caution and marking information is located at the rear or bottom of the apparatus.
- The mains plug is used as a disconnect device and it should remain readily operable during intended use. In order to disconnect the apparatus from the mains completely, the mains plug should be disconnected from the mains socket outlet completely.
- **CAUTION: TO PREVENT ELECTRIC SHOCK, MATCH WIDE BLADE OF PLUG TO WIDE SLOT, FULLY INSERT.**
- Objects filled with liquids, such as vases, shall not be placed on the apparatus
- **WARNING:** Do not place this unit directly onto furniture surfaces with any type of soft, porous, or sensitive finish. As with any rubber compound made with oils, the feet could cause marks or staining where the feet reside. We recommend using a protective barrier such as a cloth or a piece of glass between the unit and the surface to reduce the risk of damage and/or staining.
- **WARNING:** This product may contain chemicals known to the State of California to cause birth defects, or other reproductive harm (California Prop 65). Wash hands after handling.
- This product meets and complies with all Federal regulations.

Overview

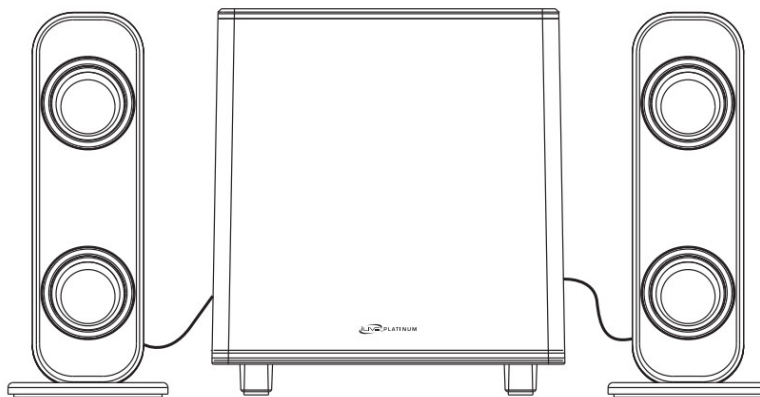

Features

- 2.1 channel stereo sound · Built-in amplifier
- 3 speakers: left, right, and subwoofer
- LED light effects

- Supports Bluetooth
- Bluetooth Wireless range: 60 ft
- Analog volume control
- Bass and Treble controls
- Aux In 3.5 mm audio input
- USB port for device charging
- AC power: built-in AC power cable

Includes

- 3.5mm audio cable
- User's guide

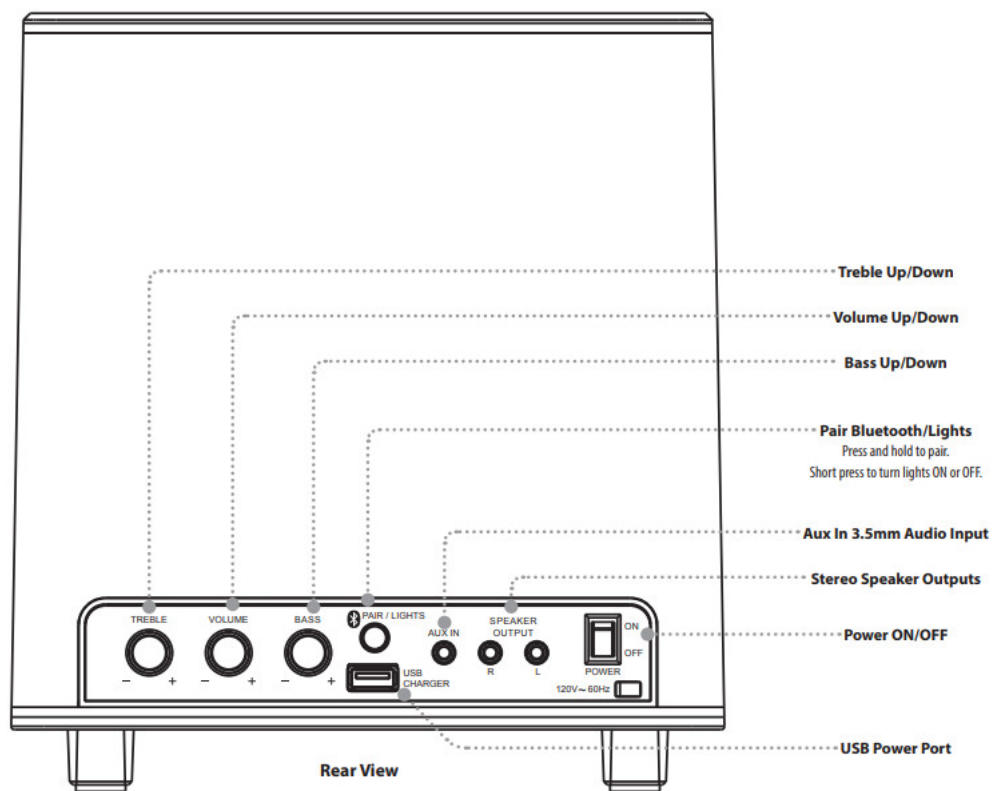

Power & Charging

Connect the power plug to a standard power outlet.

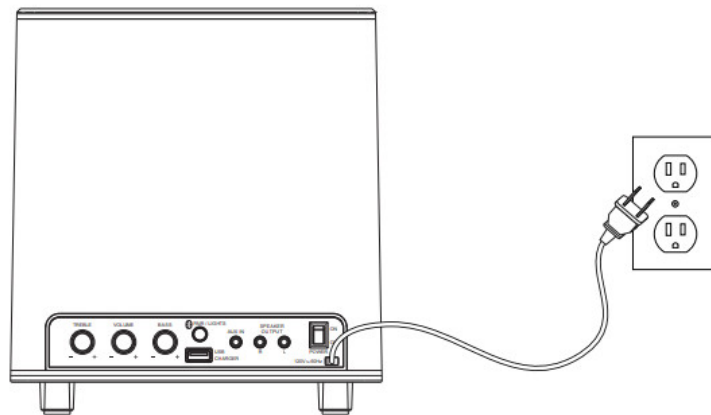

Connect Speakers

Connect the left and right speaker cables to the left and right **audio outputs** on the subwoofer.

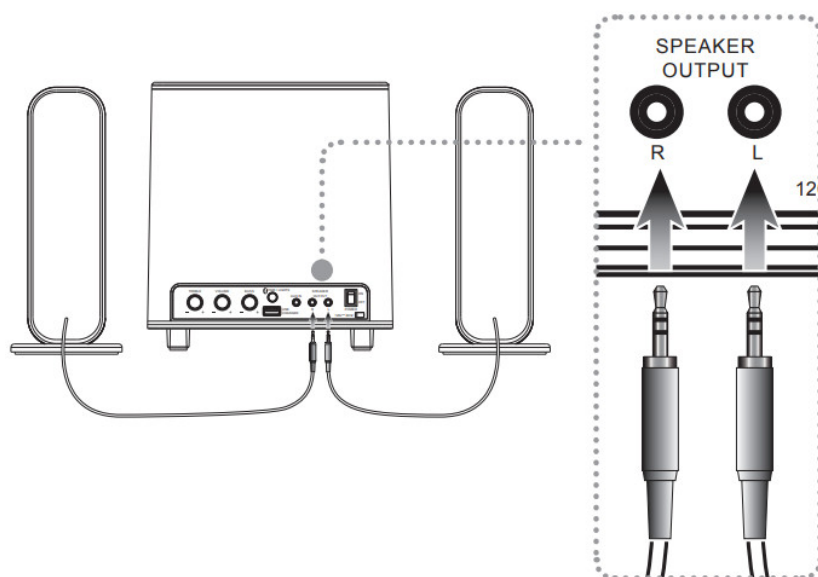

Charge Devices

Using an appropriate USB power cable (not included), connect your device to the **USB Power Port** on the rear of the subwoofer.

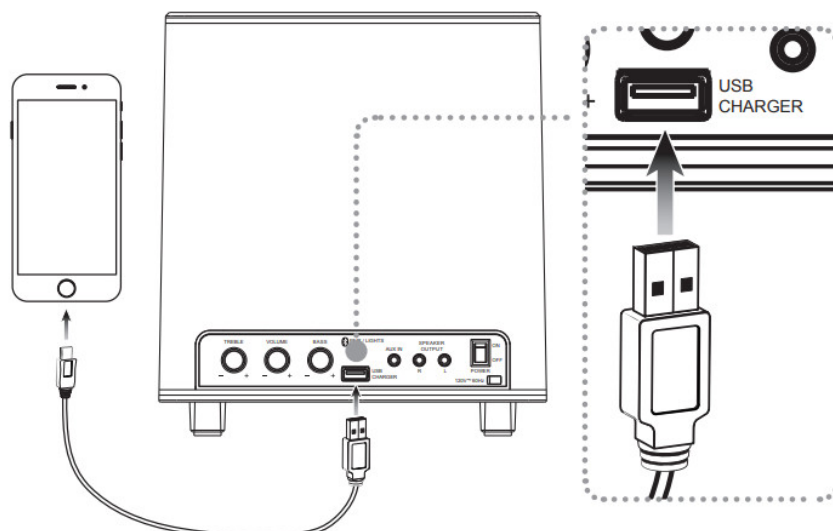

Bluetooth Wireless Audio

Pairing to a Device & Playing Audio

After the initial pairing, the unit will stay paired unless unpaired manually by the user or erased due to a reset of the device. If your device should become unpaired or you find it is unable to connect, repeat the steps listed here.

1. Power ON the unit and press and hold the **Pair button** to begin pairing. The LED lights will begin flashing quickly. The lights will always flash during the pairing process, even if they are set to OFF. Once the pairing process is complete, the lights will return to OFF. When pairing, remain within 3 feet of the unit.
2. Using the controls on your Bluetooth device, search for and select **IHB26** in your Bluetooth settings to pair. If your device requests a password, enter the default password **0 0 0 0**. Refer to the user's manual for your specific device for instructions on pairing and connecting Bluetooth devices.
3. When successfully paired, the **LED lights** will turn solid and an audible chime will sound from the speaker. Use the controls on the connected device to select audio, play, pause, skip, and adjust the volume.

Aux In

Requires a 3.5mm audio cable (included).

1. Connect a 3.5mm audio cable to the Aux In **Input** on the unit and the **audio** output on an audio device.
2. Use the controls on the connected device to select audio, play, pause, skip, and adjust the volume.

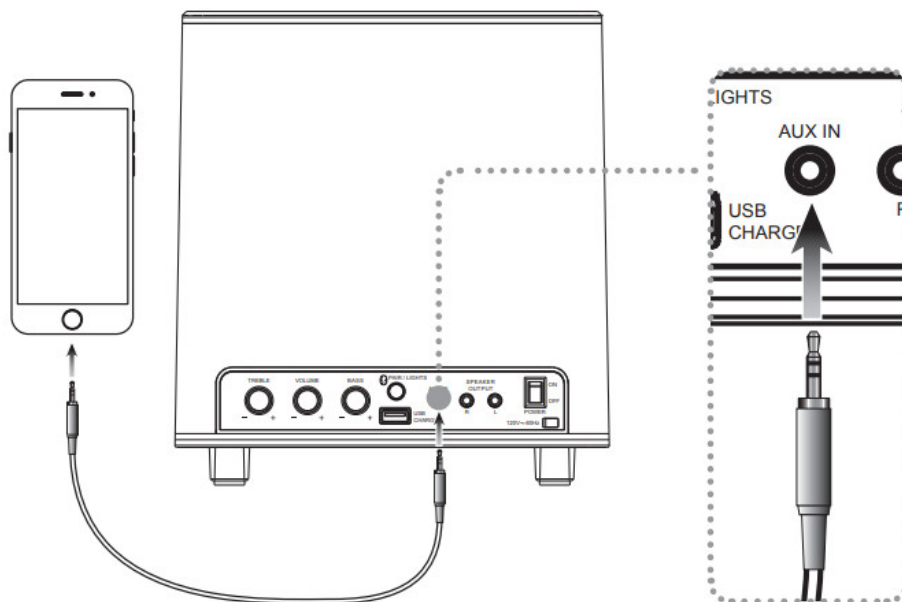

INTERNATIONAL SUPPORT

To download this User's Guide in English, Spanish, or French, or to get answers to frequently asked questions, visit the support section at: www.iLiveElectronics.com

For Warranty Information and the most up-to-date version of this User's Guide, go to www.iLiveElectronics.com

Customer Service: 1-888-999-4215
Email Support: prodinfo@dpiinc.com
Email Parts: partsinfo@dpiinc.com

Copyright © 2016 Digital Products International (DPI, Inc.)
All other trademarks appearing herein are the property of their respective owners.
Specifications are subject to change without notice.



Documents / Resources

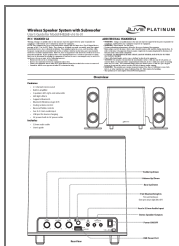

[iLIVE IHB26B Wireless Speaker System with Subwoofer](#) [pdf] User Guide
IHB26B, Wireless Speaker System with Subwoofer, IHB26B Wireless Speaker System with Subwoofer, Speaker System with Subwoofer, Subwoofer Speaker

[Manuals+](#)