



ilight Plexineon Vertical Catenary Static Color Installation Guide

[Home](#) » [ILIGHT](#) » [ilight Plexineon Vertical Catenary Static Color Installation Guide](#) 

Contents

- [1 ilight Plexineon Vertical Catenary Static Color](#)
- [2 INSTALLATION INSTRUCTION](#)
- [3 WIRING](#)
- [4 Documents / Resources](#)
 - [4.1 References](#)
- [5 Related Posts](#)



ilight Plexineon Vertical Catenary Static Color



INSTALLATION INSTRUCTION

Please read all instructions prior to installation and keep for future reference!

1. PRODUCT TO BE INSTALLED BY A QUALIFIED ELECTRICIAN.
2. USE ONLY WITH CLASS 2 POWER UNIT
3. 24 VOLTS DC
4. SUITABLE FOR WET LOCATIONS
5. CATENARY MOUNT ONLY

NOTE: Prior to installation all 24VDC wires must be present within 72" of the installation. Refer to the power supply installation instruction for additional information.

NOTE: More than one person is recommended for this installation.

1. For multi-piece frames, connect the frame members together with mounting frame joiner. Use locknuts to secure connection.

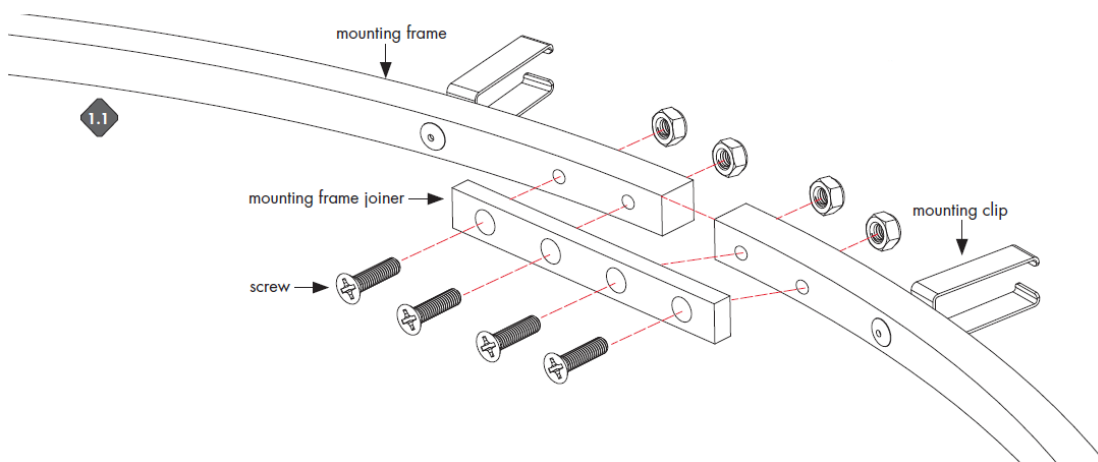

2. Install plexiglass fixture to mounting clips on mounting frame(s).

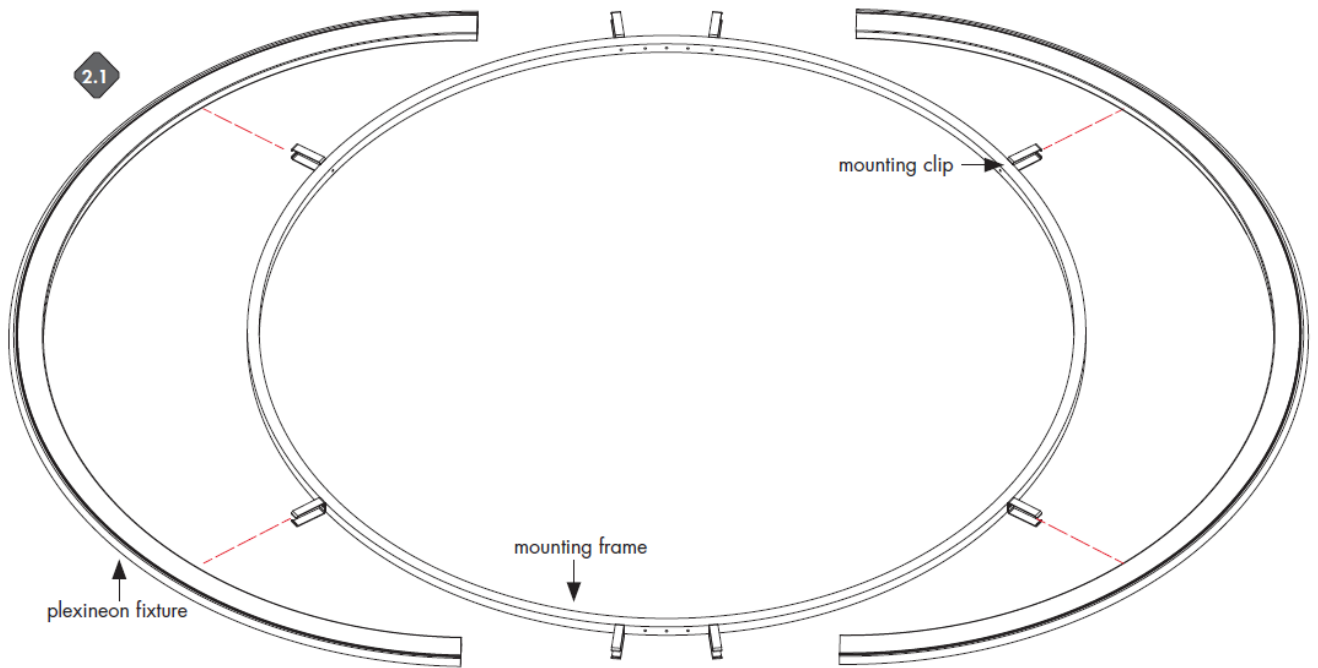

Install Fixtures into Mounting Clips

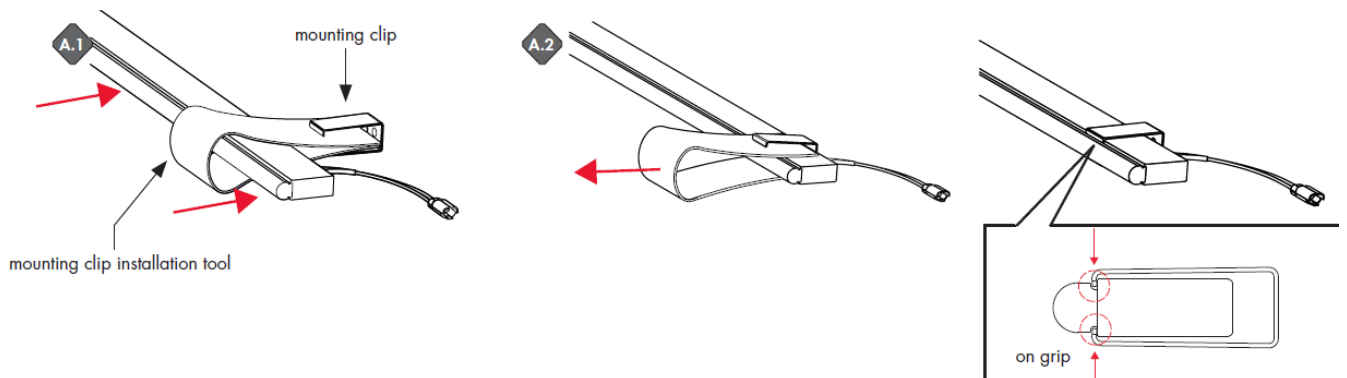

1. Make an U shape with mounting clip installation tool, insert two edges into mounting clip. Place plexineon fixture inside the shape. Then push the fixture into clip.
2. Remove the tool. Make sure mounting clip is clipped right on the grip.
3. Remove screw, u-bolt, saddle, and locknut from collar.

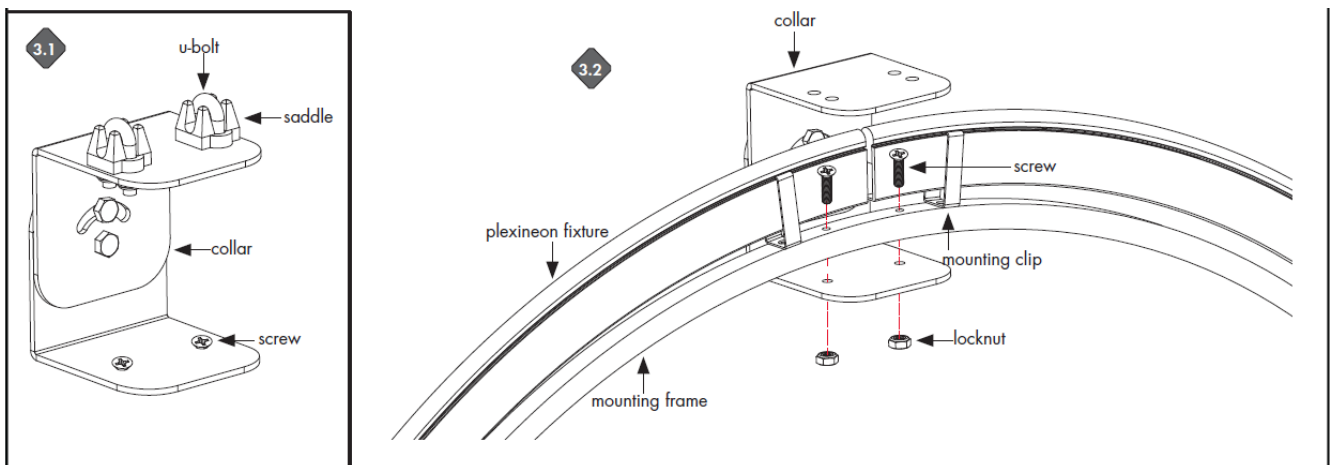

- Connect collar with mounting frame by screws. Use locknut to secure collar
4. Place the catenary cable between the saddle and u-bolt. Use locknuts to clamp the catenary cable between the saddle and u-bolt.

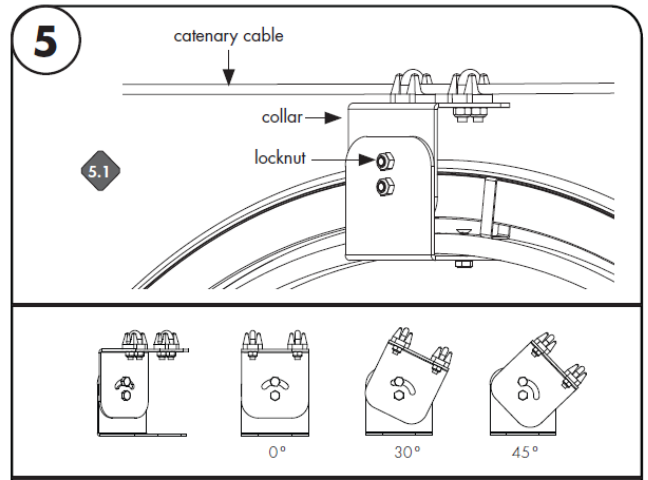
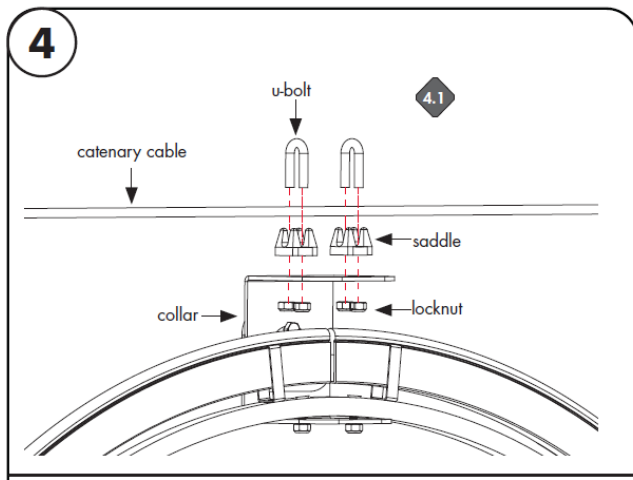

5. Loosen the top locknut on back of the collar to adjust the angle of plexineon fixture.

WIRING

1. Connect +24 VDC strip color from the Plexineon to the power supply +24 VDC red wire. Connect -24 VDC solid color wire from the Plexineon to power supply -24 VDC black wire.

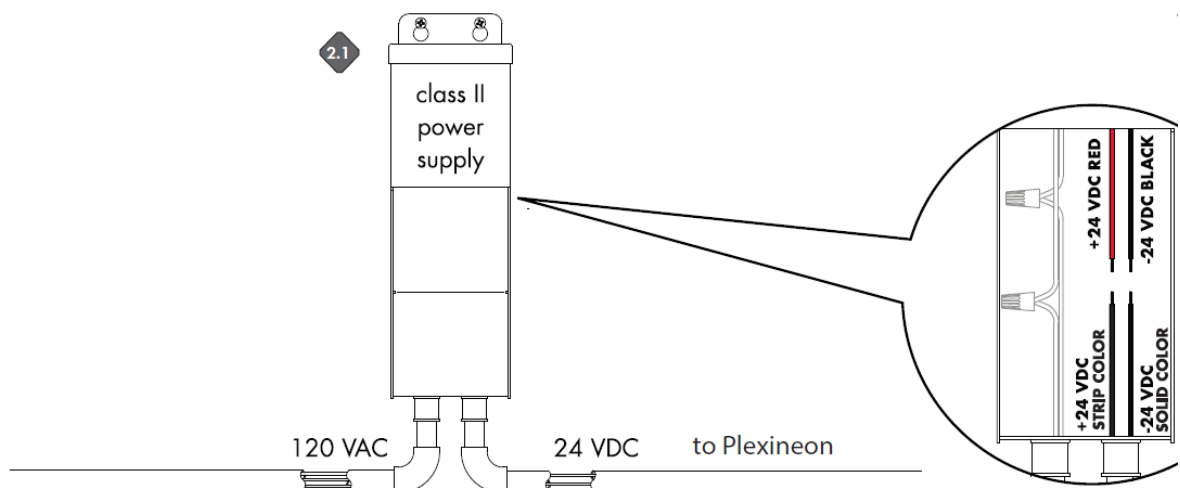

Multiple Fixtures

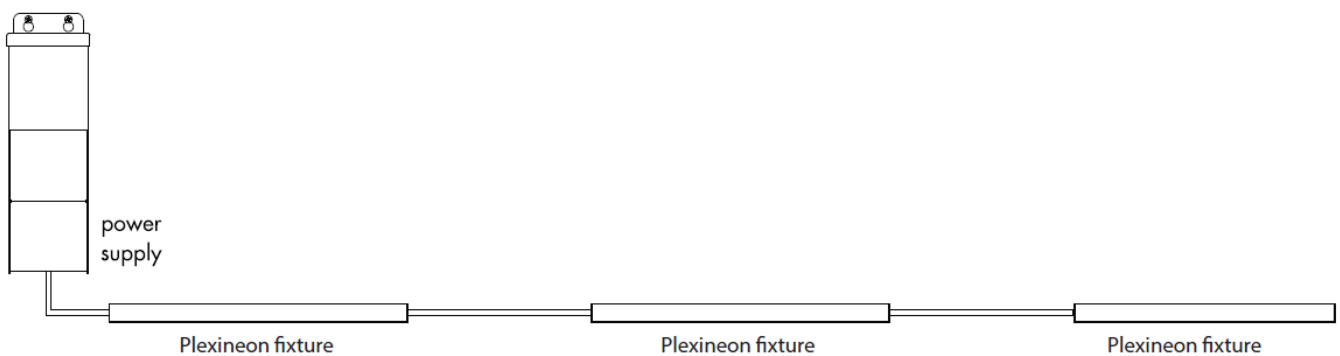

7777 Merrimac Ave

Niles, IL 60714

T 224.333.6033

F 224.757.7557

Documents / Resources

| | |
|---|--|
|  | <p>ilight Plexineon Vertical Catenary Static Color [pdf] Installation Guide Plexineon Vertical Catenary Static Color, Plexineon Static Color, Vertical Catenary Static Color, Catenary Static Color, Vertical Catenary</p> |
|---|--|

References

-  [Home - Luminii](#)