

ilight Plexineon Suspended Dynamic Color Installation Guide

[Home](#) » [ILIGHT](#) » ilight Plexineon Suspended Dynamic Color Installation Guide 

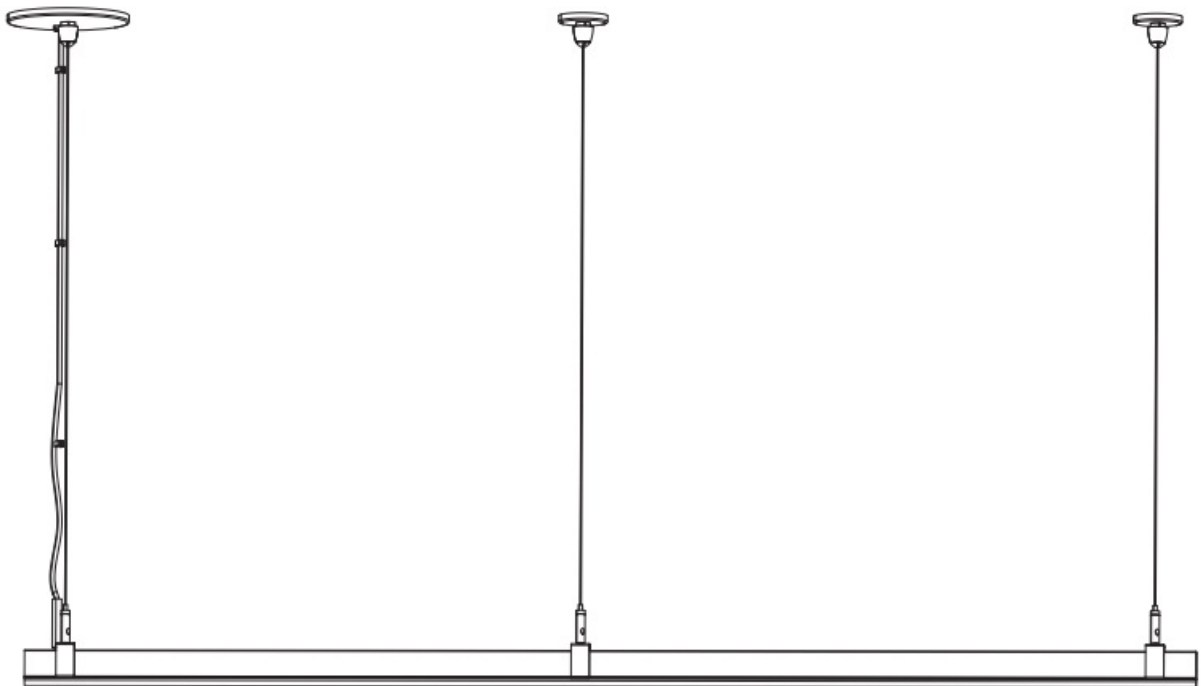

Plexineon Suspended Dynamic Color Installation Guide



Plexineon Straight Run Fixture



REV0.1
10252022

Contents

- [1 Plexineon Suspended Dynamic Color](#)
- [2 Install Fixtures into Mounting Clips](#)
- [3 RGB&RGBW WIRING DIAGRAM](#)
- [4 OPERATING GUIDE](#)
- [5 PROGRAM TABLE](#)
- [6 Documents / Resources](#)
 - [6.1 References](#)
- [7 Related Posts](#)

Plexineon Suspended Dynamic Color

Installation Instructions – Plexineon Suspended Dynamic Color

Models: Plexineon Suspended Mount Dynamic Color and Plexineon Rings Suspended Mount Dynamic Color
Please read all instructions prior to installation and keep for future reference!

1. PRODUCT TO BE INSTALLED BY A QUALIFIED ELECTRICIAN.
2. USE ONLY WITH CLASS 2 POWER UNIT
3. 24 VOLTS DC
4. SUITABLE FOR WET LOCATIONS
5. SUSPENDED MOUNT ONLY

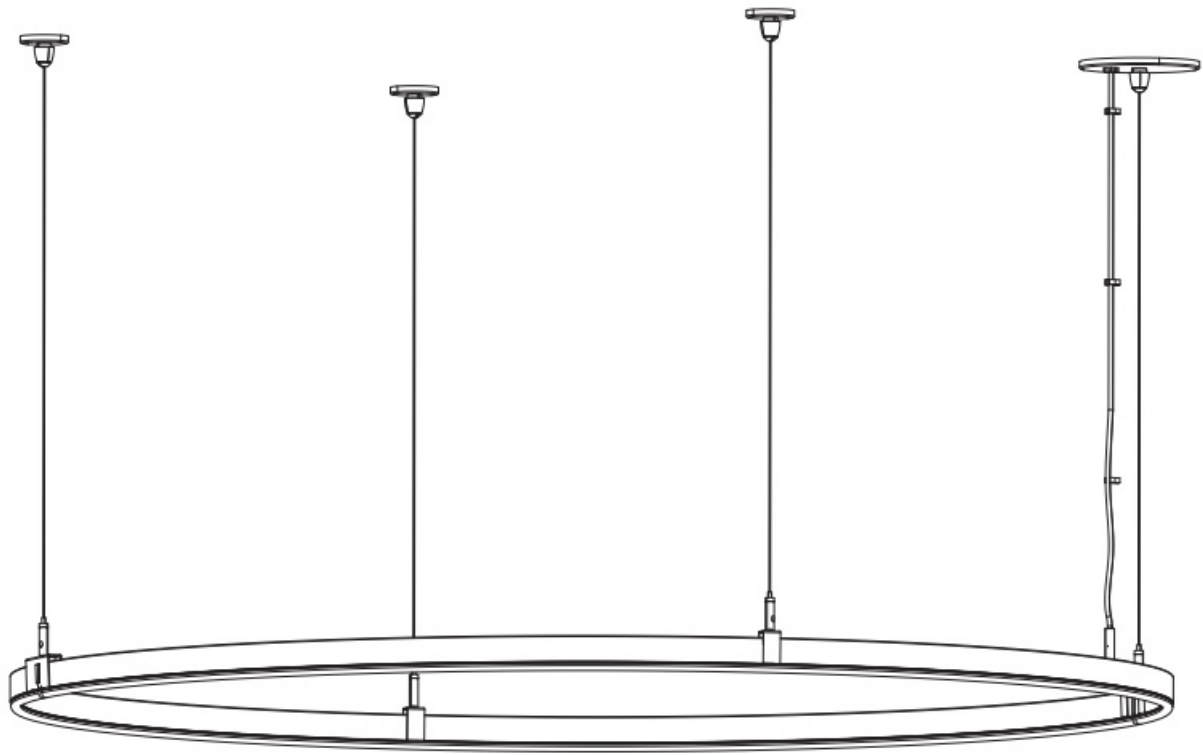

Plexineon Ring Surface Mount

*LUMINII RESERVES THE RIGHTS TO CHANGE SPECIFICATION & INSTRUCTION WITHOUT NOTICE

Models: Plexineon Suspended Mount Dynamic Color and Plexineon Rings Suspended Mount Dynamic Color
Please read all instructions prior to installation and keep for future reference!

1. PRODUCT TO BE INSTALLED BY A QUALIFIED ELECTRICIAN.
2. USE ONLY WITH CLASS 2 POWER UNIT
3. 24 VOLTS DC
4. SUITABLE FOR WET LOCATIONS
5. SUSPENDED MOUNT ONLY

NOTE: Prior to installation all 24VDC wires must be present within 72" of the installation. Refer to the power supply installation instruction for additional information.

NOTE: More than one person is recommended for this installation.

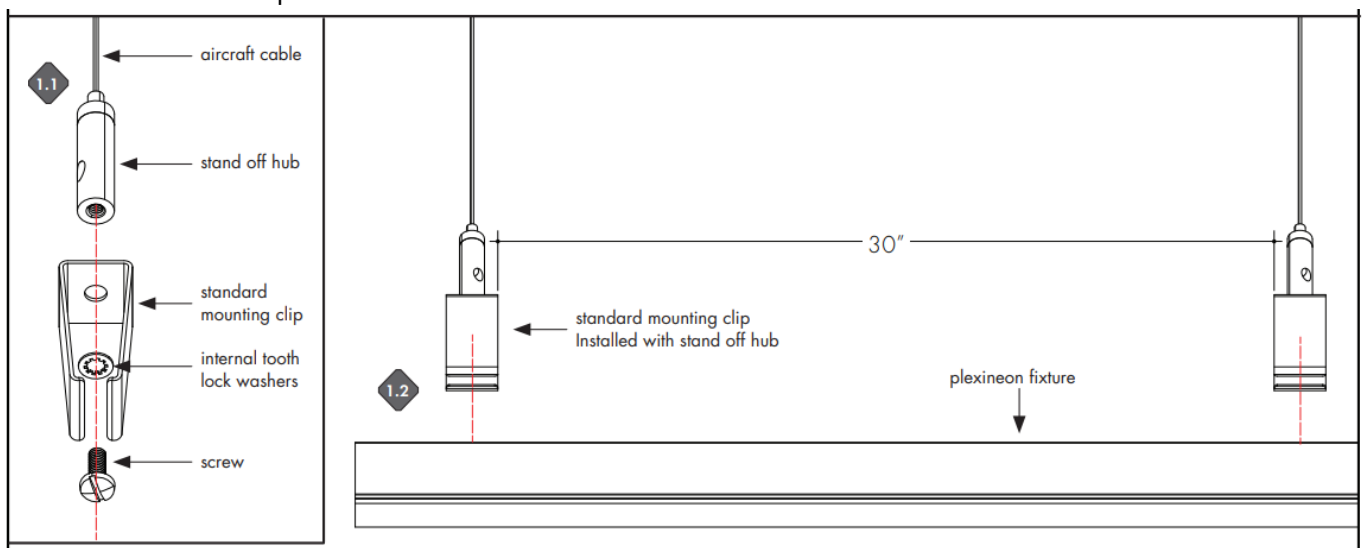

1.1 Screw mounting clip to stand off hub.

1.2 Fix the plexineon fixture into installed mounting clips. See step A for clipping instructions. Make sure mounting

clips are certain distance apart.

NOTE: Standard Clips and Decorative Clips have different required spacing.

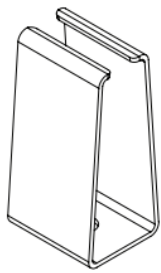

← standard mounting clip
30" space



← decorative mounting clip
18" space

Install Fixtures into Mounting Clips

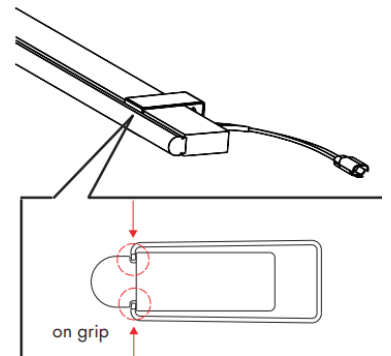
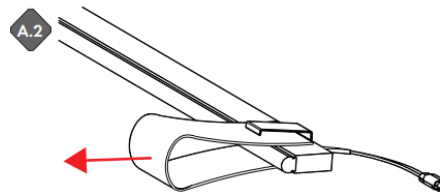
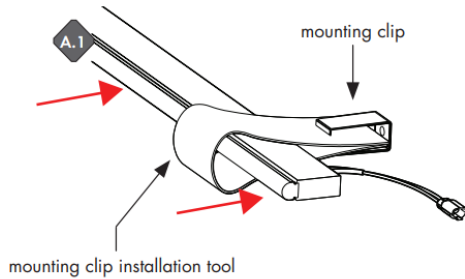

A.1 Make an U shape with mounting clip installation tool, insert two edges into mounting clip. Place plexineon fixture inside the shape. Then push the fixture into clip.

A.2 Remove the tool. Make sure mounting clip is clipped right on the grip.

2

ceiling

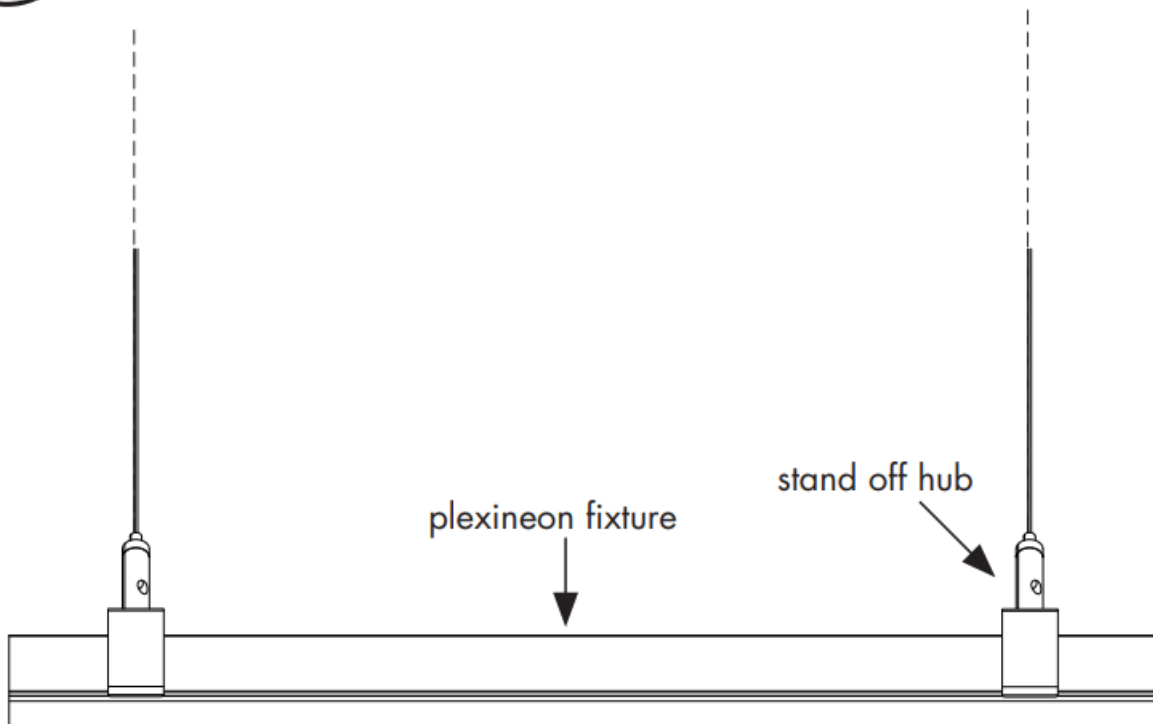

NOTE: Prior to installation all 24VDC wires must be present in junction box. Refer to the power supply installation instruction for additional information.

2.1 Align one standoff hub to the junction box and mark the other hubs' location to the ceiling.

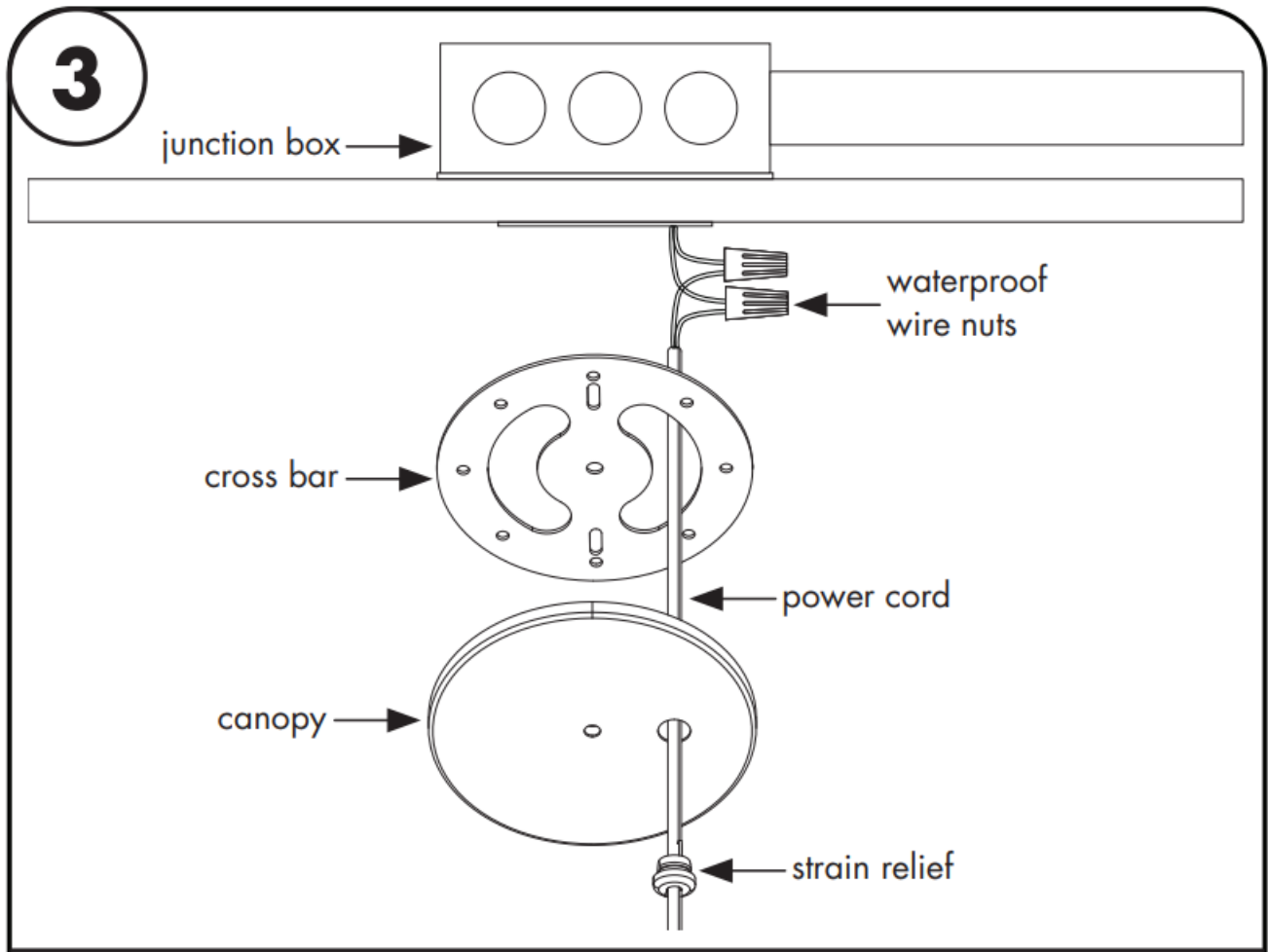

3.1 Slide power cord end through strain relief, canopy, and cross bar.

Peel back power cord to expose wires. Connect power supply wires to fixture wires. Waterproof wire nuts recommended in this step.

NOTE: Prior to wiring the desired fixture height must be determined to cut off any unnecessary wire.

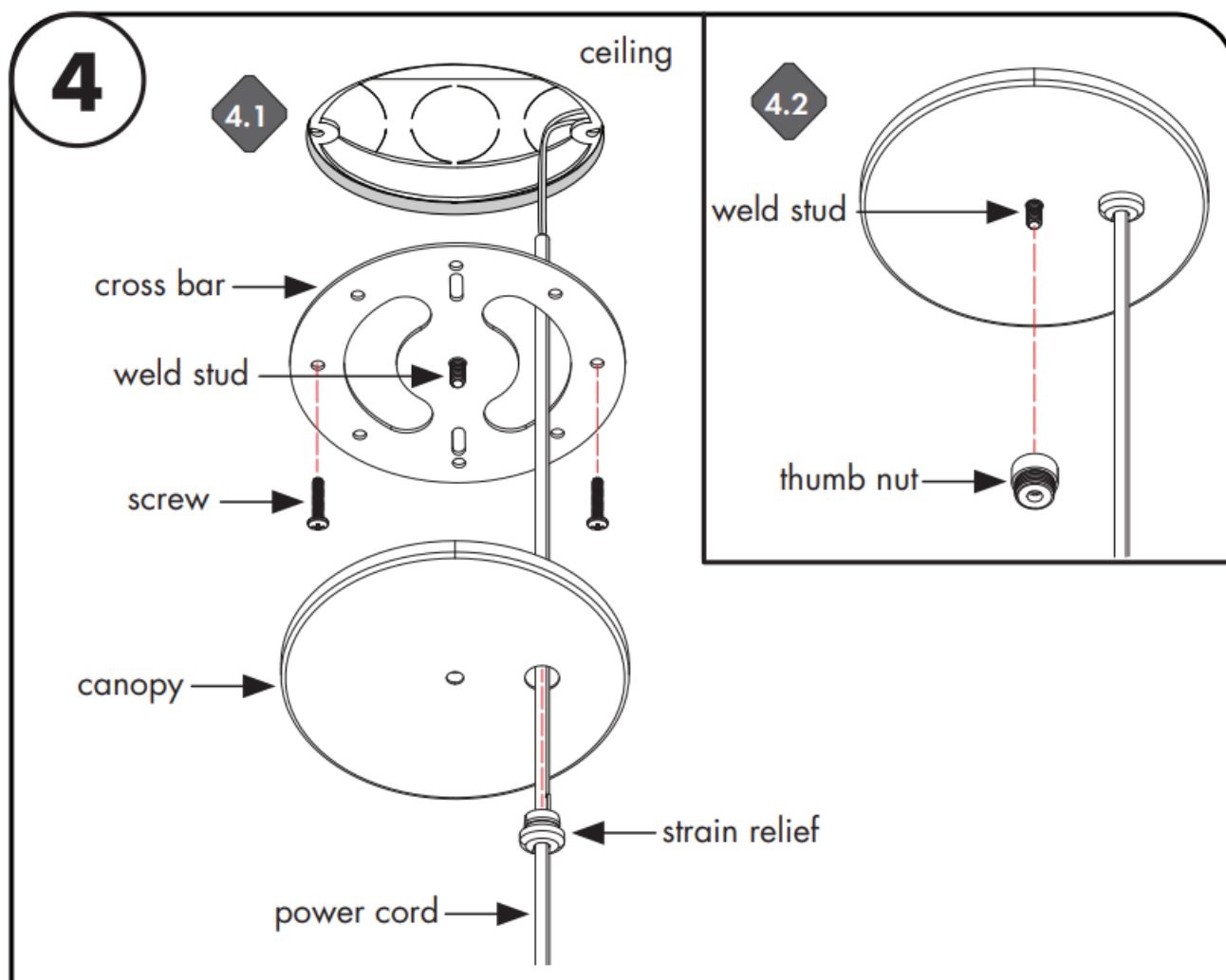

4.1 Insert wire nut and extra wire into junction box. Slide weld stud into the center hole of cross bar. Screw cross bar into junction box holes or the ceiling.

4.2 Slide canopy up to the cross bar and secure by tightening the thumb nut to weld stud.

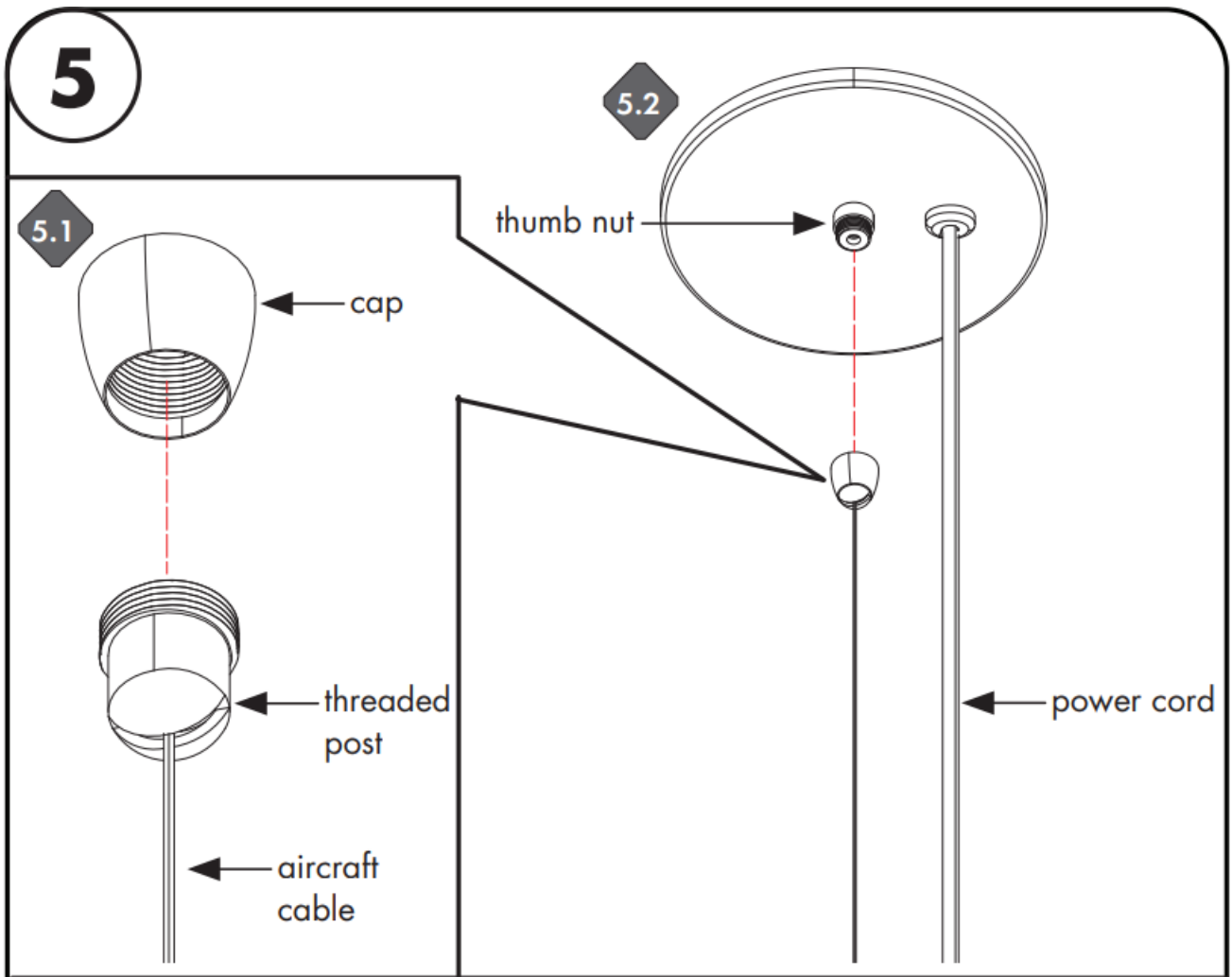

5.1 Screw cap to threaded post with aircraft cable.

5.2 Fix the aircraft cable into thumbnut, secure by tightening by hand.

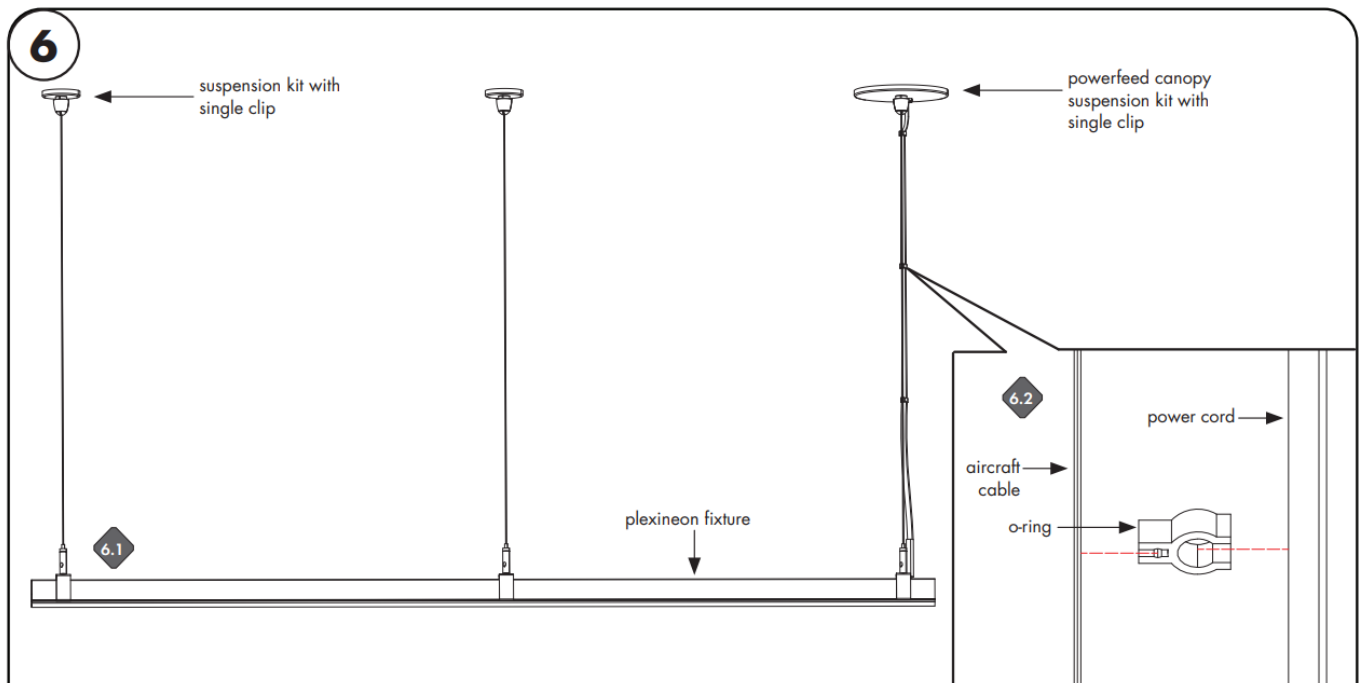

6.1 Install the rest of other canopies by similar method.

6.2 If necessary, make any final adjustment to power cord using o-ring.

RGB&RGBW WIRING DIAGRAM

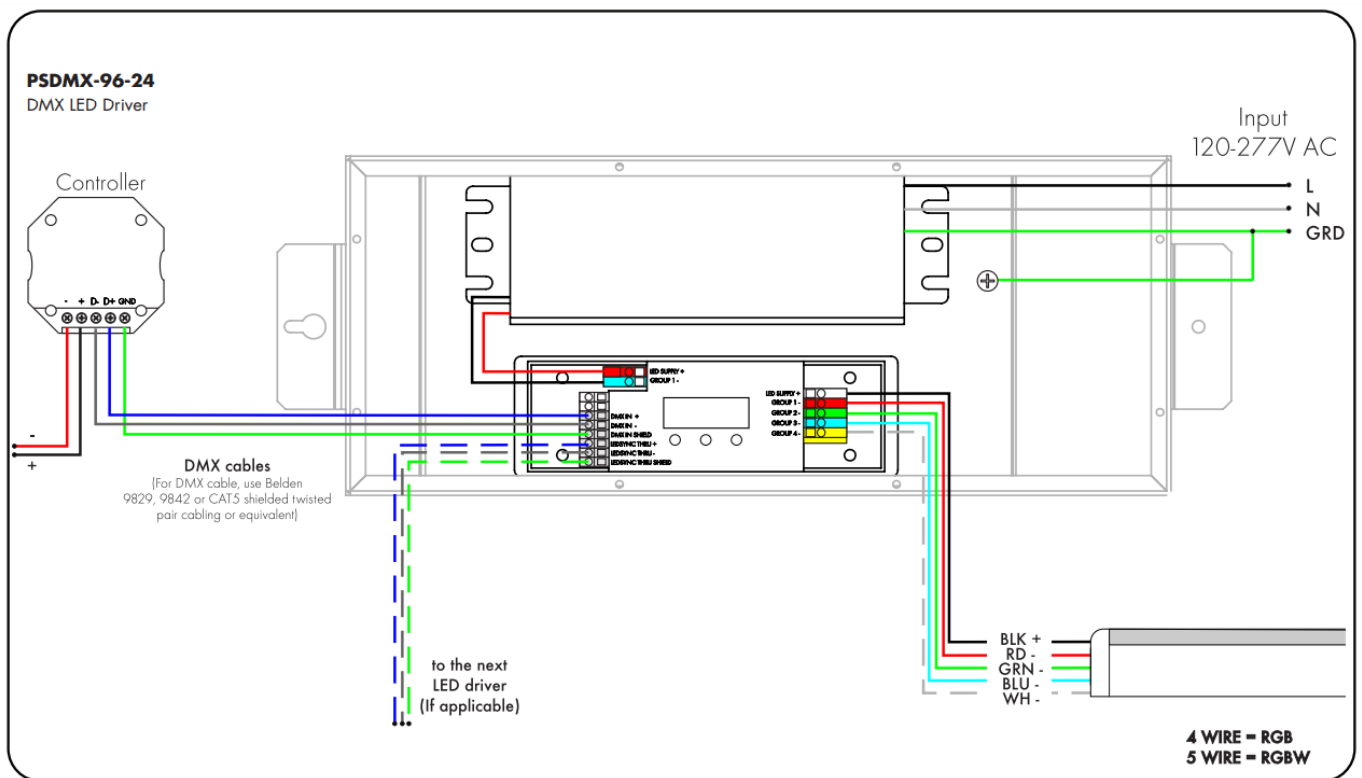

WIRING DIAGRAM

SR-DMX-SPI

Smart Pixel LineLED Decoder

NOTE: Please make sure that power is turned off before wiring. Also, ensure that the correct powersupply (voltage and wattage) is used to power the LED strips connected to the decoder. Follow illustrated wiring diagram. Use screwdriver to open and close connection slots.

NOTE: When connecting two or more LED strip lights or light fixtures, always make sure the signal direction arrows are pointing to same direction

The signal direction arrow should appear on label of each section of LED fixture.

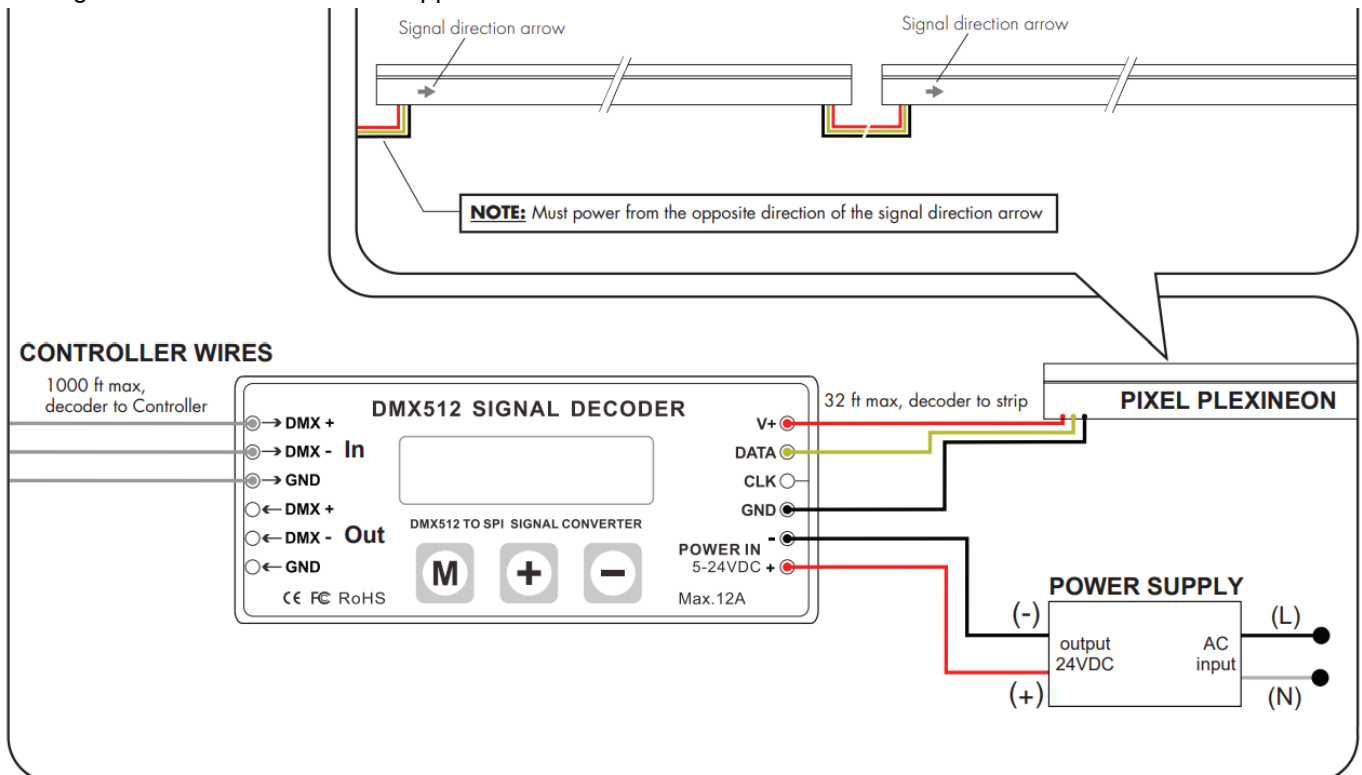

OPERATING GUIDE

SR-DMX-SPI

Smart Pixel LineLED Decoder

There are three buttons on the decoder



Parameter Setting



Increase Value



Decrease Value

After operation, if no action was taken within 30s, the button lock, and backlight of the screen will turn off.

1. Long press M button for 5s to unlock the buttons, and the backlight will turn on.
2. Long press M button for 5s to switch between test mode and decode mode after unlocked.

During test mode, the first line of LCD will show: TEST MODE. Use test mode to verify RGBW Pixel functionality. During decoder mode, the first line of LCD shows: DECODER MODE. Use decoder mode when connecting to a Controller and for final installation and customization.

The second line of the LCD Display shows the current setting and value. Note: 1 Pixel = 1 Cut Increment MODE TABLE

SETTING	LCD DISPLAY	VALUE RANGE	DESCRIPTION
Built-in Programs	hATENDIEsAX:	1-26	See Program Table below
Program Speed	TEST MODE RUN SPEED:	0-7	0: fast, 7: slow
DMX Address	DECODER MODE DMX ADDRESS:	1-512	Address of the starting point/Pixel of a program
DMX Signal RGB	DEE)C01:11RBAOS E MX	RGB, BGR, etc.	N/A
Pixel Quantity	DECODER MODE PIXEL QTY:	1-170(RGB), 1-1 28 (RGBW)	Number of Pixels to follow a program
IC TYPE	DECODER MODE IC TYPE:	2903, 8903, 2904, 8904	2903: N/A, 2904: for RUM, 8903: N/A, 8904: N/A
Color	DECODER MODE COLOR:	MONO, DUAL, RGB, RGBW	MONO: N/A, DUAL: N/A, RGB: N/A, RGBW: for RGBW
Pixel Merging / Pixel Size	DECODER MODE PIXEL MERGE:	1-100	Number of Pixels to merge together
RGB Sequence	DECODER MODE LED RGB SEQ:	RGBW, BGRW etc.	Sequence of RUM, 24 possible combinations
Integral Control	DECODER MODE ALL CONTROL:	YES, NO	Yes: Merge all Pixels No: Maintain individual Pixels or Merged Pixels
Reverse Control	DECODER MODE REV-CONTROL:	YES, NO	Reverse program order
Overall Brightness	DECODER MODE BRIGHTNESS:	1-100	1: dimmest setting 100: brightest setting

NOTE: When connected to a controller, DMX512 Signal Decoder will stay in “Decoder Mode”.

NOTE: The actual maximum control pixels of the controller are 1360 (2903) ,1024 (2904).

Please set the pixel and pixel combination value according to the actual situation, and DO NOT exceed the maximum.

NOTE: For Program Table

Change: no fading/dimming between color changes

Fade: fade/dim between color changes

Chase: change pixel by pixel

Chase with Trail: change pixel by pixel with fading between

PROGRAM TABLE

PROGRAM NO.	PROGRAM DESCRIPTION
1	Solid color: Red
2	Solid color: Green
3	Solid color: Blue
4	Solid color: Yellow
5	Solid color: Purple
6	Solid color: Cyan
7	Solid color: White
8	RGB change
9	Full color change
10	RGB fading
11	Full color fading
12	Red chase with trail
13	Green chase with trail
14	Blue chase with trail
15	White chase with trail
16	RGB chase with trail
17	Rainbow chase with trail
18	RGB chasing and fading
19	Red chasing green, chasing blue
20	Orange chasing purple, chasing cyan
21	Rainbow chase (7 colors)
22	Random twinkle: white over red
23	Random twinkle: white over green
24	Random twinkle: white over blue
25	White fading
26	Off

*LUMINII RESERVES THE RIGHTS TO CHANGE SPECIFICATION & INSTRUCTION WITHOUT NOTICE



7777 Merrimac Ave

Niles, IL 60714

T 224.333.6033

F 224.757.7557

info@luminii.com

www.luminii.com

Documents / Resources

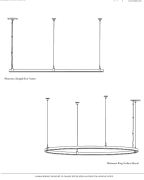
 A technical diagram showing the installation of the 'ilight Plexineon Suspended Dynamic Color' fixture. It includes a side view and a top-down view of the fixture suspended from a ceiling by three vertical rods. The diagram is labeled with 'Plexineon Suspended Dynamic Color' and 'ilight by luminii'.	<p>ilight Plexineon Suspended Dynamic Color [pdf] Installation Guide</p> <p>Plexineon Suspended Dynamic Color, Plexineon, Plexineon Dynamic Color, Suspended Dynamic Color, Dynamic Color, Plexineon Suspended Mount Dynamic Color, Plexineon Rings Suspended Mount Dynamic Color</p>
--	---

References

-  [Home - Luminii](#)

Manuals+.