

# ilight Plexineon Recessed Static Color Instruction Manual

[Home](#) » [ILIGHT](#) » ilight Plexineon Recessed Static Color Instruction Manual 

## ilight Plexineon Recessed Static Color Instruction Manual

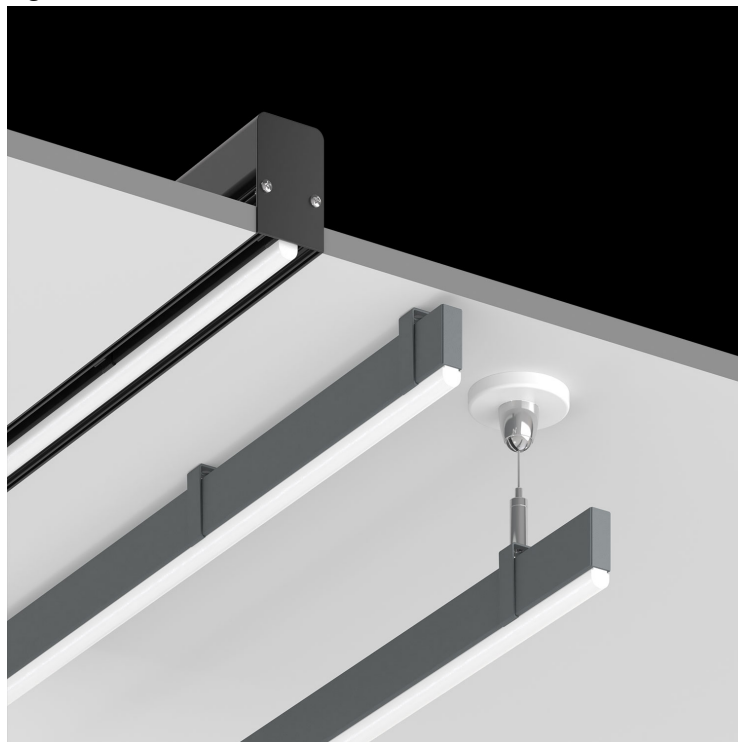

1. PRODUCT TO BE INSTALLED BY A QUALIFIED ELECTRICIAN.
2. USE ONLY WITH CLASS 2 POWER UNIT
3. 24 VOLTS DC
4. SUITABLE FOR WET LOCATIONS
5. RECESSED MOUNT ONLY

## Contents

### 1 Assembly Instructions

### 2 Documents / Resources

#### 2.1 References

### 3 Related Posts

## Assembly Instructions

**NOTE:** Prior to installation all 24VDC wires must be present within 72" of the installation. Refer to the power supply installation instruction for additional information.

**NOTE:** More than one person is recommended for this installation

### 1. Screw end plate onto extrusion housing

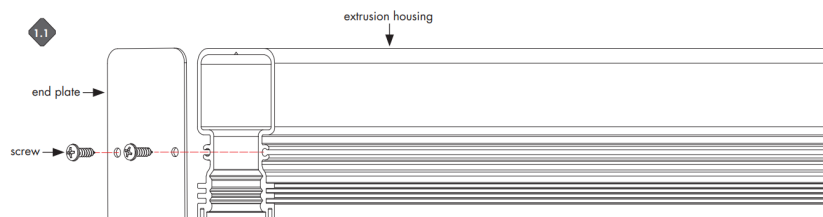

### 2. If more than one extrusion housing, use two alignment pins to connect both side of the extrusion

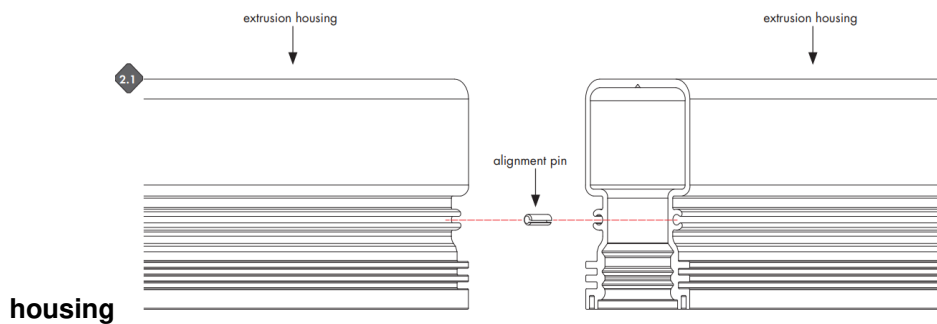

## INSTALLATION OPTIONS

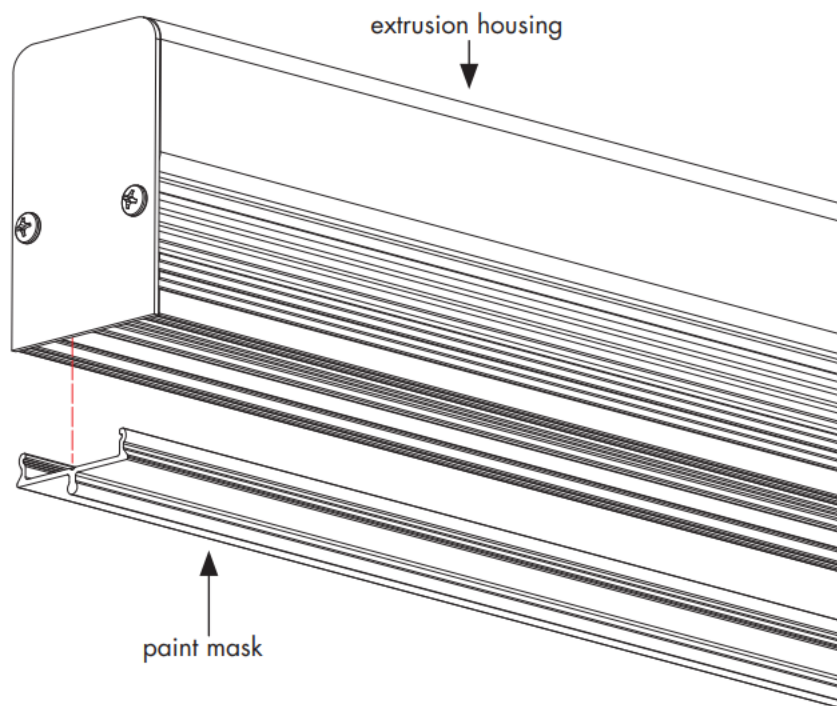

**NOTE:** Use paint mask to protect extrusion housing when doing a surface/ wall finishing. Install plexiglass fixtures after removing paint mask.

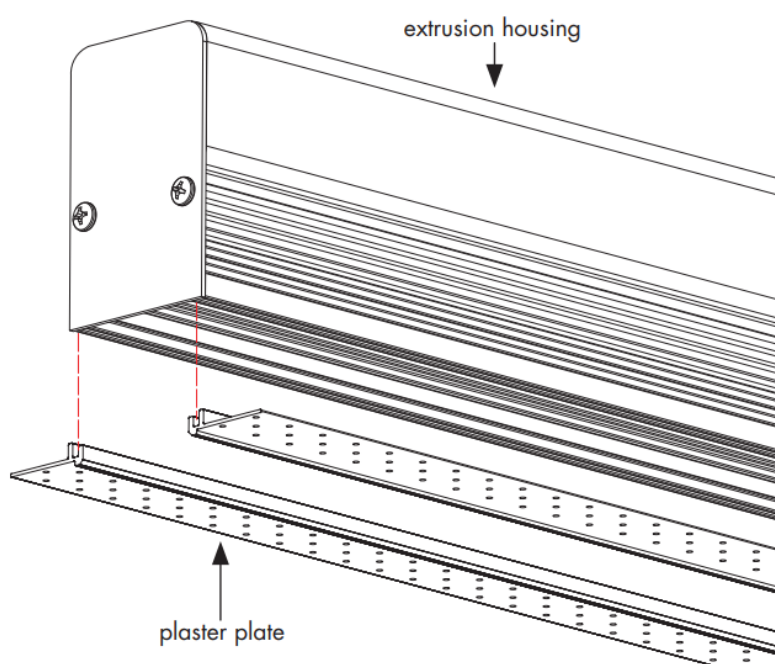

**NOTE:** Use plaster plate when doing a mud-in installation. Use paint mask to protect extrusion housing during surface/wall finishing.

### Wood Blocking Installation

**NOTE:** Blocks are provided by other.

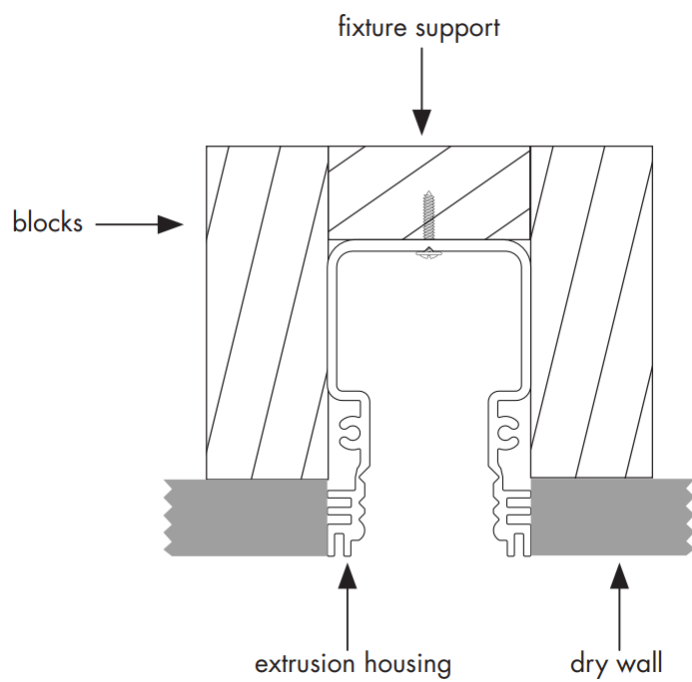

### Mud-in Installation

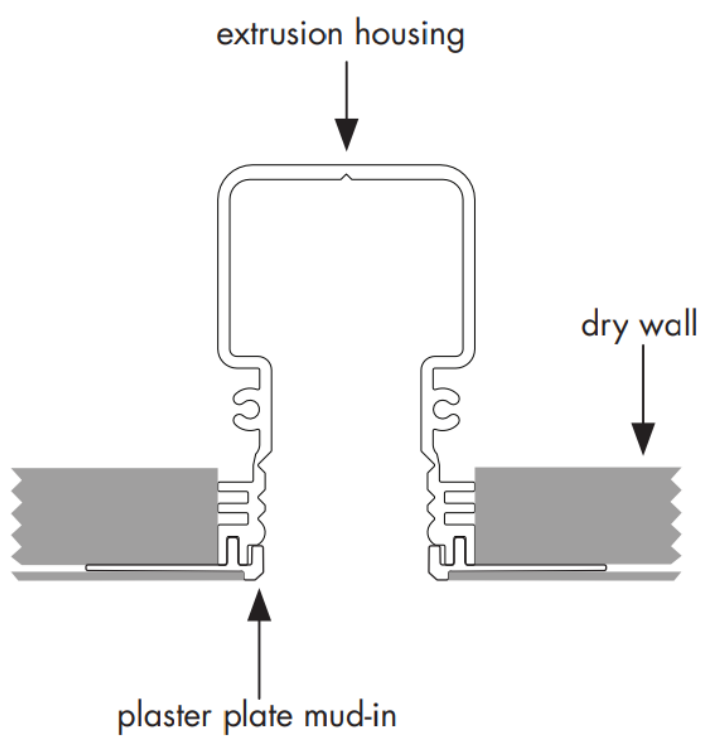

**Drill or punch Ø 5/8" hole into extrusion housing.  
Clamp powerfeed strain relief to wire**

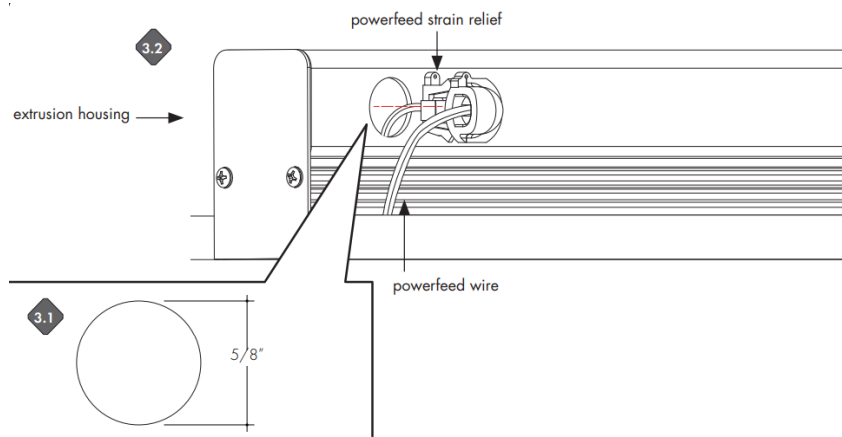

**Snap powerfeed strain relief into hole**

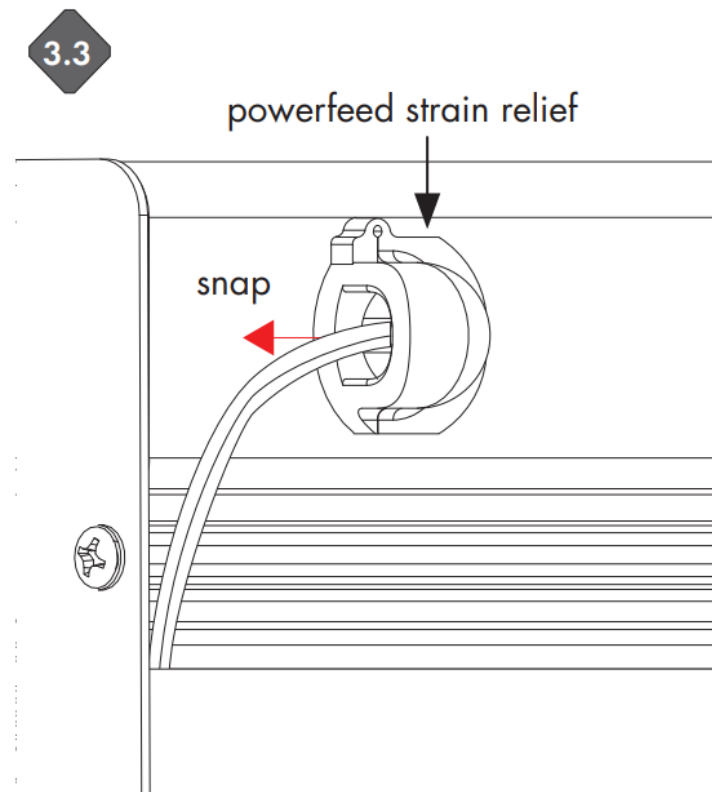

**NOTE:** Drill hole on extrusion housing before install into wall/surface.

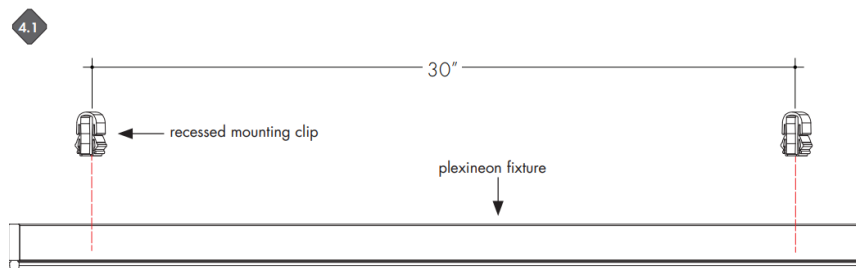

**Install recessed mounting clips to fixture. Make sure they are approximately 30" apart .**

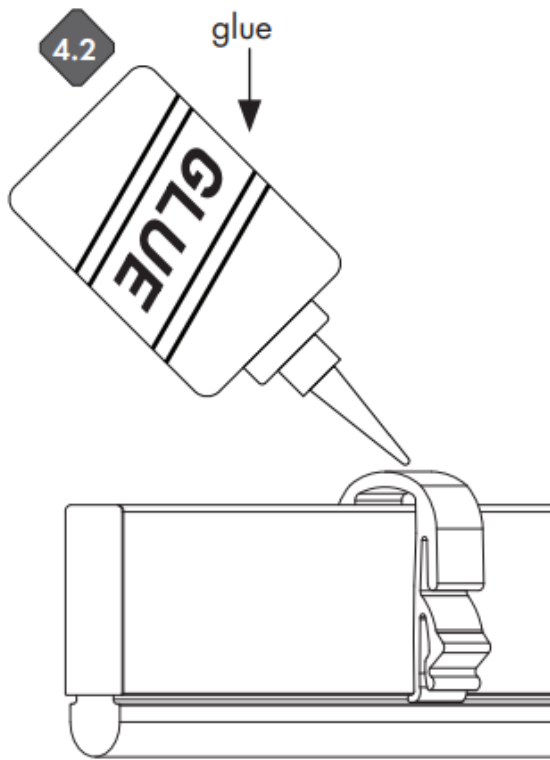

**Use gule to fill in all gaps between recessed mounting clips and plexineon fixture**

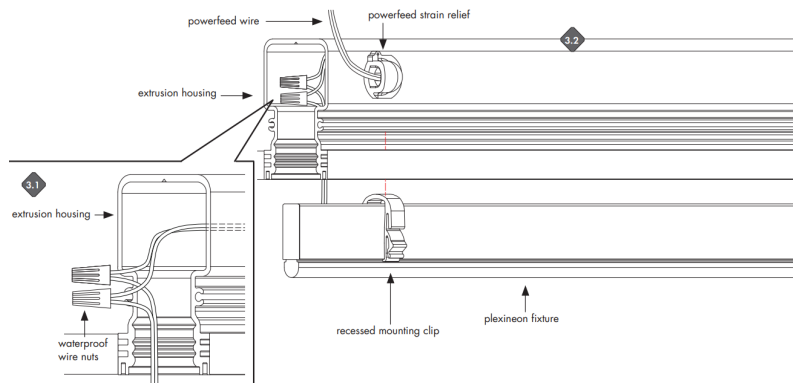

- Peel back power cord to expose wires. Connect power supply wires to fixture wires. Waterproof wire nuts recommended in this step.
- Snap plexineon fixture with glued mounting clips into extrusion housing.

## Documents / Resources

	<p><a href="#">iLight Plexineon Recessed Static Color</a> [pdf] Instruction Manual Plexineon Recessed Static Color, Plexineon Color, Recessed Static Color</p>
--	--

## References

-  [Home - Luminii](#)

Manuals+.