



iLight EG2-S Ethernet Gateway Installation Guide

[Home](#) » [iLIGHT](#) » iLight EG2-S Ethernet Gateway Installation Guide 

EG2-S Ethernet Gateway Installation Guide



Contents

- [1 Typical Schematic](#)
- [2 Mounting & Installation](#)
- [3 Technical Data](#)
- [4 Typical Connection Diagram](#)
- [5 Documents / Resources](#)
 - [5.1 References](#)

Typiccal Schematic

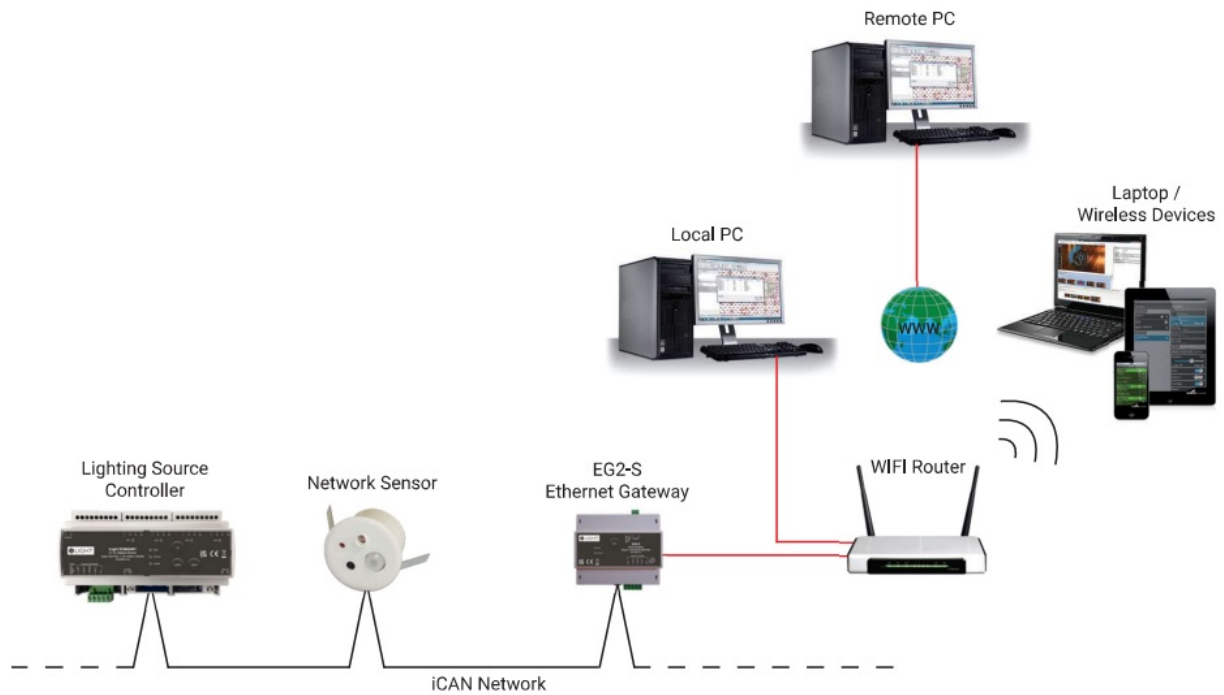

Mounting & Installation

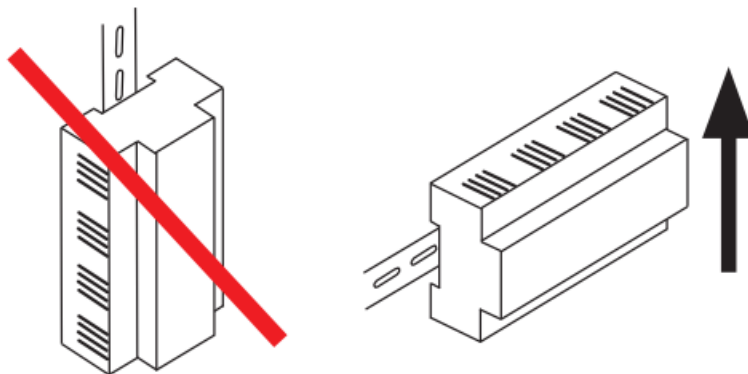

EG2-S must be mounted in a suitable enclosure to provide regulatory protection from electric shock hazard as well as protecting the iCANnet data network from tampering that could lead to reduced network security. Ensure selected enclosure provides adequate cooling ventilation.

Fixing to DIN rail

1. Fix top clips over DIN rail.
2. Pull down bottom clip using screwdriver.
3. Close module towards DIN rail.
4. Push up bottom clip to fix securely to DIN rail.

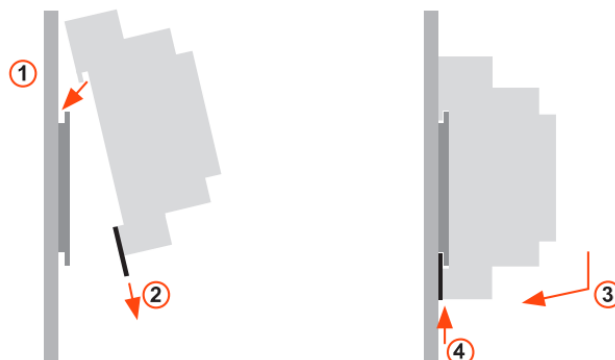

Removing from DIN rail

1. Pull down bottom clip with screwdriver.
2. Lift module away from DIN rail.

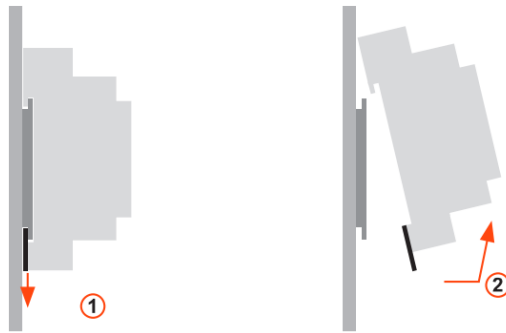

Technical Data

Electrical & Mechanical

Control: Via iLight network connection

Supply: +10 – 24V DC @ 750 mA Max (via external power supply)

Terminal Size: iCANnet cable size: 5 x 1mm². Power cable size: 2 x 1mm²

Protection: Provided by installer

Recommended Cable: iCANnet Network Cable

Ambient temperature: 2°C — 50°C

Relative humidity: 5% – 95% max, non-condensing

IP rating: IP20

Installation: Installation must be carried out by a suitably qualified electrician and installed in a suitable DIN rail enclosure.

Dimensions: 106mm (w) x 91mm (h) x 62mm (d)

Weight: 0.22kg

Software

For programming EG2-S, the latest version of Device Editor software is required.

Please sign in / register at www.ilight.info for the latest versions.

Setup

Default Password: password

When connecting to an EG2-S (with firmware version 2.03P or later) the user must change the default password for a connection to an iLight system to be established.

Using Link manager in Device editor create a connection and set a new password. The new password must contain 8-64 characters, at least one lower-case character, at least one upper-case character, at least one numeric character and at least one special character.

Device LEDs and Buttons

Status LED

Green LED flashes — device OK

Data LED

Red LED flashes when messages sent on network.

Device Identification

Press and release switch.

Sending a message to identify the device on the network (red Data LED flashes)

iCAN network wiring

Cable connections to the iCAN network are made to a removable 5-way connector block located on the EG2-S

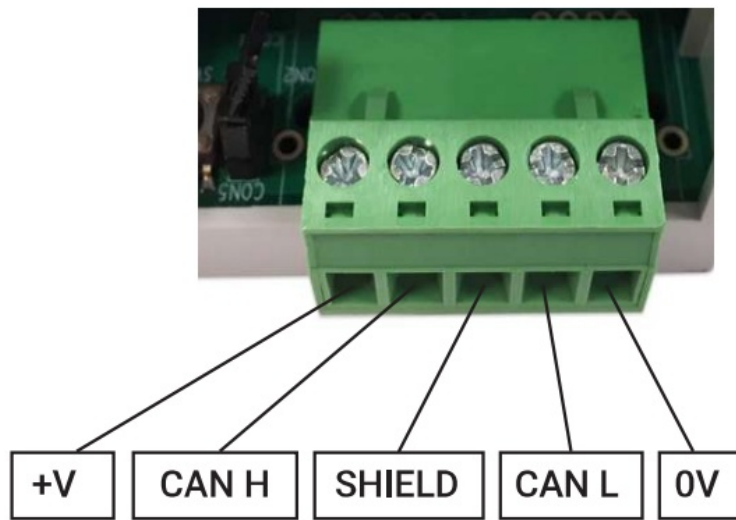

Function	iCANnet Cable Colour
OV	Black
CAN L	Blue
Shield	Silver
CAN H	White
+V	Red

Maximum segment distance: 500m (1640 ft) Devices per segment: 100 (without bridge or repeater) Consult iLight for information on alternative cable types.

IMPORTANT NOTE: Connecting a mains potential cable to the iCAN Network terminals is likley to damage the unit and other devices connected, and invalidate warranty.

Typical Connection Diagram

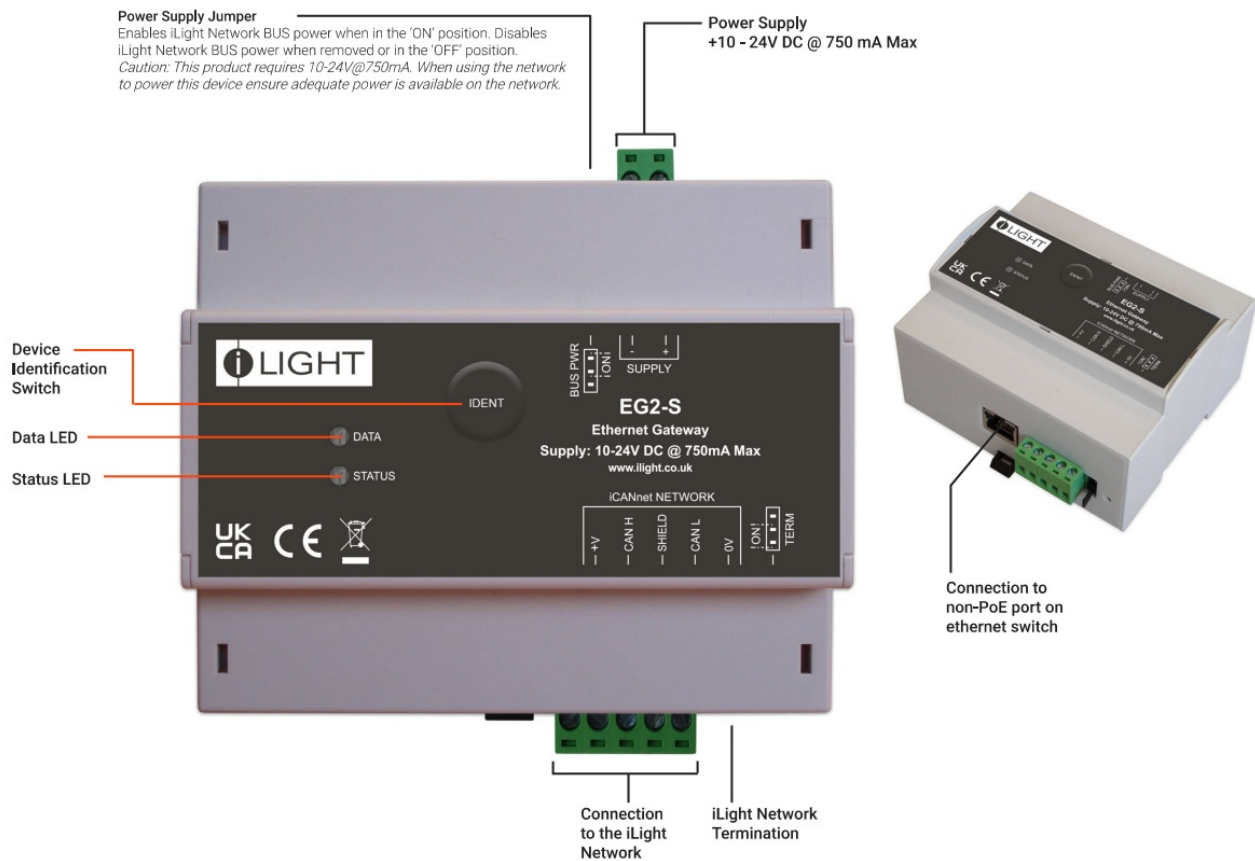

Network termination

EG2-S is supplied with termination disabled as standard. If it is connected as an end device on the iCAN network, the jumper will need to be moved to enable termination.

To enable termination, move the jumper downwards from the top two pins to the bottom two pins.

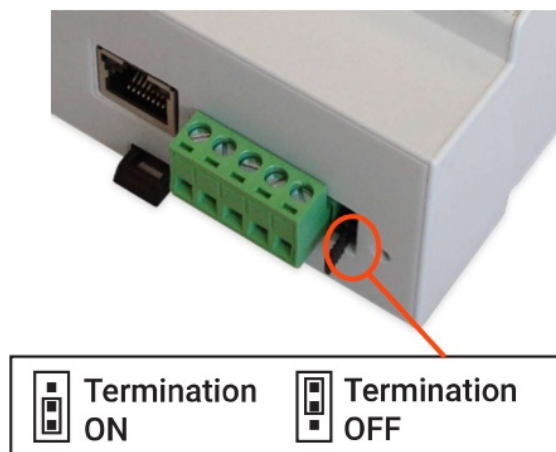

iLight

Usk House, Lakeside

Llantarnam Park,

Cwmbran,

NP44 3HD, UK

t: +44 (0)1923 495495

e: enquiries@iLight.co.uk

www.iLight.co.uk

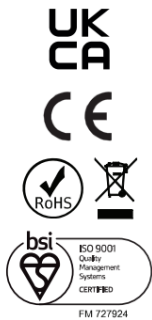

EU Authorised Representative
Cooper Lighting Netherlands B.V.
High Tech Campus
HTC 48
Eindhoven
5656 AE
E&OE. iLight reserve the right to make changes to the equipment without prior notice.
© Signify Holding
Doc No: 9850-000916-01



Documents / Resources

	<p>iLight EG2-S Ethernet Gateway [pdf] Installation Guide EG2-S, EG2-S Ethernet Gateway, Ethernet Gateway, Gateway</p>
---	--

References

- [User Manual](#)

[Manuals+](#), [Privacy Policy](#)

This website is an independent publication and is neither affiliated with nor endorsed by any of the trademark owners. The "Bluetooth®" word mark and logos are registered trademarks owned by Bluetooth SIG, Inc. The "Wi-Fi®" word mark and logos are registered trademarks owned by the Wi-Fi Alliance. Any use of these marks on this website does not imply any affiliation with or endorsement.