

IKRA ITHK 1000 Multi Function Garden Tool

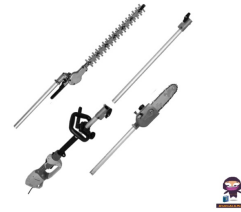

# IKRA ITHK 1000 Multi Function Garden Tool Instruction Manual

[Home](#) » [IKRA](#) » IKRA ITHK 1000 Multi Function Garden Tool Instruction Manual 

## Contents

- 1 IKRA ITHK 1000 Multi Function Garden Tool
- 2 Product Usage Instructions
- 3 Spare parts and accessories
- 4 TECHNICAL DATA
- 5 SAFETY INSTRUCTIONS
- 6 GENERAL POWER TOOL SAFETY WARNINGS
- 7 SPECIFIED CONDITIONS OF USE
- 8 SPECIFIED CONDITIONS OF USE
- 9 MAINTENANCE
- 10 TROUBLESHOOTING
- 11 ASSEMBLY INSTRUCTION
- 12 Warranty conditions
- 13 Documents / Resources
  - 13.1 References



IKRA ITHK 1000 Multi Function Garden Tool



### Specifications:

- Model: ITHK 1000
- Operating Voltage: 230-240 V AC
- Frequency: 50 Hz
- Power Consumption: 1000 W
- No-load Speed: 2.08 – 2.75 m
- Sound Pressure Level: 89 dB (A)
- Sound Power Level: 104 dB (A)
- Weight (without cutting tool and harness): 5.1 kg
- Vibration Values: ah (Rear handle / Front handle) – 3.62 m/s<sup>2</sup>
- Total Length: 480 mm
- Cutting Length: 18 mm

### Product Usage Instructions

#### Safety Instructions:

Before operating the device, carefully read and understand all safety instructions provided in the manual.

- **Workspace Safety:** Ensure a safe working environment.
- **Electrical Safety:** Use a residual current device when operating in damp conditions.
- **Personal Safety:** Follow proper safety measures to prevent injuries.
- **Maintenance:** Only allow qualified personnel to repair the device using original spare parts.

#### Maintenance:

Regular maintenance is essential for optimal performance and safety.

- **Chain Tension:** Check and adjust chain tension before each use.
- **Inspect Loose Fasteners:** Ensure all fasteners are tight before operation.
- **Chain Brake Functionality:** Verify the chain brake is working correctly before each use.

- **Cleaning:** Clean and inspect the device before each use.

### Frequently Asked Questions (FAQ):

**Q:** What should I do if the device is not operating correctly?

**A:** Check if all connections are secure, and consult the troubleshooting section of the manual for further guidance.

**Q:** How often should I lubricate the device?

**A:** Follow the maintenance schedule provided in the manual for lubrication intervals.

### Spare parts and accessories

If you need accessories or spare parts, please contact our Service department.

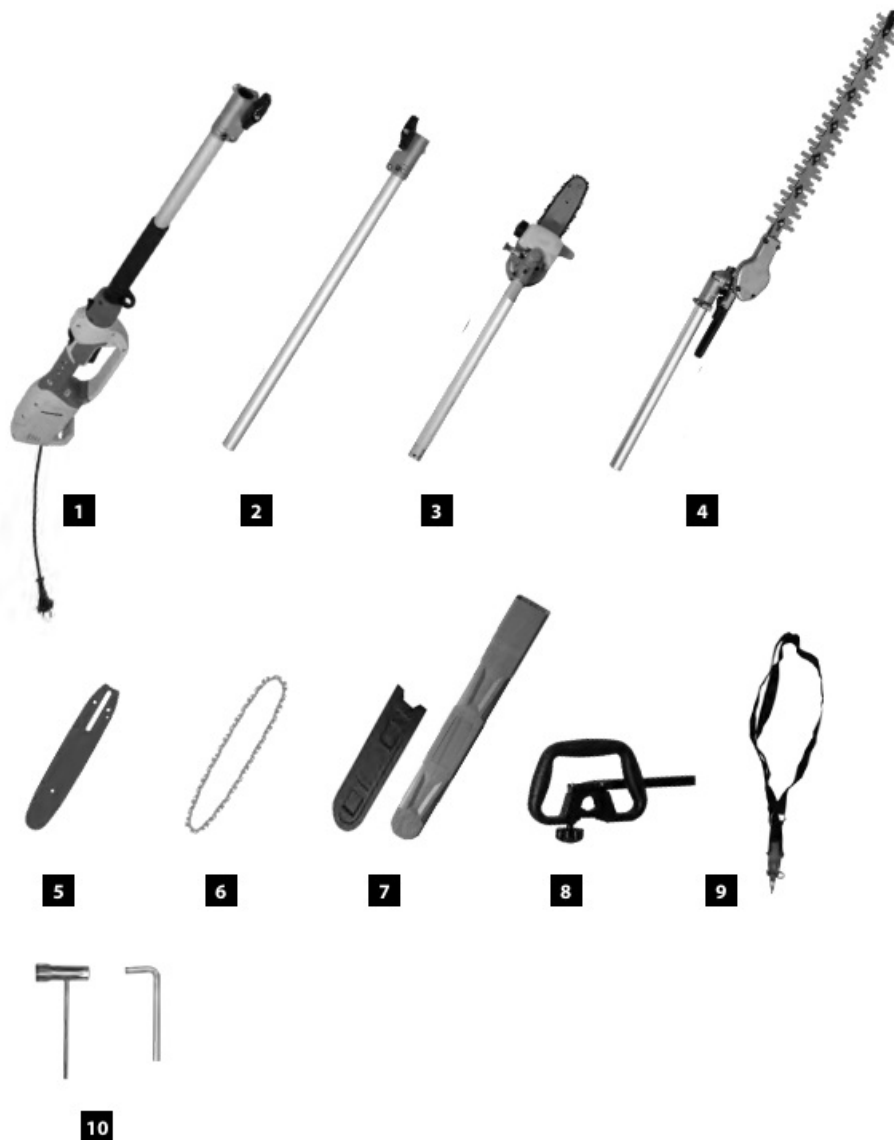

### TECHNICAL DATA

<b>Multi-funktion garden tool</b>	<b>ITHK 1000</b>
Operating voltage	230-240 V AC
Nominal frequency	50 Hz
Nominal consumption	1000 W
Device length	2,08 – 2,75 m
Sound pressure level LpA Uncertainty K = 3 dB (A)	89 dB (A)
Sound power level LWA	104 dB (A)
Weight without battery (without cutting tool and shoulder strap)	5,1 kg
<b>Vibration details</b>	
Total vibration values (triaxial vector sum) Determined properly ISO 22867, Uncertainty K = 1,5 m/s <sup>2</sup>	
Vibration emission value ah (handle back / front)	3,62 m/s <sup>2</sup>

<b>Cordless Pole Hedge trimmer</b>	
Cutting length	480 mm
Cutting width	18 mm
<b>Cordless-Chain saw</b>	
Chain	Oregon 91PX033X
Guide bar type	080SDEA318
Usable cutting length	200 mm/8"
Chain oil tank capacity	130 cm <sup>3</sup>

Technical changes reserved.

**WARNING:** The declared vibration emission level represents the main applications of the tool. However if the tool is used for different applications, with different accessories or poorly maintained, the vibration emission may differ. This may significantly increase the exposure level over the total working period.

The vibration emission level will vary because of the ways in which a power tool can be used and may increase above the level given in this information sheet.

The vibration emission level may be used to compare one tool with another.

It may be used for a preliminary assessment of exposure.

An accurate estimate of the vibratory load should also take into account the times when the tool is shut down or when it is running but not actually in use. This may significantly reduce the vibratory load over the total working period.

Identify additional safety measures to protect the operator from the effects of vibration such as: maintain the tool and the accessories, keep the hands warm, organisation of work patterns.

## SAFETY INSTRUCTIONS

This device is not suitable for use by persons (including children) with restricted physical, sensory or mental abilities or insufficient experience and knowledge or persons who are not familiar with the instructions.

You must never be allowed to use the machine.

Read and understand the operating instructions before using the appliance. Familiarise with the control elements and how to use the appliance properly.

Abide by all the safety measures stated in the service manual. Act responsibly toward third parties. The operator is responsible for accidents or risks to third parties.

Keep children and other persons including animals in a safe distance when using the appliance. Minimum safe distance is 15 m.

Do not allow persons unfamiliar with the power tool or these instructions to operate the power tool.

Local regulations may stipulate the minimum age of the user.

## **WARNING**

Wear personal protective equipment.

- Always wear goggles when using the machine.
- Wear ear protectors!
- Wear solid shoes and long trousers.
- Do not wear loose clothing or jewels. Hair, clothing and gloves must be out of reach of moving parts as they could get caught by the rotating parts. Do not use the appliance when barefooted or in open sandals.
- Never replace the non-metallic cutting device (coil head) with a metallic cutting device (coil head).
- Take a firm stance to maintain balance during operation and be sure to use the included carrying strap.
- Position the shoulder strap such that it goes over your shoulder, crossing your chest and back.
- Hook the shoulder strap into the fastening eyelet.
- Adjust the strap length such that the shoulder strap quick-release is at hip height
- The quick release of the shoulder strap regularly and before each use for damage and check correct function.  
In the event of damage or suspected damage immediately from check authorized specialists and Have it replaced if necessary.
- Pull on the for a quick-release function
- red ribbon of the quick release.

Provide adequate lighting or good lighting conditions when working with the machine. Poor lighting/light conditions represent a high safety risk.

Do not use the appliance in bad weather, especially when there is a risk of storm.

Do not use the appliance if you are tired, ill, under influence of drugs, alcohol drinks or medicaments.

Do not overreach. Keep proper footing and balance at all times.

Walk! Never run!

Be careful when going backwards – risk of tripping! Provide a safe posture, especially on slopes.

Despite the observance of the operating instructions there still may be some hidden residual risks.

When using the machine, pay attention to the working posture and change the working positions. Also take regular breaks.

Avoid using the multifunction device an ambient temperature of less than 10 ° C.

Children should be supervised to ensure that they do not play with the device. Cleaning and maintenance must not be carried out by children.

Allow the engine to cool down for transport and secure the machine from slipping before transporting it with a vehicle. This ensures that oil leakage (pruners), damage or injuries is prevented. The device is always transported with the knife/sword protection attached.

It is recommended to attend a course on the use, maintenance of the device and a first aid course. If you are not going to use the device for a long period of time, you should familiarize yourself with the device before starting. Check the work area before using the appliance. Remove any hard objects such as stones, shards of glass, wires,

etc. that could be thrown off, knocked back or that could otherwise cause injury or damage during appliance operation.

**Never use the appliance when the proper equipment is not fitted.**

The appliance must not be used if damaged or safety equipment is defective. Replace any worn-out and damaged parts.

Check all screw and plug-in connections and protective equipment if firm and tightened properly and whether all moving parts are running smooth whenever the appliance is to be put into operation.

The protective equipment on the appliance is strictly prohibited to be disassembled, changed, used in conflict with the designation and it is prohibited to attach any protective equipment of other manufacturers.

If the appliance starts abnormally vibrating, switch the engine off and search for the cause immediately. Generally, vibrations are a warning against operating failure.

When being blocked, turn the appliance immediately off and remove the jammed item.

The appliance must be stored in a dry place and protected from frost.

Store idle power tools out of the reach of children and do not allow persons unfamiliar with the power tool or these instructions to operate the power tool.

**CAUTION**

Damage to health arising from vibrations to hand and arms if the device is used for a long time or if the device is not guided and evaluated properly.

Vibration damping systems are no guaranteed protection against white finger disease or carpal tunnel syndrome. Therefore, it is necessary to carefully check the state of your fingers and wrist if you have regularly used the appliance for a long time. If any symptom of the diseases above appears, seek medical advice immediately. To reduce the white finger disease risk, keep your hands warm and take regular breaks during your work.

Please do also consider any local regulations concerning noise protection!

**DANGER**

**Warning:** This power tool generates an electromagnetic field during operation. Under certain circumstances, this field may affect active or passive medical implants. To reduce the risk of serious or fatal injury, we recommend that individuals with medical implants consult your physician and the manufacturer of the medical implant before operating the machine.

**GENERAL POWER TOOL SAFETY WARNINGS**

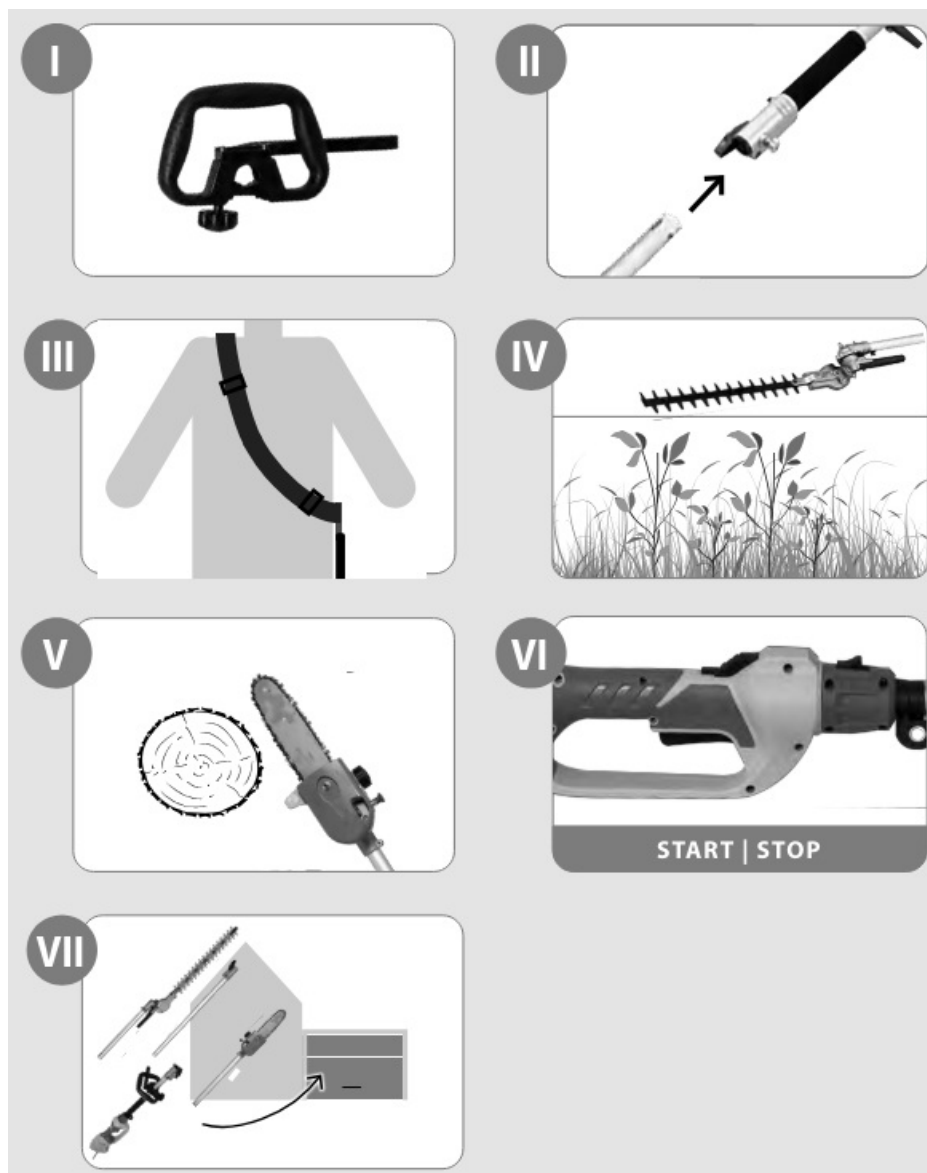

**WARNING** Read all safety warnings and all instructions. Failure to follow the warnings and instructions may result in electric shock, fire and/or serious injury.

Save all warnings and instructions for future reference.

The term „power tool“ in the warnings refers to your mains-operated (corded) power tool or battery-operated (cordless) power tool.

### Work area safety

- Keep work area clean and well lit. Cluttered or dark areas invite accidents.
- Do not operate power tools in explosive atmospheres, such as in the presence of flammable liquids, gases or dust. Power tools create sparks which may ignite the dust or fumes.
- Keep children and bystanders away while operating a power tool. Distractions can cause you to lose control.

### Electrical safety

- Power tool plugs must match the outlet. Never modify the plug in any way. Do not use any adapter plugs with earthed (grounded) power tools. Unmodified plugs and matching outlets will reduce risk of electric shock.
- Avoid body contact with earthed or grounded surfaces, such as pipes, radiators, ranges and refrigerators. There is an increased risk of electric shock if your body is earthed or grounded.
- Do not expose power tools to rain or wet conditions. Water entering a power tool will increase the risk of electric

shock.

- Do not abuse the cord. Never use the cord for carrying, pulling or unplugging the power tool. Keep cord away from heat, oil, sharp edges or moving parts. Damaged or entangled cords increase the risk of electric shock.
- When operating a power tool outdoors, use an extension cord suitable for outdoor use. Use of a cord suitable for outdoor use reduces the risk of electric shock.
- If operating a power tool in a damp location is unavoidable, use a residual current device (RCD) protected supply. Use of an RCD reduces the risk of electric shock.

## **Personal safety**

- Stay alert, watch what you are doing and use common sense when operating a power tool. Do not use a power tool while you are tired or under the influence of drugs, alcohol or medication. A moment of inattention while operating power tools may result in serious personal injury.
- Use personal protective equipment. Always wear eye protection. Protective equipment such as dust mask, non-skid safety shoes, hard hat, or hearing protection used for appropriate conditions will reduce personal injuries.
- Prevent unintentional starting. Ensure the switch is in the off-position before connecting to power source and/or battery pack, picking up or carrying the tool. Carrying power tools with your finger on the switch or energising power tools that have the switch on invites accidents.
- Remove any adjusting key or wrench before turning the power tool on. A wrench or a key left attached to a rotating part of the power tool may result in personal injury.
- Do not overreach. Keep proper footing and balance at all times. This enables better control of the power tool in unexpected situations.
- Dress properly. Do not wear loose clothing or jewellery. Keep your hair, clothing and gloves away from moving parts. Loose clothes, jewellery or long hair can be caught in moving parts.
- If dust extraction/collection devices are provided make sure that they are connected and used properly. The use of a dust extraction device may reduce risks caused by dust.

## **Power tool use and care**

- Do not force the power tool. Use the correct power tool for your application. The correct power tool will do the job better and safer at the rate for which it was designed.
- Do not use the power tool if the switch does not turn it on and off. Any power tool that cannot be controlled with the switch is dangerous and must be repaired.
- Disconnect the plug from the power source and/or the battery pack from the power tool before making any adjustments, changing accessories, or storing power tools. Such preventive safety measures reduce the risk of starting the power tool accidentally.
- Store idle power tools out of the reach of children and do not allow persons unfamiliar with the power tool or these instructions to operate the power tool. Power tools are dangerous in the hands of untrained users.
- Maintain power tools. Check for misalignment or binding of moving parts, breakage of parts and any other condition that may affect the power tool's operation. If damaged, have the power tool repaired before use. Many accidents are caused by poorly maintained power tools.
- Keep cutting tools sharp and clean. Properly maintained cutting tools with sharp cutting edges are less likely to bind and are easier to control.
- Use the power tool, accessories and tool bits etc. in accordance with these instructions, taking into account the

working conditions and the work to be performed. Use of the power tool for operations different from those intended could result in a hazardous situation.

## **Service**

- Have your power tool serviced by a qualified repair person using only identical replacement parts. This will ensure that the safety of the power tool is maintained.

## **SPECIFIED CONDITIONS OF USE**

### **Safety Instructions Hedge trimmer**

Keep all parts of the body in safe distance from the knife. Do not try to remove the material being cut or hold material to be cut when the knife is running. Jammed cuttings to be removed only when the machine is off and the battery taken out. A moment of inattention when using the hedge trimmer may result in serious injuries. Carry the hedge trimmer by the handle when the knife is off. Fit the protective cover whenever the hedge trimmer is to be transported or stored. Careful treatment with the appliance reduces the risk of injury by the blade. Hold the power tools by the insulated handles as the cutting knife may come into contact with hidden cables/lines. Contact of the cutting knife with a live conductor may bring the metal parts of the appliance under voltage and cause electric shock.

### **FURTHER SAFETY INSTRUCTIONS**

Before work, check the area for any hidden items such as wire fences.

When working, keep the appliance firmly with both hands and with a distance from your body.

### **Cordless-Chain saw**

- Keep all parts of the body away from the saw chain when the chain saw is operating. Before you start the chain saw, make sure the saw chain is not contacting anything. A moment of inattention while operating chain saws may cause entanglement of your clothing or body with the saw chain.
- Always hold the chain saw with your right hand on the rear handle and your left hand on the front handle. Holding the chain saw with a reversed hand configuration increases the risk of personal injury and should never be done.
- Wear eye protection. Further protective equipment for hearing, head, hands, legs and feet is recommended. Adequate protective equipment will reduce personal injury from flying debris or accidental contact with the saw chain.
- Do not work on trees with the chainsaw. There is a risk of injury when working on a tree.
- Always keep proper footing and operate the chain saw only when standing on fixed, secure and level surface. Slippery or unstable surfaces may cause a loss of balance or control of the chain saw.
- When cutting a limb that is under tension, be alert for springback. When the tension in the wood fibres is released the spring-loaded limb may strike the operator and /or throw the chainsaw out of control.
- • Use extreme caution when cutting brush and saplings. The slender material may catch the saw chain and be whipped toward you or pull you off balance.
- Carry the chain saw by the front handle with the chain saw switched off and away from your body. When transporting or storing the chain saw, always fit the guide bar cover. Proper handling of the chain saw will reduce the likelihood of accidental contact with the moving saw chain.
- Follow instructions for lubricating, chain tensioning and changing the bar and chain. Improperly tensioned or lubricated chain may either break or increase the chance for kickback.

- Keep handles dry, clean, and free from oil and grease. Greasy, oily handles are slippery causing loss of control.
- Cut wood only. Do not use chain saw for purposes not intended. For example: do not use chain saw for cutting metal, plastic, masonry or non-wood building materials. Use of the chain saw for operations different than intended could result in a hazardous situation.
- The machine is not protected against electric shock when coming into contact with high-voltage lines. Maintain a minimum clearance of 10 m from current-carrying lines. Life-threatening danger from electric shock!

#### **Causes and operator prevention of kickback:**

Kickback may occur when the nose or tip of the guide bar touches an object, or when the wood closes in and pinches the saw chain in the cut.

Tip contact in some cases may cause a sudden reverse reaction, kicking the guide bar up and back towards the operator.

Pinching the saw chain along the top of the guide bar may push the guide bar rapidly back towards the operator. Either of these reactions may cause you to lose control of the saw which could result in serious personal injury. Kickback is the result of tool misuse and/or incorrect operating procedures or conditions and can be avoided by taking proper precautions as given below:

- Maintain a firm grip, with thumbs and fingers encircling the chain saw handles, with both hands on the saw and position your body and arm to allow you to resist kickback forces. Kickback forces can be controlled by the operator, if proper precautions are taken.
- Do not overreach and do not cut above shoulder height. This helps prevent unintended tip contact and enables better control of the chain saw in unexpected situations.
- Only use replacement bars and chains specified by the manufacturer. Incorrect replacement guide bars and chains may cause chain breakage and/or kickback.
- Follow the manufacturer's sharpening and maintenance instructions for the saw chain. Decreasing the depth gauge height can lead to increased kickback.

#### **Additional Safety and Working Instructions**

Ensure all guards, handles, and spiked bumper are properly fitted and are in good condition.

Persons using the chainsaw should be in good health. The chainsaw is heavy, so the operator must be physically fit.

The operator should be alert, have a good vision, mobility, balance, and manual dexterity. If there is any doubt, do not operate the chain saw.

Do not start using the chainsaw until you have a clear work area, secure footing, and a planned retreat path away from a falling tree. Beware of the emission of lubricant mist and saw dust. Wear a mask or respirator, if required.

Do not cut vines and/or small undergrowth (less than 75 mm in diameter).

Always hold the chain saw with both hands during operation. Use a firm grip with thumbs and fingers encircling the chain saw handles. Right hand must be on the rear handle and left hand on the front handle.

Before starting the chain saw, make sure the saw chain is not contacting any object. Watch out for falling branches and stumble. Not. Branches hitting the ground can snap up and cause injury.

Do not modify the chain saw in any way or use it to power any attachments or devices not recommended by the manufacturer for your chain saw.

There should be a first-aid kit containing large wound dressings and a means to summon attention (e.g., whistle) close to the operator. A larger more comprehensive kit should be reasonably nearby.

An incorrectly tensioned chain can jump off the guide bar and could result in serious injury or fatality. The length of the chain depends on the temperature. Check the tension frequently.

You should get used to your new chain saw by making simple cuts on securely supported wood. Do this whenever you have not operated the saw for some time. To reduce the risk of injury associated with contacting moving parts,

always stop the motor, apply the chain brake, remove the battery pack and make sure all moving parts have come to a stop before:

- cleaning or clearing a blockage
- leaving the machine unattended
- installing or removing attachments
- checking, conducting maintenance or working on the machine

The size of the work area depends on the job being performed as well as the size of the tree or work piece involved. For example, felling a tree requires a larger work area than making other cuts, i.e., bucking cuts, etc. The operator needs to be aware and in control of everything happening in the work area.

Do not cut with your body in line with the guide bar and chain. If you experience kickback, this will help prevent the chain coming into contact with your head or body.

Do not use a back-and-forward sawing motion, let the chain do the work. Keep the chain sharp and do not try to push the chain through the cut.

Do not put pressure on the saw at the end of the cut. Be ready to take on the weight of the saw as it cuts free from the wood. Failure to do so could result in possible serious personal injury.

Do not stop the saw in the middle of a cutting operation.

Keep the saw running until it is already removed from the cut. Do not fix the on/off switch in the „on“ position when using the saw hand-held.

Remove the battery pack before starting any work on the appliance.

**WARNING!** To reduce the risk of fire, personal injury, and product damage due to a short circuit, never immerse your device, battery pack or charger in fluid or allow a fluid to flow inside them. Corrosive or conductive fluids, such as seawater, certain industrial chemicals, and bleach or bleach-containing products, etc., can cause a short circuit.

Never break open battery packs and chargers and store only in dry rooms. Keep dry at all times.

Prior to commissioning, check the following points on the pole-mounted pruner:

- Correct position of shoulder strap and inspection of the quick-release mechanism
- Damage to the device like cracks on the guide rail
- Correct guide rail seating
- Installation/running direction of the problem-free (sharp) saw chain
- Saw chain tension (in case of a new chain, check and readjust this multiple times)
- Functioning chain lubrication

Check the automatic chain lubrication

Regularly check the function of the automatic chain lubrication to prevent overheating and associated damage to the blade and saw chain. To do this, point the tip of the sword against a smooth surface (board, section of a tree) and let the chainsaw run. If an increasing amount of oil becomes visible during this procedure, the automatic chain lubrication is working properly.

**WARNING!** Danger of injury!

If the shoulder strap is not detached promptly in an emergency, serious injuries can result.

## **WARNING**

Keep your working position in mind to ensure safe working. Do not use the pole-mounted pruner from a ladder or other unsafe position. Ensure that you have firm footing and use appropriate protective clothing. Do not be

tempted to make ill-considered cuts. This can endanger yourself and others.

### **Cutting springpoles**

A springpole is any log, branch, rooted stump, or sapling which is bent under tension by other wood so that it springs back if the wood holding it is cut or removed.

On a fallen tree, a rooted stump has a high potential of springing back to the upright position during the bucking cut to separate the log from the stump. Watch out for springpoles—they are dangerous.

### **WARNING**

Springpoles are dangerous and could strike the operator, causing the operator to lose control of the chain saw. This could result in severe or fatal injury to the operator. This should be done by trained users.

Some regions have regulations that restrict the use of the machine. Check with your local authority for advice. Never allow children or people unfamiliar with the instructions to use the machine. Local regulations may restrict the age of the operator.

Ensure before each use that all controls and safety devices function correctly. Do not use the machine if the “off” switch does not stop the motor.

Do not wear loose-fitting clothing, short trousers, or jewellery of any kind.

Secure long hair so it is above shoulder level to prevent entanglement in moving parts.

Beware of thrown, flying, or falling objects. Keep all bystanders, children, and animals at least 15 m away from the work area.

Do not operate in poor lighting. The operator requires a clear view of the work area to identify potential hazards.

Use of hearing protection reduces the ability to hear warnings (shouts or alarms). The operator must pay extra attention to what is going on in the work area.

Operating similar tools nearby increases both the risk of hearing injury and the potential for other persons to enter your work area.

Keep firm footing and balance. Do not overreach.

Overreaching can result in loss of balance and can increase the risk of kickback.

Keep all parts of your body away from any moving part.

Inspect the chain saw before each use. Check for correct operation of all controls, including the chain brake.

Check for loose fasteners, make sure all guards and handles are properly and securely attached. Replace any damaged parts before use.

Do not modify the machine in any way or use parts and accessories which are not recommended by the manufacturer.

### **WARNING**

If the machine is dropped, suffers heavy impact or begins to vibrate abnormally, immediately stop the machine and inspect for damage or identify the cause of the vibration. Any damage should be properly repaired or replaced by an service station.

### **Residual Risk**

Even when the product is used as prescribed, it is still impossible to completely eliminate certain residual risk factors. The following hazards may arise in use and the operator should pay special attention to avoid the following:

- Injury caused by vibration

Always use the right tool for the job. Use designated handles. Restrict working time and exposure.

- Damage to hearing due to exposure to noise

Wear hearing protection and limit exposure.

- Injury caused by contact with exposed saw teeth of the chain

- Injury caused by thrown-out pieces of the workpiece (wood chips, splinters)

- Injury caused by dust and particles
- Injury to the skin caused by contact with lubricants
- Parts ejected from the saw chain (cutting/injection hazards)
- Unforeseen, abrupt movement, or kickback of the guide bar (cutting hazards)“

## **Risk Reduction**

- It has been reported that vibrations from handheld tools may contribute to a condition called Raynaud's Syndrome in certain individuals. Symptoms may include tingling, numbness, and blanching of the fingers, usually apparent upon exposure to cold. Hereditary factors, exposure to cold and dampness, diet, smoking and work practices are all thought to contribute to the development of these symptoms. There are measures that can be taken by the operator to possibly reduce the effects of vibration:
- Keep your body warm in cold weather. When operating the unit wear gloves to keep the hands and wrists warm.
- After each period of operation, exercise to increase blood circulation.
- Take frequent work breaks. Limit the amount of exposure per day.
- Protective gloves available from professional chain saw retailers are designed specifically for chain saw use which give protection, good grip and also reduce the effect of handle vibration. These gloves should comply with EN 381-7 and must be CE-marked.

If you experience any of the symptoms of this condition, immediately discontinue use and see your doctor. Immediately discontinue use and see your doctor.

## **WARNING**

Injuries may be caused, or aggravated, by prolonged use of a tool. When using any tool for prolonged periods, ensure you take regular breaks.

Risk of personal injury due to chainsaw in operation.

- Keep your hands in safe distance.  
Never use the machine with a damaged cover or protective device or without cover or protective devices.
- Remove the plug before starting any adjustment, cleaning and maintenance work on the device. Wait until all rotating parts have stopped and the appliance has cooled down.

Check the work area before using the appliance. Remove any hard objects such as stones, shards of glass, wires, etc. that could be thrown off, knocked back or that could otherwise cause injury or damage during appliance operation.

## **Never use the appliance when the proper equipment is not fitted.**

The appliance must not be used if damaged or safety equipment is defective. Replace any worn-out and damaged parts.

Check all screw and plug-in connections and protective equipment if firm and tightened properly and whether all moving parts are running smooth whenever the appliance is to be put into operation.

The protective equipment on the appliance is strictly prohibited to be disassembled, changed, used in conflict with the designation and it is prohibited to attach any protective equipment of other manufacturers.



















If the appliance starts abnormally vibrating, switch the engine off and search for the cause immediately. Generally, vibrations are a warning against operating failure.

When being blocked, turn the appliance immediately off and remove the jammed item.

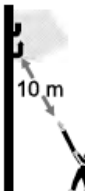
The appliance must be stored in a dry place and protected from frost.

Store idle power tools out of the reach of children and do not allow persons unfamiliar with the power tool or these instructions to operate the power tool.

## SYMBOLE

	Warning/caution!		Sound power level
	Please read the instructions carefully before starting the machine.		Note
	Wear eye protective goggles !		Any damaged or disposed electric or electronic devices must be delivered to appropriate collection centres.
	Wear protective helmet !		Protection class
	Wear ear protectors!		Wearing safety gloves.
	Wear safety cut through resistant shoes with safety sole and steel toe !		Do not expose the appliance to rain and do not use it in wet or moisture conditions.
	Cutting length		Maintain a minimum clearance of 10 m from current-carrying lines. Life-threatening danger from electric shock!
	Cutting length		
	Unplug immediately if the power cord or plug becomes damaged!		
	Risk of injury !		
	Rotating electrical tool! Do not put hands under the cover of the machine when it is running.		
	CE marking		

## SPECIFIED CONDITIONS OF USE

Take a firm stance to maintain balance during operation and be sure to use the included carrying strap.

### Chain saw

- The chain saw is designed for cutting branches, trunks, logs, and beams of a diameter of 12 cm determined by the cutting length of the guide bar. It is only designed to cut wood.

### WARNING

When using the chain saw, the safety rules must be followed. For your own safety and that of bystanders, you must read and fully understand these instructions before operating the chain saw. You should attend a professionally organized safety course in the use, preventative actions, first-aid, and maintenance of chain saws. Please keep these instructions safe for later use.

Chain saws are potentially dangerous tools. Accidents involving the use of chain saws often result in loss of limbs

or death. It is not just the chain saw that is the hazard. Falling branches, toppling trees, and rolling logs can all kill. Diseased or rotting timber poses additional hazards. You should assess your capability of completing the task safely. If there is any doubt, leave it to a professional tree surgeon. Keep the pruner in good operating condition, improper maintenance, the use of non-compliant spare parts, or removal or modification of safety devices can lead to serious damage to property or personal injury.

### **Pole hedge trimmer**

This hedge trimmer is only for cutting shrubs, Bushes, ornamental plants and hedges determined. The maximum branch thickness to be cut must not be 19 mm exceed. The use of the hedge trimmer is for determines the private garden area. The user of the Hedge trimmer has adequate protective equipment during use according to the instruction manual and the one attached to the machine To worry about warning pictograms. Before each use or while the hedge trimmer is in use, this is for any electrical or mechanical damage to consider. If damage to the machine is found, the Stop work and contact a specialist workshop.

## **WARNING**

### **Risk of injury**

The hedge trimmer may not be used to cut grass, hard brushes and wood or to crush material for composting purposes.

### **Residual risks**

Even if the tool is used correctly there always remains a certain residual risk, which is not excluded can be. From the type and construction the tool may have the following potential hazards be derived:

- Contact with the unprotected shaving blade (cuts)
- Reaching into the running hedge trimmer (cut injury)
- Unexpected, sudden movement of the Material to be cut
- Throwing away faulty shear teeth
- Throwing away parts of the material to be cut
- Damage to the hearing if not prescribed Hearing protection is worn
- Inhalation of clippings

## **NOTE**

Avoid using the engine at full power for the first 6-8 working hours.

No changes may be made to the device. This can endanger security.

This device may only be used as intended. Not observing general regulations in force and instructions from this manual does not make the manufacturer liable for damages.

Please note that our devices were not designed for commercial, craft or industrial use. We do not assume any guarantee if the device is used in commercial, craft or industrial companies as well as for similar activities.

## **MAINS CONNECTION**

Connect only to single-phase AC system voltage as indicated on the rating plate. It is also possible to connect to sockets without an earthing contact as the design conforms to safety class II.

Only plug-in when machine is switched off.

Do not use the appliance in bad weather, especially when there is a risk of storm.

## **DANGER!**

Operation is only allowed with a safety switch against stray current (RCD max. stray current of 30mA).

## **WARNING**

Electric shock! There is a risk of an injury caused by electric shock!

Never operate the apparatus if a cable, the mains cord or plug are damaged.

Insert the plug of the electrical cable in a socket of suitable shape, voltage and frequency complying with current regulations.

Handle the cord carefully. Hold the plug when unplugging the tool. Never use the cord to carry the apparatus.

Keep cord away from heat, oil, sharp edges or moving parts. Replace damaged cords immediately. Damaged cords increase the risk of electric shock and may create a fire.

Use extension cables with a maximum length of 5 meters and with a cable cross-section of not less than 1.5 mm<sup>2</sup>.

Use of extension cables of different length and cross-sections and also of adapters and multiple sockets should be avoided. When operating a power tool outdoors, use an extension cord suitable for outdoor use.

## **MAINTENANCE**

### **DANGER!**

Unplug the machine before any work on it. Wait until all rotating parts have stopped and the appliance has cooled down.

Keep the device, in particular the air vents, clean at all times. Never spray water on the device body! Never clean the machine and its components with solvents, flammable or toxic liquids. Use only a damp cloth making.

Use only original accessories and original spare parts. Using other spare parts can result in accidents/injuries of the user. The manufacturer will not be liable for any such damage.

Please contact our service department if you need accessories or spare parts.

Only a regularly maintained and treated appliance can serve as a satisfactory aid. Insufficient maintenance and care can lead to unforeseen accidents and injuries.

Repairs and works specified in these Instructions may only be performed by qualified authorised staff.

**Warning!** Always remove the plug before checking and setting work. Replacing the guide bar and saw chain

Wear protective gloves.

A dull or improperly sharpened chain can cause excessive motor speed during cutting which may result in severe motor damage.

Failure to replace or repair a damaged chain can cause serious injury.

The saw chain is sharp. Always wear protective gloves when performing maintenance to the chain.

### **Maintenance plan**

#### Daily check

- Before each use
  - Bar lubrication
- Chain tension
  - Before each use and frequently
- Chain sharpness
  - Before each use, visual check
- For damaged parts
  - Before each use
- For loose fasteners
  - Before each use

- Chain brake function  
Before each use inspect and clean
- Guide Bar  
Before each use
- Complete saw  
After each use

## Replacement parts

- Chain  
Oregon 91PX033X
- Guide Bar  
080SDEA318

Chain must be fitted with bar from the same manufacturer according to above combinations.

## DISPOSAL

If your device should become useless somewhere in the future or you do not need it any longer, do not dispose of the device together with your domestic refuse, but dispose of it in an environmentally friendly manner.

Please dispose of the device itself at an according collecting/recycling point. By doing so, plastic and metal parts can be separated and recycled. Information concerning the disposal of materials and devices are available from your local administration.

## TROUBLESHOOTING

Problem	Potential causes	Solutions, tips
The hedge trimmer does not run.	No electricity	Check whether the hedge trimmer is connected to mains electricity.
	House fuse or residual current circuit breaker has been tripped.	Check the extension cord for damage.
	The motor overload protection has triggered because the motor has been overloaded or has overheated.	Let the hedge trimmer cool off for 15–20 minutes.
Not enough power, not running smoothly	The hedge shears have been jammed by plant remains or foreign objects (e.g. a piece of wire).	Disconnect the hedge trimmer from the mains first. Inspect the hedge shears and remove any foreign objects.
	Hedge shears are dull or damaged.	Have the hedge trimmer checked by a specialist workshop.

If you are unable to rectify the problem, contact our service department (details provided on the warranty card) or find a specialist workshop.

## ASSEMBLY INSTRUCTION

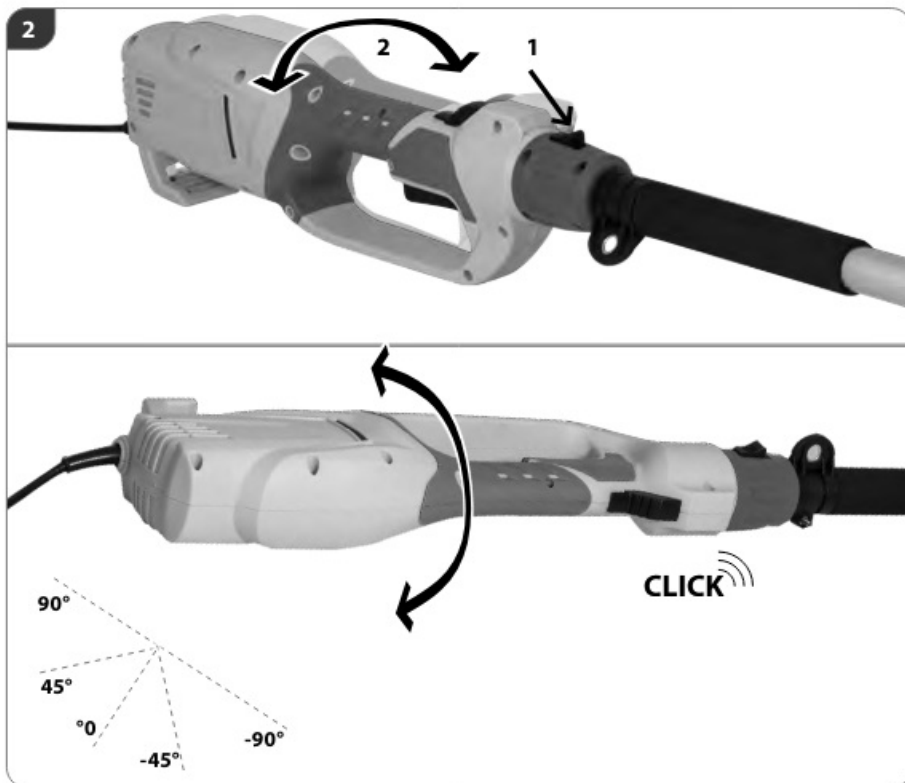
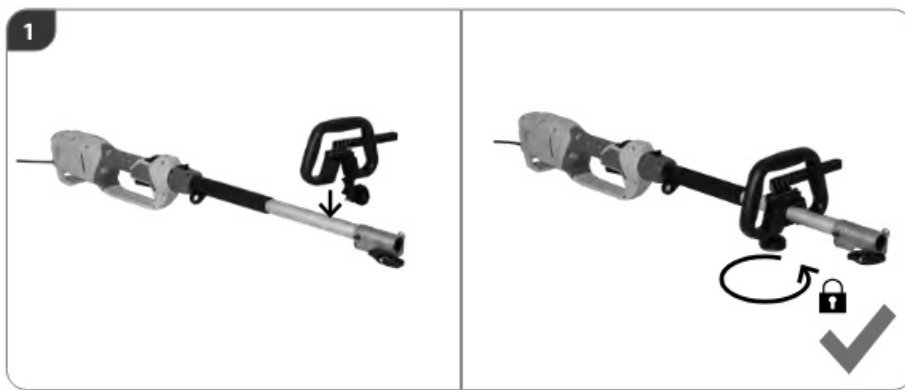

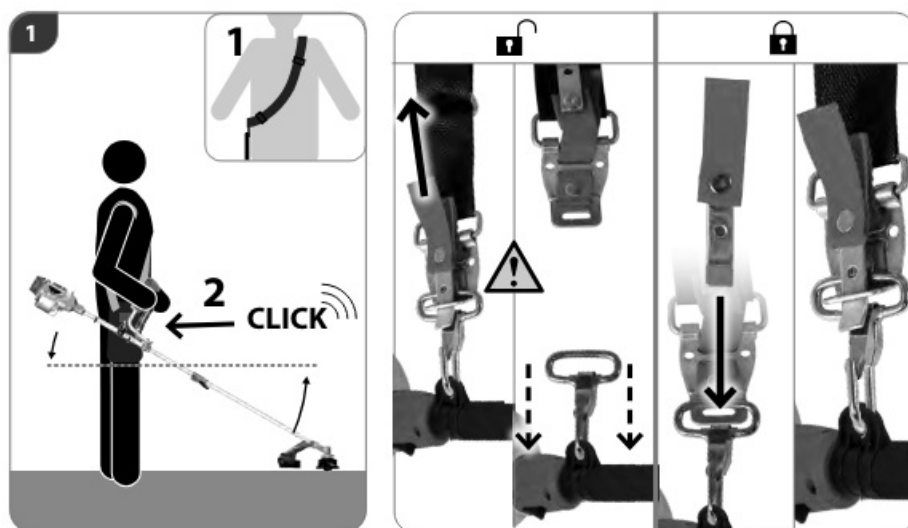
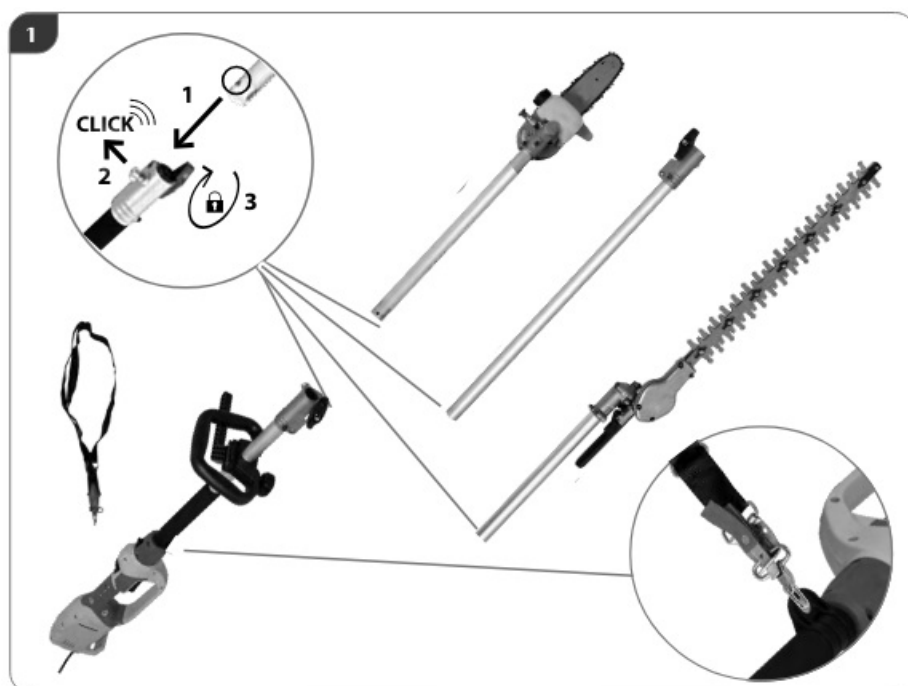

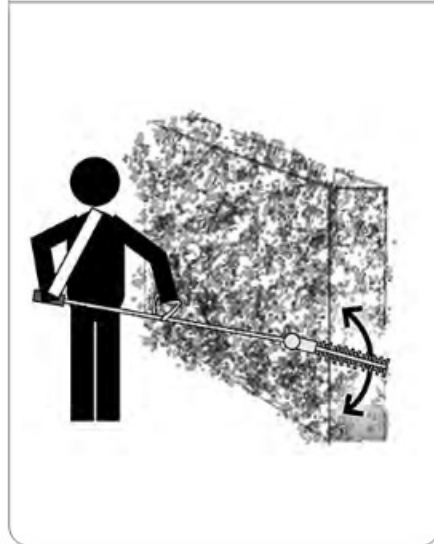
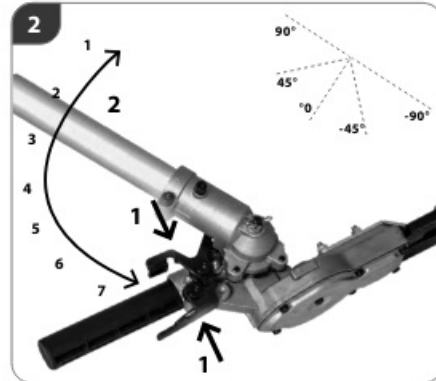
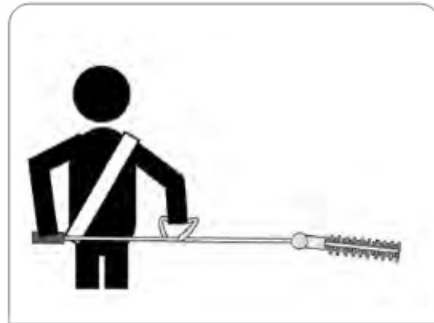
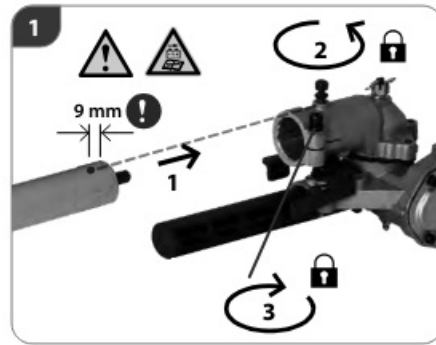
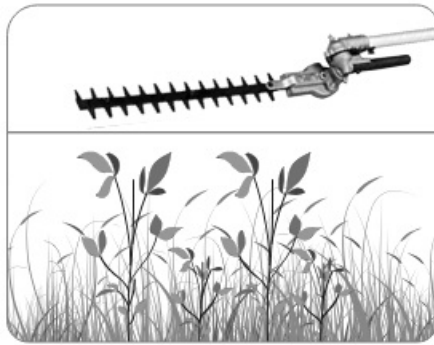

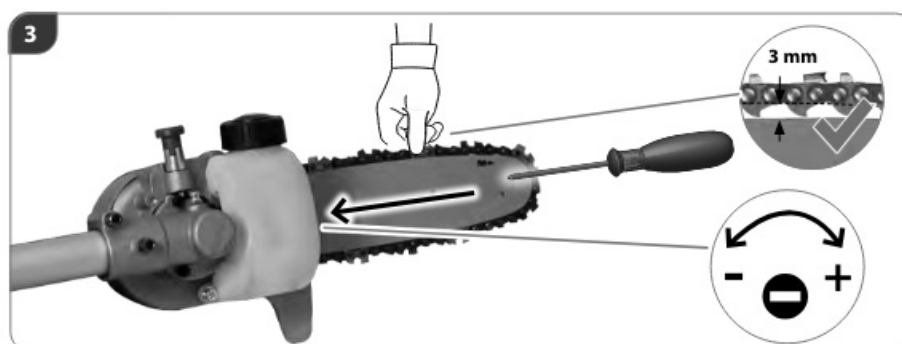
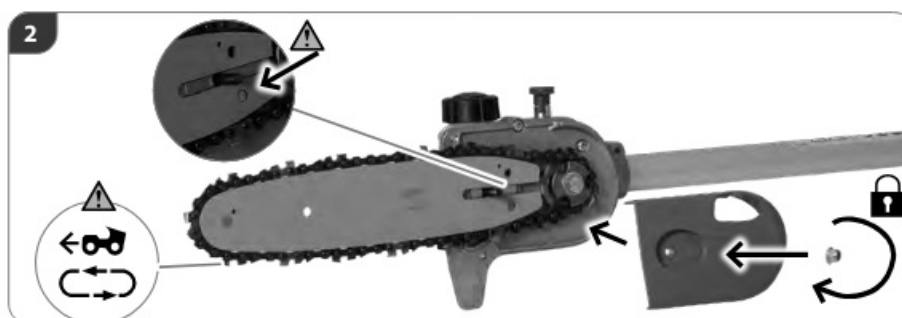
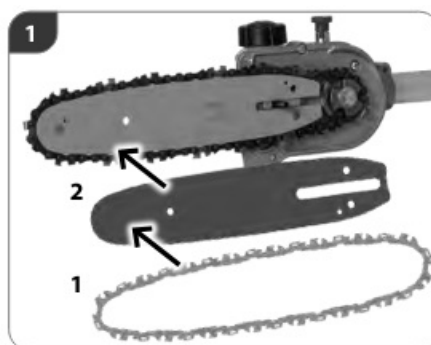
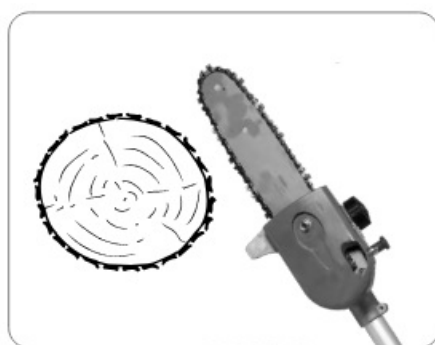

4

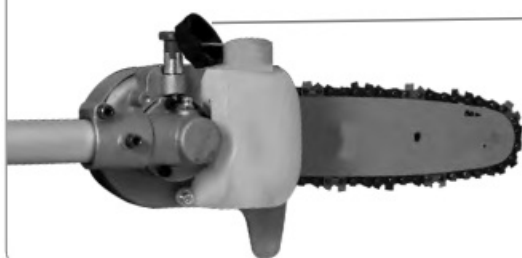

5

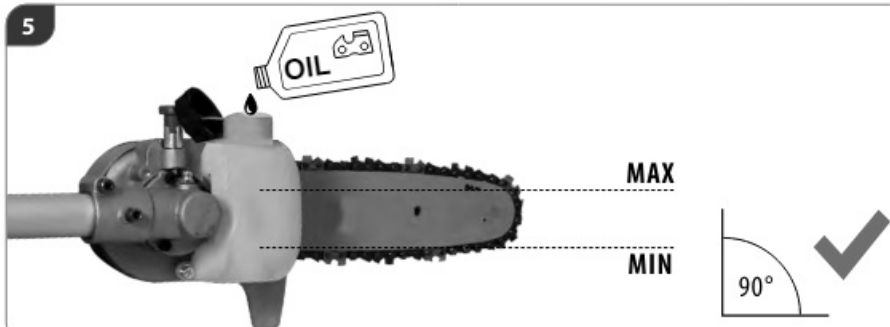

6

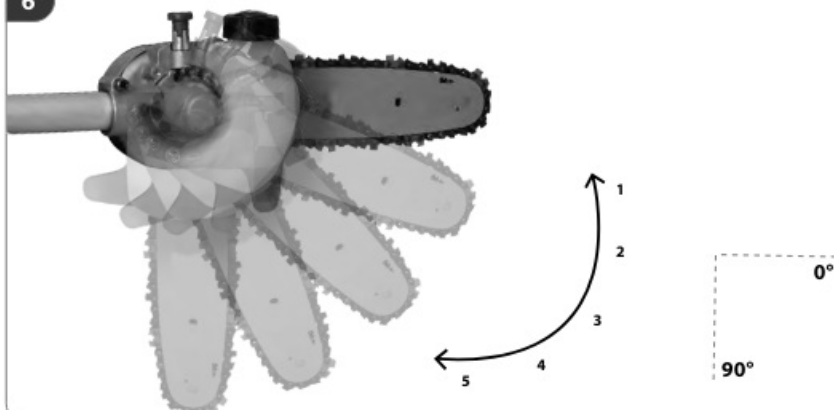

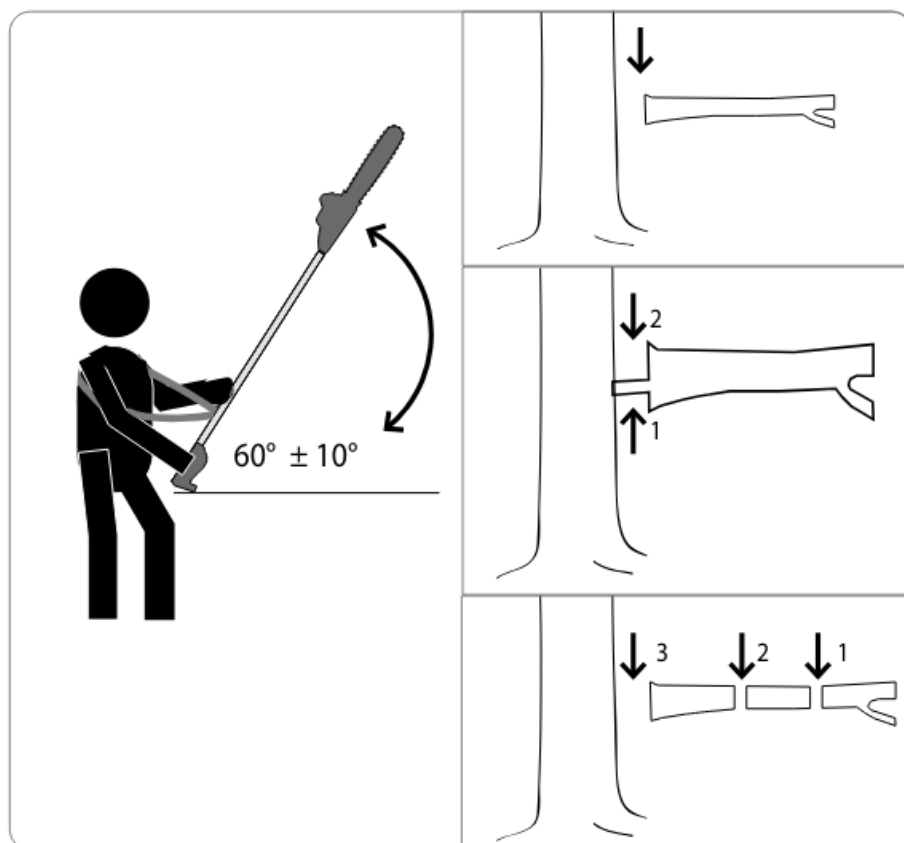

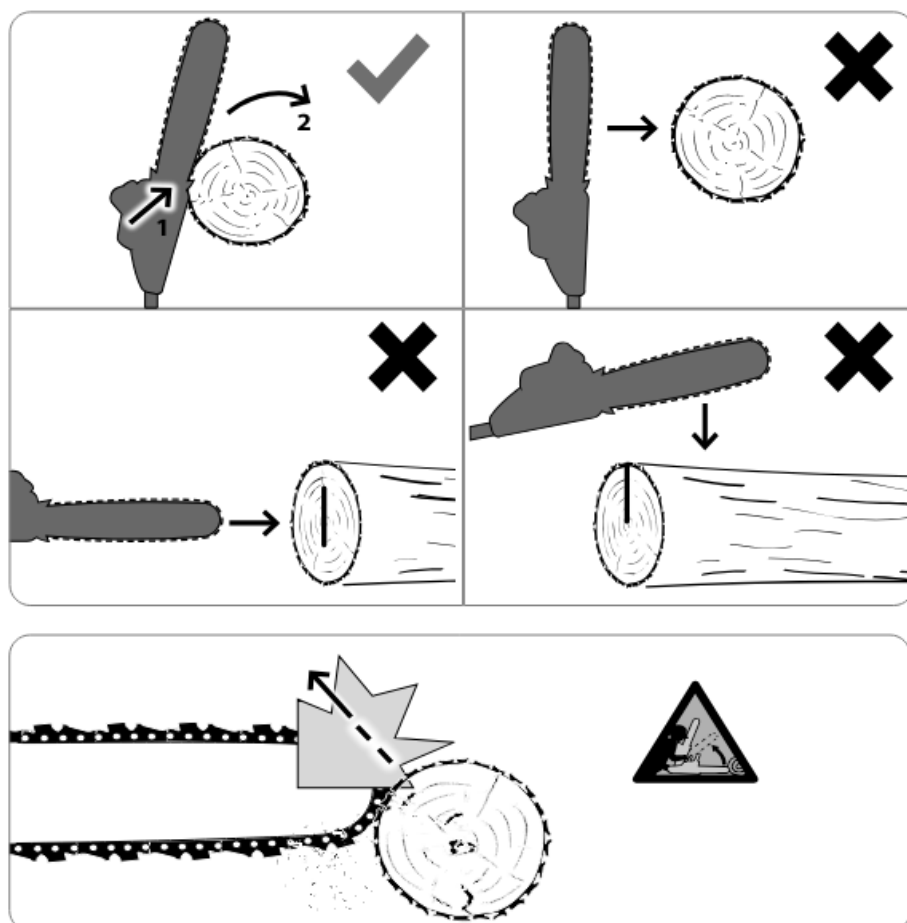

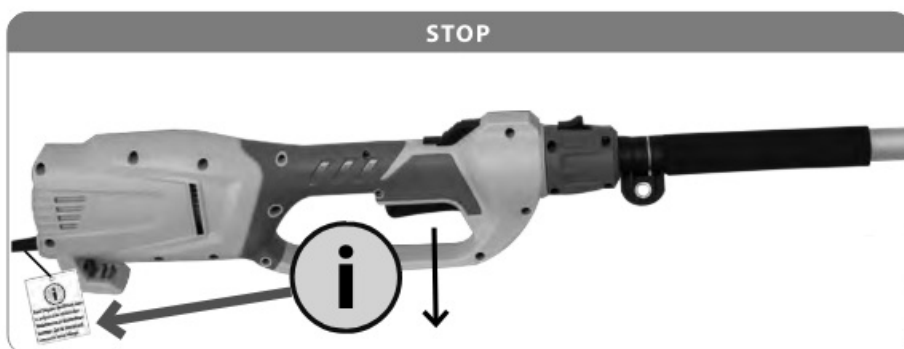
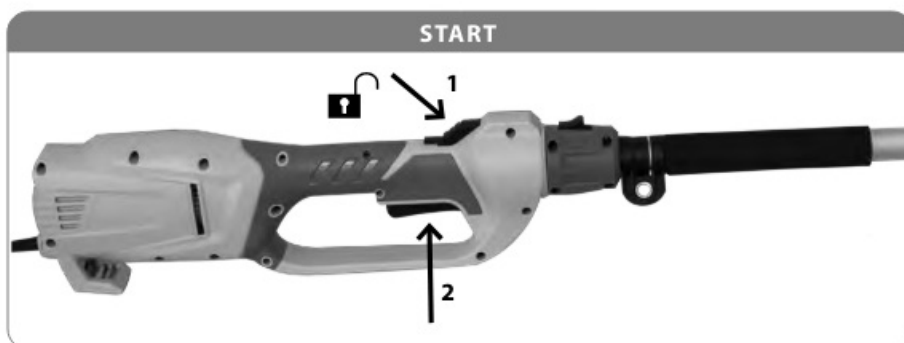
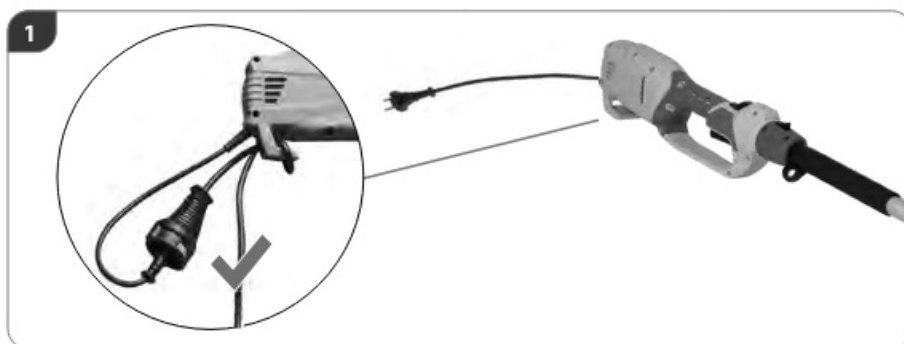

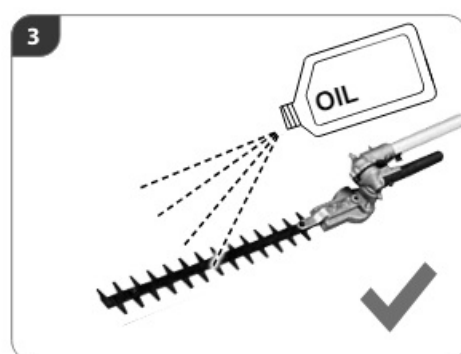
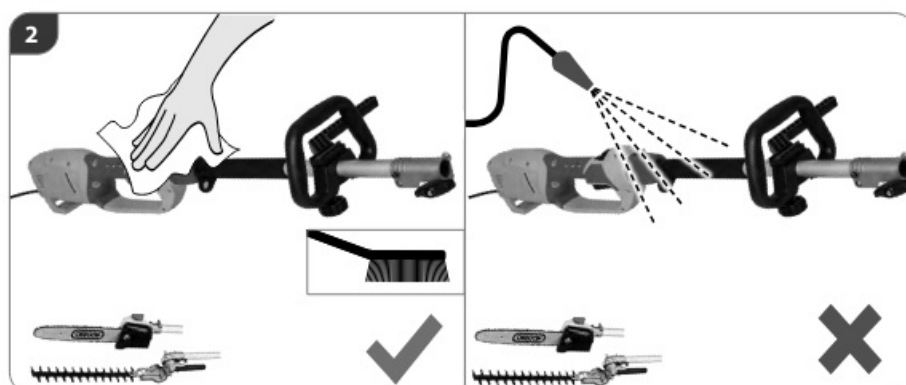
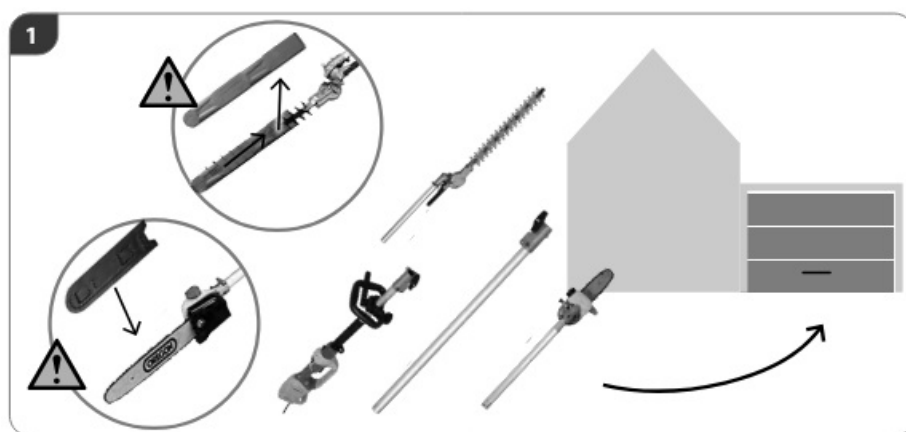

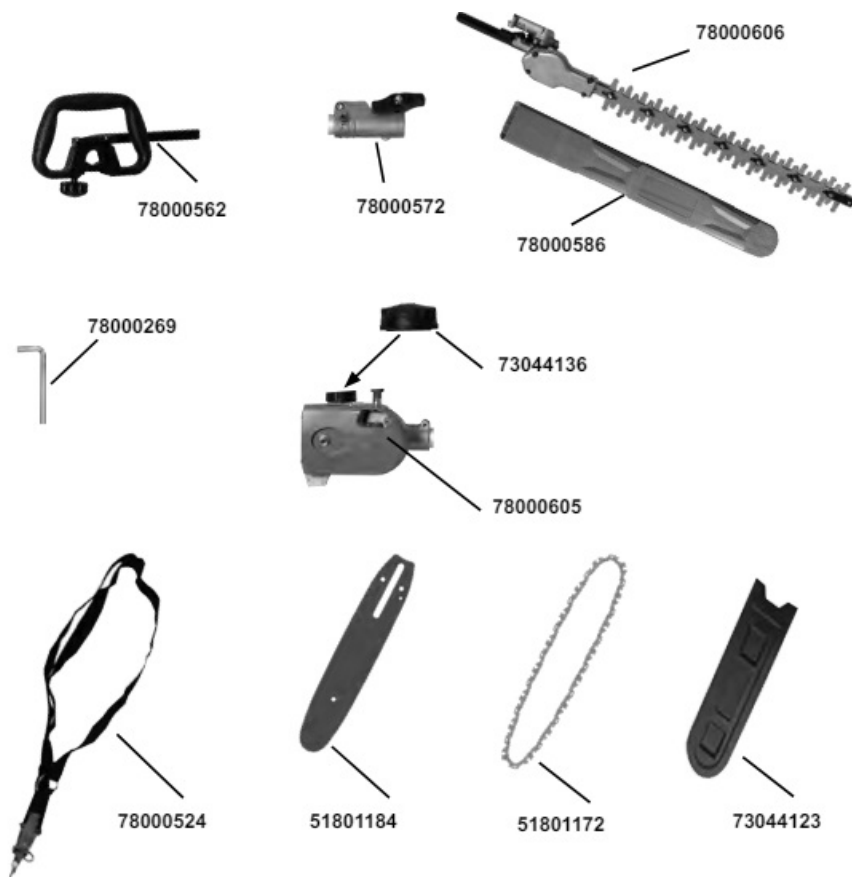

## Warranty conditions

### Warranty period:

IKRA provides a warranty for a period of 2 years in accordance with the following conditions for defects in IKRA products that are proven to be due to a manufacturing or material defect within the warranty period. The warranty period begins with the purchase, so that the date on the original purchase receipt is decisive.

### Warranty provider:

ikra GmbH, Schlesier Straße 36, D-64839 Münster-Altheim, Germany (hereafter referred to as IKRA)

### Area of validity:

The warranty is only intended for consumers. A consumer (hereafter referred to as the purchaser) is any natural person who concludes a legal transaction for purposes that are predominantly attributed neither to commercial activities nor to self-employed work-related activities. The warranty is valid for IKRA products purchased within the EU.

### No restriction of the legal rights of the purchaser:

The purchaser's warranty claims arising from the purchase contract with the seller as well as statutory rights are not affected by this warranty, the claiming of the aforementioned rights is free of charge.

The warranty shall not apply or shall expire in the following cases:

- Batteries, chargers and accessories that are due to use or other natural wear
- Demonstration devices / used products
- Defects due to improper or inappropriate use, e.g. commercial use, non-observance of operating instructions, use other than for the intended purpose, lack of maintenance and care
- Defects that arise from the use of incorrect accessory parts
- Defects due to external influences, e.g. transport damage, weather damage, impact or breakage
- IKRA products on which modifications or additions have been made or which have been completely or partially

dismantled

- Defects caused by incorrect voltage (mains voltage), e.g. when used abroad
- Repairs with non-original parts (original spare parts can be found here: [www.ikra.de/ersatzteile/](http://www.ikra.de/ersatzteile/))
- Use of force, deliberate overloading of the motor

Repairs under warranty may only be carried out by authorised workshops, otherwise the warranty shall be voided. Service addresses can be found at [www.ikra.de/serviceadressen](http://www.ikra.de/serviceadressen).

#### Enforcement of the warranty (warranty claim):

If the product does not function during the warranty period or does not function as intended for use, this is a warranty claim.

In the event of a warranty claim, IKRA shall bear the repair and material costs for defective parts.

The competent staff of the IKRA customer hotline and technical hotline are available to the purchaser for advice and assistance during the entire warranty period and can check to what extent a replacement part can remedy the defect without sending for repair.

Tel: +49 (0) 6071-3003-0

E-mail: [kundenservice@ikra.de](mailto:kundenservice@ikra.de)

If only a repair can remedy the defect, you can use our report form within Germany, providing important data (including the receipt), so that the return is free of charge for you: [www.ikra.de/defektes-produkt](http://www.ikra.de/defektes-produkt)

Shipping costs incurred from or within countries other than Germany, as well as customs and import duties, shall be borne by the purchaser.

If a repair is uneconomical, IKRA reserves the right to provide the purchaser with a replacement device (incl. successor models). The refund of the purchase price is excluded within the scope of the warranty. A repair or replacement device does not lead to a new start of the warranty, IKRA does not provide the purchaser with loan devices during the repair.

The assignment of any claims against this warranty is excluded. The laws of the Federal Republic of Germany shall apply to this contract, with the exception of the UN Convention on the International Sale of Goods (CISG). The place of performance for the warranty obligation is Germany.

#### EC DECLARATION OF CONFORMITY

explains the following conformity according to EU directives and norms for the following product

Latest service addresses can be found under:

[www.ikra.de](http://www.ikra.de)

## Documents / Resources

	<p><a href="#">IKRA ITHK 1000 Multi Function Garden Tool</a> [pdf] Instruction Manual</p> <p>ITHK 1000 Multi Function Garden Tool, ITHK 1000, Multi Function Garden Tool, Function Garden Tool, Garden Tool</p>
---	---

## References

- [User Manual](#)

[Manuals+](#), [Privacy Policy](#)

This website is an independent publication and is neither affiliated with nor endorsed by any of the trademark owners. The "Bluetooth®" word mark and logos are registered trademarks owned by Bluetooth SIG, Inc. The "Wi-Fi®" word mark and logos are registered trademarks owned by the Wi-Fi Alliance. Any use of these marks on this website does not imply any affiliation with or endorsement.