



IKEA UNRESTRICTED Record Player User Guide

[Home](#) » [Ikea](#) » **IKEA UNRESTRICTED Record Player User Guide** 



Design and Quality IKEA of Sweden

OBEGRÄNSAD

Contents

- [1 UNRESTRICTED Record Player](#)
- [2 Before use](#)
- [3 Installation](#)
- [4 Features](#)
- [5 Parts](#)
- [6 How to play vinyl records](#)
- [7 Cleaning](#)
- [8 Other](#)
- [9 Documents / Resources](#)
- [10 Related Posts](#)

UNRESTRICTED Record Player

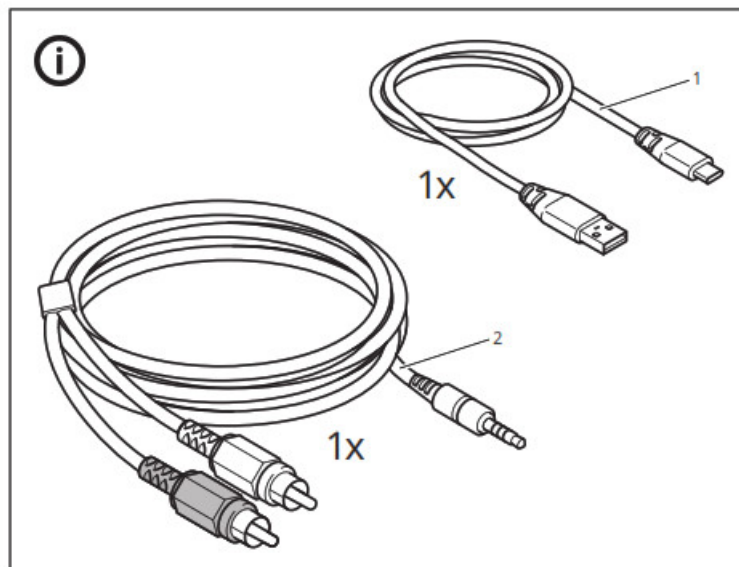
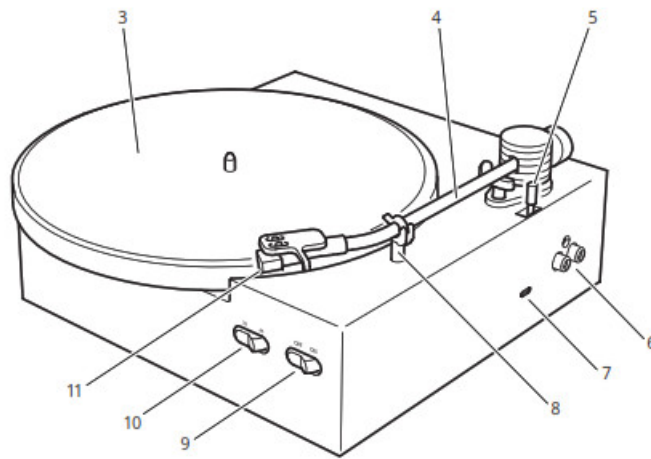

Before use

- Choose placement. Avoid placing the record player in direct sunlight or near any heat source. Also avoid locations subject to vibrations and excessive dust, heat, cold or moisture.
- The record player is designed to operate in a horizontal position only.
- If the record player is brought directly from a cold or warm location, moisture may condense inside the player and cause damage. When you first install the player, or when you move it from a cold to a warm location – wait for 30 minutes before starting the player.

Installation

- Connect the included RCA-cable (3.5 mm) to your stereo.
- Connect the included USB cable to a power source.

Features

- Outputs for RCA cables, so you can connect the record player to your speaker or stereo.

Parts

1. USB cable
2. RCA cable (3.5 mm)
3. Turntable
4. Tone arm and stylus
5. Lifter for tone arm
6. RCA output
7. USB input
8. Tone arm rest and security latch
9. Power switch
10. Speed switch
11. Cartridge/stylus

Caution

- To avoid stylus damage, ensure that the included stylus guard is in place when the record player is being installed, moved or cleaned.
- No naked flame sources, such as lighted candles, should be placed on the apparatus.
- temperature operating 0-40 degrees
- Prior to moving the turntable – always unplug it from the power outlet and fasten the tone arm by using the security latch.
- To prevent fire or electric shock, disconnect the unit from the power source when cleaning.
- Use caution when cleaning and wiping the player.

How to play vinyl records

1. Place the vinyl record on the turntable.
2. Press power switch to 'on'.
3. Choose 33 or 45 RPM by using the speed switch.
4. Loosen the security latch.
5. Lift the tone arm, move it over the record and lower it. The record now starts playing.
6. When finished – raise the tone arm, move it back to the rest and lower the arm.

Cleaning

- Do not touch the stylus tip with your fingers, avoid bumping the stylus on the turntable's mat or on a record's edge.
- Clean the stylus tip frequently, using a soft brush with a back-to-front motion only. If you use a stylus cleaning fluid, use it very sparingly.
- Wipe the turntable housing gently with a soft cloth. Use only a small amount of mild detergent solution to clean the turntable.

Other

This device complies with part 15 of the FCC Rules ((Federal Communications Commission Statement). Operation is subject to the following conditions: (1) this device may not cause harmful interference and (2) this device shall accept any interference received, including interference that may cause undesired operation.

WARNING: Any changes or modifications to this unit not expressly approved by the party responsible for compliance could void the user’s authority to operate the equipment.

Note: This equipment has been tested and found to comply with the limits for a Class B digital device, pursuant to part 15 of the FCC Rules. These limits are designed to provide reasonable protection against harmful interference in a residential installation. This equipment generates, uses and can radiate radio frequency energy and, if not installed and used in accordance with the instructions, may cause harmful interference to radio communications. However, there is no guarantee that interference will not occur in a particular installation. If this equipment does cause harmful interference to radio or television reception, which can be determined by turning the equipment off and on, the user is encouraged to try to correct the interference by one or more of the following measures:

- Reorient or relocate the receiving antenna.
- Increase the separation between the equipment and receiver.
- Connect the equipment into an outlet on a circuit different from that to which the receiver is connected.
- Consult the dealer or an experienced radio/TV technician for help. For indoor use only.

Manufacturer: IKEA of Sweden AB



Address: Box 702, SE-343 81 Älmhult, SWEDEN The crossed-out wheeled bin symbol indicates that the item should be disposed of separately from household waste. The item should be handed in for recycling in accordance with local environmental regulations for waste disposal. By separating a marked item from household waste, you will help reduce the volume of waste sent to incinerators or land-fill and minimize any potential negative impact on human health and the environment. For more information, please contact your IKEA store.

Documents / Resources

<div>OBEGRÄNSAD</div> <div></div>	<div>IKEA UNRESTRICTED Record Player [pdf] User Guide</div> <div>AA-2337099-2-2, UNRESTRICTED, UNRESTRICTED Record Player, Record Player, Player</div>
--	--