



## IKEA SYMFONISK Floor Lamp User Manual

[Home](#) » [Ikea](#) » IKEA SYMFONISK Floor Lamp User Manual 

### Contents

- [1 KEA SYMFONISK Floor Lamp](#)
- [2 Product Information](#)
- [3 Product Usage Instructions](#)
- [4 DIMENSION](#)
- [5 ASSEMBLE INSTRUCTION](#)
- [6 HOW TO SWITCH ON/OFF](#)
  - [6.1 WARNING](#)
- [7 BUTTON FUNCTION](#)
- [8 Documents / Resources](#)
- [9 Related Posts](#)



**KEA SYMFONISK Floor Lamp**

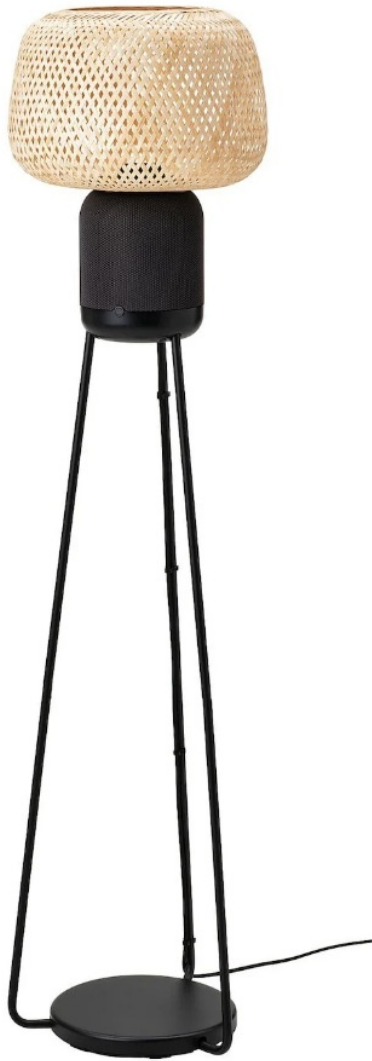

## Product Information

The product is a SYMFONISK lamp, which is a smart lamp that can be used as a speaker. The lamp has an external flexible cable or cord that should be exclusively replaced by the manufacturer or a qualified person to avoid any hazards.

### The product comes with the following items:

- 1x SYMFONISK lamp
- 6x screws (10097846)
- 4x screws (10089605)
- 3x screws (10097847)
- 7x plugs (10097832)
- 1x plug (10089605)
- 1x power cord (10097844)

The product manual is available in English, Dutch, Latvian, Lithuanian, Croatian, Serbian, Slovenian, Indonesian, and Malaysian languages.

## Product Usage Instructions

1. Refer to the manual in your preferred language before using the product.
2. Connect the power cord to the lamp and plug it into an electrical outlet.
3. If the external flexible cable or cord is damaged, do not attempt to replace it yourself. Contact the manufacturer or a qualified person to replace it for you.
4. Use the screws and plugs provided to install the lamp on a suitable surface.
5. The lamp can be used as a speaker by connecting it to a compatible device via Wi-Fi or Bluetooth.
6. Follow the instructions in the manual to connect your device to the lamp and enjoy your music.

**Note:** The product should only be used indoors and should not be exposed to water or moisture.

If the external flexible cable or cord of this luminaire is damaged, it shall be exclusively replaced by the manufacturer or his service agent or a similar qualified person in order to avoid a hazard. If you are uncertain, please contact IKEA.

## DIMENSION

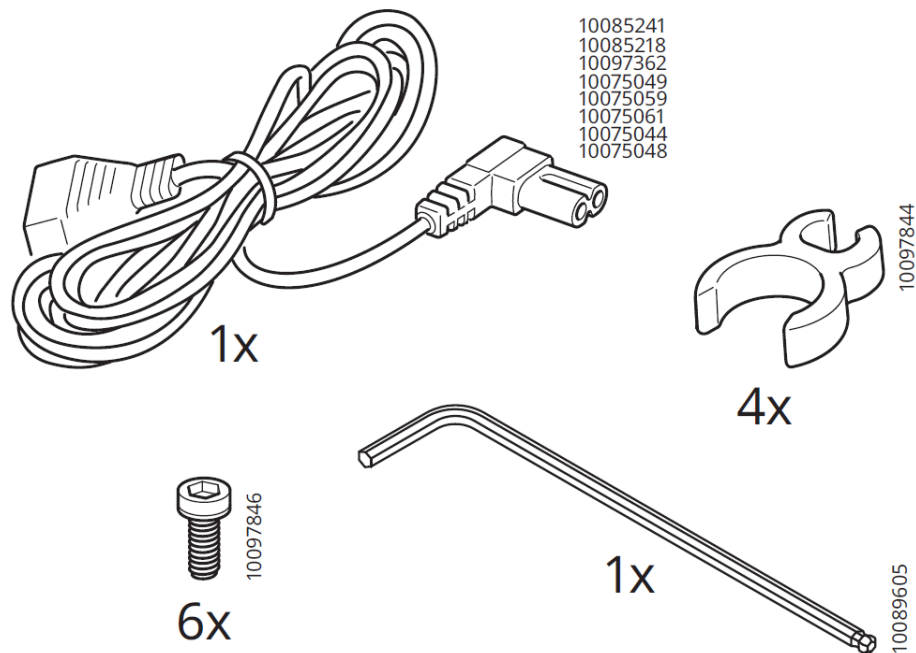

## ASSEMBLE INSTRUCTION

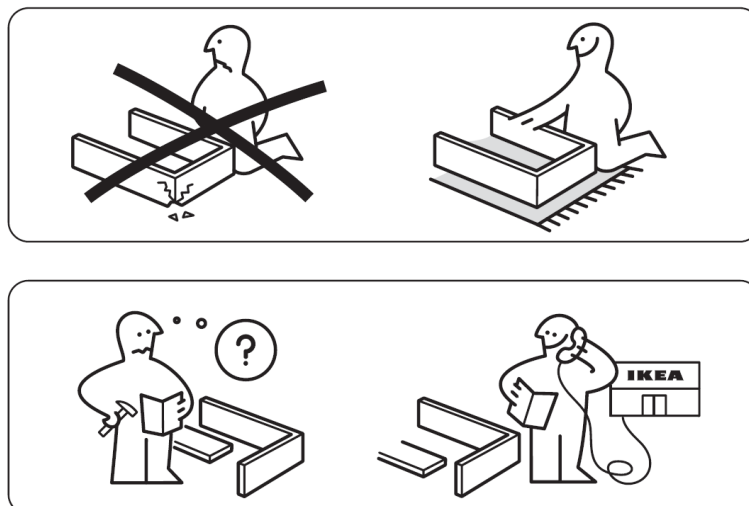

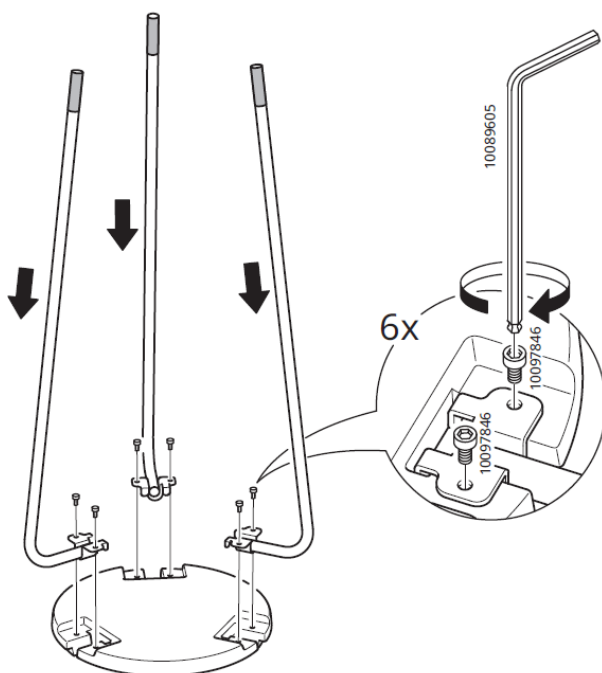
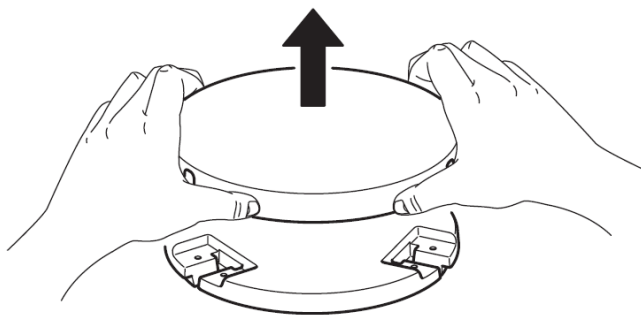

3

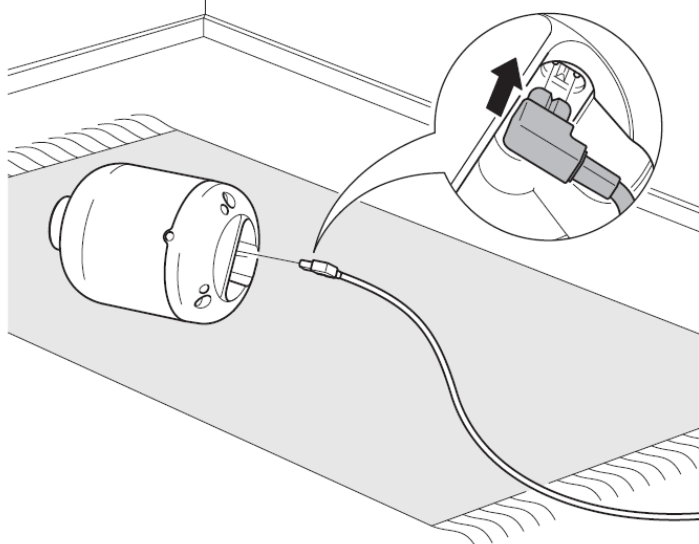
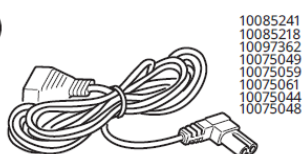

4

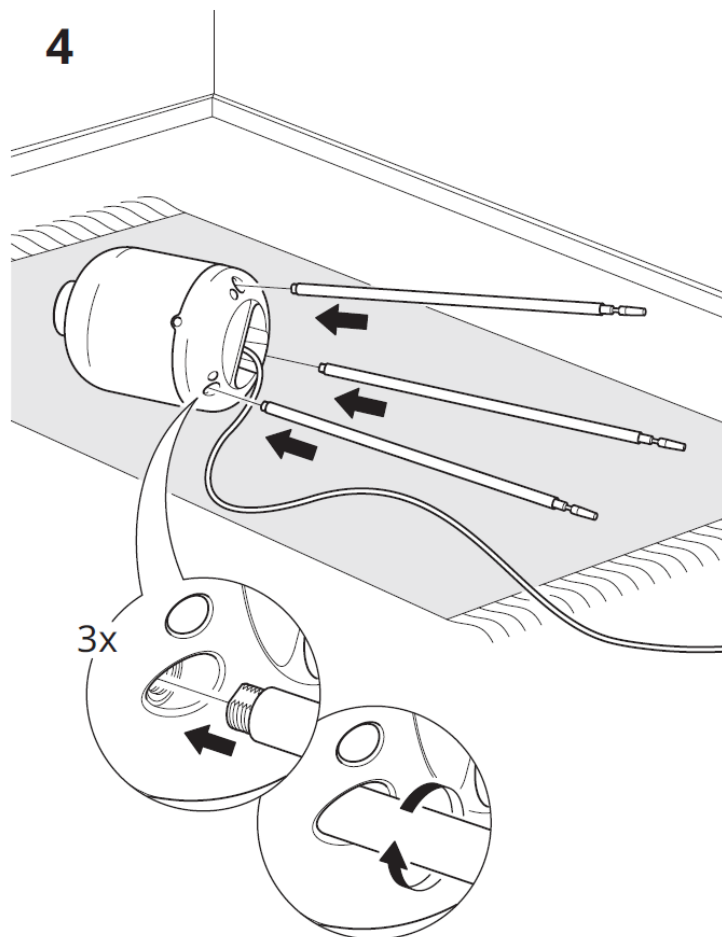

5

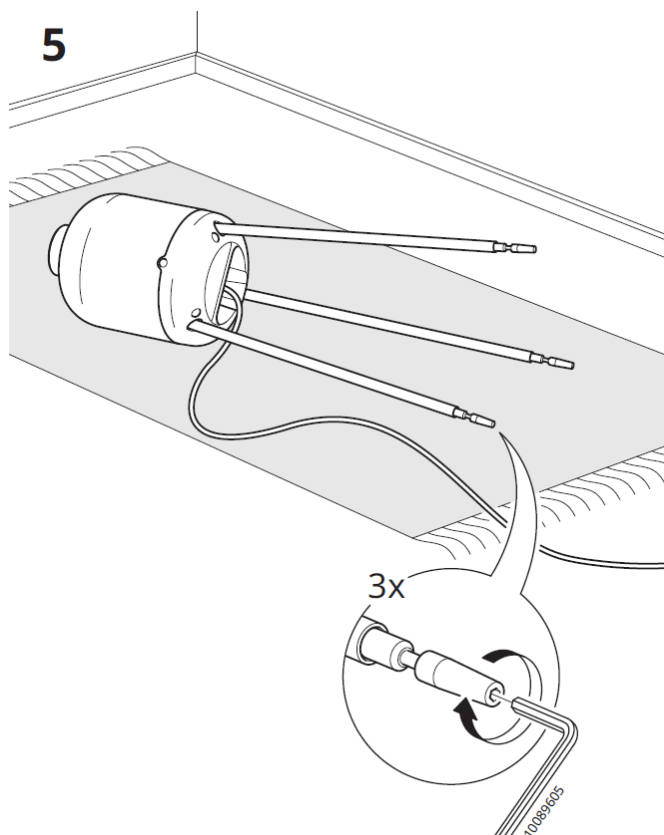

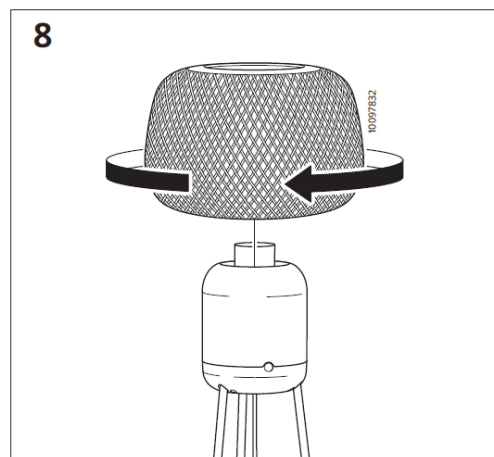
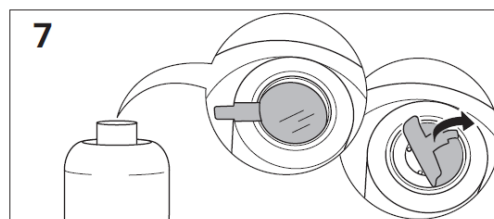
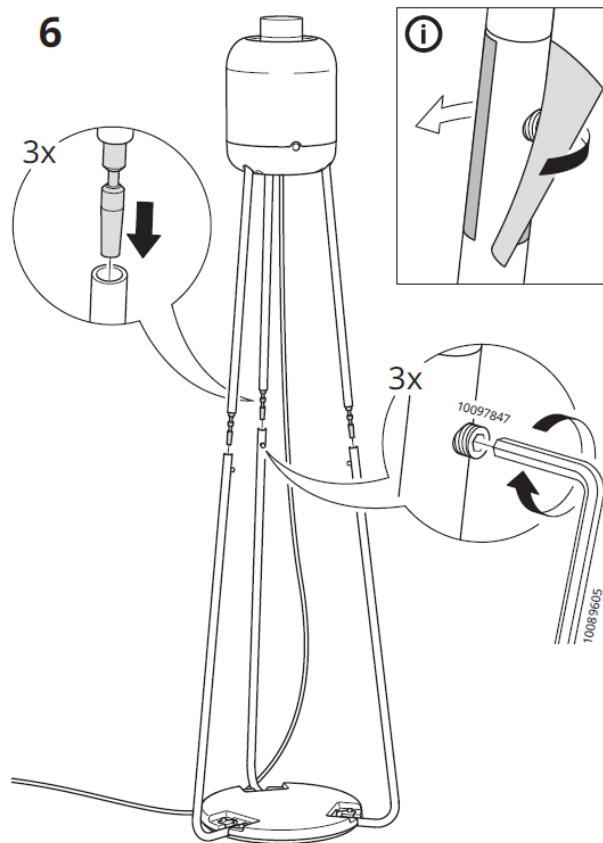

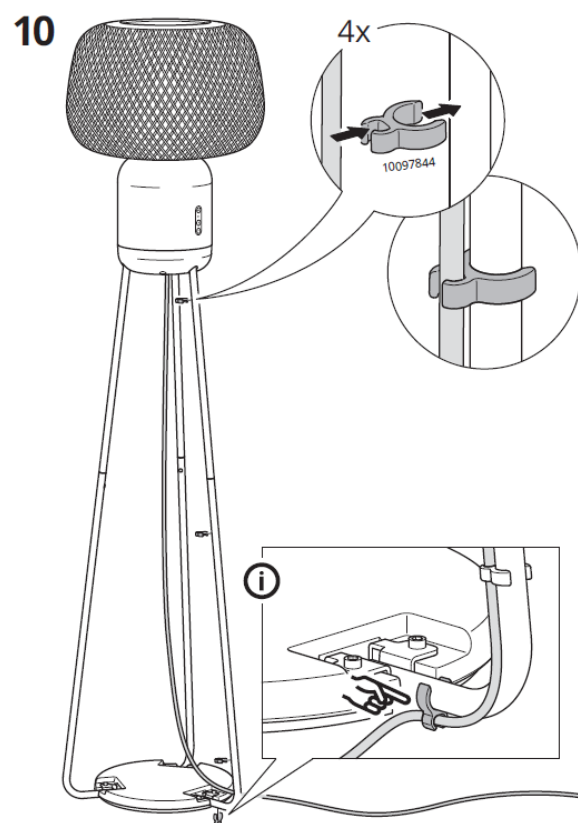
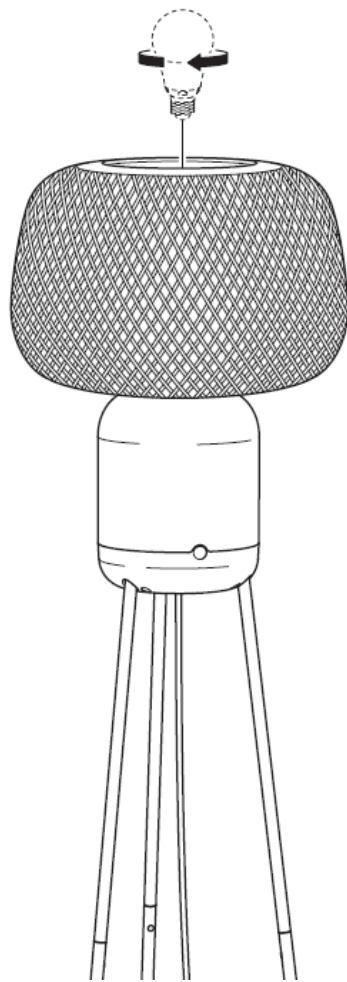

**HOW TO SWITCH ON/OFF**

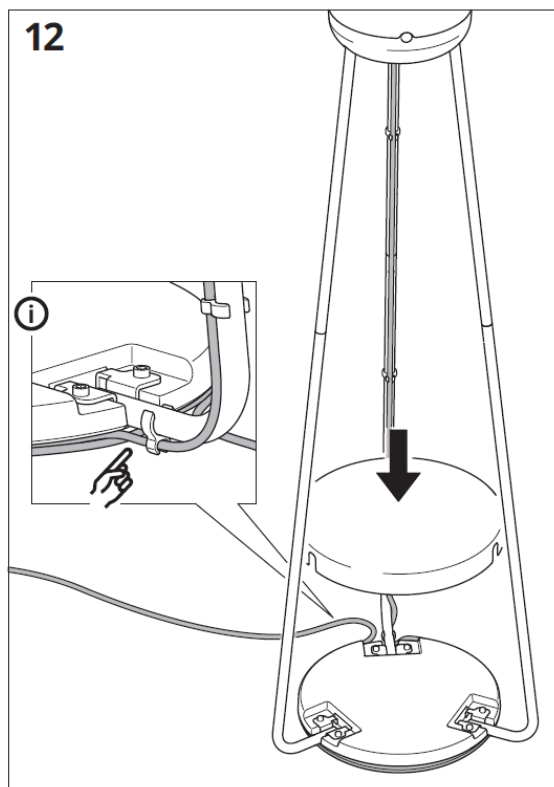
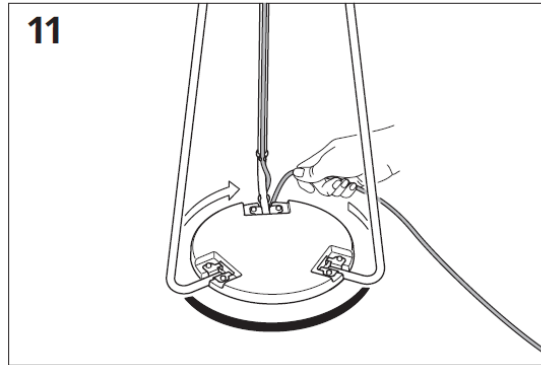
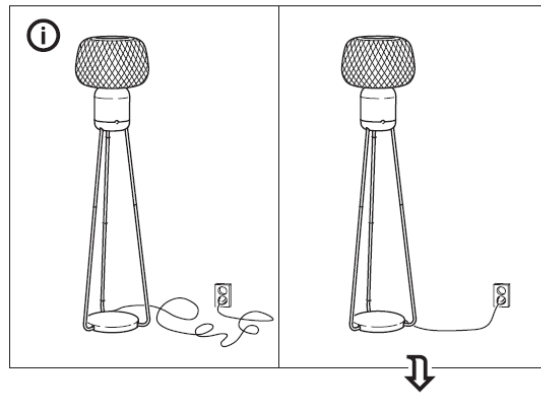



13

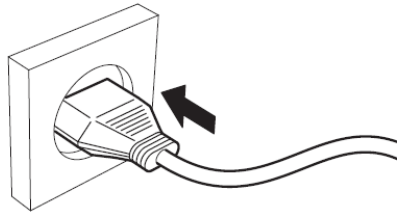

i

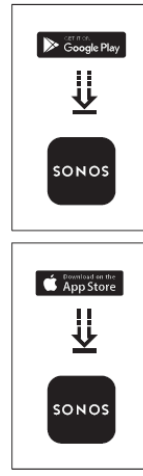

**WARNING**

i

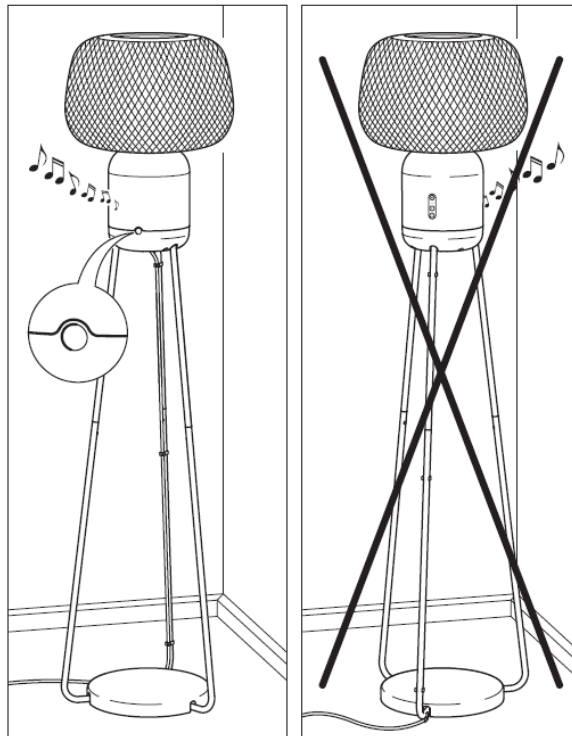

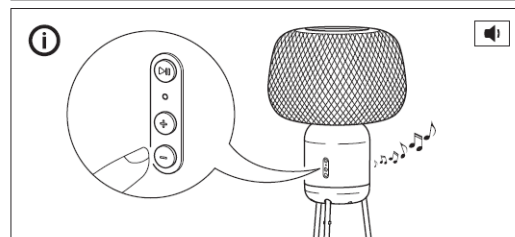
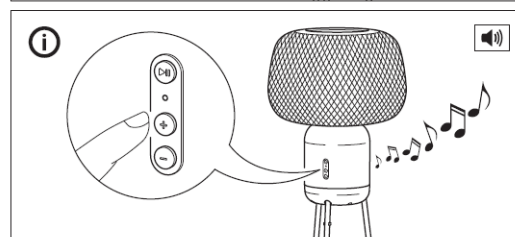
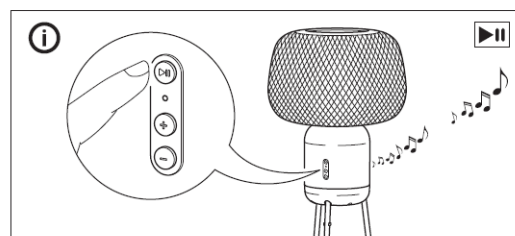
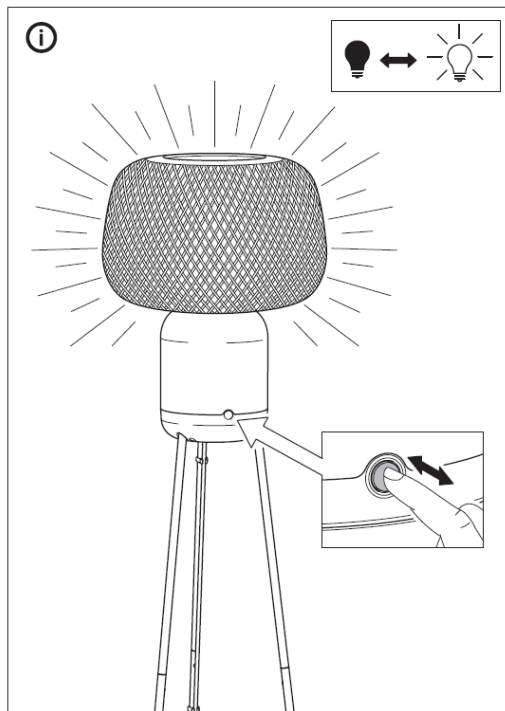

## BUTTON FUNCTION

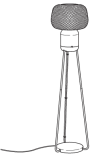

© Inter IKEA Systems B.V.  
2022 2022-06-17  
AA-2355067-1

## Documents / Resources

<p><b>SYMFONISK</b></p>  	<p><a href="#">IKEA SYMFONISK Floor Lamp [pdf] User Manual</a> 505.282.78, SYMFONISK Floor Lamp, SYMFONISK, SYMFONISK Lamp, Floor Lamp, Lamp</p>
---	--

