



IKEA SYMFONISK 2nd Gen Sound Remote Instruction Manual

[Home](#) » [Ikea](#) » IKEA SYMFONISK 2nd Gen Sound Remote Instruction Manual 



Design and Quality
IKEA of Sweden
SYMFONISK 2nd Gen Sound Remote
Instruction Manual

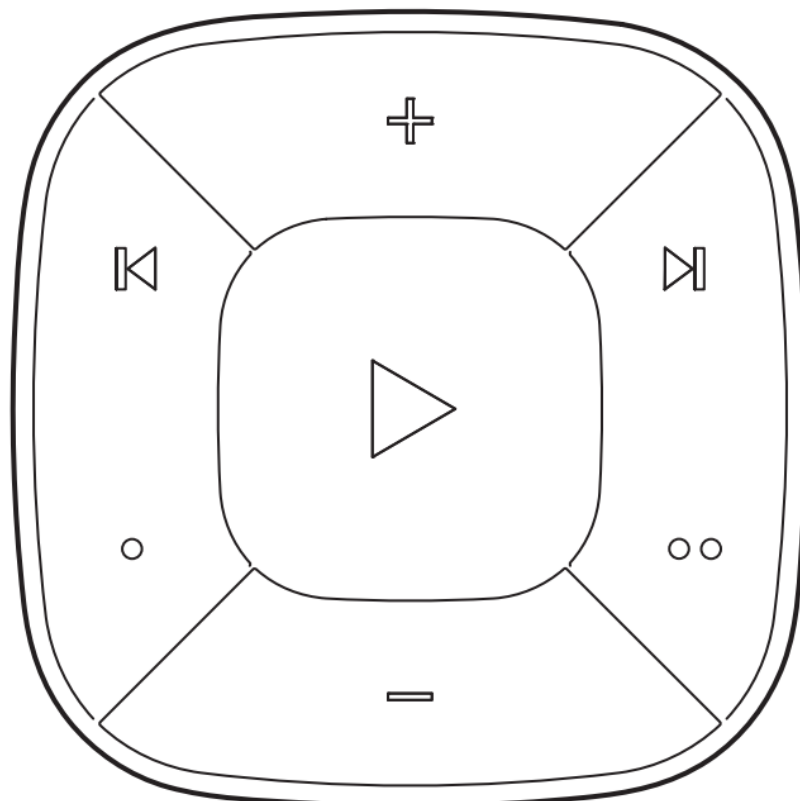

Contents

- [1 SYMFONISK 2nd Gen Sound Remote](#)
- [2 Getting started](#)
- [3 Care instructions](#)
- [4 Changing the batteries](#)
- [5 RF EXPOSURE INFORMATION](#)
- [6 Documents / Resources](#)
- [7 Related Posts](#)

SYMFONISK 2nd Gen Sound Remote

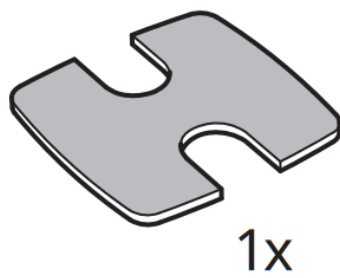
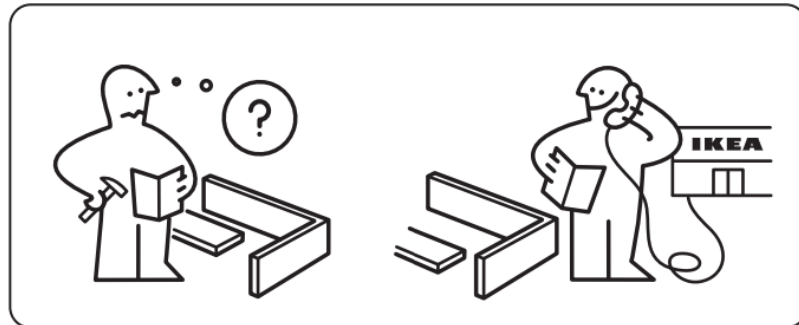

10071830

1x

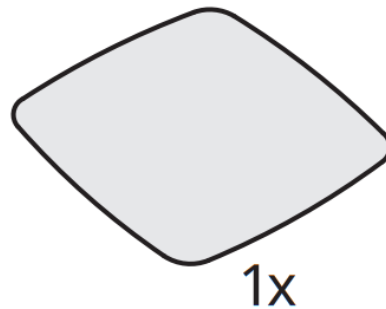

1x

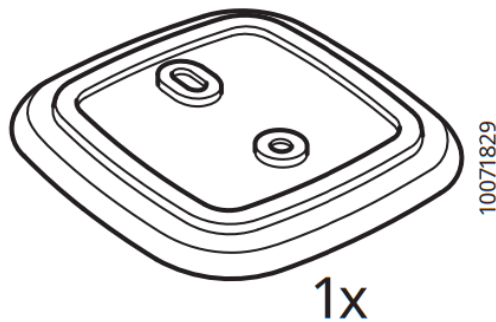

10071829

1x

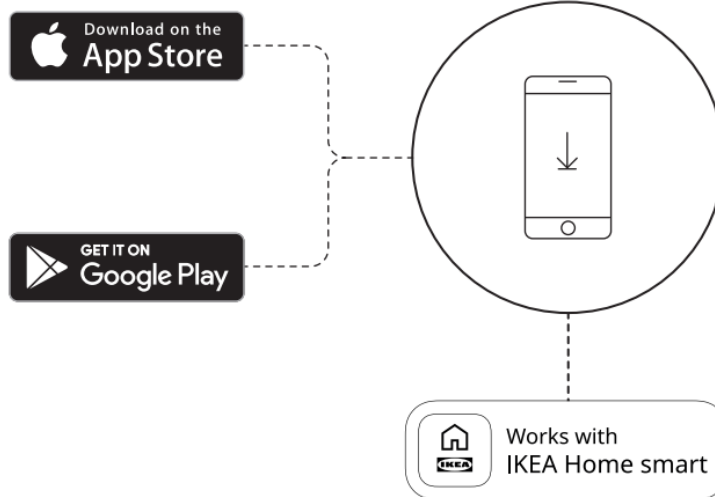
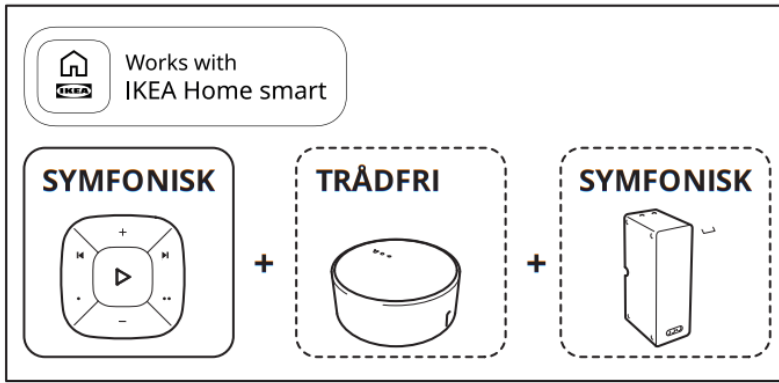

1



2

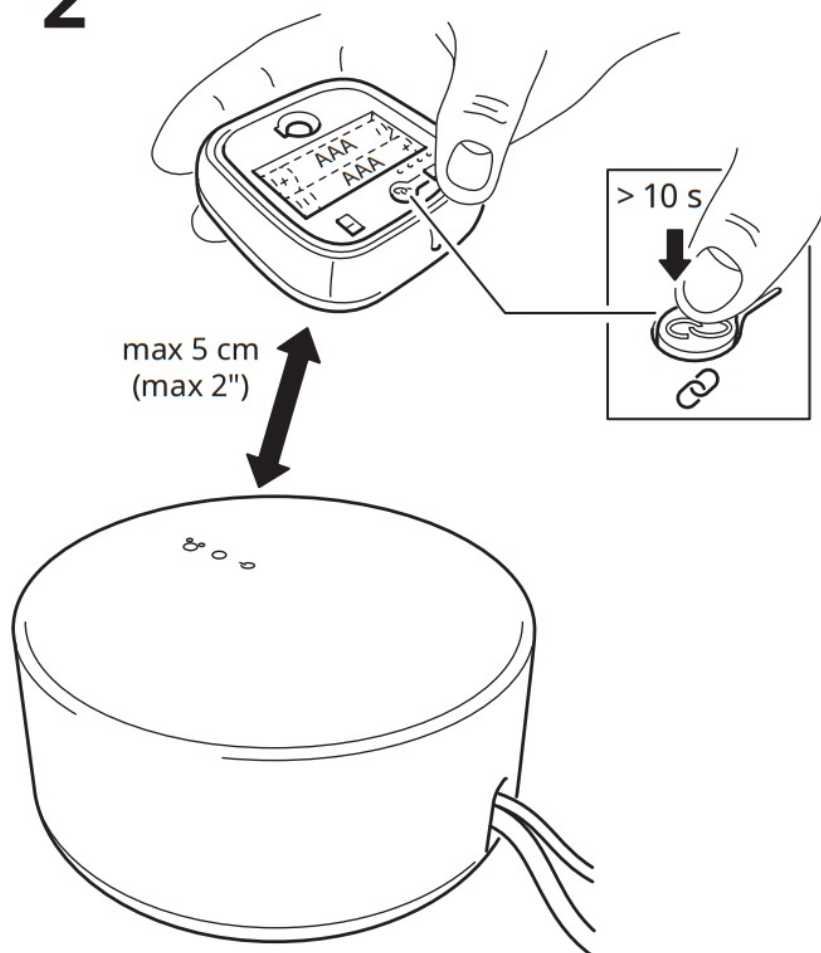

3

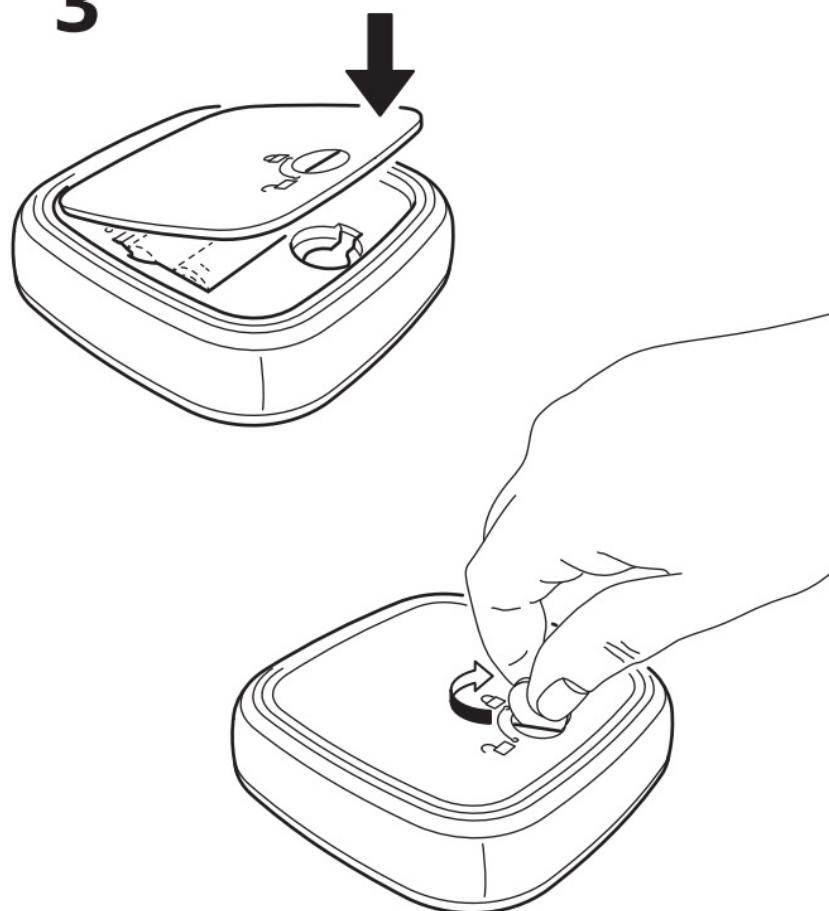

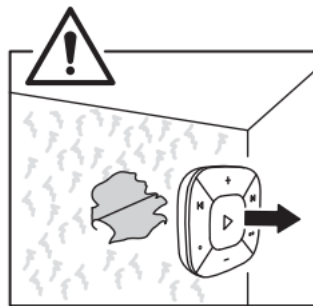
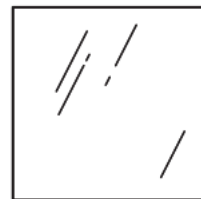
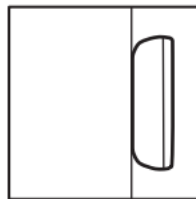
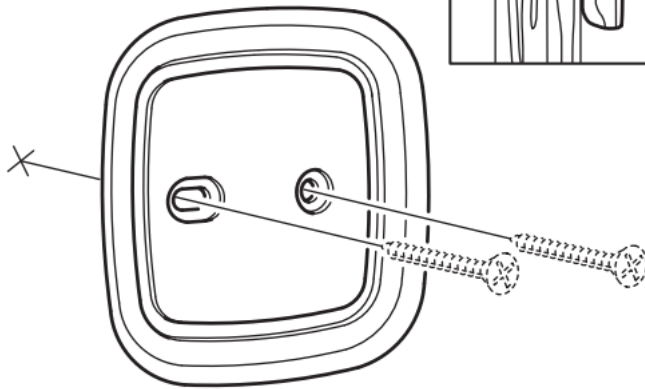
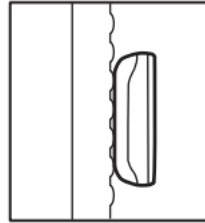
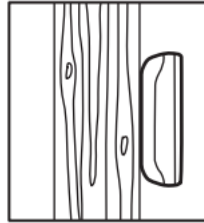

4

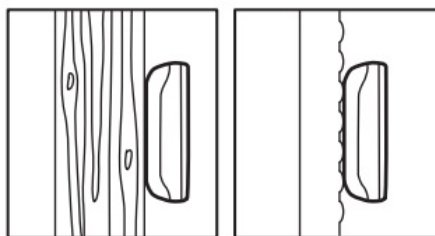
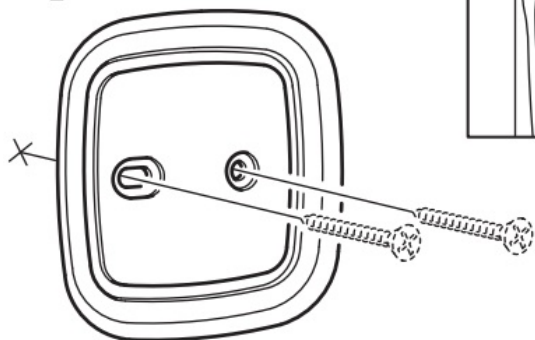

5

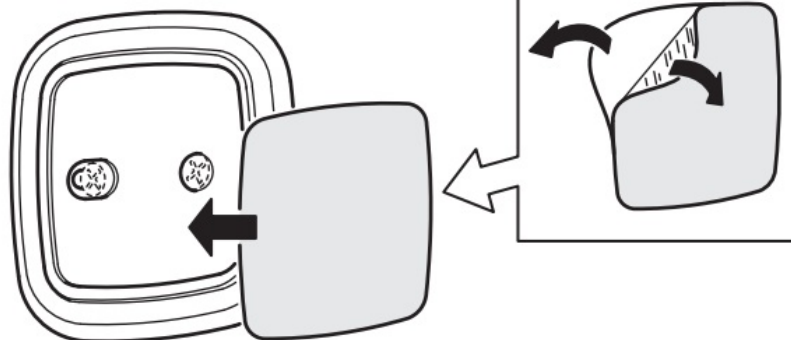

6

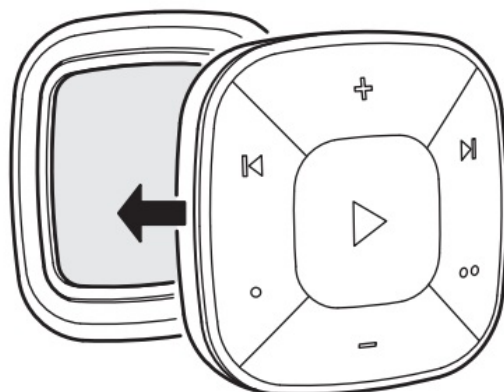

4

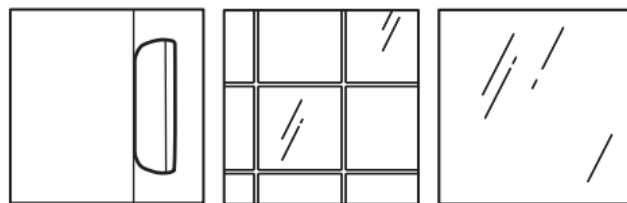

5

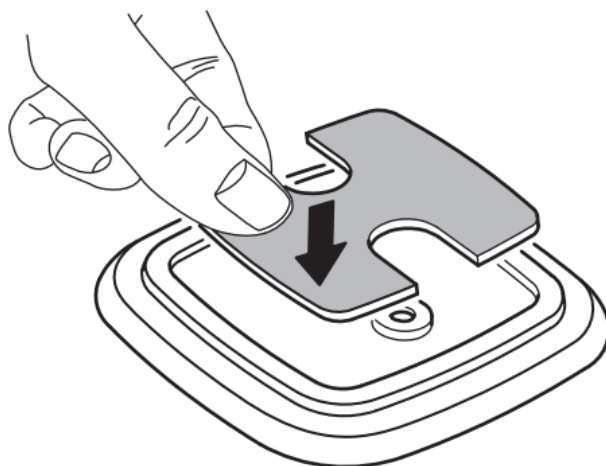

6



7

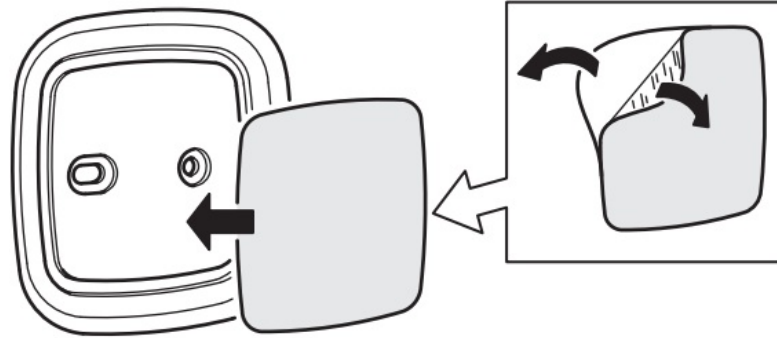

8

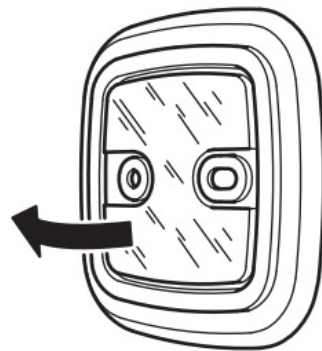

9

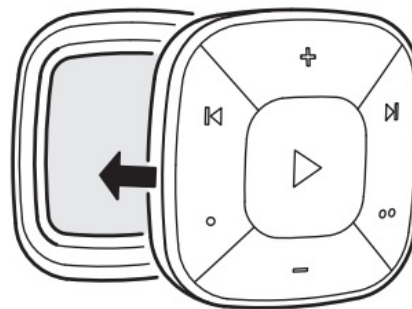

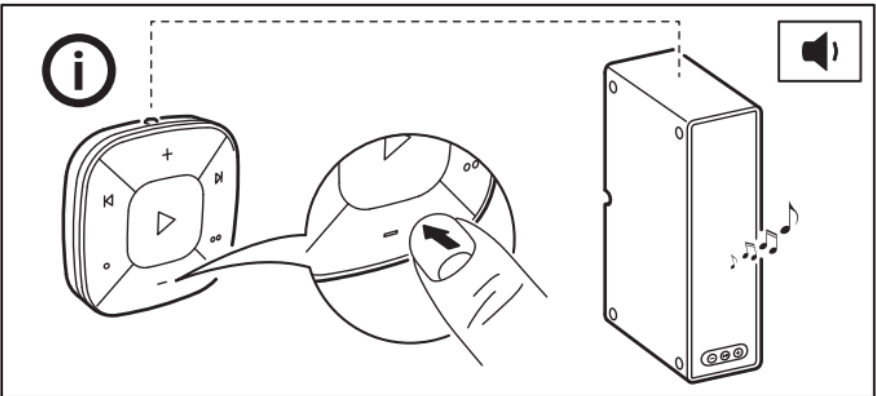
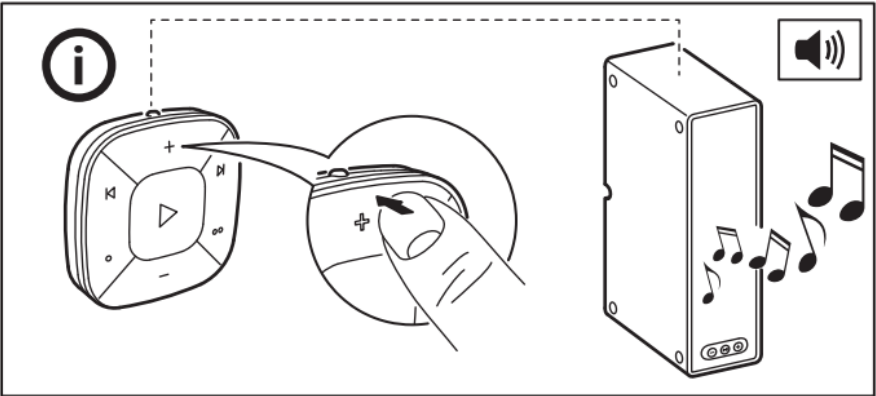
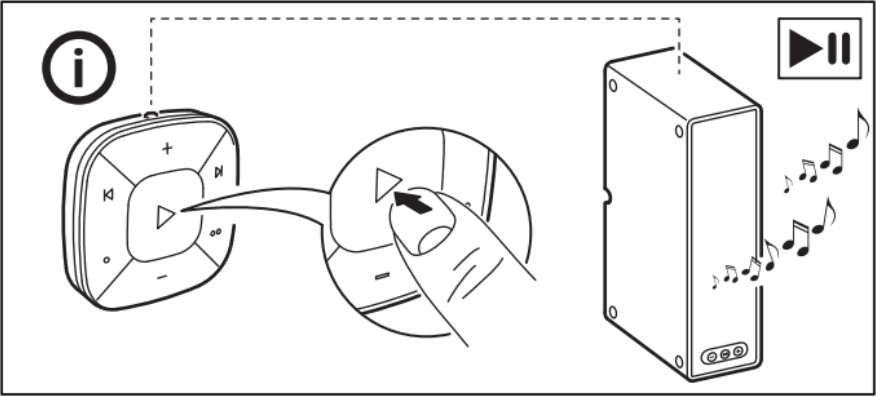

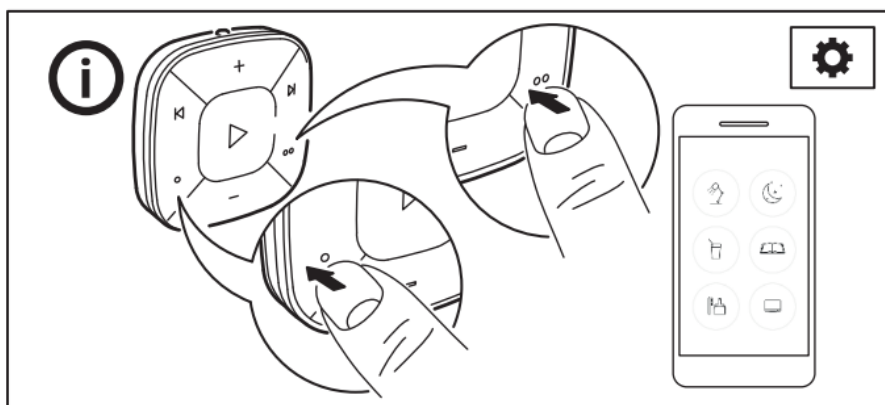
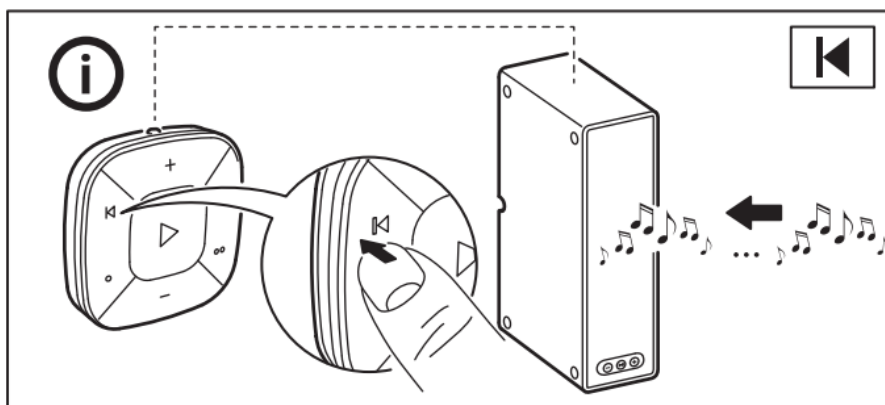
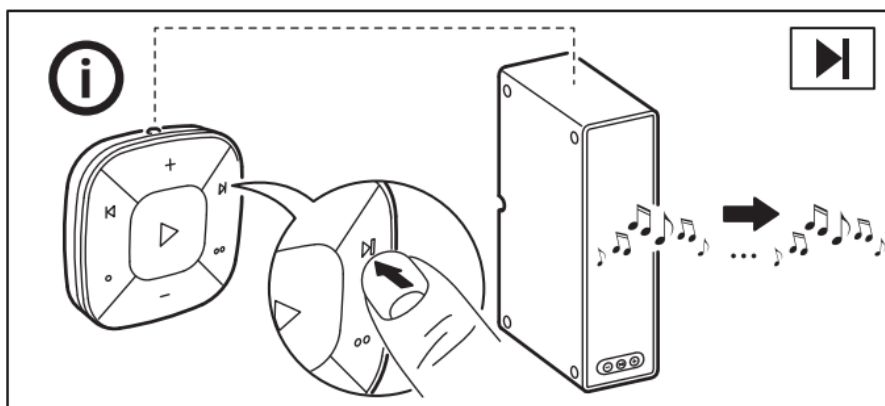

SYMFONISK sound remote overview

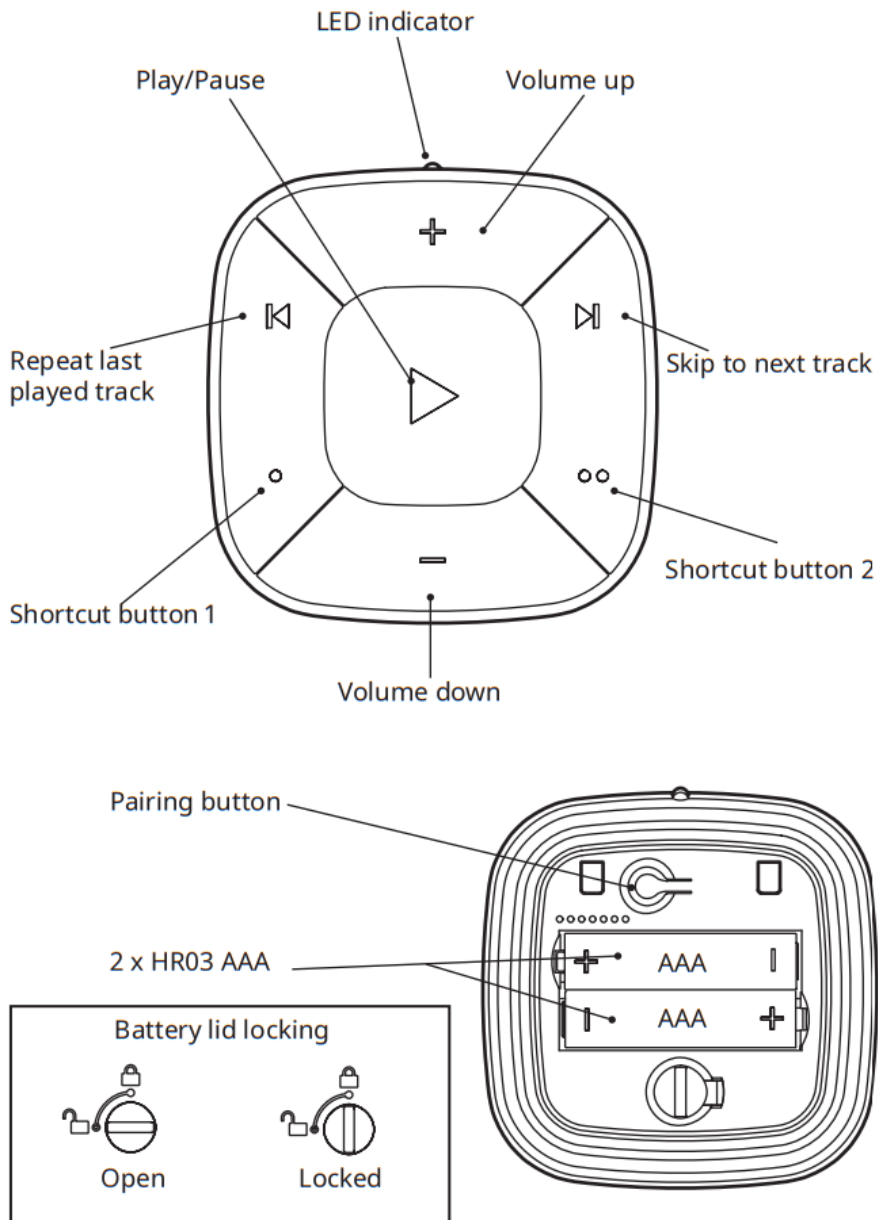

IMPORTANT

SYMFONISK sound remote is made to work together with IKEA gateway or hub and control your SYMFONISK speakers.

Use the IKEA Home smart app to add more functions to your sound remote.

You cannot add "Works with IKEA Home smart" marked products directly to your sound remote.

If you have an Apple device

Go to the App Store and download the IKEA Home smart app. The app will take you through the process of installing your SYMFONISK sound remote and other "Works with IKEA Home smart" devices.

If you have an Android device

Go to the Google Play store and download the IKEA Home smart app. The app will take you through the process of installing your SYMFONISK sound remote and other "Works with IKEA Home smart" devices.

Getting started

Insert 2 HR03 AAA 1.2V batteries with correct polarity. Start the IKEA Home smart app and follow the instructions in the app on how to set up your device and add scenes to the shortcut buttons.

Close the battery lid and your sound remote is now ready for use.

Sound remote functions

**Play/pause**

Press once to start or stop the music.

**Repeat**

Press once to repeat the most recently played music.

**Skip**

Press once to skip to the next track.

**Raise and lower volume**

Press and hold to change the volume rapidly.

**Shortcut buttons**

Activates the scene you link to this button via the IKEA Home smart app. Scenes are set up in the IKEA Home smart app on your smart device.

Care instructions

To clean the sound remote, wipe with a soft moistened cloth, Use another soft, dry cloth to wipe dry.

Changing the batteries

When SYMFONISK sound remote is used regularly and as intended, the batteries will last for approximately 2 years. When it's time to replace the batteries, the red LED indicator on the back of the sound remote will flash when you use it.

Open the battery lid and replace the batteries with 2 new HR03 AAA 1.2V batteries.

WARNING!

Risk of explosion if either battery is replaced by an incorrect type. Dispose of used batteries according to the instructions.

IMPORTANT!

- SYMFONISK sound remote is for indoor use only and can be used in temperatures ranging from 0 °C to 40 °C (32°F to 104°F).
- Do not leave SYMFONISK sound remote in direct sunlight or near any heat source, as it may overheat.
- The range between SYMFONISK sound remote and the receiver is measured in open air.
- Different building materials and placement of the units can affect the wireless connectivity range.

Recommended batteries:

Batteries are sold separately. We recommend 2 x LADDA rechargeable batteries HR03 AAA 1.2V

Do not mix batteries of different capacities, types or date stamps.

Save these instructions for future use.

Technical data

Model: SYMFONISK sound remote gen 2

Type: E2123

Input: 2.4V, 2 x LADDA batteries HR03 AAA 1.2V

Range: 10 m unobstructed

For indoor use only

Operating frequency: 2400-2483.5 Mhz

Output power: 3 dBm (EIRP)

Manufacturer: IKEA of Sweden AB

Address: Box 702, SE-343 81 Älmhult, SWEDEN

This device complies with Part 15 of the FCC Rules.

This device contains licence-exempt transmitter(s)/ receiver(s) that comply with Innovation Science and Economic

Development Canada's licence-exempt RSS standard(s). Operation is subject to the following two conditions: (1) this device may not cause harmful interference, and
(2) this device must accept any interference received, including interference that may cause undesired operation of the device.

WARNING:

Any changes or modifications to this unit not expressly approved by the party responsible for compliance could void the user's authority to operate the equipment.

NOTE:

This equipment has been tested and found to comply with the limits for a Class B digital device, pursuant to part 15 of the FCC Rules. These limits are designed to provide reasonable protection against harmful interference in a residential installation.

This equipment generates, uses and can radiate radio frequency energy and, if not installed and used in accordance with the instructions, may cause harmful interference to radio communications. However, there is no guarantee that interference will not occur in a particular installation. If this equipment does cause harmful interference to radio or television reception, which can be determined by turning the equipment off and on, the user is encouraged to try to correct the interference by one or more of the following measures:

- Reorient or relocate the receiving antenna.
- Increase the separation between the equipment and receiver.
- Connect the equipment into an outlet on a circuit different from that to which the receiver is connected.
- Consult the dealer or an experienced radio/TV technician for help.

RF EXPOSURE INFORMATION

This product is approved as a portable handheld device (not body worn)

This product includes a static magnet, generating a magnetic field that might interfere with the normal operation of pacemakers, defibrillators, or other medical devices.

Maintain a safe distance of separation between your medical device and this device. Stop using this device and consult your physician or medical device manufacturer if you believe that it is interfering with your medical device.

License rights and limitations

NO RIGHTS OR LICENSES, EXPRESS NO RIGHTS OR LICENSES, EXPRESS OR IMPLIED, ARE GRANTED TO USE THIRD-PARTY DEVICES IN COMBINATION WITH THESE PRODUCTS IN A WIRELESS MESH NETWORK, OR TO USE THIRD-PARTY SERVICES TO ACCESS, MONITOR OR CONTROL THESE PRODUCTS IN A WIRELESS MESH NETWORK VIA THE INTERNET OR ANOTHER EXTERNAL WIDE AREA NETWORK.

For use pursuant to U.S. Patent Nos.:

US 6,914,893

US 7,697,492

US 8,964,708



The crossed-out wheeled bin symbol indicates that the item should be disposed of separately from household waste. The item should be handed in for recycling in accordance with local environmental regulations for waste disposal. By separating a marked item from household waste, you will help reduce the volume of waste sent to incinerators or land-fill and minimize any potential negative impact on human health and the environment. For more information, please contact your IKEA store.



MX

Importador: IKEA Supply Mexico, S.A. de C.V., Calle Oriente 158, número 440, Piso 3, Local JD-01, Colonia Moctezuma, Segunda Sección, Alcaldía Benito Juárez, C.P. 15530, Ciudad de México. Tel. 55-8310-8310.



Design and Quality
IKEA of Sweden

Documents / Resources

<div><div>SYMFONISK</div><div></div><div></div></div>	<div><div>IKEA SYMFONISK 2nd Gen Sound Remote [pdf] Instruction Manual</div><div>SYMFONISK 2nd Gen Sound Remote, SYMFONISK, 2nd Gen Sound Remote, Sound Remote , Remote, SYMFONISK Sound Remote, SYMFONISK Remote</div></div>
---	---