



# IKEA SUNDVIK Changing Table Chest of Drawers Instruction Manual

[Home](#) » [Ikea](#) » IKEA SUNDVIK Changing Table Chest of Drawers Instruction Manual 

## Contents

- [1 IKEA SUNDVIK Changing Table Chest of Drawers](#)
- [2 Product Information](#)
- [3 Product Usage Instructions](#)
- [4 Assembly Instructions](#)
- [5 Tools Required](#)
- [6 Installation](#)
- [7 FAQ](#)
- [8 Documents / Resources](#)
  - [8.1 References](#)



**IKEA SUNDVIK Changing Table Chest of Drawers**



## Product Information

### Specifications

- Product Name: SUNDVIK
- Languages: English

### Product Usage Instructions

#### WARNING

Children have died from furniture tipovers. To reduce the risk of furniture tip-over:

- ALWAYS install the anti-tip device provided.
- NEVER put a TV on this product.
- NEVER allow children to stand, climb, or hang on any drawers, doors, or shelves.
- NEVER open more than one drawer at a time.
- Place the heaviest items in the lowest drawers.

### Assembly Instructions

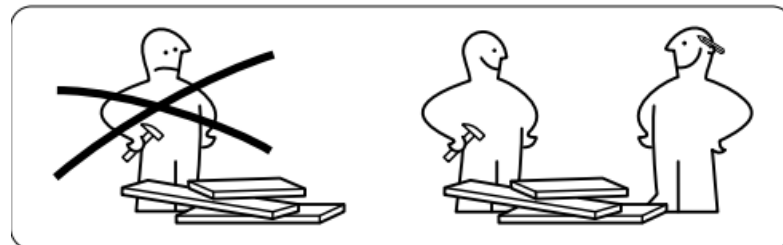
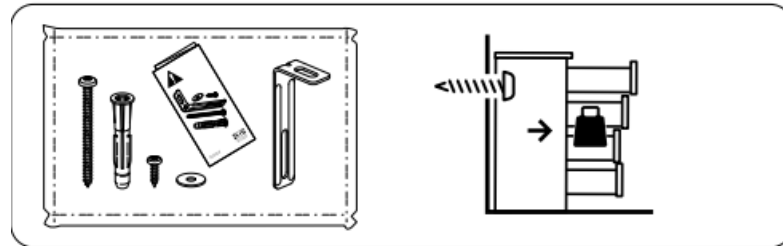
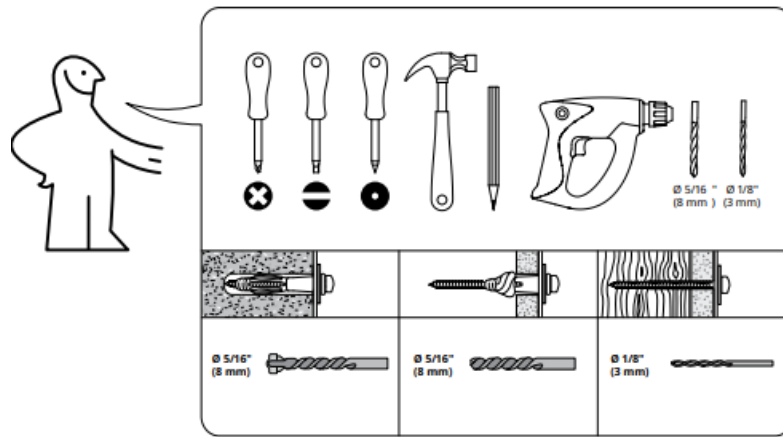

## Tools Required

1

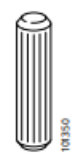

32x



16x



26x

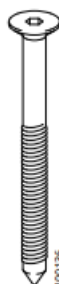

4x



4x

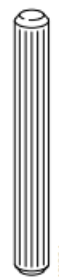

6x

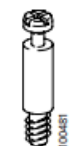

10x



4x



20x



4x



2x



4x



4x

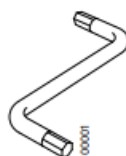

1x

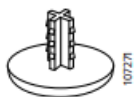

4x

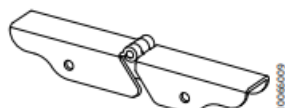

2x



2x



4x

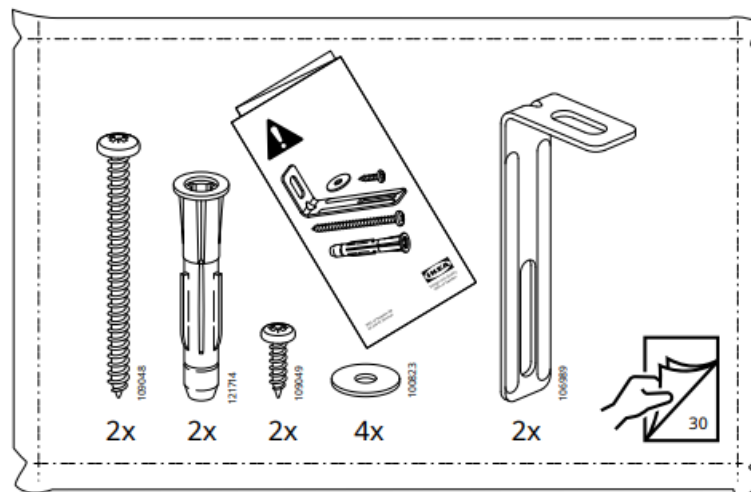
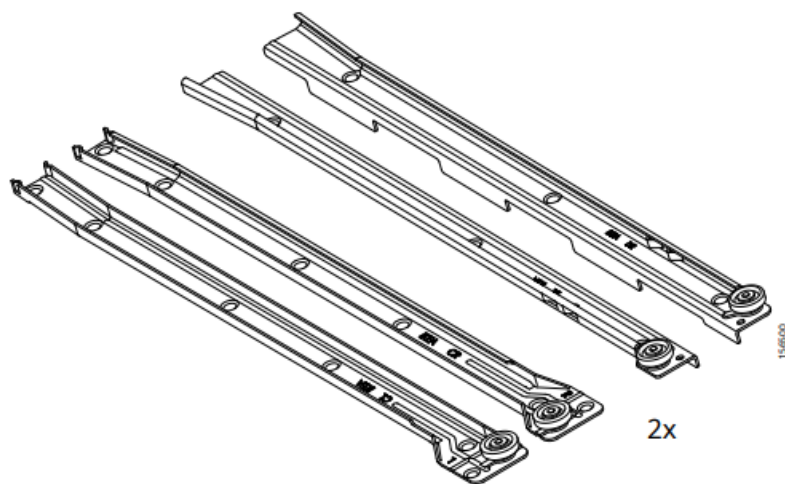
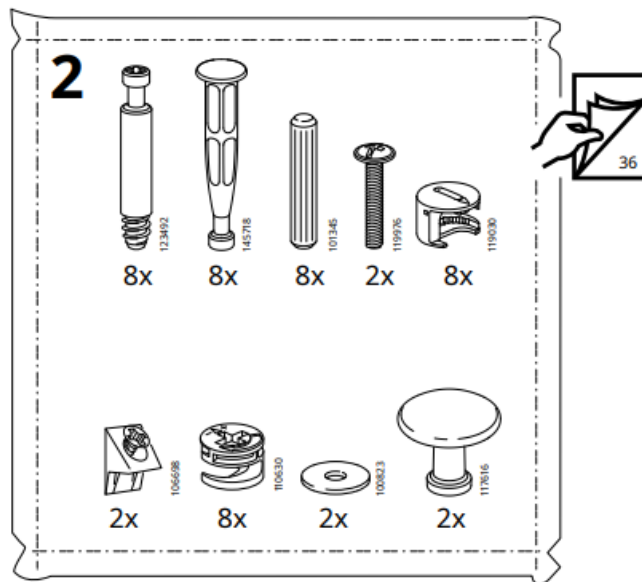

## Installation

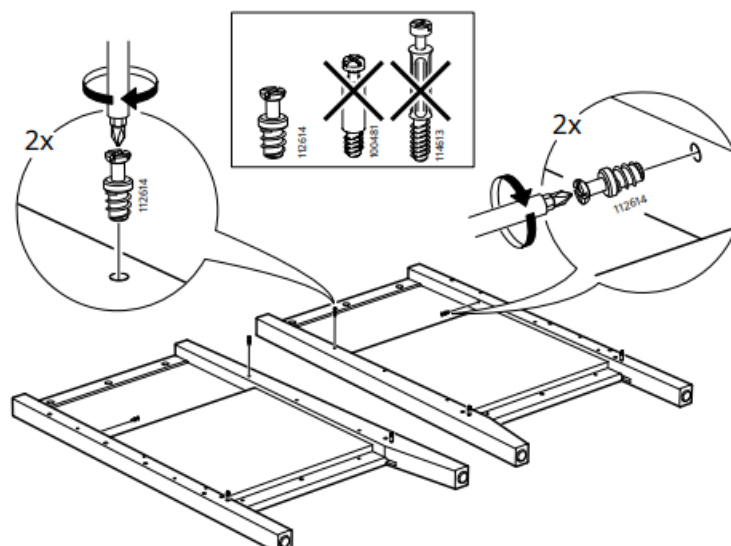
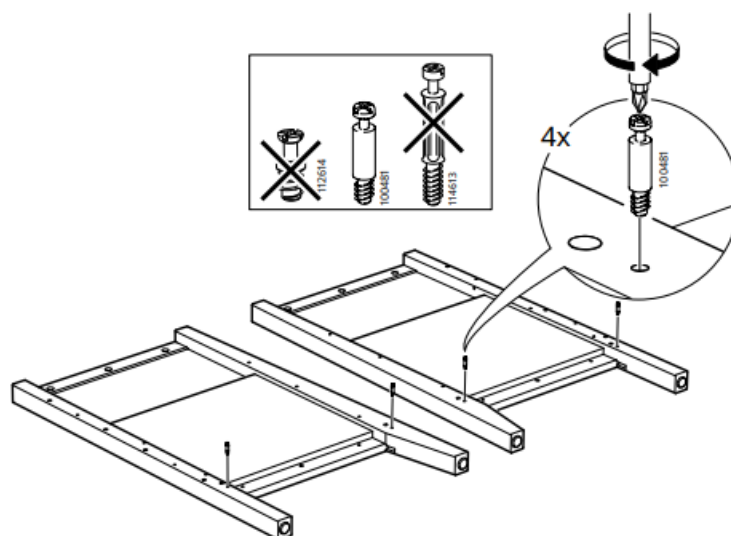
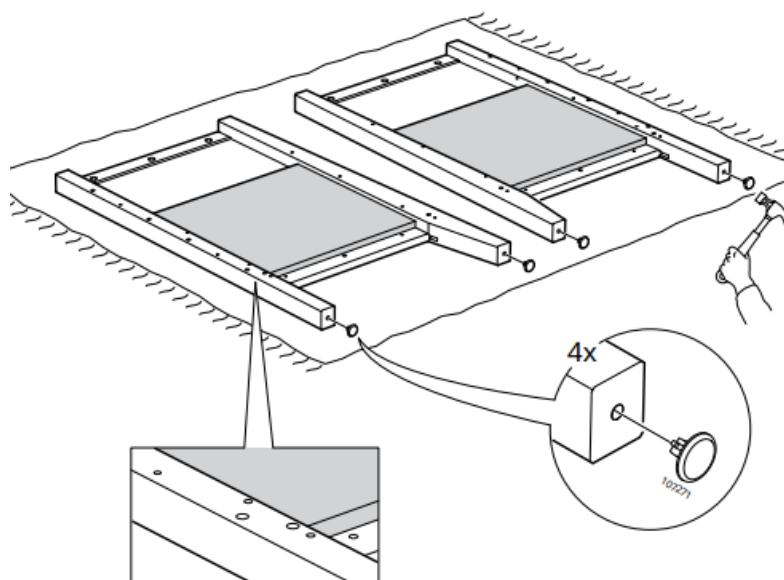

4

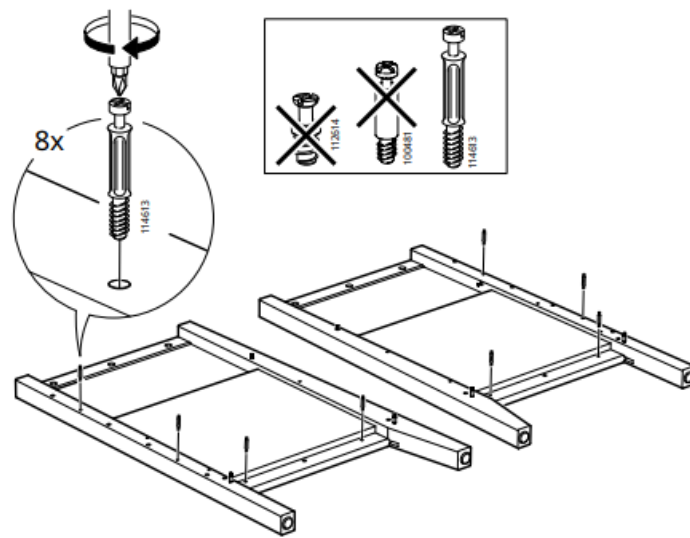

5

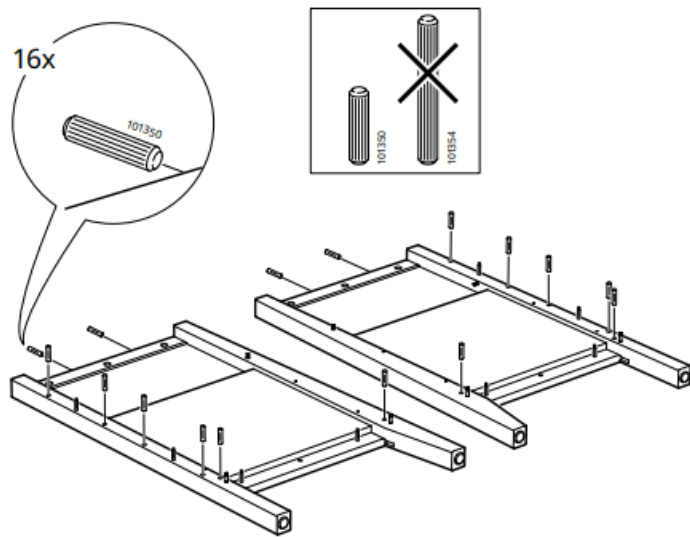

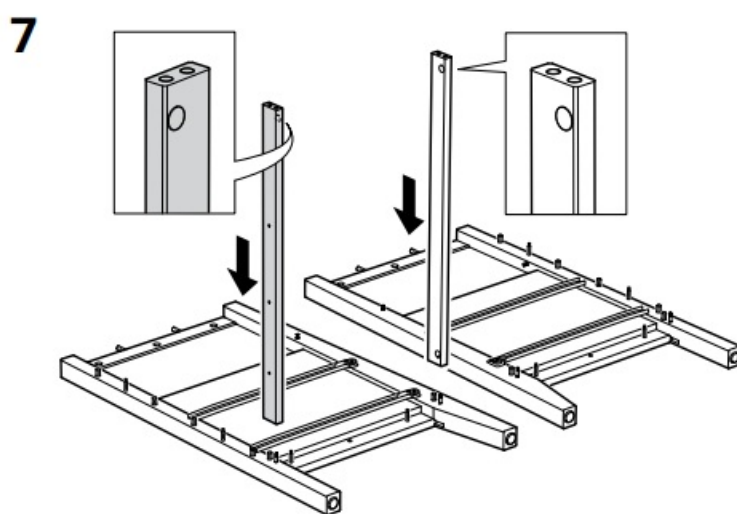
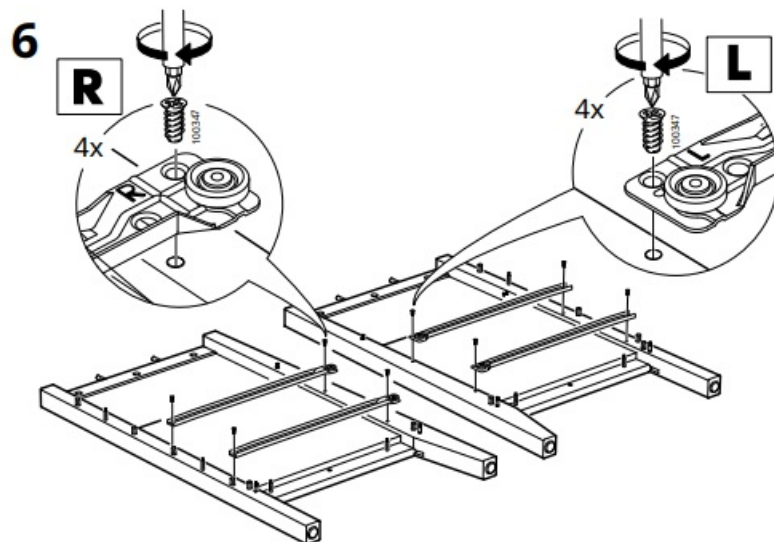



8

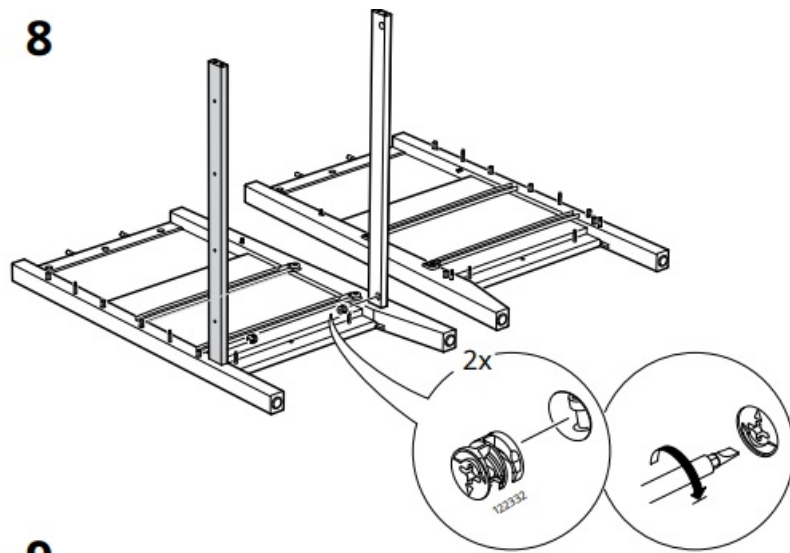

9

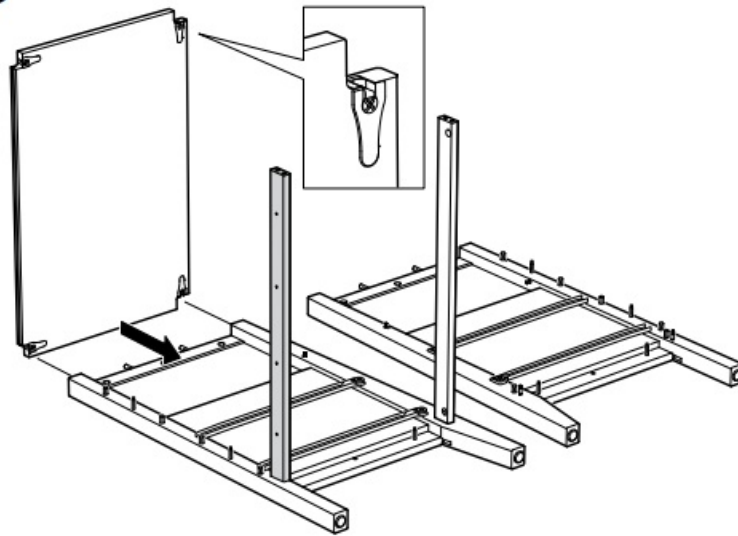

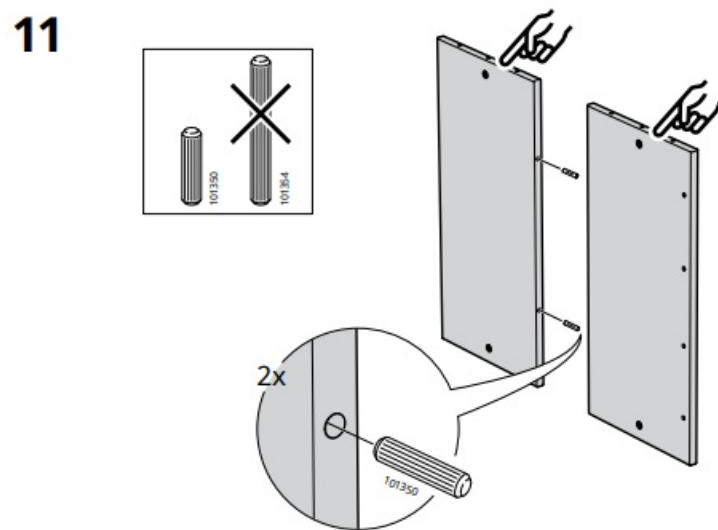
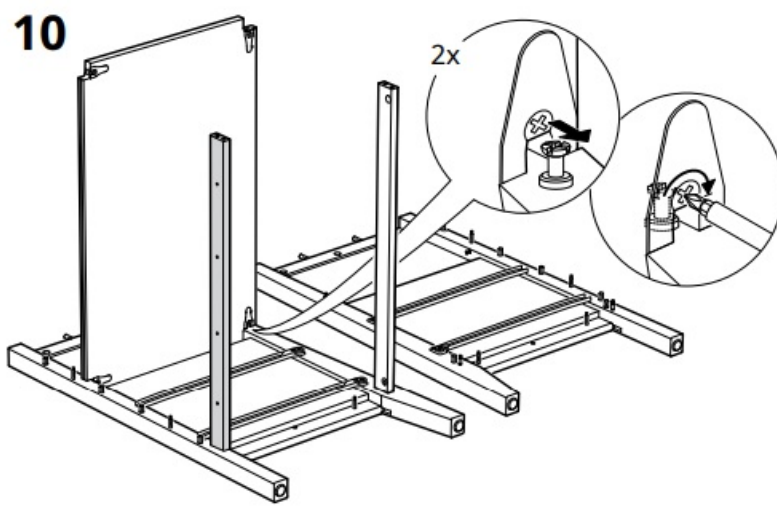

12

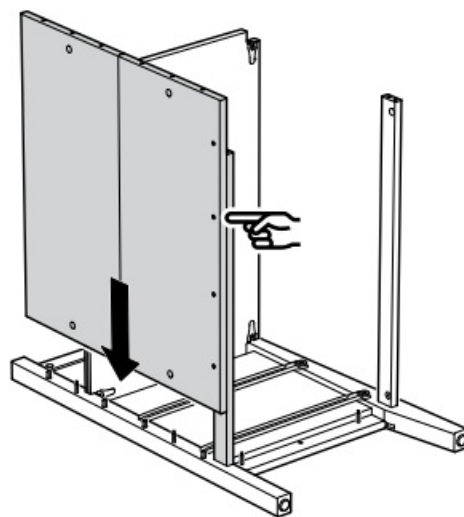

13

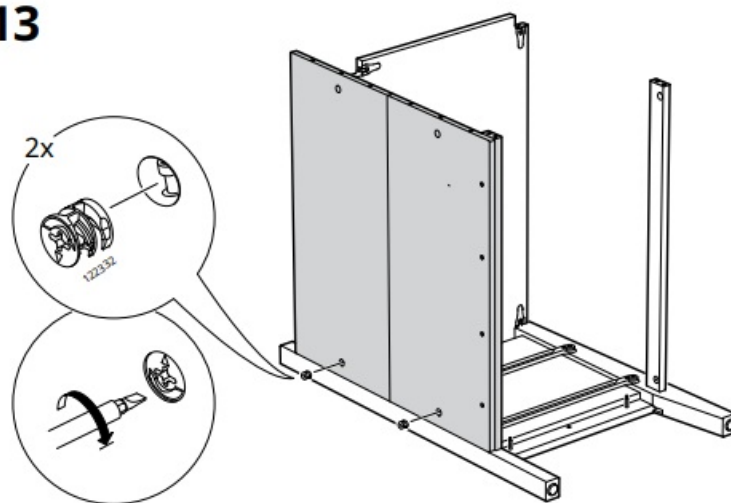

14

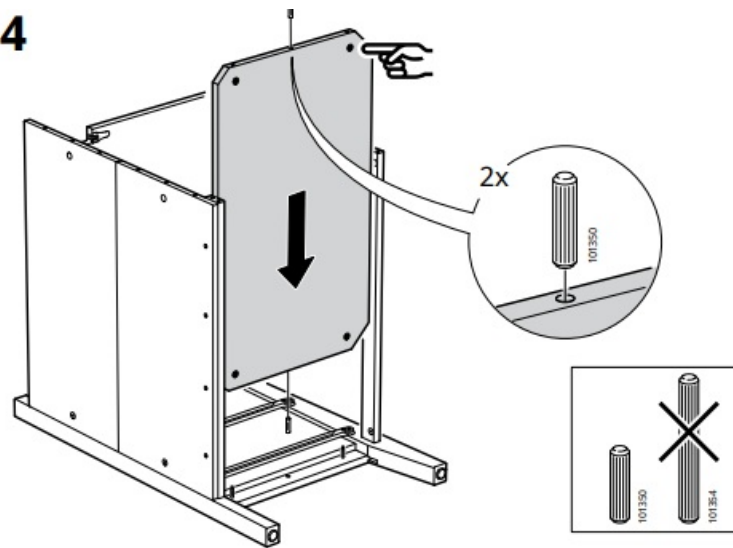

15

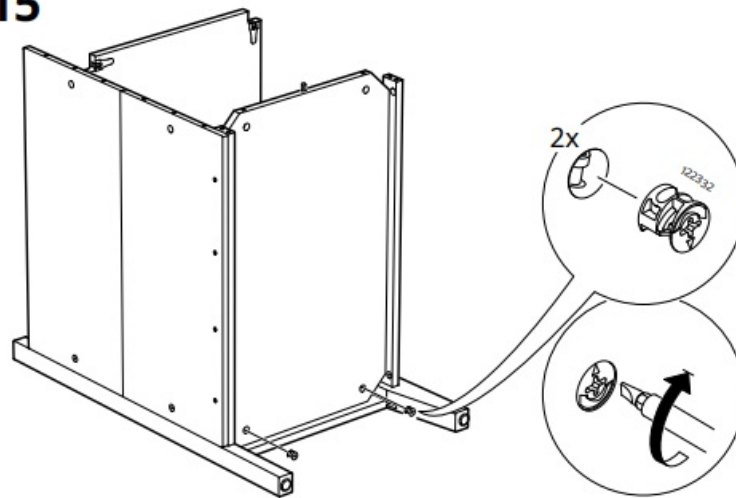

**16**

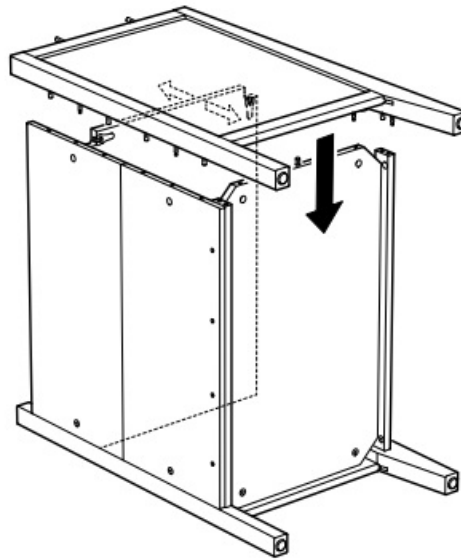

**17**

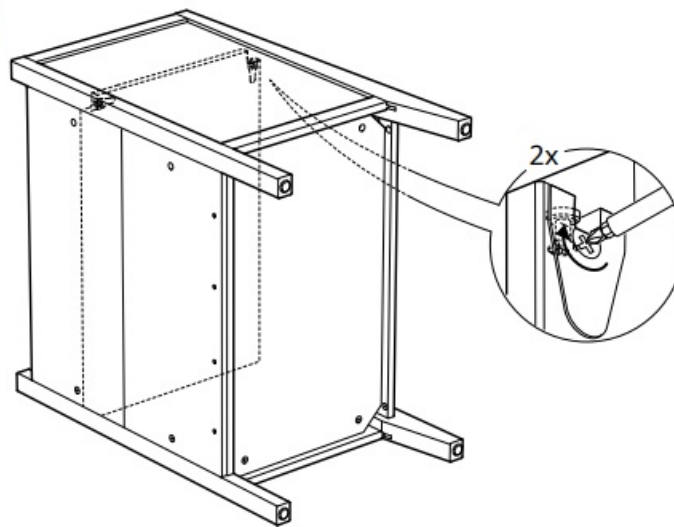

18

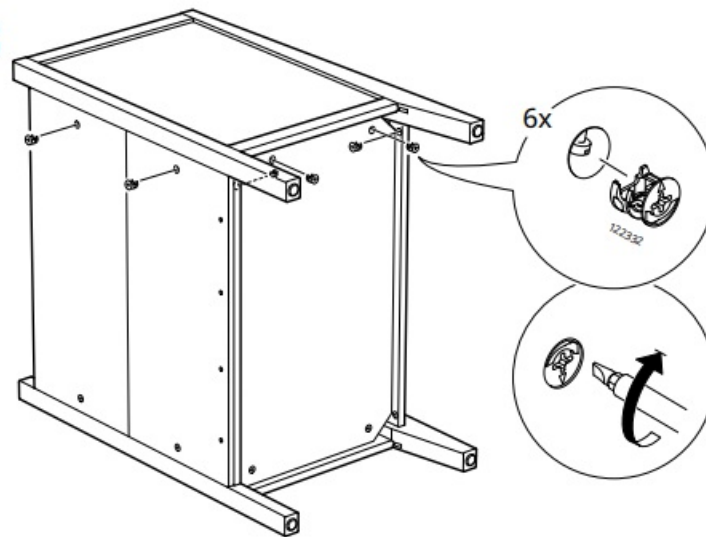

19

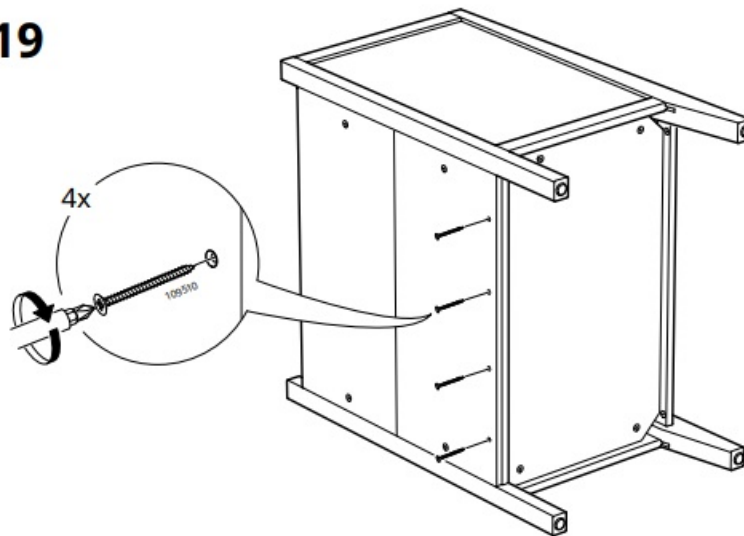

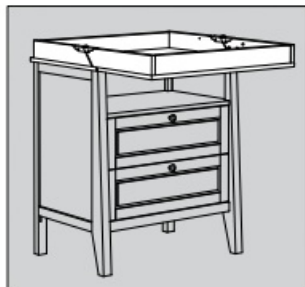

20

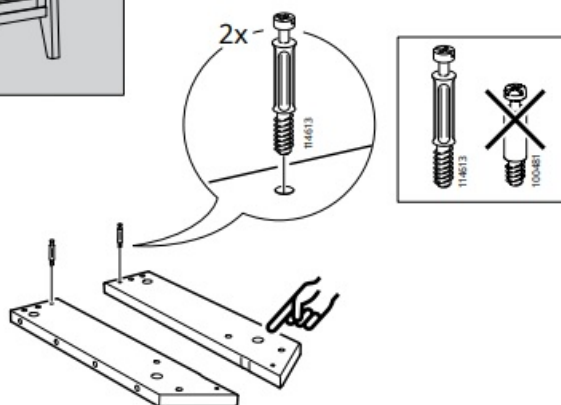

21

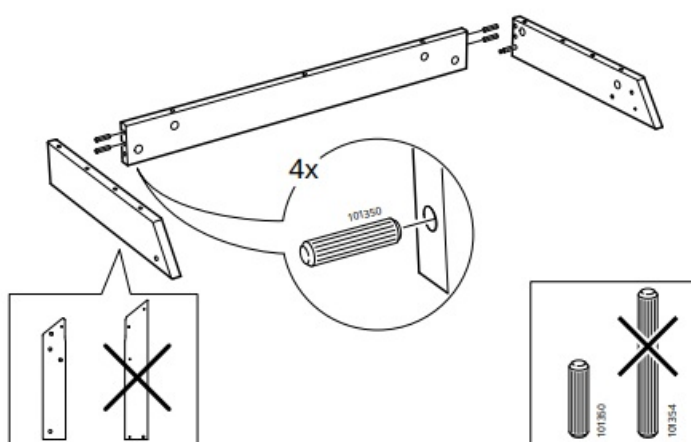

22

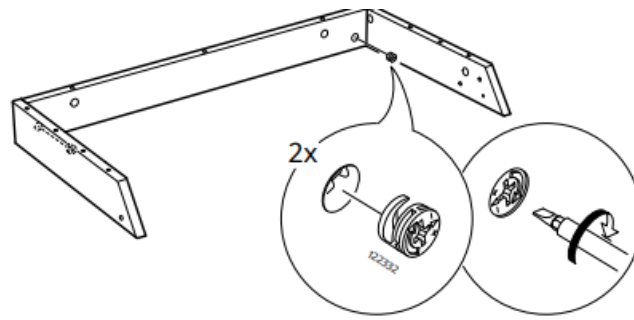

23

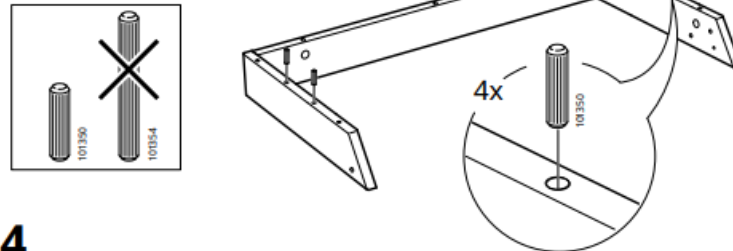

24

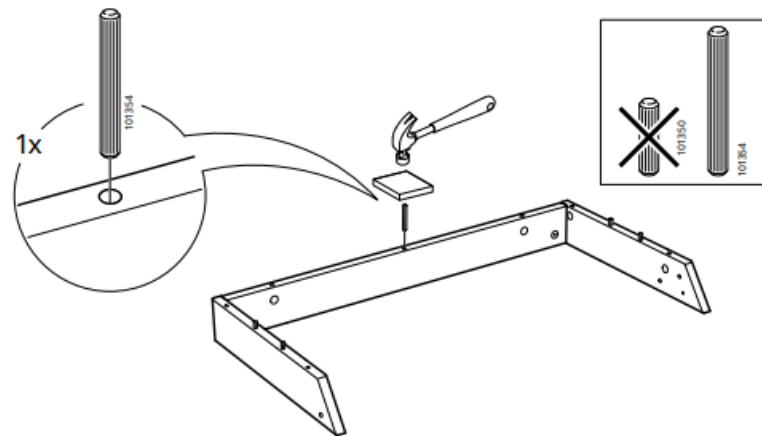



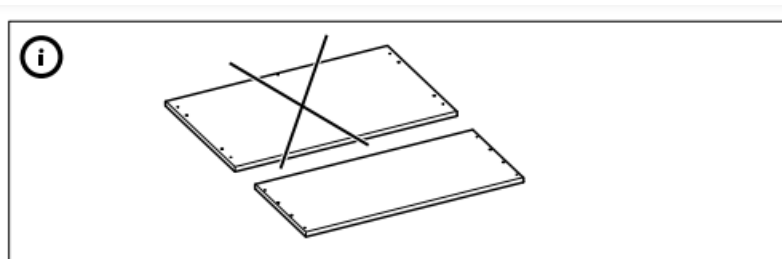

**25**

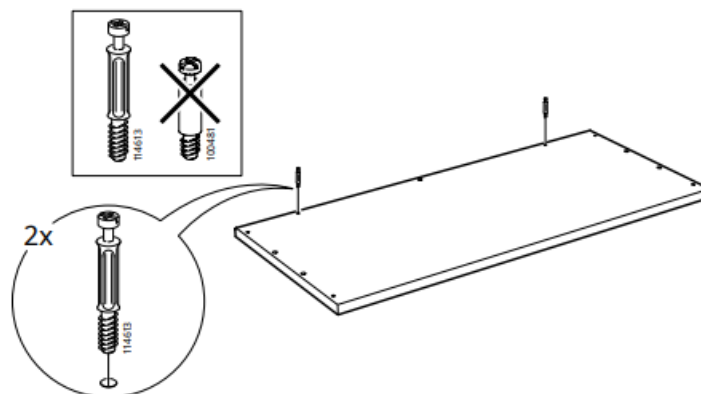

**26**

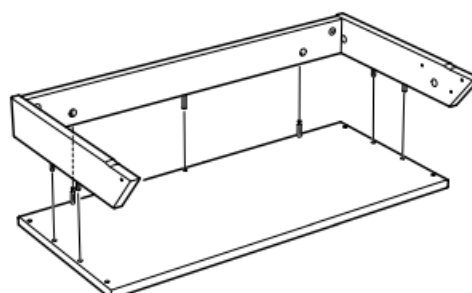

**27**

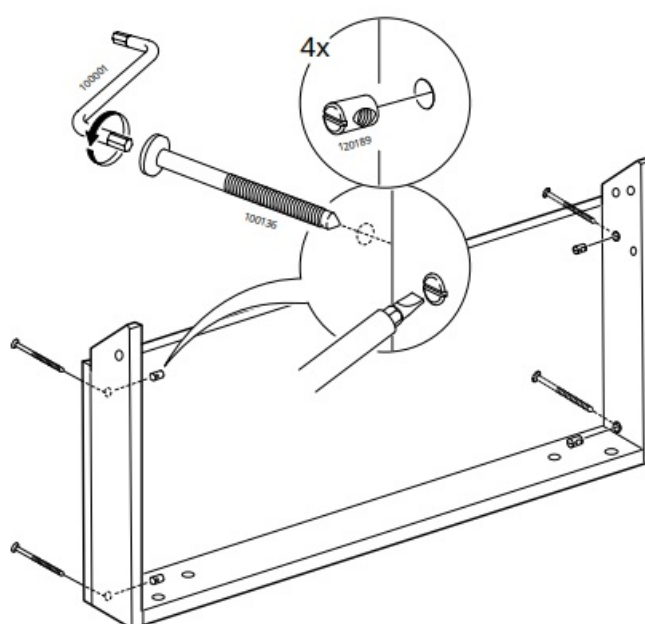

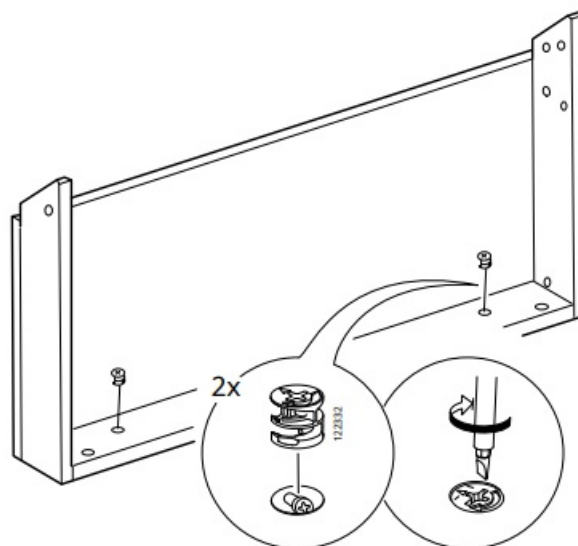

**29**

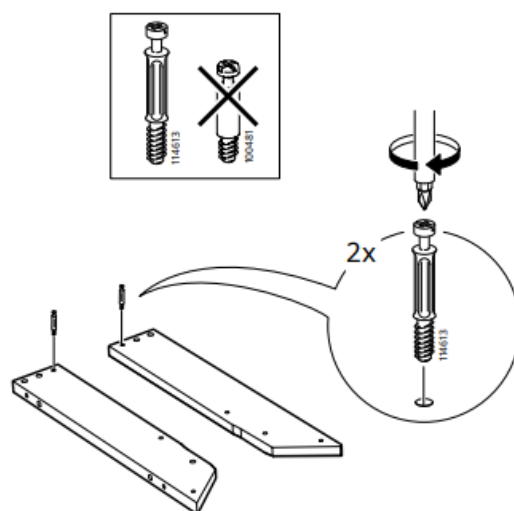

**30**

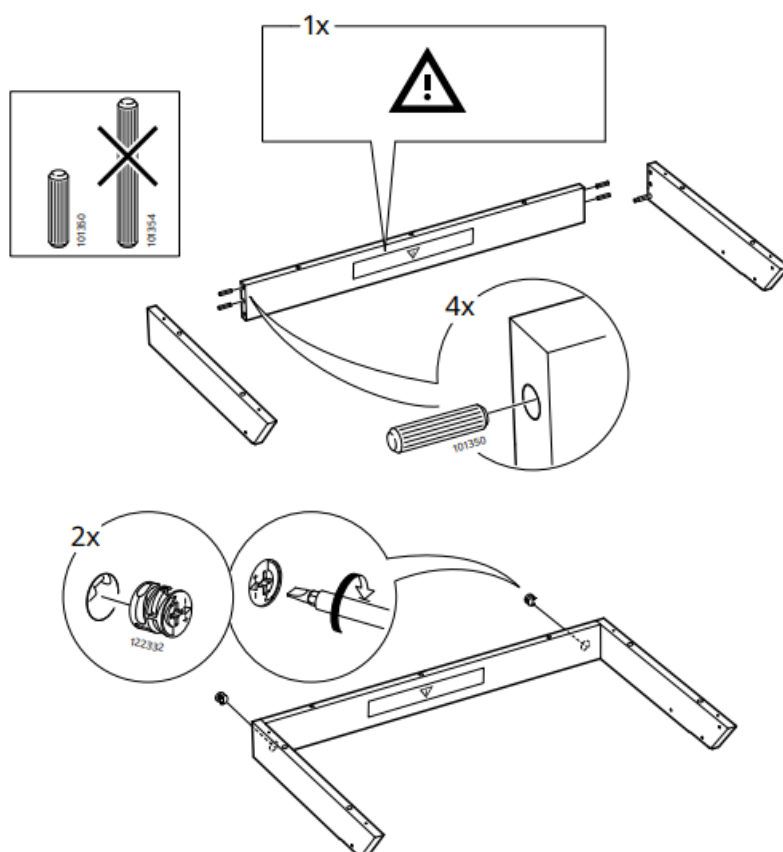

32

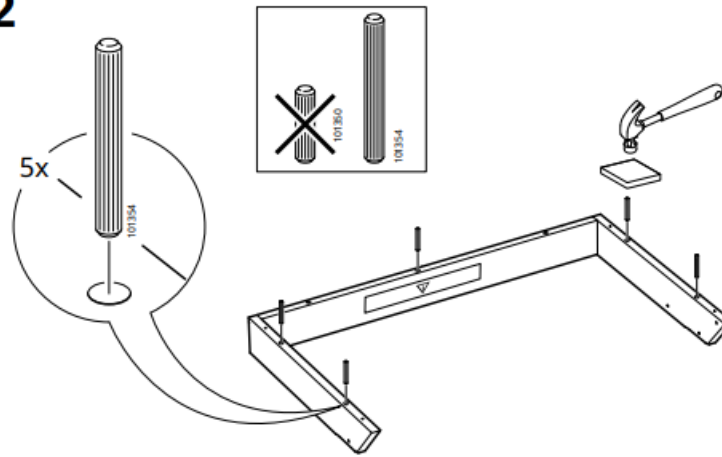

33

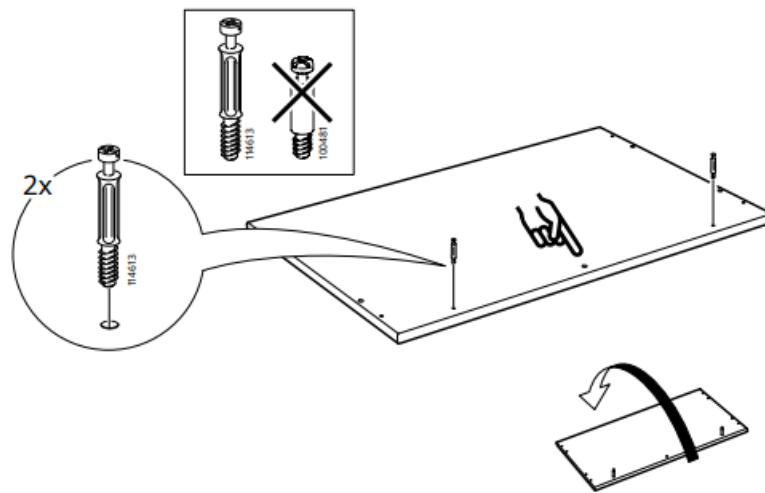

42

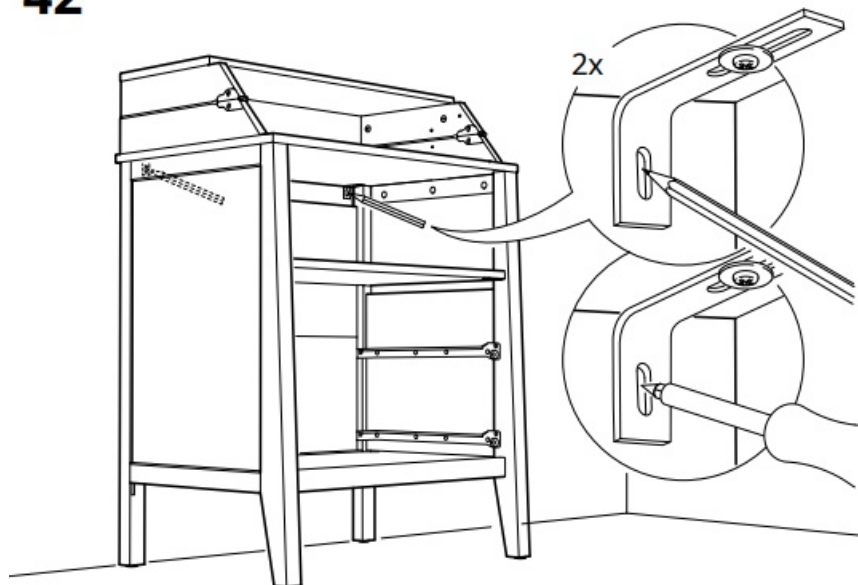

**40**

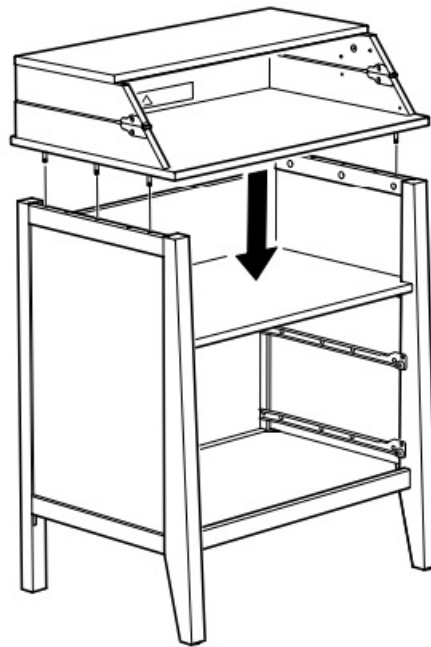

**41**

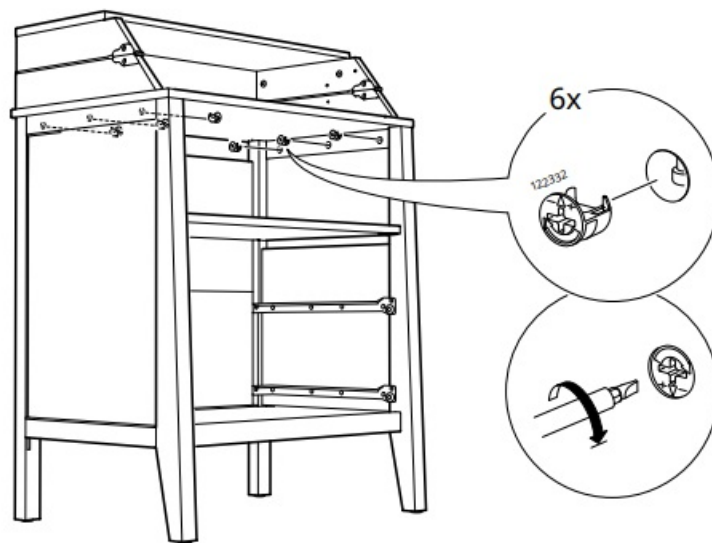

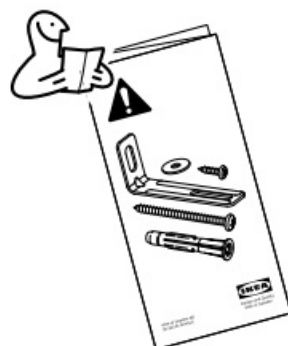
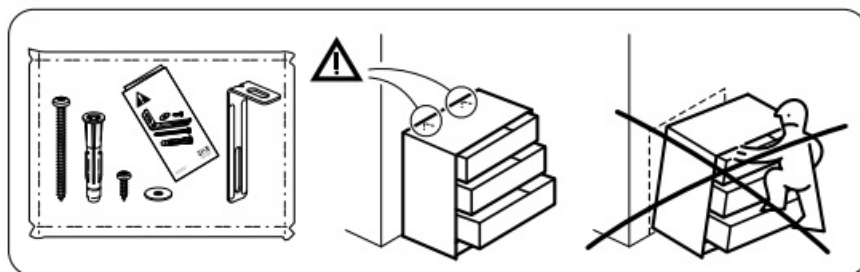

39

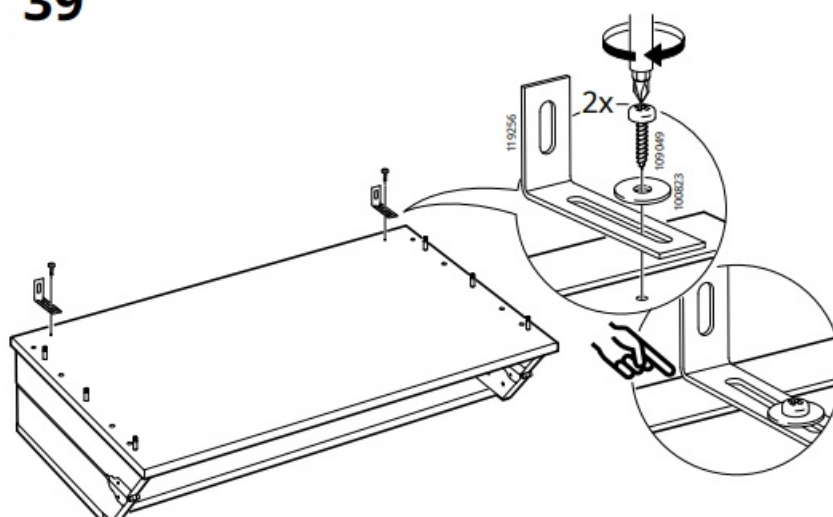

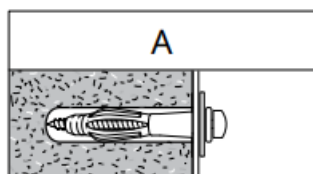

Ø 5/16"  
(8 mm)

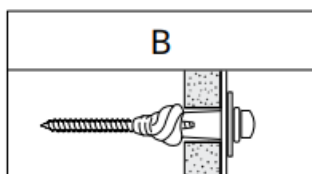
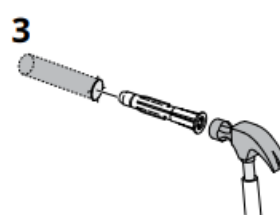
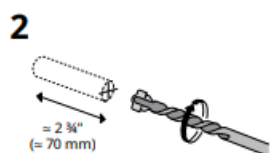
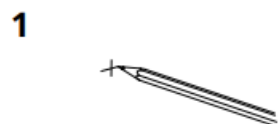

Ø 5/16"  
(8 mm)

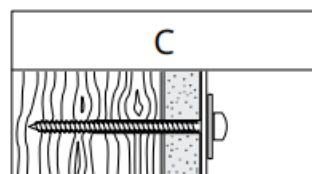
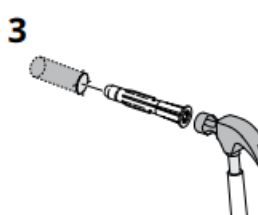
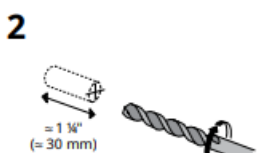
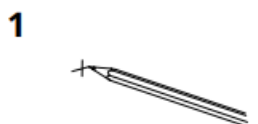

Ø 1/8"  
(3 mm)

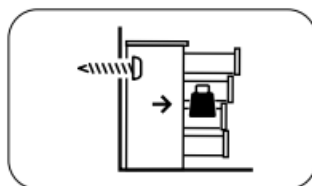
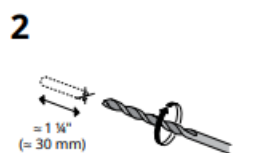
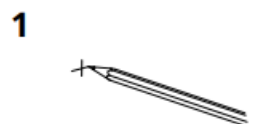

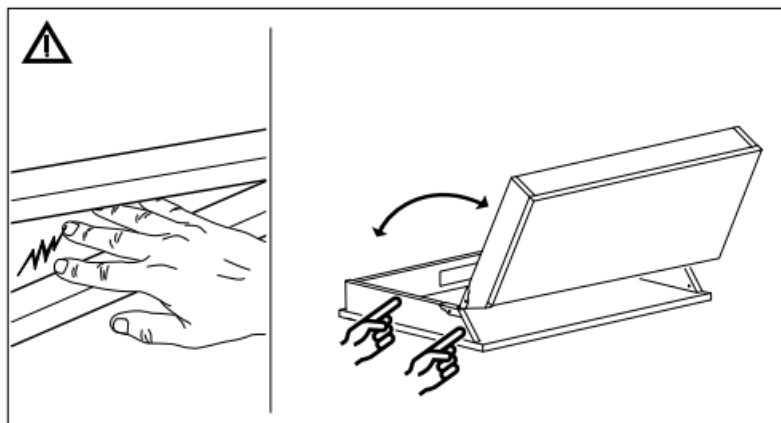

38

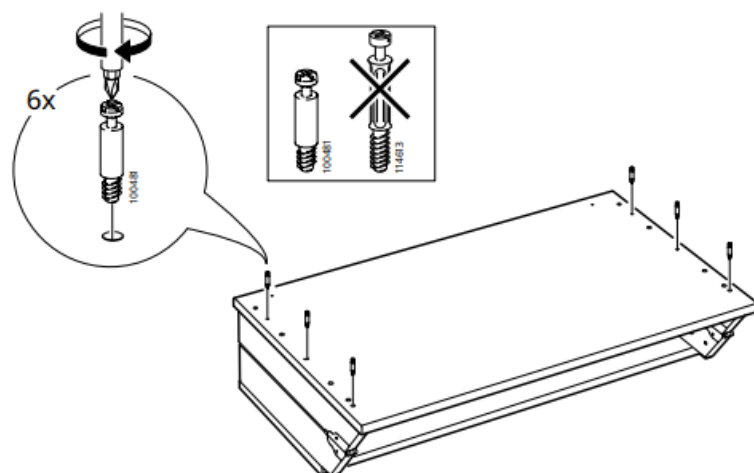

**36**

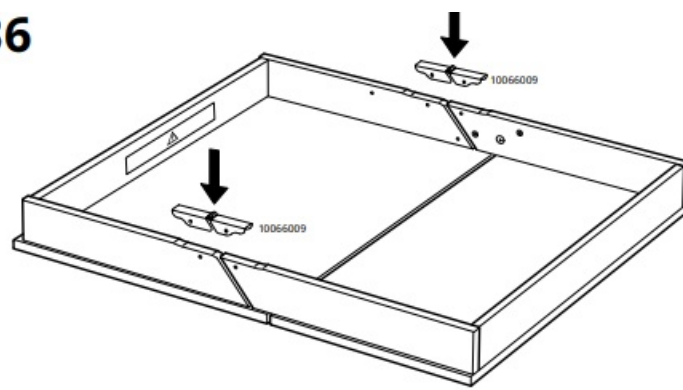

**37**

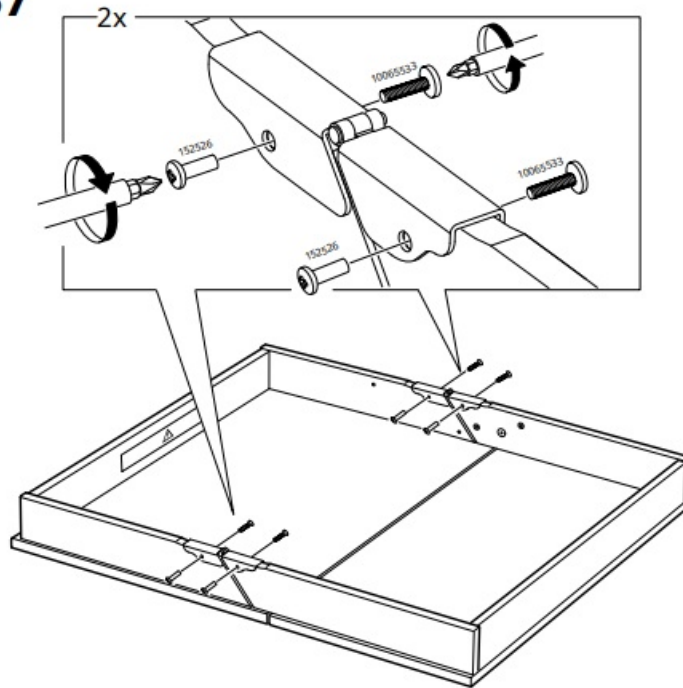



34

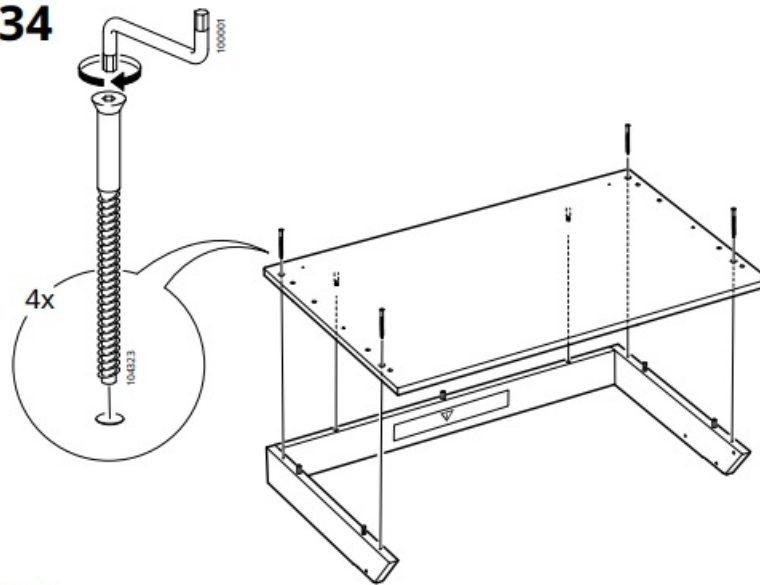

35

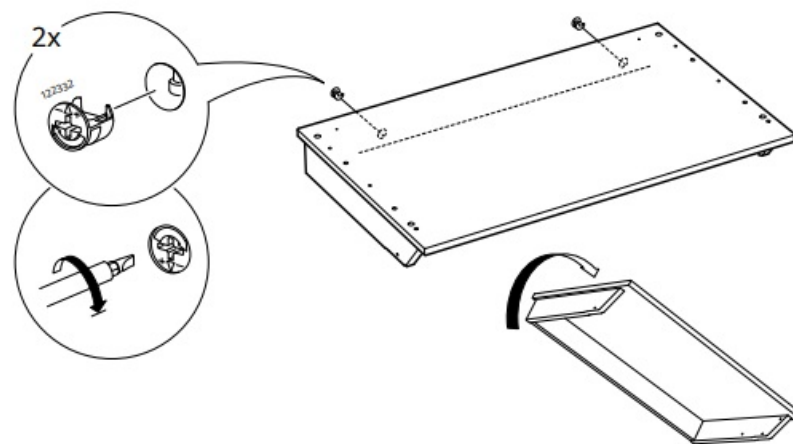

43

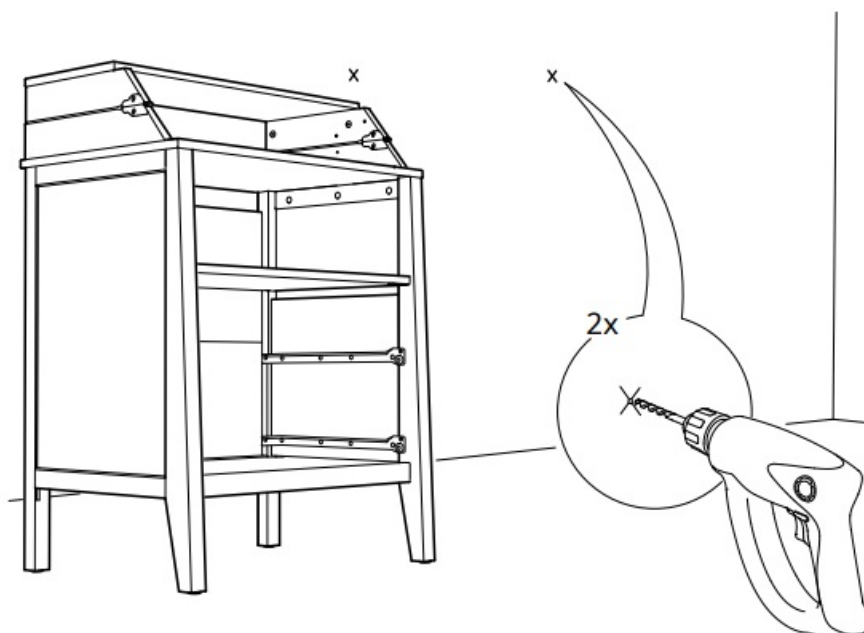

44

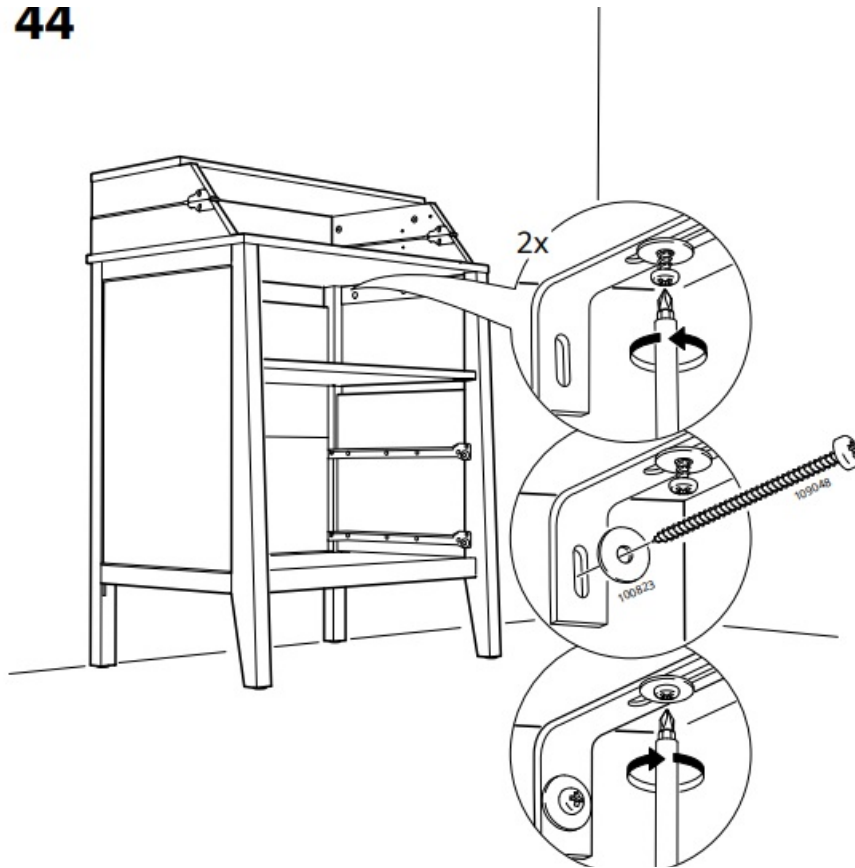

45

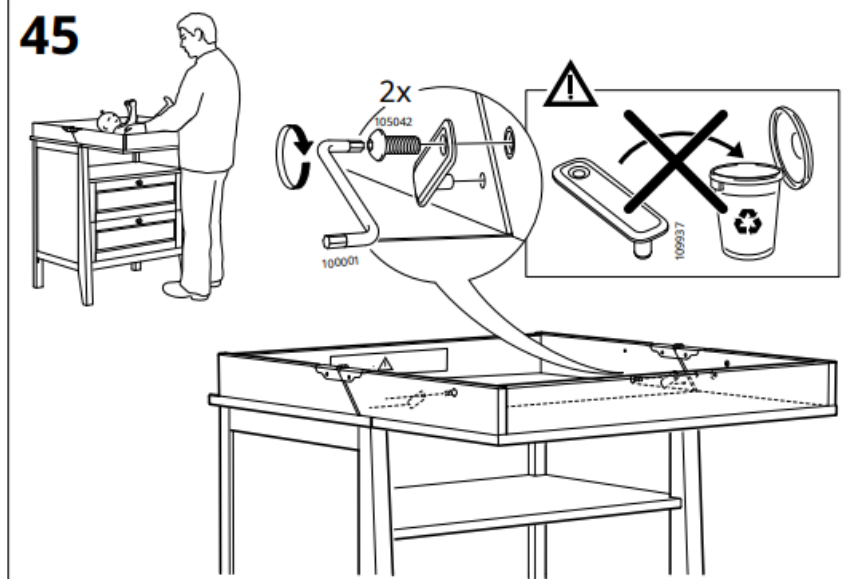

45

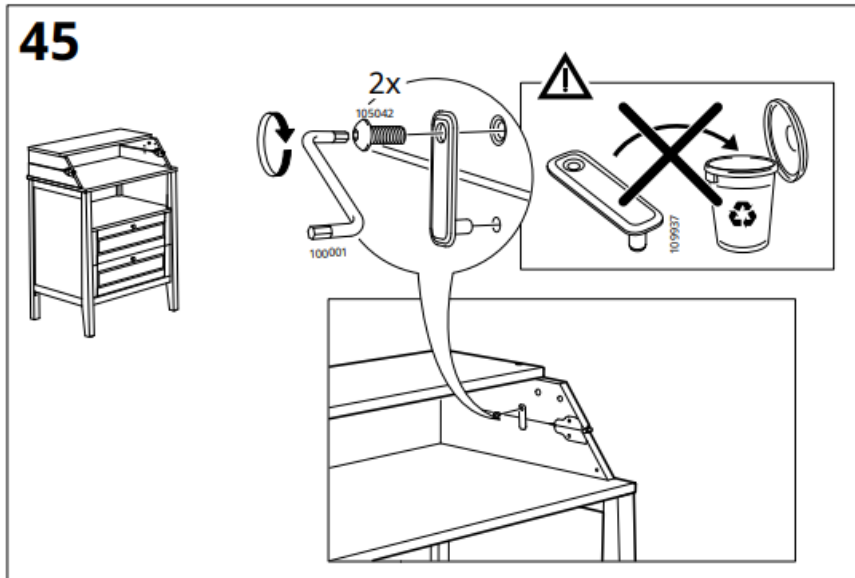

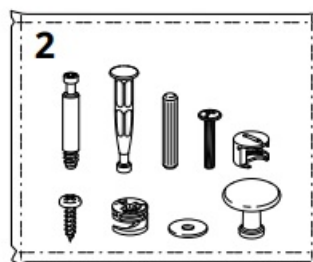
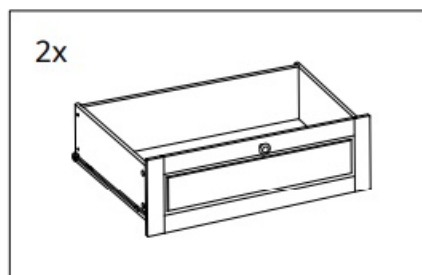

46

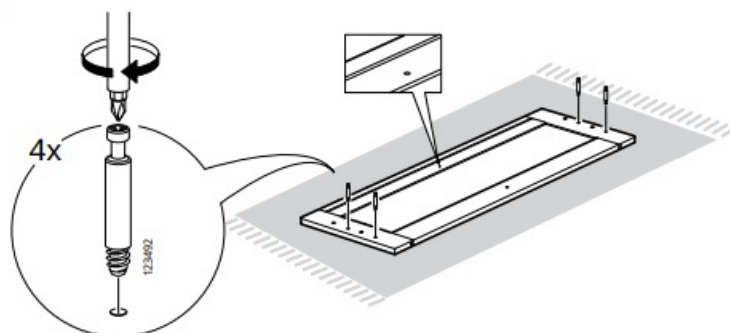

47

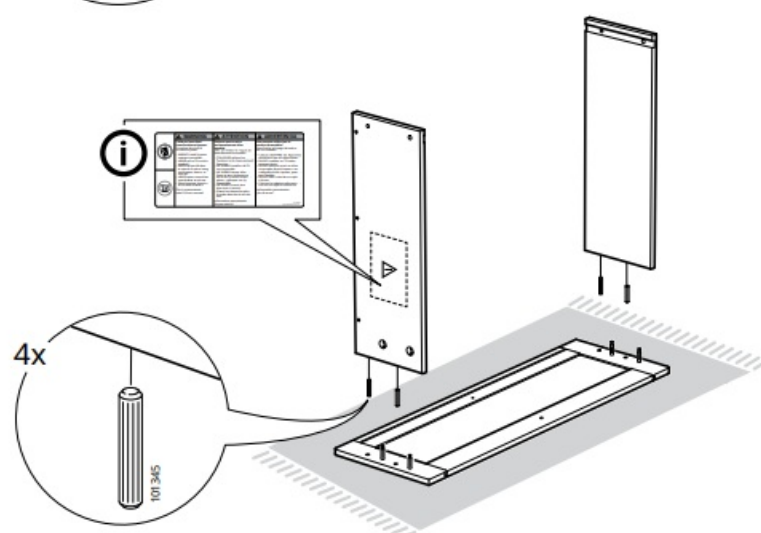

**48**

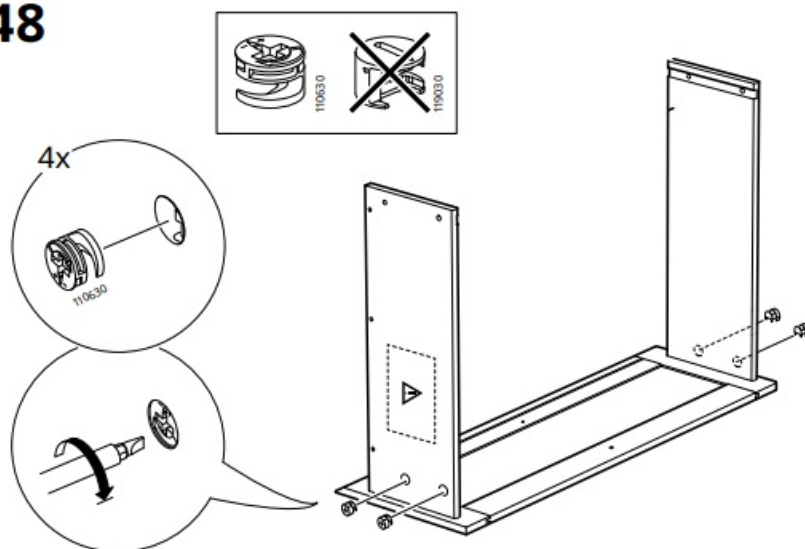

**49**

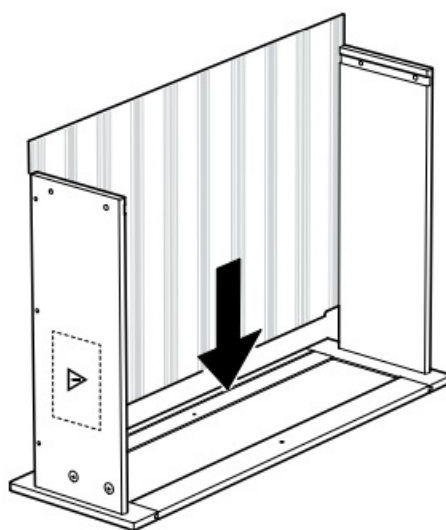

50

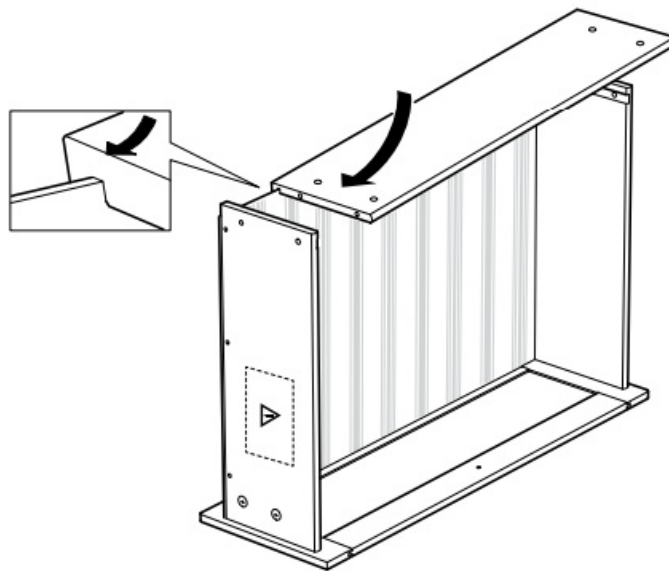

51

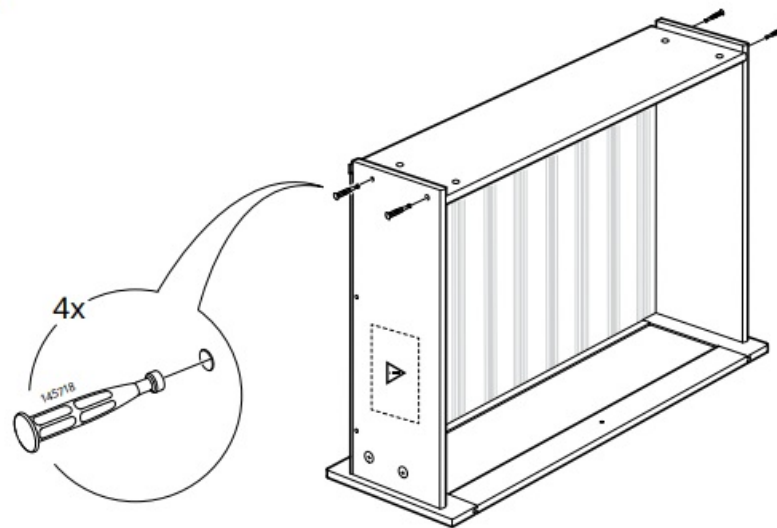

52

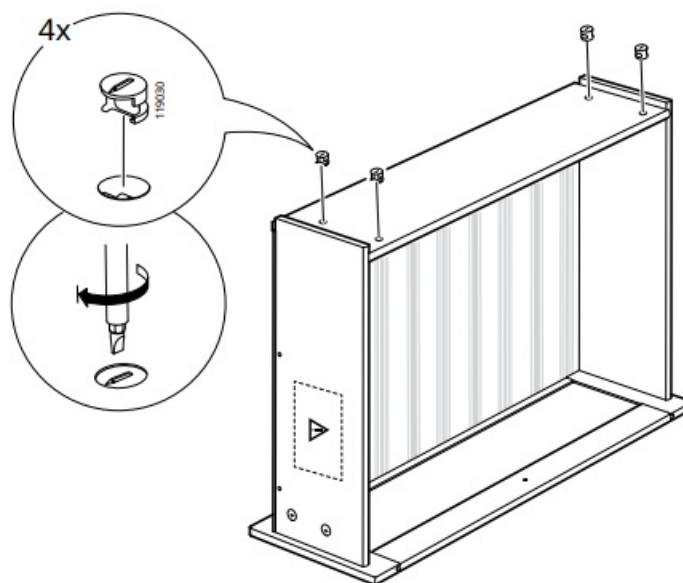

**53**

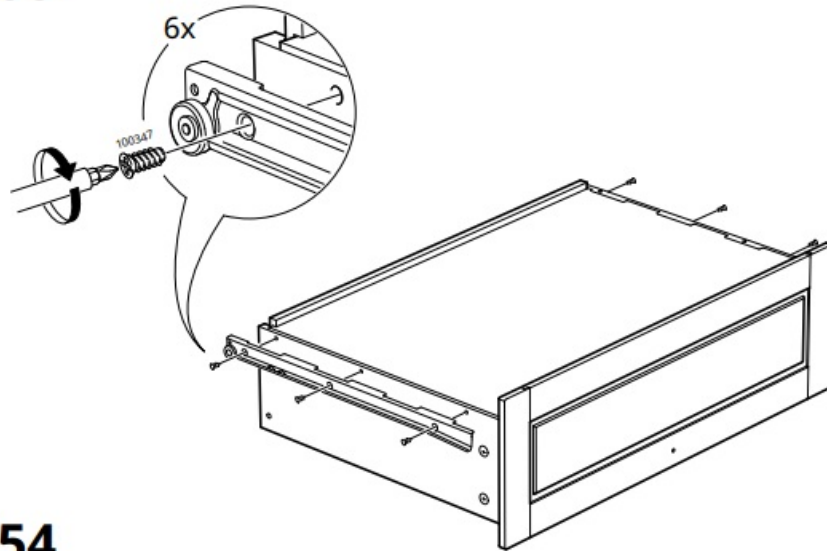

**54**

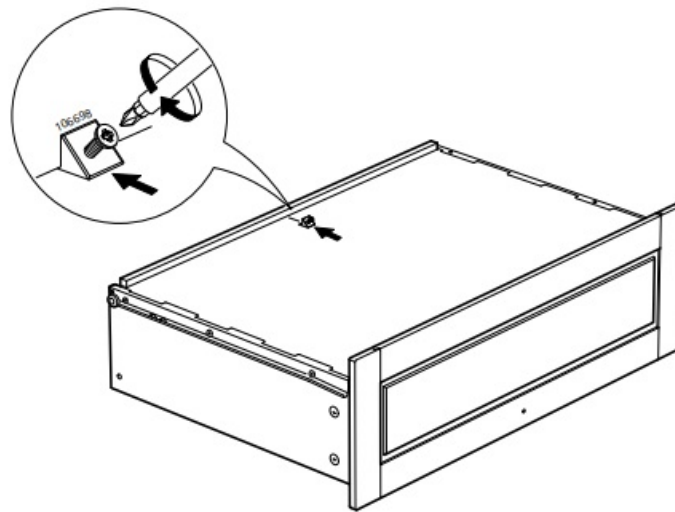

55

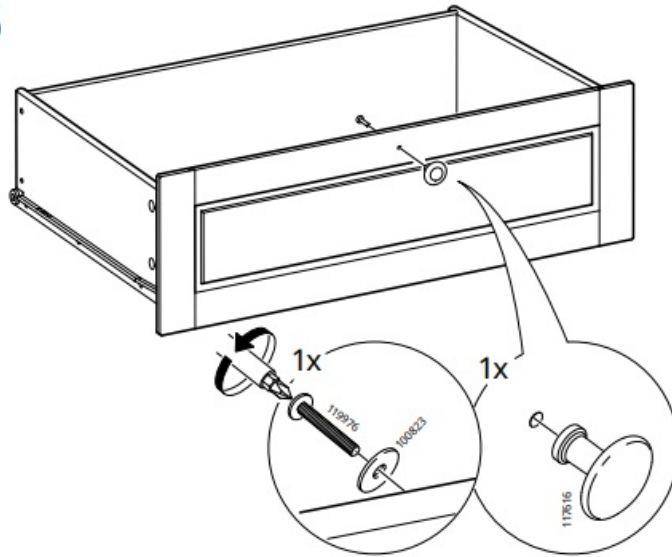

56

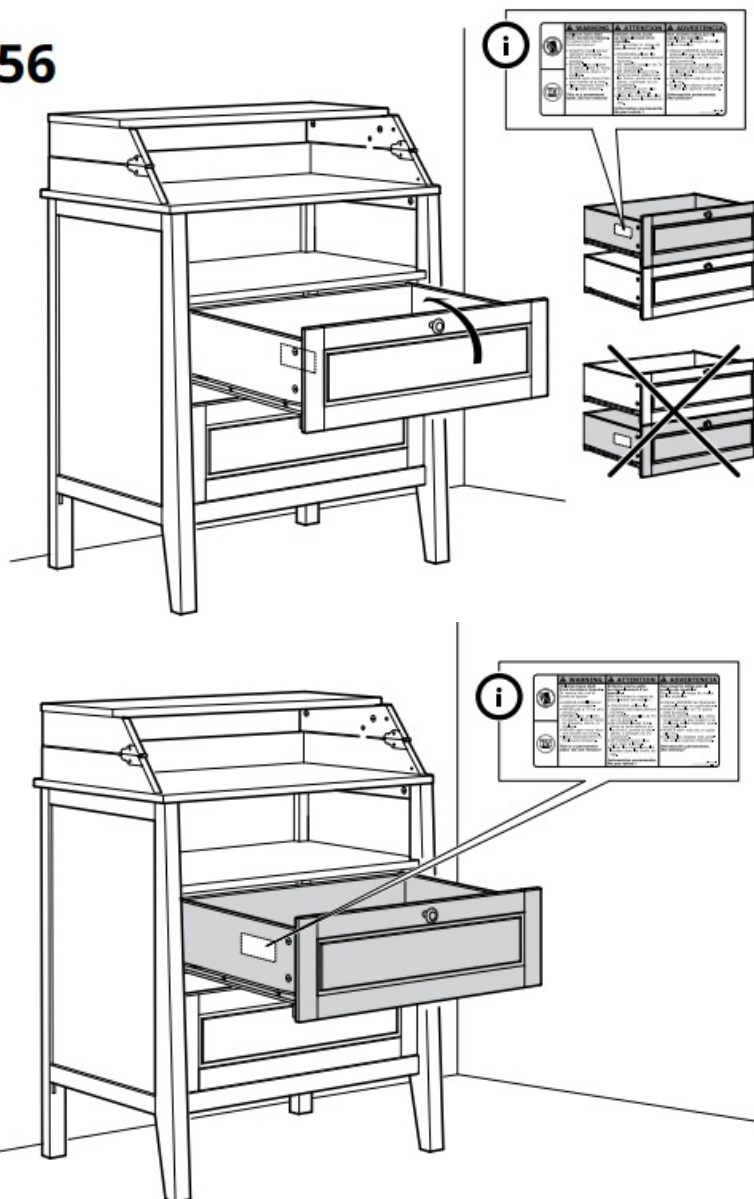

## FAQ

**Q: Can I put a TV on this product?**

**A:** No, it is strongly advised not to put a TV on this product to reduce the risk of furniture tipover.

**Q: What should I do to reduce the risk of furniture tipover?**



A: Always install the anti-tip device provided, never allow children to stand, climb, or hang on any drawers, doors, or shelves, and never open more than one drawer at a time. Additionally, place the heaviest items in the lowest drawers.

**Q: Can I install this product on any type of wall?**

A: The screw(s) and plug(s) supplied can be used with most solid (A) and hollow (B) walls. For solid wood (C), use the screw(s) without plug(s). If you are uncertain, seek professional advice.

---

**Documents / Resources**

<div><p><b>SUNDBVIK</b></p></div>	<p><a href="#">IKEA SUNDBVIK Changing Table Chest of Drawers</a> [pdf] Instruction Manual SUNDBVIK, SUNDBVIK Changing Table Chest of Drawers, Changing Table Chest of Drawers, Table Chest of Drawers, Chest of Drawers, Drawers</p>
--	--

**References**

-  [YouTube](#)
- [User Manual](#)

[Manuals+](#), [Privacy Policy](#)

This website is an independent publication and is neither affiliated with nor endorsed by any of the trademark owners. The "Bluetooth®" word mark and logos are registered trademarks owned by Bluetooth SIG, Inc. The "Wi-Fi®" word mark and logos are registered trademarks owned by the Wi-Fi Alliance. Any use of these marks on this website does not imply any affiliation with or endorsement.