



**SOLKLINT Table Lamp
With Led Bulb**



IKEA SOLKLINT Table Lamp With Led Bulb Instructions

[Home](#) » [Ikea](#) » **IKEA SOLKLINT Table Lamp With Led Bulb Instructions** 

Contents

- [1 IKEA SOLKLINT Table Lamp With Led Bulb](#)
- [2 Specifications](#)
- [3 Product Information](#)
- [4 Product Usage Instructions](#)
- [5 TOOLS](#)
- [6 INSTALLATION](#)
- [7 FAQ](#)
- [8 Documents / Resources](#)
 - [8.1 References](#)
- [9 Related Posts](#)



IKEA SOLKLINT Table Lamp With Led Bulb



Specifications

- **Brand:** SOLKLINT
- **Model:** AA-2214348-6

Product Information

The SOLKLINT luminaire comes with flexible cables that need to be handled carefully to ensure safety. Different materials require specific fittings for installation. It is recommended to use screws and plugs that are suitable for the material of the surface where the luminaire will be mounted.

Product Usage Instructions

Replacing Damaged Cable:

If the external flexible cable or cord of the luminaire is damaged, it should only be replaced by the manufacturer, their service agent, or a qualified person to prevent hazards. Contact IKEA for assistance if unsure.

Safety Precautions

Ensure that flexible cables connected to the luminaire are securely attached to the wall, especially if they are within reach, to minimize the risk of accidents like strangulation or choking.

If the external flexible cable or cord of this luminaire is damaged, it shall be exclusively replaced by the manufacturer or his service agent or a similarly qualified person to avoid a hazard. If you are uncertain, please contact IKEA. Different materials require different types of fittings. Always choose screws and plugs that are specially suited to the material.

TOOLS

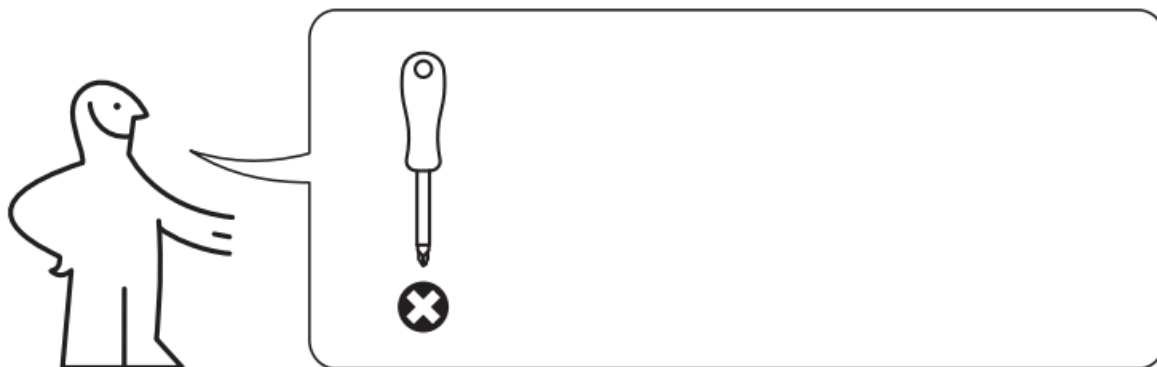

INFO

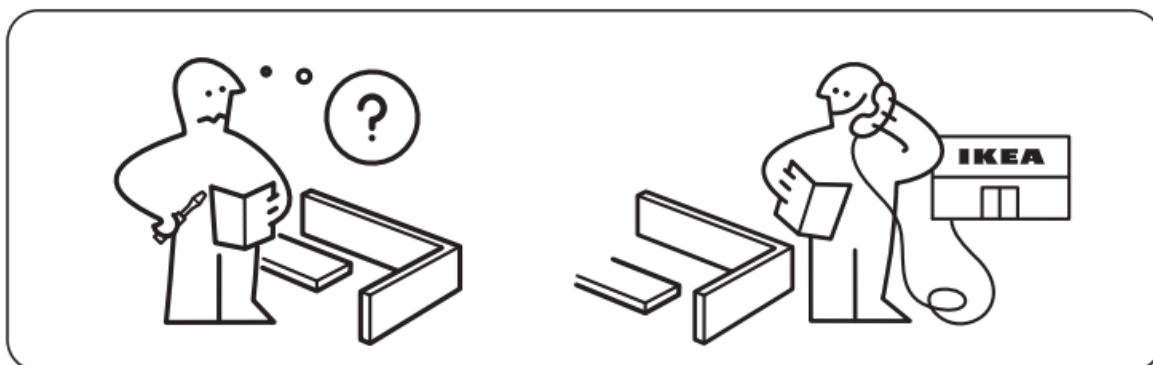

INSTALLATION

1

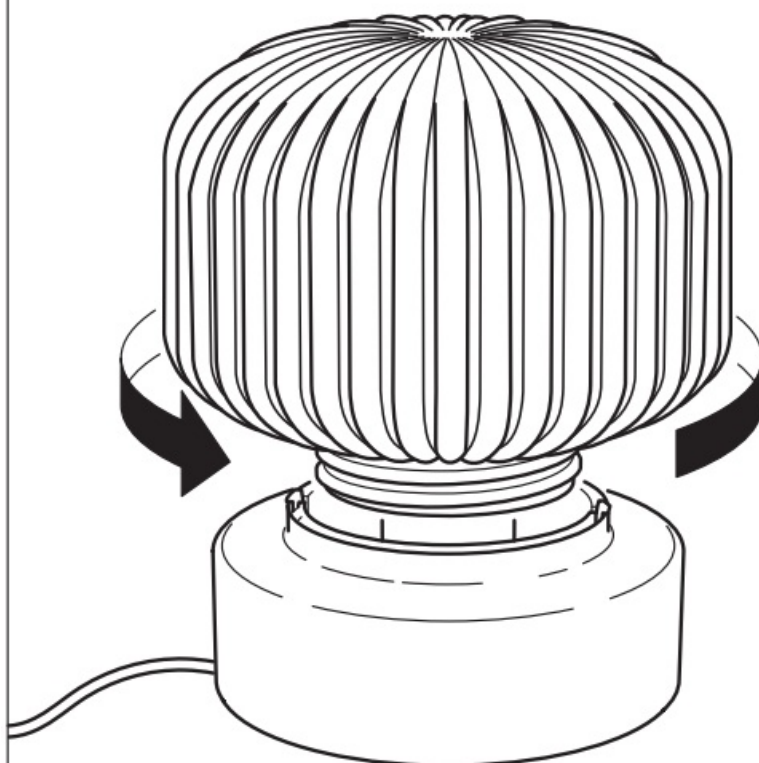

2

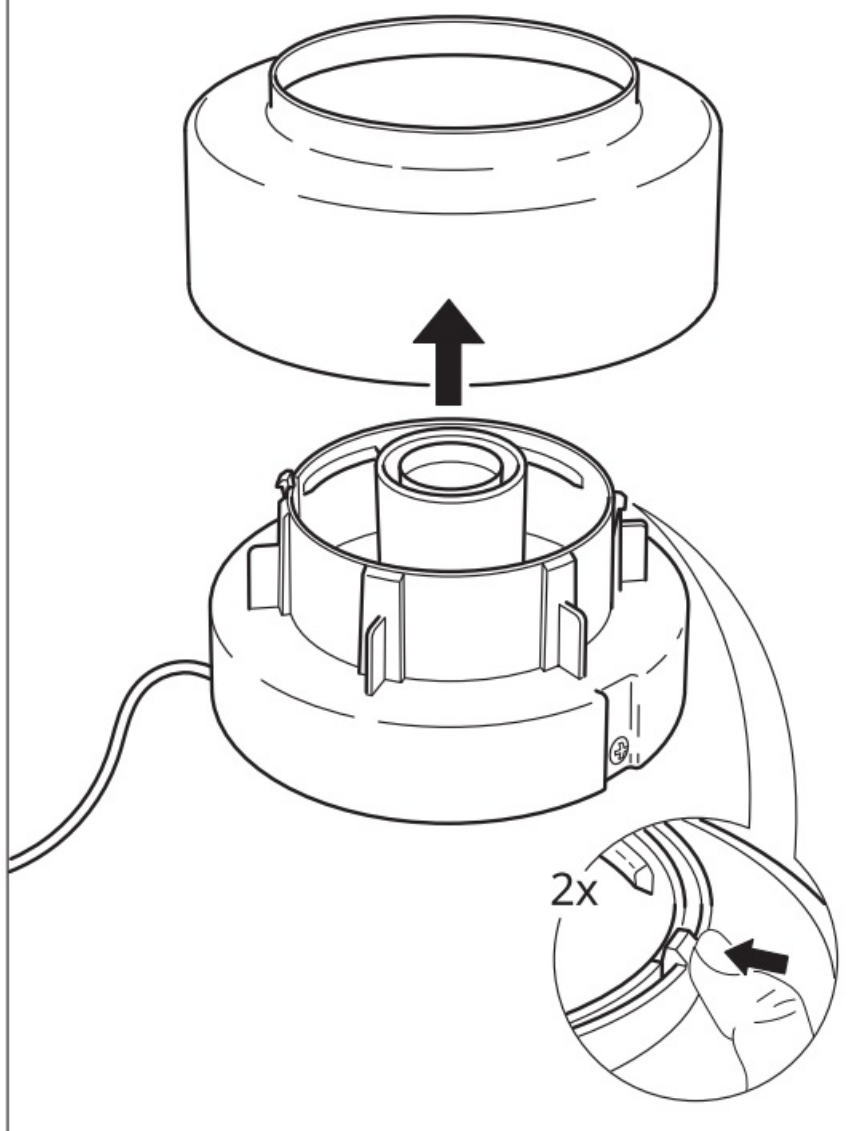

3

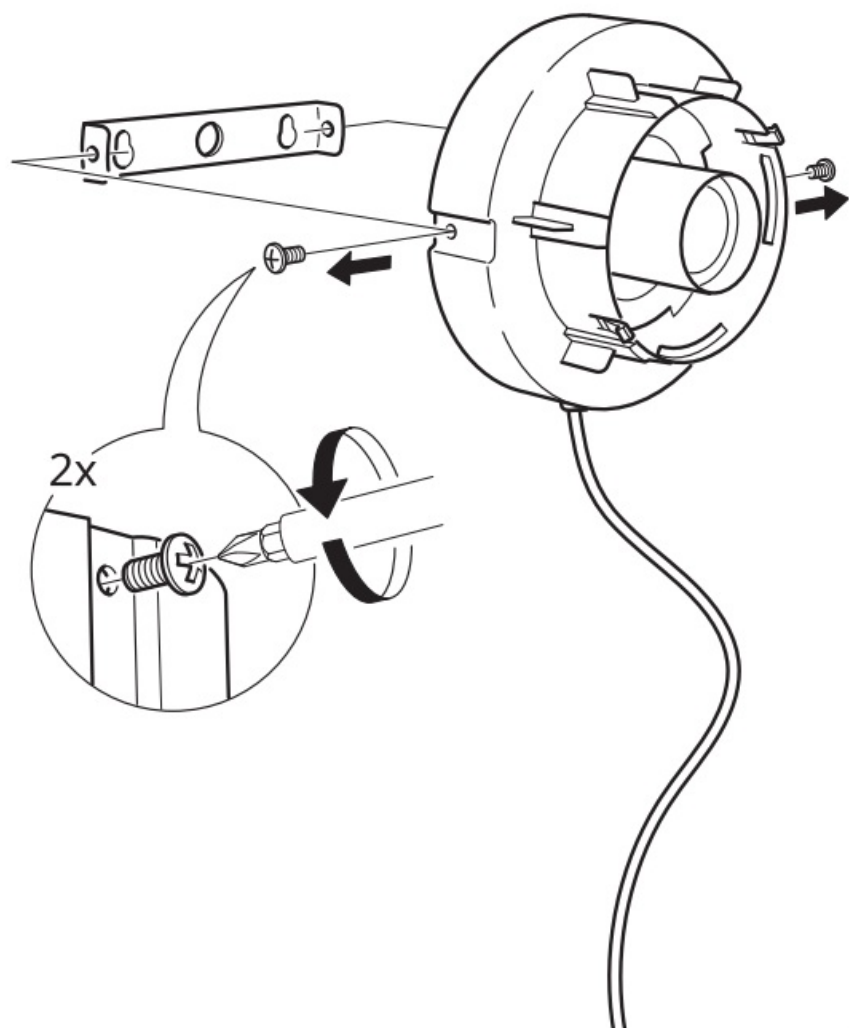

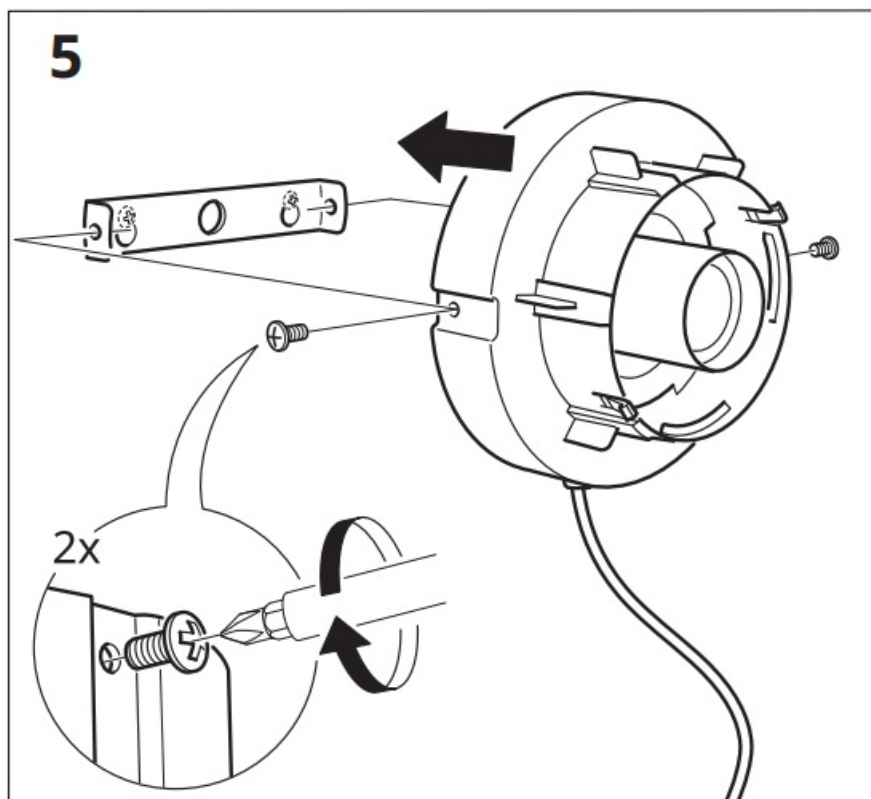
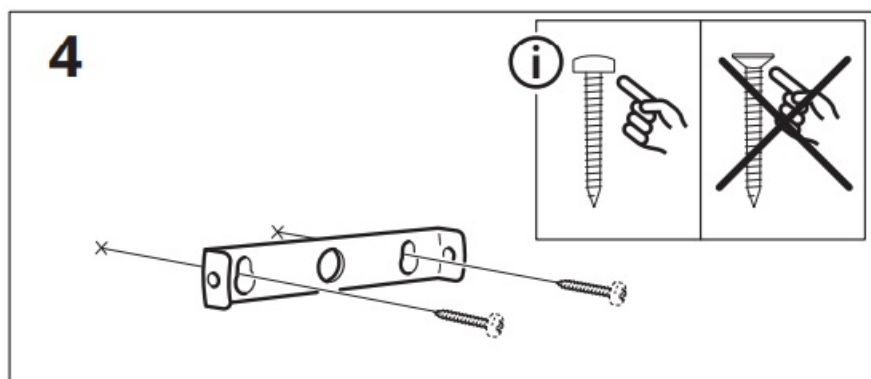

6

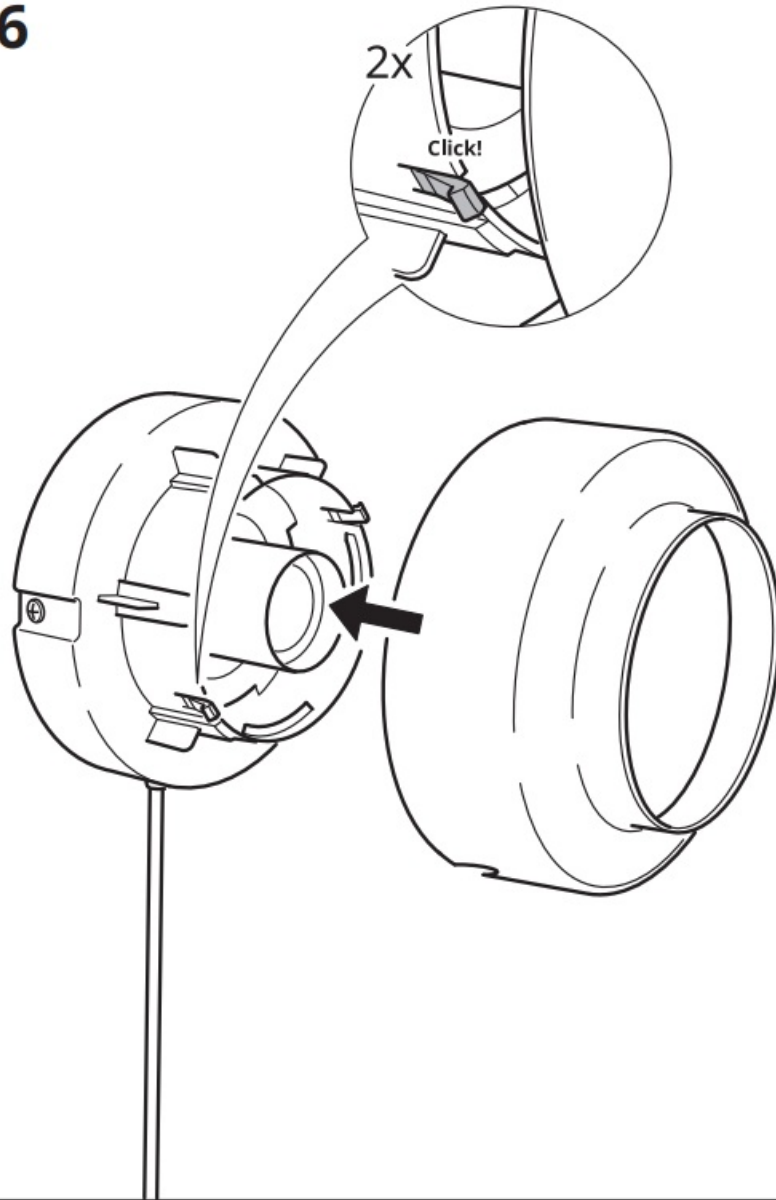

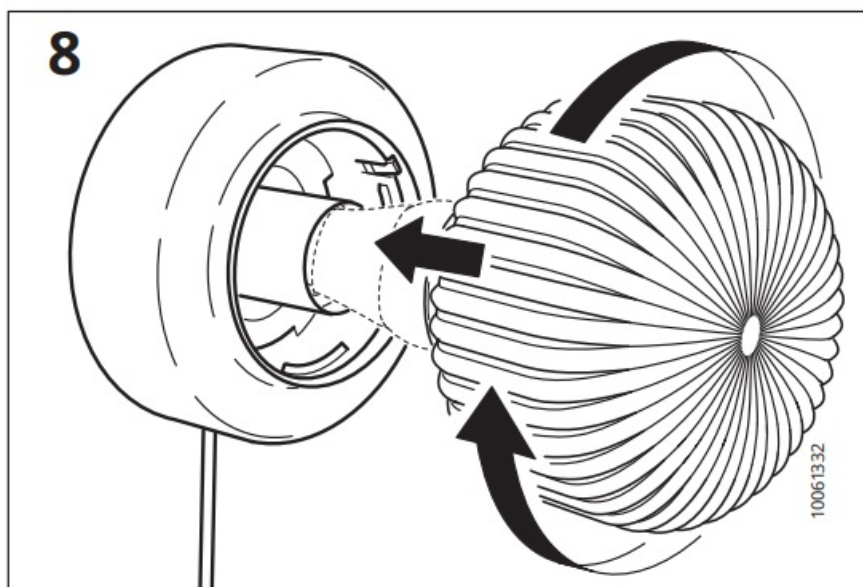
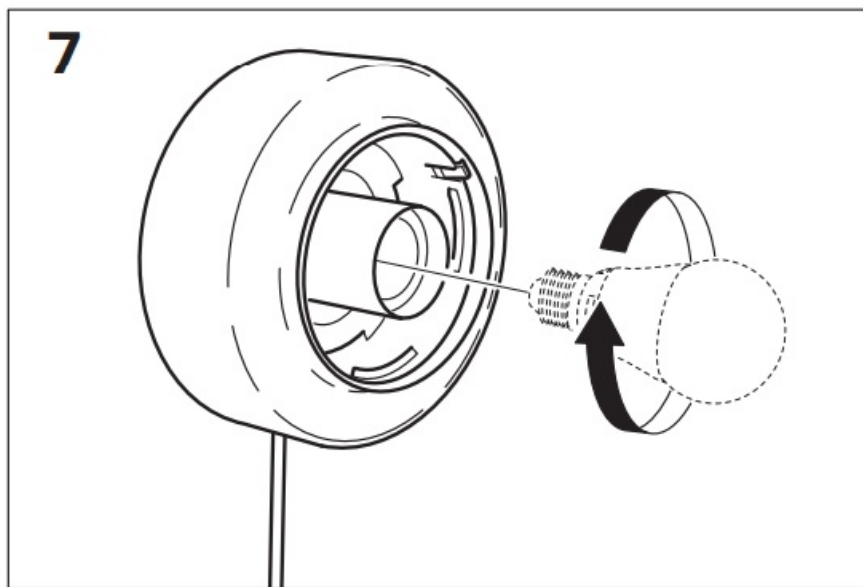

FAQ

- **Q: What should I do if the flexible cables are damaged?**
 - A: Contact the manufacturer, their service agent, or a qualified professional to replace the damaged cables.
- **Q: Can I use any screws and plugs for installation?**
 - A: It is recommended to choose screws and plugs that are specifically suited to the material of the surface where the luminaire will be mounted for secure installation.

Documents / Resources

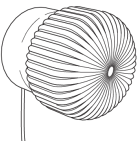
<p>SOLKLINT</p> 	<p>IKEA SOLKLINT Table Lamp With Led Bulb [pdf] Instructions SOLKLINT Table Lamp With Led Bulb, SOLKLINT, Table Lamp With Led Bulb, Lamp With Led B ulb, With Led Bulb, Led Bulb, Bulb</p>
--	--

References

- [User Manual](#)

[Manuals+](#), [Privacy Policy](#)

This website is an independent publication and is neither affiliated with nor endorsed by any of the trademark owners. The "Bluetooth®" word mark and logos are registered trademarks owned by Bluetooth SIG, Inc. The "Wi-Fi®" word mark and logos are registered trademarks owned by the Wi-Fi Alliance. Any use of these marks on this website does not imply any affiliation with or endorsement.