

## IKEA SIMRISHAMN Wall Lamp with Swing Arm Installation Guide

[Home](#) » [Ikea](#) » IKEA SIMRISHAMN Wall Lamp with Swing Arm Installation Guide 

**IKEA SIMRISHAMN Wall Lamp with Swing Arm**

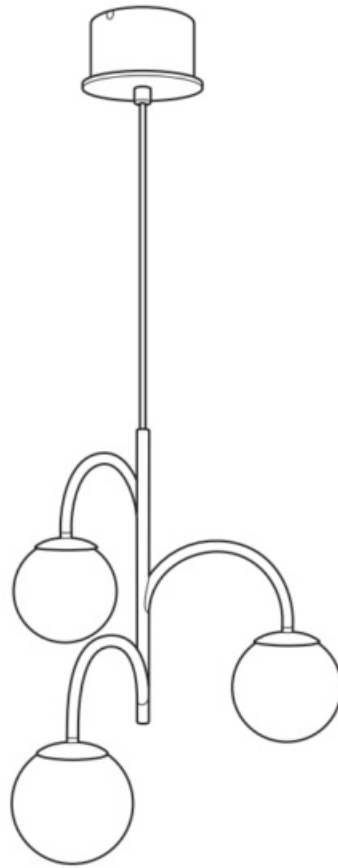

## Contents

- 1 IMPORTANT
- 2 FEATURES
- 3 INSTALLATION
- 4 Documents / Resources
  - 4.1 References



## IMPORTANT

Always shut off power to the circuit before starting installation work. In some countries electrical installation work may only be carried out by a authorised electrical contractor. Contact your local electricity authority for advice.

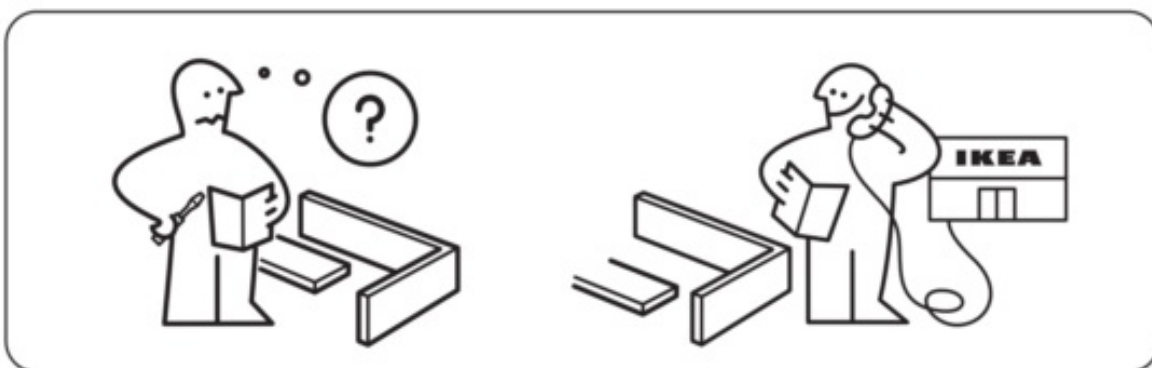

## FEATURES

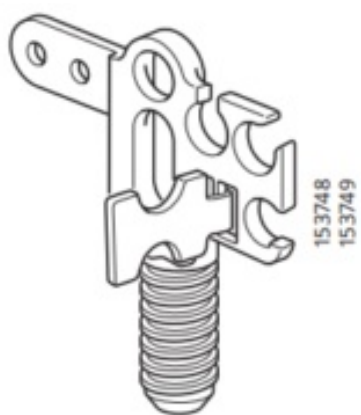

1x

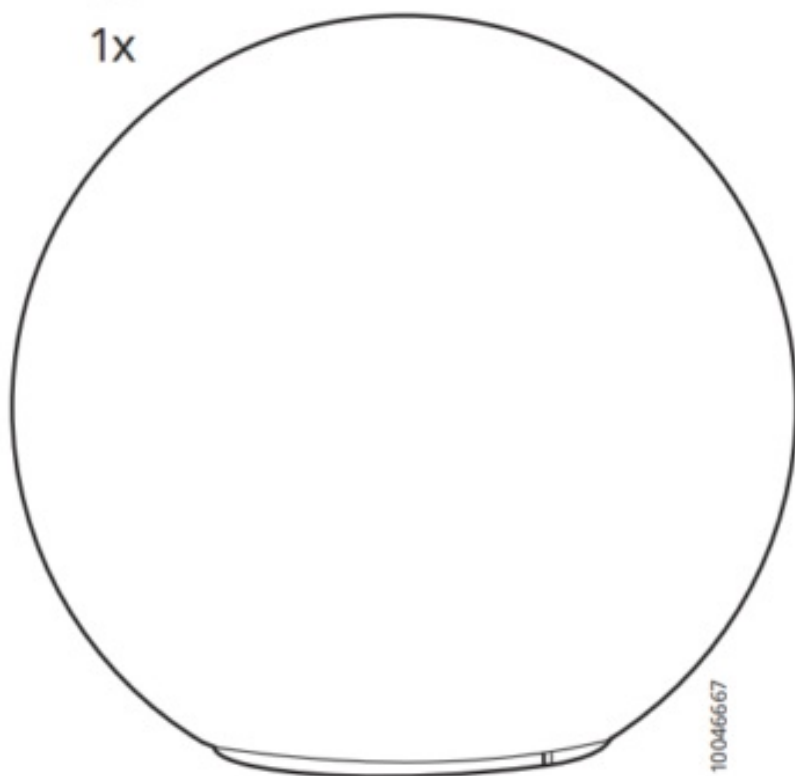

3x

## INSTALLATION

1

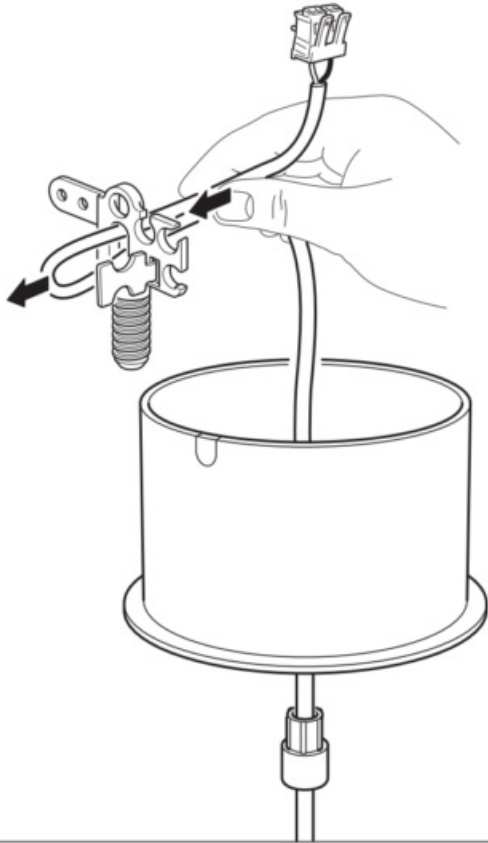

2

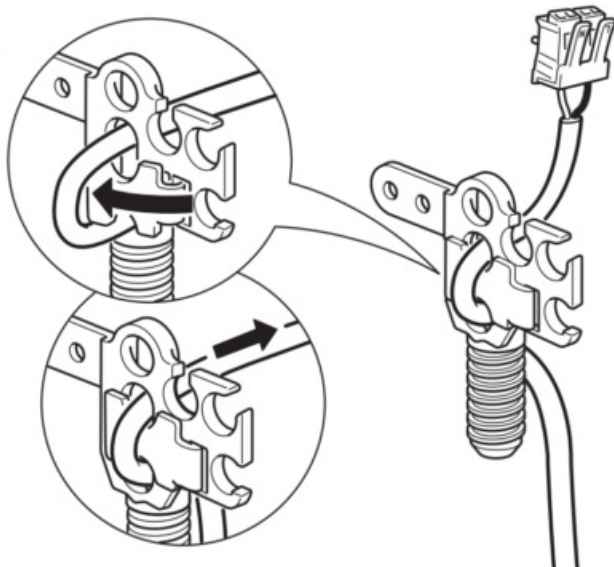

3

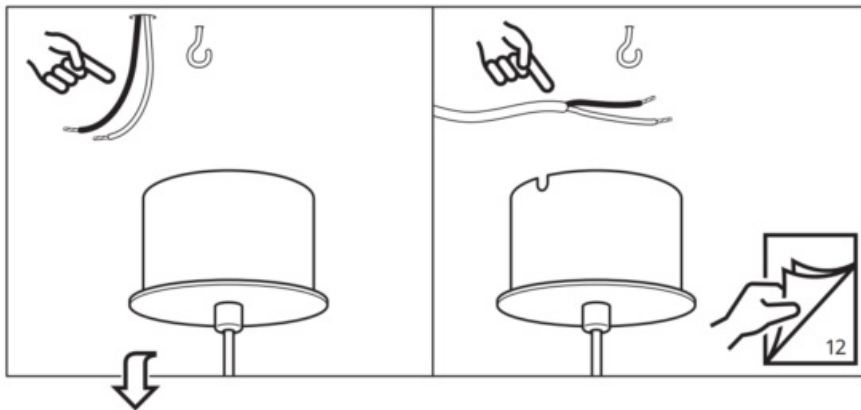
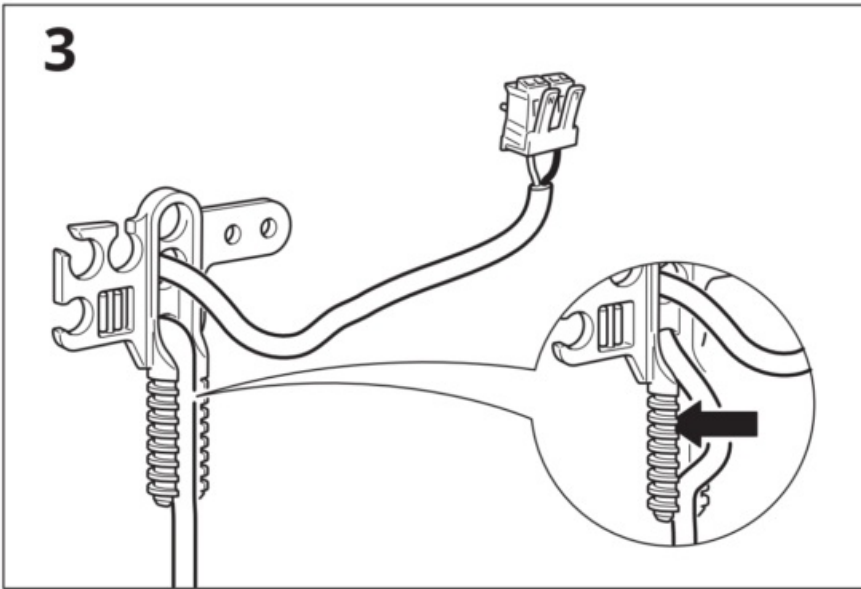

4

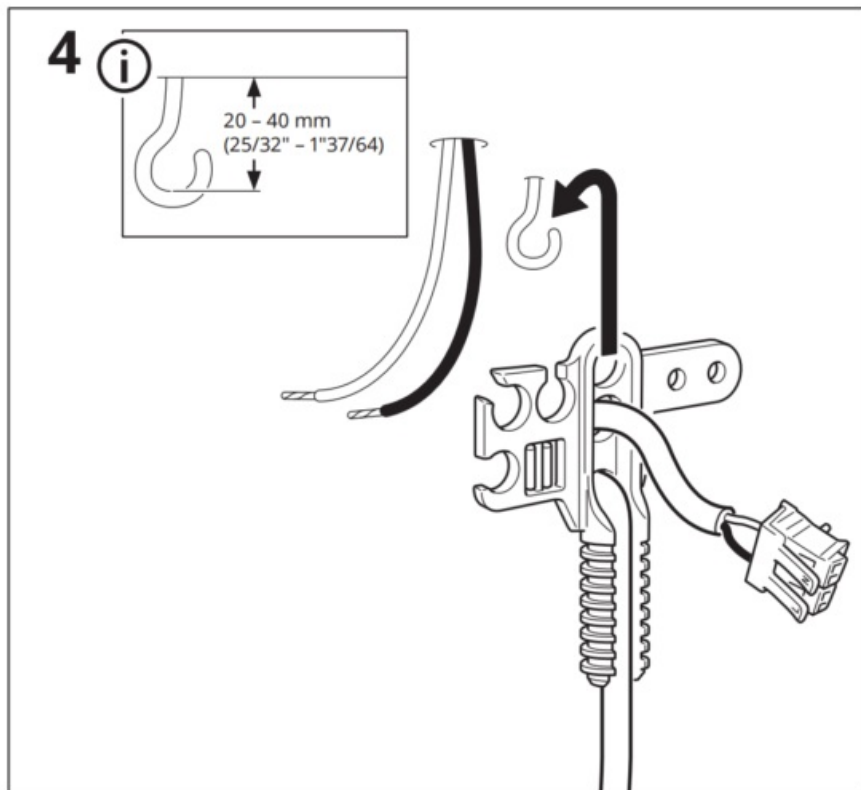
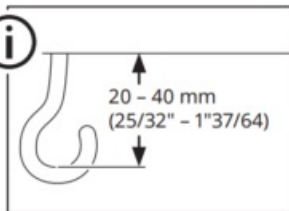

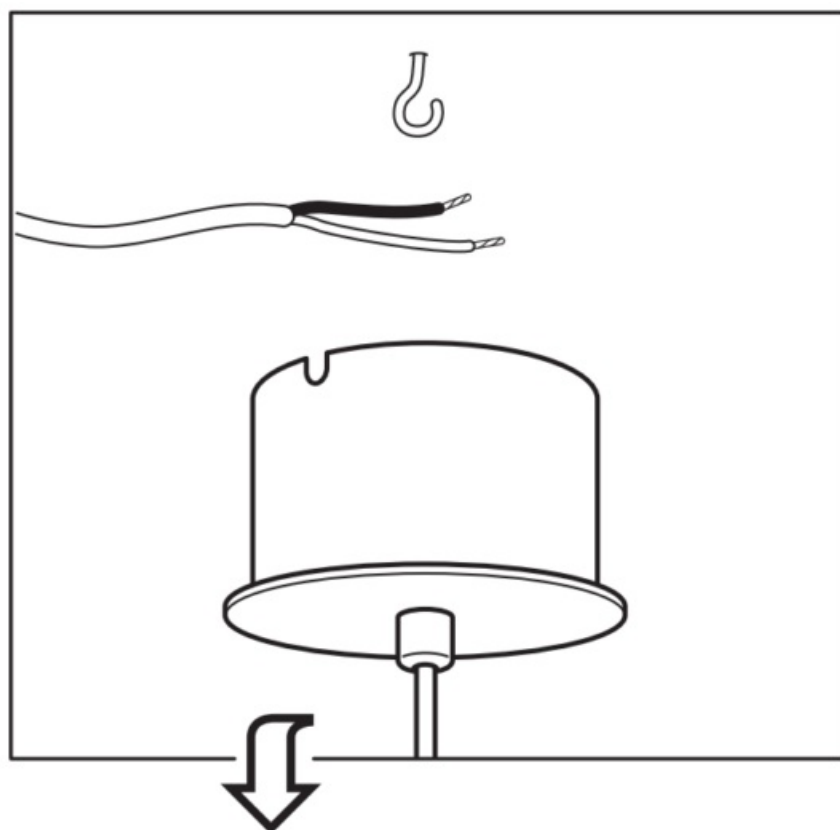
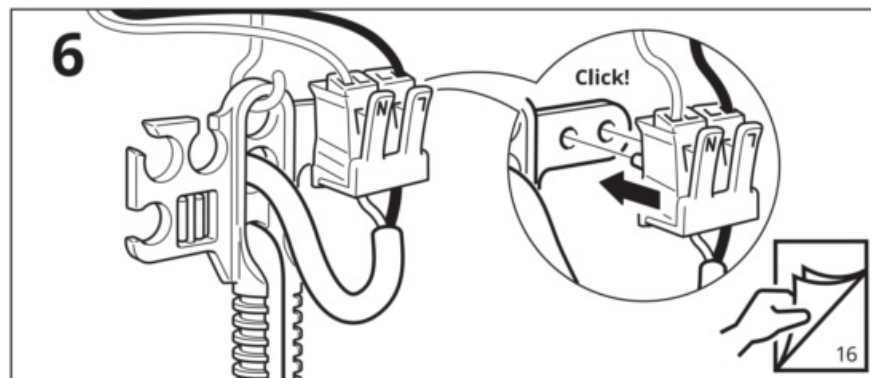
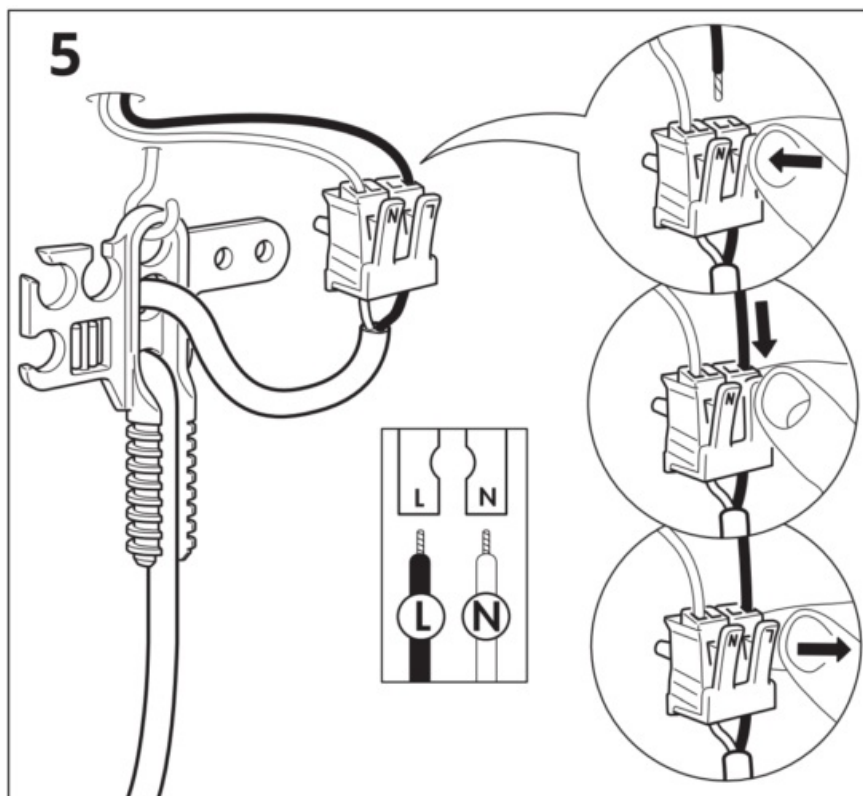

4

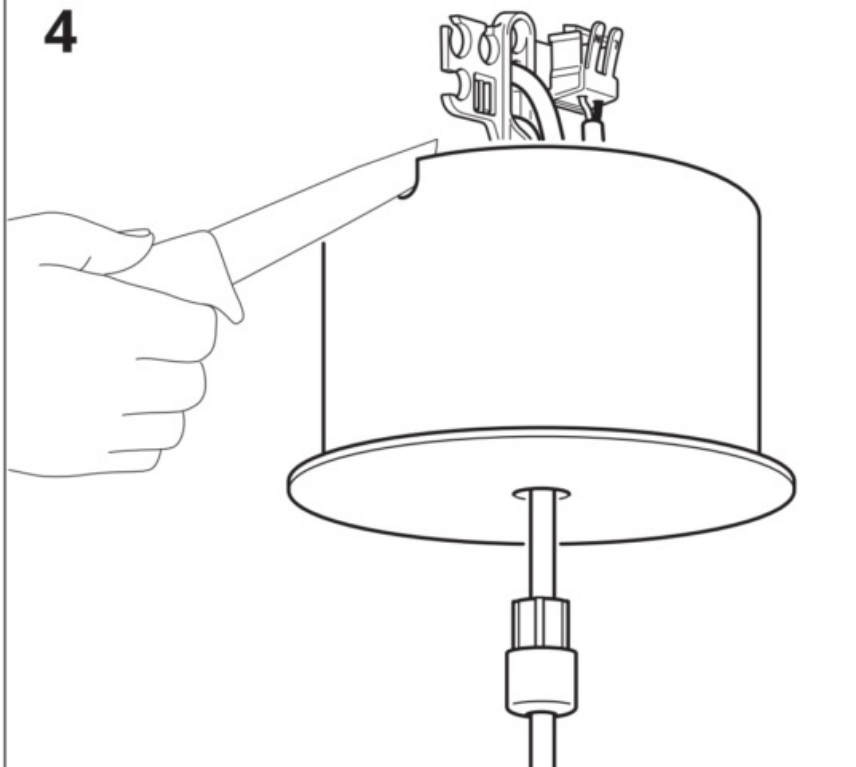

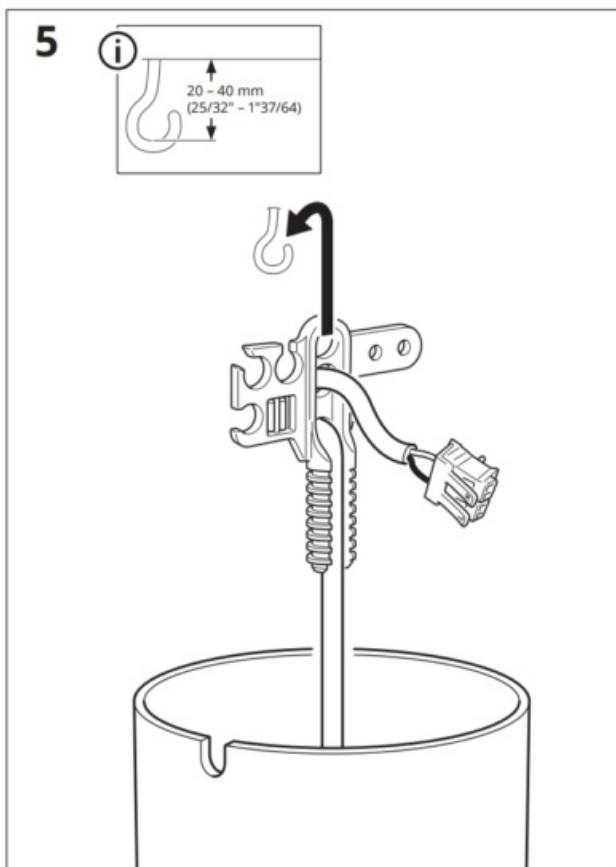
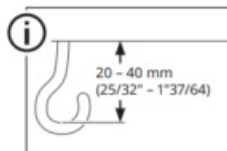

5

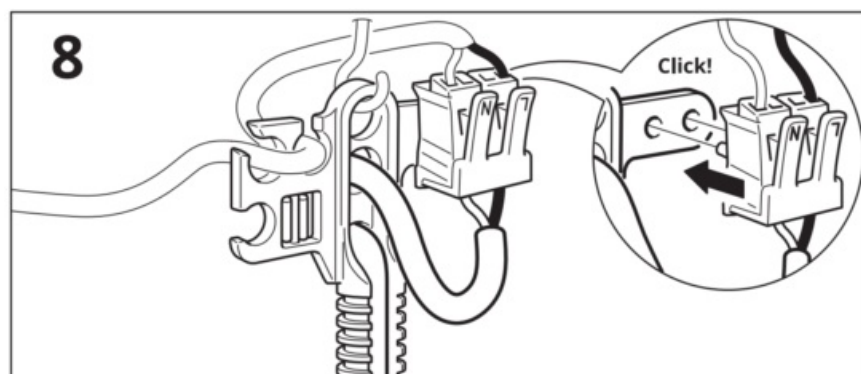
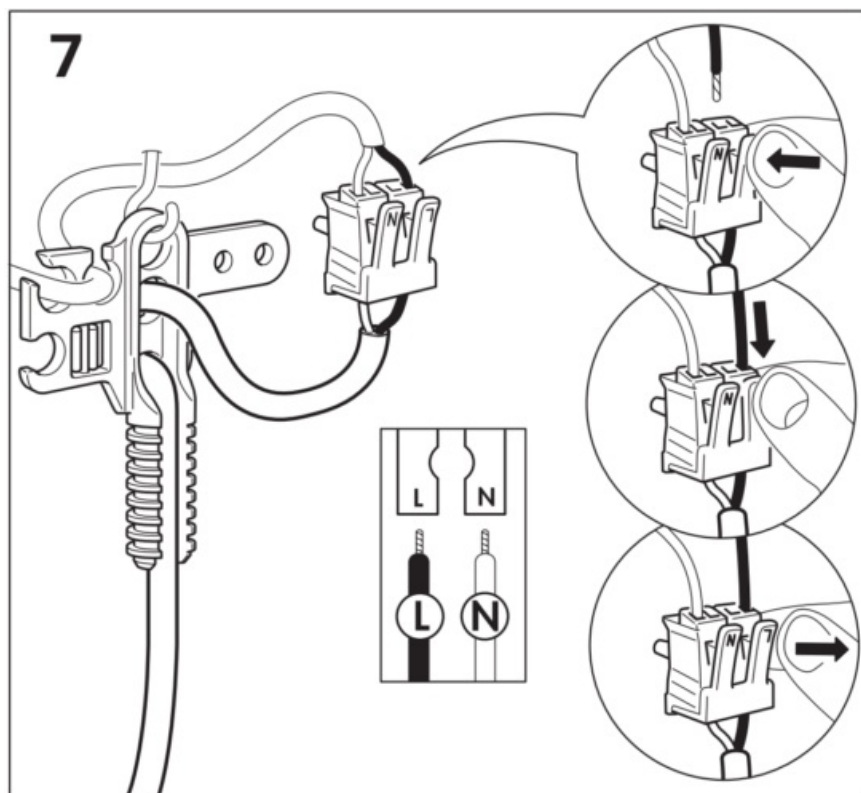
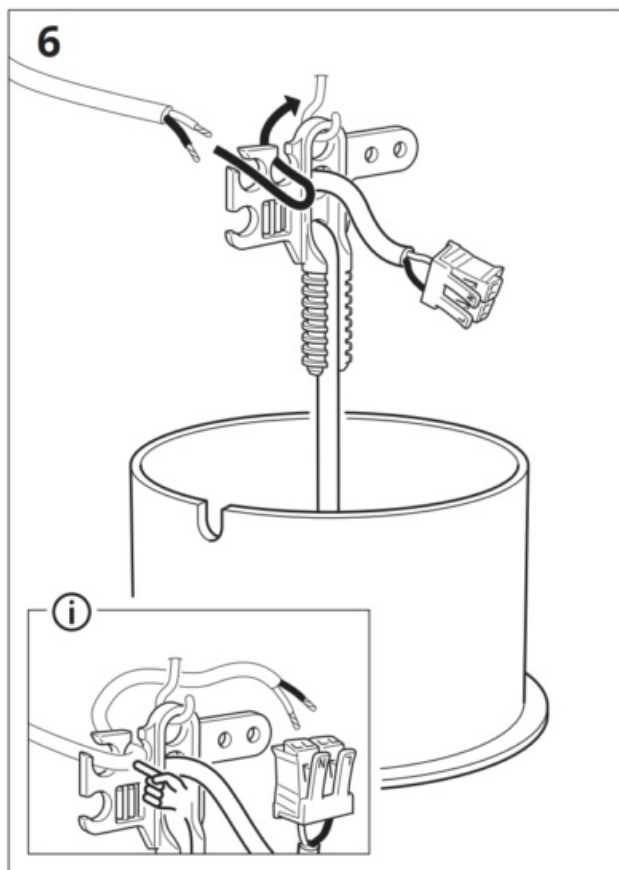



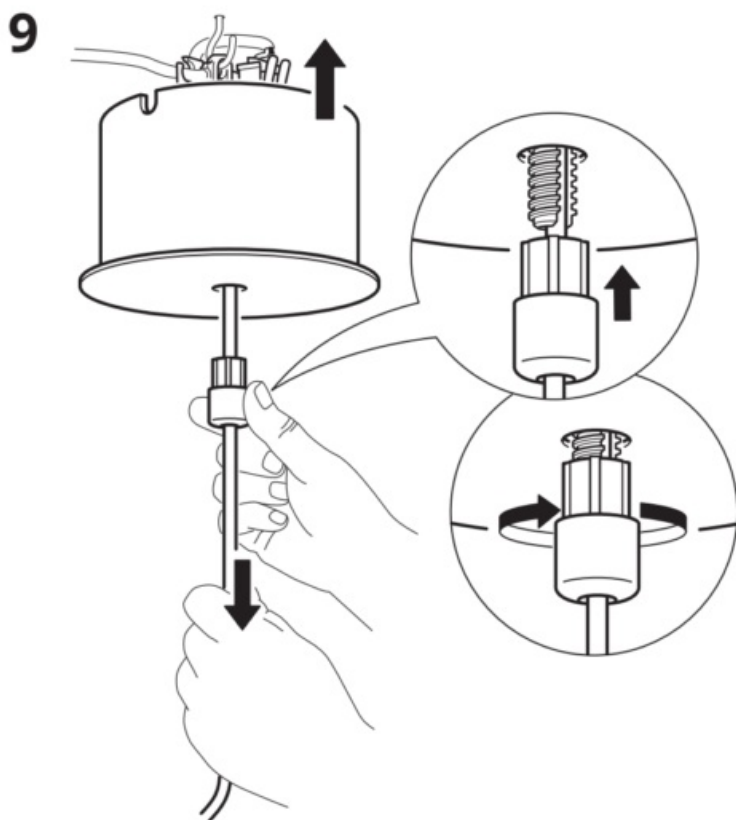



 **CAUTION!** Do not overtighten.



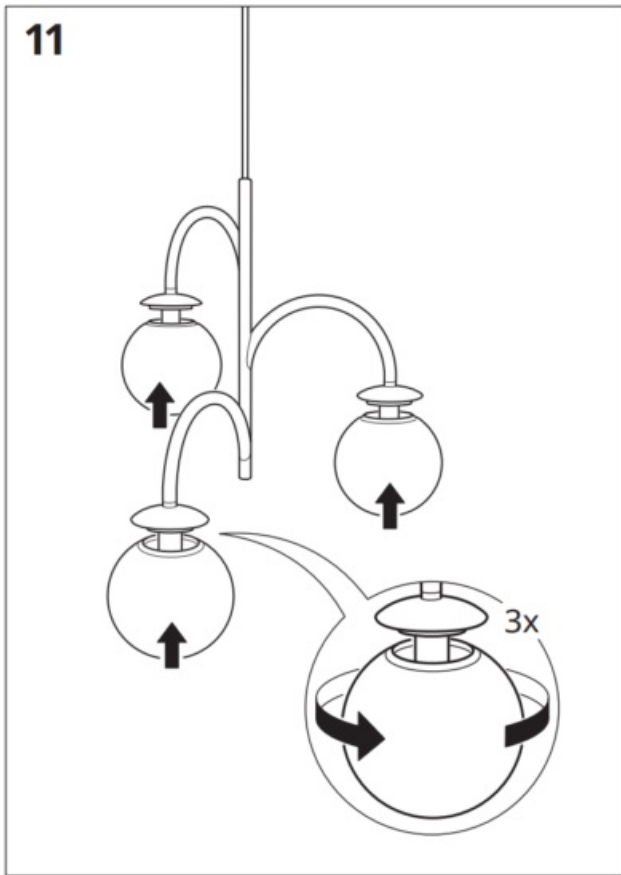



Design and Quality  
IKEA of Sweden

# SIMRISHAMN

## Documents / Resources

<p>SIMRISHAMN</p>  	<p><a href="#">IKEA SIMRISHAMN Wall Lamp with Swing Arm</a> [pdf] Installation Guide AA-2171332-4, SIMRISHAMN Wall Lamp with Swing Arm, SIMRISHAMN, Wall Lamp with Swing Arm, Lamp with Swing Arm, with Swing Arm, Swing Arm, Arm</p>
---	---

## References

- [User Manual](#)

[Manuals+.](#) [Privacy Policy](#)

This website is an independent publication and is neither affiliated with nor endorsed by any of the trademark owners. The "Bluetooth®" word mark and logos are registered trademarks owned by Bluetooth SIG, Inc. The "Wi-Fi®" word mark and logos are registered trademarks owned by the Wi-Fi Alliance. Any use of these marks on this website does not imply any affiliation with or endorsement.