



## FJALLBO Ikea Shelf Unit User Manual

[Home](#) » [Ikea](#) » FJALLBO Ikea Shelf Unit User Manual 

### Contents

- [1 FJALLBO Ikea Shelf Unit User Manual](#)
- [2 Important information](#)
- [3 TOOLS REQUIRED](#)
- [4 WHAT IS IN THE BOX?INSTALLATION INSTRUCTION](#)
- [5 FJALLBO Ikea Shelf Unit User Manual](#)
- [6 Related Posts](#)



## FJALLBO Ikea Shelf Unit User Manual



### Important information

#### **Read carefully.**

Keep this information for further reference.

#### **WARNING**

Serious or fatal crushing injuries can occur from furniture tip-over. To prevent this furniture from tipping over it must be permanently fixed to the wall. Fixing devices for the wall are not included since different wall materials require different types of fixing devices. Use fixing devices suitable for the walls in your home. For advice on suitable fixing systems, contact your local specialized dealer.

## TOOLS REQUIRED

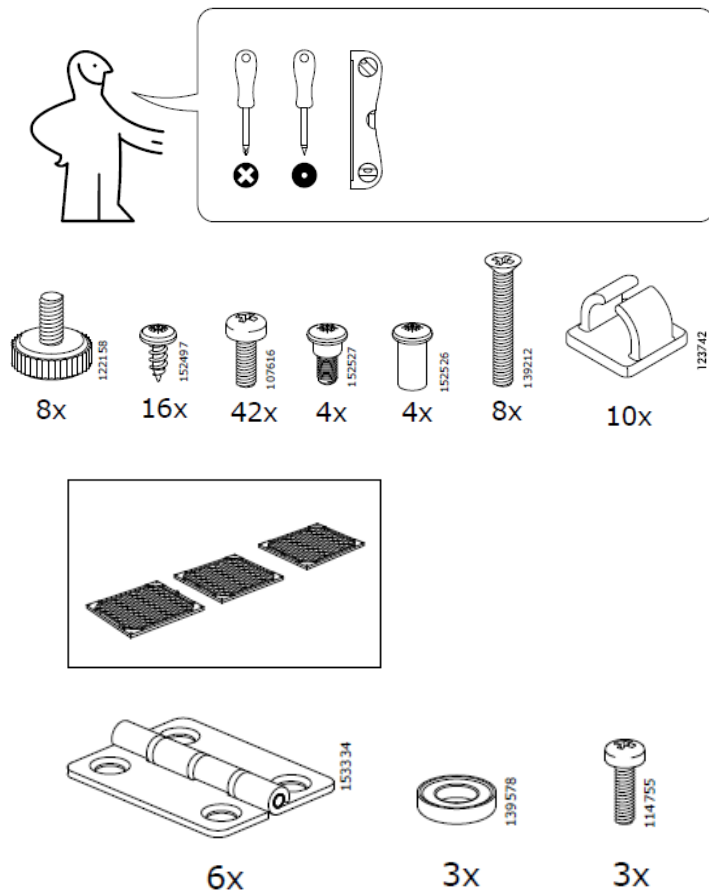

## WHAT IS IN THE BOX?



## INSTALLATION INSTRUCTION

1

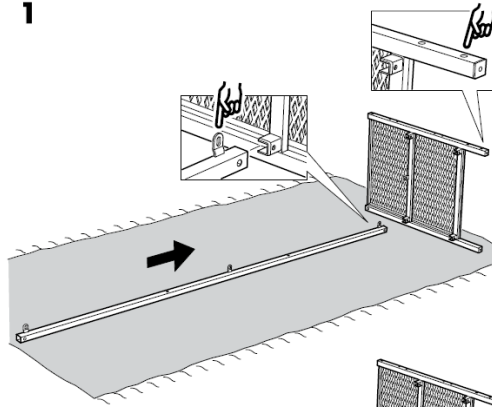

2

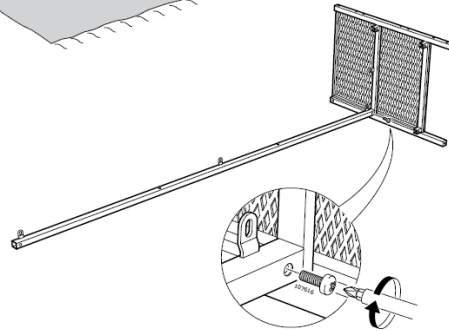

3

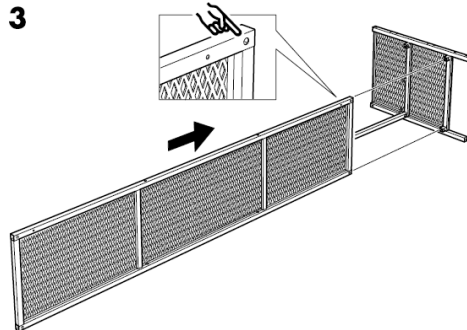

4

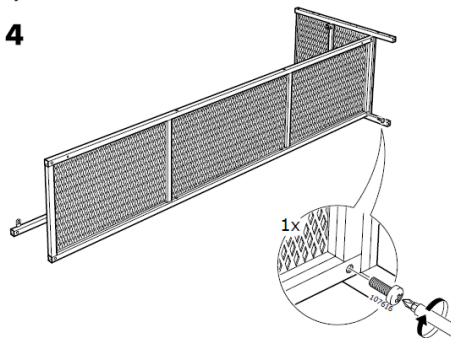

5

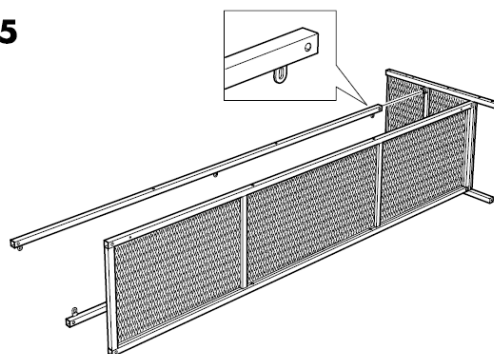

6

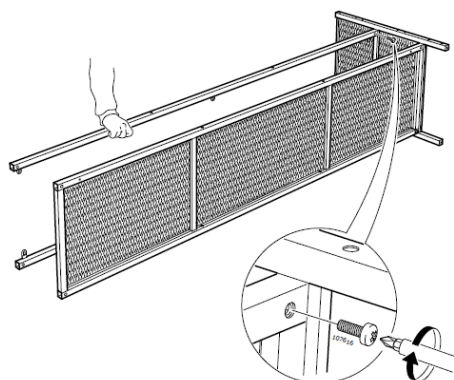

7

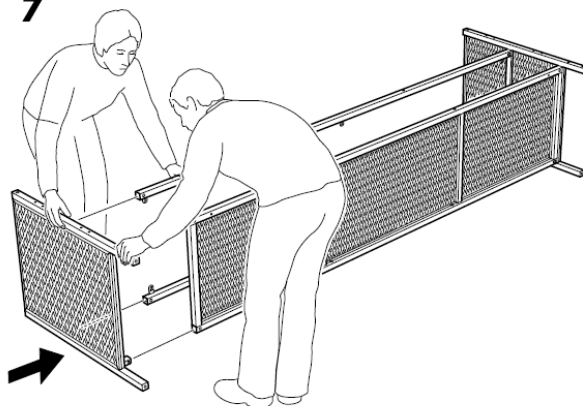

8

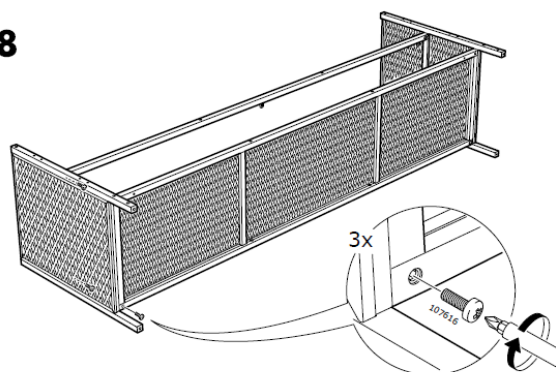

9

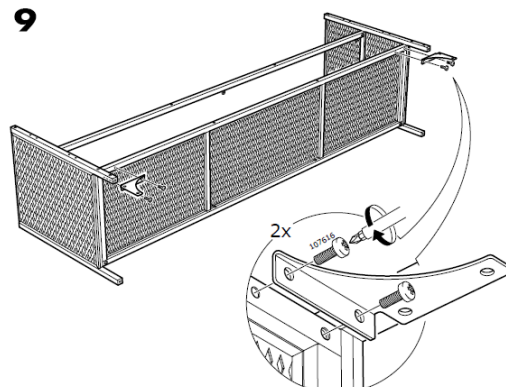

10

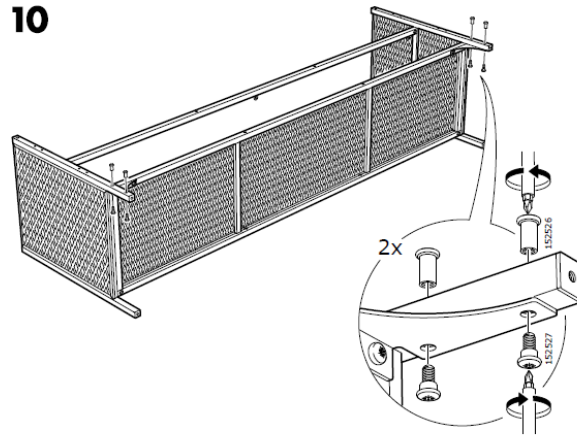

11

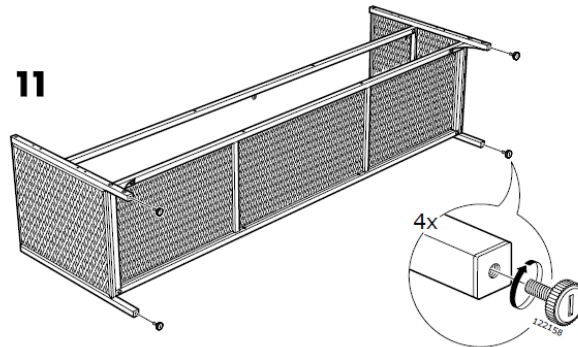

12

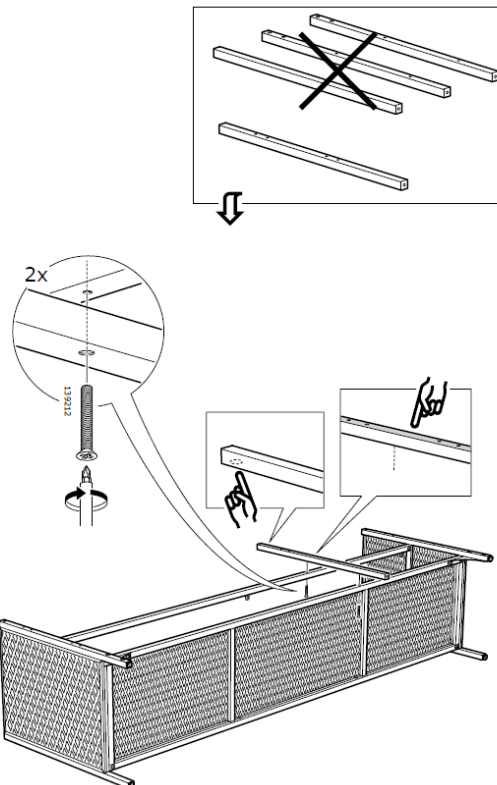

**13**

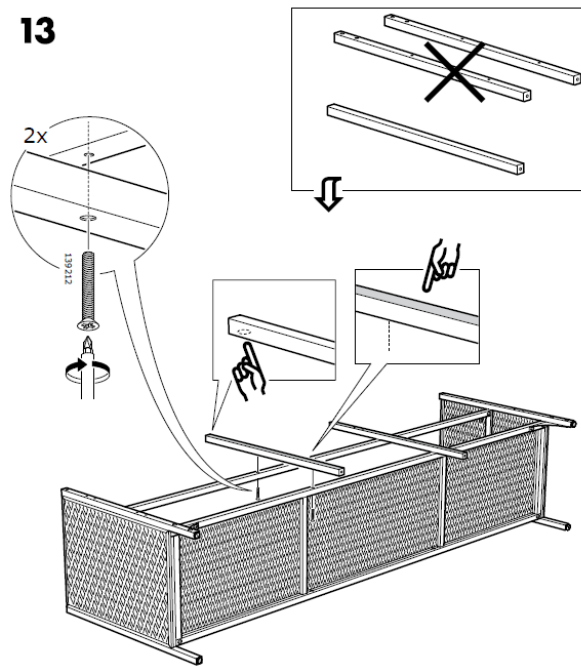

**14**

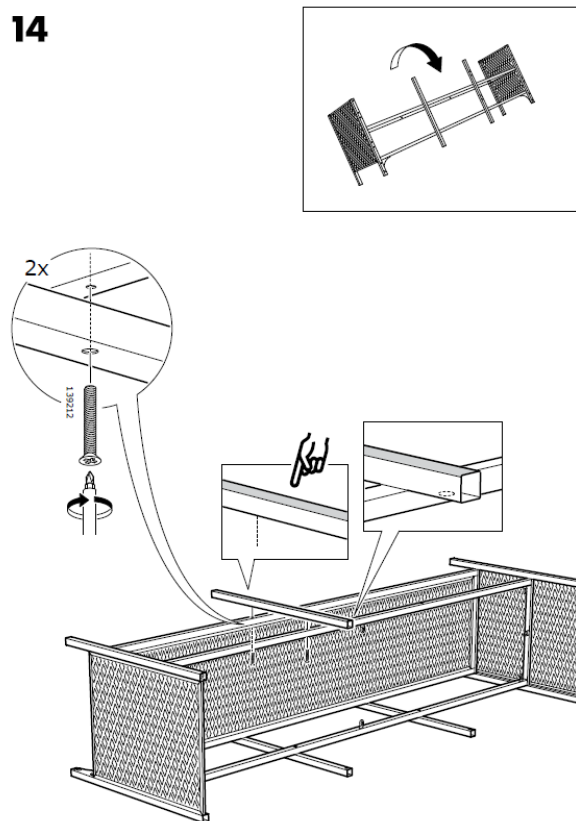

15

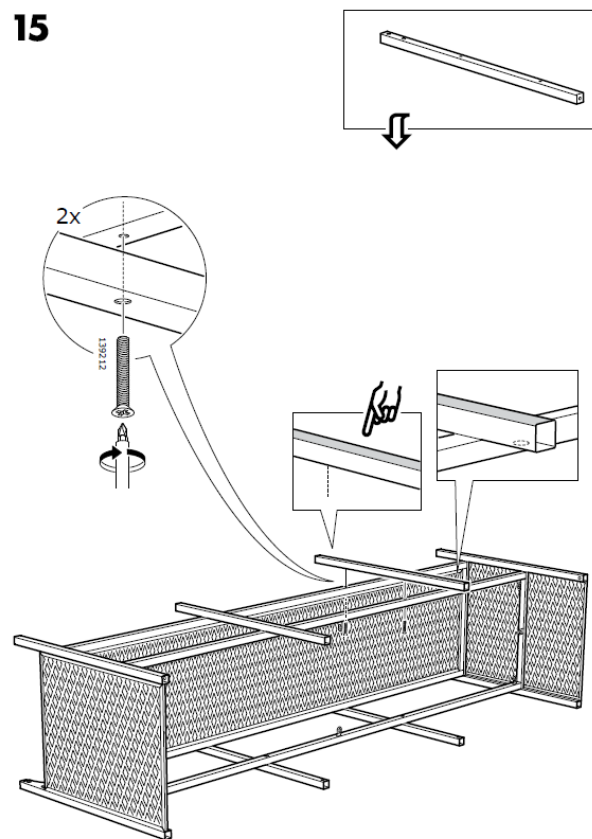

16

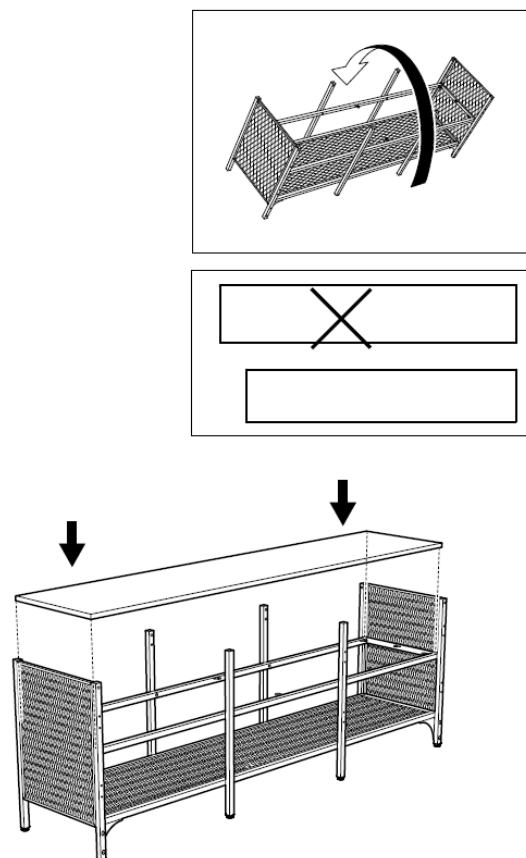



17

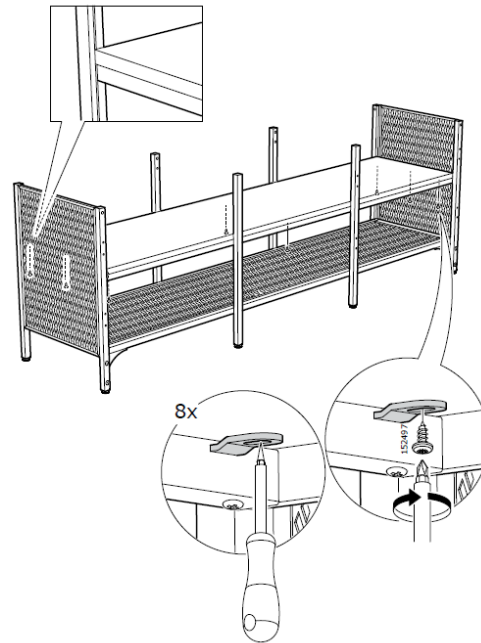

18

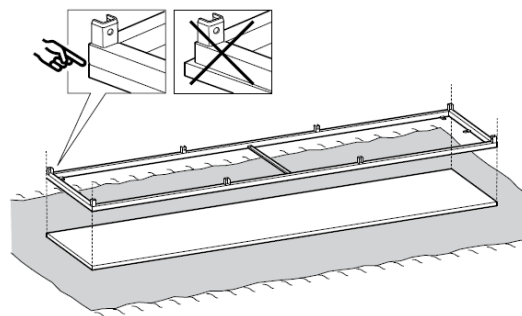

19

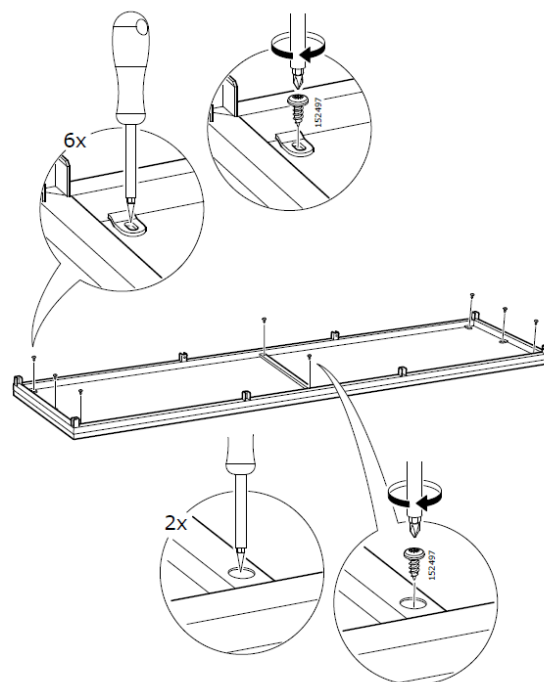

**20**

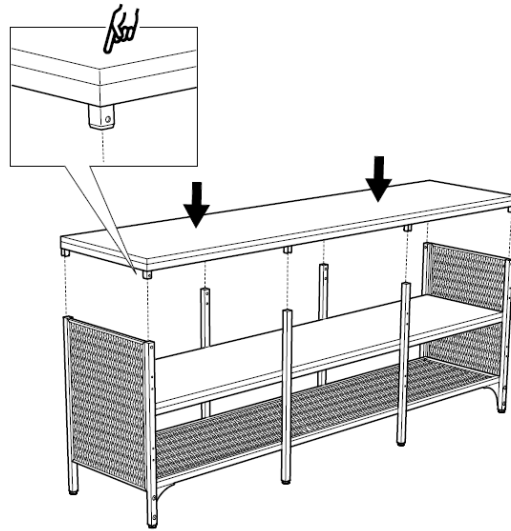
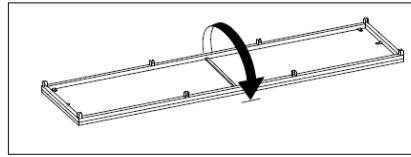

**21**

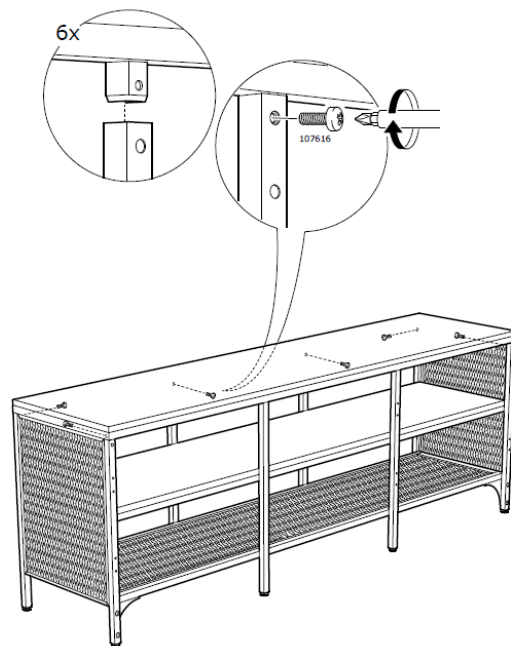

**22**

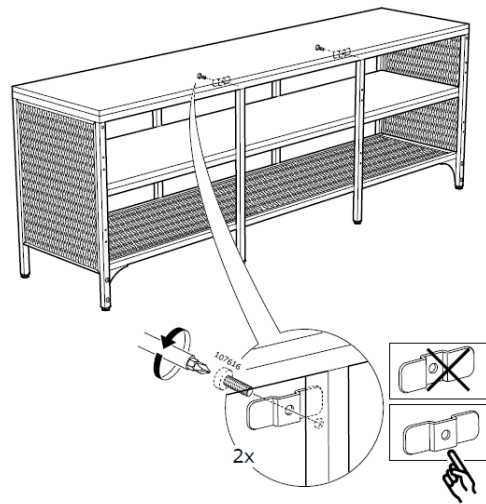

**23**

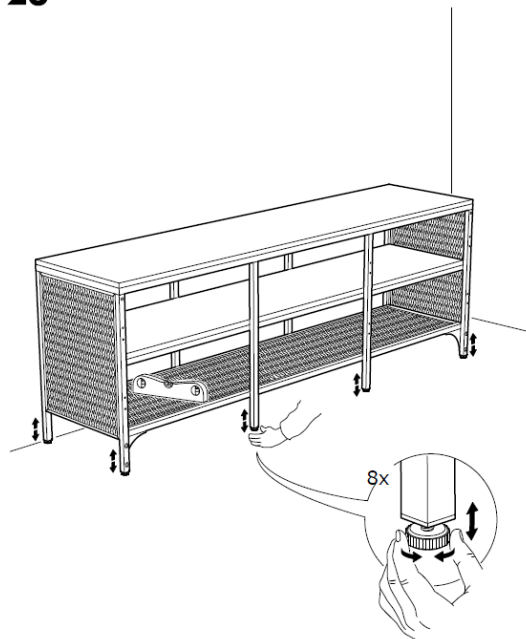

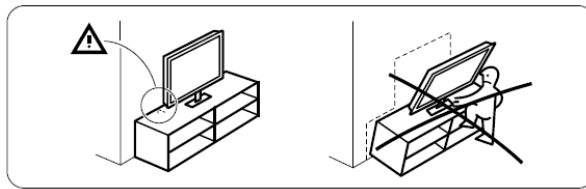

**24**

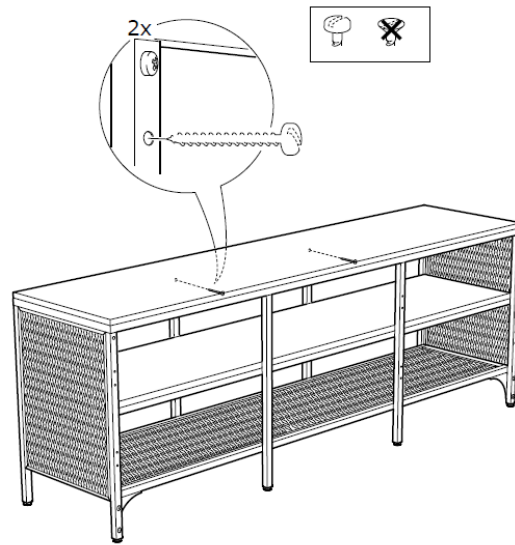

**25**

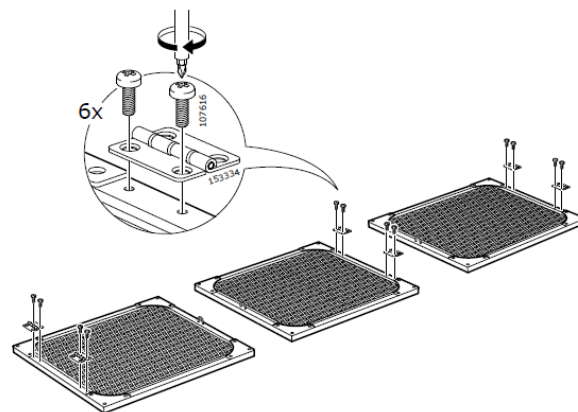

**26**

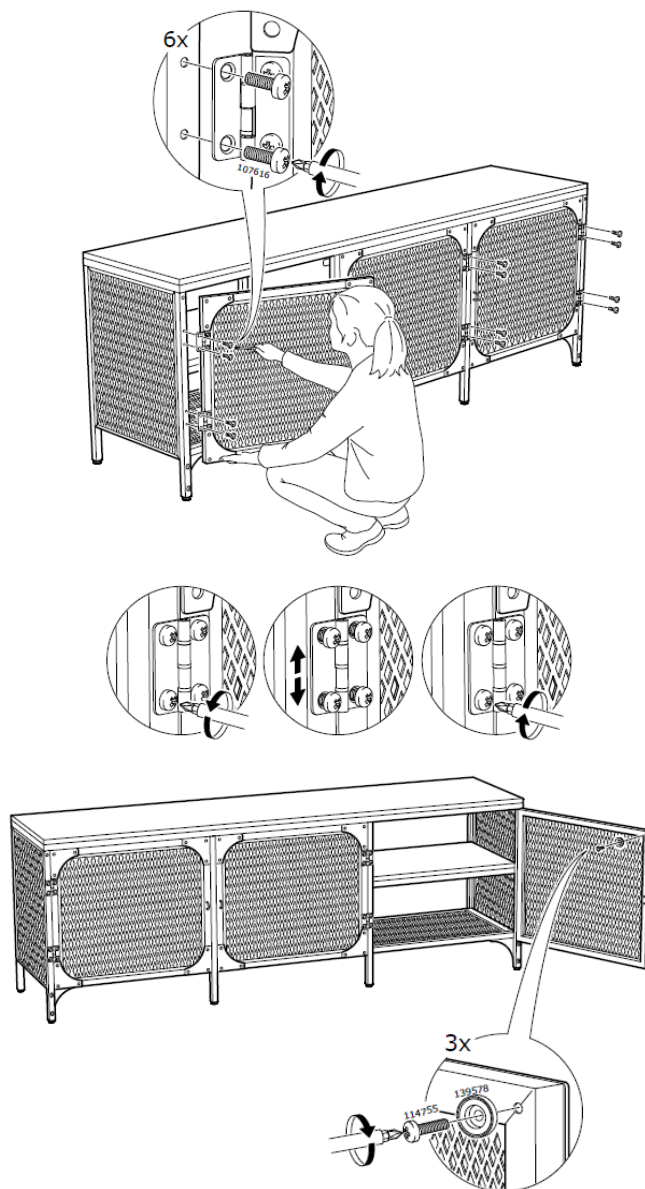

**28**

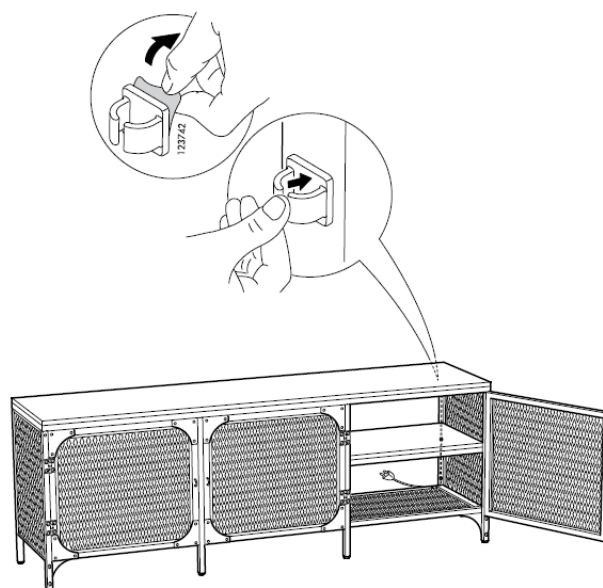

2016-09-08  
AA-1927215-2

## **FJALLBO Ikea Shelf Unit User Manual**

Download PDF: [FJALLBO Ikea Shelf Unit User Manual](#)

Manuals+.