

IKEA Lindasen Display Shelf Instruction Manual

[Home](#) » [Ikea](#) » IKEA Lindasen Display Shelf Instruction Manual 

Contents

- [1 IKEA Lindasen Display Shelf](#)
- [2 Product Information](#)
- [3 Product Usage Instructions](#)
- [4 Important information](#)
- [5 TOOLS REQUIRED](#)
- [6 ASSEMBLING INSTRUCTION](#)
- [7 Documents / Resources](#)
- [8 Related Posts](#)



IKEA Lindasen Display Shelf

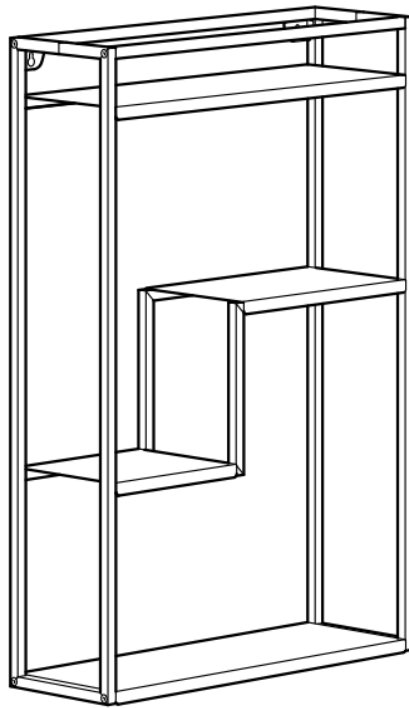

Product Information

This product is a piece of furniture that needs to be permanently fixed to the wall to prevent it from falling down. The user manual provides important information and warnings in multiple languages, emphasizing the potential for serious or fatal crushing injuries if the furniture is not properly secured.

Product Usage Instructions

1. Read the user manual carefully: It is important to read and understand all the instructions provided in the user manual before attempting to use or assemble the product.
2. Secure the furniture to the wall: To prevent the furniture from falling down and causing injuries, it must be permanently fixed to the wall. Use appropriate wall mounting hardware and follow the instructions for proper installation.
3. Seek professional help if needed: If you are unsure about how to properly secure the furniture to the wall or if you have any doubts about the suitability of your walls for installation, it is recommended to consult a professional or specialist for assistance.
4. Follow all safety precautions: When using the product, make sure to follow all safety precautions mentioned in the user manual. This includes avoiding overloading the furniture, using it on a stable surface, and keeping it away from children or pets.
5. Store the user manual for future reference: After reading and understanding the instructions, keep the user manual in a safe place for future reference. It may contain additional information or troubleshooting tips that can be useful later on. Remember, the primary purpose of securing the furniture to the wall is to ensure safety and prevent accidents. Always prioritize safety when using this product.

Important information

Read carefully and follow each step of the instruction carefully
Keep this information for further reference

WARNING

- Serious or fatal crushing injuries can occur from furniture falling down.
- To prevent this furniture from falling down it must be permanently fixed to the wall.
- Assembly should be carried out by a qualified person, because wrong assembly may lead to that the furniture will fall down and cause injury or damage. Fastening devices for the wall are not included since different wall materials require different types of fastening devices. Use fastening devices suitable for the walls in your home. Assess the suitability of the wall to ensure that the fastening devices will withstand the forces generated. For advice on suitable fastening devices, contact your local specialized dealer.

TOOLS REQUIRED

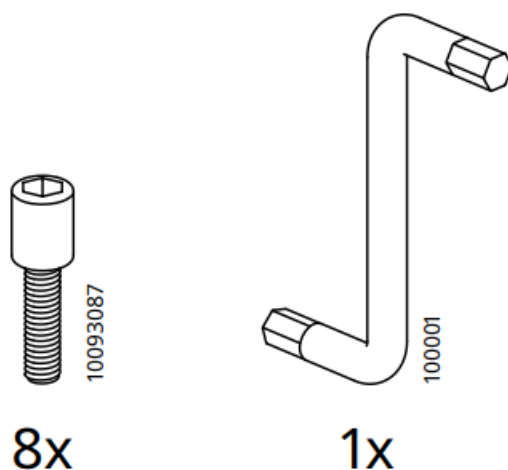

ASSEMBLING INSTRUCTION

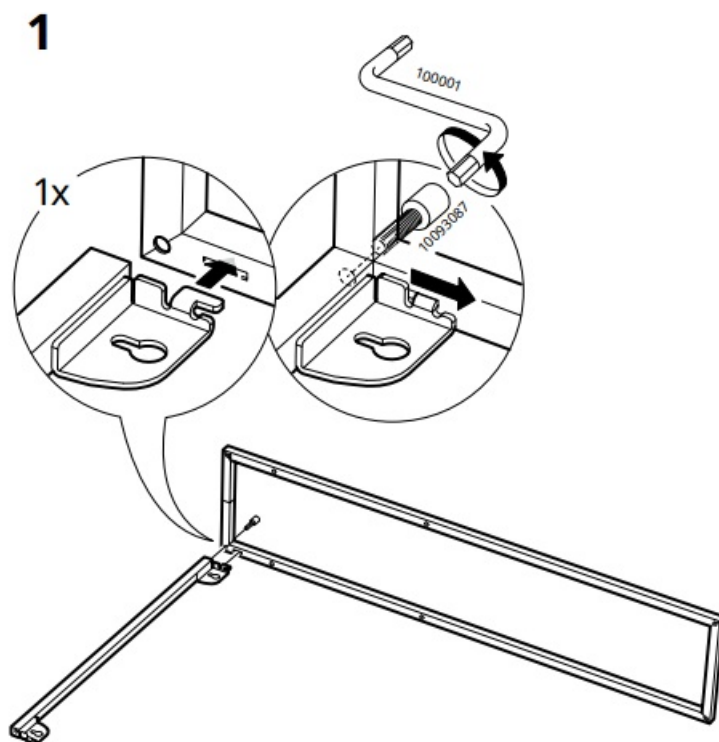

2

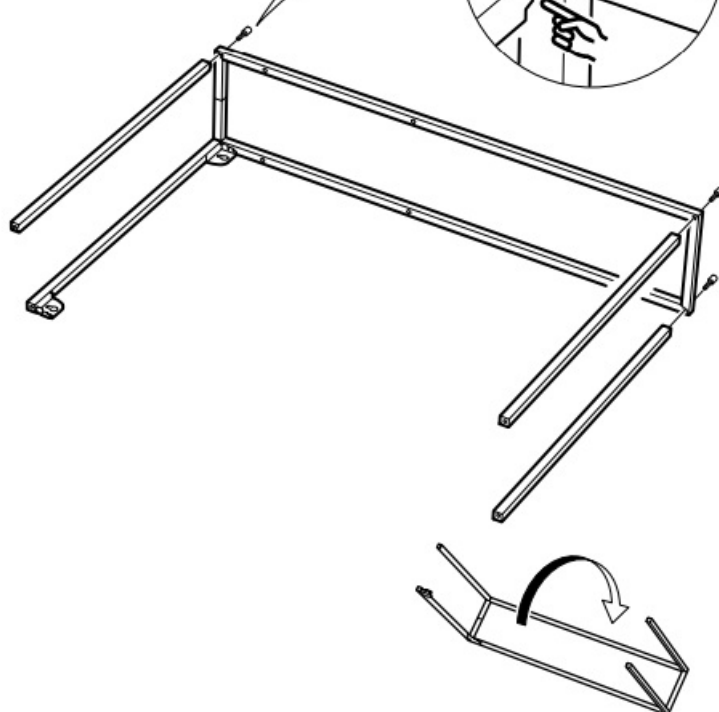
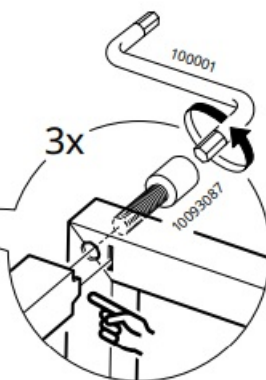
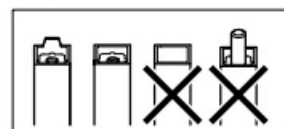

3

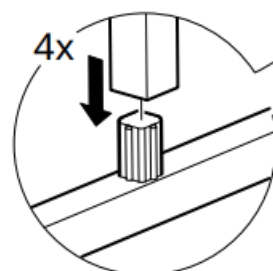
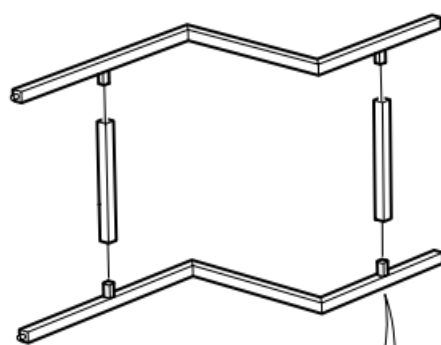
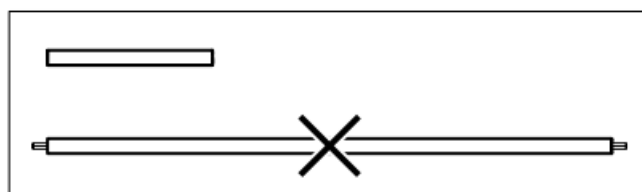

4

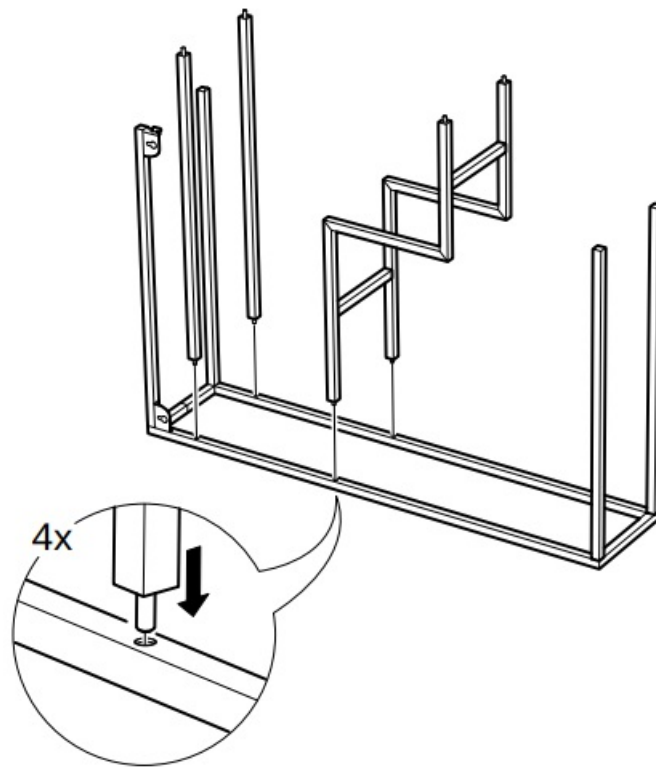

5

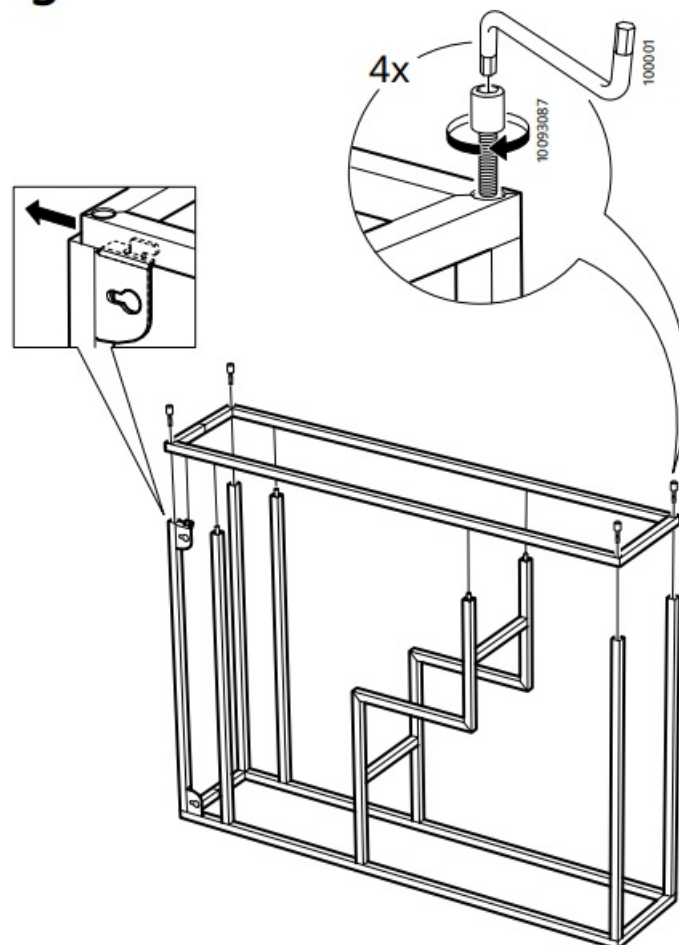

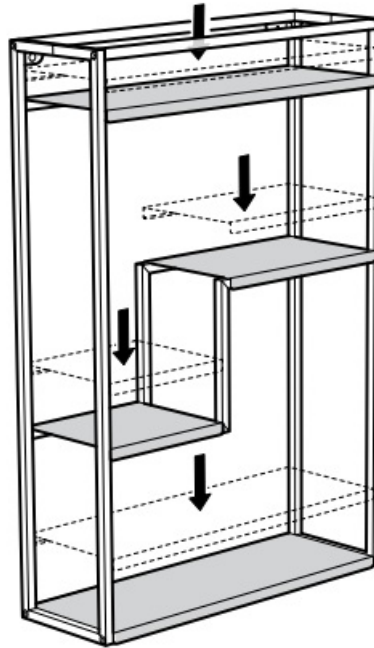
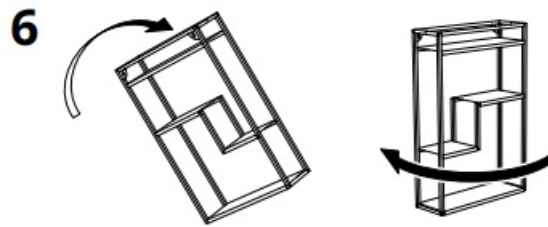

Documents / Resources

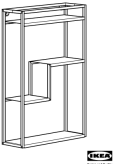
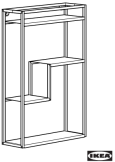
<p>LINDÅSEN</p> 	<p>IKEA Lindasen Display Shelf [pdf] Instruction Manual AA-2333896-1, Lindasen Display Shelf, Lindasen, Lindasen Shelf, Display Shelf, Shelf</p>
<p>LINDÅSEN</p> 	<p>IKEA LINDÅSEN Display Shelf [pdf] Instruction Manual 005.158.05, LINDÅSEN Display Shelf, LINDÅSEN, LINDÅSEN Shelf, Display Shelf, Shelf</p>