



# IKEA KALLAX Open Cupboard Instruction Manual

[Home](#) » [Ikea](#) » IKEA KALLAX Open Cupboard Instruction Manual 

## Contents

- [1 IKEA KALLAX Open Cupboard](#)
- [2 Product Information](#)
- [3 Product Usage Instructions](#)
- [4 Important Safety Instruction](#)
- [5 Caution](#)
- [6 Parts List](#)
- [7 Installation](#)
- [8 Documents / Resources](#)
- [9 Related Posts](#)



**IKEA KALLAX Open Cupboard**



## Product Information

KALLAX is a furniture product that requires wall attachment to prevent it from falling down. The product comes with wall attachment device(s) but screws and plugs for the wall are not included. It is necessary to assess the suitability of the wall to ensure that it will withstand the forces generated. Suitable screw(s) and plug(s) should be used for your walls and the intended load. Professional advice should be sought if there is uncertainty.

## Product Usage Instructions

1. Inspect the suitability of the wall to ensure it can withstand the forces generated by KALLAX.
2. Use screws and plugs suitable for your walls and the intended load. If you are uncertain, seek professional advice.
3. Attach the wall attachment device(s) provided with KALLAX to the wall using suitable screws and plugs.
4. Attach KALLAX to the wall attachment device(s) using the appropriate method as described in the product manual.
5. Ensure that KALLAX is securely attached to the wall and test for stability before use.

### Note:

It is important to read and follow each step of the instruction carefully to prevent serious or fatal crushing injuries that can occur from furniture falling down.

## Important Safety Instruction

### WARNING!

Serious or fatal crushing injuries can occur from furniture falling down. To prevent this furniture from falling down it must be used with the wall attachment device(s) provided. Screw(s) and plug(s) for the wall are not included. Assess the suitability of the wall to ensure that it will withstand the forces generated. Use screw(s) and plug(s) suitable for your walls and the intended load. If you are uncertain, seek professional advice. Read and follow each step of the instruction carefully.

## Caution

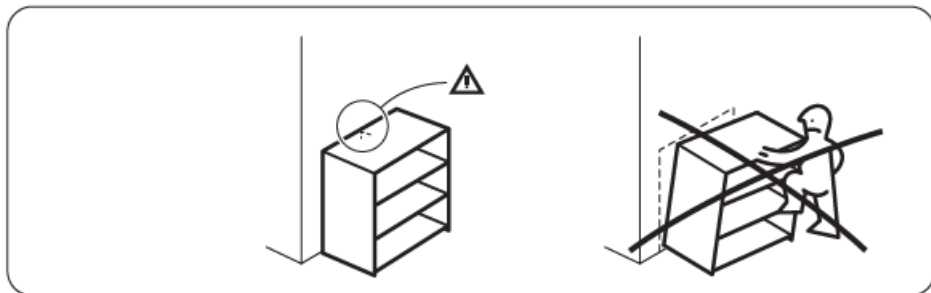
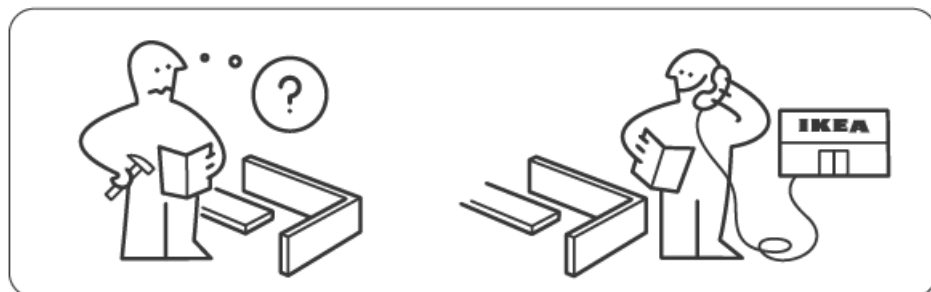
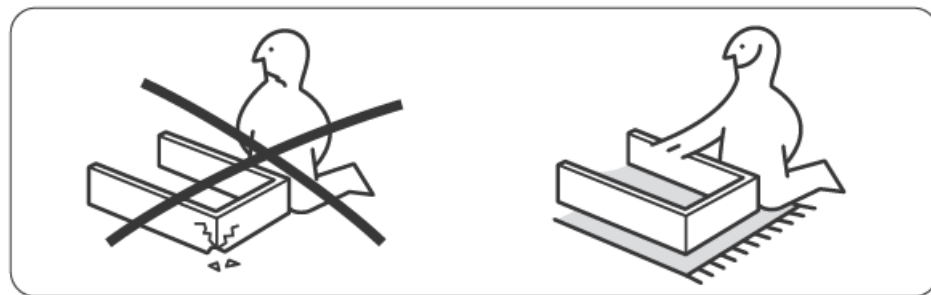
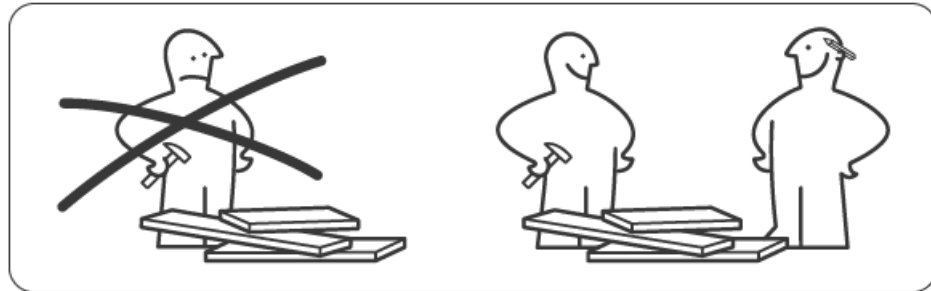
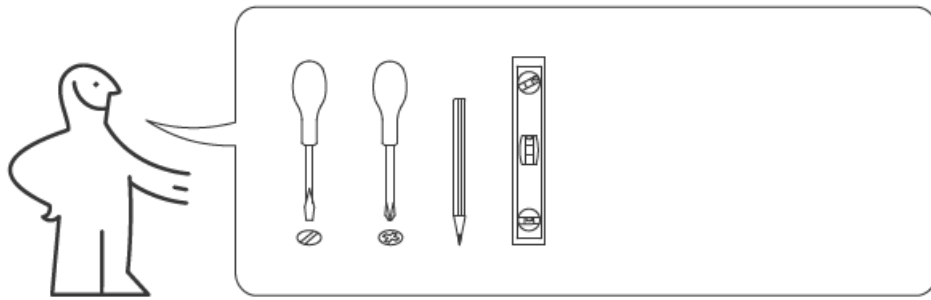

## Parts List

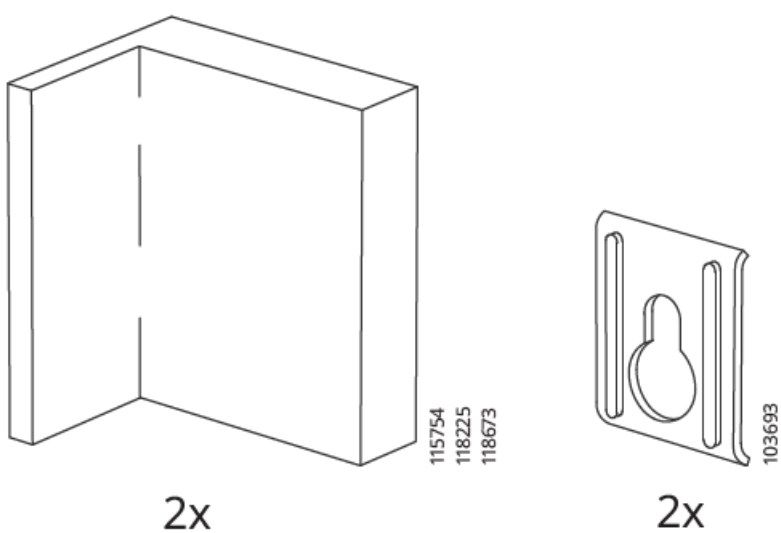
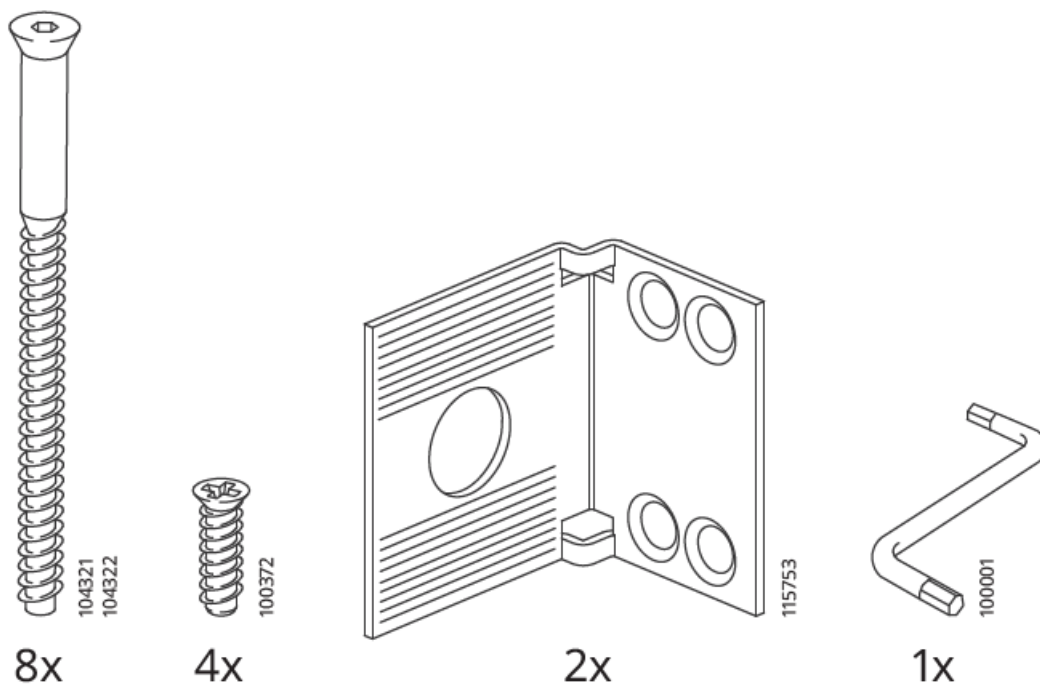

## Installation

1

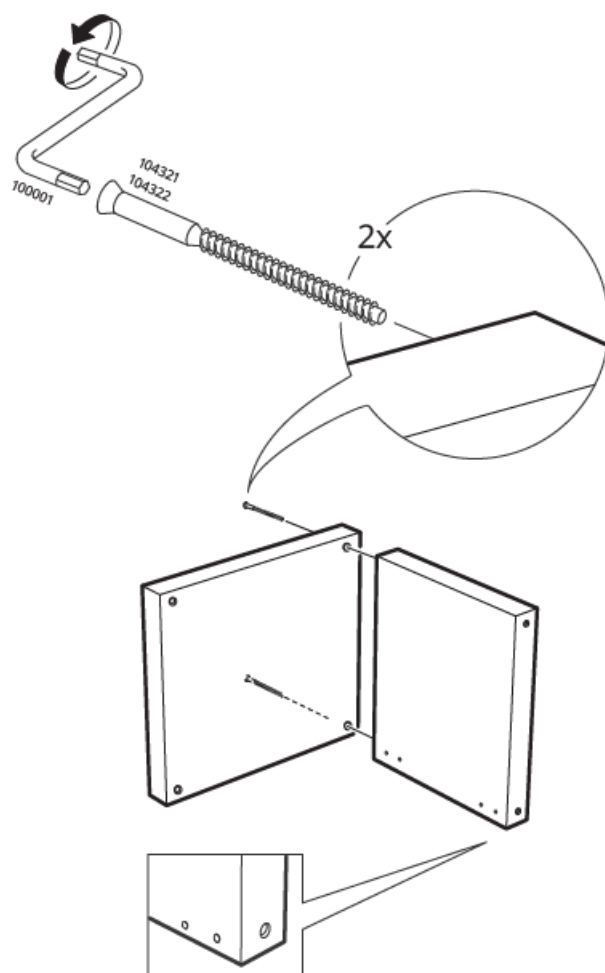

2

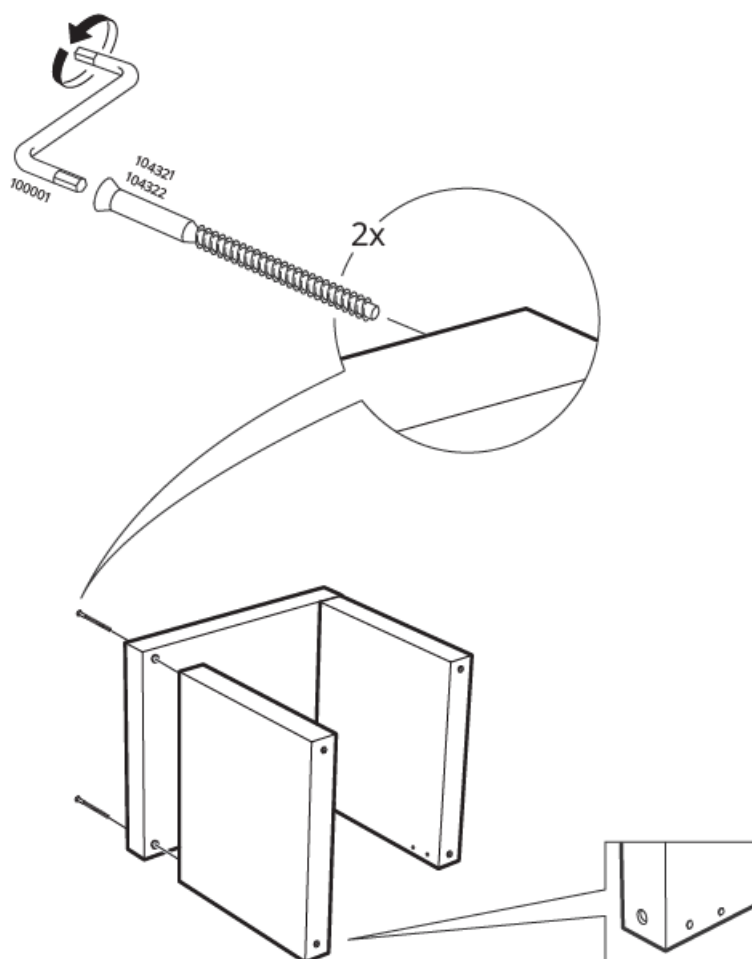

3

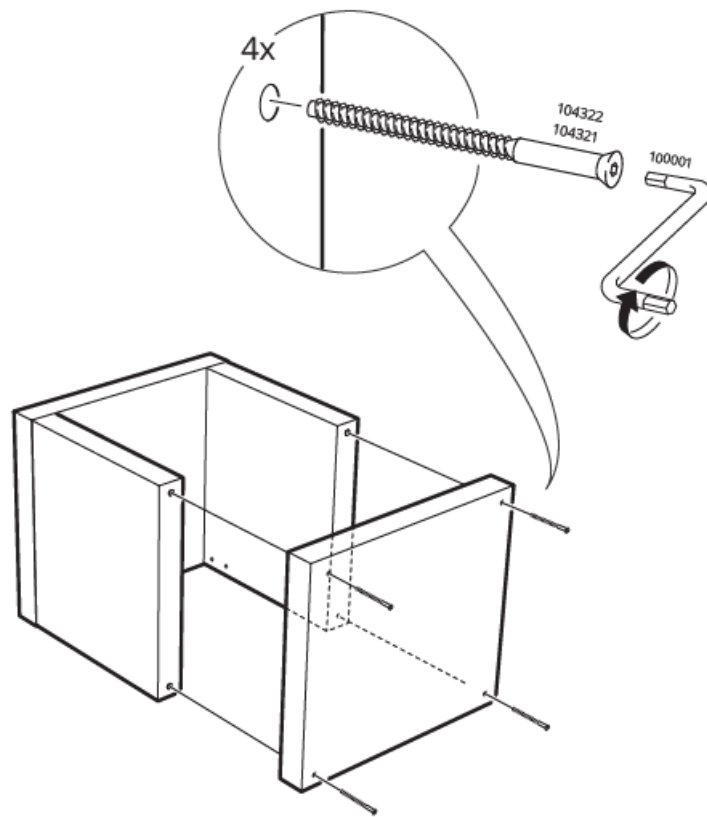

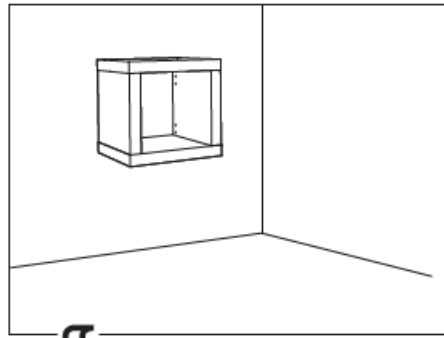

4

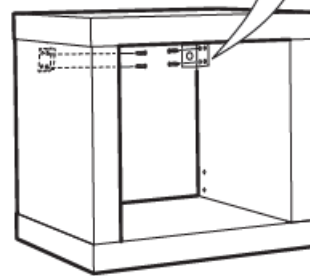
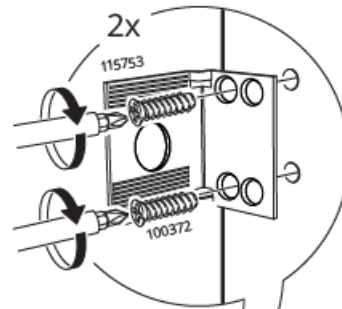

5

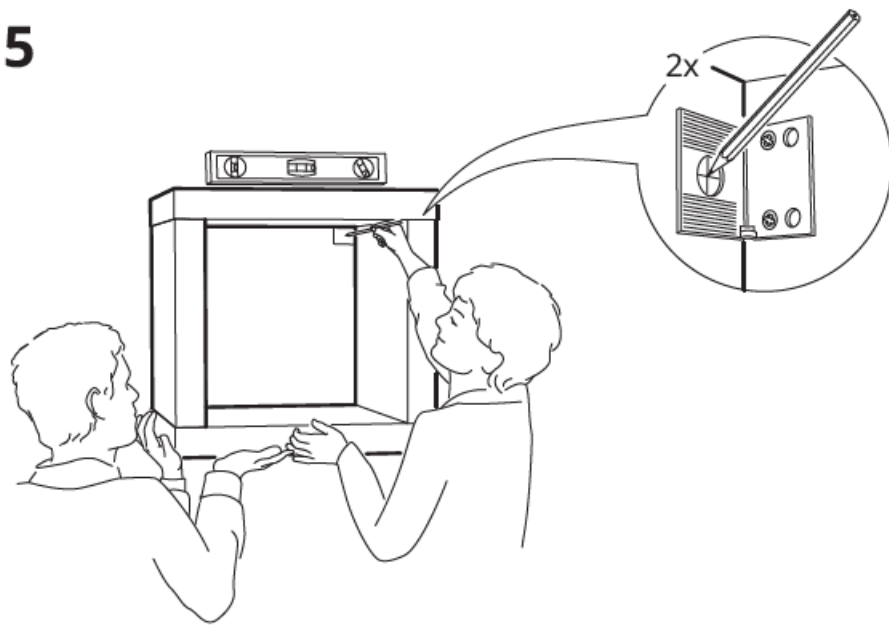

6

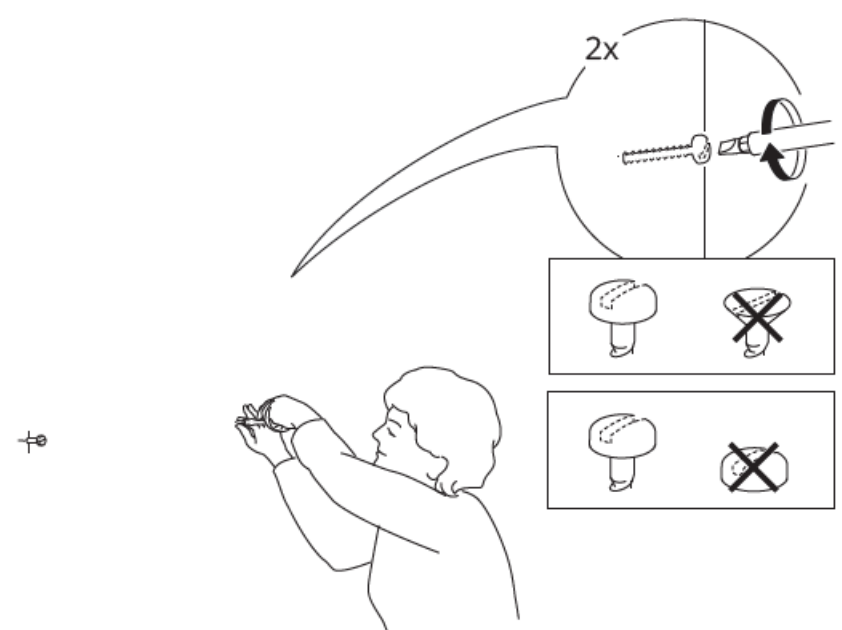



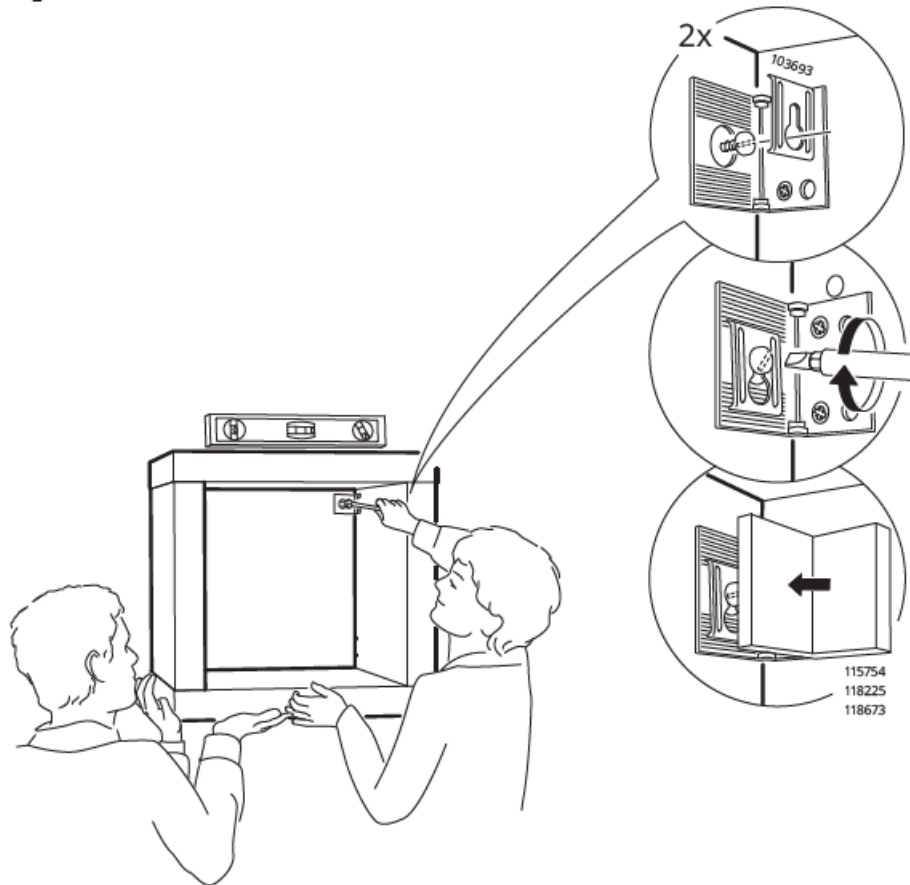



© Inter IKEA Systems B.V. 2022

[www.IKEA.com](http://www.IKEA.com).

## Documents / Resources

<p><b>KALLAX</b></p>  	<p><a href="#">IKEA KALLAX Open Cupboard</a> [pdf] Instruction Manual KALLAX Open Cupboard, KALLAX, Open Cupboard, Cupboard</p>
--	---