



Kallax Instructions: IKEA Assembly Manual & Tips for Stability

[Home](#) » [Ikea](#) » Kallax Instructions: IKEA Assembly Manual & Tips for Stability

The IKEA KALLAX is a versatile piece of furniture that can be used for storage, as a room divider, or even as a desk. However, it is important to follow the assembly instructions carefully to ensure stability and prevent tip-over accidents. The KALLAX comes with wall attachment devices, which must be used to prevent serious or fatal crushing injuries. The manual provides step-by-step instructions for assembly and answers frequently asked questions, such as how to make the KALLAX more stable and whether it can be wall-mounted or cut. Additionally, the manual includes a video tutorial for visual learners. The KALLAX is made from 100% wood from more sustainable sources, and its design has been updated to reduce its impact on the environment. With proper assembly and care, the KALLAX can be a functional and stylish addition to any home.

Contents [[hide](#)]

- [1 IKEA KALLAX](#)
- [2 SPECIFICATIONS](#)
- [3 FAQ'S](#)
- [4 VIDEO](#)
- [5 Documents / Resources](#)
- [6 Related Posts](#)



IKEA KALLAX



IKEA KALLAX



WARNING!

Serious or fatal crushing injuries can occur from furniture tip-over. To prevent tip-over this furniture must be used with the wall attachment device(s) provided.

Screw(s) and plug(s) for the wall are not included.

Use screw(s) and plug(s) suitable for your walls. If you are uncertain, seek professional advice. Read and follow each step of the instruction carefully.

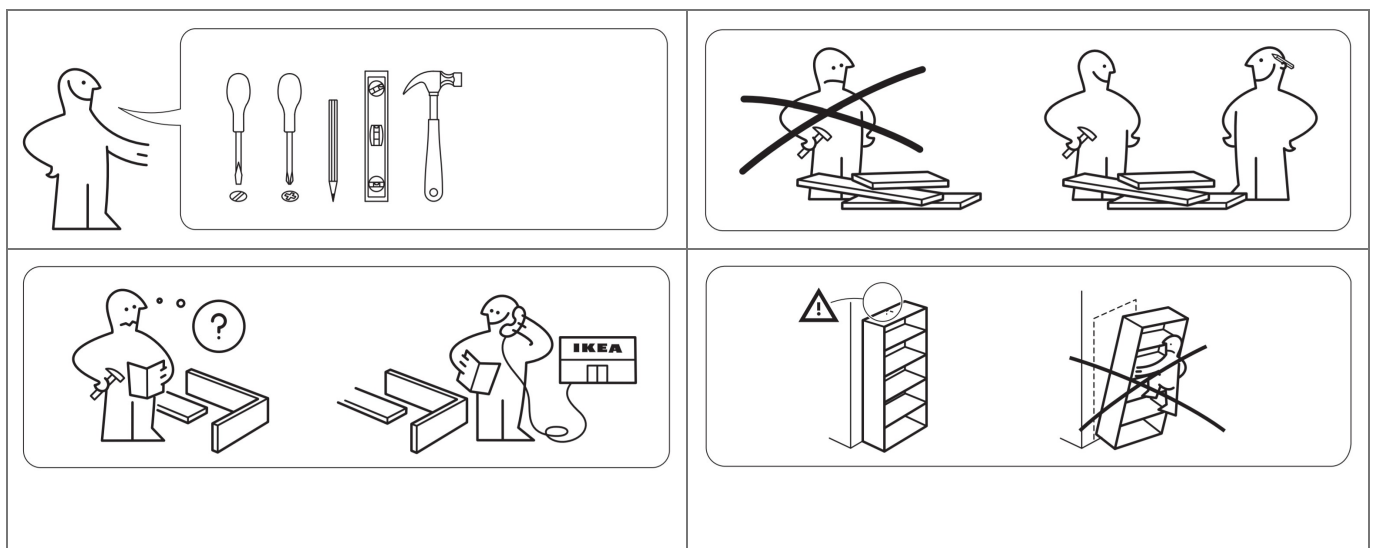

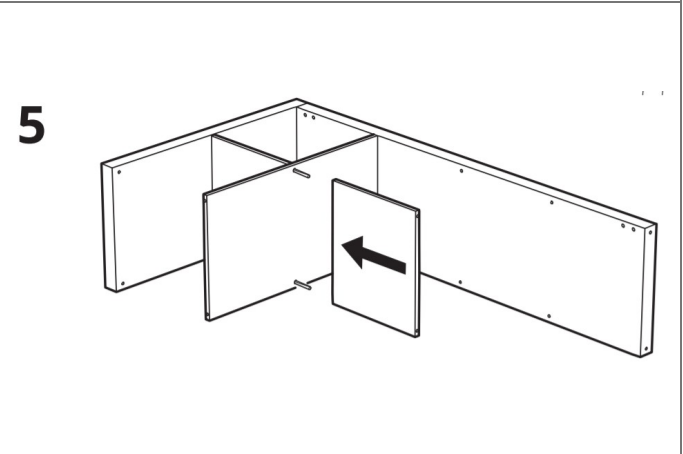
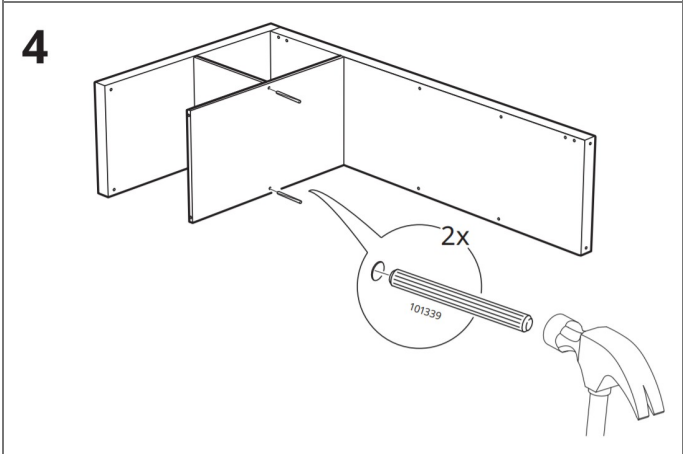
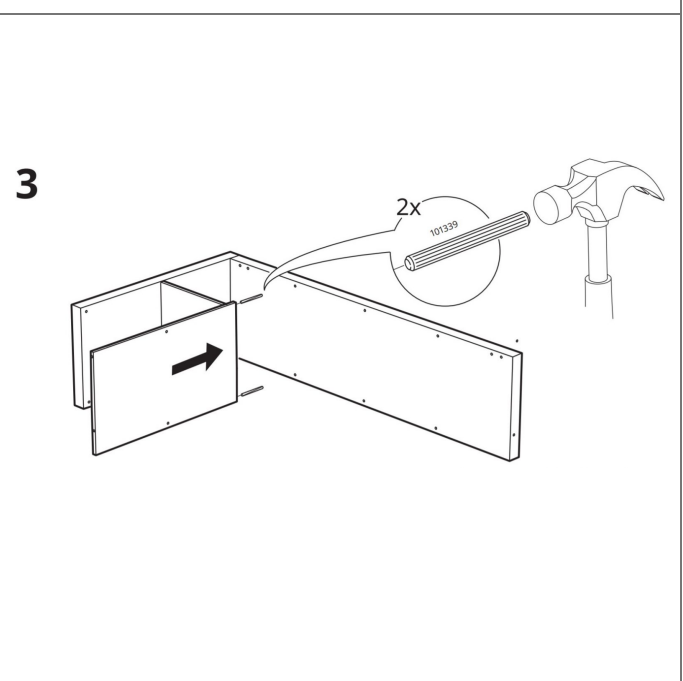
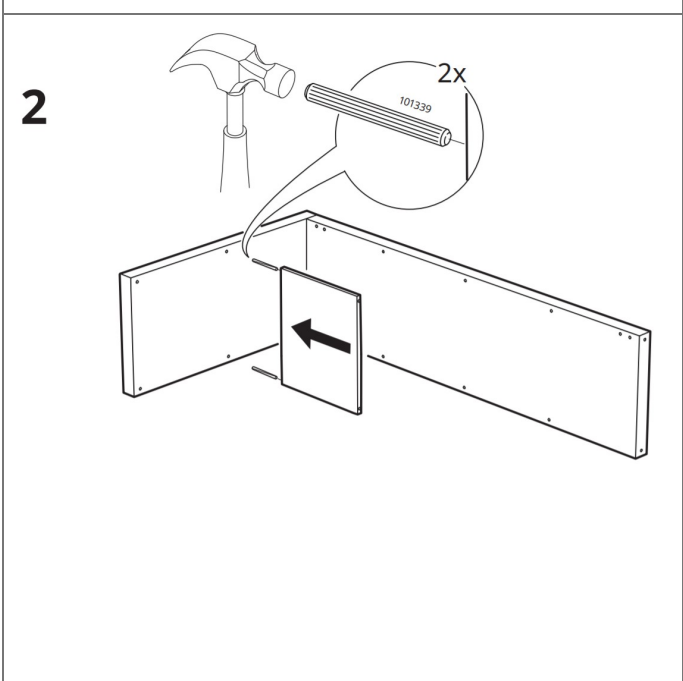
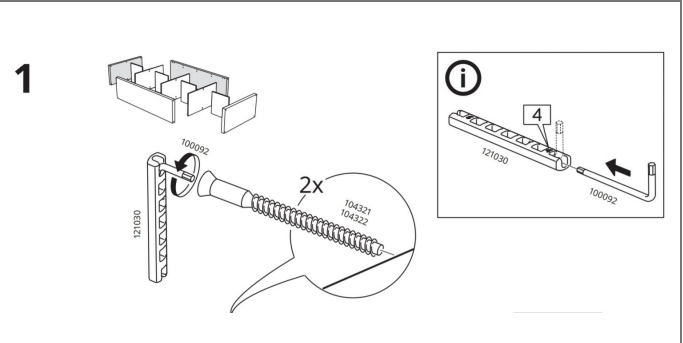
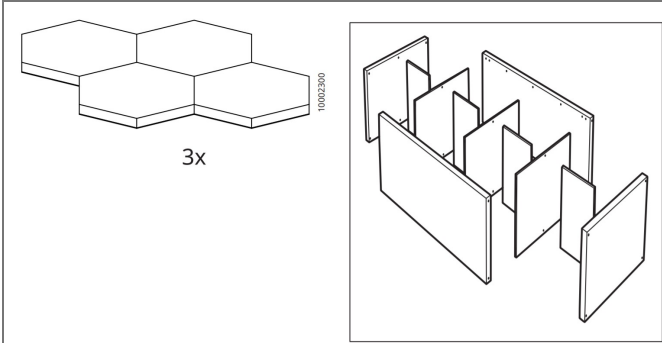
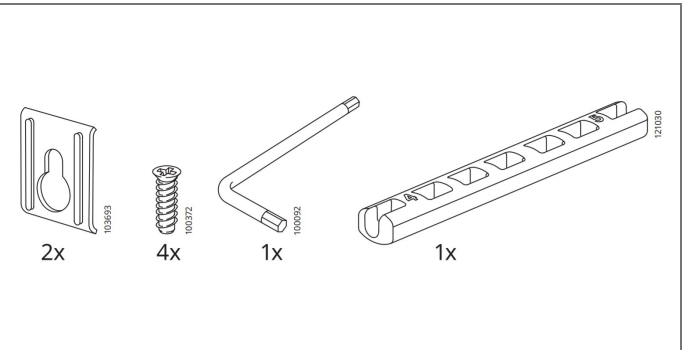
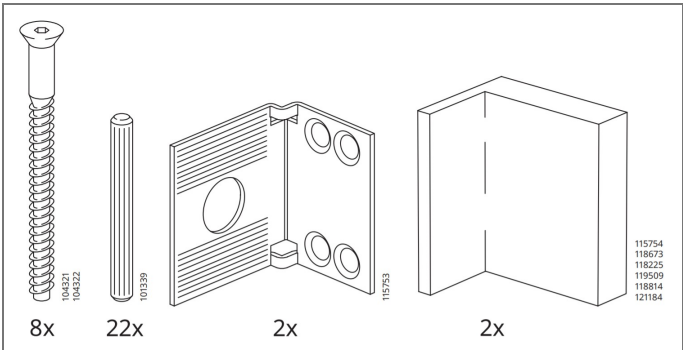

6

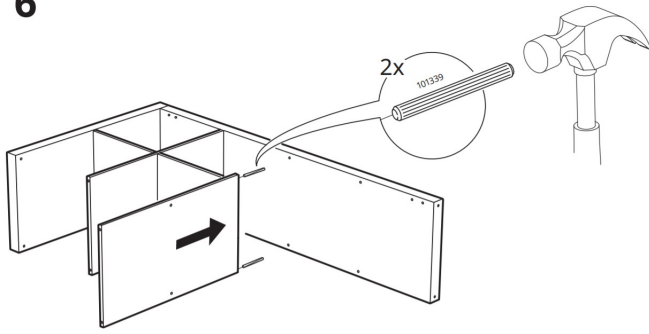

7

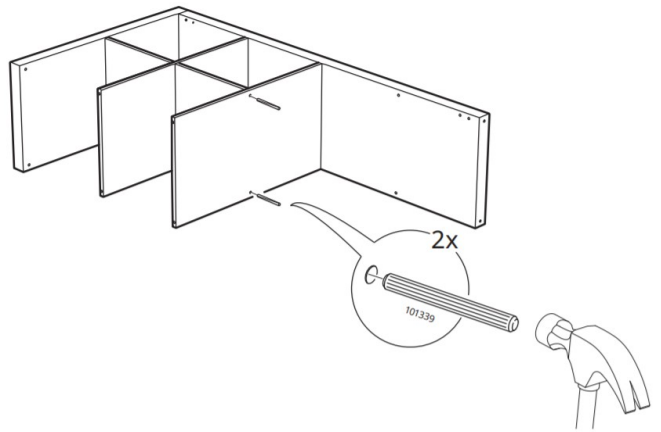

8

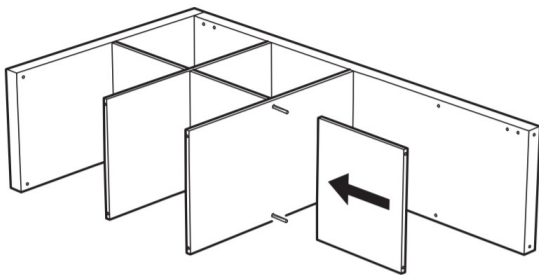

9

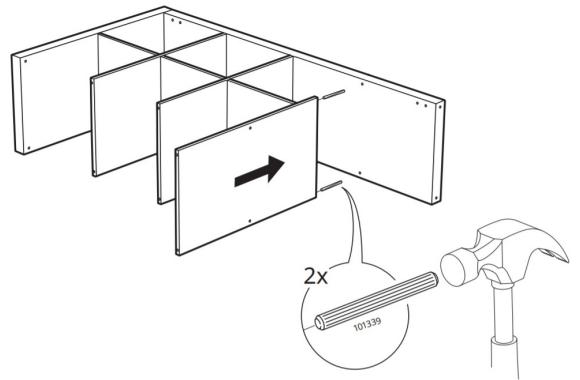

10

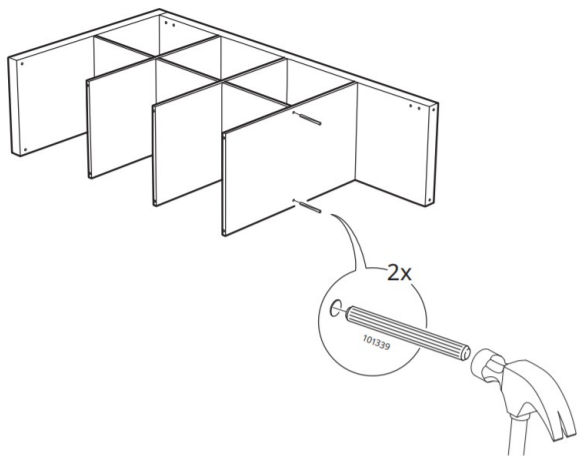

11

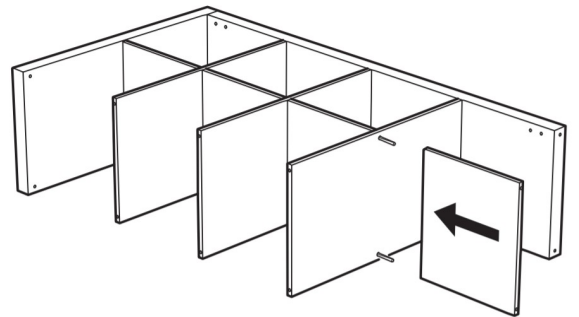

12

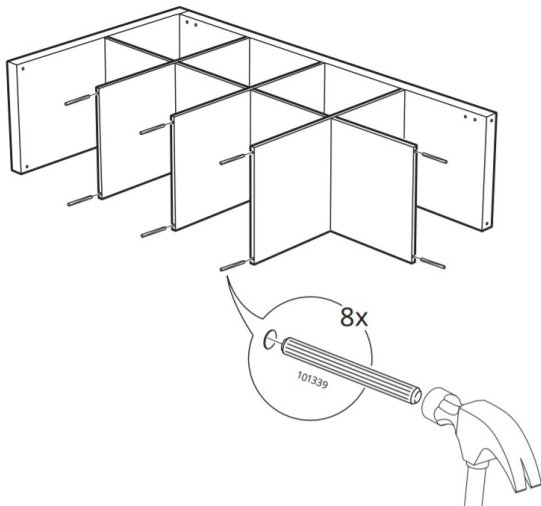

13

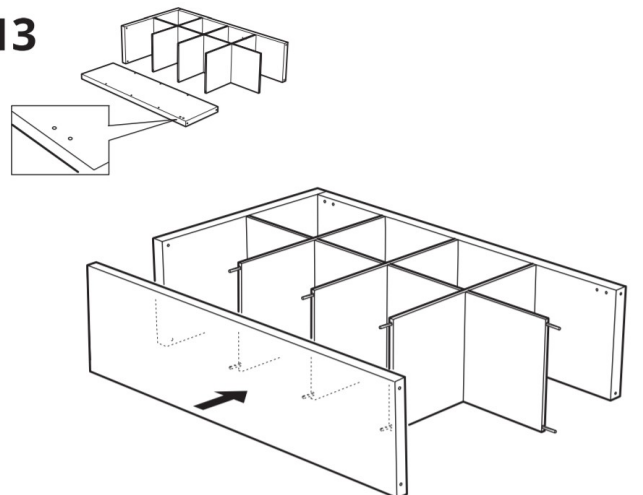

14

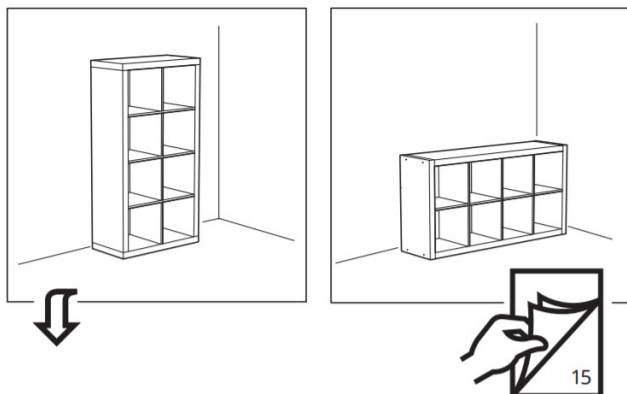
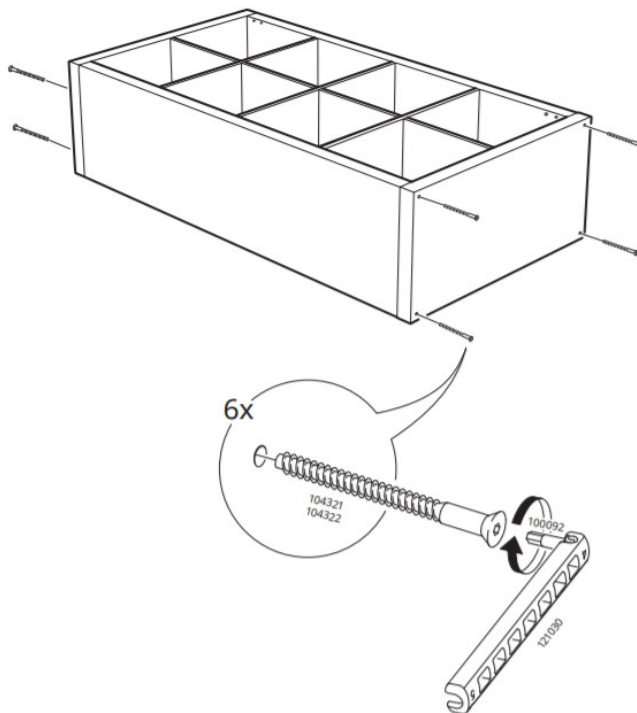
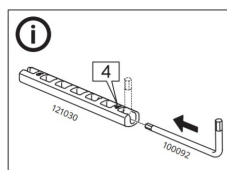
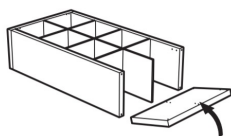

15

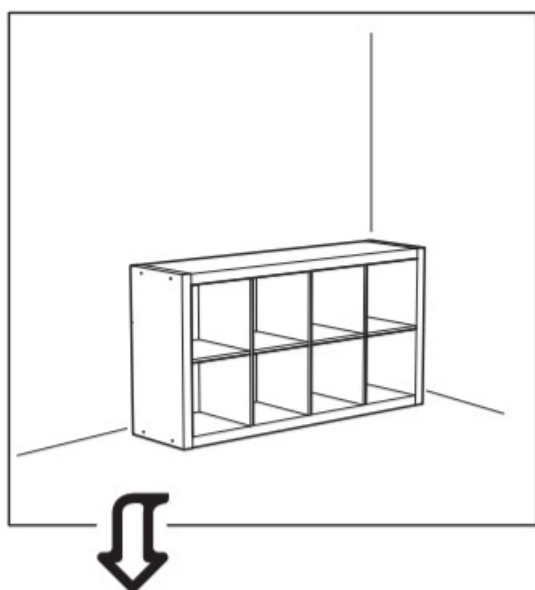
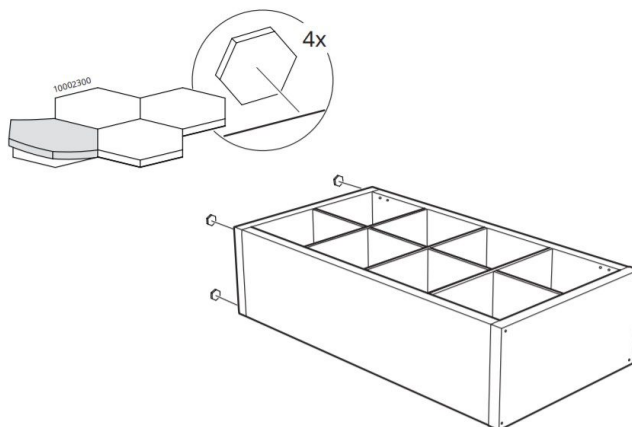

15

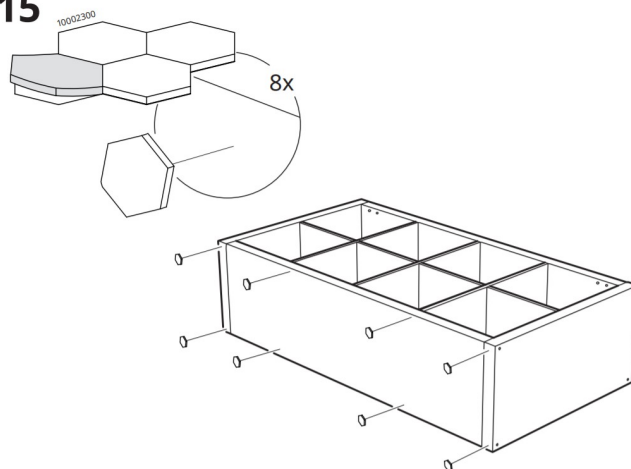

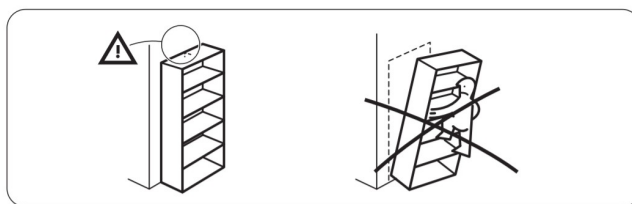
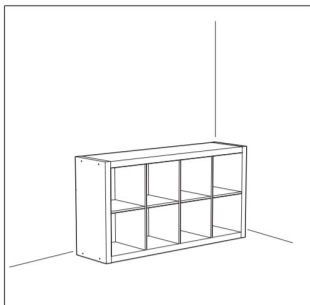
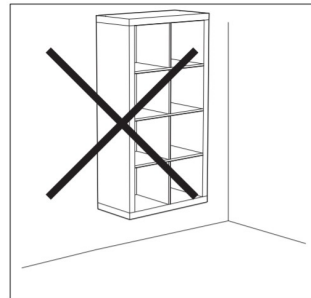
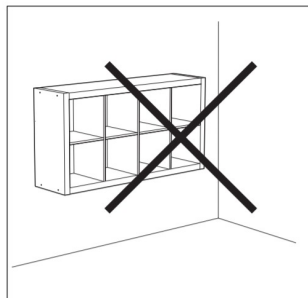
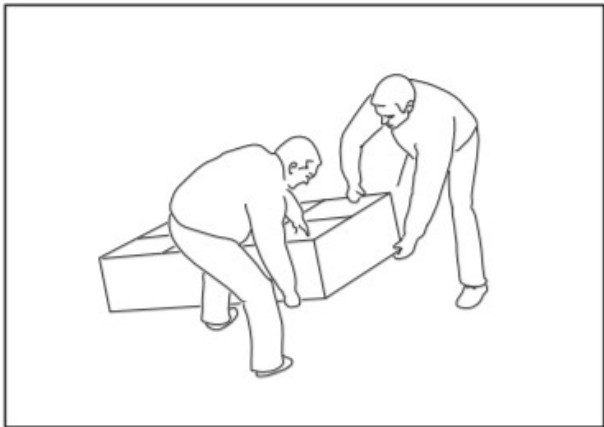

16

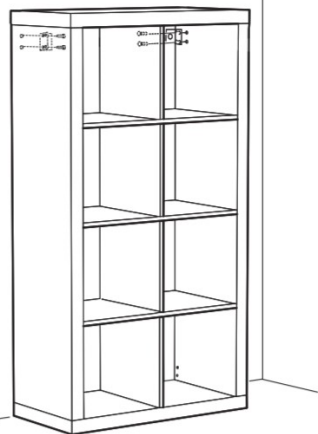
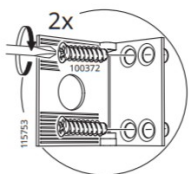

17

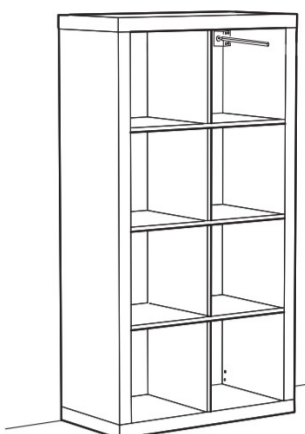
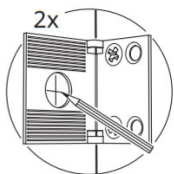

18

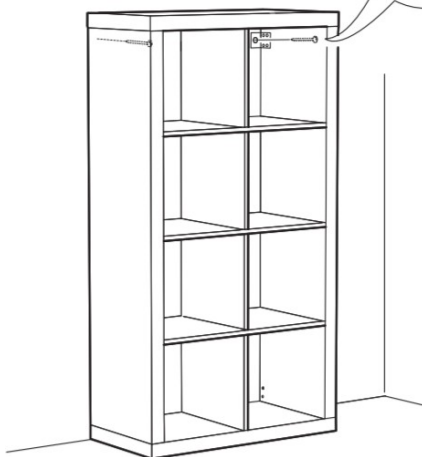
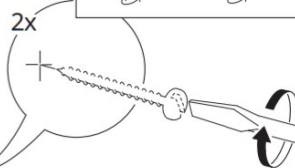
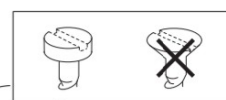

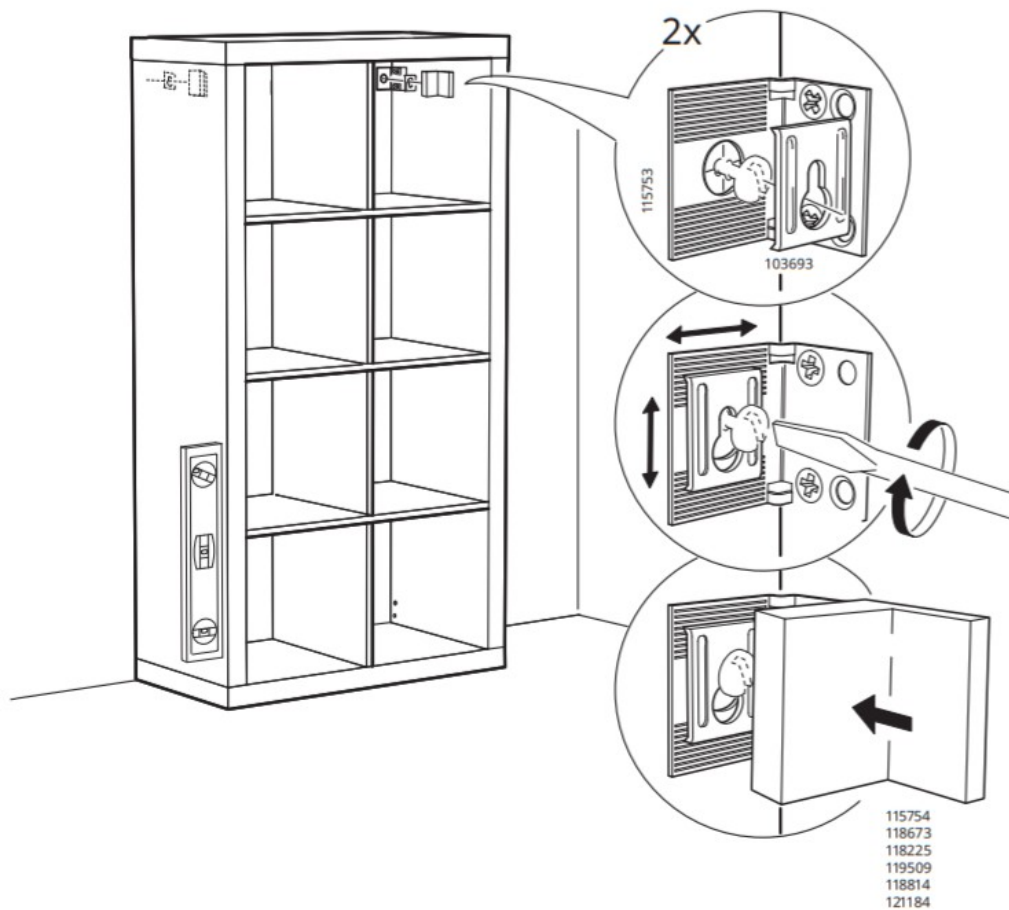

© Inter IKEA Systems B.V. 2013
2021-06-23
AA-1055145-8

SPECIFICATIONS

Product Name	IKEA KALLAX
Wall Attachment Devices	Must be used to prevent serious or fatal crushing injuries. Screw(s) and plug(s) for the wall are not included. Use screw(s) and plug(s) suitable for your walls. If you are uncertain, seek professional advice.
FAQs	Answers frequently asked questions such as how to make the KALLAX more stable, whether it can be wall-mounted or cut, and whether spray paint works on IKEA furniture.
Material	100% wood from more sustainable sources.
Dimensions	Kallax and Expedit have different dimensions. The sides of the Kallax are a single centimeter thinner than those of the Expedit.
Wall Mounting	KALLAX can be mounted on a wall using the pre-drilled holes and plastic screw sleeves provided.
Adding Wheels	Wheels can be added to KALLAX by using glue and oversize drawer pulls.
Video Tutorial	Includes a video tutorial for visual learners.
Product Care	With proper assembly and care, KALLAX can be a functional and stylish addition to any home.

FAQ'S

Can I hang KALLAX on the wall?

While waiting for the paint to dry, KALLAX was prepared to be mounted to the wall. Mounting holes were pre-drilled with a counter-sink bit. Plastic part was melted, so used a knife to trim it off. Tapped plastic screw sleeves into all holes so that it expands inside the material of KALLAX walls.

How do I make my KALLAX more stable?

If you have a piece of wood. Behind each row of shelving. It prevents records from being pushed too far back third this gives you a surface to easily screw.

What is Kallax made out of?

100% wood from more sustainable sources.

Are Expedit and Kallax the same dimensions?

The difference? The sides of the Kallax are a single centimeter thinner than those of the Expedit. The change is being made because Ikea consumes an astounding 1 percent of the world's wood, and is trying to lessen its impact

Does spray paint work on IKEA furniture?

And if you're wondering, you can use spray paint, it just takes a while longer to build up the layers for a nice, even finish. Wait until the last coat of paint is completely dry, then cover the surface with a sealer

How do you protect IKEA furniture without wall drilling?

Anti-tip kits can help tether furniture to the wall using adhesives, small hooks, or pins that connect to the wall or stud. Additionally, you can try your luck mounting brackets or L-hooks to secure furniture with cable, cords, or ties using a heavy-duty construction adhesive.

Can I screw legs into Kallax?

Steps to adding custom legs to your Kallax book shelf:

Screw the hardware plate, flat side down, flush to the book shelf. Screw the leg into the attached hardware. I had the long cubbie, so I added 6 legs, but on a smaller unit, 4 would be sufficient.

Can Ikea KALLAX be wall mounted?

KALLAX units are stylish, simple cube storage shelving that does a lot. Place it on the floor, mount it on a wall or turn it into a desk to transform your living area.

How do I Add wheels to KALLAX?

Again every place you can put glue. Make sure you put some glue. Wait a minute isn't I make a mess. Well. Yeah it does but all you need to do is take a wet rag and wipe right off.

Do you have to secure KALLAX to wall?

Mine is free standing and I never had any problems. However, I worked at Ikea and they do recommend you to mount the unit on the wall, especially if you have kids. The product comes with the brackets. You just have to buy the right fasteners for your wall in any hardware store.

Can you cut a kallax unit?

It's not impossible, but if I could cut ~5" off the Kallax that would still leave me with a generously sized shelf for storage and putting a TV on top of, and would widen my walkway just enough that I wouldn't have to be nearly so careful walking.

Can you put casters on Ikea Kallax?

An IKEA KALLAX bookshelf is transformed into an elegant and modern bar cart with the simple addition of oversize drawer pulls above and casters below. Aside from the hardware, all you need is a drill and a screwdriver to pull off this IKEA shelves hack and get your home ready for a classic cocktail party.

Is it safe to use KALLAX without wall attachment devices?

No, it is not safe to use KALLAX without wall attachment devices. Serious or fatal crushing injuries can occur from furniture tip-over.

How can I make my KALLAX more stable?

You can make your KALLAX more stable by adding a piece of wood behind each row of shelving. This prevents records from being pushed too far back and gives you a surface to easily screw.

What is Kallax made out of?

Kallax is made out of 100% wood from more sustainable sources.





[A-KALLAX-](#)

IKEA KALLAX
www://ikea.com/us/

Documents / Resources

KALLAX



[IKEA KALLAX](#) [pdf] Instructions
KALLAX, IKEA