



IKEA IDANÄS Desk with Add On Unit Instructions

[Home](#) » [Ikea](#) » IKEA IDANÄS Desk with Add On Unit Instructions 

Contents

- [1 IKEA IDANÄS Desk with Add On Unit](#)
- [2 Product Information](#)
- [3 Product Usage Instructions](#)
- [4 Safety Instructions](#)
- [5 Tools](#)
- [6 Assembly](#)
- [7 Documents / Resources](#)
 - [7.1 References](#)
- [8 Related Posts](#)



IKEA IDANÄS Desk with Add On Unit



Product Information

The product is identified by the model number AA-2320473-5. It has a magnification range of 10x to 8x and an objective lens diameter of 2x. The eyepiece lens diameter is 18x, and the field of view is 18x. The product weighs approximately 152517 grams.

Specifications

- **Magnification Range:** 10x-8x
- **Objective Lens Diameter:** 2x
- **Eyepiece Lens Diameter:** 18x
- **Field of View:** 18x
- **Weight:** 152517 grams

Product Usage Instructions

1. Unboxing

Open the product packaging and remove all contents.

2. Assembly

Follow the assembly instructions provided in the user manual to assemble the product.

3. Powering On

Insert the required batteries into the product and turn it on using the power button.

4. Adjusting Magnification

Use the magnification adjustment knob to select the desired magnification level between 10x and 8x.

5. Focusing

Rotate the focus wheel to adjust the focus of the product and obtain a clear image.

6. Using the Eyepiece Lens

If necessary, adjust the eyepiece lens diameter to achieve a comfortable viewing experience.

7. Field of View Adjustment

Rotate the field of view adjustment knob to change the width of the observed area.

8. Cleaning and Maintenance

Regularly clean the lenses and other surfaces of the product using a soft, lint-free cloth. Avoid using harsh chemicals or abrasive materials.

Frequently Asked Questions (FAQ)

- **Q: What are the magnification options of this product?**

A: The product offers a magnification range of 10x to 8x.

- **Q: How do I adjust the focus?**

A: Use the focus wheel to adjust the focus of the product.

- **Q: Can I change the width of the observed area?**

A: Yes, you can adjust the field of view using the field of view adjustment knob.

- **Q: How should I clean the lenses?**

A: Use a soft, lint-free cloth to clean the lenses. Avoid using harsh chemicals or abrasive materials.

Safety Instructions

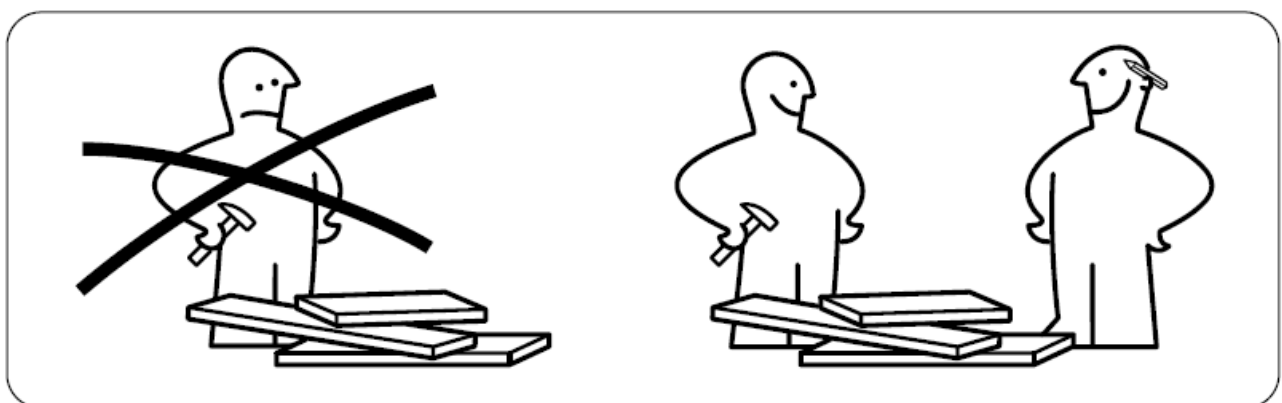
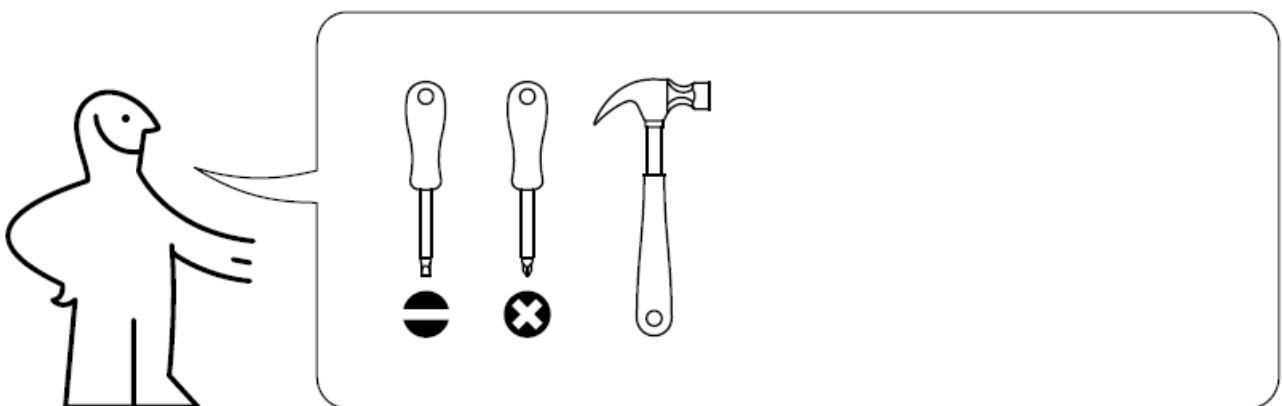

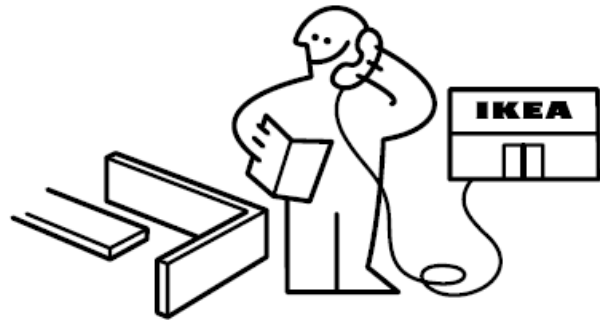
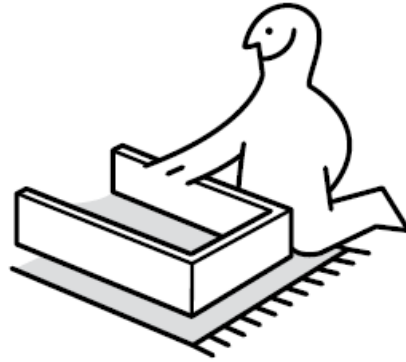
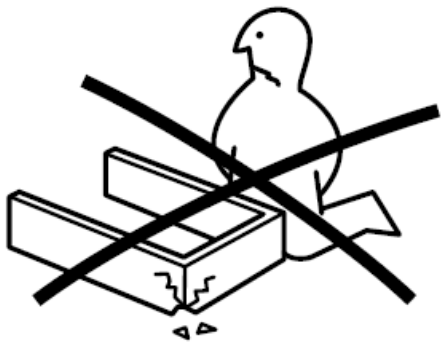

Tools

1

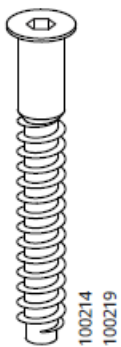

6x



1x

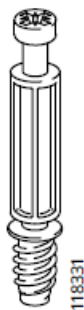

36x

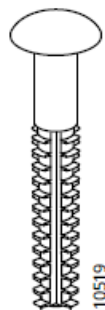

6x

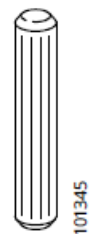

4x

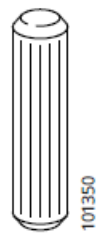

40x

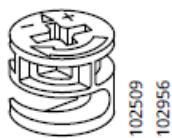

36x

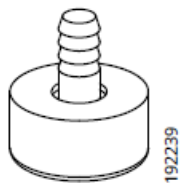

6x

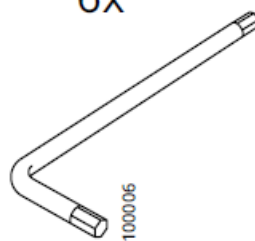

1x

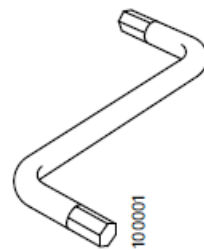

1x

2

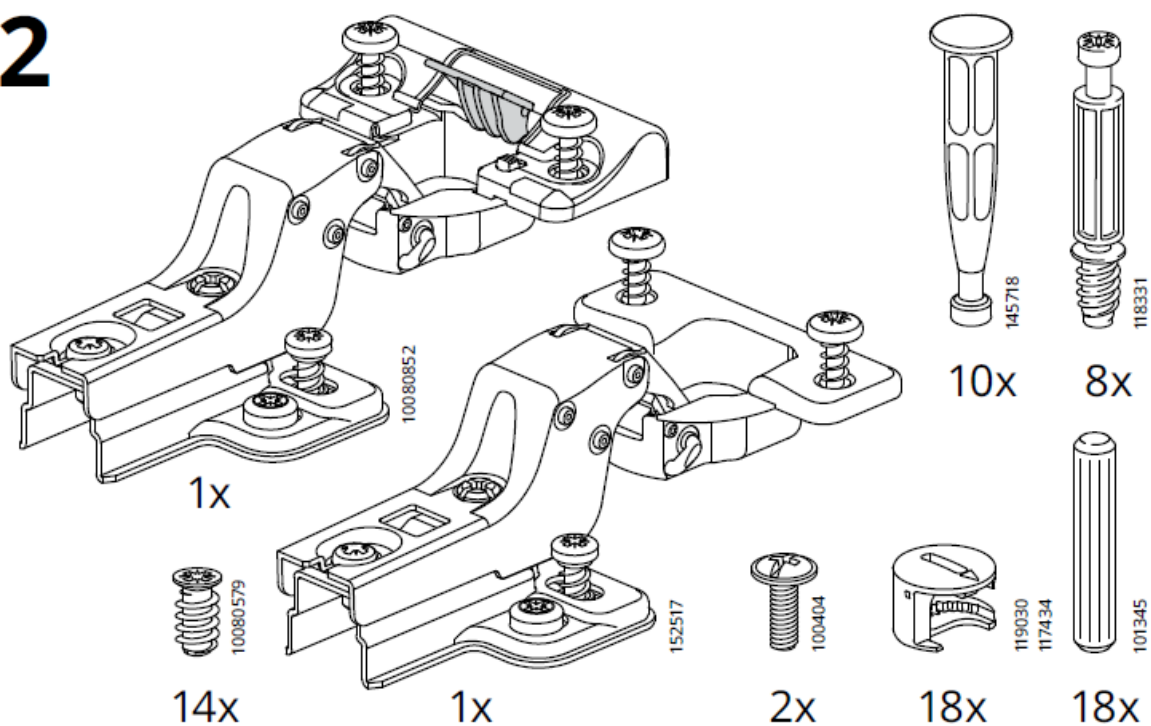

3

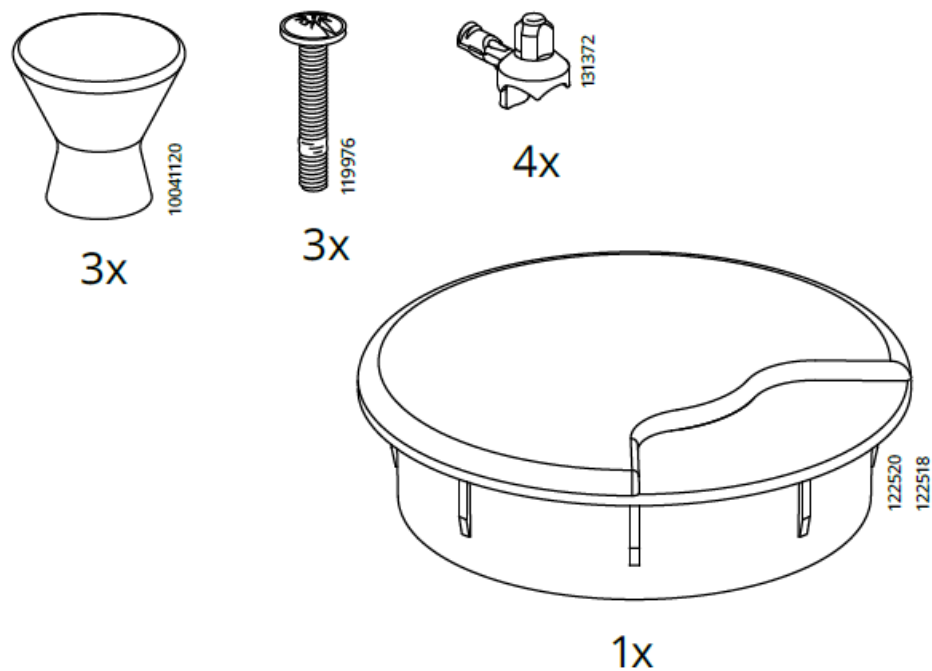

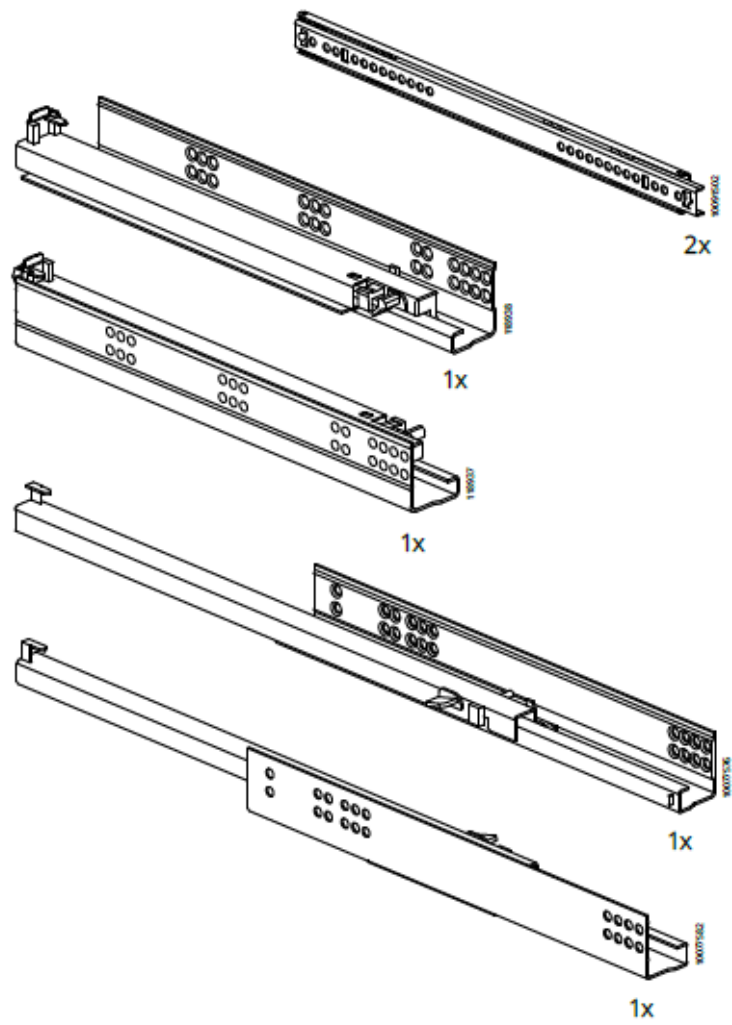

Assembly

1

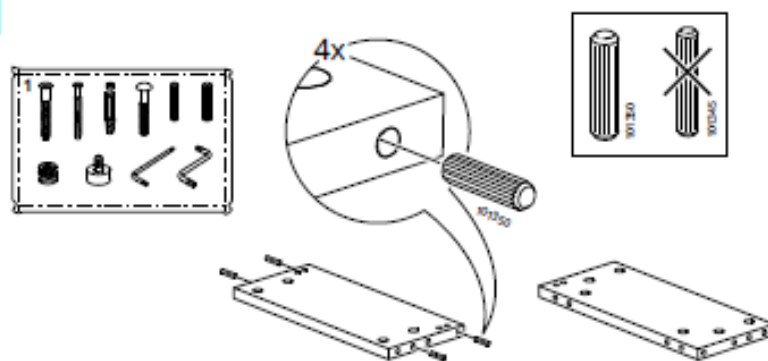

2

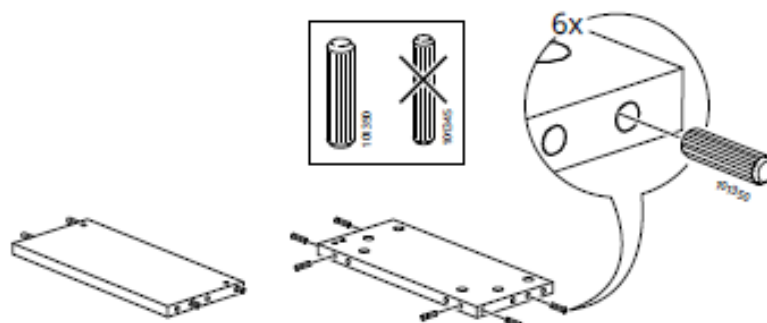

3

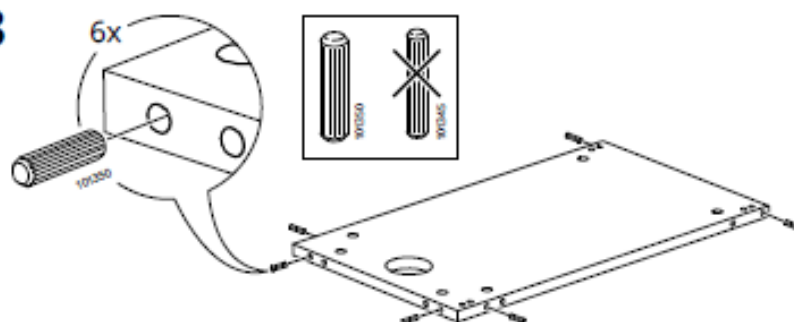

4

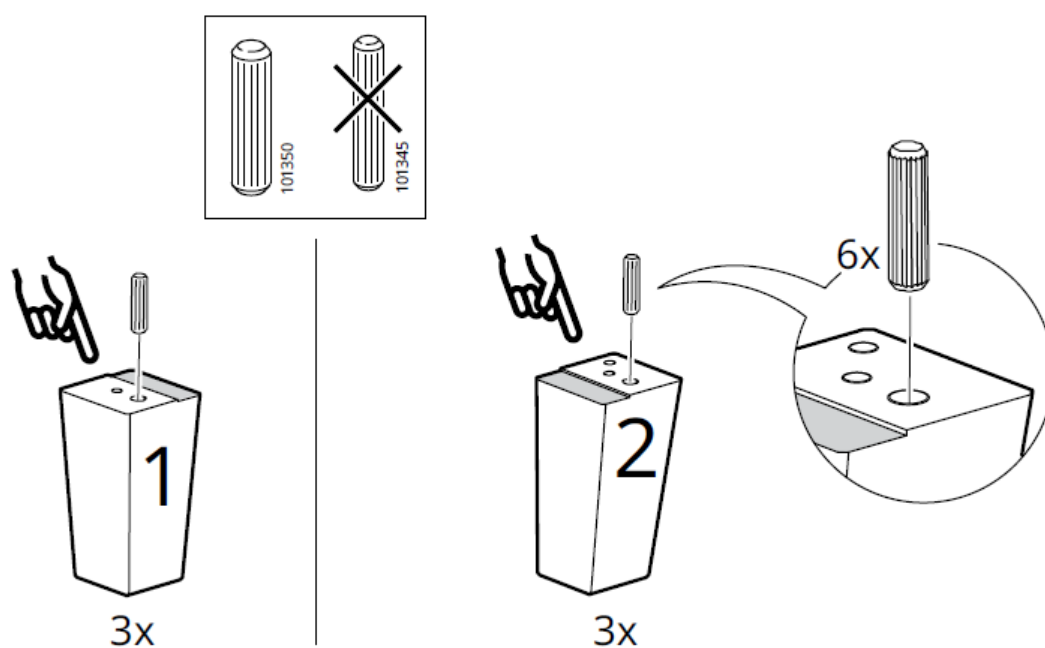

5

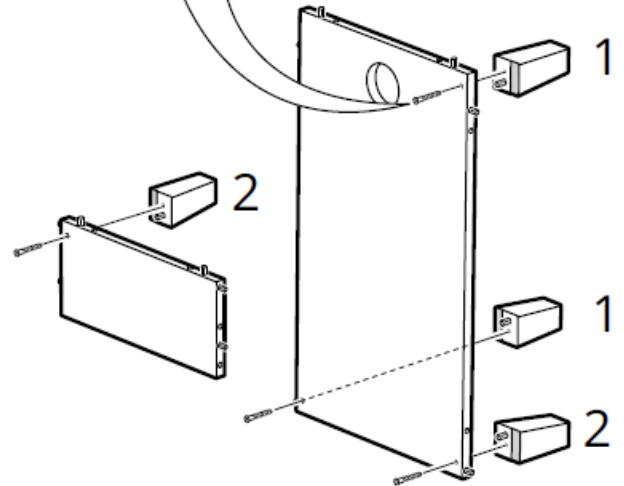
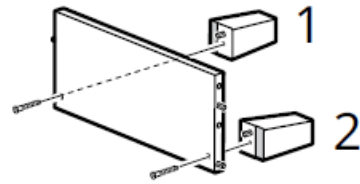
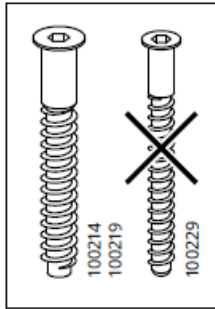
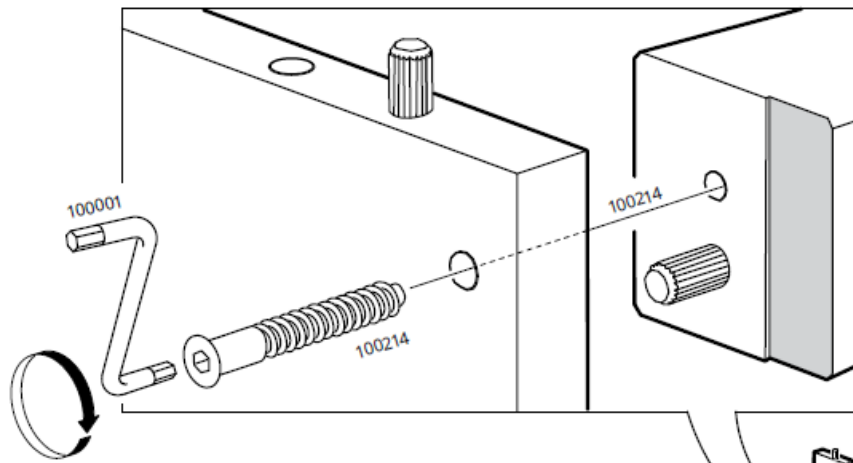

6

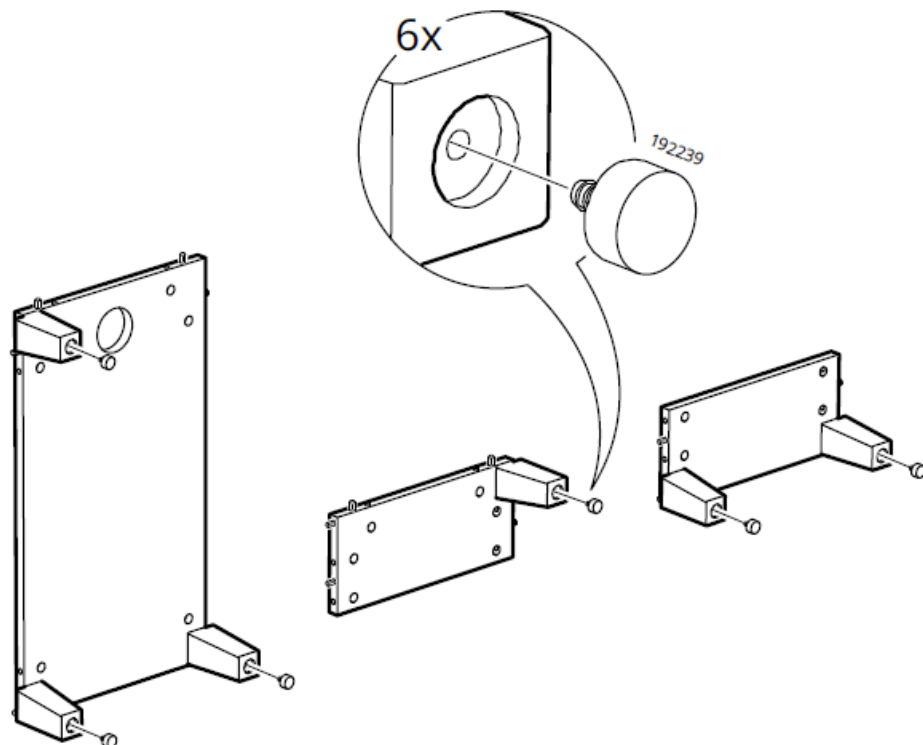

7

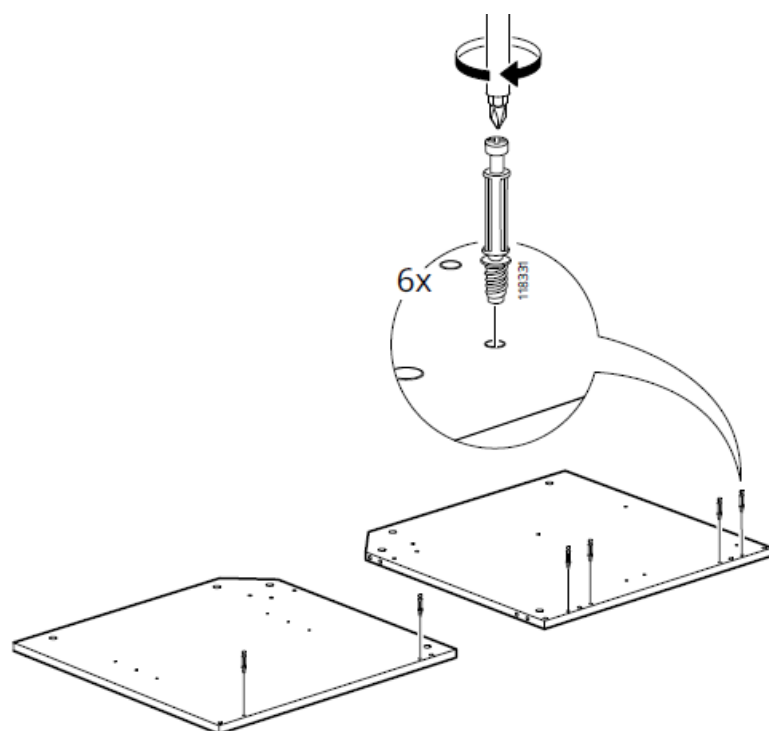

8

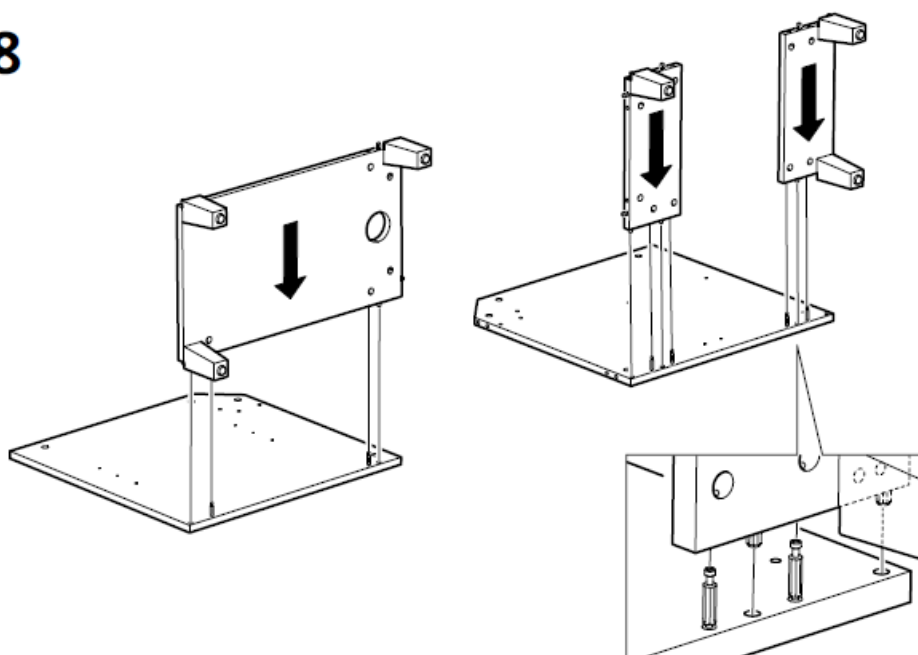

9

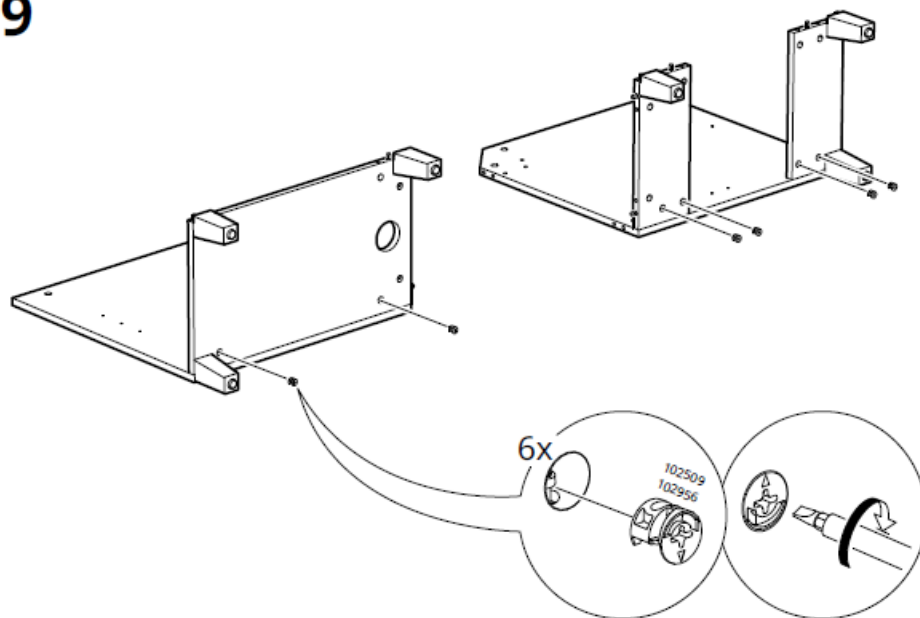

10

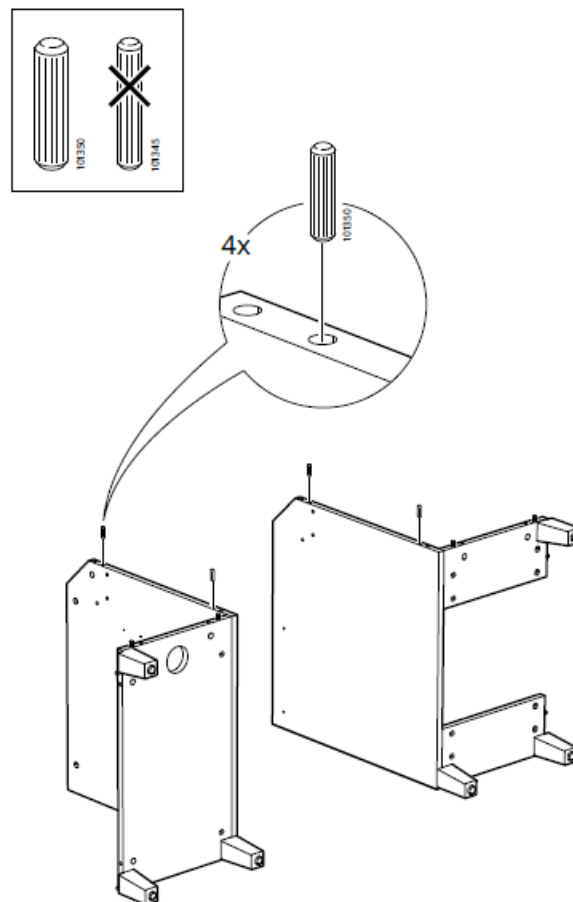

11

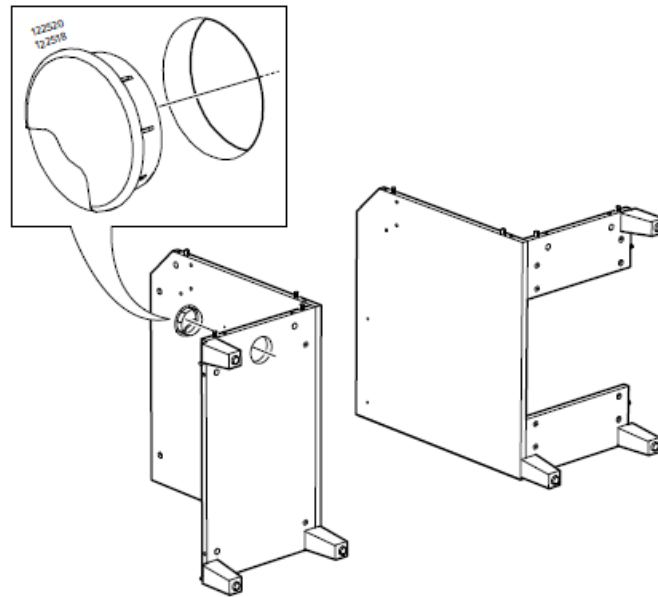

12

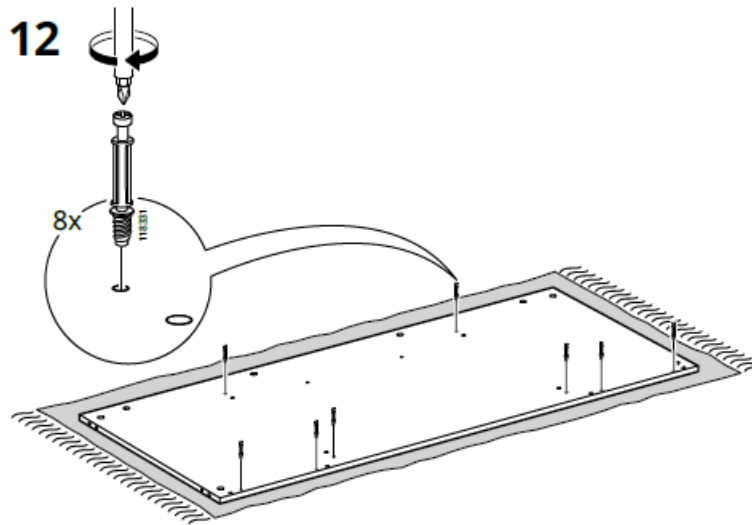

13

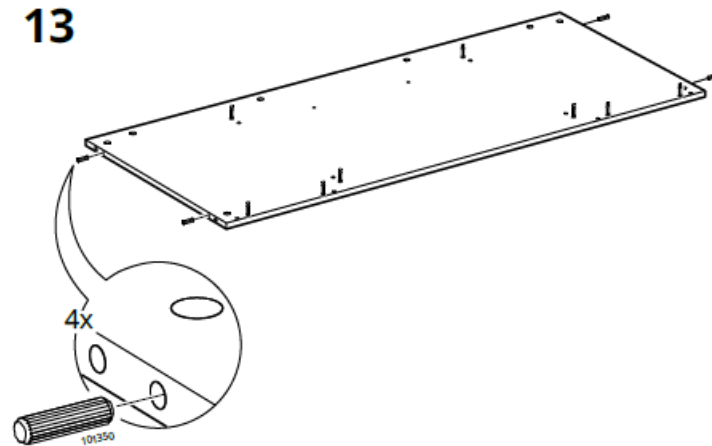

14

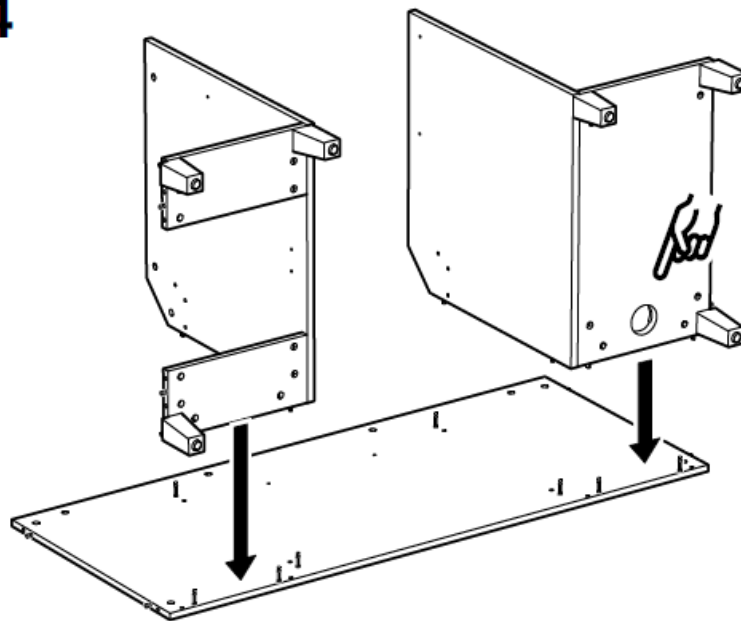

15

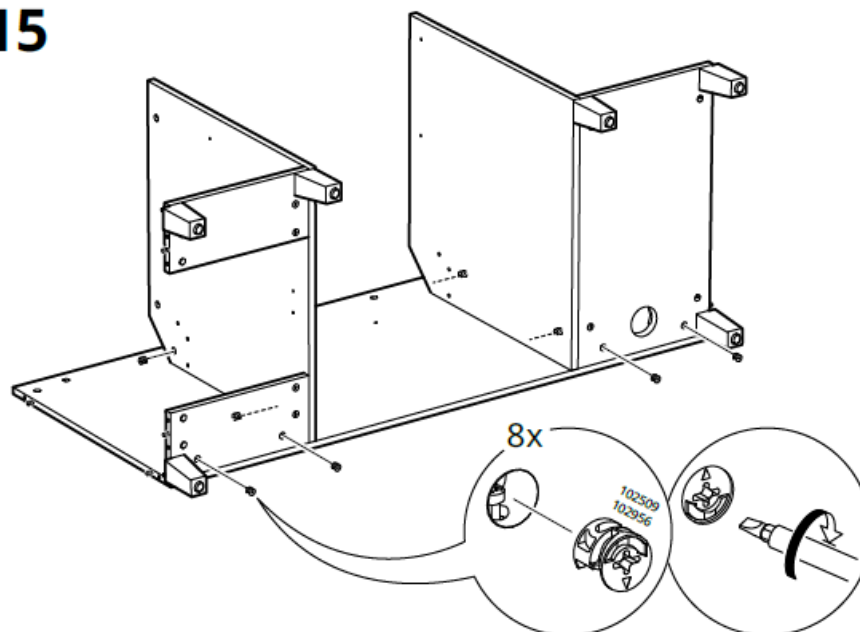

16

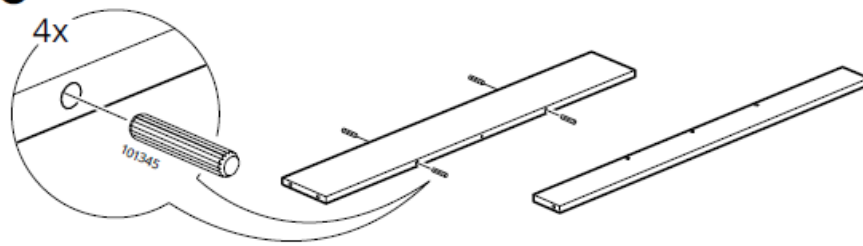

17

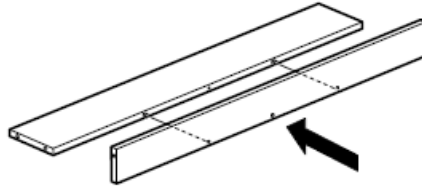

18

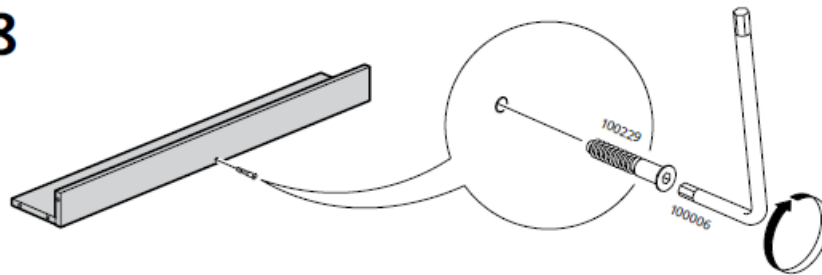

19

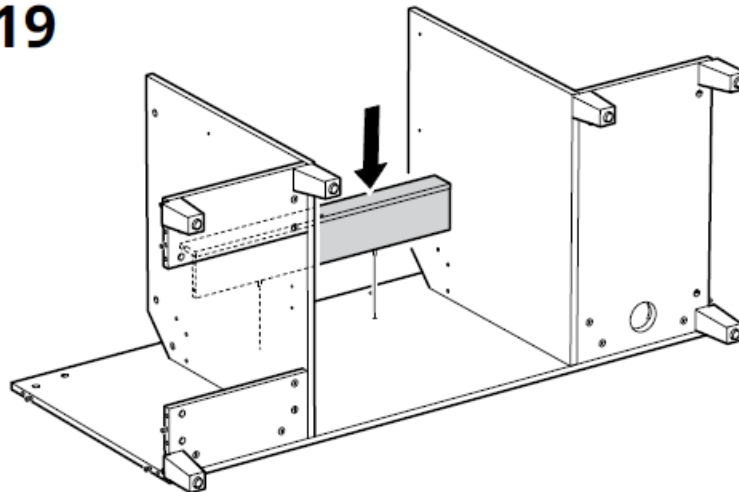

20

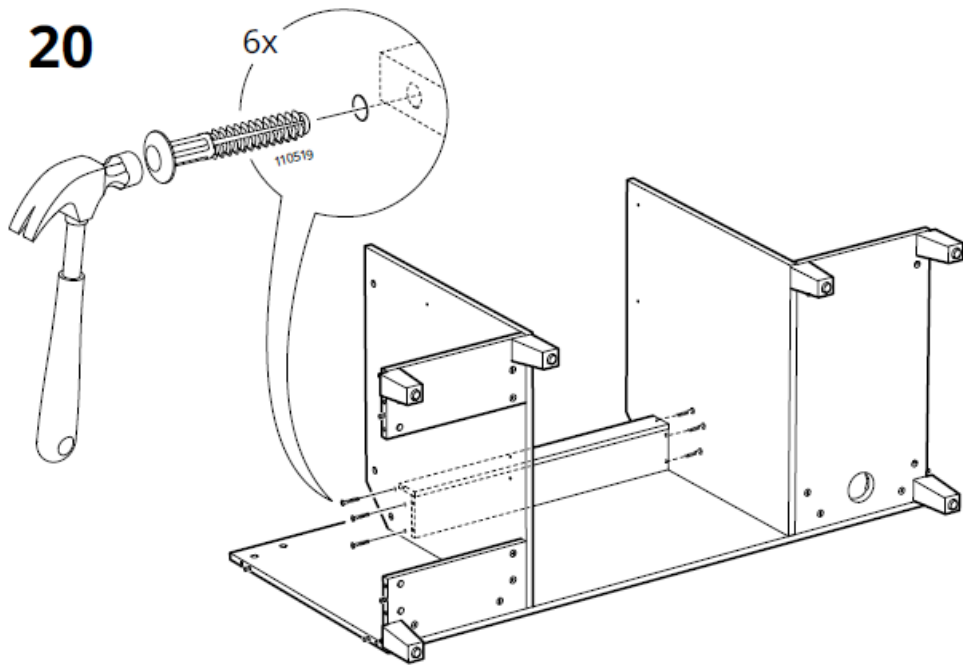

21

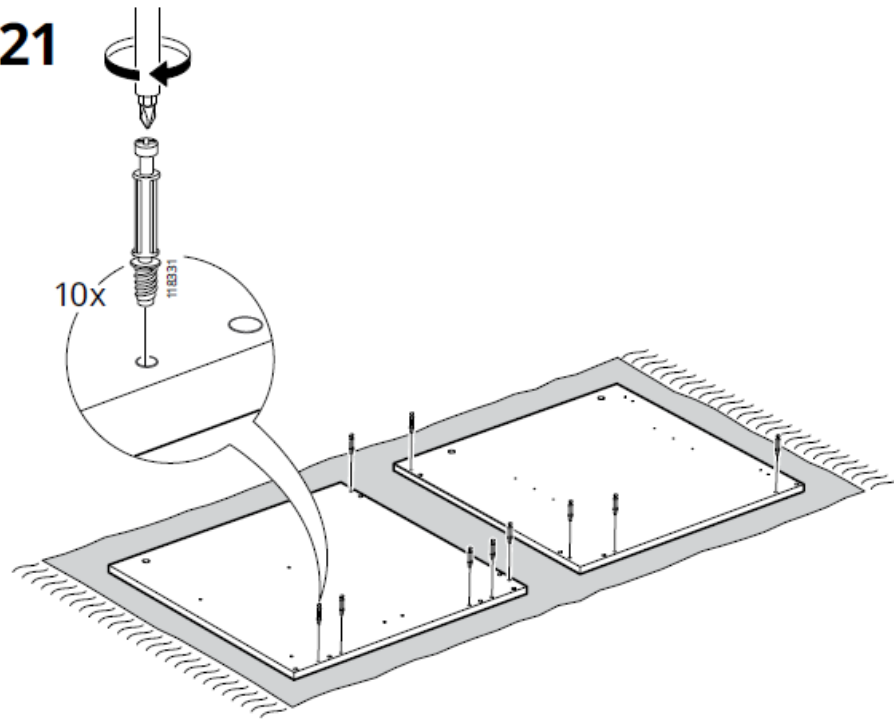

22

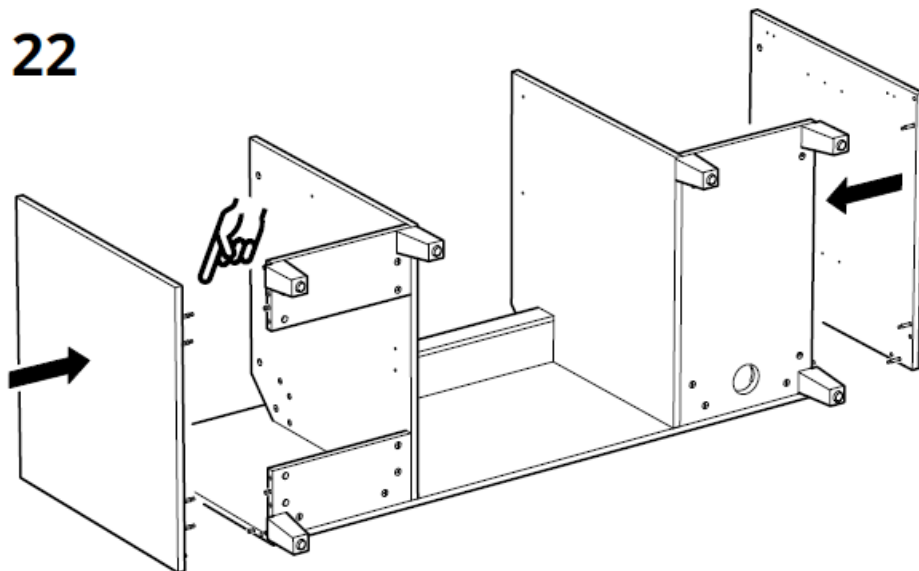

23

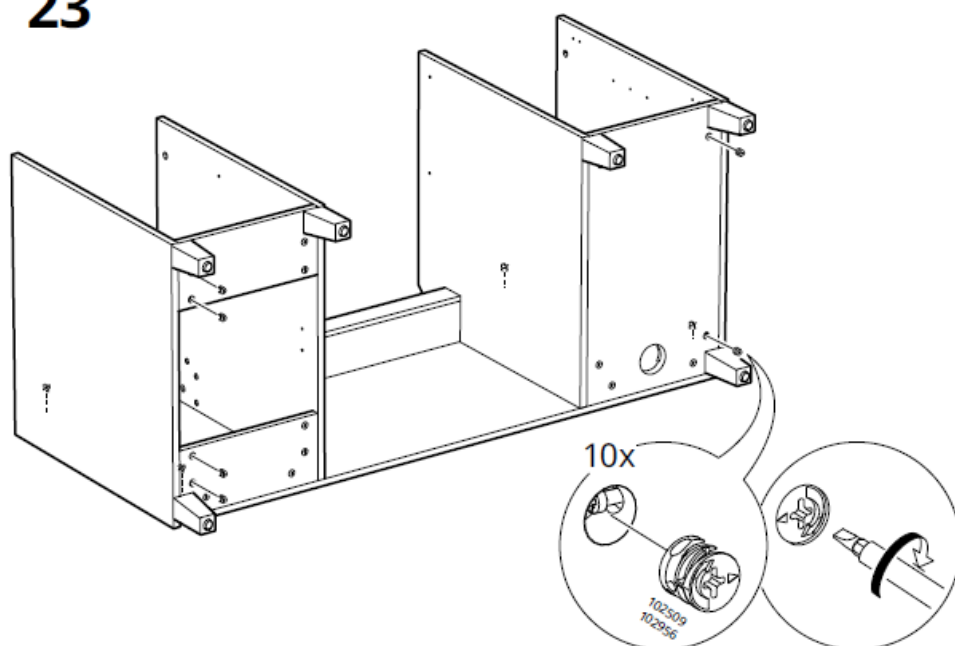

24

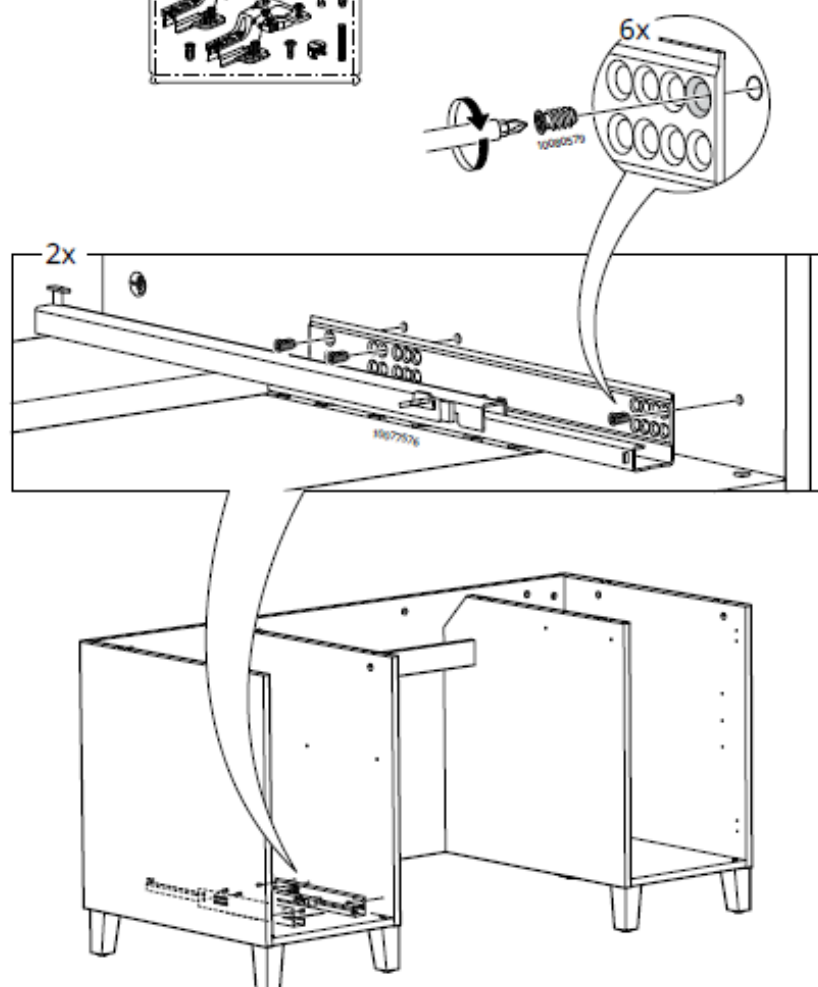
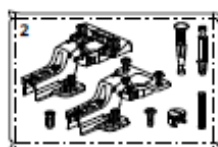

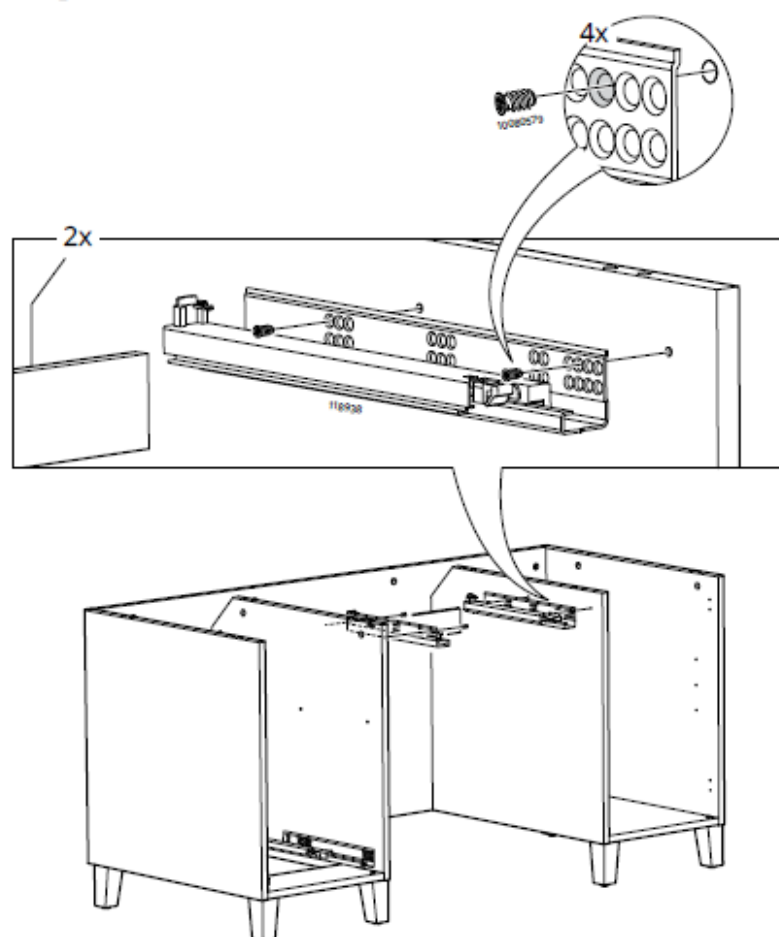

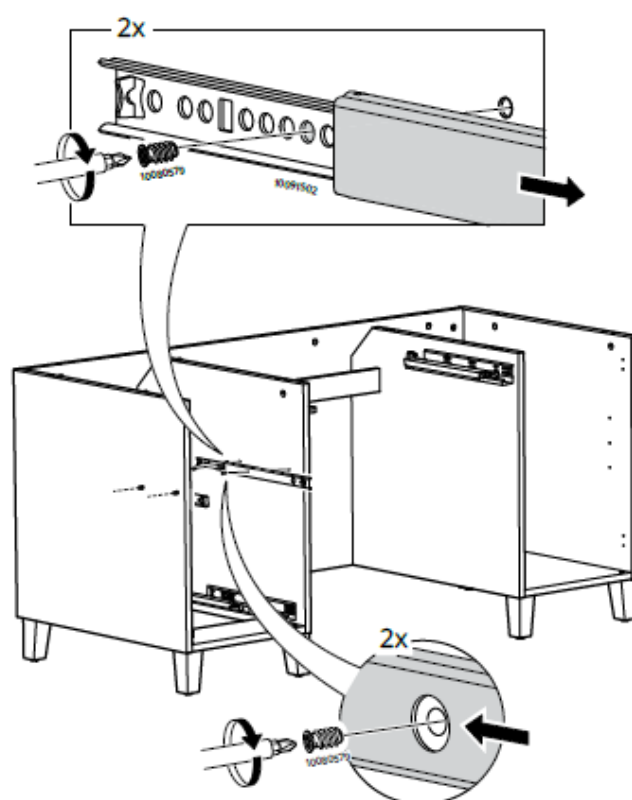

27

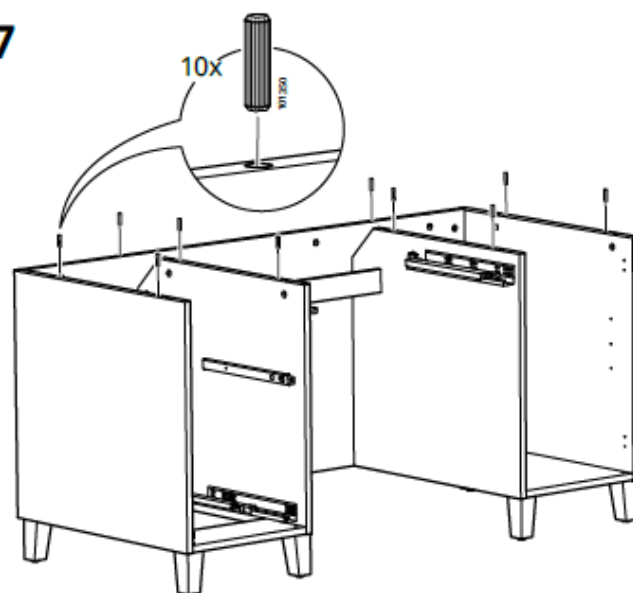

28

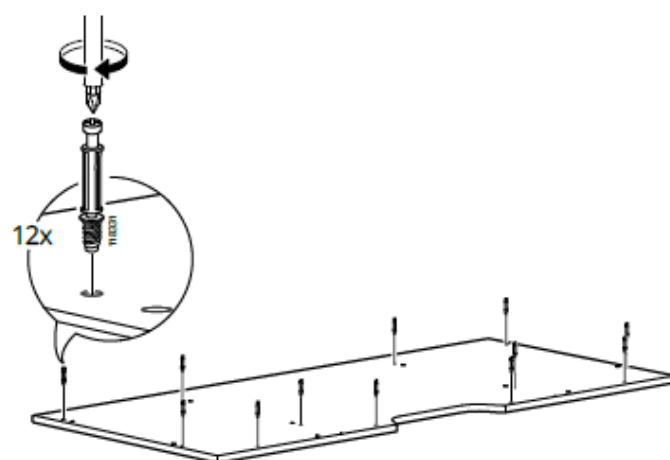

29

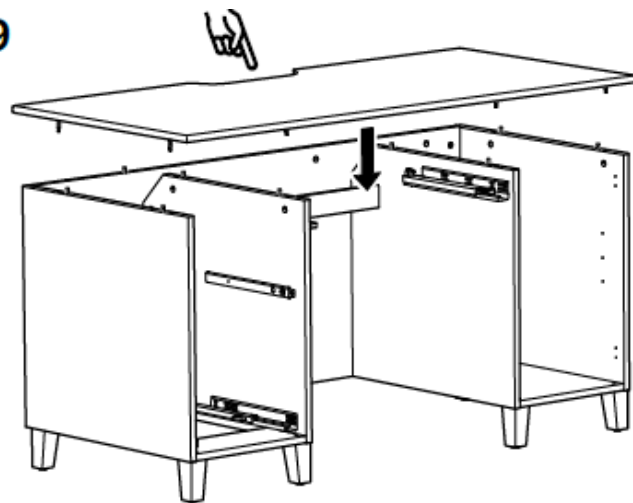

30

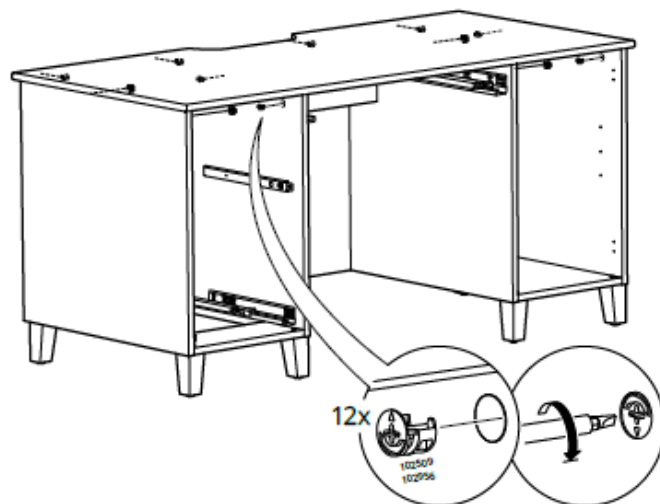

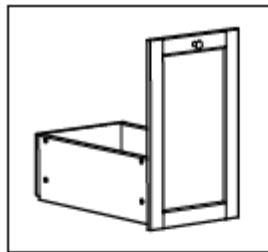

31

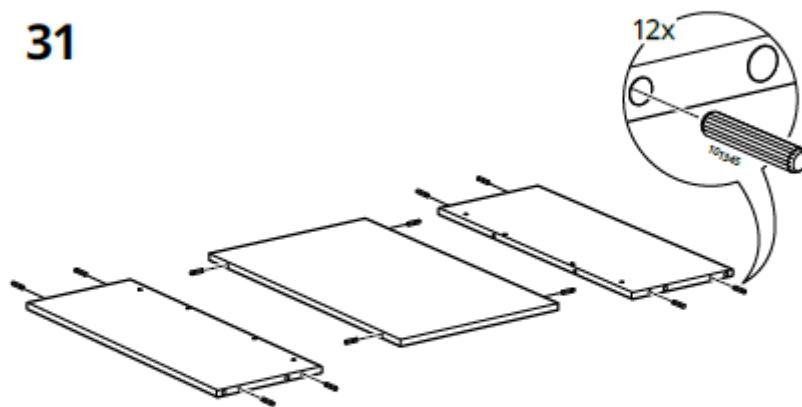

32

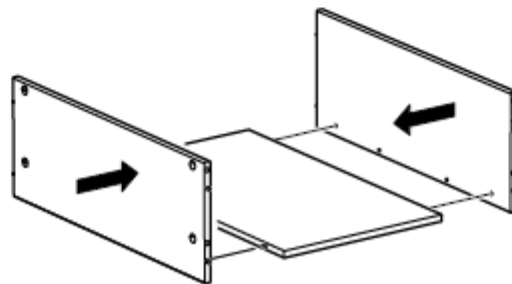

33

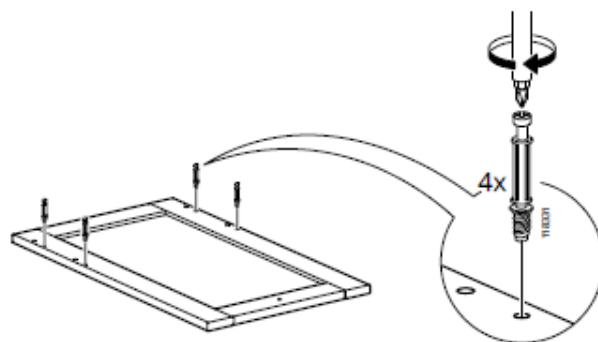

34

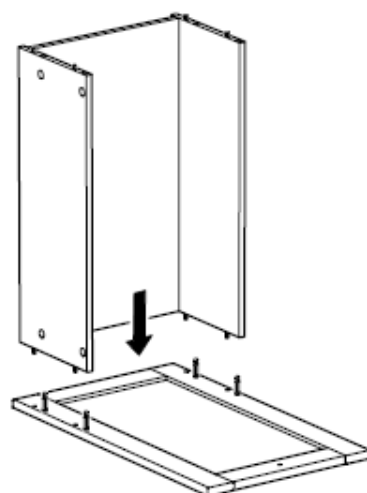

35

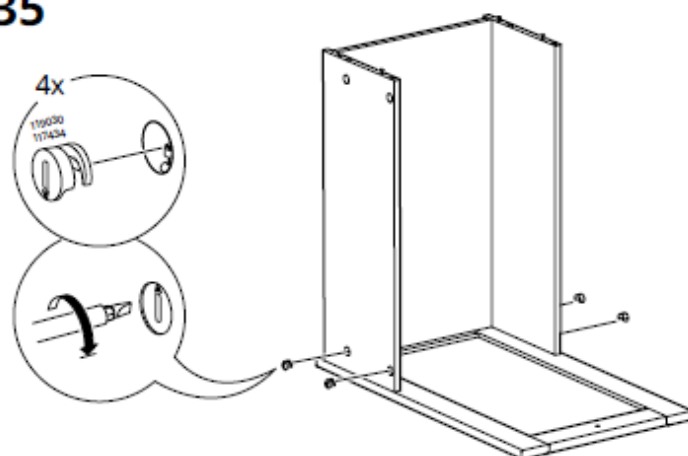

36

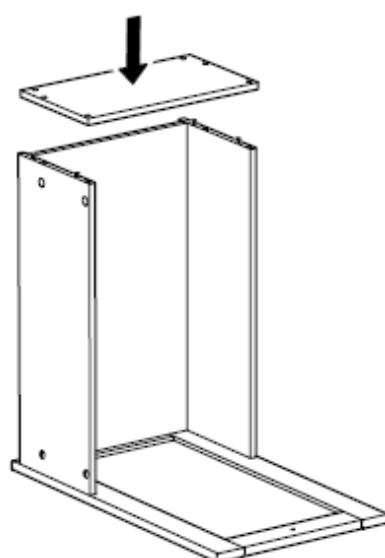

37

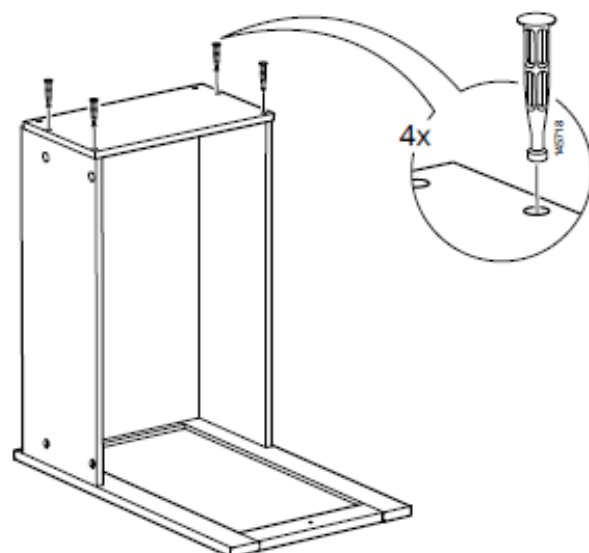

38

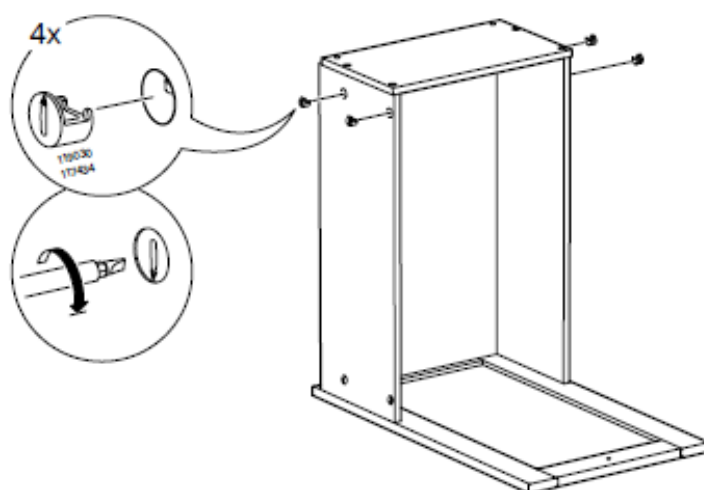

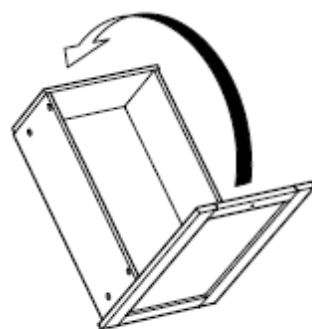

39

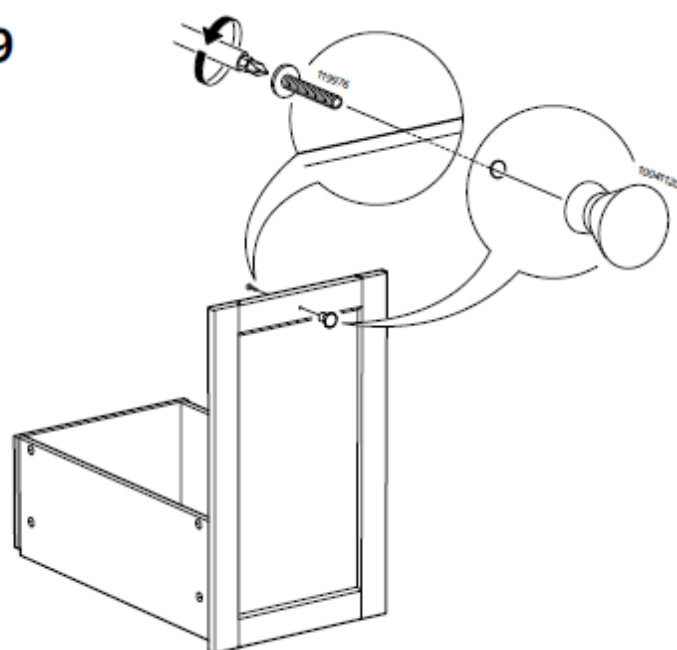

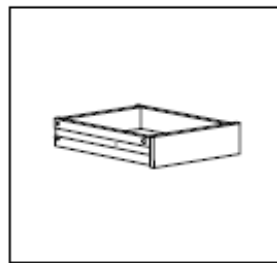

40

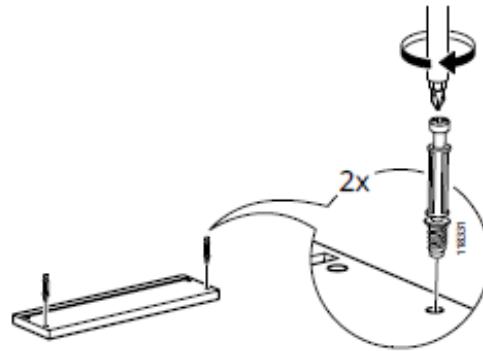

41

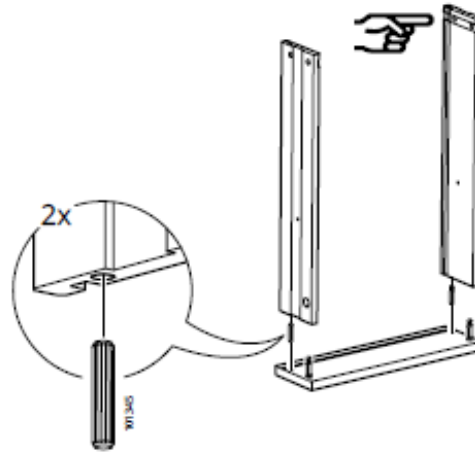

42

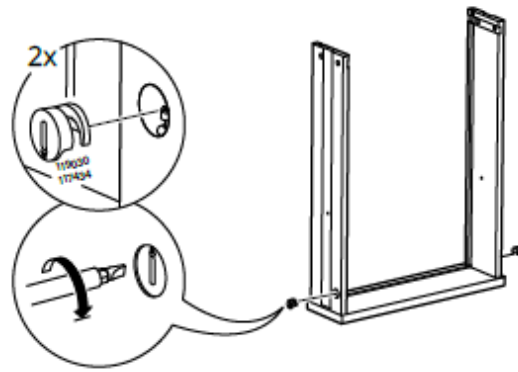

43

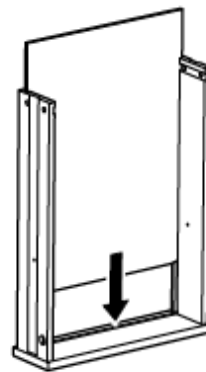

44

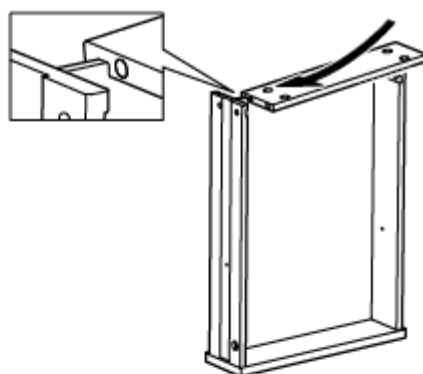

45

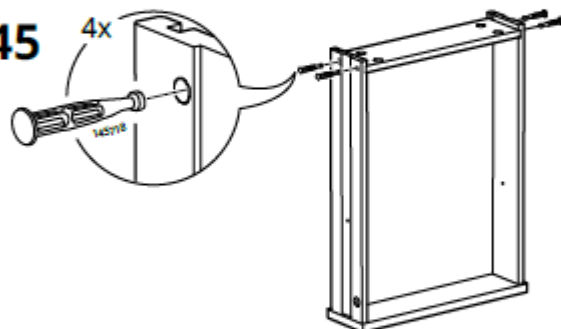

46

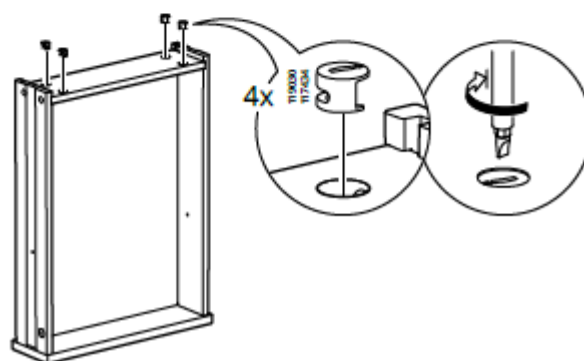

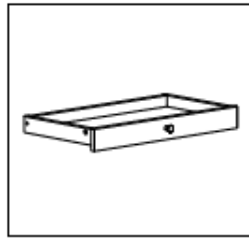

47

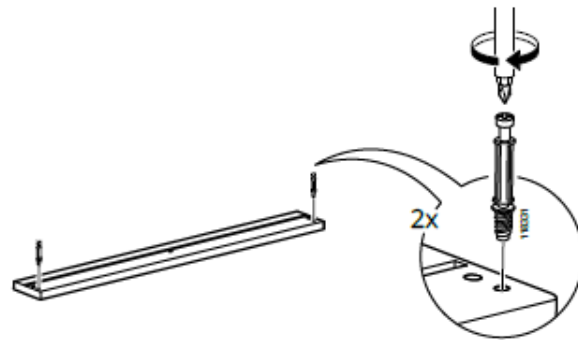

48

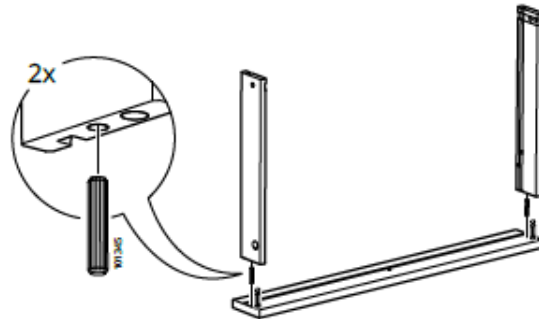

49

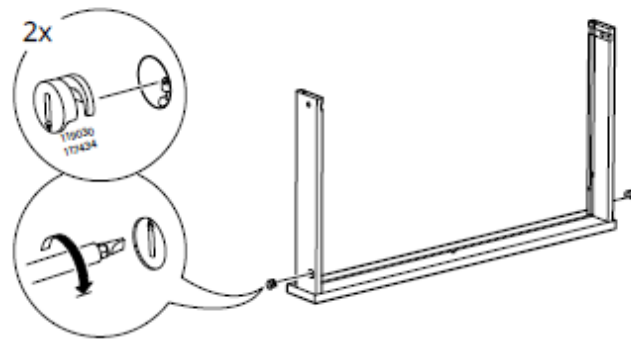

50

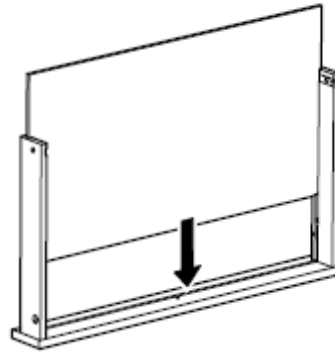

51

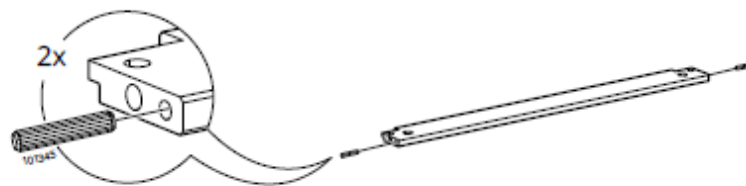

52

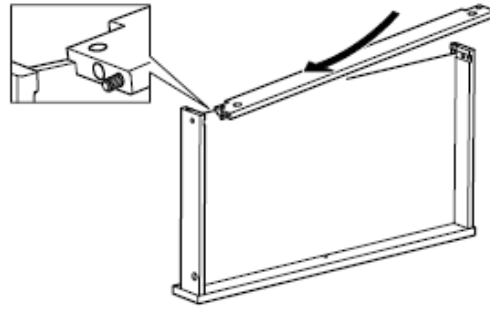

53

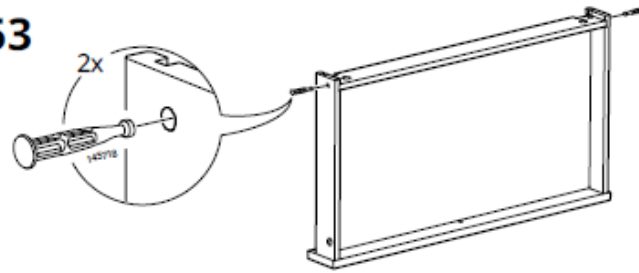

54

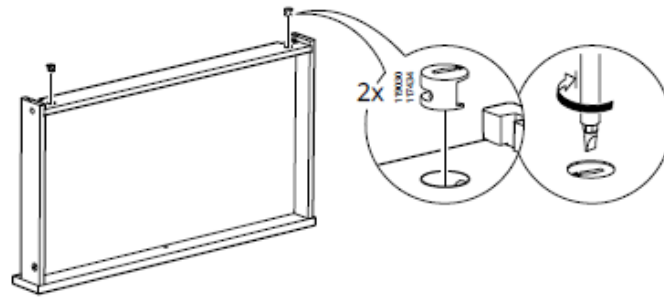

55

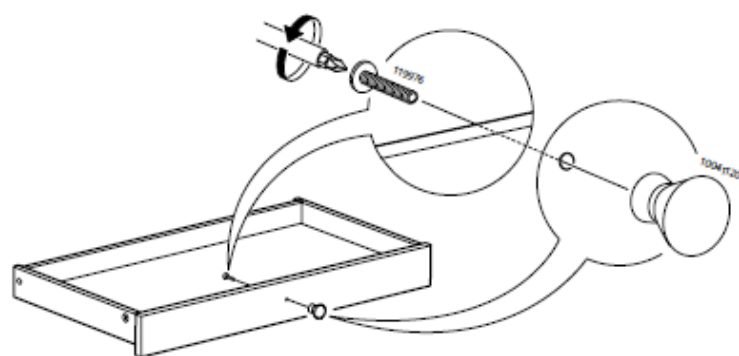

56

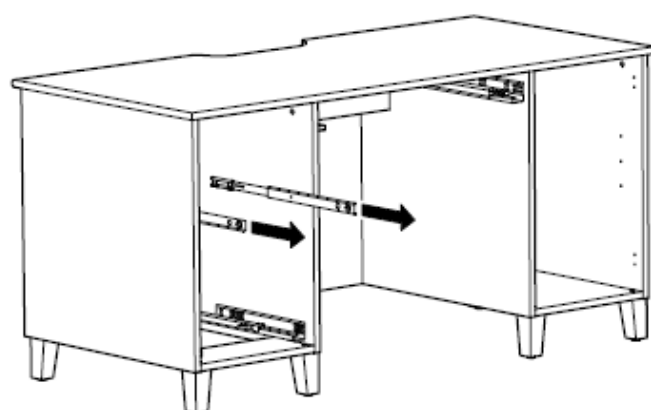

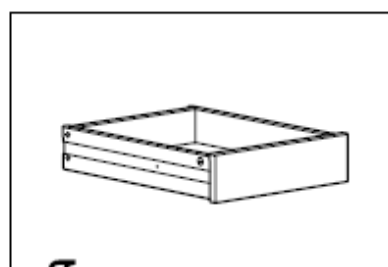

57

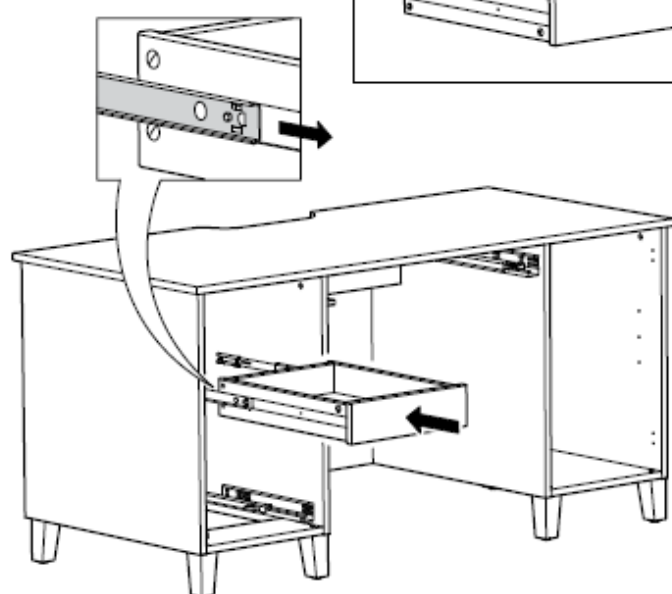
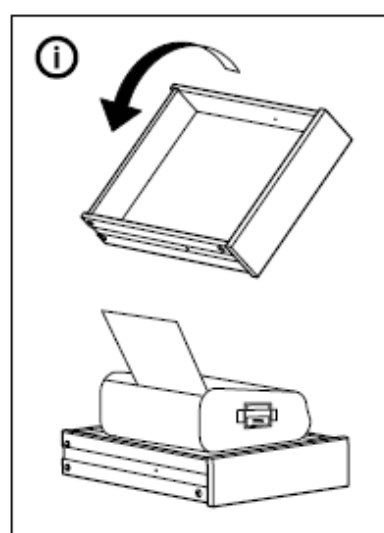

58

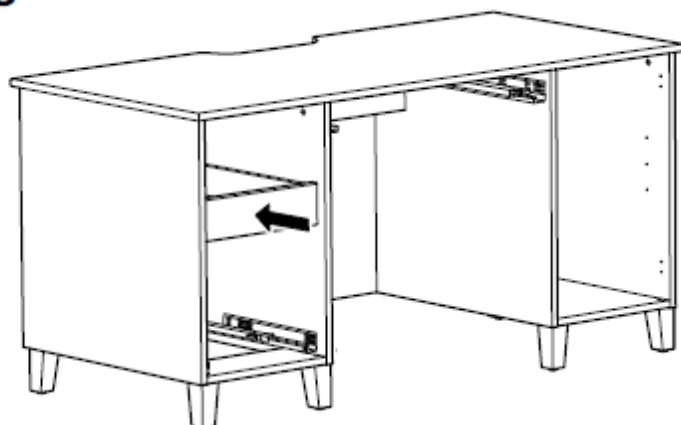

59

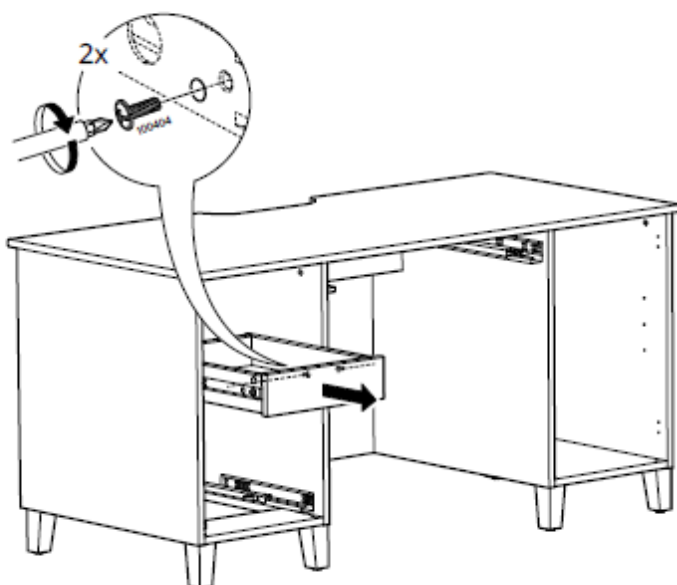

60

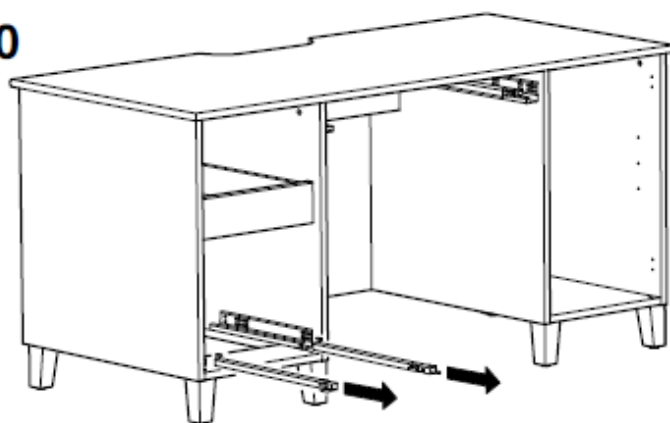

61

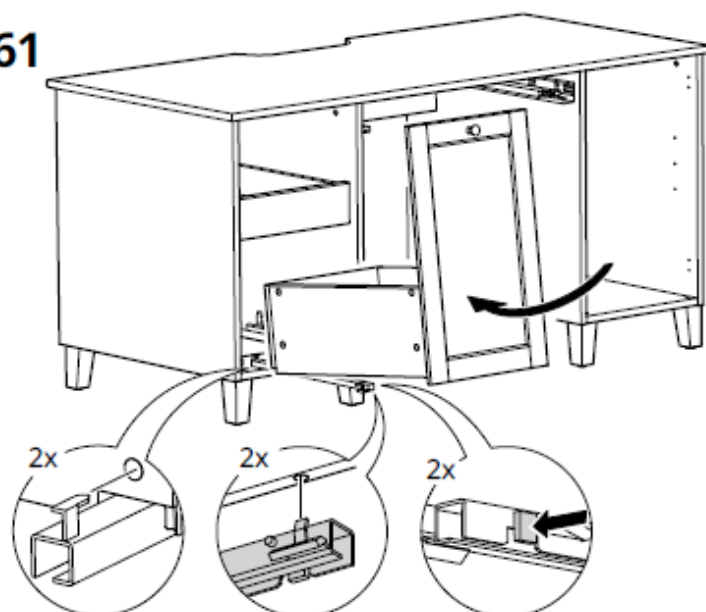

62

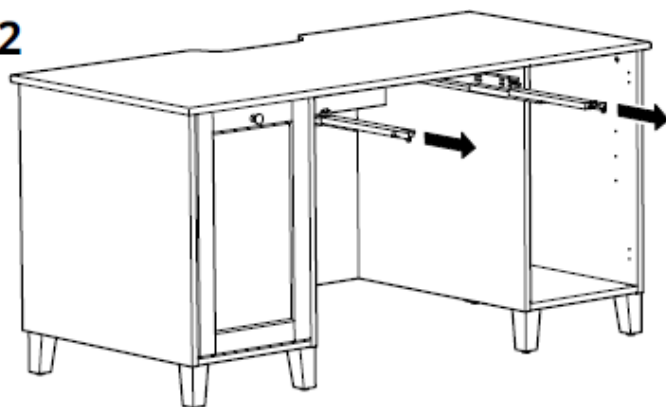

63

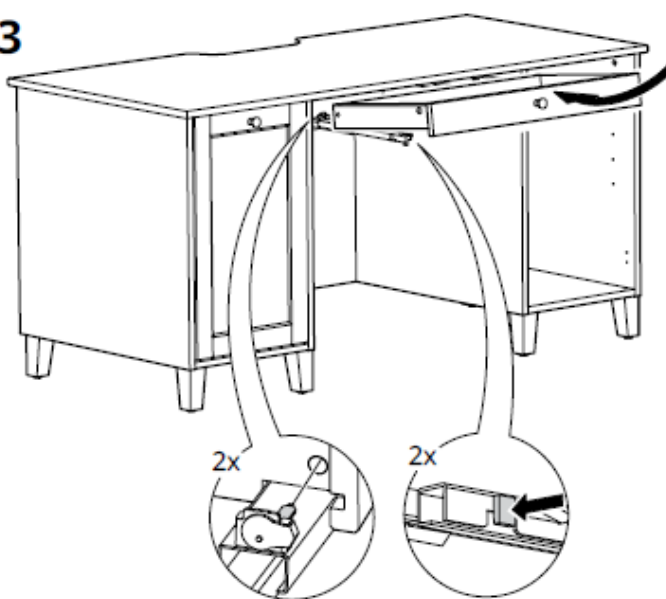

64

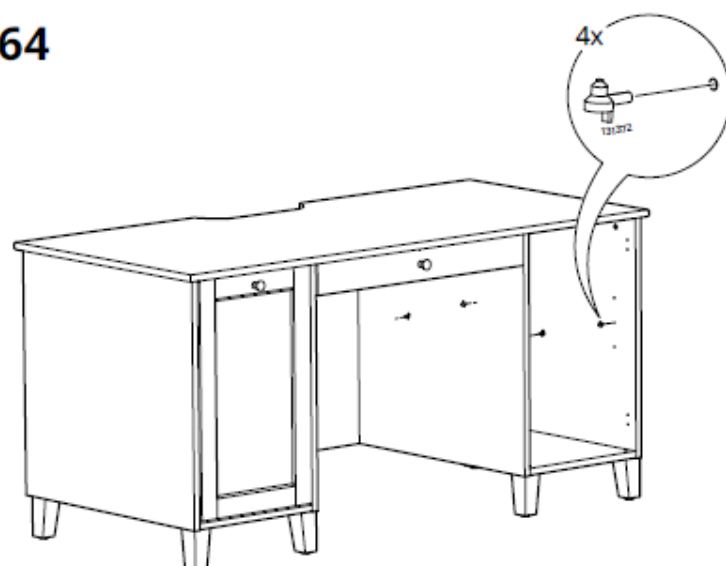

65

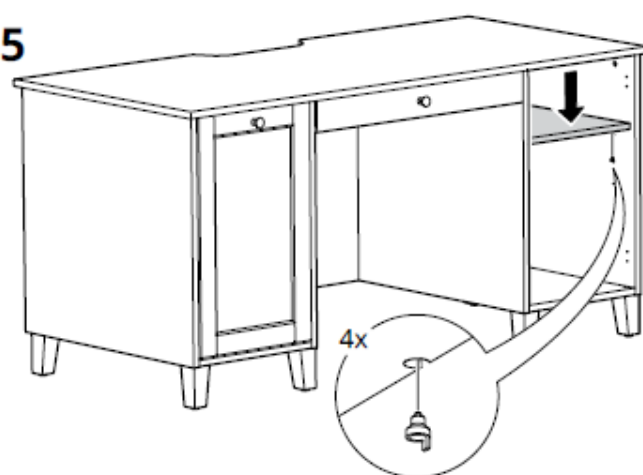

66

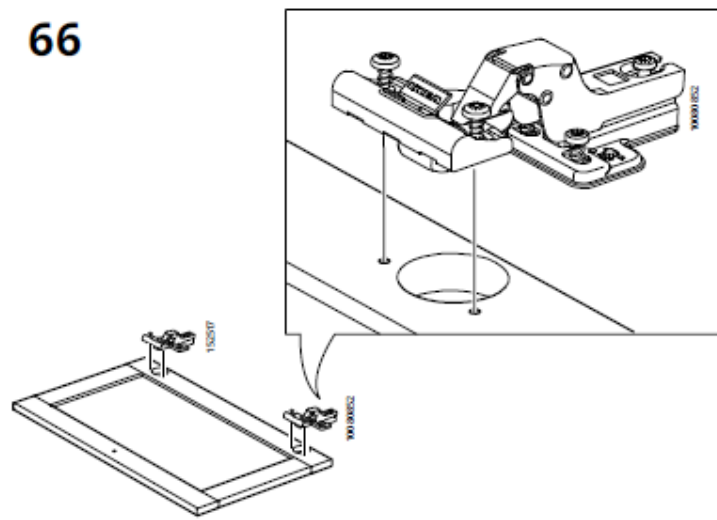

67

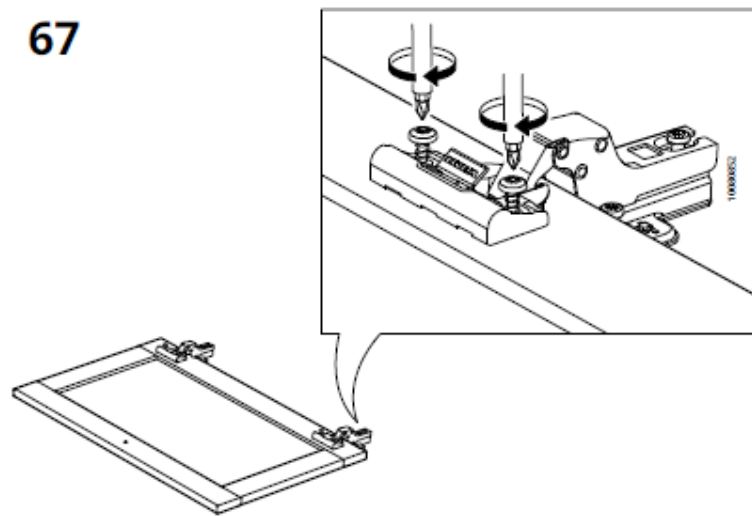

68

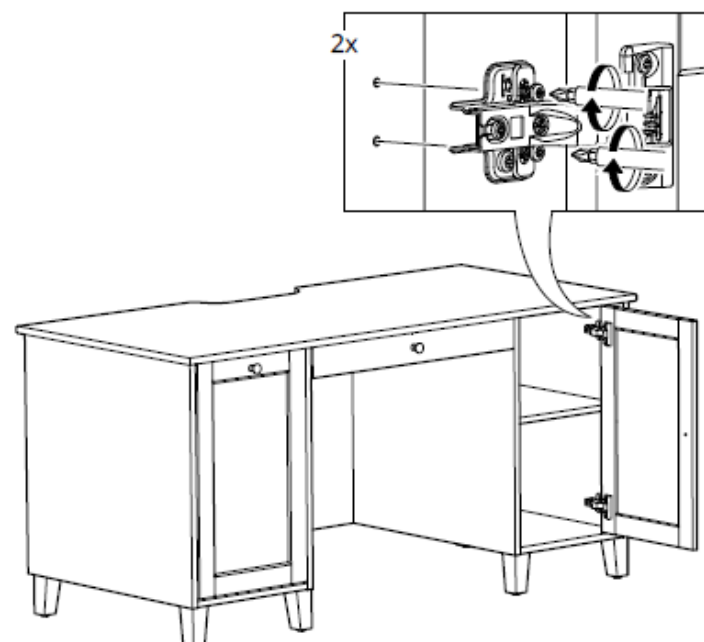

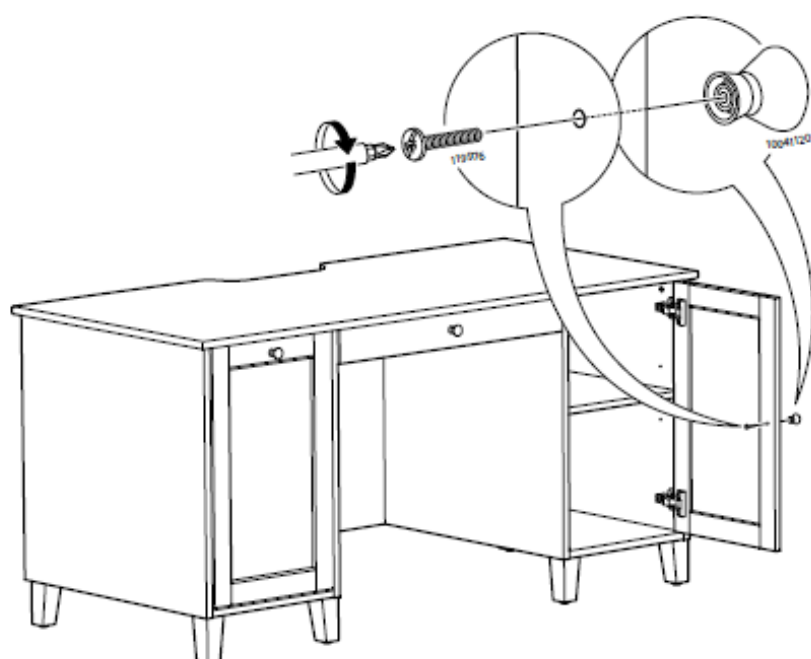

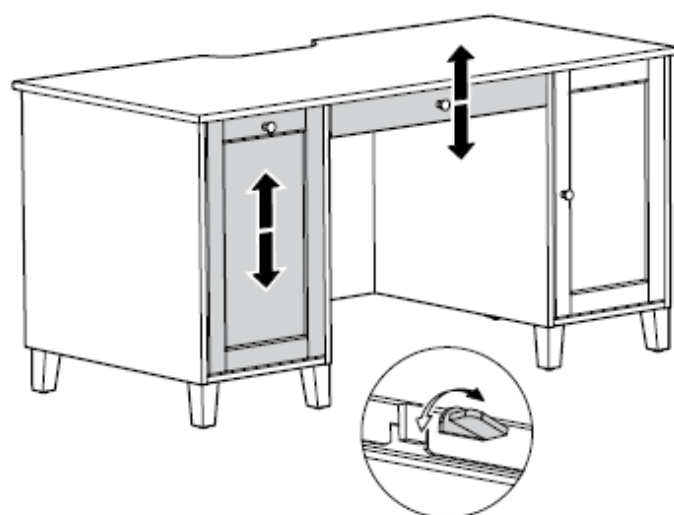

①

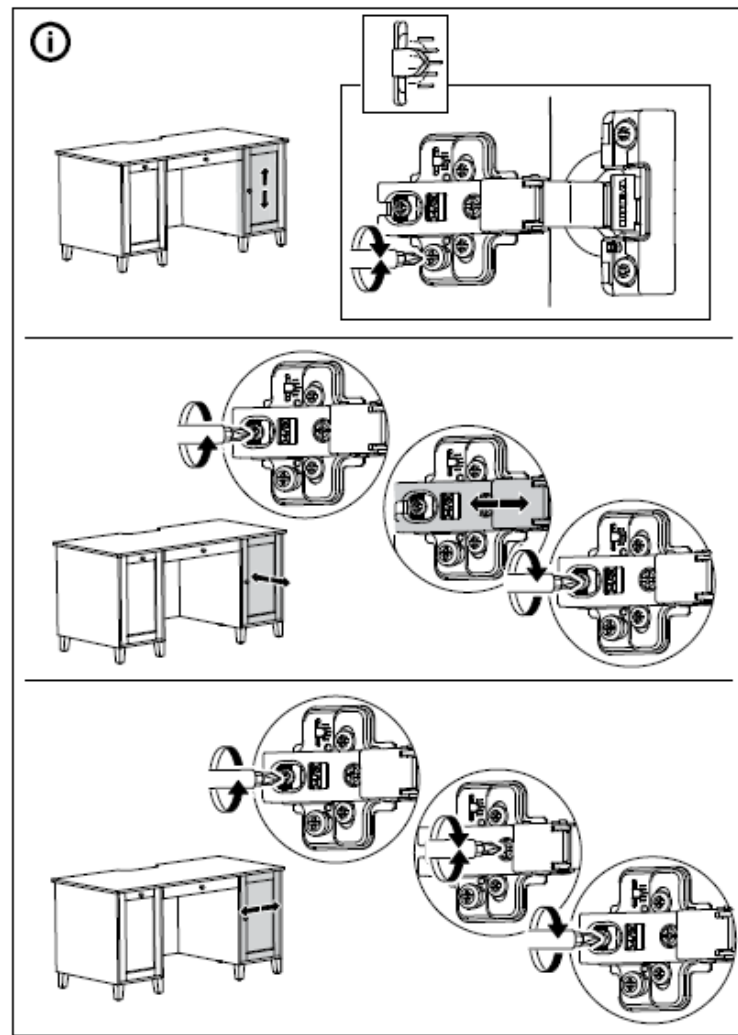



Documents / Resources

<p>IDANÄS</p>  	<p>IKEA IDANÄS Desk with Add On Unit [pdf] Instructions IDAN S Desk with Add On Unit, IDAN S, Desk with Add On Unit, with Add On Unit, Add On Unit, Unit</p>
----------------------------------------------------------------------------------------------------------------------------------------------------------------------------------------------	-----------------------------------------------------------------------------------------------------------------------------------------------------------------------------------

References

- [User Manual](#)

[Manuals+](#). [Privacy Policy](#)

This website is an independent publication and is neither affiliated with nor endorsed by any of the trademark owners. The "Bluetooth®" word mark and logos are registered trademarks owned by Bluetooth SIG, Inc. The "Wi-Fi®" word mark and logos are registered trademarks owned by the Wi-Fi Alliance. Any use of these marks on this website does not imply any affiliation with or endorsement.