



IKEA HATTASEN Bedside
Table and Shelf Unit



IKEA HATTASEN Bedside Table and Shelf Unit Instruction Manual

[Home](#) » [Ikea](#) » **IKEA HATTASEN Bedside Table and Shelf Unit Instruction Manual** 

Contents

- [1 IKEA HATTASEN Bedside Table and Shelf Unit](#)
- [2 Product Usage Instructions](#)
- [3 SAFETY](#)
- [4 TOOLS](#)
- [5 INSTALLATION](#)
- [6 Documents / Resources](#)
 - [6.1 References](#)
- [7 Related Posts](#)



IKEA HATTASEN Bedside Table and Shelf Unit



Product Specifications

- Maximum Load Capacity: 25 kg (55 lb)

Product Usage Instructions

Thank you for choosing our product. Please follow the guidelines below for proper product usage

Handling Instructions

1. Avoid placing heavy objects on the table.
2. Do not sit on the product.

Assembly Instructions

1. Refer to the provided manual for assembly steps.
2. Carefully follow the instructions to ensure proper setup.

Cleaning and Maintenance

1. Clean the product with a damp cloth and mild detergent.
2. Avoid using abrasive cleaners that may damage the surface.

Frequently Asked Questions (FAQ):

Q: What is the maximum weight this table can hold?

A: The maximum load capacity of the table is 25 kg (55 lb).

WARNING – Delicate table – Do not sit on the product.

WARNING – Delicate table – Do not place heavy objects on this product, maximum load 25 kg (55 lb)

SAFETY

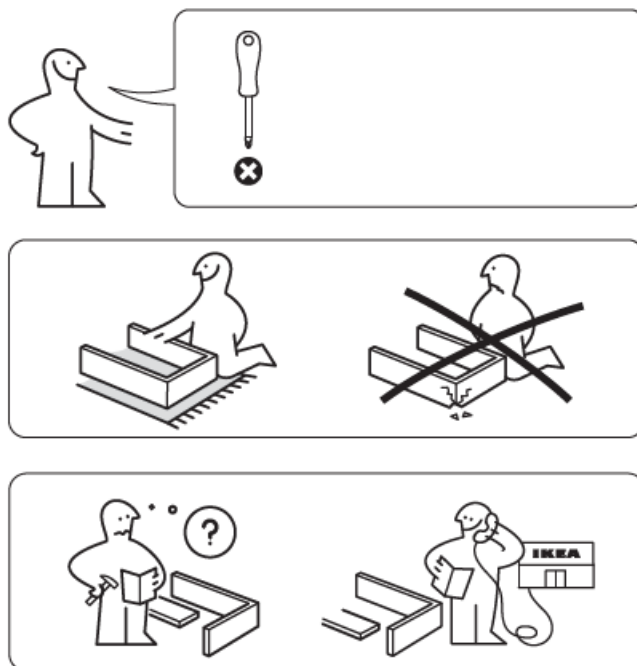

TOOLS

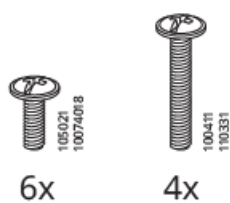

INSTALLATION

1

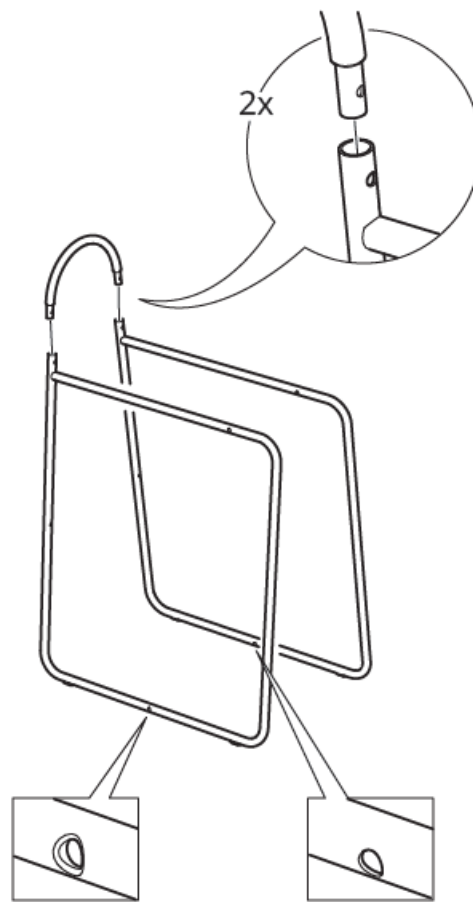

2

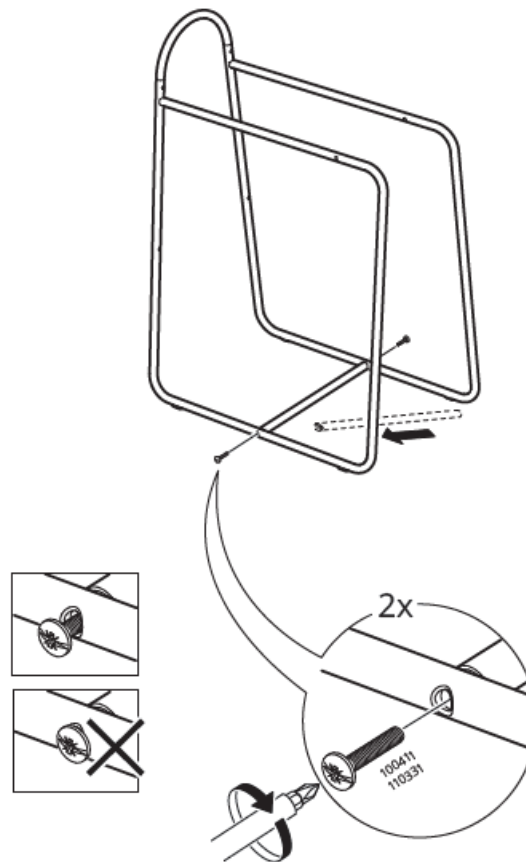

3

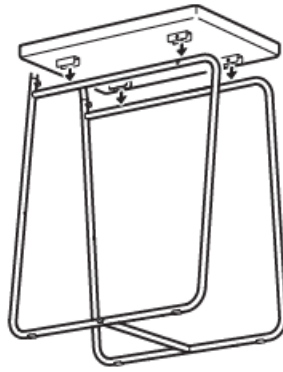

4

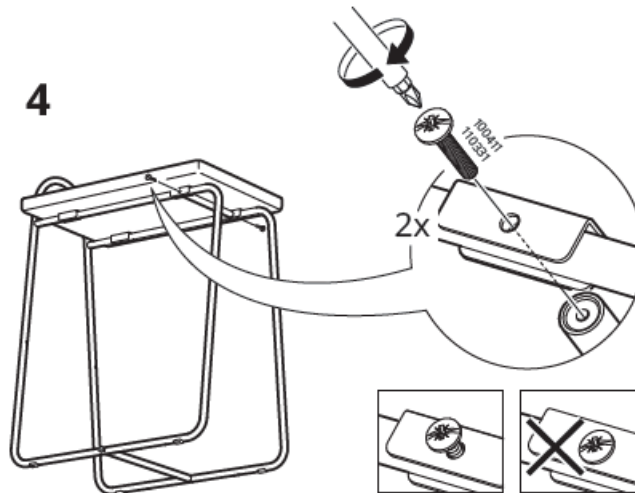

5

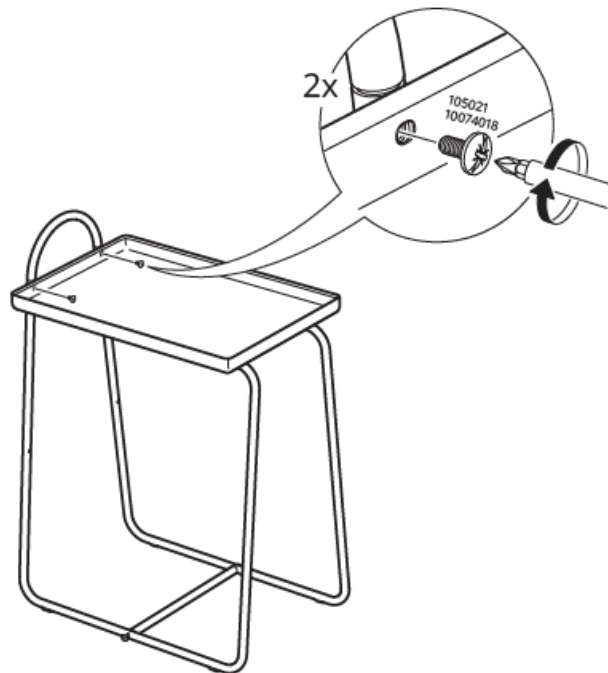

6

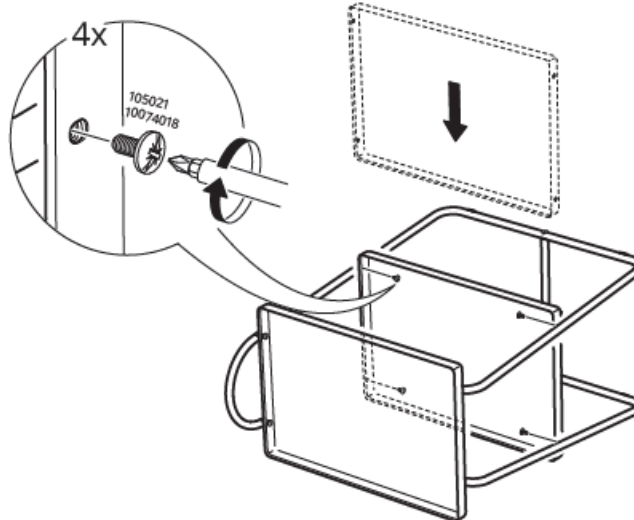
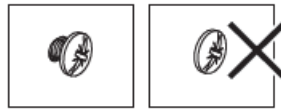
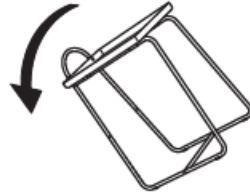

7

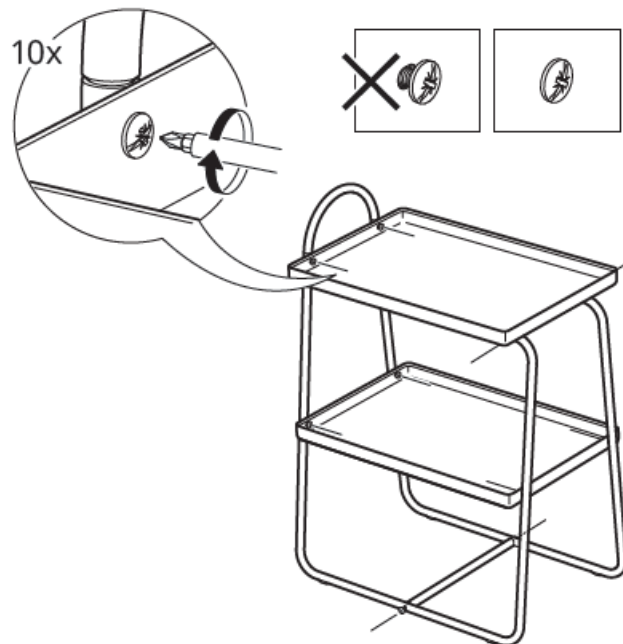

HATTÅSEN



[IKEA HATTÅSEN Bedside Table and Shelf Unit](#) [pdf] Instruction Manual

AA-2523325-1, 105021, 10074018, 100411, 110331, 101014013131, 11000570420118, HATTÅSEN Bedside Table and Shelf Unit, HATTÅSEN, Bedside Table and Shelf Unit, Table and Shelf Unit, Shelf Unit

References

- [User Manual](#)

[Manuals+](#), [Privacy Policy](#)

This website is an independent publication and is neither affiliated with nor endorsed by any of the trademark owners. The "Bluetooth®" word mark and logos are registered trademarks owned by Bluetooth SIG, Inc. The "Wi-Fi®" word mark and logos are registered trademarks owned by the Wi-Fi Alliance. Any use of these marks on this website does not imply any affiliation with or endorsement.