



## IKEA HADDEBO Triple Cord Set Instruction Manual

[Home](#) » [Ikea](#) » IKEA HADDEBO Triple Cord Set Instruction Manual 



Design and Quality  
IKEA of Sweden  
HADDEBO



### **IMPORTANT**

Always shut off power to the circuit before starting installation work. In some countries electrical installation work may only be carried out by an authorised electrical contractor. Contact your local electricity authority for advice.

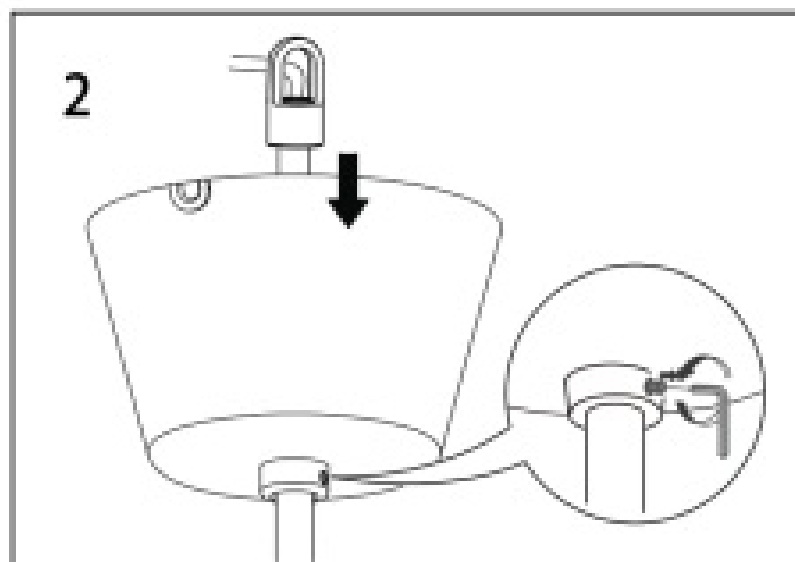
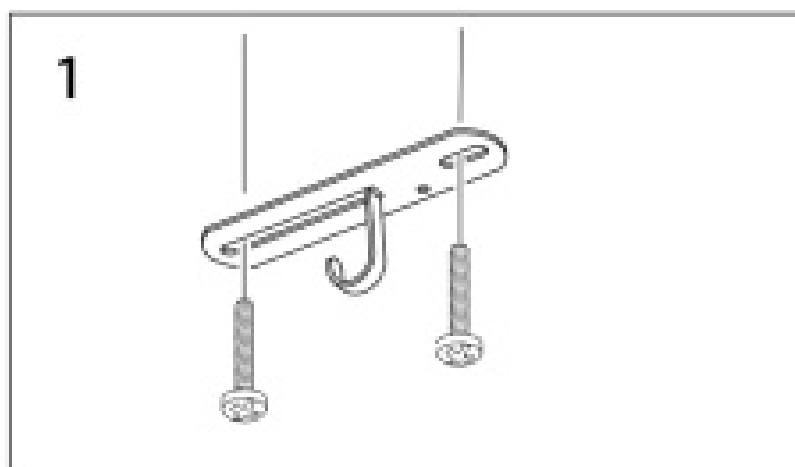
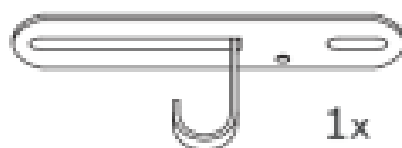
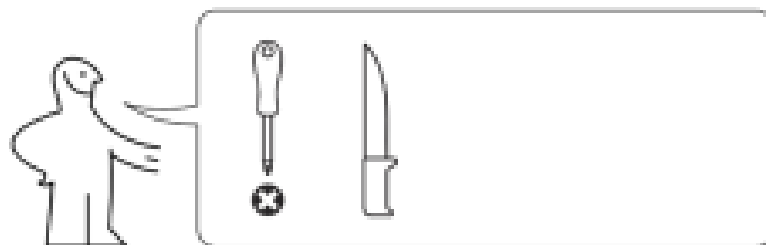
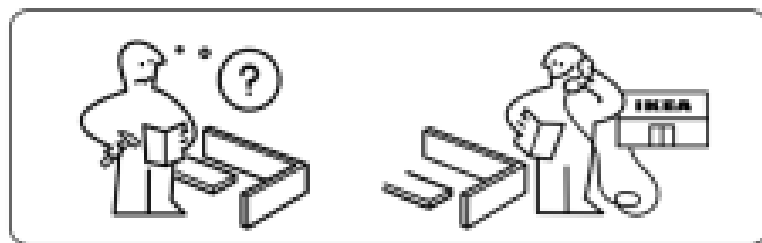

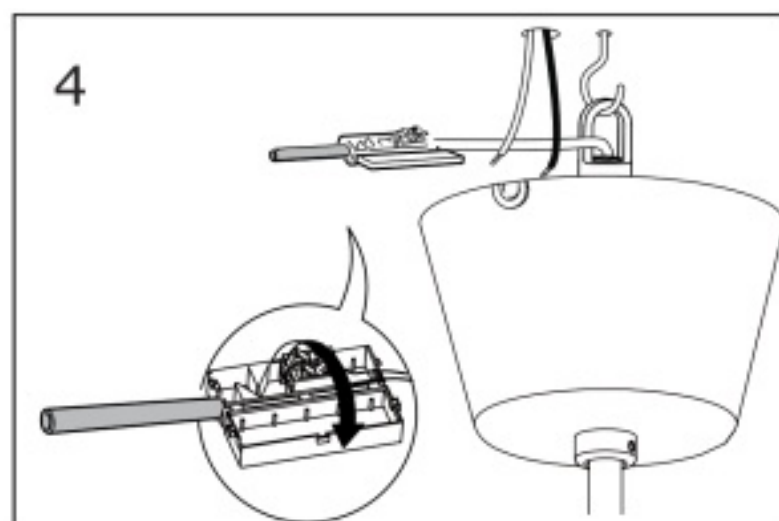
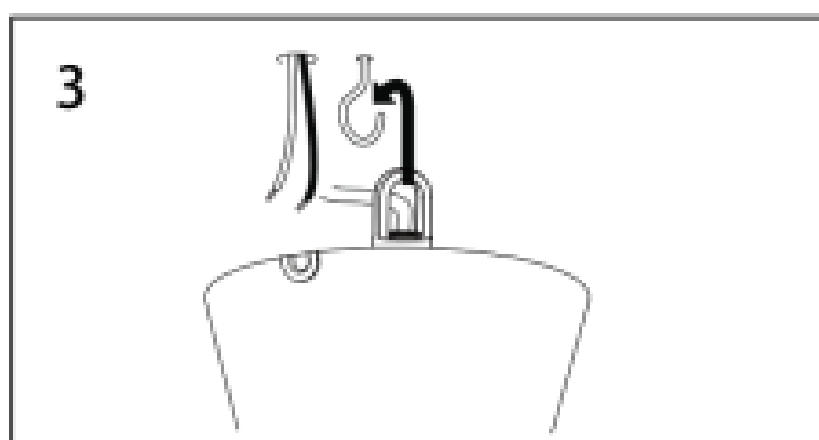
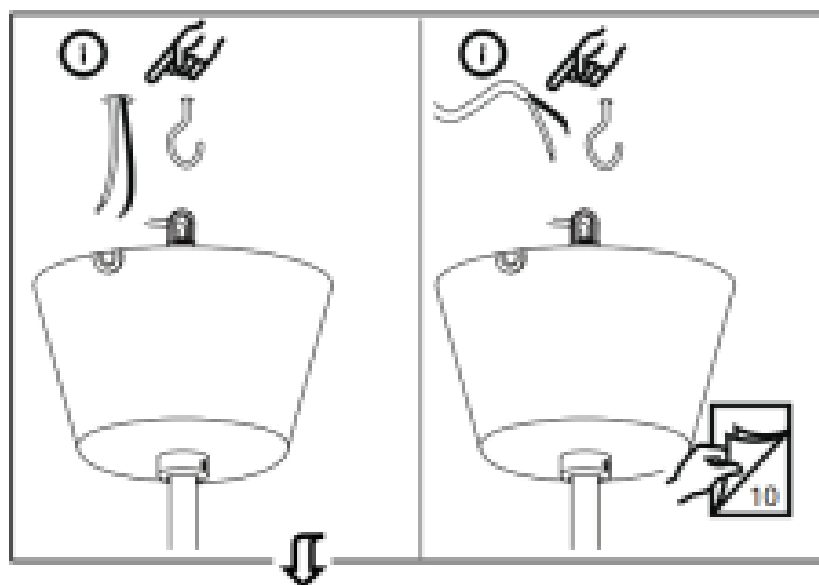

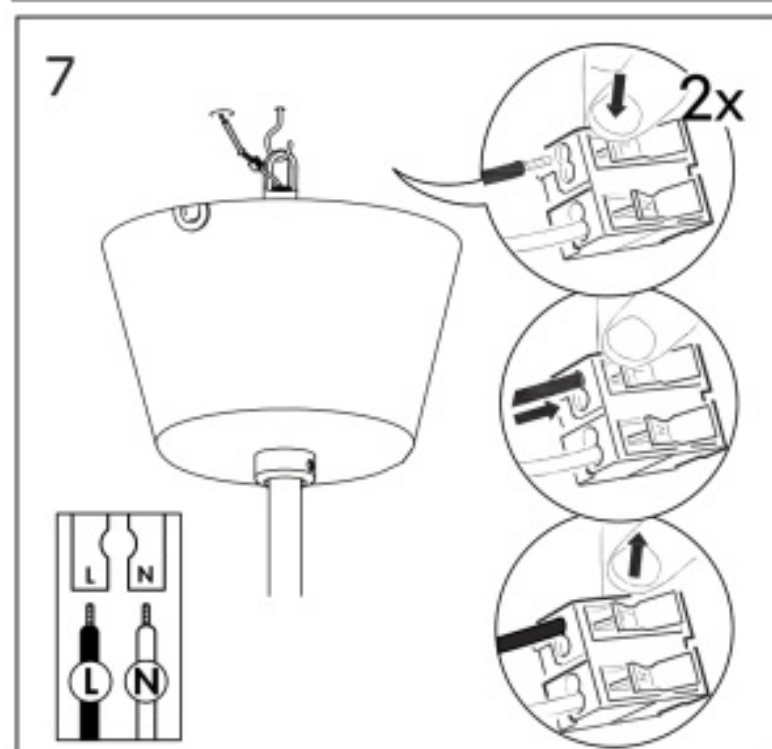
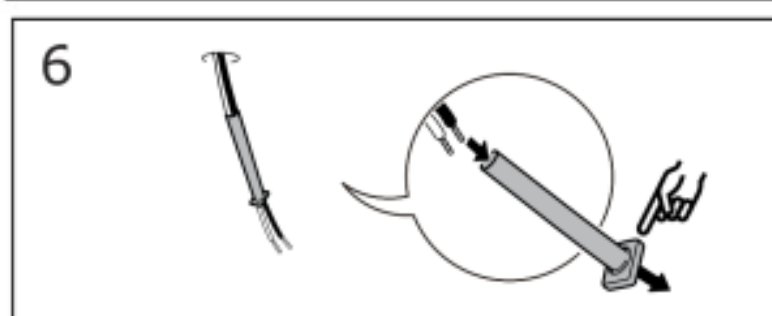
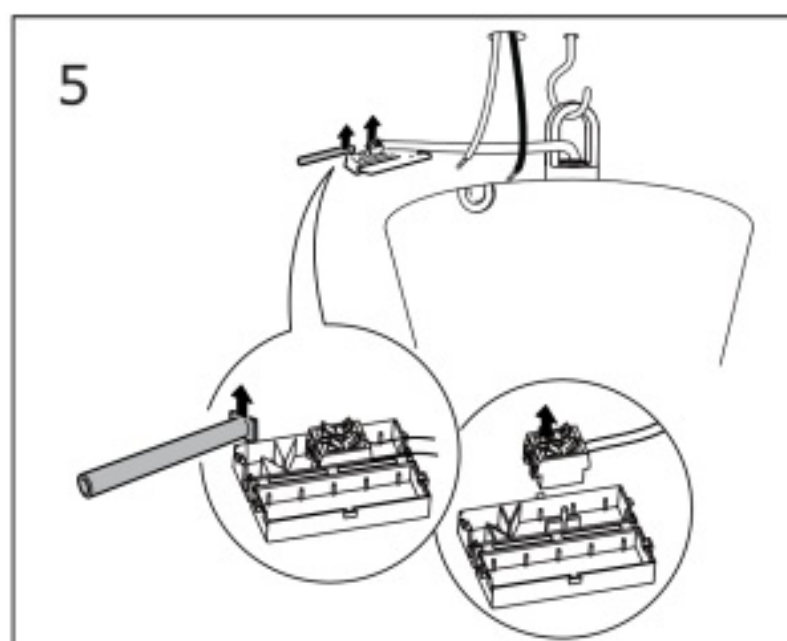

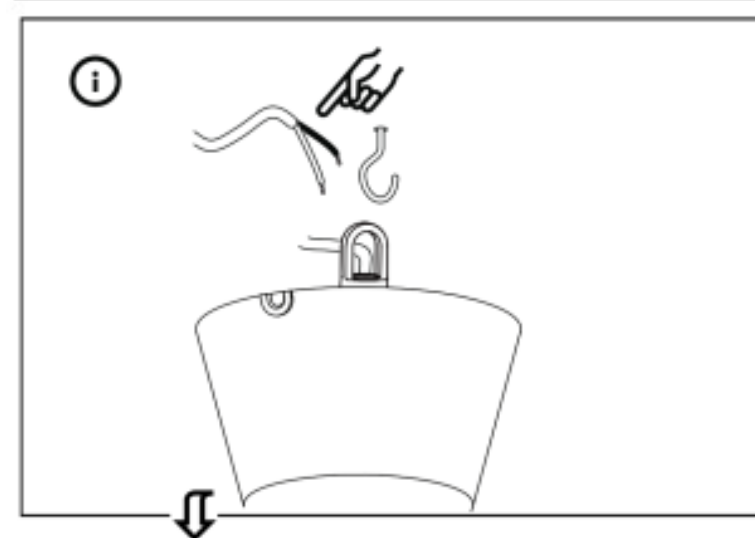
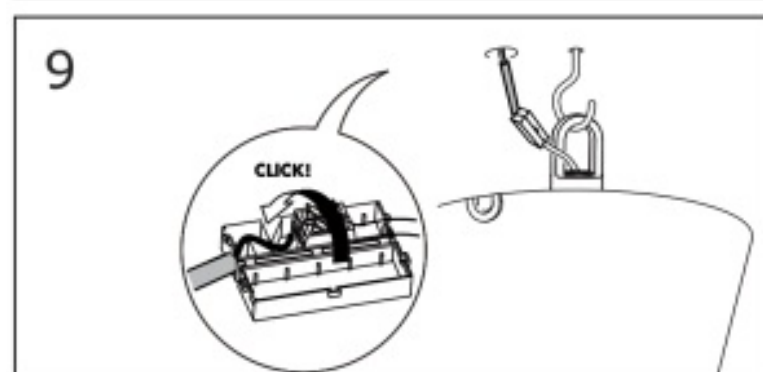
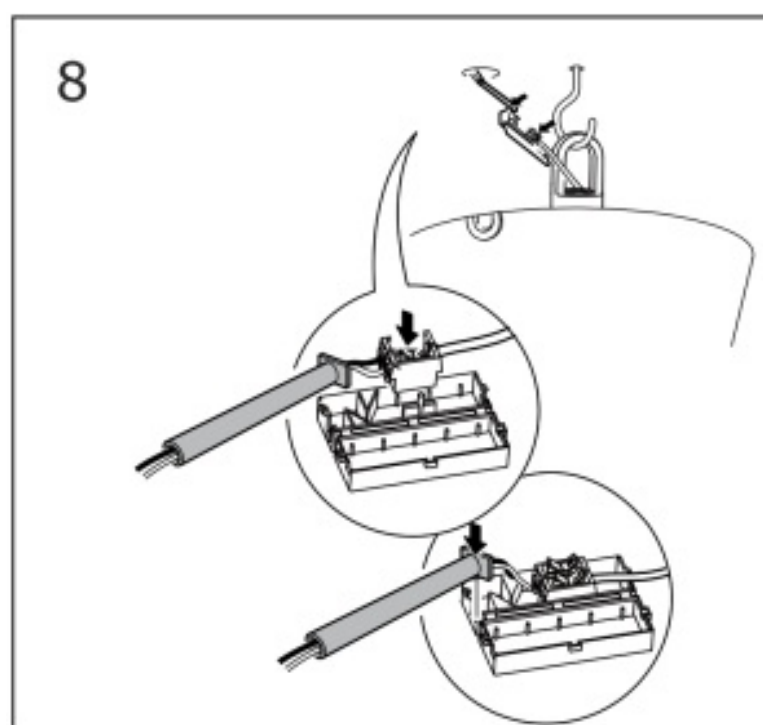

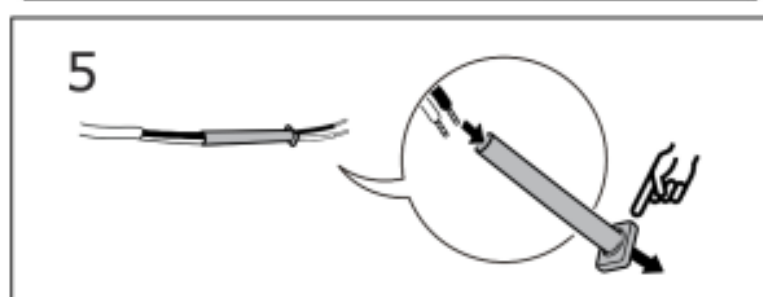
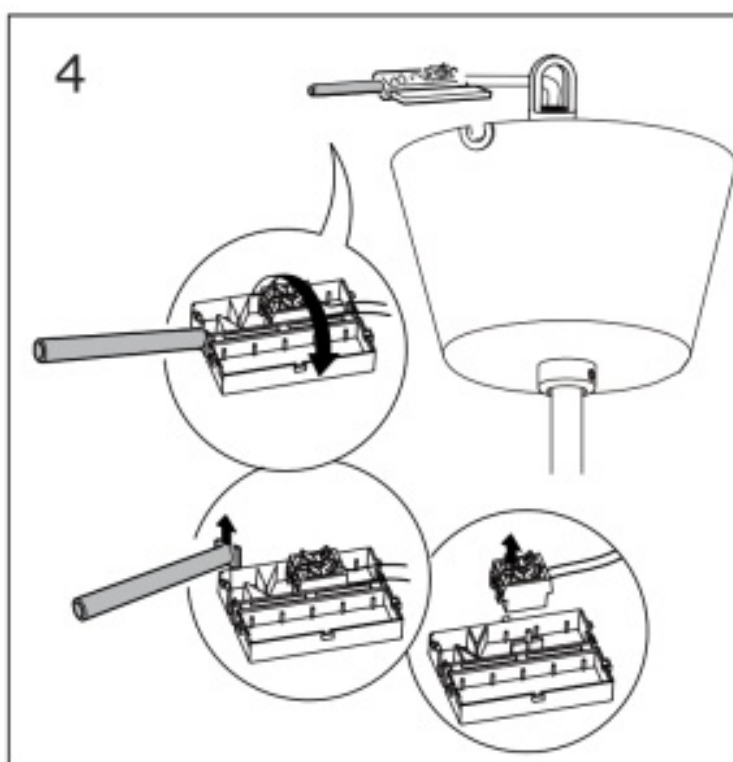
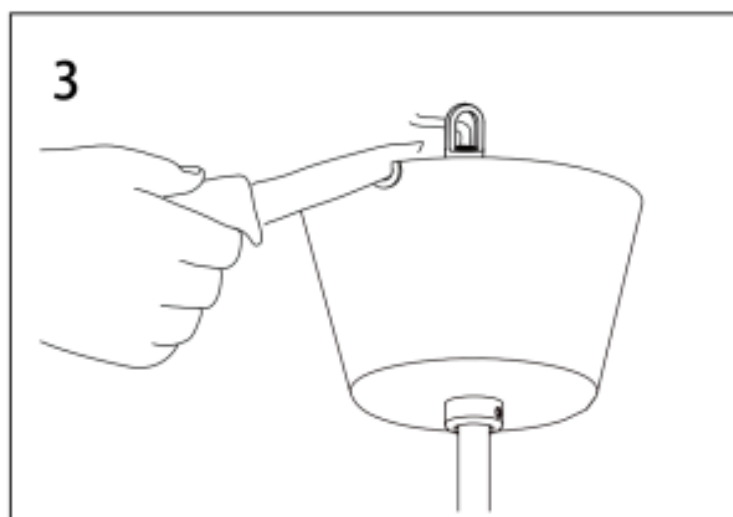

6

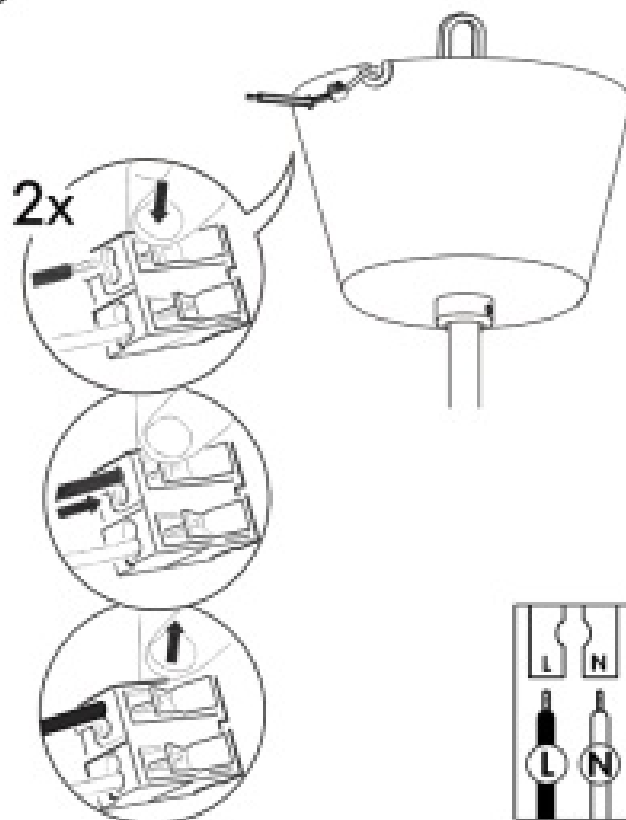

7

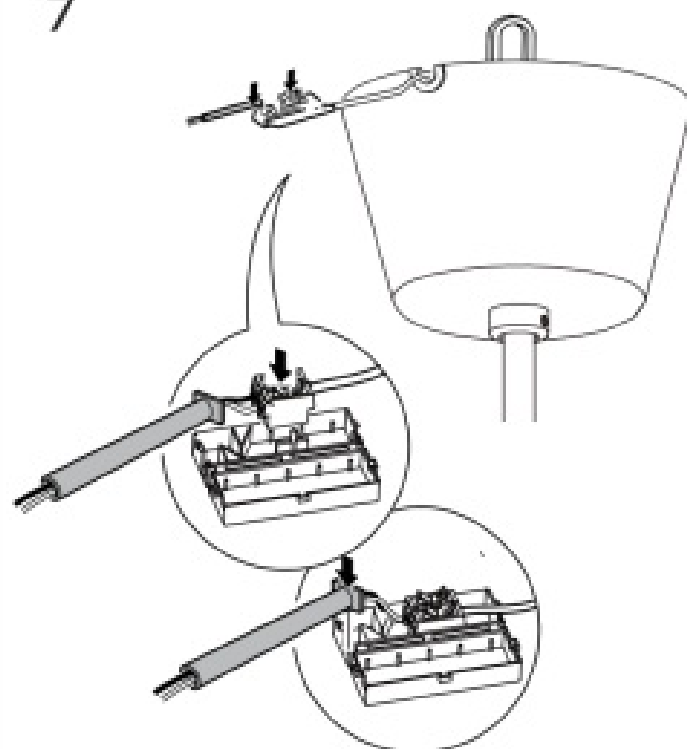



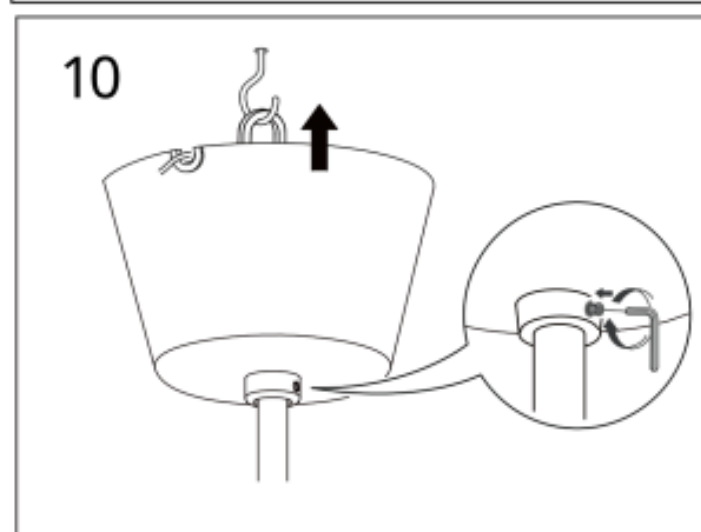
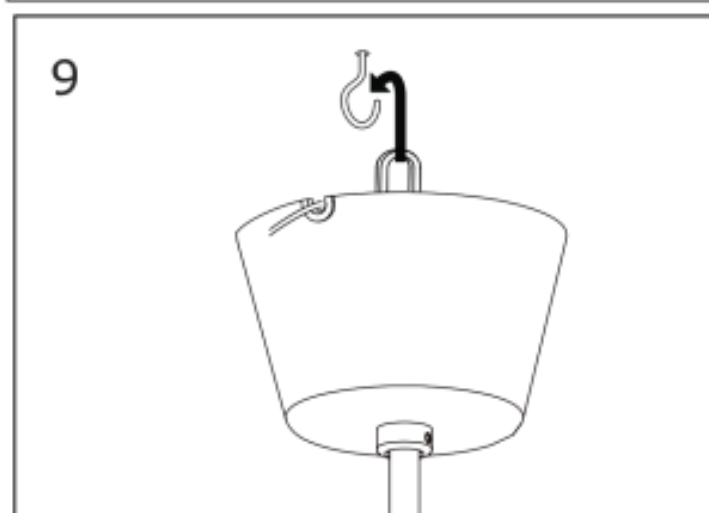
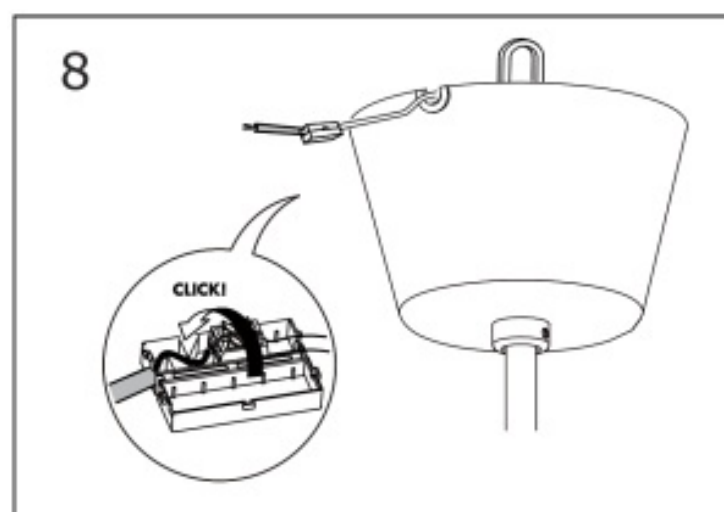

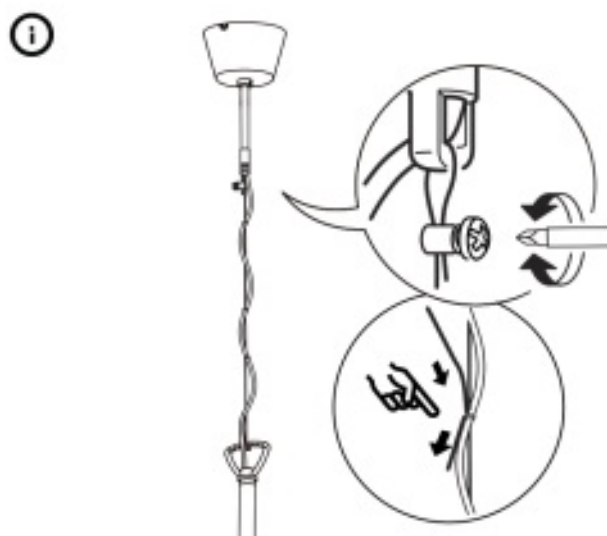

The weight of the lamp must be taken by the suspension wire. When adjusting the cable make sure that it is longer than the wire.

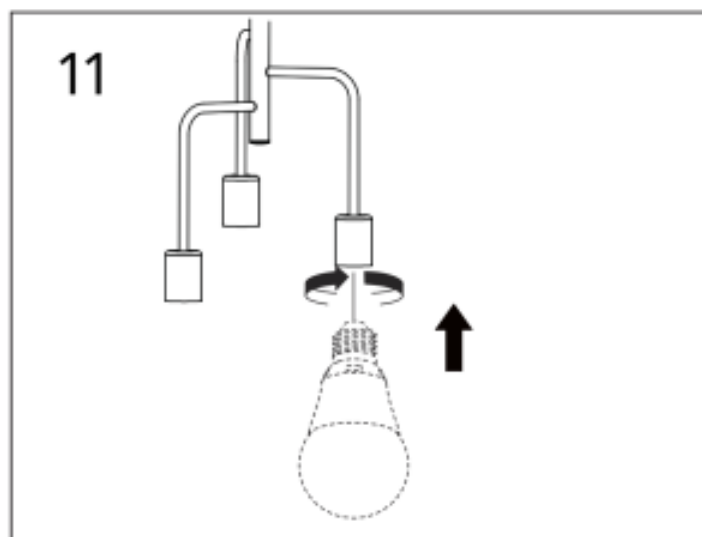

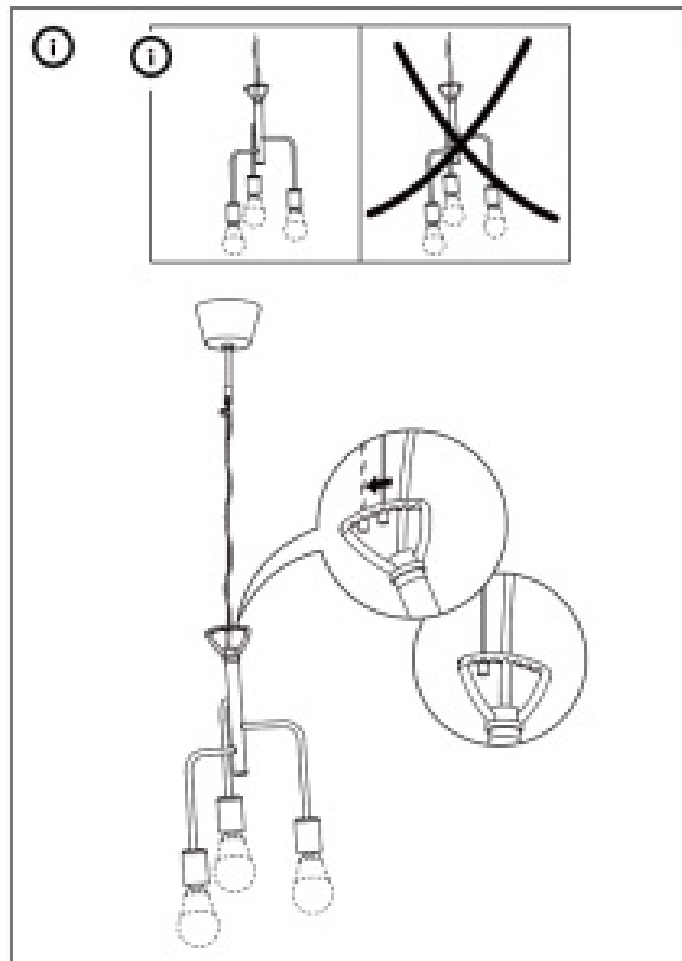



## Contents

- [1 Documents / Resources](#)
- [2 Related Posts](#)

## Documents / Resources

<p><b>HADDEBO</b></p>  	<p><a href="#">IKEA HADDEBO Triple Cord Set</a> [pdf] Instruction Manual HADDEBO, Triple Cord Set</p>
---	---