



Ikarao BREAK X1 Go Speaker User Guide

[Home](#) » [Ikarao](#) » Ikarao BREAK X1 Go Speaker User Guide 

Contents

- [1 Ikarao BREAK X1 Go Speaker](#)
- [2 IMPORTANT SAFETY INFORMATION](#)
- [3 WHAT'S IN THE BOX](#)
- [4 BUTTON](#)
- [5 INTERFACES](#)
- [6 HOMEPAGE](#)
- [7 LIGHTING EFFECT](#)
- [8 BLUETOOTH AUDIO](#)
- [9 LOCAL AUDIO](#)
- [10 WI-FI AUDIO](#)
- [11 HDMI](#)
- [12 MICROPHONES](#)
- [13 SPEAKER CHARGING](#)
- [14 MICROPHONES CHARGING](#)
- [15 SOFTWARE UPDATE](#)
- [16 USER MANUAL](#)
- [17 CUSTOM SERVICE](#)
- [18 USE CARRYING STRAP](#)
- [19 USE SPEAKER TRIPOD STAND](#)
- [20 CERTIFICATION AND COMPLIANCE](#)
 - [20.1 FCC Statement](#)
- [21 Documents / Resources](#)
 - [21.1 References](#)
- [22 Related Posts](#)

Ikarao BREAK X1 Go Speaker

USER GUIDE

IMPORTANT SAFETY INFORMATION

Safety Instructions Before Using the Machine:

- Please read and retain this user manual.
- Do not block the speaker's ventilation openings or sound channels with objects.
- Avoid using the machine at high volumes for prolonged periods to prevent damage .
- Use compliant accessories, internal batteries must not be removed or replaced by the end user.
- The operating temperature should be between 0°C and 40°C.
- Do not expose the device to damp or high-temperature environments such as puddles, sunligh or open flames to ovoid the risk of electric shock or explosion.
- Unplug the machine during thunderstorms or if it will not be used for on extended period.
- Do not forcibly insert a TF cord or SD cord into the slot. Insert the cord in the correct sequence to ovoid malfunction. 8 Do not use any corrosive or oily cleaners to clean the machine.
- To maintain the machine's performance and battery life, fully charge it at least once every three months.

WHAT'S IN THE BOX

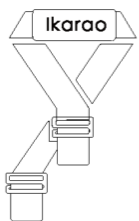

CARRYING STRAP

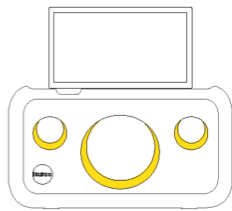

BREAK X1

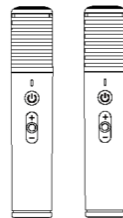

TWO WIRELESS MICS

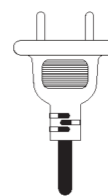

POWER CABLE

BUTTON

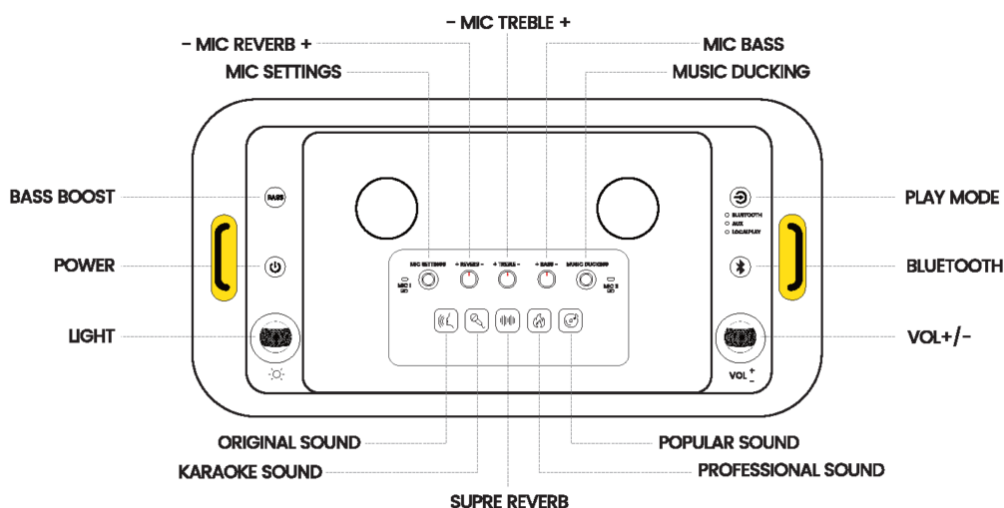

INTERFACES

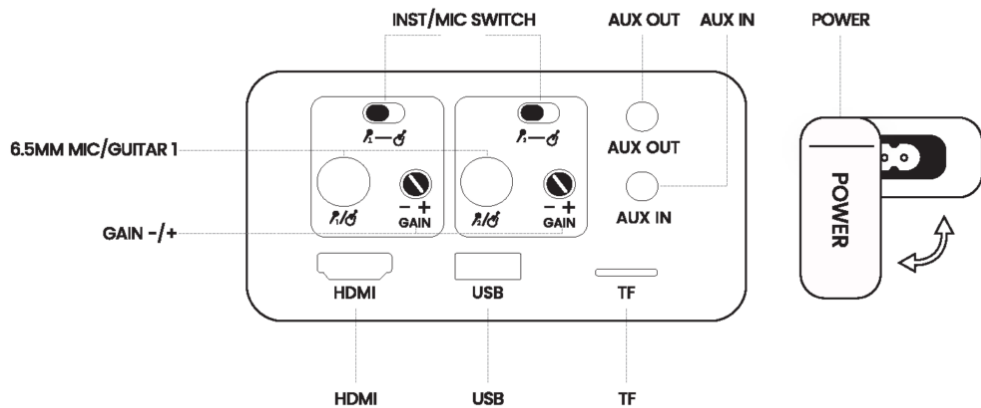

HOMEPAGE

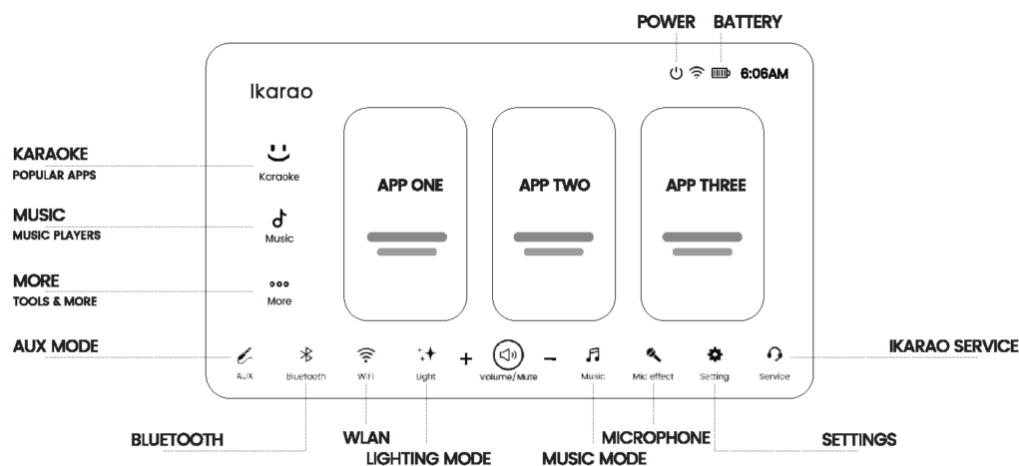

LIGHTING EFFECT

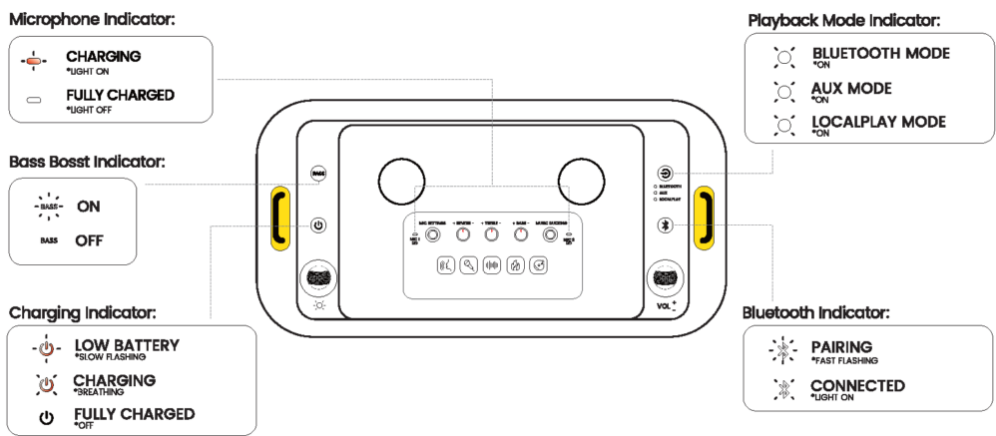

BLUETOOTH AUDIO

- Press the button on the screen or speaker to enter Bluetooth mode. Bluetooth indicator light flashes fast

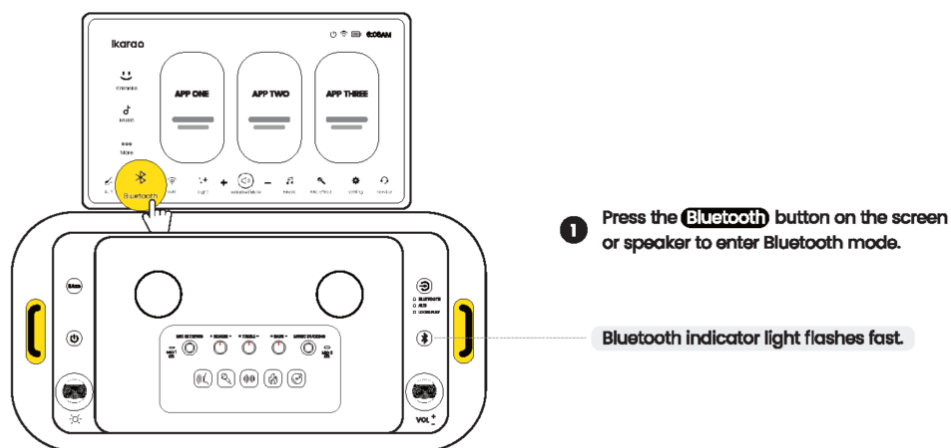

2. Open the Bluetooth settings on your device and pair with 'IKARAO X1-XXXX'

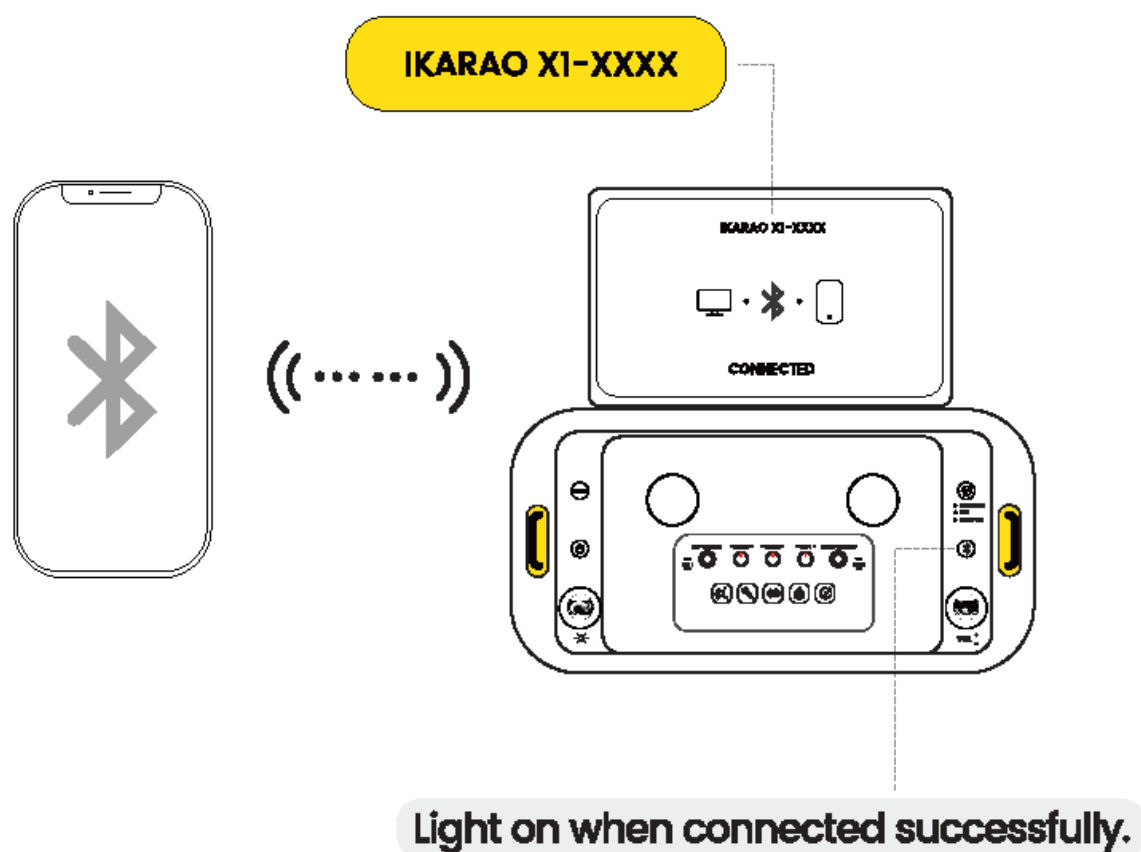

3. Press the Bluetooth button to disconnect

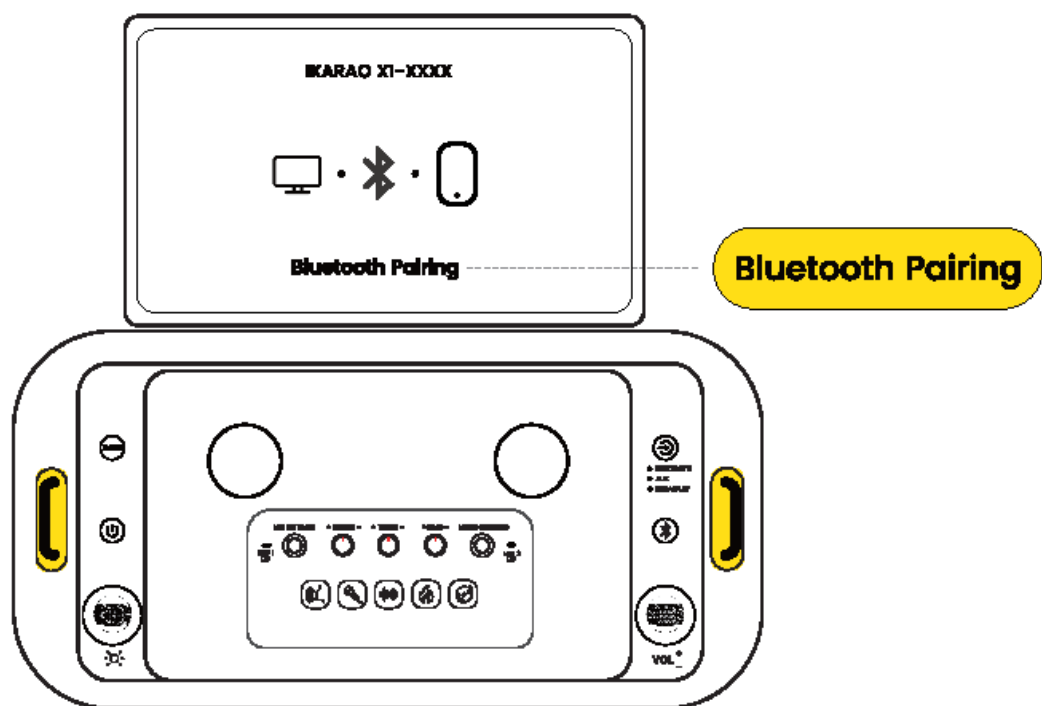

LOCAL AUDIO

1. Insert a USB with audio/video files

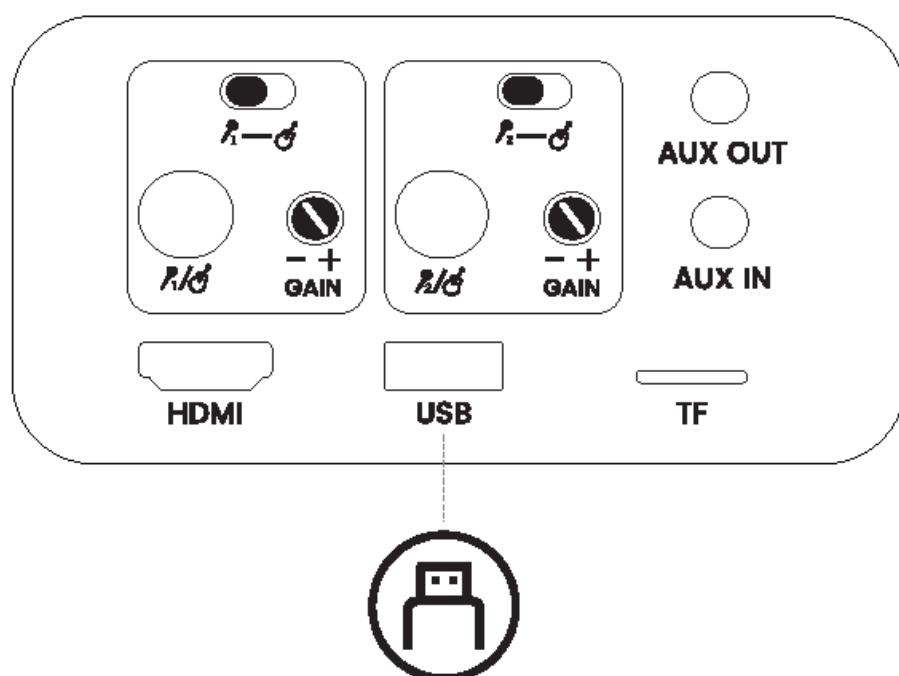

2. Click YES on the screen prompt to enter the local media player

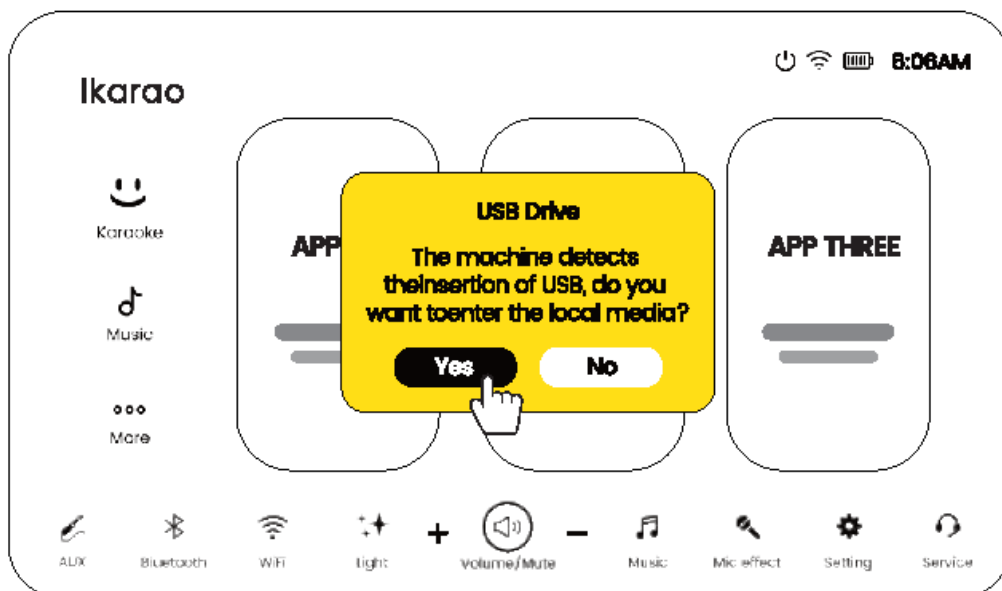

3.If you accidentally click **NO**, re-enter the local media player by selecting **MUSIC** → **LOCAL MEDIA** from the left sidebar.

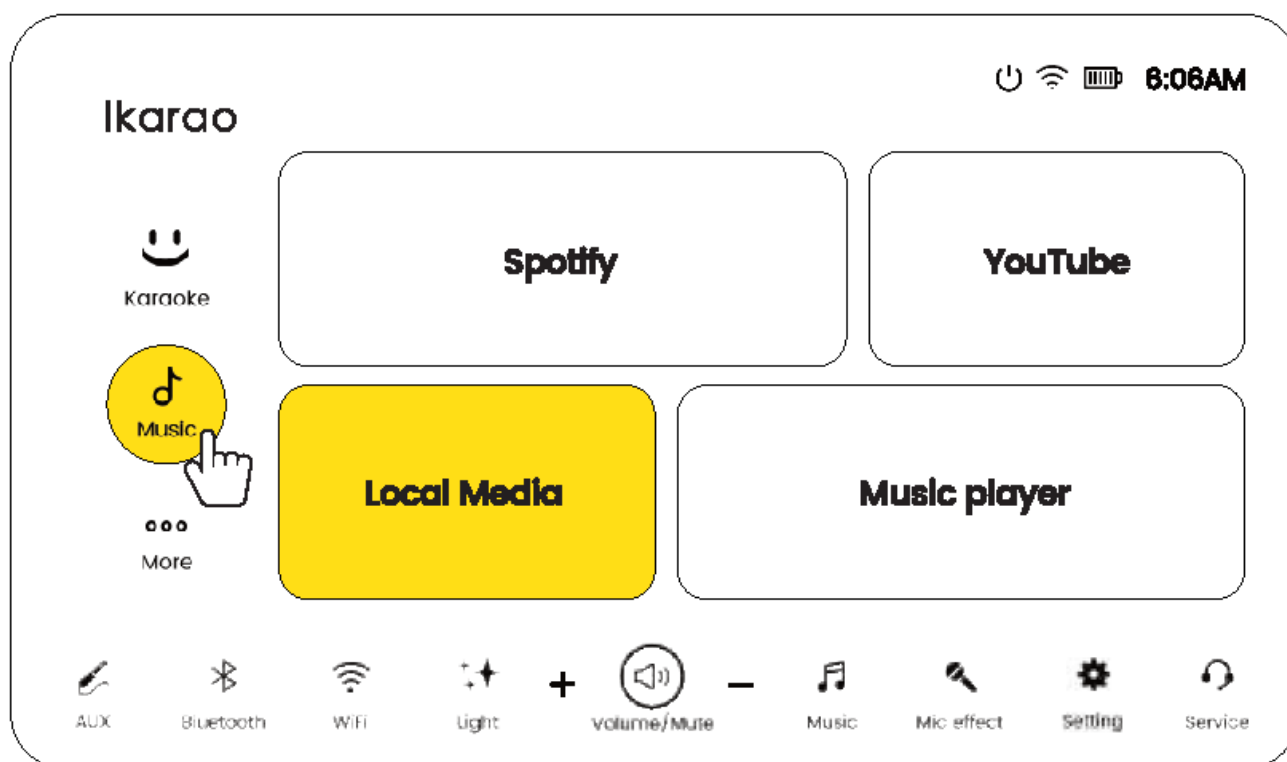

NOTE: Local Media Player auto-loads .LRC lyrics from the same directory as audio files.

WI-FI AUDIO

1. click **SETTING**

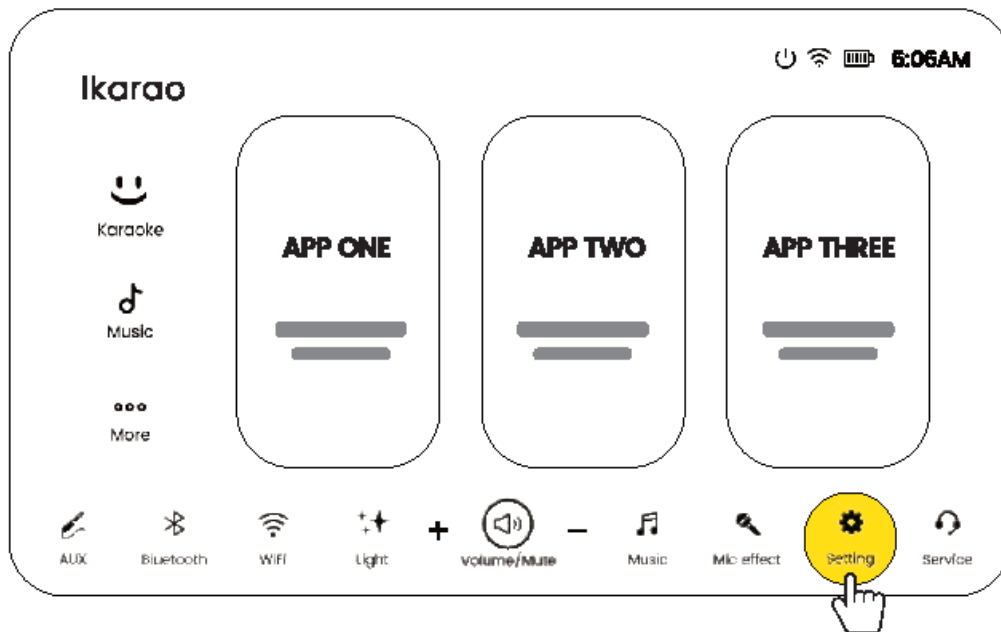

2. Connect Your WLAN

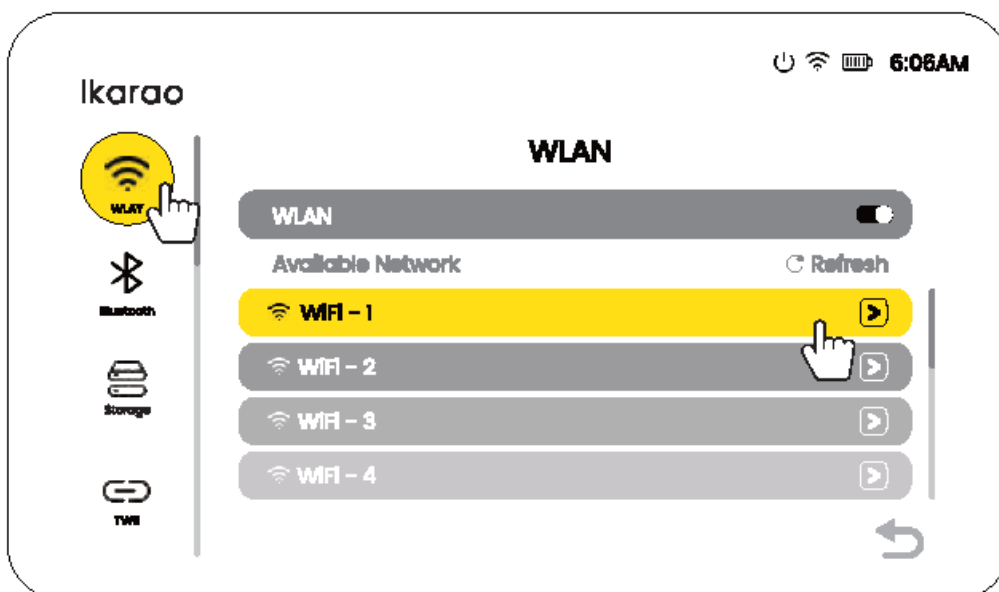

3. Log In to **SPOTIFY** for music or **KARAFUN** for ,for karaoke OR **YOUTUBE** music and video.

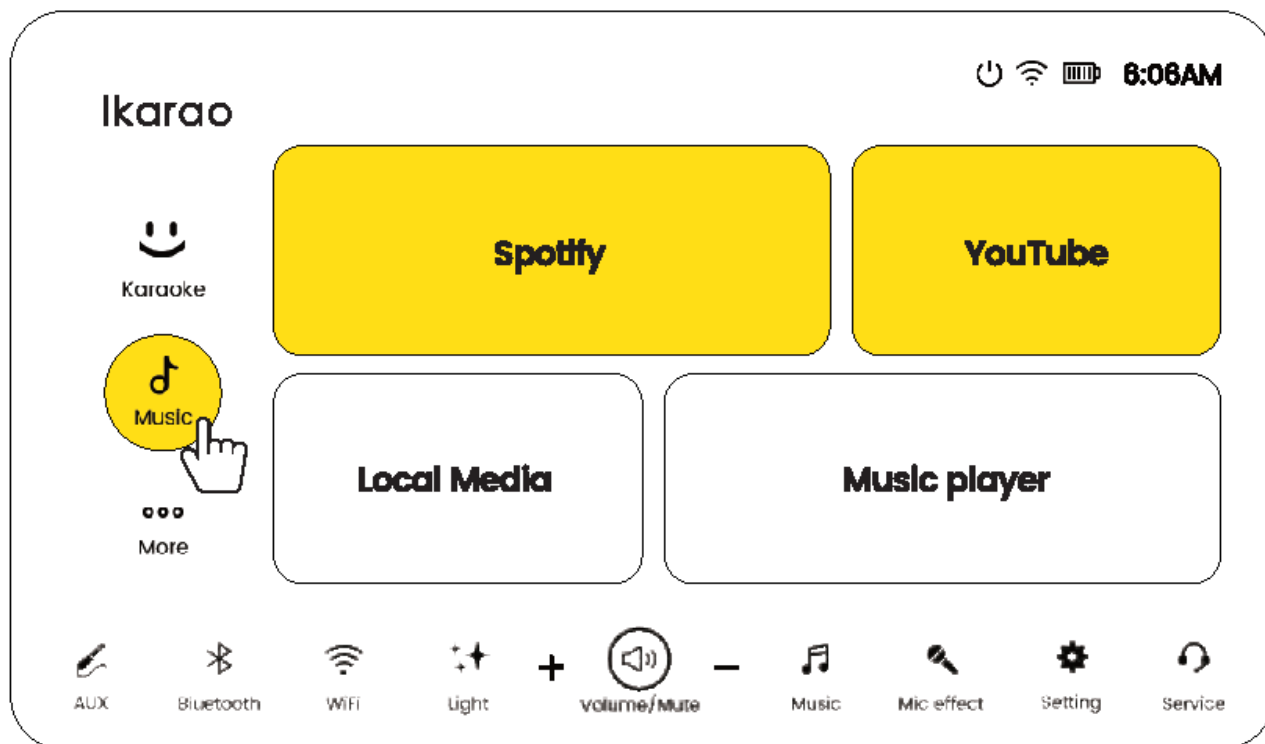

For FAQs and more information, please visit

WWW.IKARAO.COM/PAGES/SUPPORT



@ikaraoofficial



@IKARAO



@IKARAO



@IKARAO



@ikaraoofficial

HDMI

1. Connect using HDMI cable

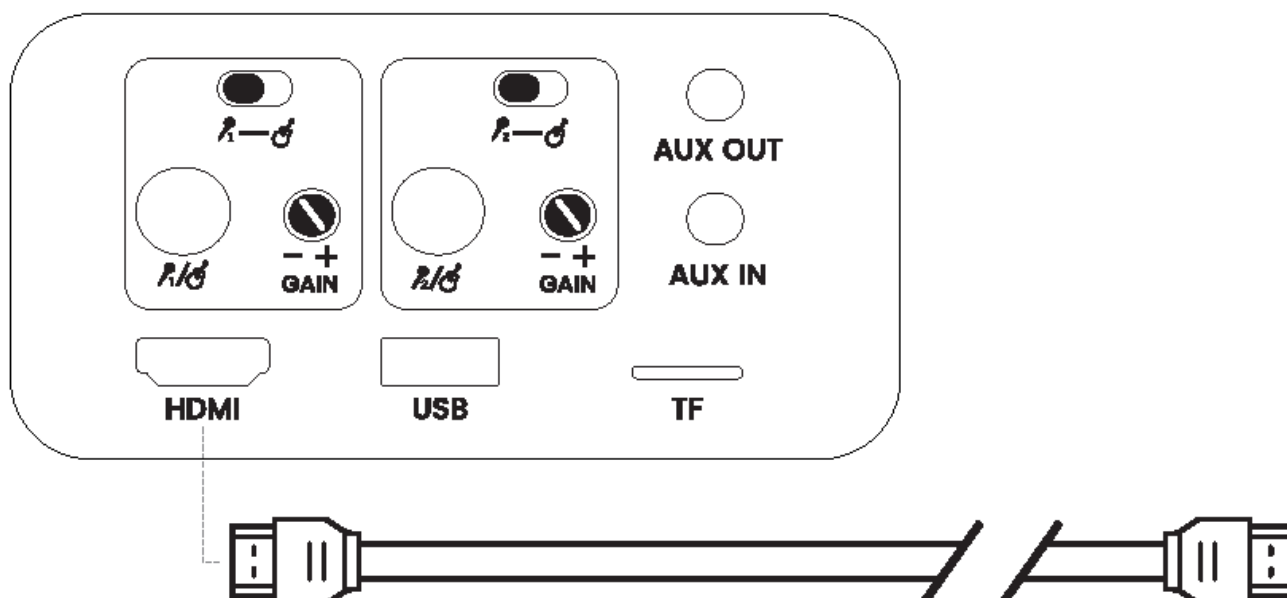

2. Select the HOMI input source to confinn connection

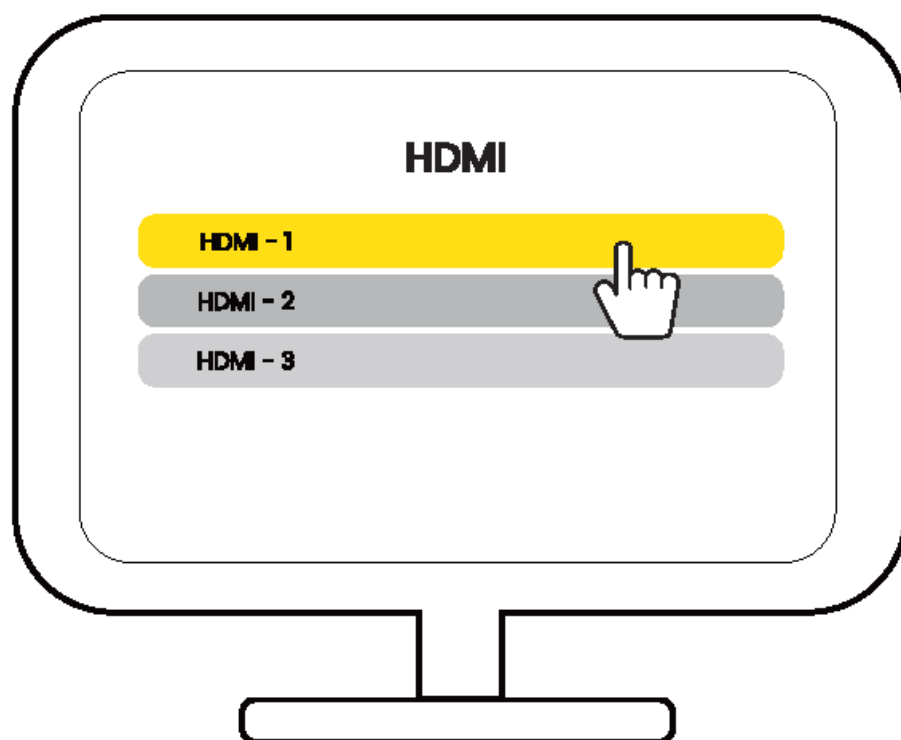

MICROPHONES

1. Hold the power button for 2 seconds to tum on



2. The mic auto-pairs with the speaker



3. Use buttons to switch effects, adjust volume, and play/pause.

NOTE: Don't point the mic at the speaker to avoid interference.

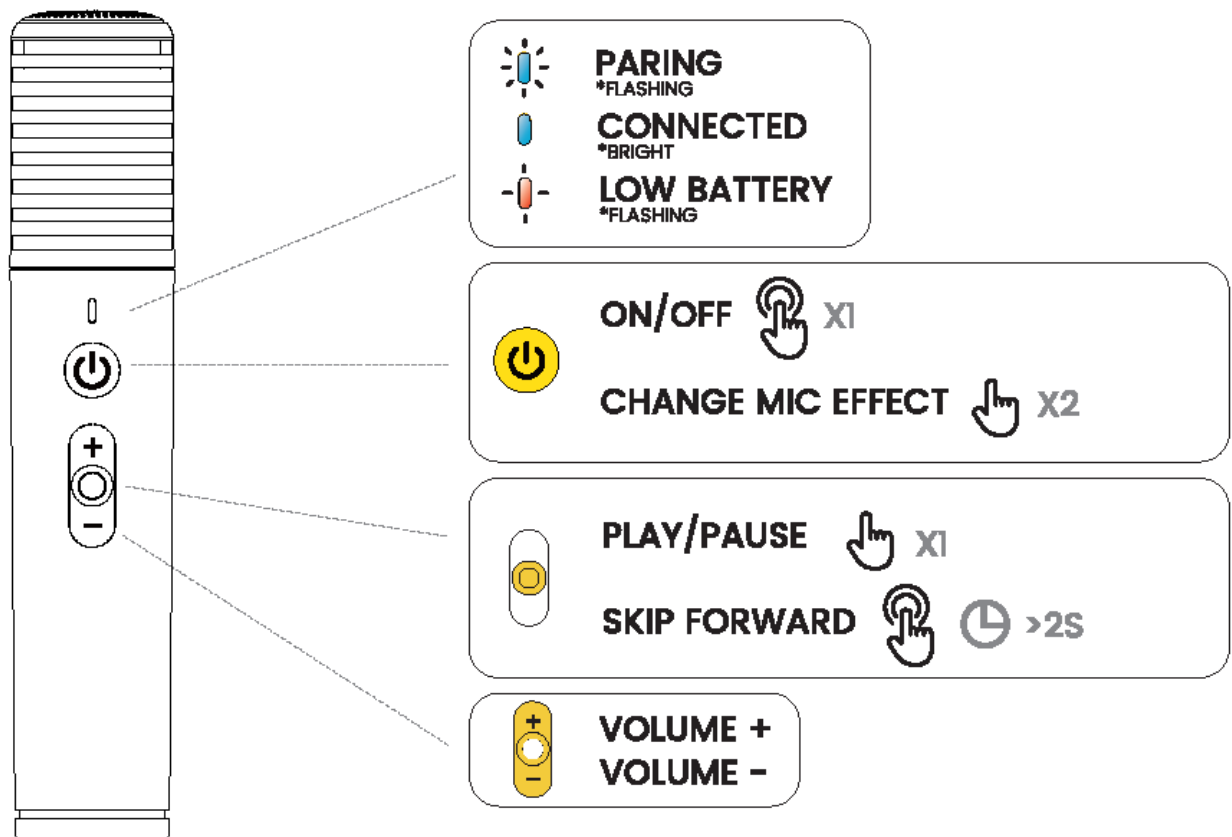

4. Switch microphone sound via speaker buttons or **MUSIC EFFECT** In the software.

5. Click **MIC SETTING** or **CUSTOM** enter custom sound mode and adjust Reverb, Treble, and Bass to your preference.

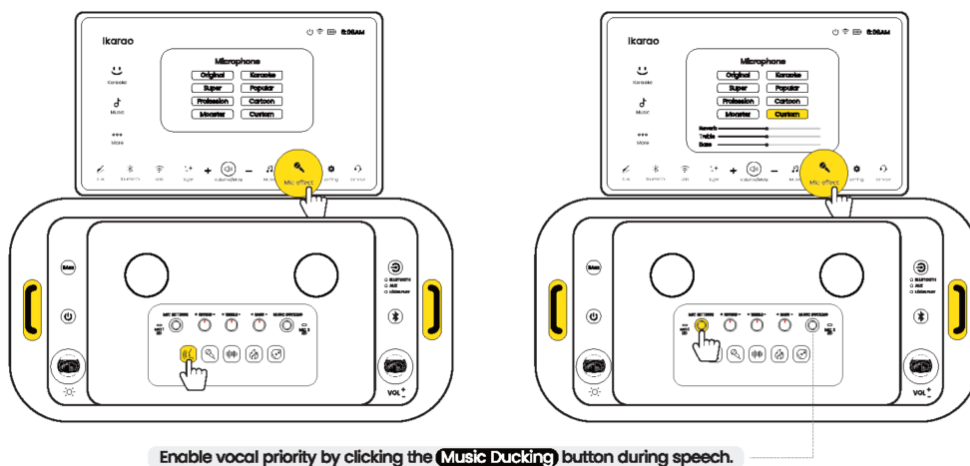

SPEAKER CHARGING

1 Charging with the included power cable.

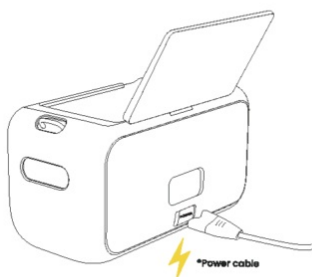

2

- LOW BATTERY
*SLOW FLASHING
- CHARGING
*BREATHING
- FULLY CHARGED
*OFF

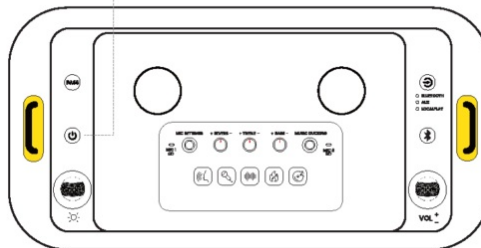

NOTE: The included power cable supports 100V-240V.

MICROPHONES CHARGING

- CHARGING
*BREATHING
- FULLY CHARGED
*OFF

Tap the microphone into the storage to begin charging.

NOTE: Microphone has a 30-hour usage duration with a 5-hour full charge time.

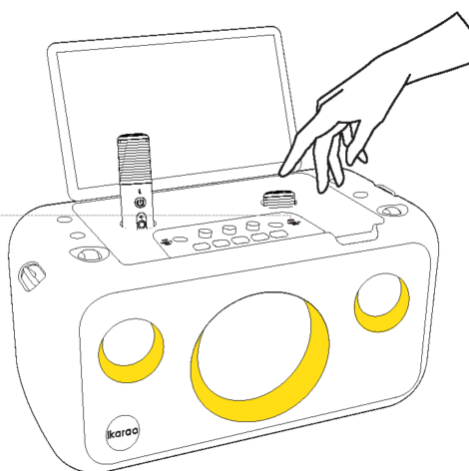

SOFTWARE UPDATE

1 Click **Settings**

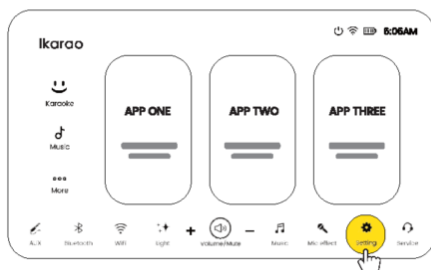

2 Click **Detect New Version** on **About**

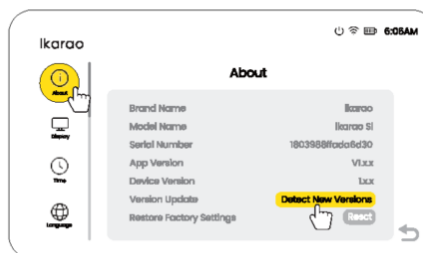

NOTE: Ensure speaker power is above 50% or plugged in.

USER MANUAL

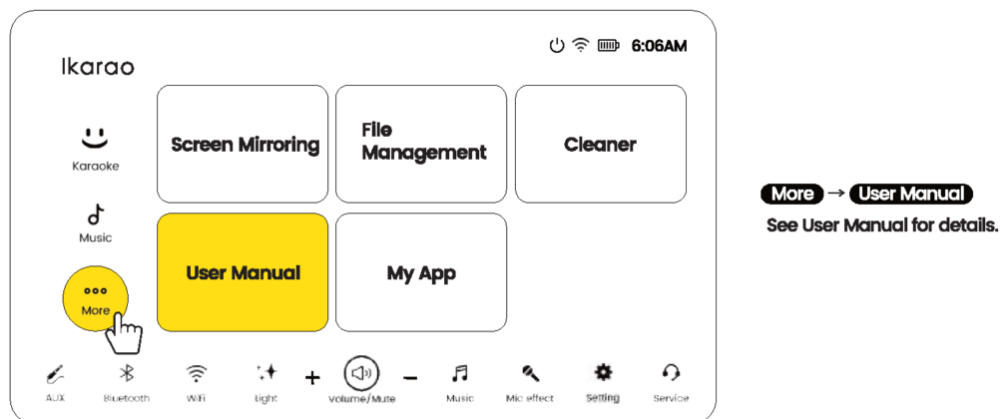

CUSTOM SERVICE

1. Click **SERVICE**

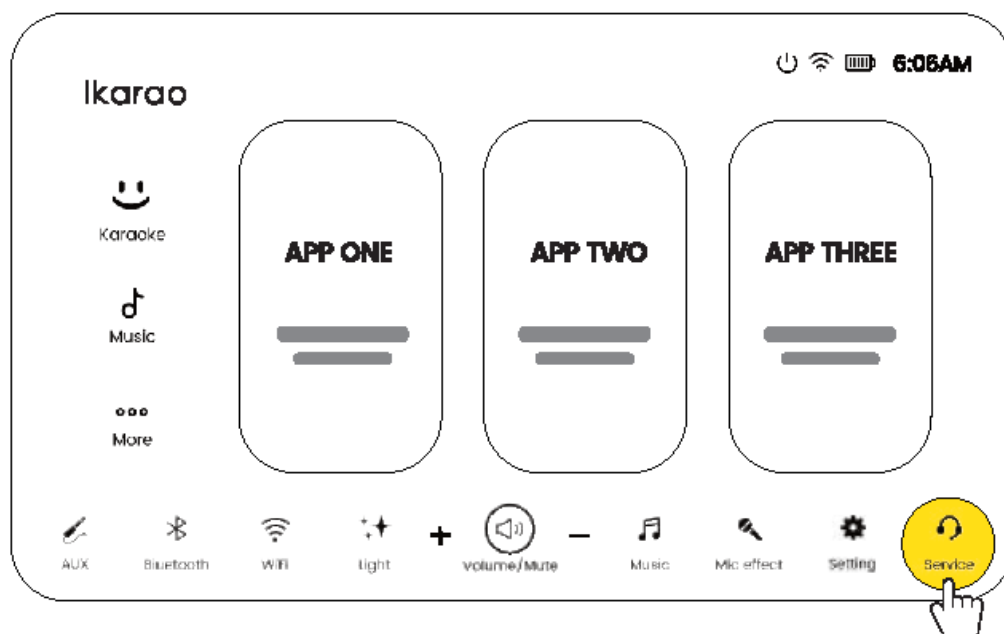

2. Fill in your information

Ikarao Service

If you have any suggestions of this product kindly leave your precious advice here, and your feedback will encourage us improve our product preferably.

way 1:



way 2:

Model Number

Shell 81

Tel

Email

Question or Suggestion

USE CARRYING STRAP

① Take out Carrying Strap

② Buckle up Carrying Strap

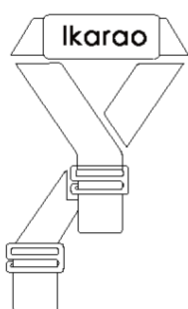

Carrying Strap

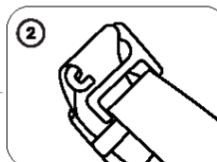
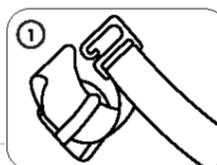
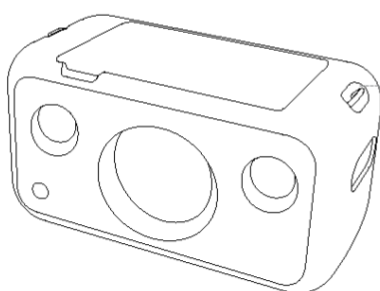

NOTE: Please fasten the strap to ensure your speaker can be carried safely.

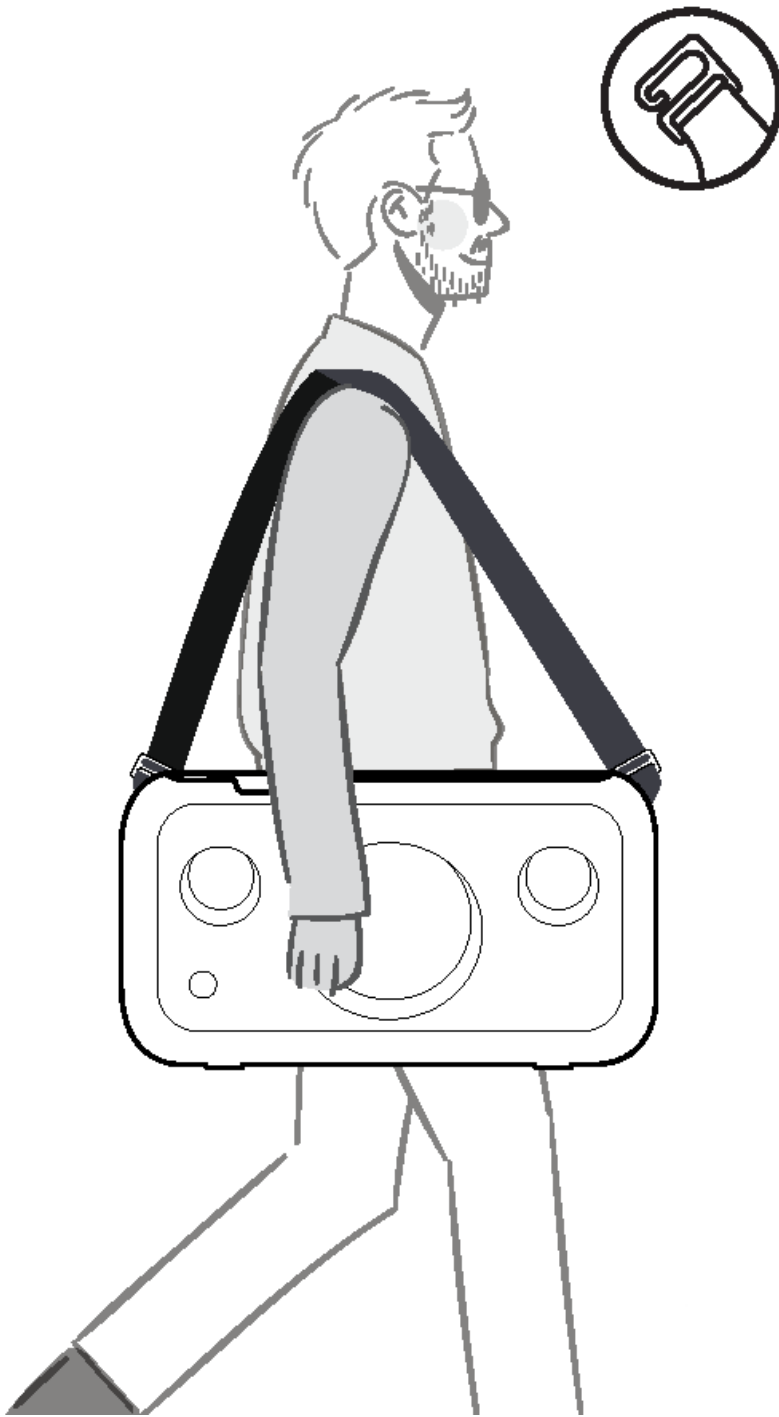

USE SPEAKER TRIPOD STAND

1. Extend the speaker stand and find the 35mm mount hole on the bottom of the Break XI

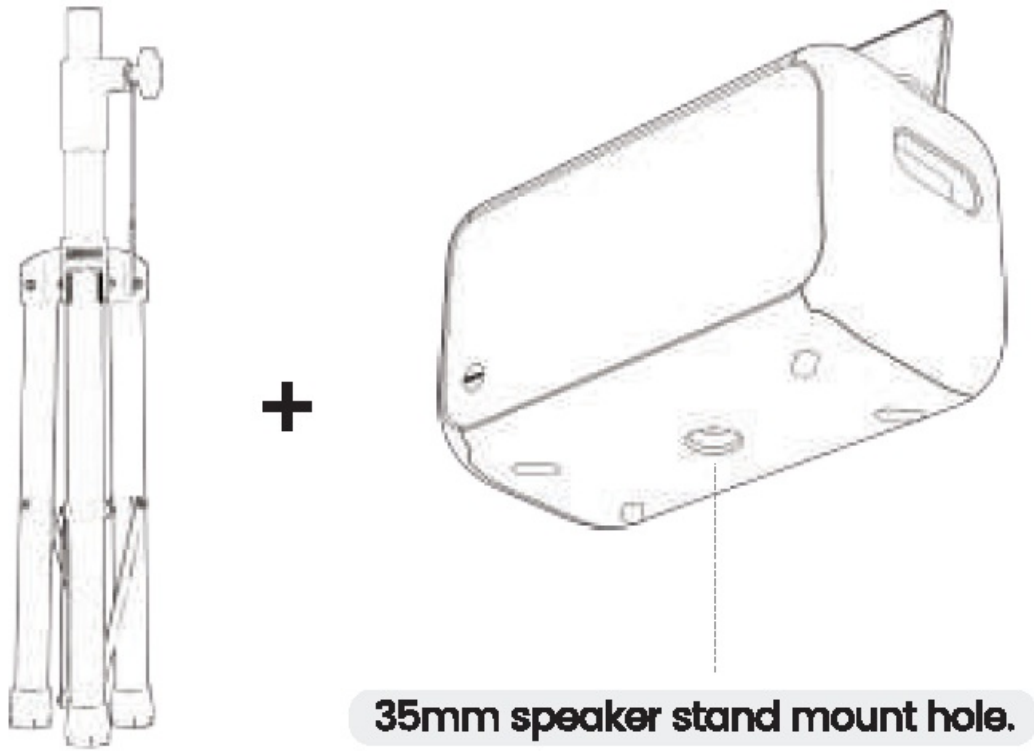

2. Place the speaker securely on the stand. For safety, it is recommended to have two people.

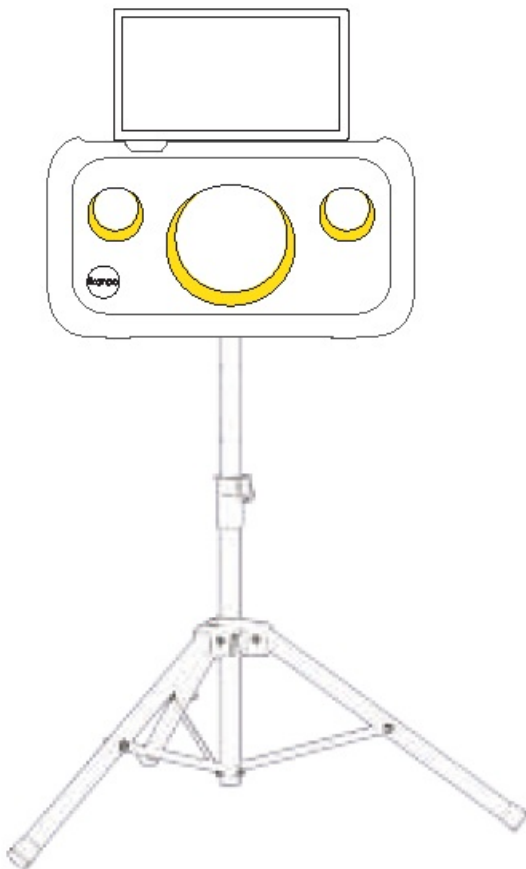

CERTIFICATION AND COMPLIANCE

FCC Statement

This device complies with Part 15 of the FCC Rules. Operation is subject to the following two conditions:

- 1) This device may not cause harmful interference, and
- 2) this device must accept any interference received, including interference that may cause undesired operation.

FCC WARNING

Changes or modifications not expressly approved by the party responsible for compliance could void the users authority to operate this equipment

Radiation Exposure Statement (Only for speaker)

This equipment complies with FCC radiation exposure limits set forth for uncontrolled environment. This equipment should be installed and operated with minimum distance of 20 cm between the radiation & your body.

CE

Dongguan Aiko Electronic Technology Co, Ltd. Declares that this product is in compliance with Directives 2014/53/EU and all other applicable EU directive requirements. The complete declaration of conformity can be found at: www.lkarao.com

BLUETOOTH

The Bluetooth® word mark and logos are registered trademarks owned by Bluetooth SIG, Inc. and any use of such marks by Dongguan Aiko Electronic Technology Co., Ltd. is under license. Other trademarks and trade names are those of their respective owners.



This symbol means the product must not be discarded as household waste, and should be delivered to an appropriate collection facility for recycling. Follow local rules and never dispose of the product and rechargeable batteries with normal household waste. Correct disposal of old products and rechargeable batteries helps prevent negative consequences for the environment and human health.

Complete SAFETY INFORMATION, CERTIFICATION AND COMPLIANCE can be found in the document USER MANUAL located in the system.

Documents / Resources



[Ikarao BREAK X1 Go Speaker](#) [pdf] User Guide

1032, X1 Go Speaker, X1 Speaker, Go Speaker, BREAK X1 Go Speaker, BREAK X1 Speaker, BREAK X1

References

- [User Manual](#)

This website is an independent publication and is neither affiliated with nor endorsed by any of the trademark owners. The "Bluetooth®" word mark and logos are registered trademarks owned by Bluetooth SIG, Inc. The "Wi-Fi®" word mark and logos are registered trademarks owned by the Wi-Fi Alliance. Any use of these marks on this website does not imply any affiliation with or endorsement.