



iiRCADE IRORO1 Game Console User Manual

[Home](#) » [iiRCADE](#) » iiRCADE IRORO1 Game Console User Manual 



iiRcade Game Console User Manual (Ver. 1.0)
IIRCADE, Inc.

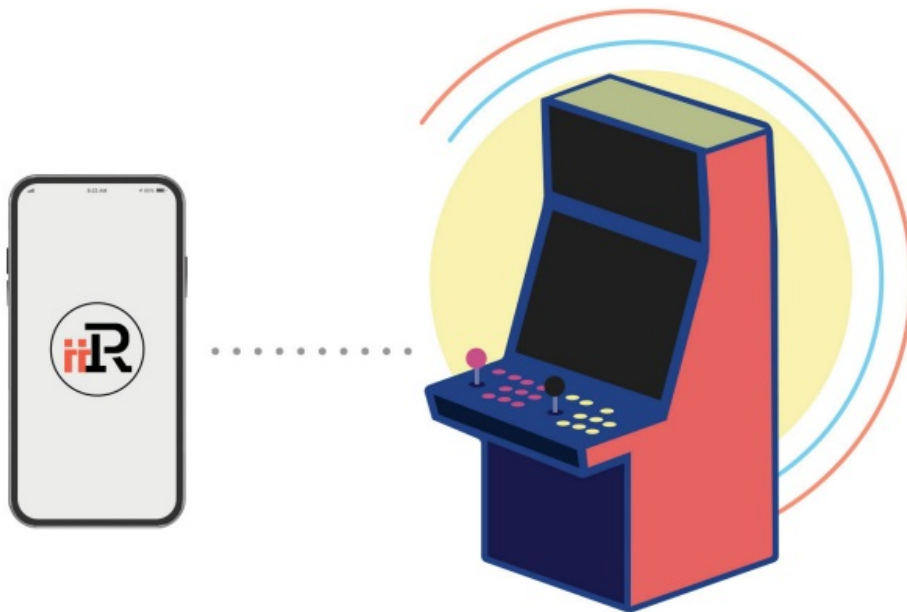

Contents

- [1 Information](#)
- [2 Specification](#)
- [3 Block Diagram](#)
 - [3.1 iiRcade Mainboard configuration](#)
 - [3.2 iiRcade Audio board configuration](#)
- [4 System Components](#)
- [5 System's Main Menu Screen](#)
- [6 Operation setting](#)
- [7 Game Purchase – iiRcade Store](#)
- [8 Documents / Resources](#)
- [9 Related Posts](#)

Information

iiRcade Game console, IROR01-128C190GA, is the ultimate connected arcade machine that allows gamers of all ages to own and play their favorite retro arcade games and modern games in the true arcade style at home, iiRcade will be the ultimate home arcade machine providing gamers with their favorite officially licensed modern and retro games.

Unlike other arcade devices, iiRcade is not limited to just a few pre-loaded games, new games can be purchased and downloaded through the iiRcade online game store. Featuring a 19-inch display, 100-watts of powerful stereo audio with authentic arcade controllers, and a premium wood cabinet.

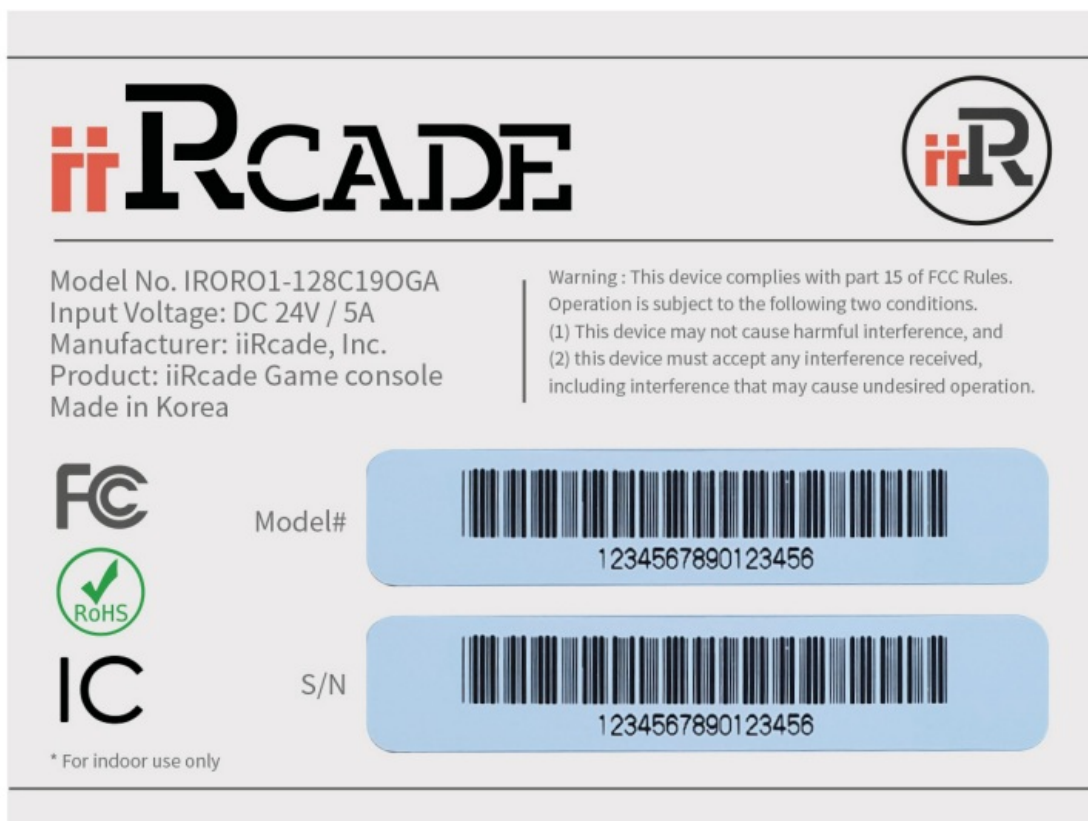

Specification

iiRcade Game Console – **IROR01-128C190GA**

System Performance	
Processor	Rockchip RK3399
OS	Android 9.0
Memory	LPDDR4 4GB, eMMC 64 / 128GB
Display	19" TFT LCD (1280 x 1024)
Wireless Interface	2.4/5GHz Dual-band WiFi, Bluetooth 4.2
I/O Port	3.5mm Audio out, HDMI
Speaker	50w x 2
Keyboard	Joysticks & Buttons

Physical	
Dimension	L510 x W550 x H625
Power	Adapter 24V/5A
Temperature	Storage:-40°C-60°C, Working: 0°C – 60°C
Relative Humidity	[0 – 95%

Block Diagram

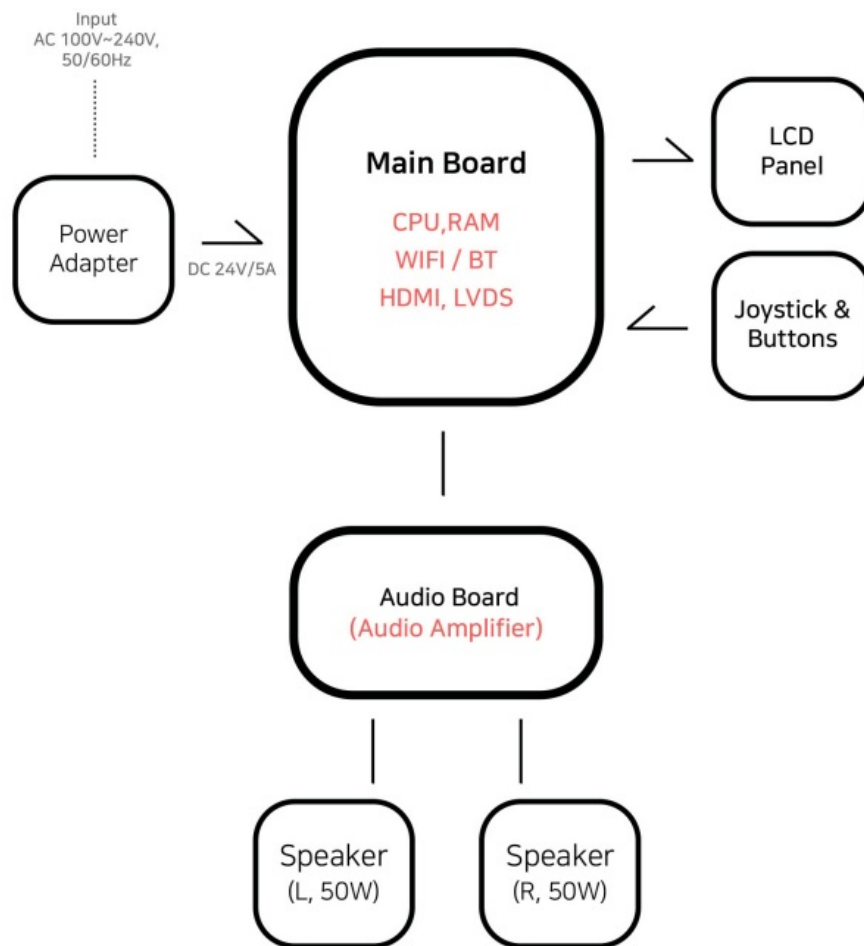

iiRcade Mainboard configuration

Power Connector (DC)

Main Processor
(1.8GHz Hexa-Core CPU)

DRAM
(LP DDR4 4GB)

EMMC
(64GB/128GB)

Joystic Button Connector

WiFi/BT Module
(2.4/5.0GHz)

HDMI Connector

LCD Module connector

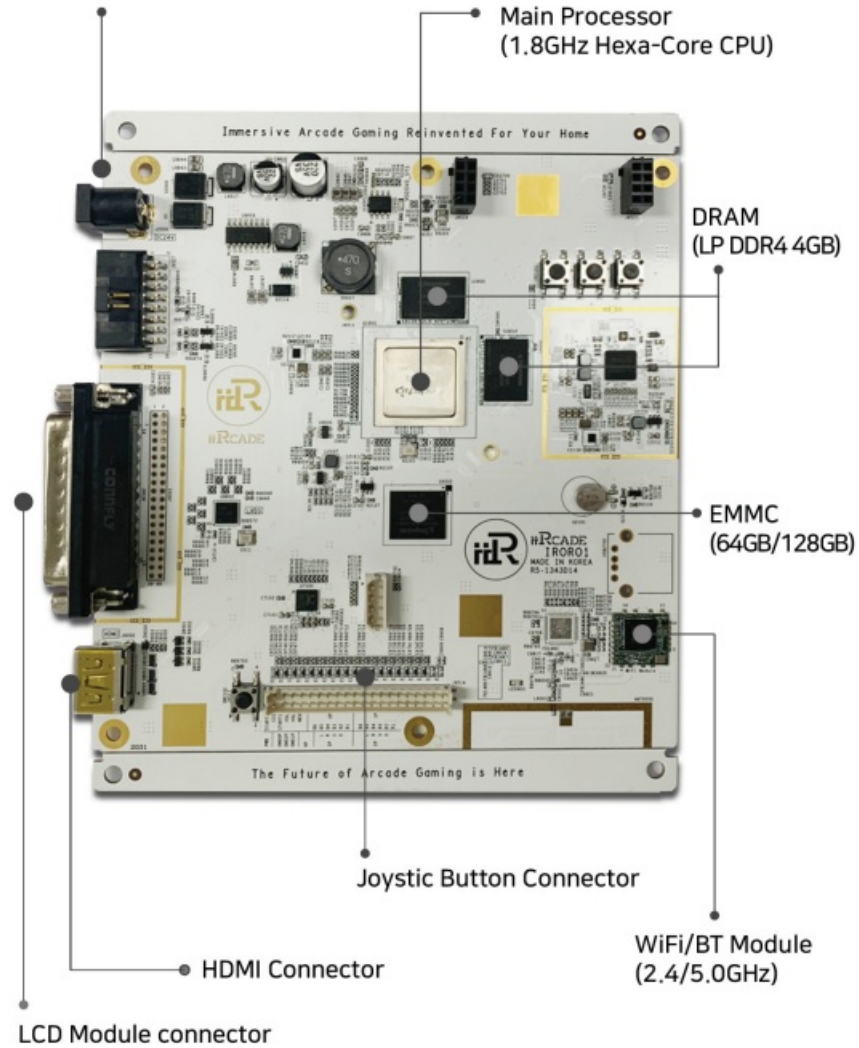

iiRcade Audio board configuration

Speaker Connector (L)

Speaker Connector (R)

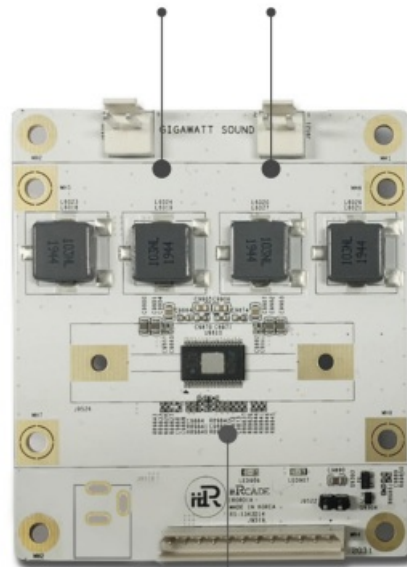

Power and I/O connector

Audio Amp Chip

System Components



System's Main Menu Screen

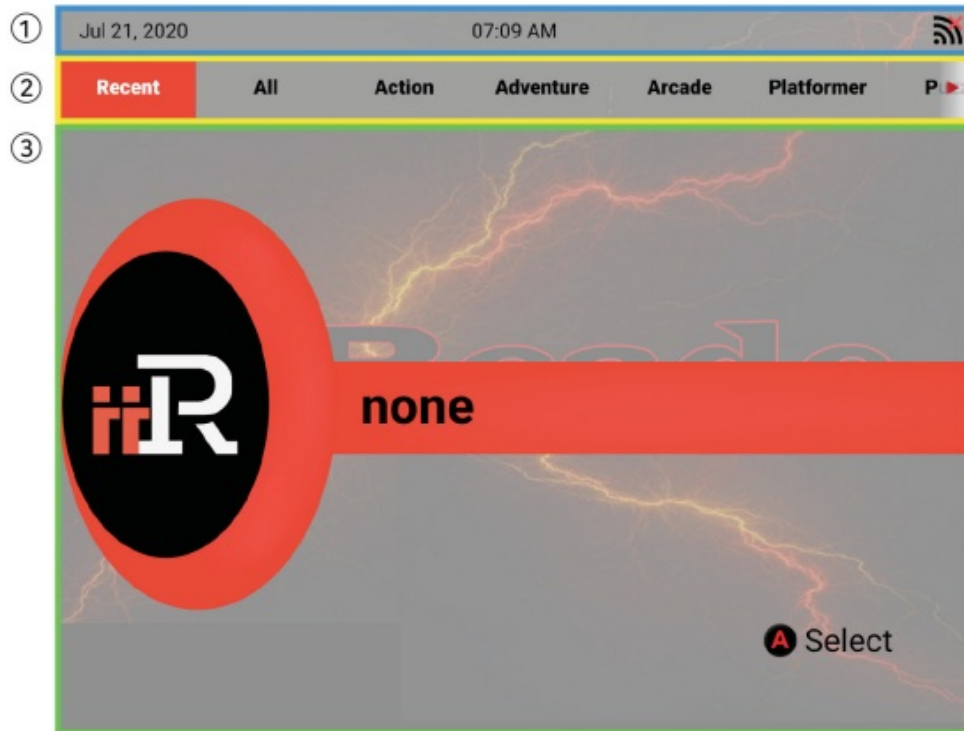

- ① **System Status Display** : Displays date, time, and Wi-Fi connection status.
- ② **Game Genre Selection Tabs** : Displays Recent games tab, All games tab, Game Genre tab, Settings tab.
- ③ **Content Area** : Displays contents of selected tab.

Operation setting

*Joystic Keyboard module

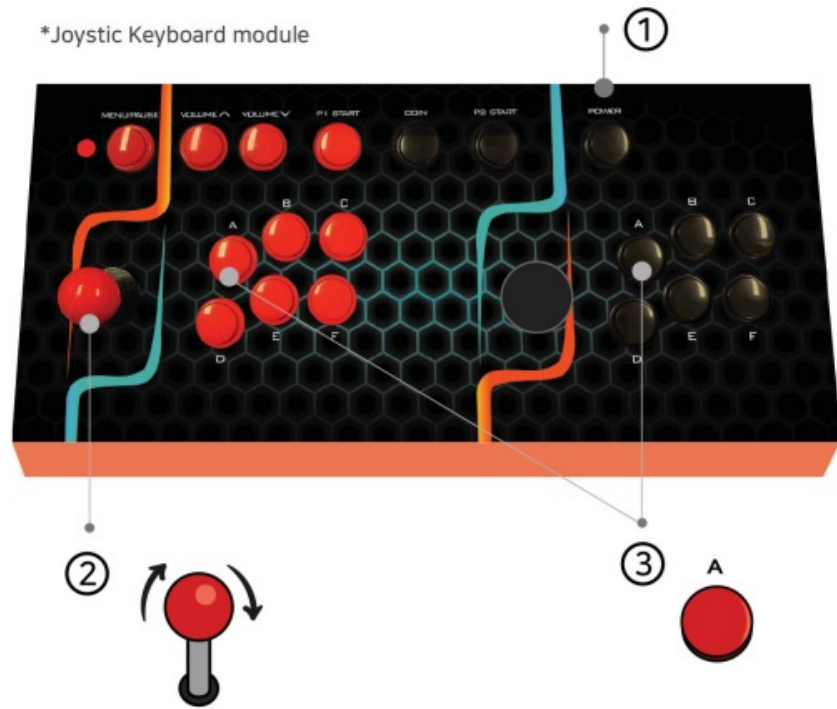

*Game Genre Selection Tabs

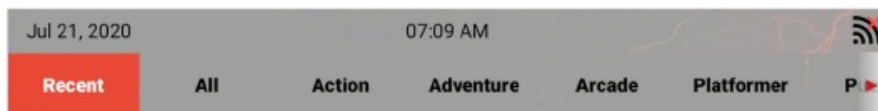

- ① Power button : press for 3 seconds to turn system power on or off.
- ② Use joystick to move through game genre tabs to select a desired genre tab.
- ③ Push button A to enter into the selected game genre tab.

Game Purchase – iiRcade Store

*game download

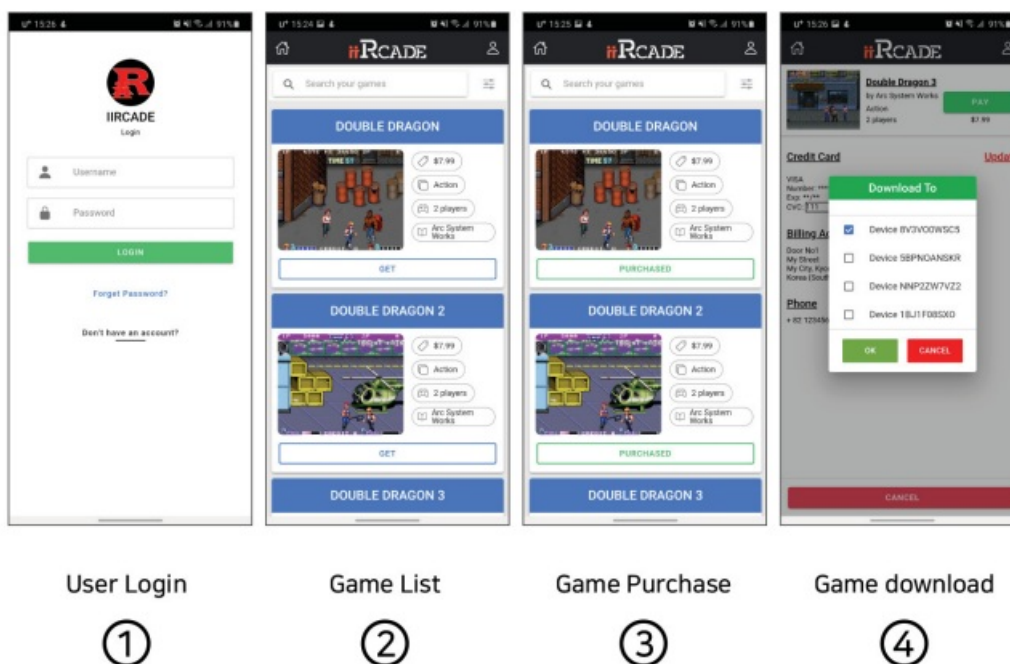

1. Log into a user account.
2. Search game list.
3. Purchase a game.
4. Download the purchased game.

* You can play with iiRcade Game Console.



This device complies with the following conditions:

- (1) This device must not cause harmful interference.
- (2) This device must accept any interference, including interference that may cause undesired operation.

NOTE: THE GRANTEE IS NOT RESPONSIBLE FOR ANY CHANGES OR MODIFICATIONS NOT EXPRESSLY APPROVED BY THE PARTY RESPONSIBLE FOR COMPLIANCE. SUCH MODIFICATIONS COULD VOID THE USER'S AUTHORITY TO OPERATE THE EQUIPMENT.

NOTE: This equipment has been tested and found to comply with the limits for a Class B digital device, pursuant to part 15 of the FCC Rules.

These limits are designed to provide reasonable protection against harmful interference in a residential installation. This equipment generates uses and can radiate radio frequency energy and, if not installed and used in accordance with the instructions, may cause harmful interference to radio communications. However, there is no guarantee that interference will not occur in a particular installation.

If this equipment does cause harmful interference to radio or television reception, which can be determined by turning the equipment off and on, the user is encouraged to try to correct the interference by one or more of the following measures:

- Reorient or relocate the receiving antenna.

- Increase the separation between the equipment and receiver.
- Connect the equipment into an outlet on a circuit different from that to which the receiver is connected.
- Consult the dealer or an experienced radio/TV technician for help.

RF Exposure Statement:

This equipment complies with the FCC RF radiation exposure limits set forth for an uncontrolled environment. This equipment should be installed and operated with a minimum distance of 20cm between the radiator and any part of your body.



www.iircade.com

Company Name	IIRCADE, INC.
KOREA	338 GwanggyoJungang-Ro, Suji-Gu, Yongin-Si, Gyeonggi-Do, 16942, Rep. of KOREA Te1.82 541
USA	5250 Old Orchard Rd Suite 300 Skokie, IL 60077 USA
Home page	www.iircade.com

Release Date: Nov. 01. 2019
Document name: GS_CKHSX10
V1.0

Documents / Resources

The image shows the cover of the iiRcade Game Console User Manual (Ver. 1.0). It features the iiRcade logo and a stylized illustration of the game console.	<p>iiRCADE IRORO1 Game Console [pdf] User Manual IRORO1, 2AXRR-IRORO1, 2AXRRIRORO1, IRORO1 Game Console, Game Console</p>
---	---