



iGear DL MBL01 Portable Mini Blender Instruction Manual

[Home](#) » [iGear](#) » iGear DL MBL01 Portable Mini Blender Instruction Manual 

iGear DL MBL01 Portable Mini Blender Instruction Manual



Contents

- 1 Description of parts
- 2 Specifications
- 3 Circuit diagram
- 4 Important safety information
- 5 Interactions for use
- 6 Clean, storage and maintenance
- 7 Troubleshooting
- 8 Documents / Resources
- 9 Related Posts

Description of parts

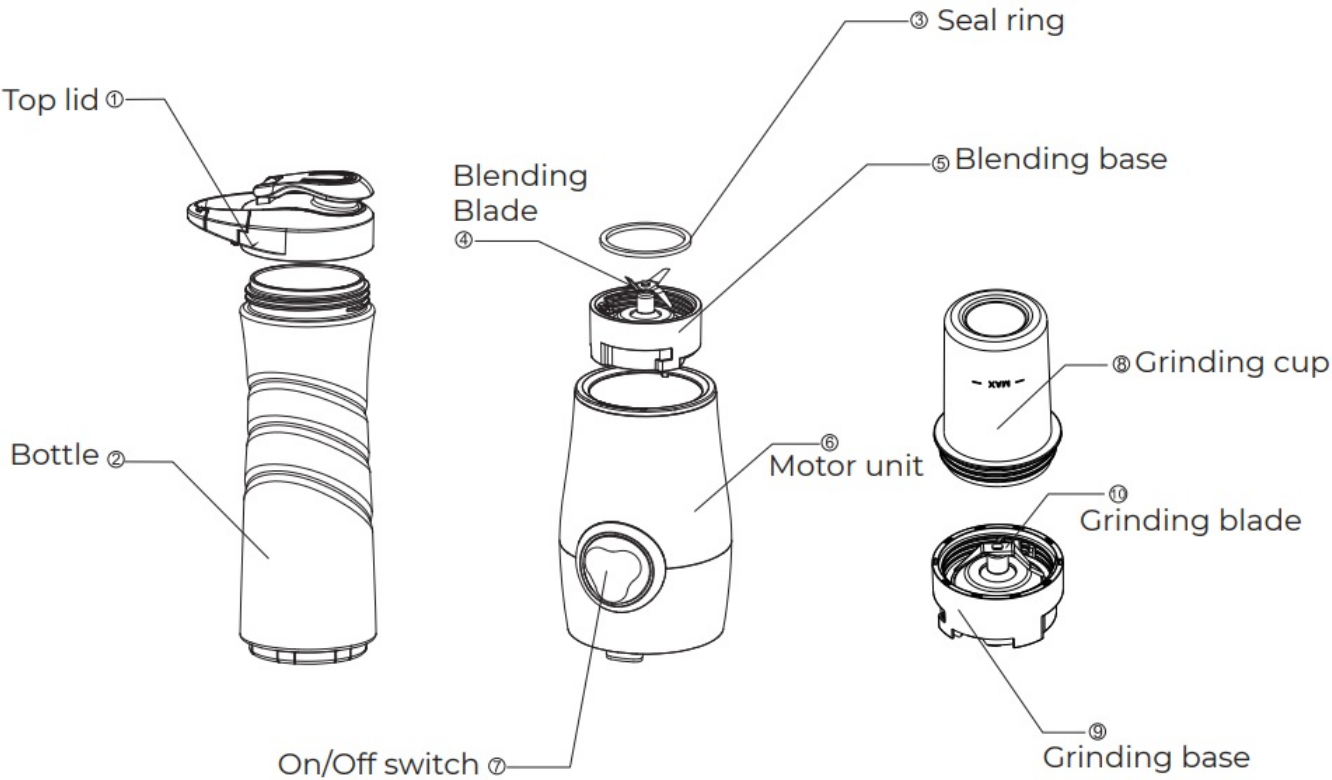

Specifications

Model Number	DL-MBL01	Rated Voltage	220-240V~
Rated Power	300W	Rated Frequency	50/60Hz
Bottle Capacity	500ml	Grinding Jug capacity	40g
Rated Blending time	≤60s	Rated Grinding time	≤50s
Intermittent time	≥60s		

Circuit diagram

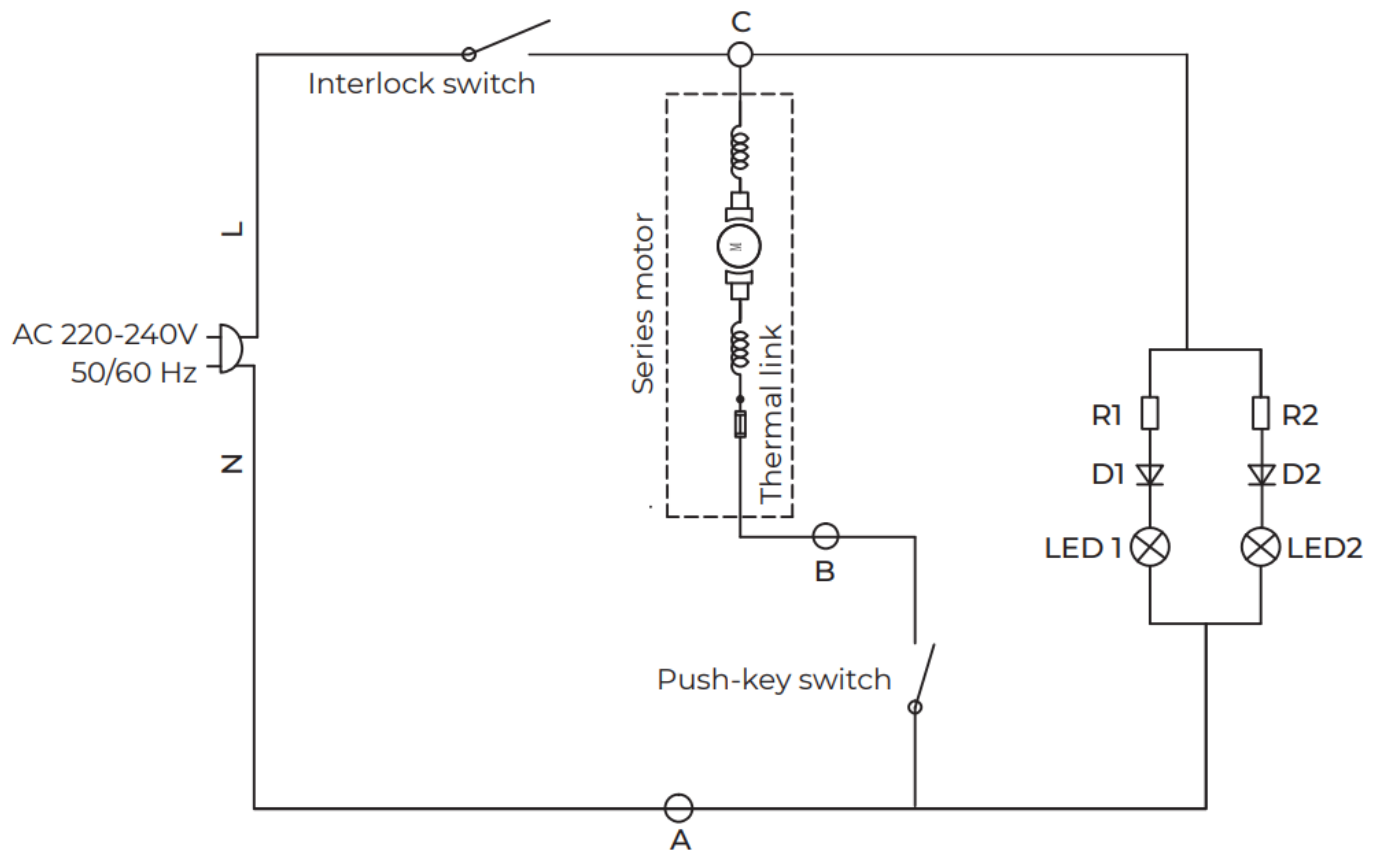

Important safety information

1. This appliance is intended for domestic use only.
2. Read all instruction before using the appliance for the first time and keep it well for future reference.
3. Do not switch on when the bottle is empty or over-loaded.
4. Check that voltage indicated on the rating plate corresponds with that of the local network before connecting the appliance to the mains power supply.
5. Keep the appliance and its power cord away from Sharp edges or moving parts that could cause damage.
6. Do not use other accessories that not supplied with this appliance.
7. Do not operate the blender with damaged power cord or plug, after the appliance malfunction, or if it is dropped or damaged in any manner. Return the appliance to the nearest authorized dealer or after-sales service centre for examination, repair, electrical or mechanical adjustment.
8. Make sure that bottle is well rotated to blending base and correctly fixed on motor unit. Do not leave blending base along on motor unit that could cause injury.
9. Ensure bottle is fitted completely with blending base, in avoid of leakage or blending base fall off.
10. The ingredients do not exceed the maximum fill mark.
11. If it could not work please contact with our after-sales service centre per Email, do not disassemble by yourself.
(support@hommini.com)
12. If blades stuck, switch off and unplug blender and clean up the blocks. After motor base cool down then use it again.
13. This appliance is not intended for use by persons (including children) with reduced physical, sensory or mental capabilities, or lack of experience and knowledge, unless they have been given supervision or interaction concerning use of the appliance by a person responsible for their safety.
14. Disconnect the blender to main power supply when cleaning and assembly.

15. Be careful of sharp blade when cleaning and operation.
16. After use, clean the blender timely and keep it dry.
17. When using the blender for the first time, a slight odour may be emitted. This is normal and will soon subside.
18. Do not immerse accessories into hot water that over 60°C and use microwave for disinfection, in avoid of temperature distortion.

Interactions for use

Carefully unpack the blender and accessories remove all packaging materials. Wash the bottle, lid, blending base, seal ring with detergent and wash it again with clean water and dry it. Wipe the motor base with a damp cloth.

- As the graphics show
 - The size of blending food should be 1.5* 1.5* 1.5cm
 - The selection of blending time:
 - Liquid food: 30s
 - Hard food: 60s
 - Continuously blending time do not over 1 minute
 - Grinding time: between 15~50s, do not grind very hard food
 - Special attention:
 - If the blade can not cut or touch to the food when grinding, please switch off and disassemble the grinding cup, then shake the cup before put it onto the motor house.
 - The blender must stop completely before you disassemble the grinding cup.
1. Place the blender onto stable and flat surface, keep away from impacting from other things and reach of children.
 2. Roughly cut food into small pieces 1.5* 1.5* 1.5cm. Put all ingredients into bottle and pour proper liquid. (The recommended ratio of liqui to food is 3:2) Rotate bottle tightly to lending base.

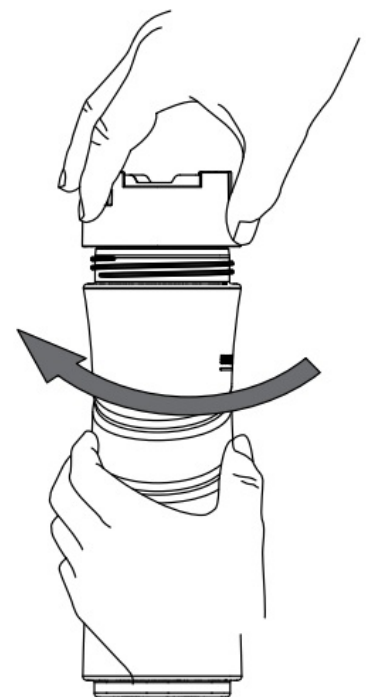
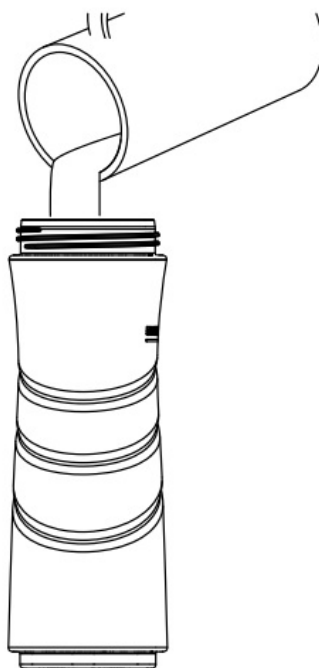
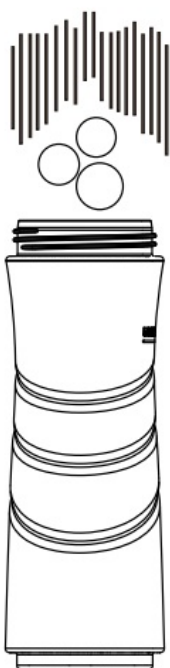

3. Make this symbol “▼” of blending base rightly about this symbol “” of motor unit and press down bottle,

rotate in a clockwise direction to symbol“”.

Plug in and press on knob switch, the appliance gets to work. Release the switch then blender stop working.

Notes: The appliance is fitted with safety protection. Ensure install correctly, otherwise it won't work when switch on.

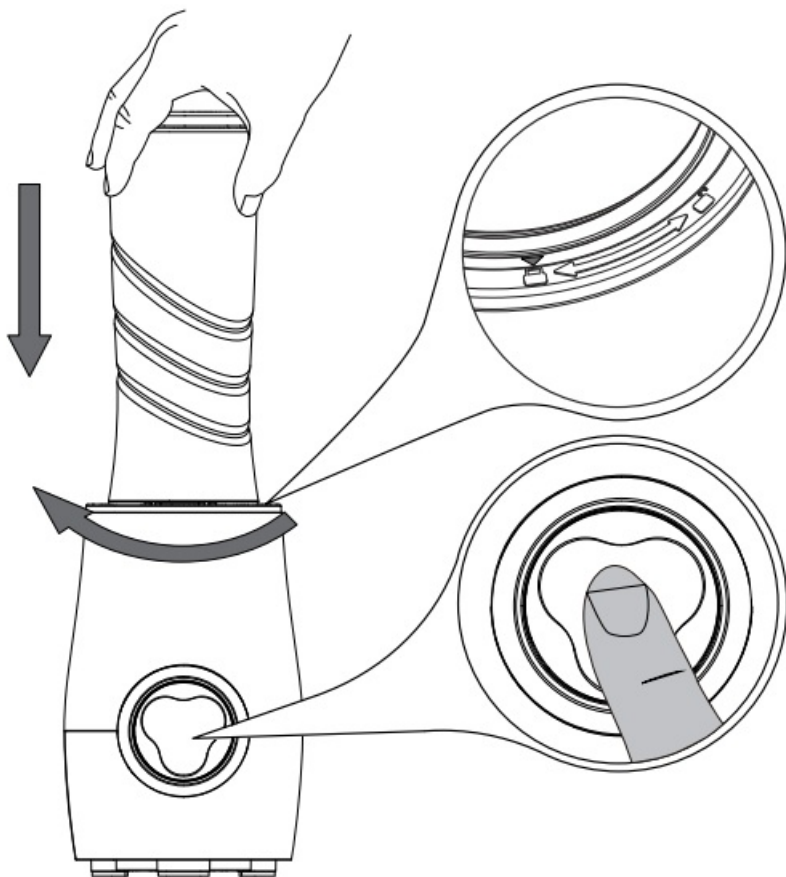

4. After blending Ingredients to desired this effect, release the switch, unplug the

unit from the outlet. Press down bottle, rotate in anticlockwise direction to symbol “” and take up bottle. Invert bottle blending base upwards, anticlockwise rotate blending base to pour juice into container. To go out, please cover bottle with lid.

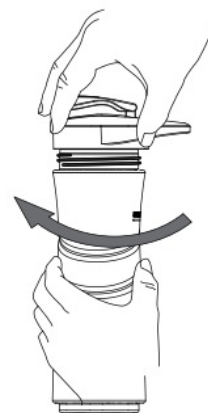
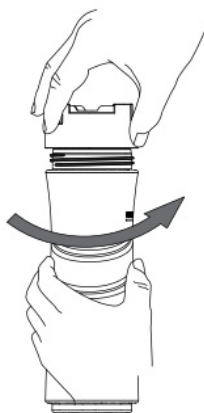
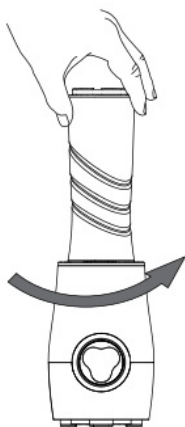

5. Put the dry food into the grinding jug and install it on the grinding base as photo.

Locked the grinding jug with base on the motor unit and then insert the plug. Switch on the power, the grinder will running and switch off the power will stop work. It just need grinding 15s to 50s, do not put very hard food into grinder.

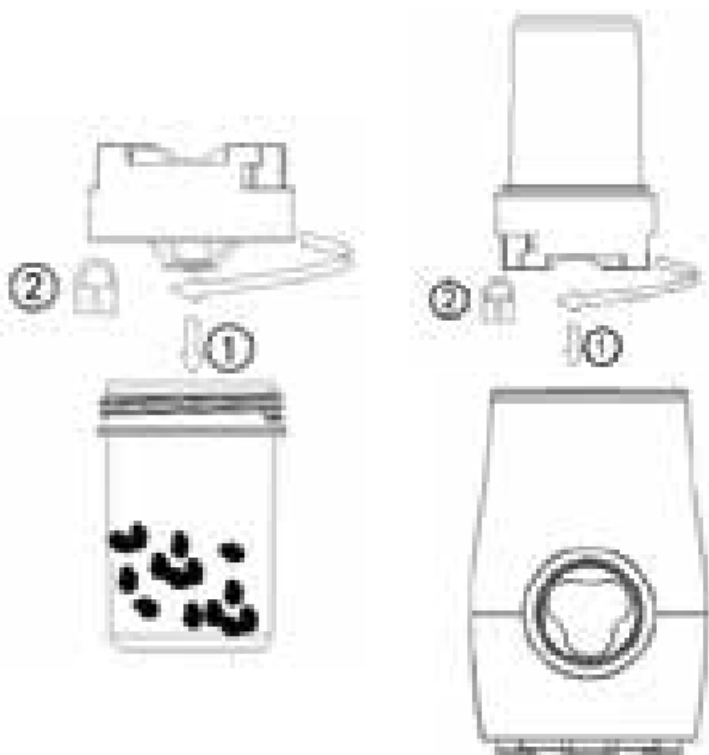

Clean, storage and maintenance

After use, unplug the appliance from the mains outlet and wait for the blade to come to a complete halt before removing the bottle from the base.

Wash all of the parts, except the power base unit in warm, soapy water, then rinse and dry thoroughly.

Wipe the base unit with a soft, damp cloth and allow dry thoroughly. Particular care must be taken when cleaning the blade because it is very sharp.

The blender should be cleaned after each use and keep it dry for next use.

Warning:

Never immerse the base unit in water or any other liquid.

Do not use stainless steel scrubber, abrasive detergent or corrosive liquids (such as alcohol, gasoline or acetone) to clean the appliance.

Troubleshooting

Symptom	Possible Cause	Solution
The blender will not operate.	The bottle is not rotated well to the motor base.	Rotate bottle correctly to the motor base .

In the first few times of use, there is a slight odour emitted.	This is normal and will soon subside.	After use it for a period time, the smell still exist, please send it to after-service centre for repair.
The appliance stops working during use.	<ol style="list-style-type: none"> 1. A reduction in electric power. 2. Motor over-heating protection affects. 	<ol style="list-style-type: none"> 1. Check if main power supply is too low. 2. Stop it for 20-30m then use again.
The blender has vibration excessively or big noise during use.	<ol style="list-style-type: none"> 1. Bottle is not rotated well with blending base. 2. The blender base unit is imbalance or rubber foot peel off. 3. Over high Voltage 4. There are too many ingredients in the bottle. 	<ol style="list-style-type: none"> 1. Rotate bottle correctly with blending base. 2. Place the appliance onto a flat, stable surface. Rubber foot are fixed in the right place. 3. Check if voltage too high. 4. Switch off and unplug appliance, reduce ingredients, ensure that do not exceed the maximum fill mark.
The blade is stuck.	The ingredients used are too thick and heavy.	Disconnect to the main power supply, remove the bottle and cut food into smaller pieces.
The bottle is leaking.	<ol style="list-style-type: none"> 1. Bottle is not rotated well with blending base. 2. The bottle is broken. 3. Seal ring is not fixed or damaged. 	<ol style="list-style-type: none"> 1. Rotate bottle correctly with blending base. 2. Change a new bottle. 3. Fix or replace new seal ring.



Documents / Resources

 A product image of the iGear Slender Blender, a portable mini blender with a white base and a blue lid. The text 'Slender Blender' and 'Portable Mini Blender' is visible on the image.	<p>iGear DL MBL01 Portable Mini Blender [pdf] Instruction Manual DL MBL01 Portable Mini Blender, DL MBL01, Portable Mini Blender</p>
---	--

Manuals+