



IFYOO-KMAX2-WL Wireless Keyboard and Mouse Combo User Manual

[Home](#) » [iFYOO](#) » IFYOO-KMAX2-WL Wireless Keyboard and Mouse Combo User Manual 

IFYOO-KMAX2-WL Wireless Keyboard and Mouse Combo User Manual



Contents

- [1 Package Contents](#)
- [2 Safety Instructions](#)
- [3 Connect to PS4 via 2.4GHz Receiver](#)
- [4 Connect to Xbox via 2.4GHz Receiver](#)
- [5 Connect to SWITCH via 2.4GHz Receiver](#)
- [6 Connect to PC via 2.4GHz Receiver](#)
- [7 Keyboard Shortcut and Reset](#)
- [8 Power Saving Mode and Hibernation](#)
- [9 Charging the keyboard and Mouse](#)
- [10 Product Specification](#)
- [11 WARRANTY & SUPPORT](#)
- [12 FCC Statement](#)
- [13 Documents / Resources](#)
- [14 Related Posts](#)

Package Contents

- 11x Gaming Keyboard,
- 1x Gaming Mouse,
- 1x 2.4GHz Receiver,
- 1x User Manual,
- 1x Micro USB charge & syne cable

Safety Instructions

Warning: This product contains small parts, please do not swallow. Children must use this product under adult supervision.

Recommended age for user: over 12.

Product Overview

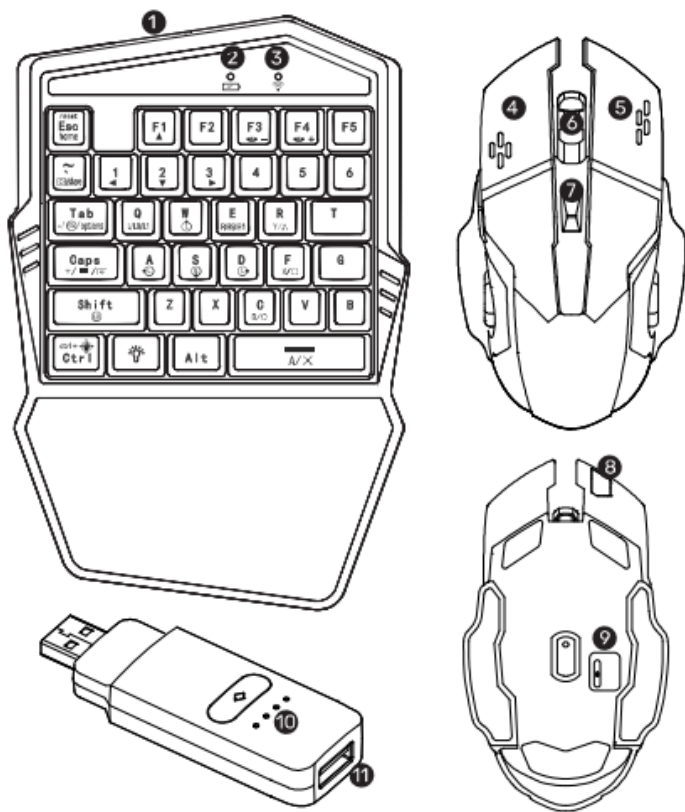

1. Keyboard Micro USB Charging Port
2. Battery indicator Light 

When it flashes charge it immediately
3. Connection indicator Light 
4. R2/RT/ZR/left button
5. L2/LT/2L/Right Button
6. R3/R/R3/Middle Button

When blue light flashes, charge it immediately
7. DPI Button
8. Micro USB charging Port
9. House Power Switch

OFF > ON (RGB) >ON (Lights OF, save power)
10. 2.4GHz Receiver indicator Light

1 2 3
11. 2.4GHz Receiver USB Port

Connect with official PS4, Xbox One controller



Please fully charge the keyboard and mouse before using it for the first time.

Connect to PS4 via 2.4GHz Receiver

Installation

1. Plug the 2.4GHz receiver into the USB port of your PS4. the **1 2 4** indicator light on the receiver will light up.
2. Power off your PS4 official controller and connect it to the 2.4GHz receiver with a charge & sync cable. The **3**

indicator light on the receiver will light up.

3. Power on the mouse, wait for it to auto pair and connect to the 2.4GHz receiver.
4. Pair the keyboard with the 2.4Ghz Receiver when using it for the first time. Long press “**ESC**” + “**Q**” for 3 seconds, the connection indicator light  will flash slowly, after the keyboard successfully connected, the indicator light  will stay on. Now it is ready to use.
5. when you use it next time. just press any key on the keyboard. it'll auto reconnect.

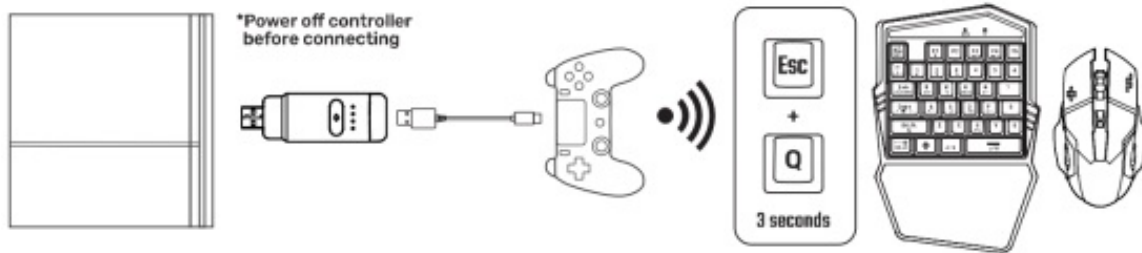

Note

1. Charge only cable and Third-Party controllers do not work with the keyboard.
2. If the keyboard and mouse do not work, please check the battery status of the keyboard & mouse and try to reconnect it again.



Connect to Xbox via 2.4GHz Receiver

Installation

1. Plug the 2.40Hz receiver into the USB port of your PS4. the **1 2 4** indicator light on the receiver will light up.
2. Power off your PS4 official controller and connect it to the 2.40Hz receiver with a charge & sync cable. The **3** indicator light on the receiver will light up.
3. Power on the mouse, wait for it to auto pair and connect to the 2.4GHz receiver.
4. Pair the keyboard with the 2.4Ghz Receiver when using it for the first time. Long press “**ESC**” + “**Q**” for 3 seconds, the connection indicator light  will flash slowly, after the keyboard successfully connected, the indicator light  will stay on. Now it is ready to use.
5. when you use it next time. just press any key on the keyboard. it'll auto reconnect.



Note

1. Charge only cable and Third-Party controllers do not work with the keyboard.
2. If the keyboard and mouse do not work, please check the battery status of the keyboard & mouse and try to reconnect it again.



Connect to SWITCH via 2.4GHz Receiver

Installation

1. Turn on your Switch and go to “Settings” — “Controllers and Sensors” —“PRO Controller Wired Communication”—click ON.
2. Plug the 2.4GHz receiver into the USB port of your SWITCH, the **1 2 4** indicator light on the receiver will light up.
3. Power on the mouse, wait for it to auto pair and connect to the 2.4GHz receiver.
4. Pair the keyboard with the 2.4Ghz Receiver when using it for the first time. Long press “**ESC**” + “**Q**” for 3 seconds, the connection indicator light  will Hash slowly, after the keyboard successfully connected, the indicator light  will stay on. Now it is ready to use.
5. when you use it next time, just press any key on the keyboard, it'll auto reconnect.

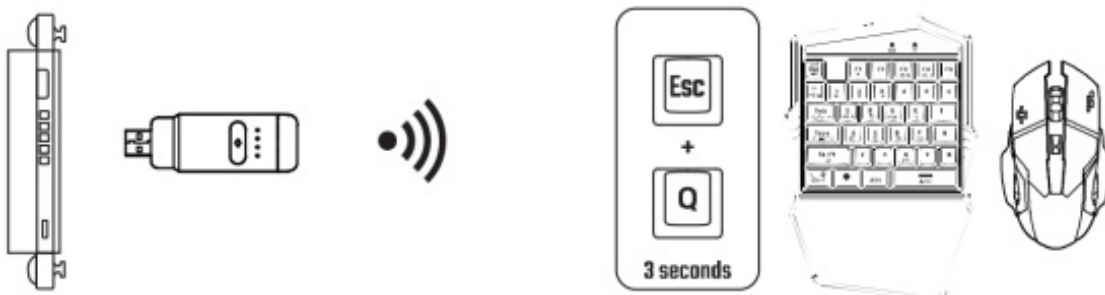

Note

1. You must turn on the “PRO Controller Wired Communication” .
2. If the keyboard and mouse do not work, please check the battery status of the keyboard & mouse and try to reconnect it again.



Connect to PC via 2.40Hz Receiver

Installation

1. Plug the 2.4GHz receiver into the USB port of your PC, the **1 2 4** indicator light on the receiver will light up.
2. Power on the mouse. wait for it to auto pair and connect to the 2.4GHz receiver.
3. Pair the keyboard with the 2.4Ghz Receiver when using it for the first time. Long press “**ESC**” + “**Q**” for 3 seconds, the connection indicator light  will flash slowly, after the keyboard successfully connected, the indicator light  will stay on. Now it is ready to use.
4. when you use it next time, just press any key on the keyboard, it'll auto reconnect.

Note

1. the keyboard and mouse do not work, please check the power statue of the keyboard & mouse and try to reconnect it again.

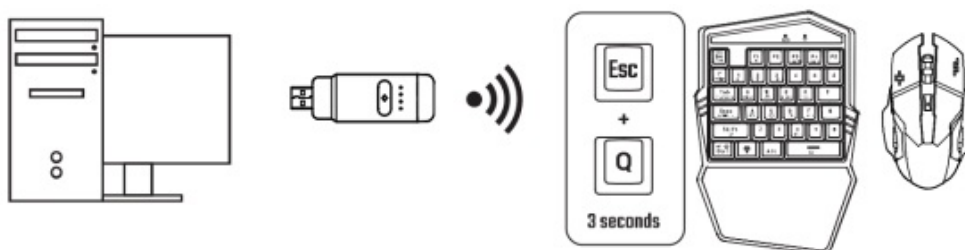

Keyboard Shortcut and Reset

1. Hold Down “Ctrl” while moving your mouse to turn in game character around at fast speed.
2. Press “**F3**”/“**F4**” to decrease or increase mouse sensitivity.
3. Press “**Ctrl + Esc**” to reset everything to default including customized key mapping.

Power Saving Mode and Hibernation

1. The mouse will go into Stage 1 power saving mode after being Idle for 3-5 seconds. the light on the back of the mouse will dim down. It'll switch to Stage 2 power saving mode after being idle for 60 seconds, the red light will flash. It will switch to deep hibernation after being Idle for 10 minutes. The red light will turn off. Right click or move the mouse. it will back to normal.
2. The keyboard will switch to power saving mode after being idle for 20 seconds. Press any key on the keyboard, it will back to normal.

Charging the keyboard and Mouse

Connect the keyboard and mouse to a 5v  0.5-1A Power adapter. It'll Start charging.

Keyboard	
Battery Indicator	Status
Blinks	Low Battery
Constant ON	Charging

It Takes about 4 hours to fully charge it.

Mouse	
Middle Button Blue LED	Status
Blinks	Low Battery
Constant ON	Charging

It takes about 2 hours to fully charge it.

Product Specification

Product	One Hand Keyboard	Model No.	IFY00-KMAX2-WL
Compatibility	Xbox One. PS4, Switch. PC	Working Temperature	0°C-45°C
Connection	2.4GHz Wireless	Working Humidity	20-80%
Wireless Distance	Approx. 10M	Battery	800 mAh
Number of buttons	35 buttons (Keyboard)	Input	5V 0.5A
Product Dimensions	250 x 165 x 35 mm	Lighting Color	IRGI3
Product	Gaming Mouse	Working Temperature	0°C-45°C
Connection	2.4GHz Wireless	Working Humidity	20-80%
Wireless Distance	Approx. 10M	Battery	400 mAh
DPI	800/1200/1600	Input	5V 0.5A

WARRANTY & SUPPORT

ONE-YEAR WARRANTY

We offer a 90-day free replacement and one-year warranty service from the date of purchase. If there are any problem with the product, please do not hesitate to contact us.

KEY MAPPING SOFTWARE

You can install our software on Windows (10/8/7/XP), and custom button mapping to the keyboard or mouse.

Please download it from : www.ifyoo.net/support

For more advanced setup guide, please follow our YouTube channel & download pdf manual from our official website.

Download Key Mapping Software

www.ifyoo.net/support



User Manual

www.ifyoo.net/support



Customer Service: cs@ifyoo.net

9:00 – 18:00 Monday to Friday



Official Website: www.ifyoo.net



www.youtube.com/IFY00

FCC Statement

This device complies with Part 15 of the FCC Rules. Operation is subject to the following two conditions:

1. this device may not cause harmful interference, and
2. this device must accept any interference received, including interference that may cause undesired operation.

NOTE: This equipment has been tested and found to comply with the limits for a Class B digital device, pursuant to Part 15 of the FCC Rules. These limits are designed to provide reasonable protection against harmful Interference in a residential Installation. This equipment generates, uses and can radiate radio frequency energy and, if not installed and used in accordance with the instructions, may cause harmful interference to radio communications. However, there is no guarantee that Interference will not occur in a particular Installation. If this equipment does cause harmful interference to radio or television reception, which can be determined by turning the equipment off and on, the user is encouraged to try to correct the Interference by one or more of the following measures:

- Reorient or relocate the receiving antenna. Increase the separation between the equipment and receiver.
- Connect the equipment into an outlet on a circuit different from that to which the receiver is connected.
- Consult the dealer or an experienced radio/TV technician for help.

Warning: changes or modifications not expressly approved by the party responsible for compliance could void the user's authority to operate the equipment

The device has been evaluated to meet general RF exposure requirements. The device can be used in portable exposure conditions without restriction.



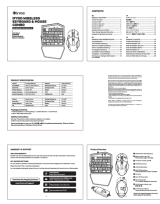

Documents / Resources

	<p>iFYOO IFYOO-KMAX2-WL Wireless Keyboard and Mouse Combo [pdf] User Manual X9W, 2A4H5-X9W, 2A4H5X9W, IFYOO-KMAX2-WL Wireless Keyboard and Mouse Combo, Wireless Keyboard and Mouse Combo</p>
---	---

Manuals+