



## IFIXIT Adding Images to an Existing Question User Manual

[Home](#) » [IFIXIT](#) » IFIXIT Adding Images to an Existing Question User Manual

### Contents [ [hide](#) ]

- [1 IFIXIT Adding Images to an Existing Question](#)
- [2 Adding images to an existing question](#)
- [3 INTRODUCTION](#)
- [4 Documents / Resources](#)
- [5 Related Posts](#)



## IFIXIT Adding Images to an Existing Question

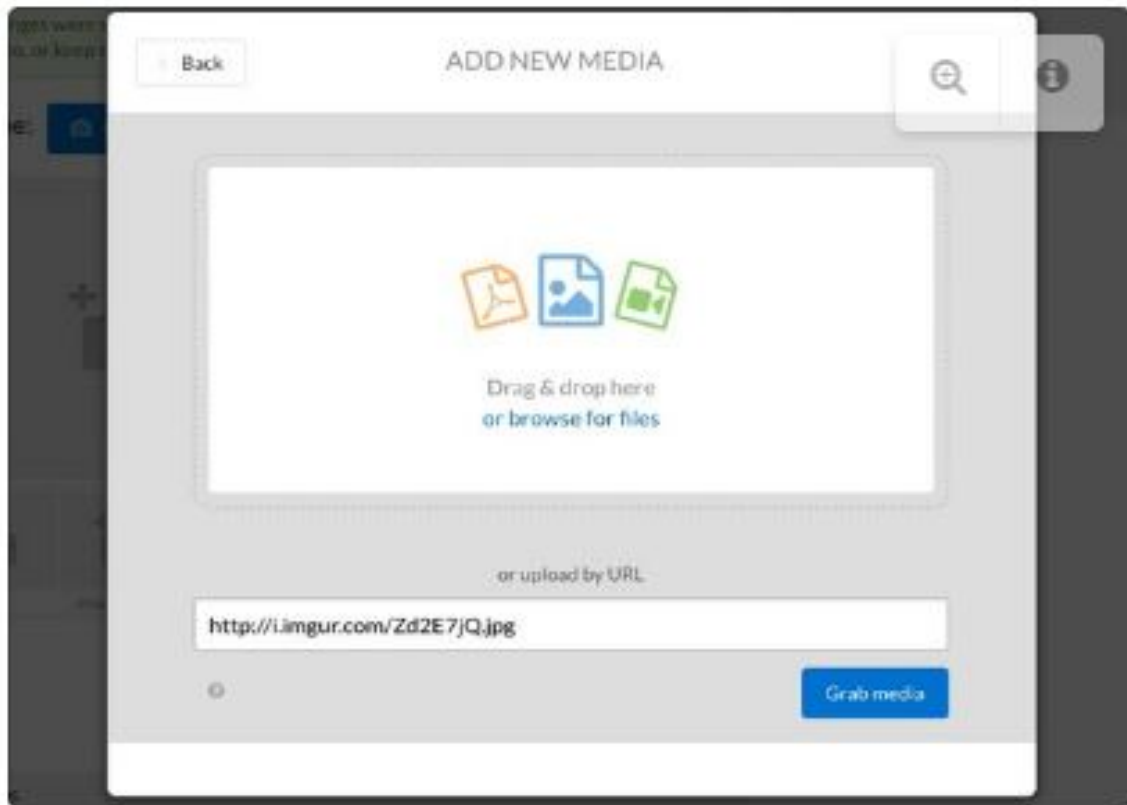

### Adding images to an existing question

Sometimes we forget or want to add images later, to our questions or answers. This will show how to add those images.

Written By: oldturkey03

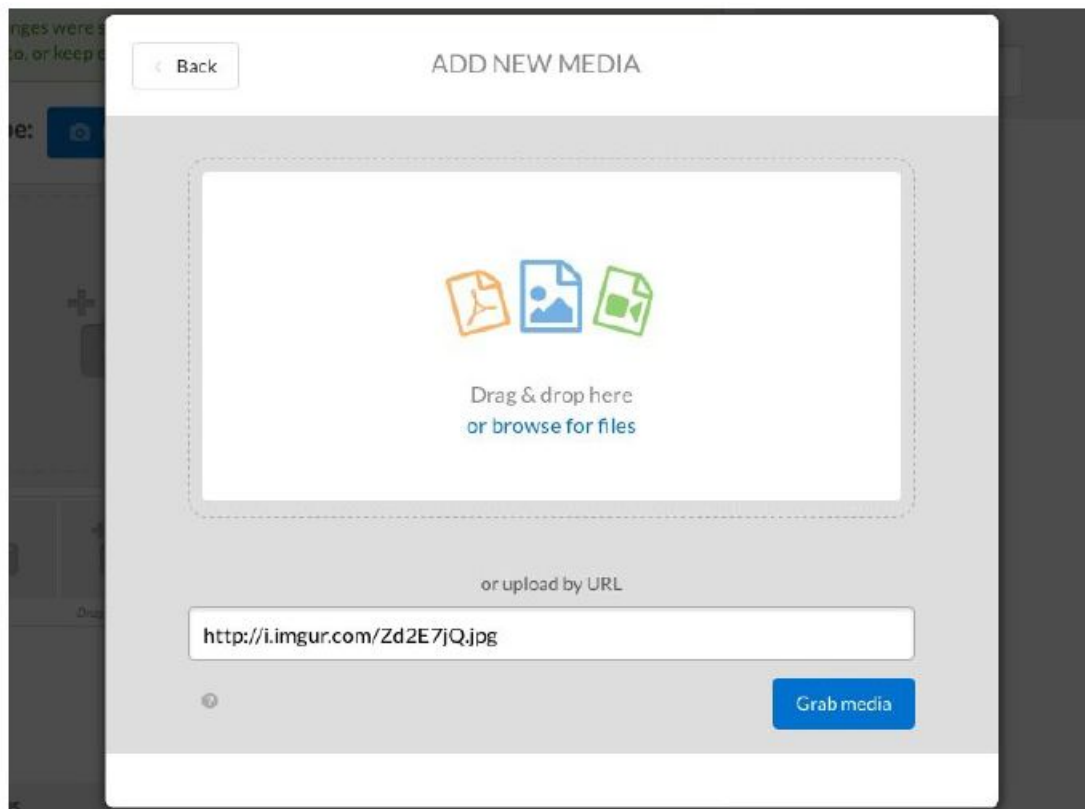

## INTRODUCTION

This is a “quick and dirty” guide on how to add images to existing questions or answers.

## Step 1 — Adding images to an existing question

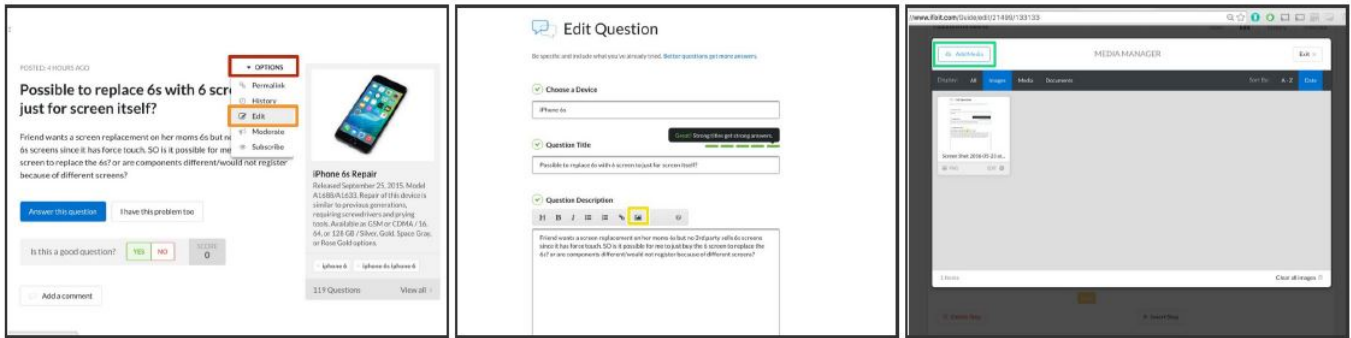

- Mouse-over Options on the top right corner of the Question field to reveal a dropdown menu.
- Click on Edit to open the Edit Post page.
- Before adding your image, position the cursor at the place in your text where you want to add the image. We suggest placing it at the end of the question.
- Click on the image icon to open the Media Manager.
- Click on Add Media and select files from your computer to upload. Alternatively, you can simply drag and drop images into the Media Manager to upload them. If you did this, proceed directly to step 3.

## Step 2

- In the Add Media window, you can add images from the internet or your local machine.
- **To add images from your computer:**
  - Click on the browse for files to find photos on your computer, or simply drag and drop them onto the window.
- **To add images from the internet:**
  - Get the link to your desired image. You can usually do this by right-clicking the image and selecting Copy link address.
  - Paste the link into the field provided.
  - Click Grab Media to add the image to your Media Manager.

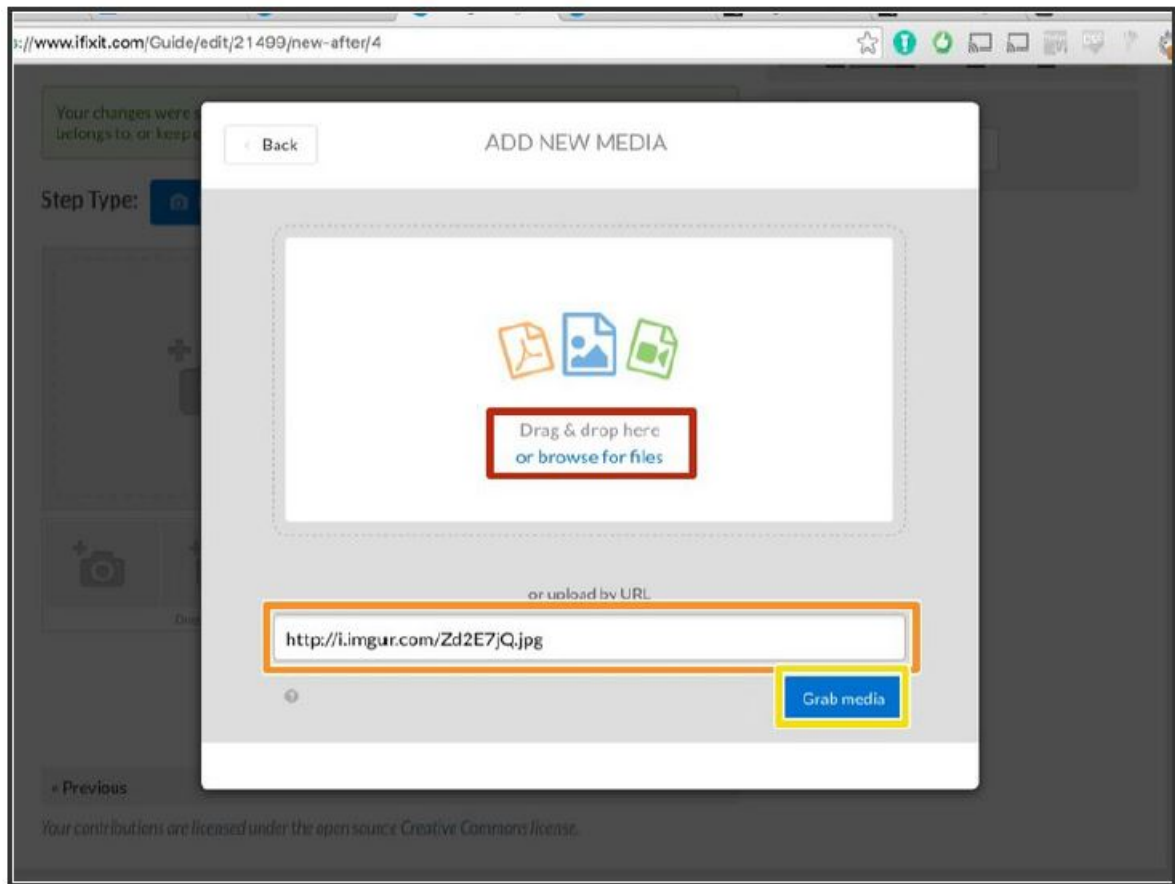

### Step 3

- Once the image is in your Media Manager, click on it to insert into your question.
- The image should appear in-line at the spot where your cursor was positioned when you opened the Media Manager. iFixit images show up in 4:3 format. Most modern cameras capture in 3:2 or 16:9, which will require a crop. If you change your capturing preferences when taking pictures to 4:3, you won't need to crop them in the Media Manager.

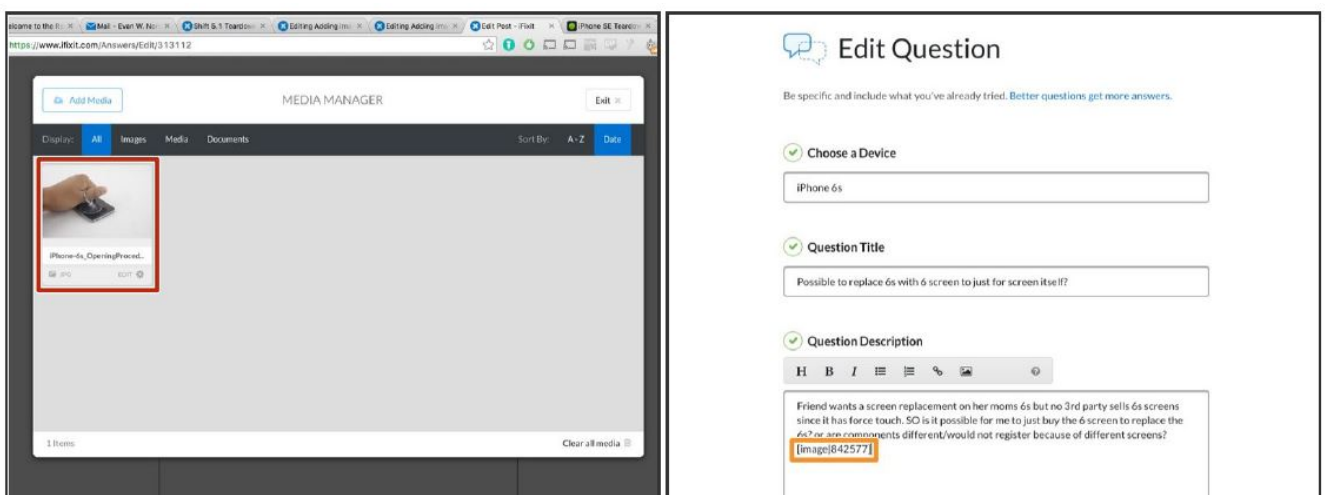

### Step 4

- After inserting the image, scroll to the bottom of the page and click Preview Edit.
  - A preview will be automatically inserted below the fields for you to review.
- If everything looks good, click Submit Edit. If not, scroll back up and adjust your question as necessary.

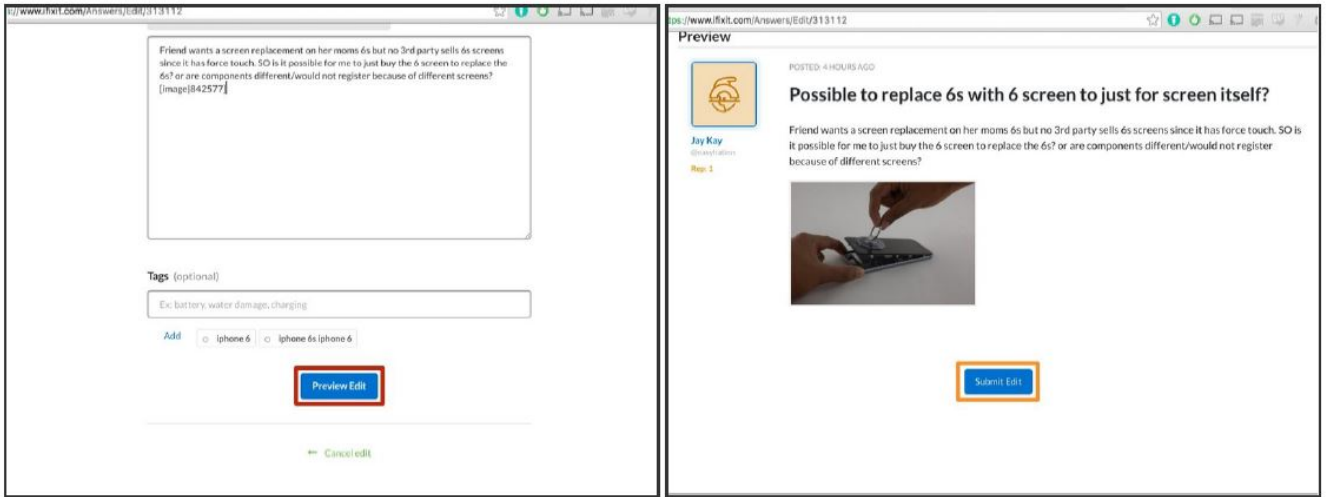

The image size for insertion must be 800 x 600 pixels otherwise there will be an error message in the Media Manager. It looks complicated, but is actually straightforward.

This document was generated on 2022-06-29 02:38:02 PM (MST).

[www.iFixit.com](https://www.iFixit.com)

© iFixit — CC BY-NC-SA

## Documents / Resources

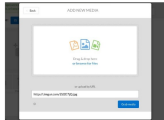
	<p><a href="#">iFixit Adding Images to an Existing Question</a> [pdf] User Manual Adding Images to an Existing Question, Existing Question, Question</p>
---	--