

iDM LED Pixel Display User Manual

[Home](#) » [iDM](#) » iDM LED Pixel Display User Manual 

Contents

- [1 iDM LED Pixel Display](#)
- [2 Safety Tips](#)
- [3 Product Information](#)
- [4 Product Accessories](#)
- [5 Product Function](#)
- [6 Download the 'iDotMatrix' APP](#)
- [7 Connect to Device](#)
- [8 Creative Graffiti](#)
- [9 Documents / Resources](#)
 - [9.1 References](#)
- [10 Related Posts](#)

iDM

iDM LED Pixel Display



Safety Tips

1. Please tear off the protecti film before using.
2. Please place the equipment on a stable and safe level surface to avoid falling and causing damage or injury.
3. Do not insert any foreign objects into the device socket.
4. Do not knock or strike the device with force.
5. Keep away from heat sources and avoid electrical appliances such as open flames, microwave ovens, and electric heaters that can generate high heat. To ensure safety, only use the supplied accessories when using the product.
6. The signal cable is only for use with this product and should not be used on other devices, as it may cause damage to the equipment.

Product Information

- **Product Name:** LED
- **Pixel Display Pixel Dot:** 32*32
- **LED Qty:** 1024pcs
- **Power Supply:** USB
- **Product Power:** 10W
- **Voltage/Current:** 5V/2A
- **Product Size:** 7.9*7.9*0.9 inches
- **Package Size:** 11.0*9.0*1.6 inches

Product Accessories

1. 1x Pixel Screen Panel
2. 1x User Manual

3. Ix Support Rod
4. IxL.SM USB Cable
5. Ix Adapter

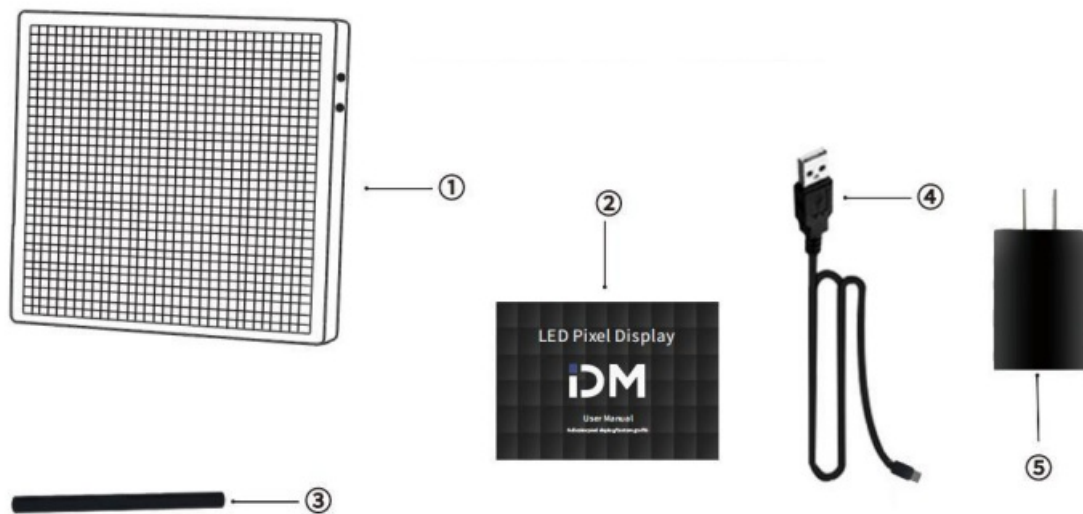

Product Function

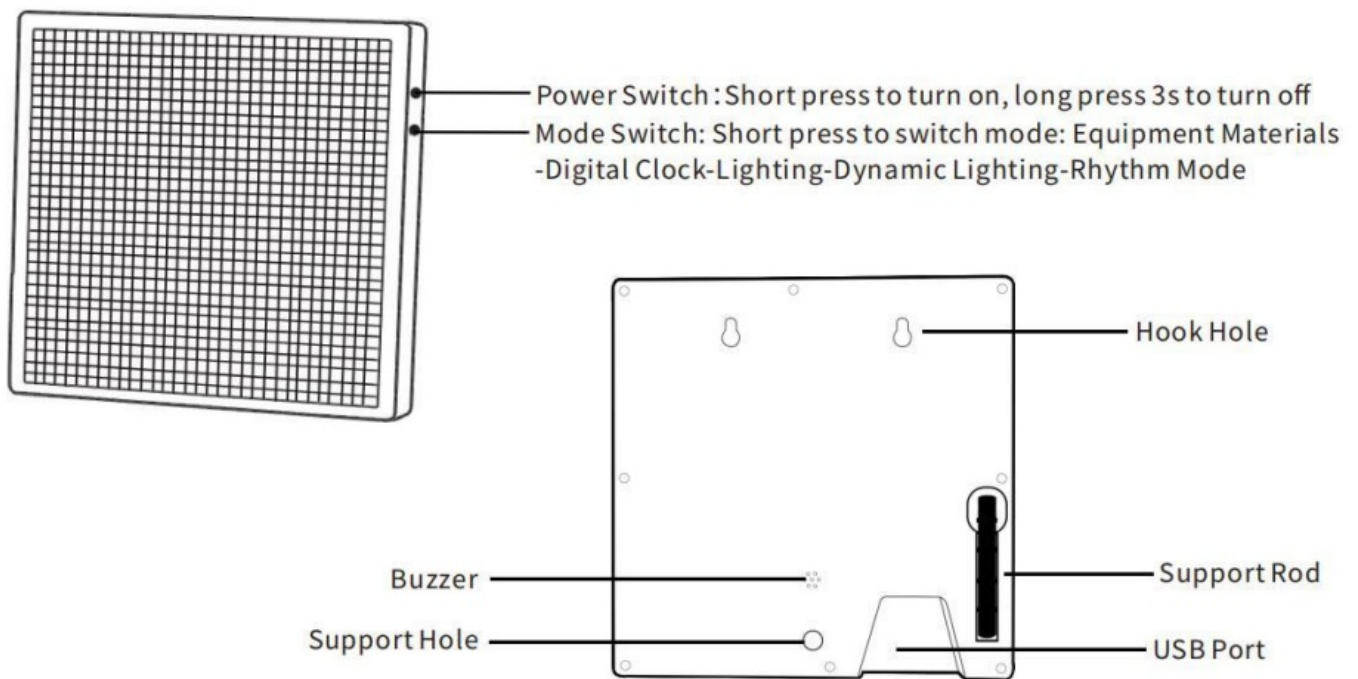

Download the 'iDotMatrix' APP

1. Scan the QR code below or go to Google Play/App Store and search for 'iDotMatrix' to download the app.



2. Turn on Bluetooth

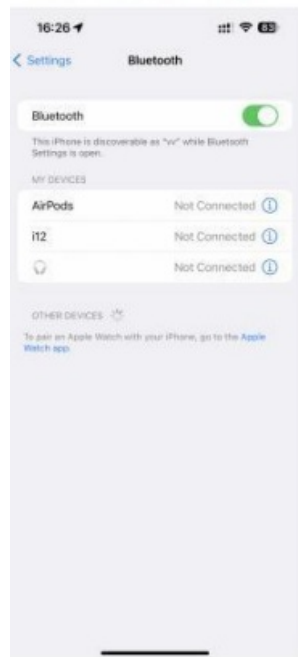

Connect to Device

Notes

1. When first time opens the app, the pop-up option of whether to allow permissions, please select 'allow'.
2. Turn on Bluetooth and connect the device.
3. If Android phone can't retrieve the Bluetooth, please check to open the location

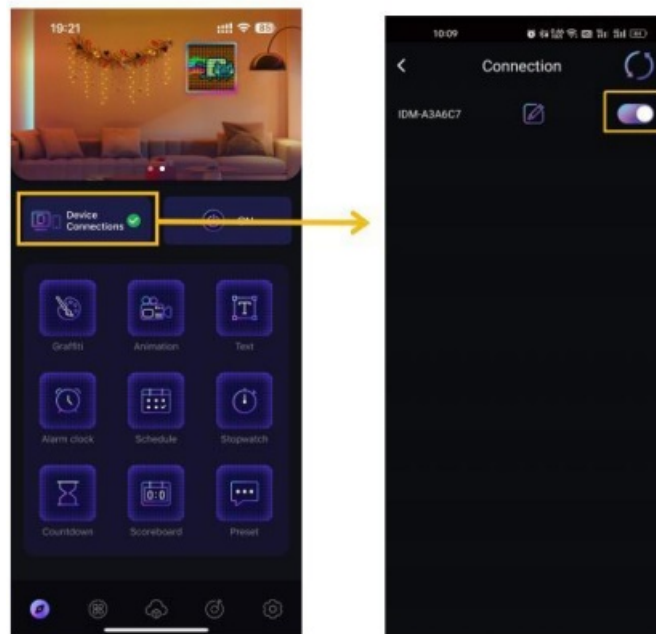

Creative Graffiti

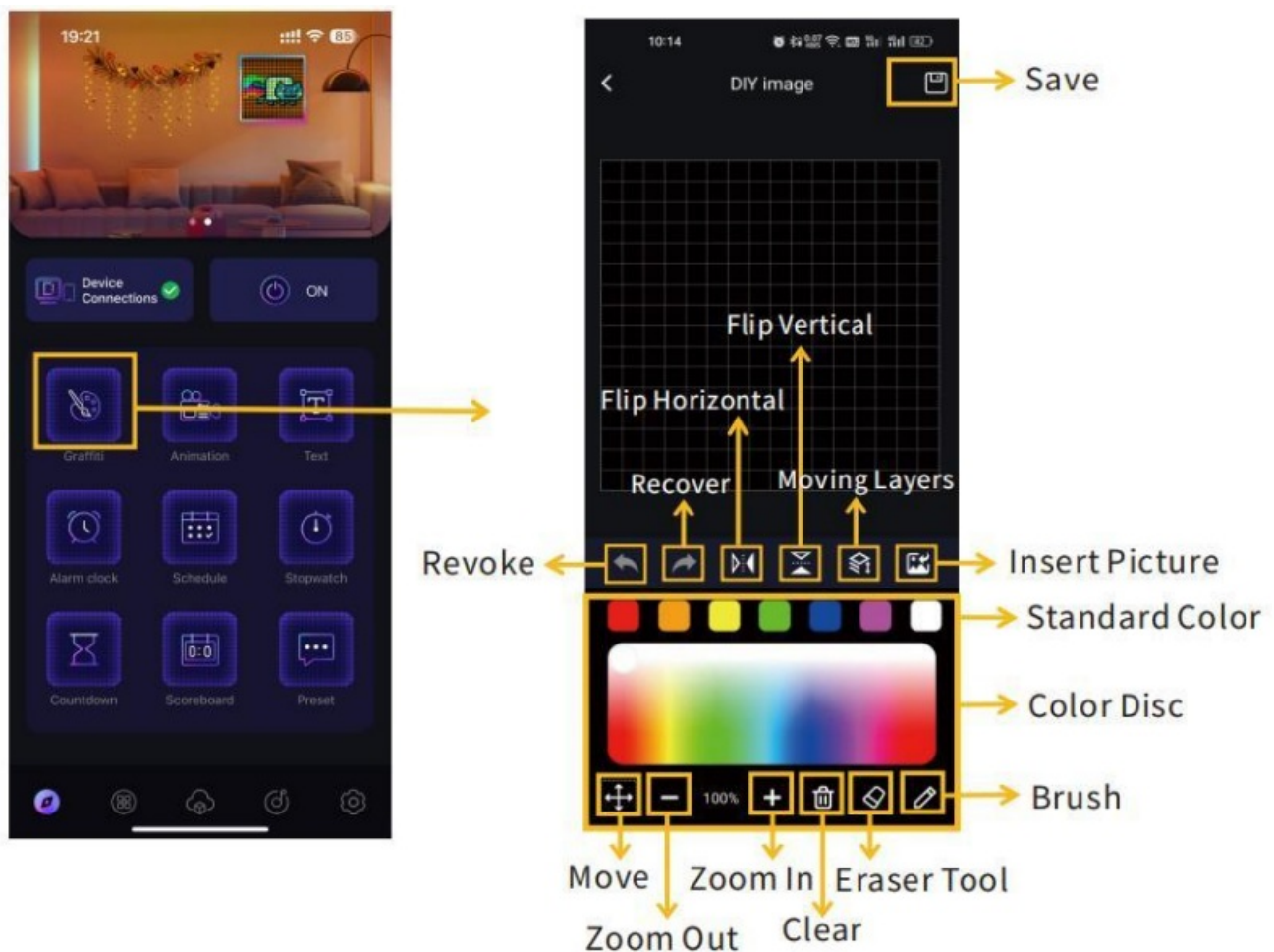

Creative Animation

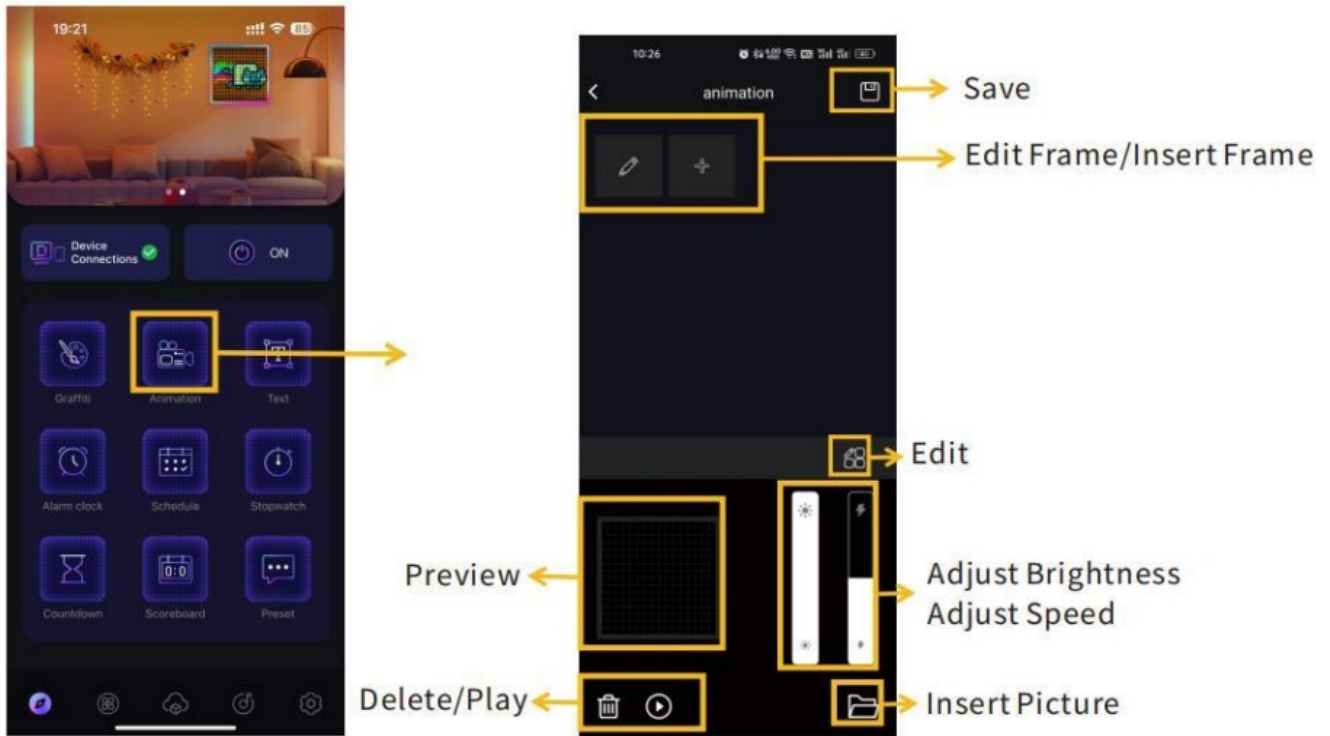

Text Editing

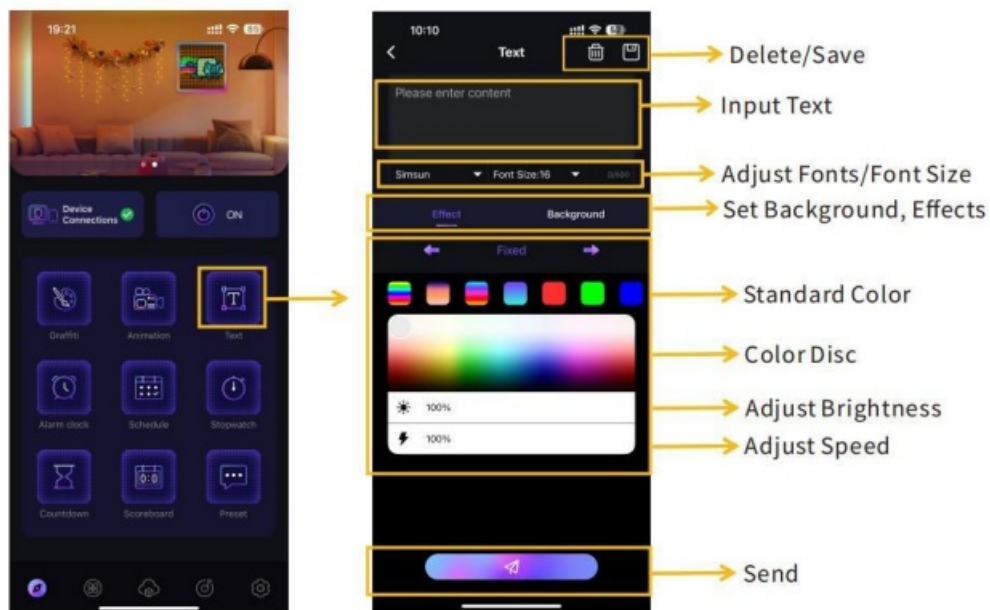

Alarm Clock

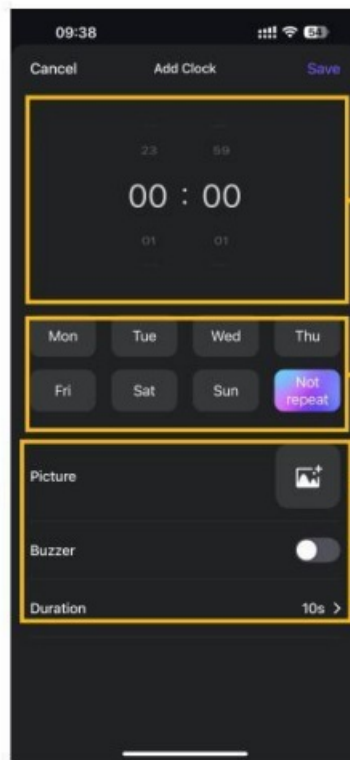
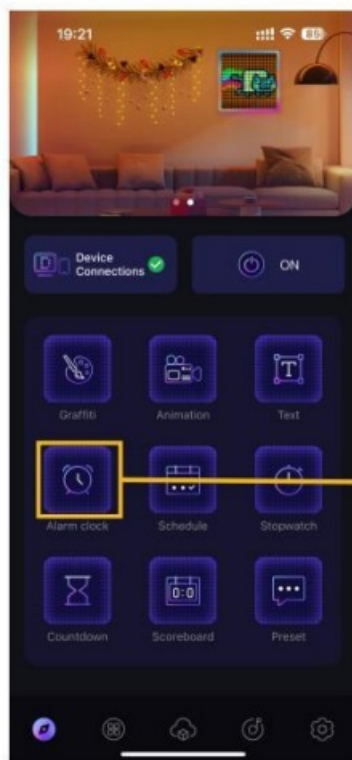

Time Setting

Day Settings

Add Patterns

Buzzer Switch

Buzzing Duration

Schedule



Initial Schedule

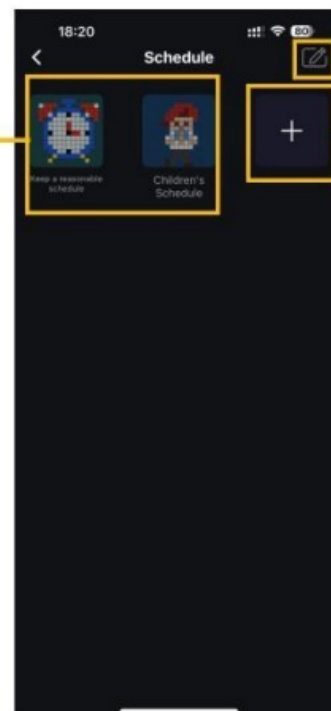

Save/Delete

Add Schedule

Stopwatch

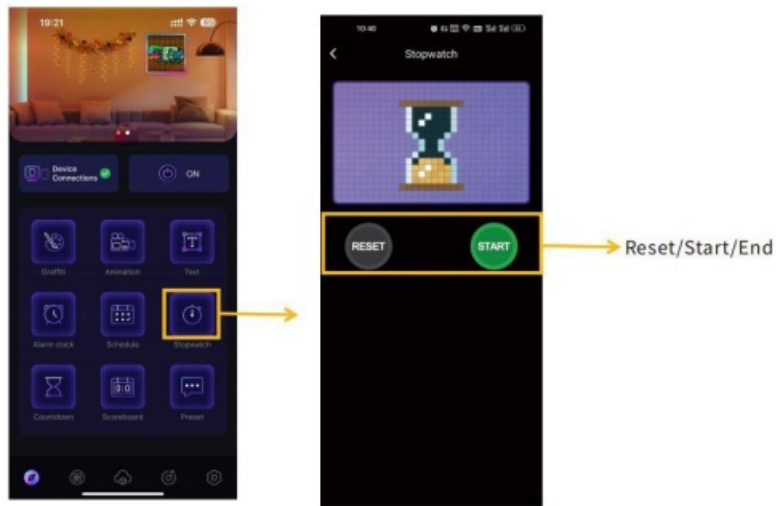

Countdown

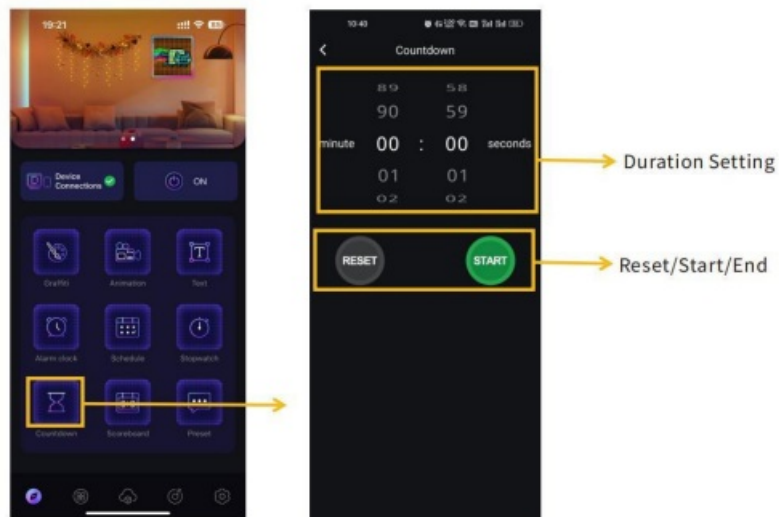

Scoreboard

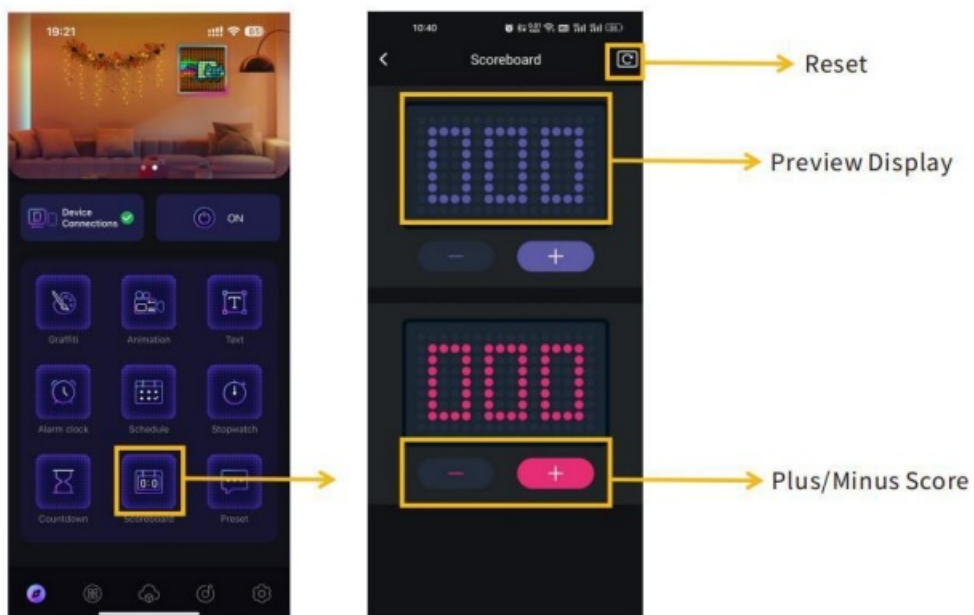

Preset Phrase

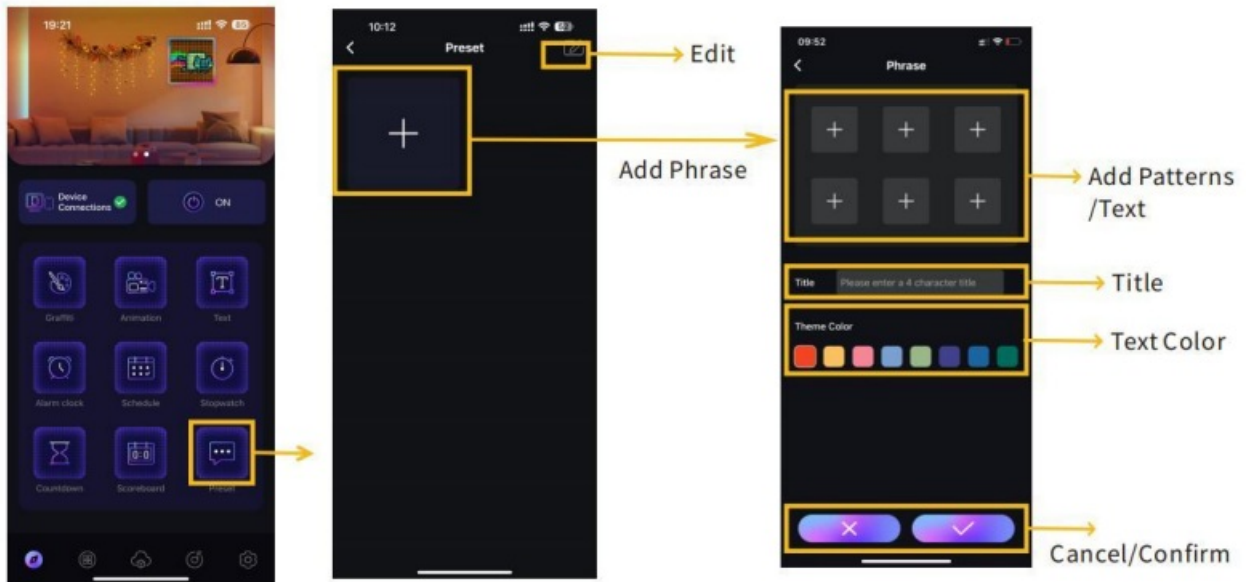

Mode-Digital Clocks

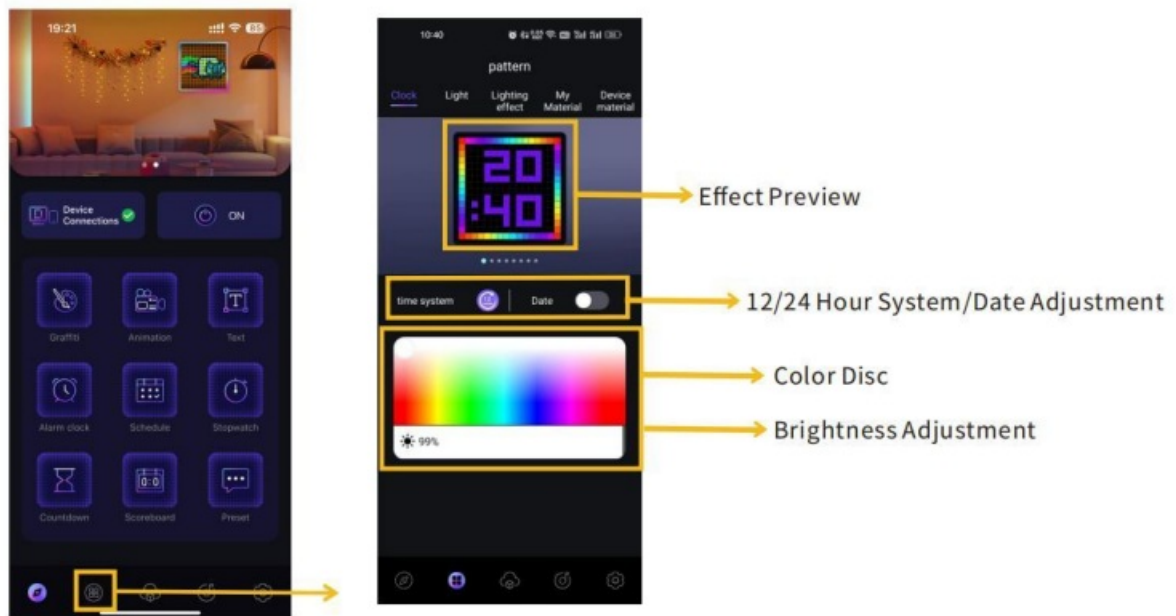

Mode-Lighting

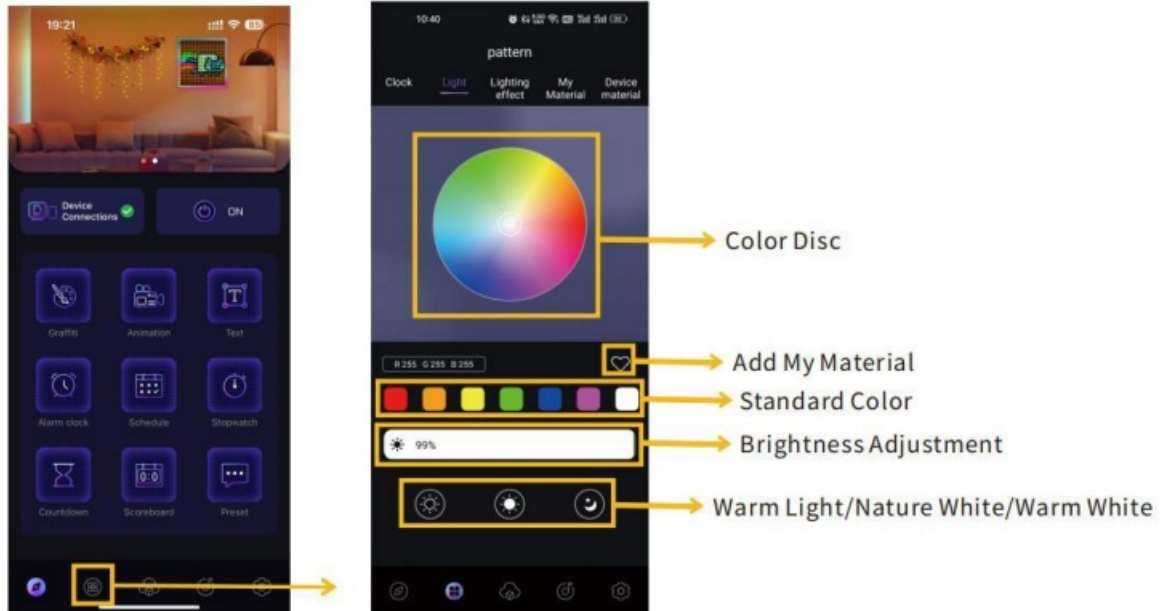

Mode-Dynamic Lighting

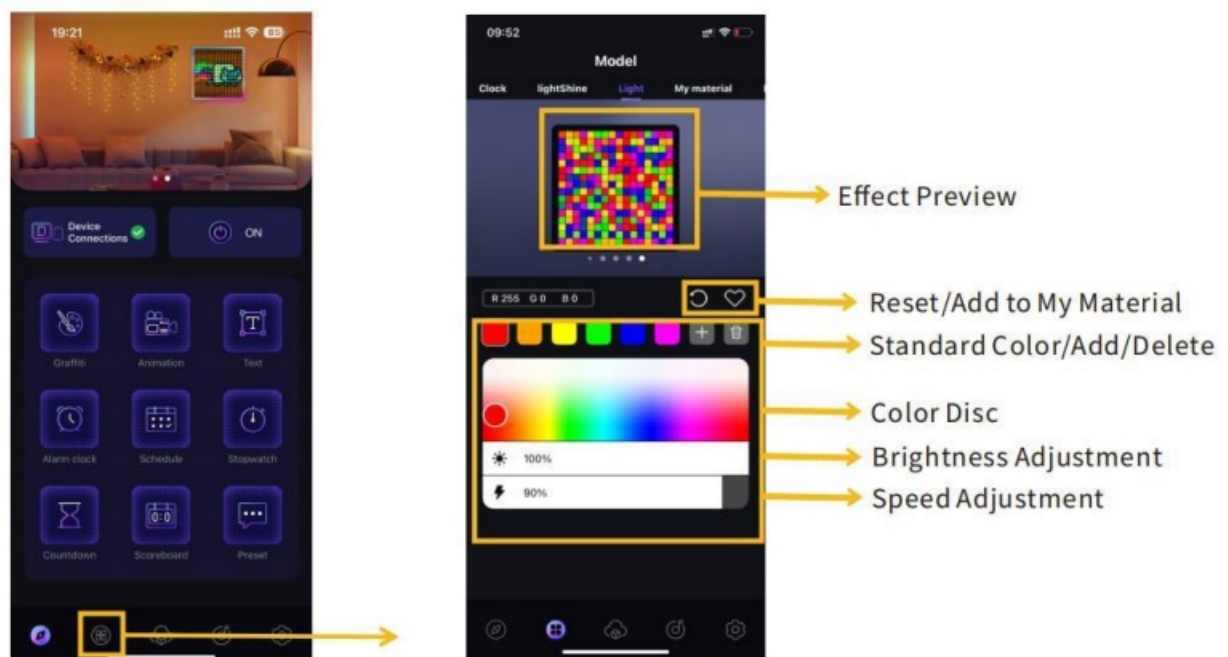

Mode-My Material



Mode-Equipment Materials

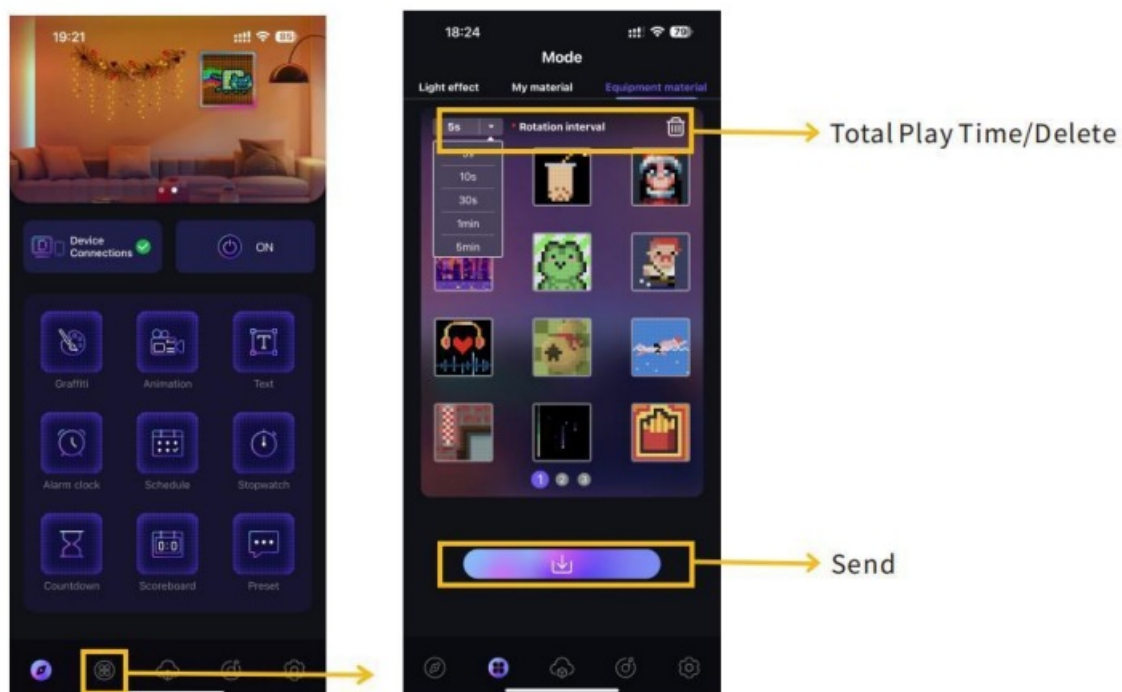

Cloud Material



Rhythm

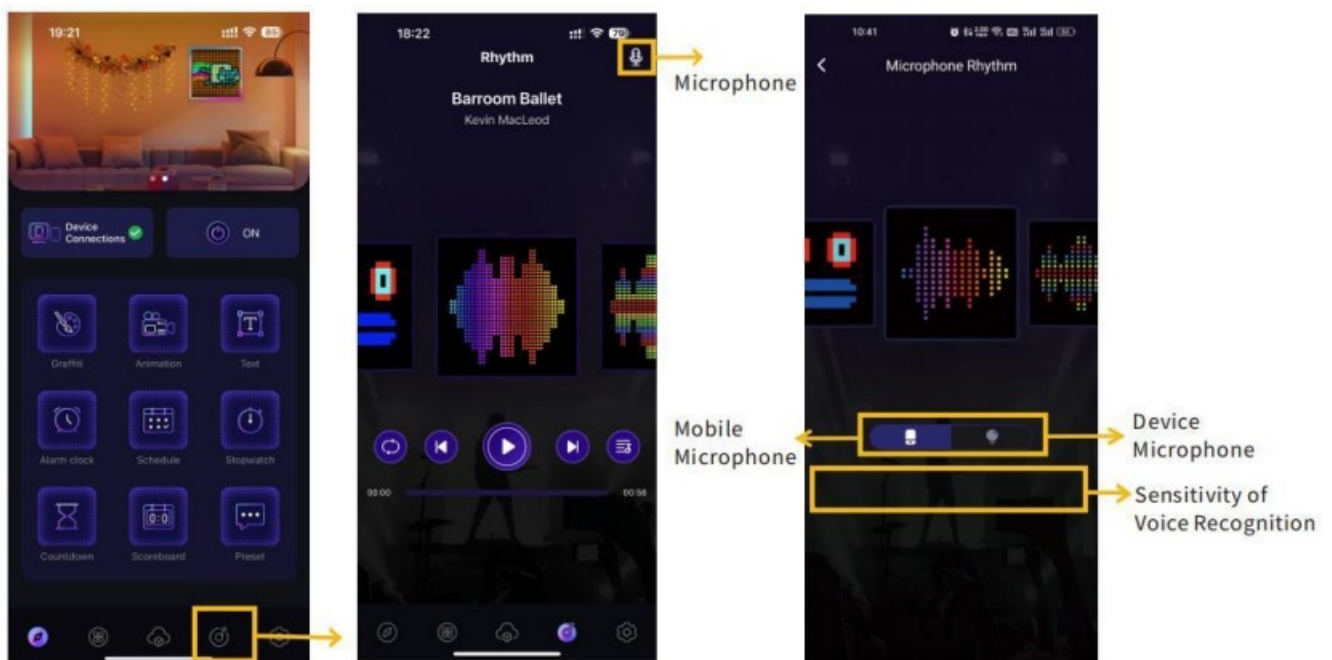

Settings

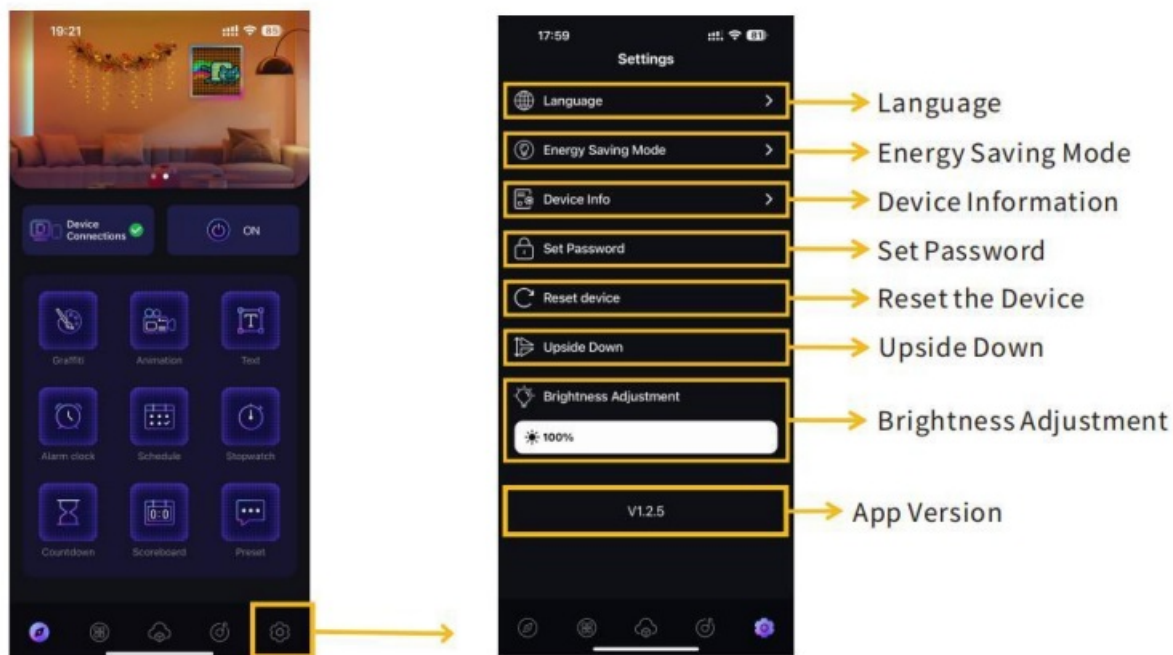

Warning:

This device complies with Part 15 of the FCC Rules. Operation is subject to the following two conditions:

1. this device may not cause harmful interference, and
2. this device must accept any interference received including interference that may cause undesired operation.

Changes or modifications not expressly approved by the party responsible for compliance could void the user's authority to operate the equipment. NOTE: This equipment has been tested and found to comply with the limits for a Class B digital device, pursuant to Part 15 of the FCC Rules. These limits are designed to provide reasonable protection against harmful interference in a residential installation. This equipment generates uses and can radiate radio frequency energy and, if not installed and used in accordance with the instructions, may cause harmful interference to radio communications. However, there is no guarantee that interference will not occur in a particular installation. If this equipment does cause harmful interference to radio or television reception, which can be determined by turning the equipment off and on, the user is encouraged to try to correct the interference by one or more of the following measures:

- Reorient or relocate the receiving antenna.
- Increase the separation between the equipment and receiver.
- Connect the equipment into an outlet on a circuit different. from that to which the receiver is connected.
- Consult the dealer or an experienced radio/TV technician for help.

NOTE: This device and its antenna(s) must not be co-located or operation in conjunction with any other antenna or transmitter

RF Exposure Statement

To maintain compliance with FCC' s RF Exposure guidelines, This equipment should be installed and operated with minimum distance of 20cm the radiator your body. This device and its antenna(s) must not be co-located or operation in conjunction with any other antenna or transmitter



Documents / Resources

	iDM LED Pixel Display [pdf] User Manual LED Pixel Display, Pixel Display, Display
---	--

References

- [User Manual](#)