



idinio Security Camera Smart Floodlight User Guide

[Home](#) » [idinio](#) » idinio Security Camera Smart Floodlight User Guide 

idinio Security Camera Smart Floodlight User Guide



Your tablet or smartphone must be connected to a 2.4GHz WiFi network

Contents

- [1 Application Installation](#)
- [2 Basic Network Requirements](#)
- [3 Product Overview](#)
- [4 Mounting Bracket](#)
- [5 Box Contents](#)
- [6 Installation](#)
- [7 Add Device](#)
- [8 AP Modes](#)
- [9 Warning](#)
- [10 Documents / Resources](#)
- [11 Related Posts](#)

Application Installation

Download the Idinio Smart app from the Google Play or Apple App Store and create a user account.





Basic Network Requirements

- This device only supports 2.4GHz WiFi networks so when you own a 5GHz router you must select the 2.4GHz network or disable the 5GHz network first in your router' menu. Refer to your router manual for instructions
- Make sure that during the pairing process this device as well as your iOS or Android device will remain in the WiFi range of your router.

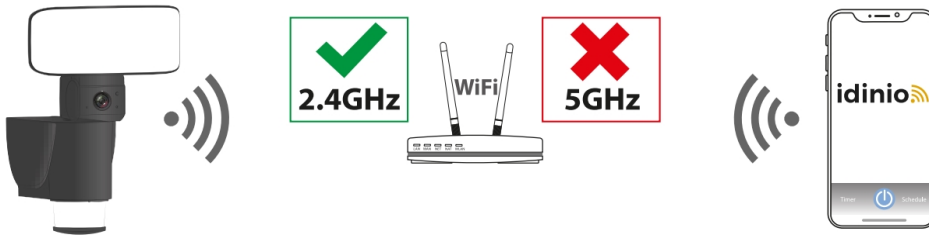

Product Overview

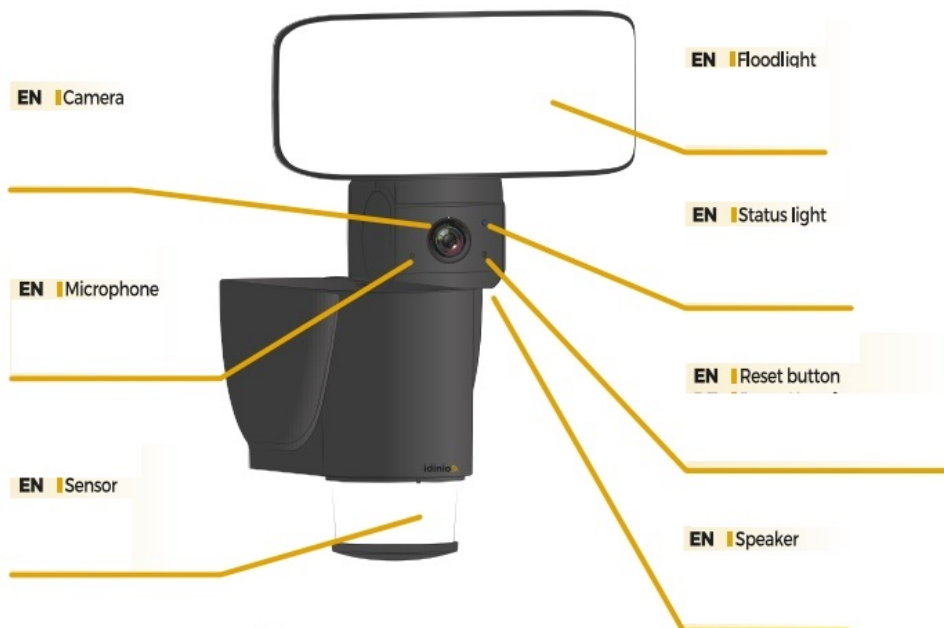

Mounting Bracket

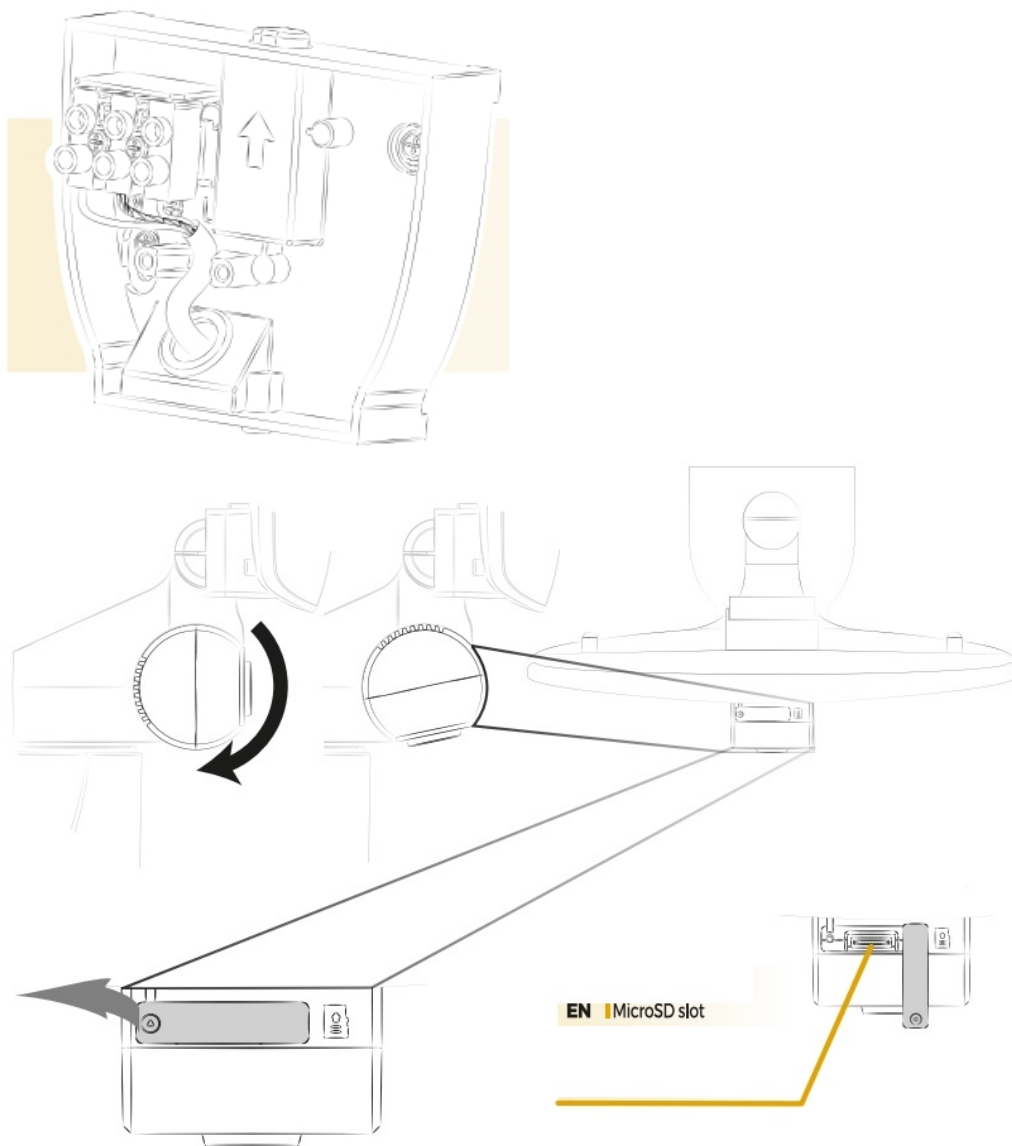

Box Contents

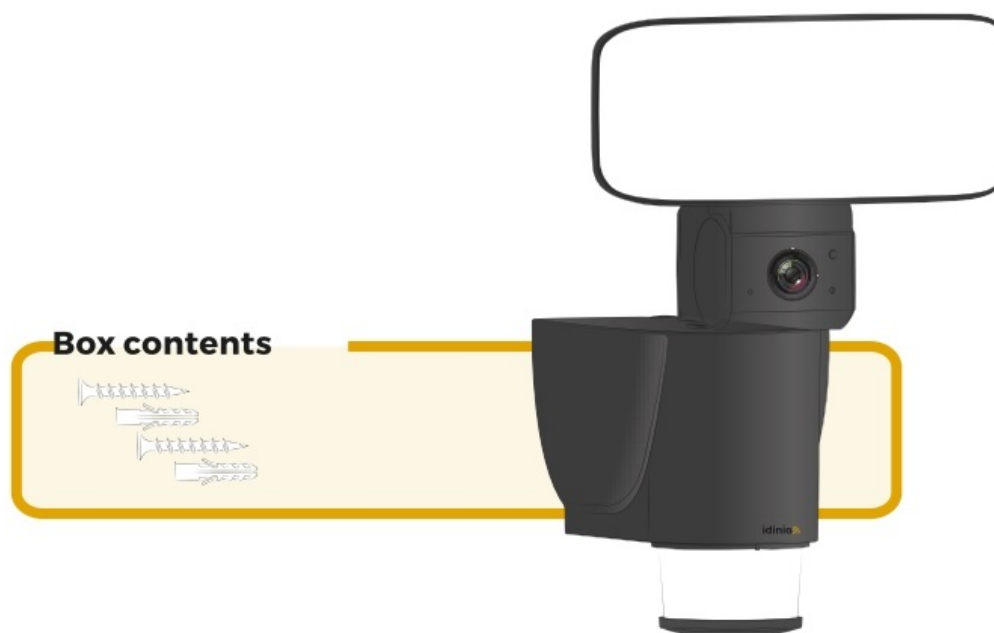

Installation

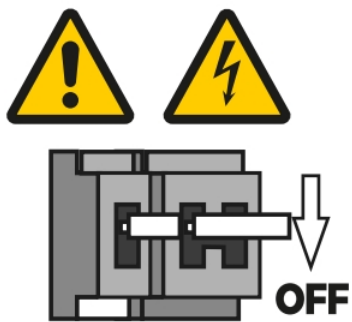

1

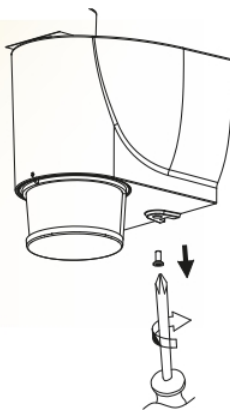

2

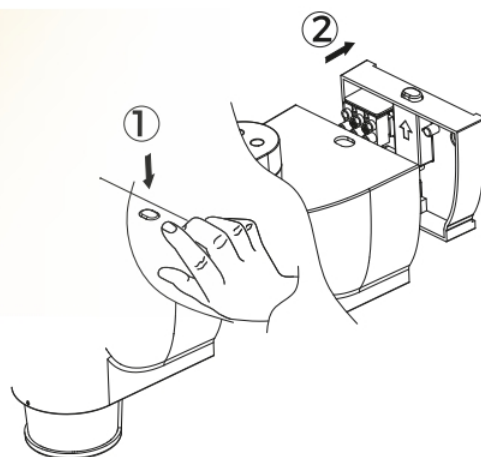

3

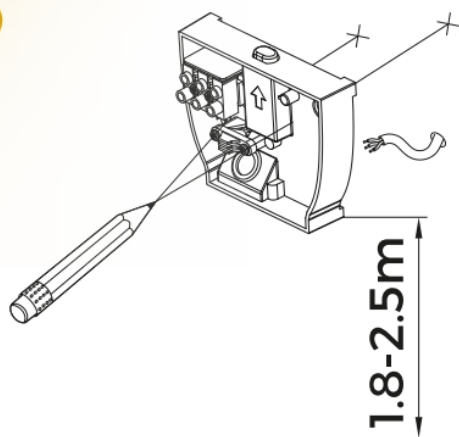

4

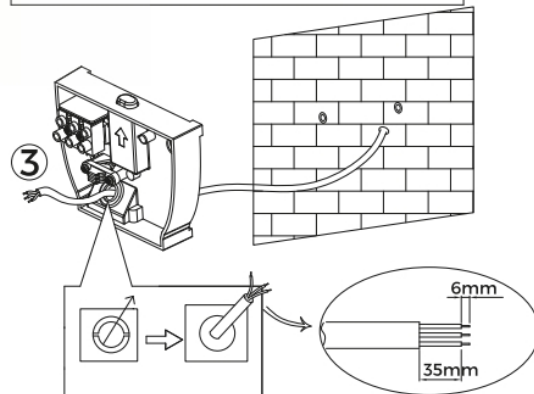
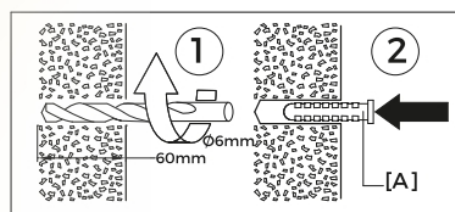

5

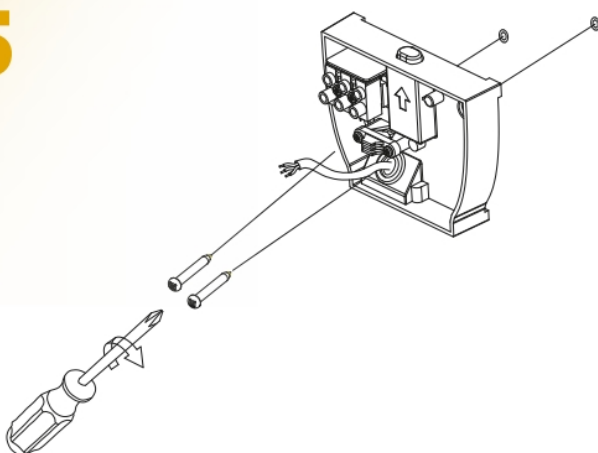

6

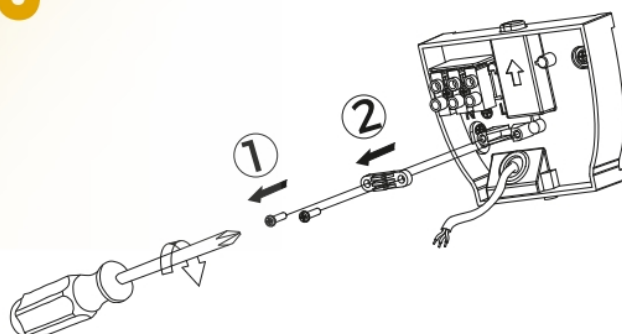

7

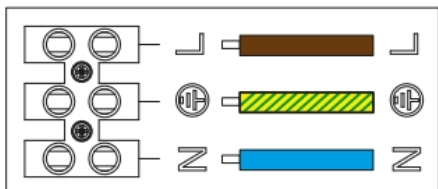
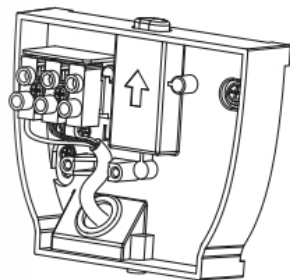

8

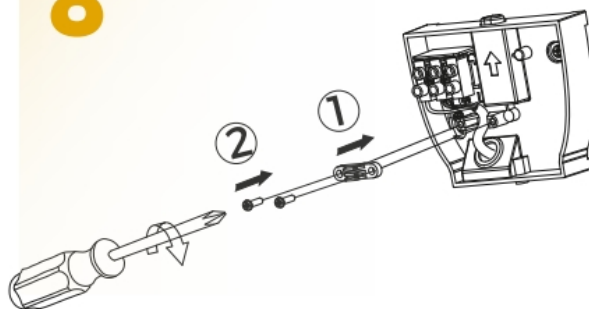

9

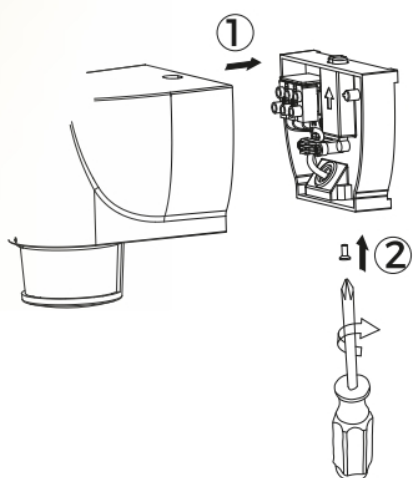

10

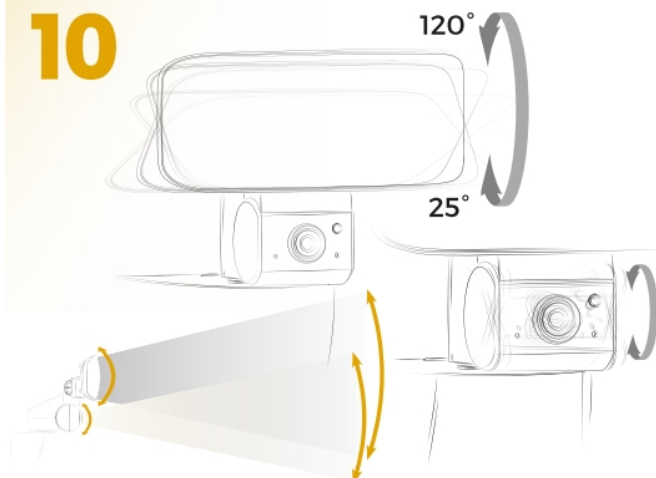

Add Device

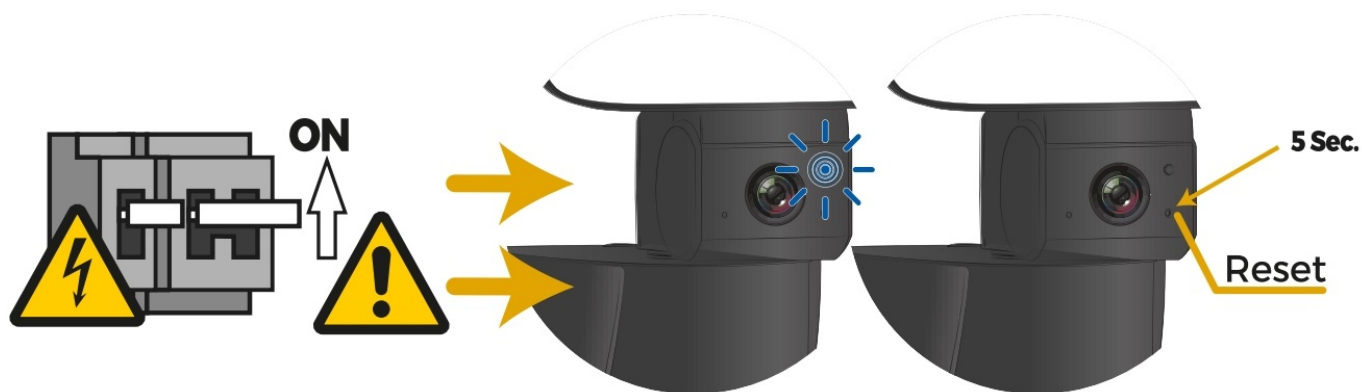

When power in the fuse box is turned back on, the LED indicator will start blinking rapidly. If this is not the case you must reset the device by pressing the Reset button for 5 seconds.

- Launch the app and tap the '+' in the top right corner

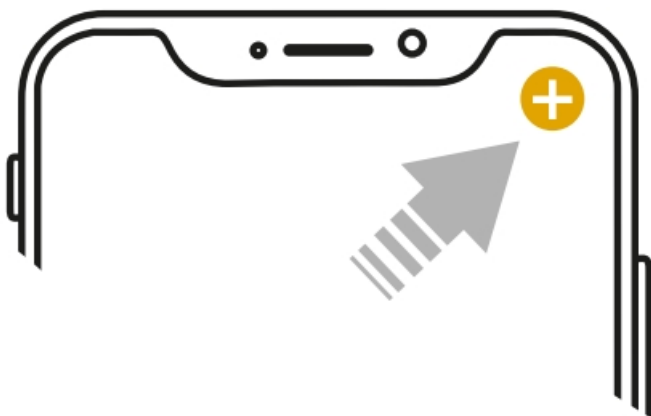

- Select Camera and tap View Out 3 Floodlight WiFi Camera.

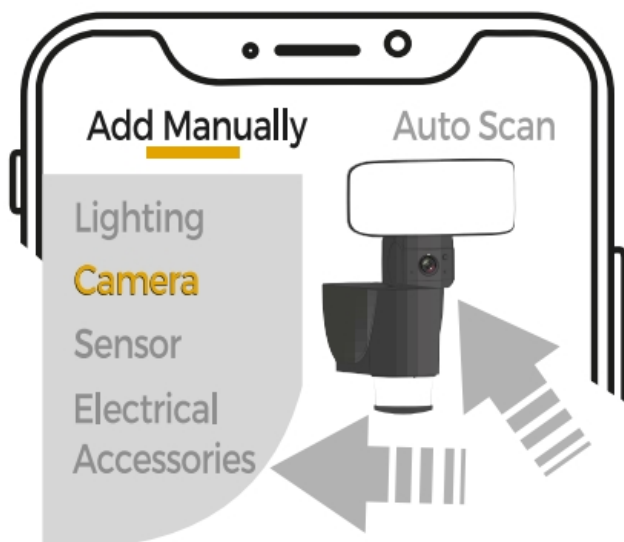

- Tap 'Confirm indicator rapidly blinks'

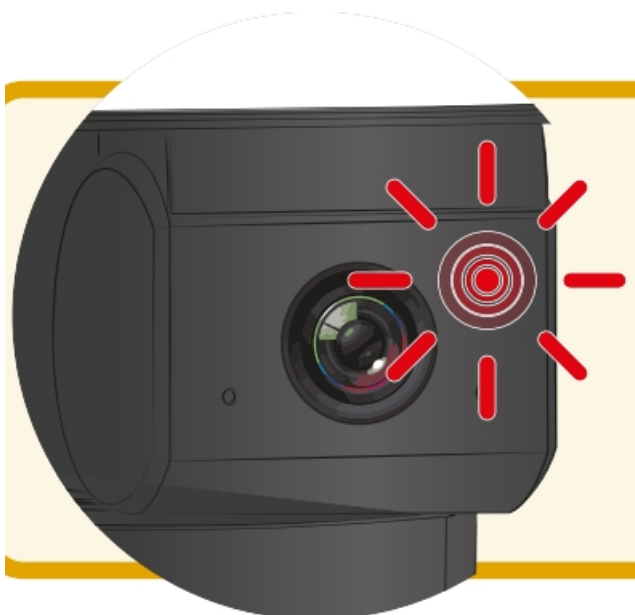

- Select the right 2.4GHz WiFi network and password and tap 'Confirm'



- Press continue to have the app generate a QR code which needs to be scanned by the camera. Hold the QR code in front of the camera at 15-20cm.

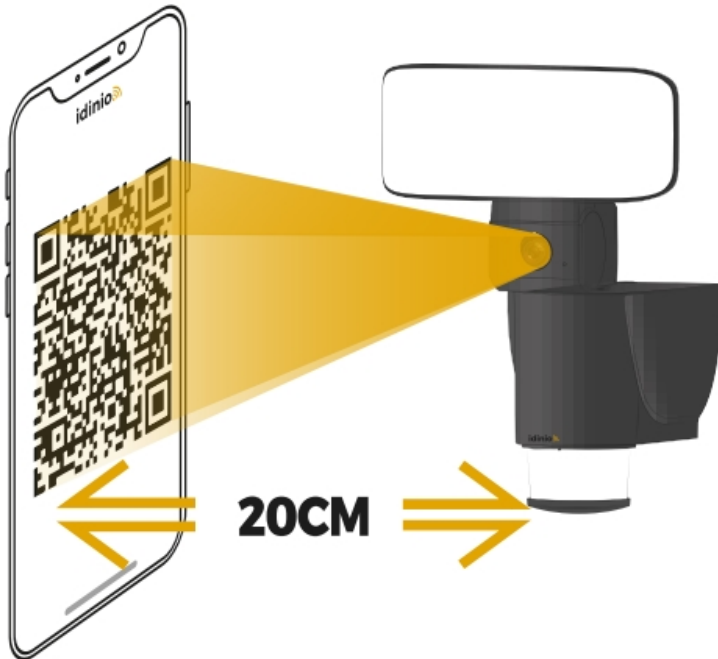

- Confirm that after scanning the QR code you heard a beep.



- The app will auto-connect with the device. Once the process is completed, it will prompt you to rename the device. Enter a new name and 'Save'



AP Modes

- If adding the device failed it maybe a networking problem. You can now proceed using the AP Mode for adding the device.

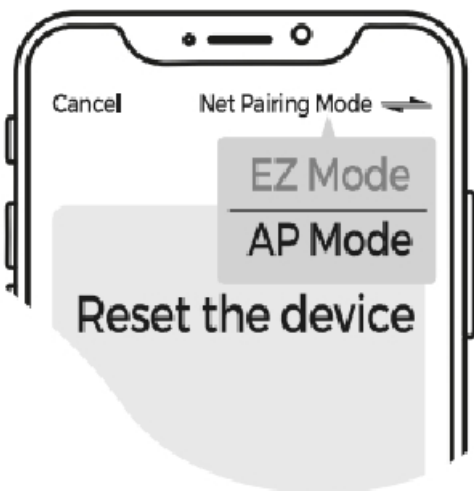

- Press the Reset button for 5 seconds and make sure that the device lights are flashing slowly.

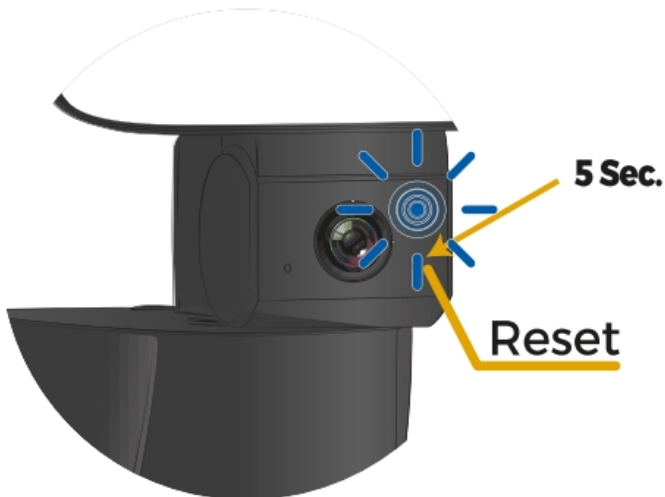

- Launch the app and tap the in the top right corner

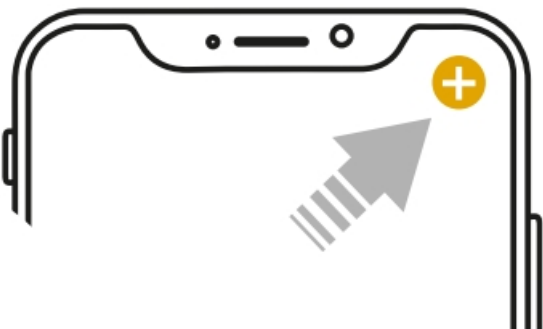

- Select Camera and tap View Out 3 Floodlight WiFi Camera.

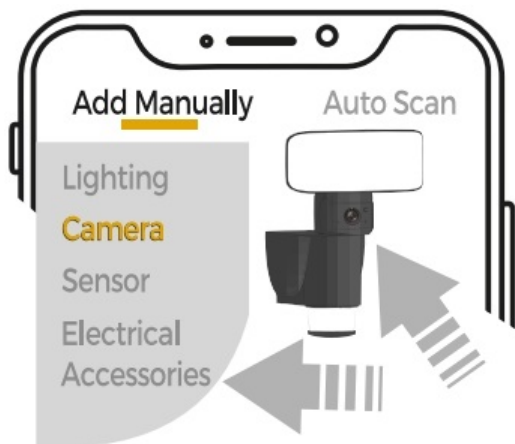

- Tap 'Other Mode' in top right corner and select 'AP Mode'.

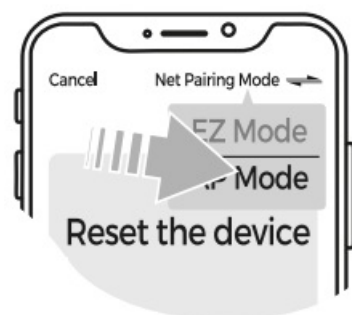

- Check if the connection light is flashing slowly. Press 'Confirm indicator slowly blinks'. Then select your 2.4GHz network, password and confirm."
- Now connect you smartphone or tablet with the device's hotspot. Tap 'Connect'. The app will now open the settings menu of your smartphone or tablet. Open WiFi settings.
- Search the smart device name in the list of WiFi networks and connect. Devices will connect.
Now open the Idinio Smart app again and wait until the connection process is finished.

Warning

Safety warning!

- Ensure you have fully read and understood the instructions in this document before you install or use the product following the installation/wire diagram (when applicable).
- Keep this document for future reference and only use the product as described in this document.
- Any other use of the product than described in this manual may damage the product or cause injury to the user (e.g. due to a short circuit, fire or electric shock).
- Disconnect the product from the power source if problems occur.
- Do not drop the product and avoid bumping.
- Do not use the product if a part is damaged or defective.
- Replace a damaged defective product immediately.
- When a non-standard consumer (power) installation is required this should be performed by a qualified technician to reduce the risk of an electric shock. Make sure the product is sufficiently ventilated during use.
- Never cover an electrical (LED) device during usage since it can generate heat causing damage.
- Besides LED can be extremely bright and may cause serious eye damage so don't stare at it directly.
- When a product is meant for indoor and/or outdoor use only, this will be mentioned on the product/parts or in

the manual.

- Keep the product out of reach of children or animals.

Cleaning and Maintenance warning!

- Do not use cleaning solvents or abrasives.
- Do not clean the inside of the device.
- Do not attempt to repair the device when the device does not operate correctly, replace it.
- Clean the outside of the device using a soft, damp cloth (don't use microfiber cloth).

Support:

If you need further help or have comments or suggestions please visit www.shada.nl/nl/contact



Item should be disposed of separately from household waste. The item should be handed in for recycling in accordance with local environmental regulations for waste disposal.



This product carries the CE mark of certification, which confirms that this product meets EU safety, health and environmental protection requirements.



The full text of the EU declaration of conformity is available at the following internet address:
<https://www.shada.nl/downloads>.

Documents / Resources

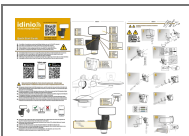

[Idinio Security Camera Smart Floodlight](#) [pdf] User Guide
Security Camera Smart Floodlight, Smart Floodlight, Security Camera, Floodlight