



## Ideal Standard Strada II Countertop Basin Instruction Manual

[Home](#) » [Ideal Standard](#) » Ideal Standard Strada II Countertop Basin Instruction Manual 

### Ideal Standard Strada II Countertop Basin Instruction Manual



#### Contents

- [1 Assembly instructions](#)
- [2 Dimensions](#)
- [3 Installation Instruction](#)
- [4 ECOLOGICAL NOTES](#)
  - [4.1 PRODUCT LIFE-CYCLE](#)
  - [4.2 PRODUCT INFORMATION](#)
- [5 SAFETY](#)
- [6 MAINTENANCE AND CLEANING](#)
- [7 Support](#)
- [8 Documents / Resources](#)
- [9 Related Posts](#)

### Assembly instructions

Please read the instructions first. We reserve the right to change product specifications due to possible technical

improvements. The manual is supplied with the product. It must be kept for future reference and for the entire life cycle of the product and given to each subsequent owner.

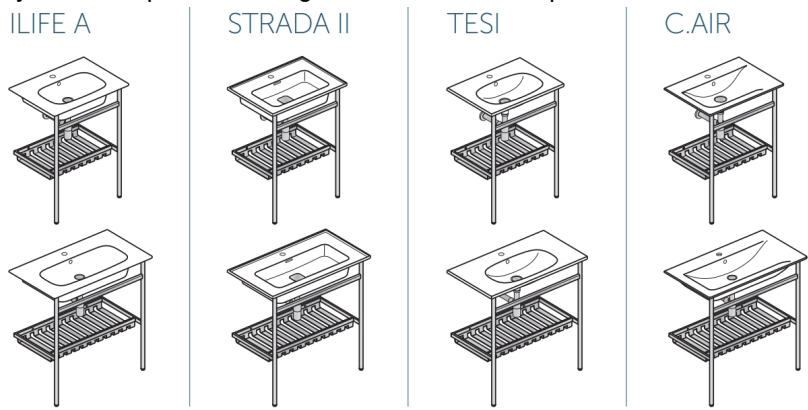

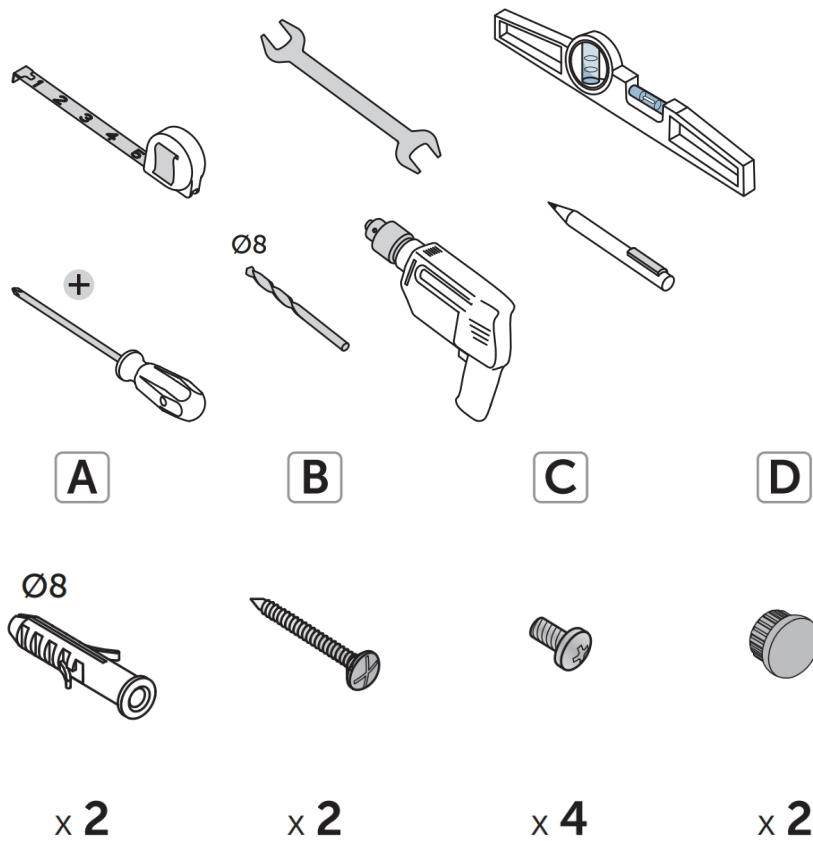

**Caution:** Always use appropriate fixings to suit your type of wall.



**Dimensions**



**ILIFE A**

## ILIFE A

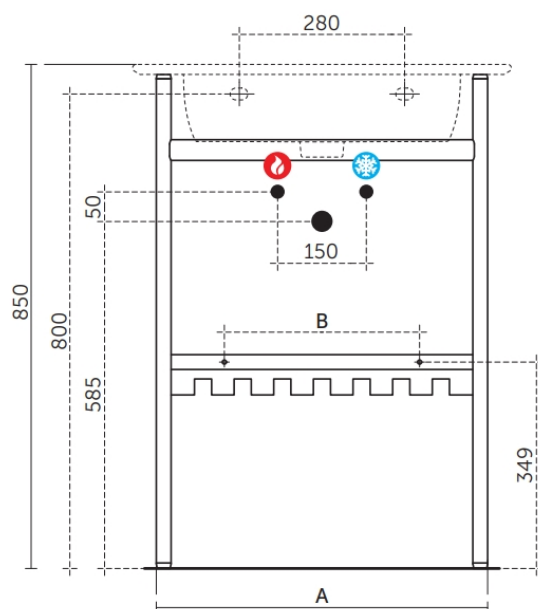
	A	B
	560	330
	760	460



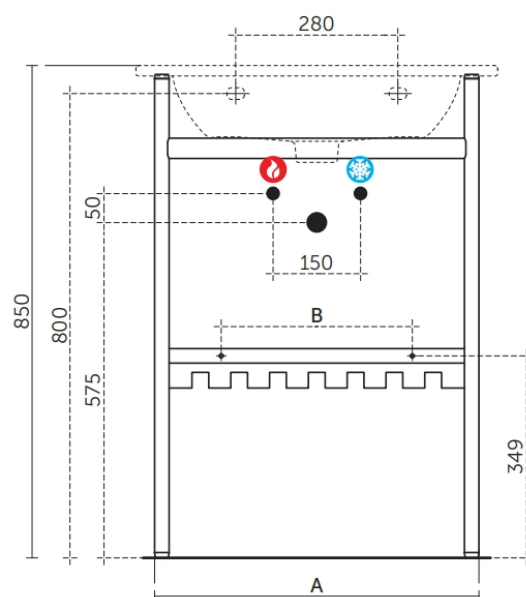

## TESI

	A	B
	560	330
	760	460



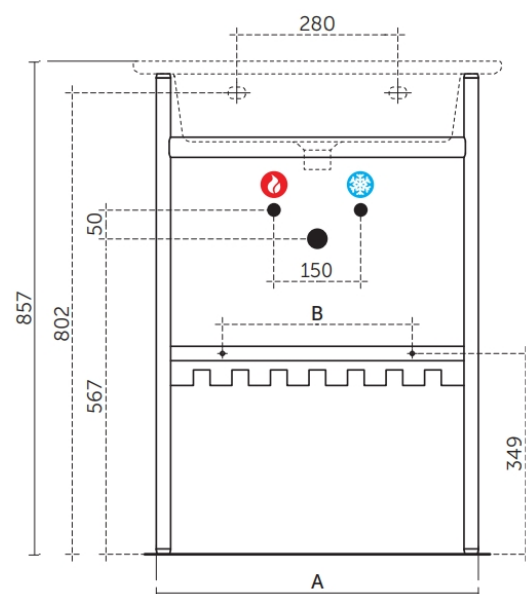

## STRADA II

	A	B
	560	330
	760	460

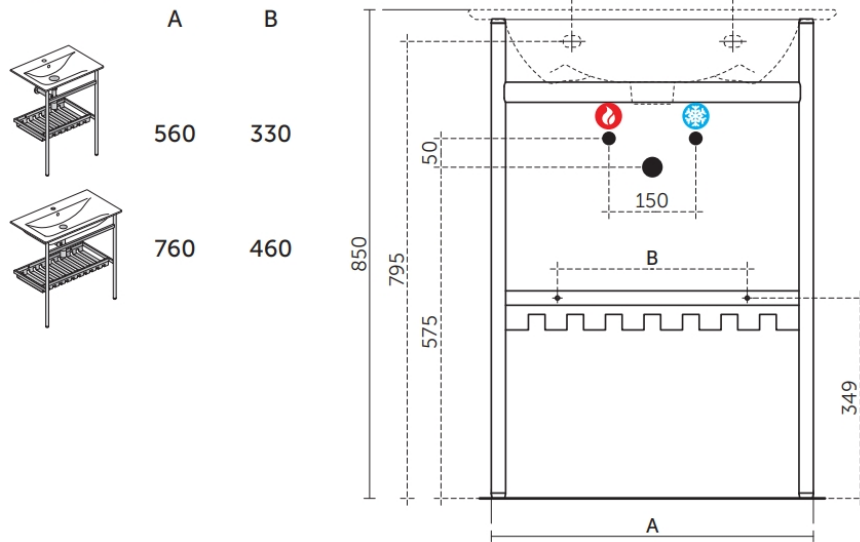

## C.AIR



-  Wall-mounted hot water tap
-  Wall-mounted cold water tap

## Installation Instruction

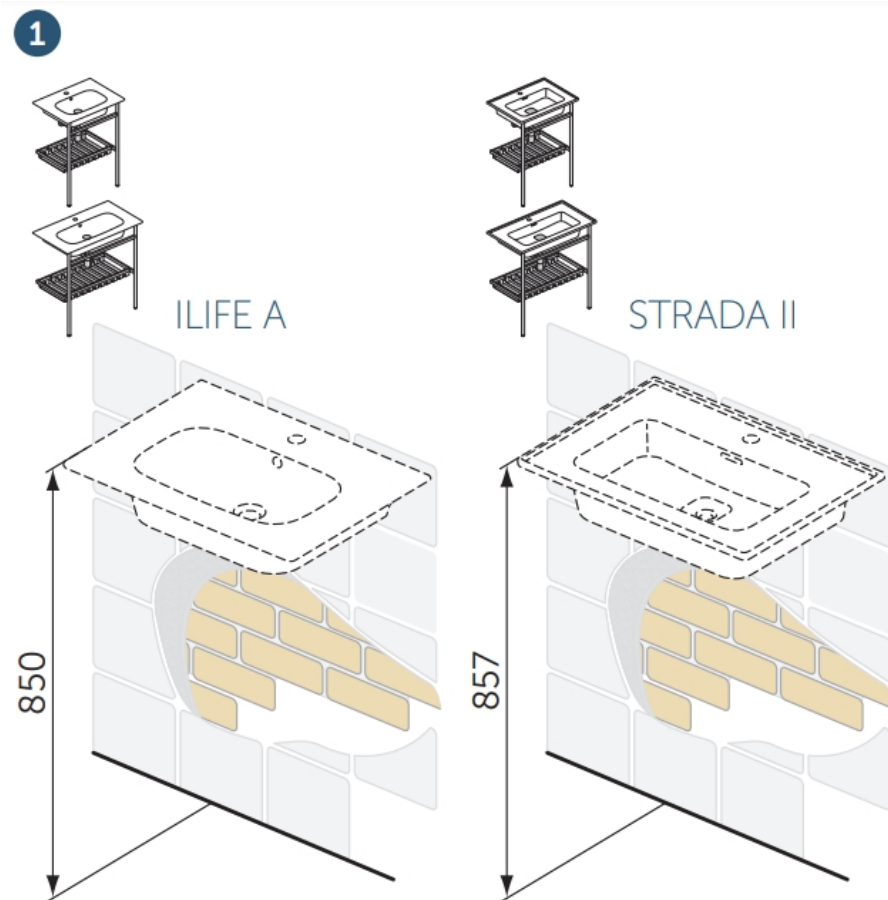

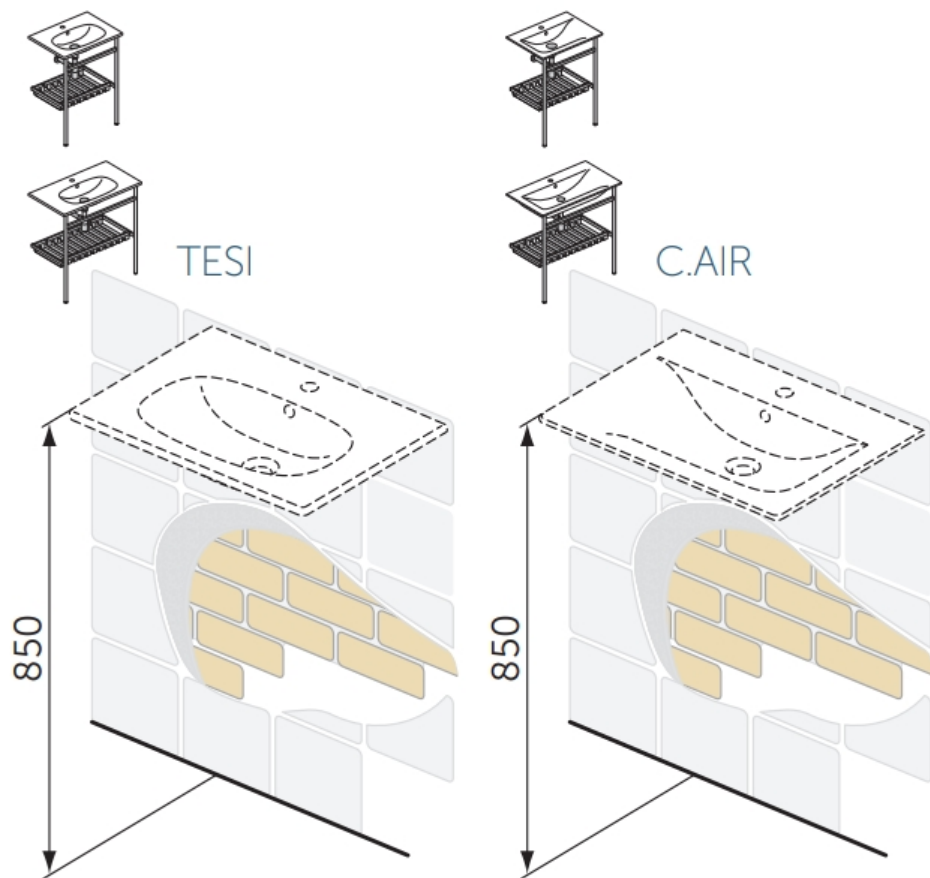

2

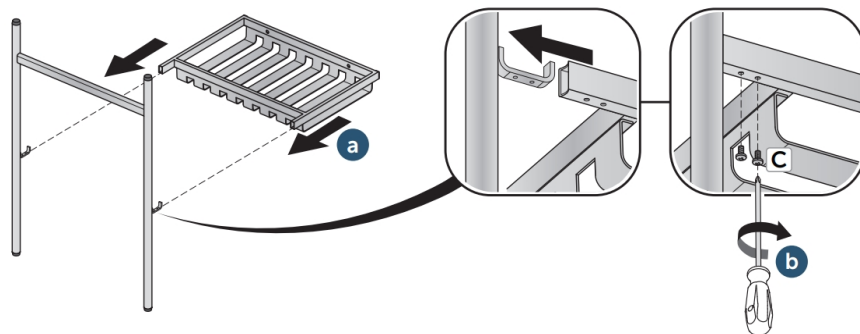

3

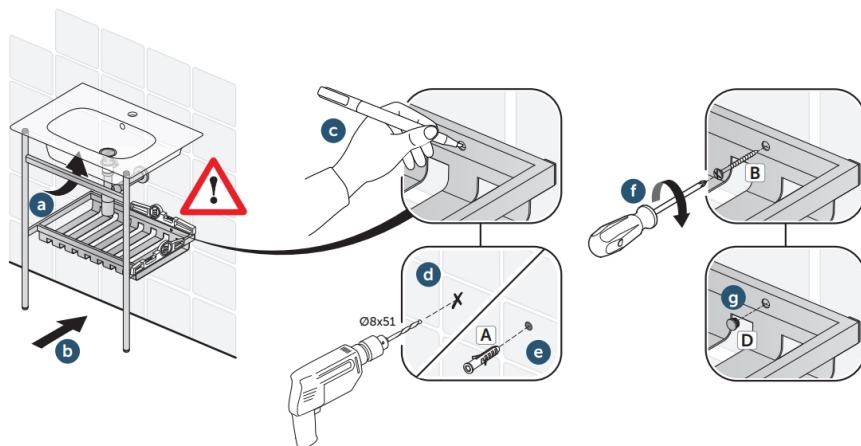

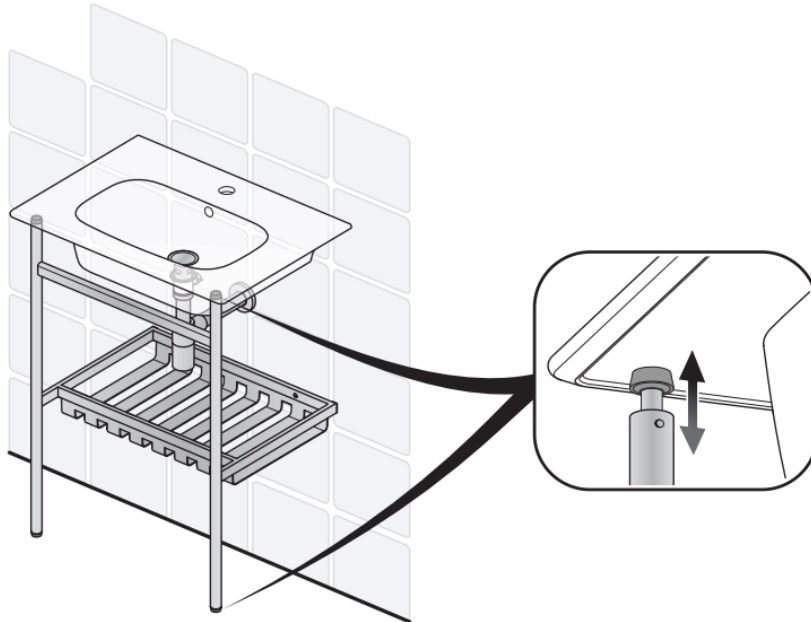

## ECOLOGICAL NOTES

Upon completion of installation, please remember to dispose of the packaging and assembly waste in accordance with the regulations in effect in the country where the product will be used.

## PRODUCT LIFE-CYCLE

At the end of its useful life, entrust the unit to the local waste disposal company.

## PRODUCT INFORMATION

Metal frame; Finishes: Matt black or Chrome frame

## SAFETY

 Incorrect installation and/or use of the item for any purpose other than that for which it was intended can be dangerous or cause possible injury to users. Maximum Shelf Loading: 17 kg evenly distributed.

## MAINTENANCE AND CLEANING

When cleaning chromed products use only a mild detergent, rinse & wipe dry with a soft cloth. Ideally clean after each use to maintain appearance. Never use abrasive, scouring powders or scrapers. Never use cleaning agents containing alcohol, ammonia, hydrochloric acid, sulphuric acid, nitric acid, phosphoric acid or organic solvents. Use of incorrect cleaning products / methods may result in chrome damage which is not covered by the manufacturer's guarantee.

### Guarantee:

Product warranty takes effect as of the purchase date of the product, as shown on the invoice or receipt and for the period granted under applicable law. Product warranty granted by law only covers defects (appearance, dimension, operation) existing at the time of delivery resulting from manufacturing errors, as verified and confirmed by the manufacturer's after-sales service technical staff. Normal wear is not included.

## Support

## QR Code:



**GB** 01482 496 318  
**IT** 800 – 652290  
**FR** +33 (0)1 49 38 28 00  
**DE** +49 (0)228 521 580

**ES** +34 93 561 80 00  
**DK** +45 75 84 10 10  
**BG** +359 675 30801  
**BE** +32 (02) 325 66 33

**CZ** +420 417 592 111  
**EE** +371 673 57 792  
**GR** +30 210 67 90 810  
**HU** +36 30 6991 594

**LT** +371 673 57 792  
**LV** +371 673 57 792  
**MD** +7 495 669 23 11  
**MK** +381 11 713 80 58

**PL** +48 71 7868 301/302  
**RO** +40 21 3223 201/202  
**RU** +7 495 669 23 11  
**RS** +381 11 713 80 58

**SK** +420 417 592 179  
**TR** +90 216 314 87 87  
**UA** +359 675 30468  
**NL** +31 (077) 355 08 08

## Documents / Resources



[Ideal Standard Strada II Countertop Basin](#) [pdf] Instruction Manual  
ILIFE A, STRADA II, TESI, C.AIR, Countertop Basin, Basin, Strada II Countertop Basin

