

IDEAL
electrical™
32 In Sure Push In
Wire Connectors



IDEAL electrical 32 In Sure Push In Wire Connectors Instruction Manual

[Home](#) » [IDEAL electrical](#) » IDEAL electrical 32 In Sure Push In Wire Connectors Instruction Manual 

Contents

- [1 IDEAL electrical 32 Sure Push Wire Connectors](#)
- [2 Product Specifications](#)
- [3 Installation Instructions](#)
- [4 Wire Ranges](#)
- [5 Product Usage Instructions](#)
- [6 FAQs](#)
- [7 Documents / Resources](#)
 - [7.1 References](#)



IDEAL electrical 32 Sure Push Wire Connectors



Product Specifications

- Wire Ranges:
 - Solid Copper (Reusable): 20-12 AWG
 - Stranded Copper (Non-Reusable): 16-12 AWG (19 Stranded), 18 AWG (7 Stranded)
 - Stranded Copper Tin-Bonded (Non-Reusable): 18-14 AWG (19 Stranded)
 - Solid Copper-Clad Aluminum: 12 AWG
- Wire Strip Length: 1/2 inch (13 mm)

Installation Instructions

To be sold only with installation instructions.

1. Wiring must comply with all applicable electrical codes.

Wire Strip Length

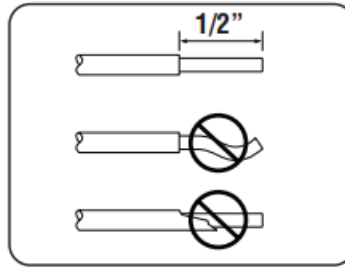

Insertion

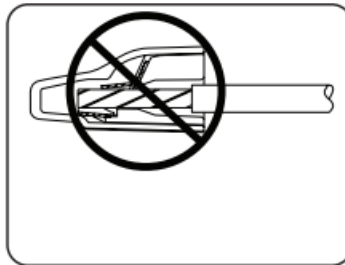
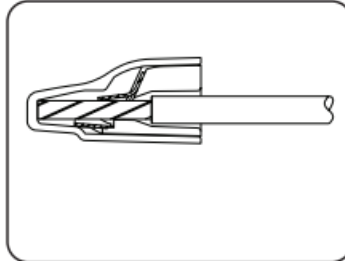

Removal

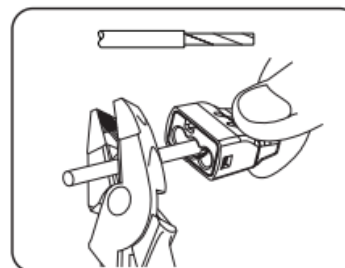
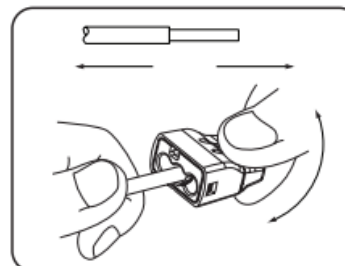

2. Turn off the power before installing or removing connectors.
3. Cleanly strip wires 1/2" (13 mm).
4. Grip the wire firmly and push the conductor into an open port. Slightly twist the stranded wire counterclockwise while inserting. Use only one conductor per port.
5. Verify conductor is fully inserted into the back of the connector.
6. CThe connections are reusable on solid wires only of the same wire gauge or larger. If reusing connector, cut and re-strip conductors.
7. To remove a solid wire, pull and twist the wire back and forth.
8. DO NOT RE-USE connector on stranded wire.

Wire Ranges

- Solid Copper (Reusable): 20-12 AWG
- Stranded Copper (Non-Reusable): 16-12 AWG (≤ 19 Stranded)
- 18 AWG (7 Stranded)
- DO NOT USE WITH 16 AWG (26 Stranded)
- Stranded Copper Tin-Bonded (Non-Reusable): 18-14 AWG (≤ 19 Stranded)
- Solid Copper-Clad Aluminum 12 AWG

CAUTION: LISTED FOR USE WITH Cu-Cu and CC-Cu. DO NOT USE ON ALUMINUM WIRE. For use in dry locations only. Consult IDEAL

- For a complete table of UL-listed wire combinations.
- Temperature Rating: 105°C (221°F) maximum.
- Voltage Rating: 600V maximum building wire, 1000V in signs and lighting fixtures.

Product Usage Instructions

1. Wiring Compliance:

- Ensure wiring complies with all applicable electrical codes.

2. Power Shutdown:

- Turn off the power before installing or removing connectors.

3. Wire Preparation:

- Cleanly strip wires to a length of 1/2 inch (13 mm).

4. Connector Installation:

- Grip the wire firmly and push the conductor into the open port.
- Slightly twist the stranded wire counter-clockwise while Inserting.
- Use only one conductor per port.
- Verify conductor is fully inserted into the back of the Connector.

5. Reusability:

- The connector is reusable on solid wires only of the same wire gauge or larger.
- If reusing the connector, cut, and re-strip conductors.

6. Wire Removal:

- To remove a solid wire, pull and twist the wire back and forth.

7. Not for Stranded Wire Reuse:

- DO NOT RE-USE connector on stranded wire.



Improper use or installation of this product may cause fire, electrocution, serious personal injury, or death. Shut off power to the circuit or remove the fuse before using this product. Use only connectors properly sized to the wiring being used. Consult local building codes for installation requirements.

WARRANTY: www.idealind.com

WARNING

FAQs

Q: Can I reuse the connector on stranded wires?

A: No, the connector is not designed for reuse on stranded wires. Only reuse with solid wires of the same gauge or larger.

Q: What wire ranges are supported by the product?

A: The product supports various wire ranges including solid copper, stranded copper, stranded copper tin-bonded, and solid copper-clad aluminum. Refer to the specifications section for detailed information.

Documents / Resources

	IDEAL electrical 32 In Sure Push In Wire Connectors [pdf] Instruction Manual 32, 33, 34, 32 In Sure Push In Wire Connectors, 32 In, Sure Push In Wire Connectors, Wire Connectors
-----------------------------------------------------------------------------------	------------------------------------------------------------------------------------------------------------------------------------------------------------------------------------------------------

References

-  P65Warnings.ca.gov
- [User Manual](#)

Manuals+. [Privacy Policy](#)

This website is an independent publication and is neither affiliated with nor endorsed by any of the trademark owners. The "Bluetooth®" word mark and logos are registered trademarks owned by Bluetooth SIG, Inc. The "Wi-Fi®" word mark and logos are registered trademarks owned by the Wi-Fi Alliance. Any use of these marks on this website does not imply any affiliation with or endorsement.